

FIBERGLASS FULL LOUVER DOUBLE DOOR FBC PRODUCT APPROVAL DRAWINGS

ANCHORAGE SCHEDULE AND DESCRIPTION				
SUBSTRATE	ANCHOR	EMBEDMENT	ANCHOR SPACING	EDGE DISTANCE
WOOD FRAMING	#14 WOOD SCREW	MINIMUM 1-1/2"	MINIMUM 1-1/2"	MINIMUM 2"
CONCRETE	1/4" TAPPER	MINIMUM 1-3/8"	MINIMUM 2-1/2"	MINIMUM 2-1/2"
CONCRETE	1/4" TAPCON	MINIMUM 1-1/4"	MINIMUM 2-1/2"	MINIMUM 2-1/2"
CONCRETE	1/4" CRETE-FLEX	MINIMUM 1-1/4"	MINIMUM 2-1/2"	MINIMUM 2-1/2"
STEEL STUD	#14-20 GR 2 SMS	MINIMUM 1"	MINIMUM 1-1/2"	MINIMUM 2"

DESIGN PRESSURE RATING	IMPACT RATING
+/-55.0	LARGE MISSILE

DRAWINGS TABLE OF CONTENTS

- SHEET 1: INDEX TO DRAWINGS AND NOTES
- SHEET 2: ELEVATIONS
- SHEET 3: ELEVATIONS AND BOM
- SHEET 4: ANCHORAGE DETAILS
- SHEET 5: ANCHORAGE DETAILS
- SHEET 6: HARDWARE OPTIONS
- SHEET 7: HARDWARE OPTIONS

OVERALL SIZE:
76-1/2" x 86-3/4"

PANEL D.L.O.:
36" X 84"

NOTES:

1. THE PRODUCT ILLUSTRATED SATISFIES THE REQUIREMENTS FOR THE FLORIDA BUILDING CODE INCLUDING HVHZ.
2. THE INSTALLATION DRAWINGS DEPICTED WITHIN ARE NECESSARY TO MEET THE STRUCTURAL LOAD REQUIREMENTS. PLEASE SEE THE MANUFACTURER'S INSTALLATION INSTRUCTIONS FOR SEALING, FLASHING AND DRAINAGE REQUIREMENTS.
3. THIS PRODUCT IS IMPACT RESISTANT AND THEREFORE AN APPROVED IMPACT PROTECTION SYSTEM IS NOT REQUIRED FOR THIS PRODUCT IF IT IS INSTALLED IN A WIND BORNE DEBRIS AREA.
4. THIS PRODUCT IS NOT APPROVED FOR USE WHERE WATER INFILTRATION RESISTANCE IS REQUIRED BY THE DOOR, UNLESS UNITS ARE INSTALLED IN A NON-HABITABLE AREA WHERE THE UNIT AND THE AREA ARE DESIGNED TO ACCEPT WATER INFILTRATION. UNITS SHALL BE INSTALLED ONLY AT LOCATIONS PROTECTED BY A CANOPY OR OVERHANG SUCH THAT THE ANGLE BETWEEN THE EDGE OF THE CANOPY OR OVERHANG TO THE SILL IS LESS THAN 45 DEGREES.
5. MAXIMUM ALLOWABLE SHIM STACK TO BE 1/4". SHIM ALL SPACES IN EXCESS OF 1/16".
6. WOOD FRAMING INSTALLATIONS ARE ASSUMED TO BE 2X S-P-F (G=0.42) OR DENSER. WOOD FRAMING SHALL BE GREATER THAN THE WINDOW FRAME WIDTH. TAPERED OR PARTIAL WOOD BUCKS ARE NOT ALLOWED. FOR INSTALLATION INTO WOOD FRAMING USE #14 WOOD SCREWS WITH SUFFICIENT LENGTH TO OBTAIN A 1-1/2" PENETRATION. ANCHORS SHALL BE LOCATED AS DESCRIBED IN THE ELEVATION DETAIL.
7. CONCRETE INSTALLATIONS ASSUME A MINIMUM COMPRESSIVE STRENGTH FOR CONCRETE OF 3,200 PSI . USE A 1/4" ITW TAPCON, A 1/4" POWERS TAPPER OR A 1/4" CRETE-FLEX SS4 ANCHOR FOR INSTALLATION INTO CONCRETE. THE ANCHOR SHALL HAVE A MINIMUM OF 1-1/4" EMBEDMENT. PLEASE SEE TABLE FOR EMBEDMENT REQUIREMENTS FOR EACH ANCHOR. ANCHORS SHALL BE LOCATED AS DESCRIBED IN THE ELEVATION DETAIL.
8. METAL FRAMING INSTALLATION SHALL BE A MINIMUM OF 16 GAUGE 33 KSI STRENGTH METAL. USE A #14 GRADE 2 SMS WITH SUFFICIENT LENGTH TO ACHIEVE FULL PENETRATION OF THE METAL FRAMING AND EMBED 1/4" BEYOND THE DRILL POINT.
9. CORROSIVE RESISTANT FASTENERS SHALL BE USED.
10. WINDOW FRAME MATERIAL SHALL BE FRP MATERIAL.
11. ALLOWABLE STRESS INCREASE OF 1/3 WAS NOT USED IN THE DESIGN OF THE PRODUCT SHOWN, WIND LOAD DURATION FACTOR Cd=1.6 WAS USED FOR WOOD ANCHOR CALCULATIONS.
12. UNITS SHALL BE INSTALLED AS DESCRIBED IN THESE INSTALLATION INSTRUCTIONS AND ALSO IN CONFORMANCE TO THE MANUFACTURER'S PUBLISHED INSTALLATION INSTRUCTIONS.

REVISIONS	MATERIAL	CHEM-PRUF DOOR CO. LTD P.O. BOX 4560, 5224 FM 802 BROWNSVILLE, TX 78521	SCALE NTS
	EST. AREA		DWG NO. 100255D
	EST. WT.		SHEET NO. 1 OF 7
	EST. PERIM.	FIBERGLASS FULL LOUVER DOOR FBC INSTALLATION DRAWINGS GENERAL NOTES	EXTRUSION NO. REV.
	DRAWN BY JMR	DATE 04/20/11	

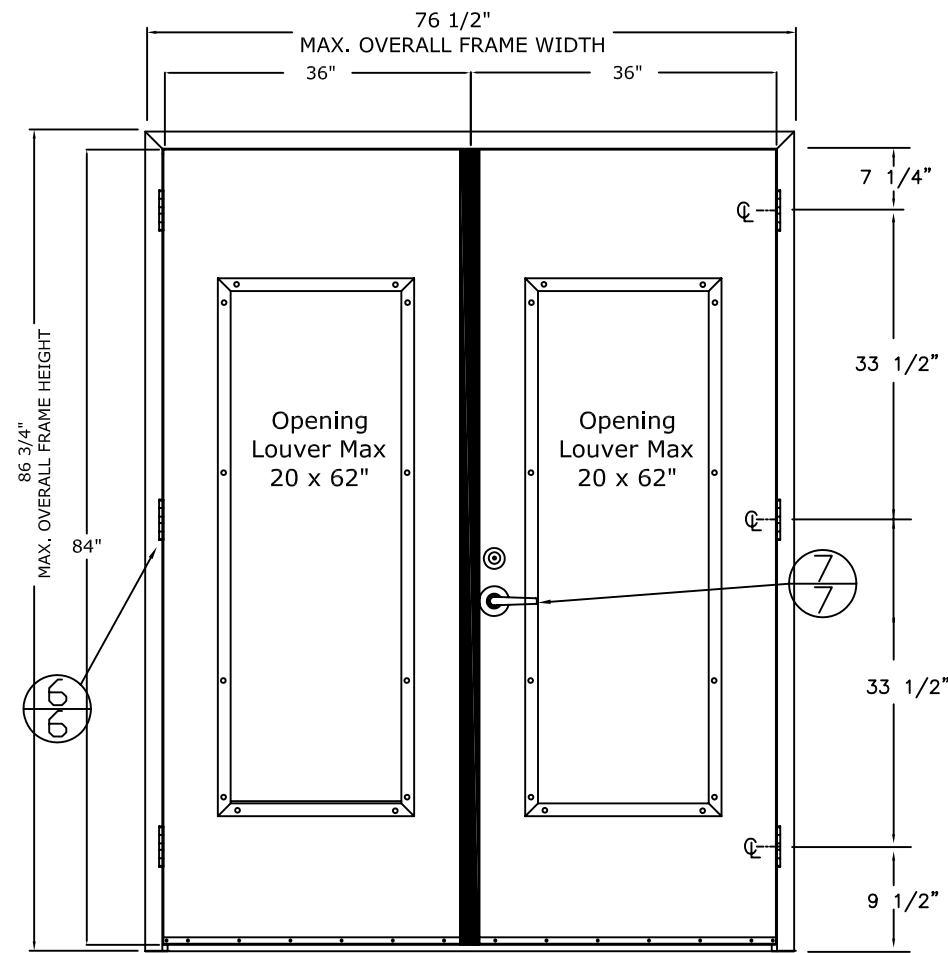

EXTERIOR VIEW
FIBERGLASS FULL LOUVER OUTSWING DOUBLE DOOR

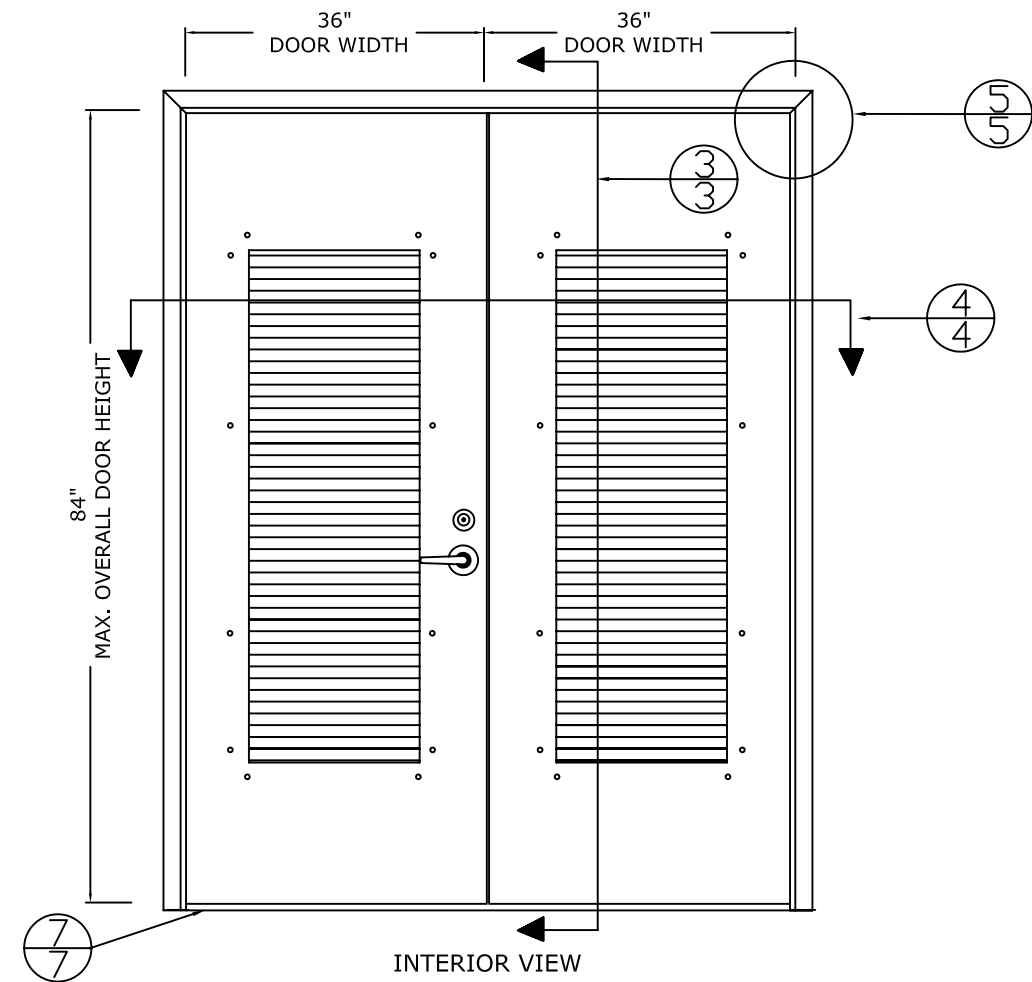

INTERIOR VIEW
FIBERGLASS FULL LOUVER OUTSWING DOUBLE DOOR

REVISIONS		MATERIAL		CHEM-PRUF DOOR CO. LTD P.O. BOX 4560, 5224 FM 802 BROWNSVILLE, TX 78521		SCALE NTS	
		EST. AREA				DWG NO. 100255D	
		EST. WT.		FIBERGLASS FIRE SINGLE OS DOOR FBC INSTALLATION DRAWINGS ELEVATION DETAILS		SHEET NO. 2 OF 7	
		EST. PERIM.				EXTRUSION NO. REV.	
		DRAWN BY JMR	DATE 04/20/11				

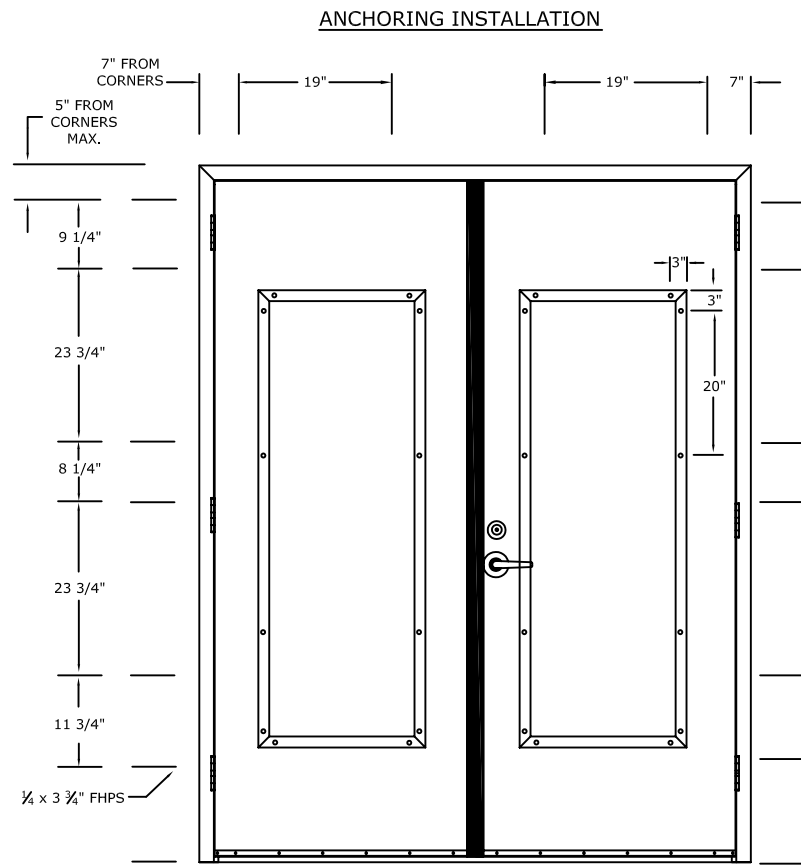

EXTERIOR VIEW
FIBERGLASS FULL LOUVER OUTSWING DOUBLE DOOR

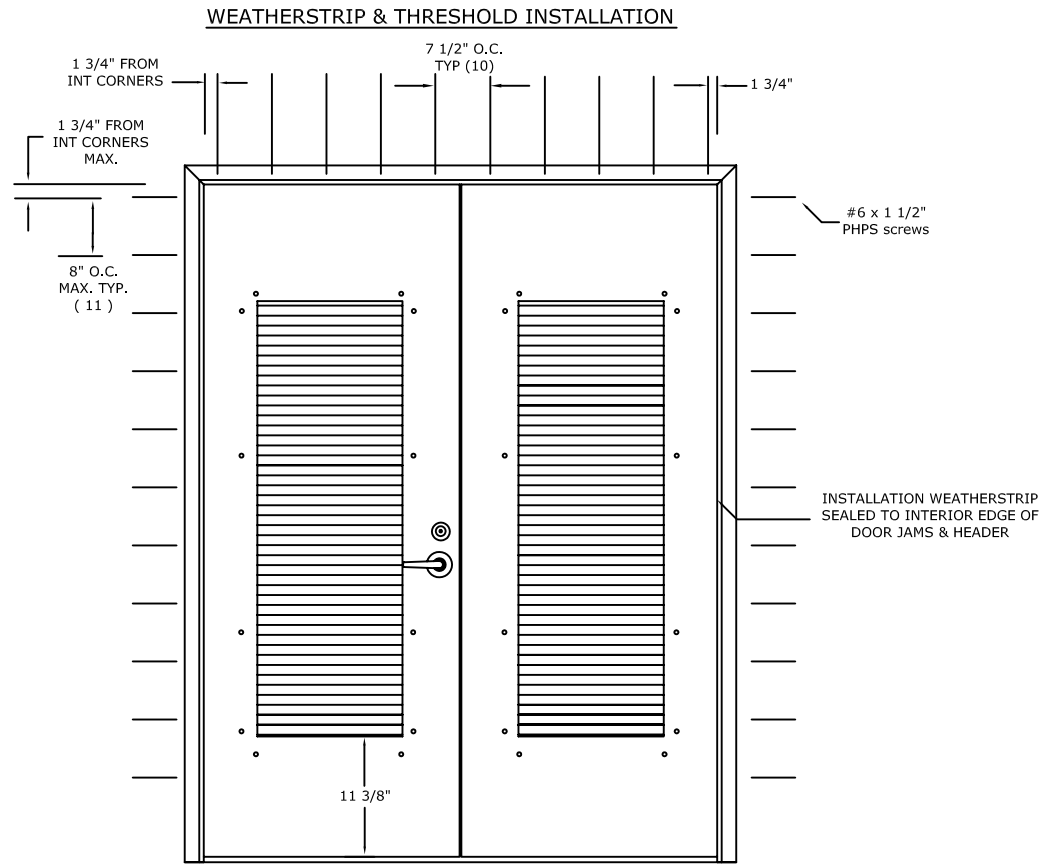

INTERIOR VIEW
FIBERGLASS FULL LOUVER OUTSWING DOUBLE DOOR

BILL OF MATERIAL	
ITEM	DESCRIPTION
1	STANDARD GELCOAT
2	COMBIFLOW MAT
3	FOAM FILLER
4	TRIVERA
5	CYLINDRICAL LOCK 10G05 SGT
6	DEADBOLT CYL X THUMBTURN SGT 475
7	FLUSH BOLT MANUAL TRIMCO 3917
8	LOUVER SPACER
9	CAULK MATERIAL
10	HINGE, FM STAN FBB 191 4.5 X 4.5 NRP
11	FRP PLATE
12	PPC CORE
13	2" FRAME JAMB 5-3/4" THICK
	A) 5 1/4" x 3/8" TRIVERA.
	B) 5 1/4" x 1" FOAM FILLER.
	C) 1 1/2" x 5/8" FOAM FILLER.
14	WEATHERSTRIP CHEM-PRUF
15	LOUVER STD INVERTED "V" 19 3/4" X 60"
16	THRESHOLD PANIC TYPE 896V NGP
17	ADHESIVE WEATHERSTRIP
18	ASTRAGAL, FIBERGLASS CPH-A WITH SEAL
19	A) STANDARD GELCOAT
20	B) NEOPRENE SEAL
21	LOUVER COVER 19 3/4" X 60"
22	LOUVER FRP FRAME

REVISIONS		MATERIAL	CHEM-PRUF DOOR CO. LTD P.O. BOX 4560, 5224 FM 802 BROWNSVILLE, TX 78521	SCALE	
		EST. AREA		NTS	
		EST. WT.		DWG NO.	
		EST. PERIM.		100255D	
		DRAWN BY JMR	DATE 04/20/11	SHEET NO. 3 OF 7	
				FIBERGLASS FIRE SINGLE OS DOOR FBC INSTALLATION DRAWINGS ANCHORAGE DETAILS	
				EXTRUSION NO.	REV.

VERTICAL CROSS-SECTION

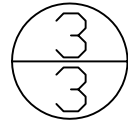

DOOR TOP

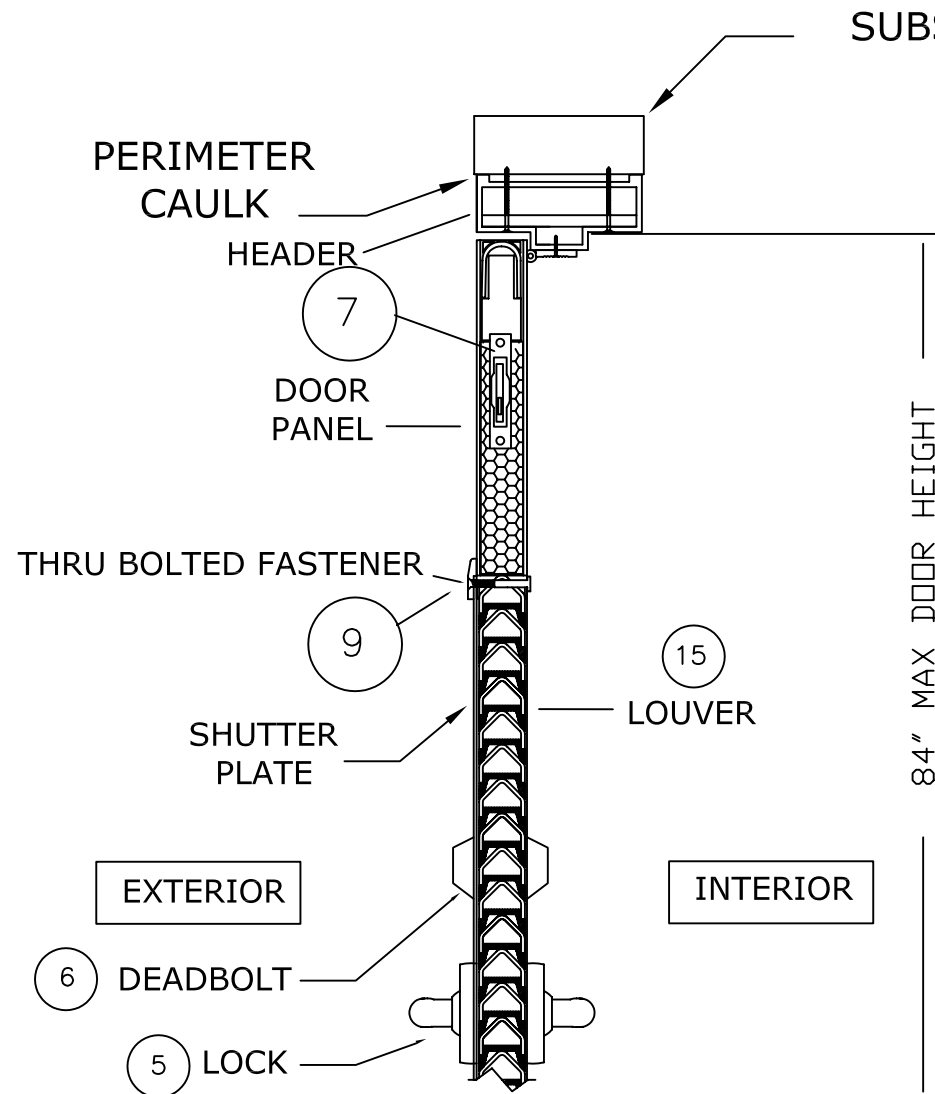

SUBSTRATE

INVERTED "V" LOUVER VIEW

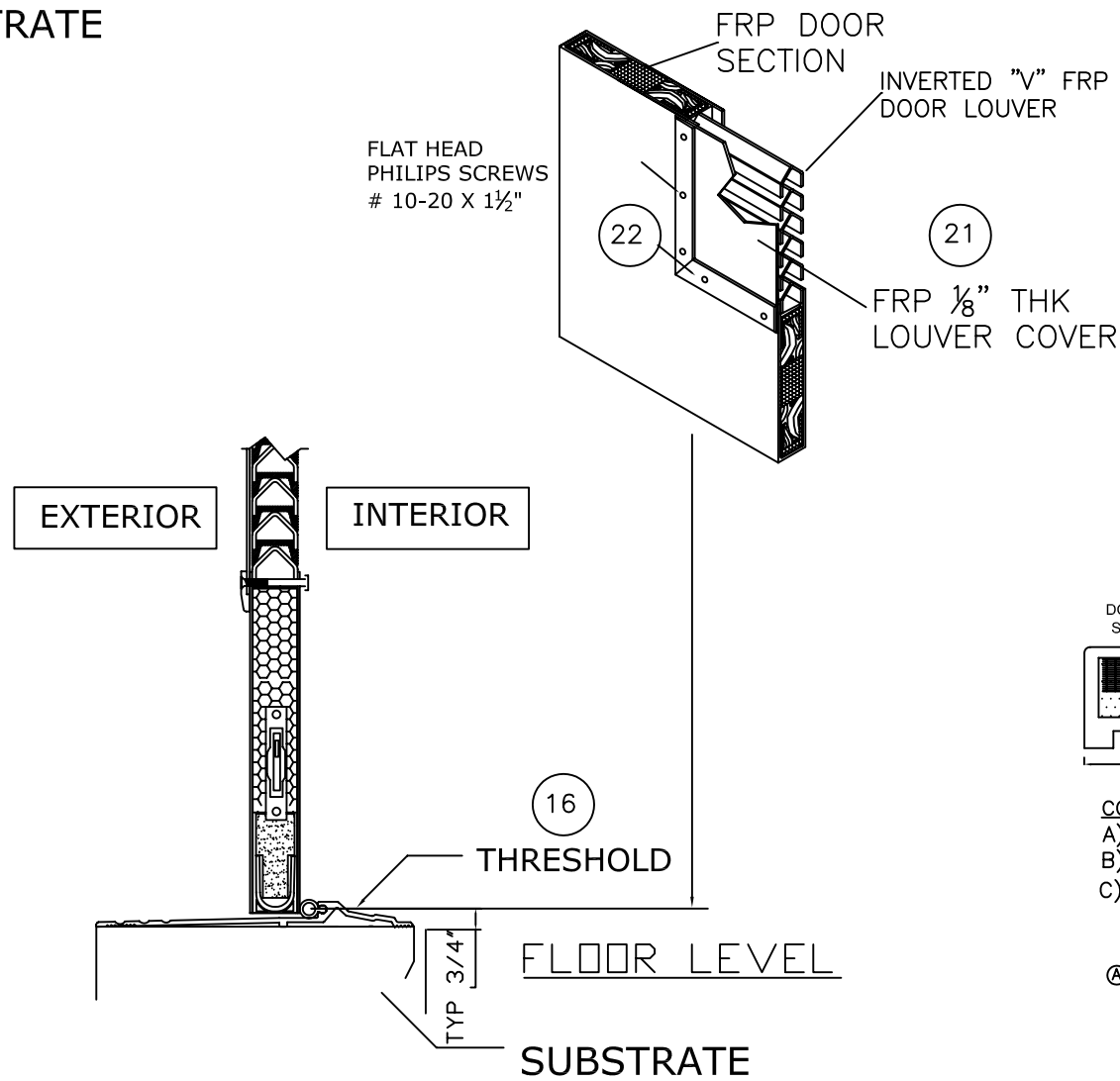

DETAIL LEGEND	
#	DESCRIPTION
1	GELCOAT
2	COMBIFLOW MAT
3	FOAM FILLER
4	TRIVERA

FRAME CONSTRUCTION

- 1). GELCOAT 25 MILLS.
- 2). LAYER COMBIFLO MAT
- 3). RESIN - 33000 RT RESIN WITH 40% ATH FILLER.
- 4). TRIVERA.

JAMB

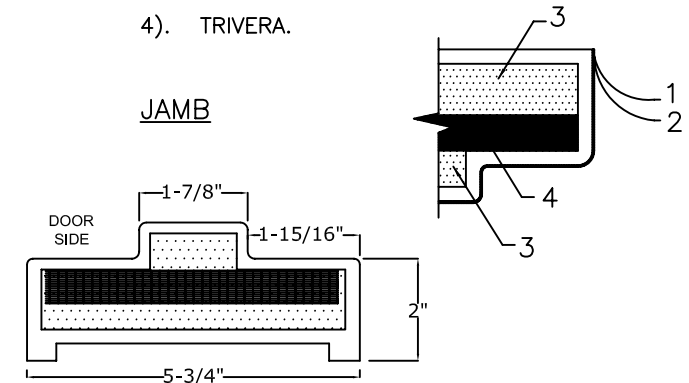

CORE DIMENSIONS

- A) 5 1/4" x 3/8" TRIVERA.
- B) 5 1/4" x 1" FOAM FILLER.
- C) 1 1/2" x 5/8" FOAM FILLER.

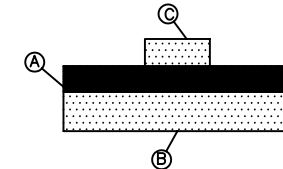

REVISIONS		MATERIAL	CHEM-PRUF DOOR CO. LTD P.O. BOX 4560, 5224 FM 802 BROWNSVILLE, TX 78521 FIBERGLASS FIRE SINGLE OS DOOR FBC INSTALLATION DRAWINGS INSTALLATION DETAILS	SCALE	
		EST. AREA		NTS	
		EST. WT.		DWG NO.	
		EST. PERIM.		100255D	
		DRAWN BY JMR		SHEET NO. 4 OF 7	
		DATE 04/20/10	EXTRUSION NO.	REV.	

NOTE: SUGGESTED FASTENING IN ALTERNATE MATERIALS (TESTED IN WOOD)
SEE SHEET 2 FOR FASTENER REQUIREMENTS

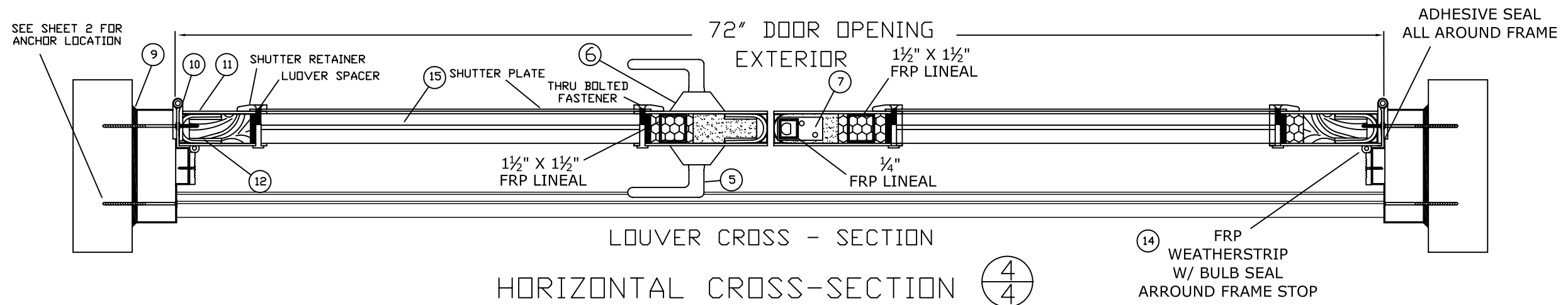
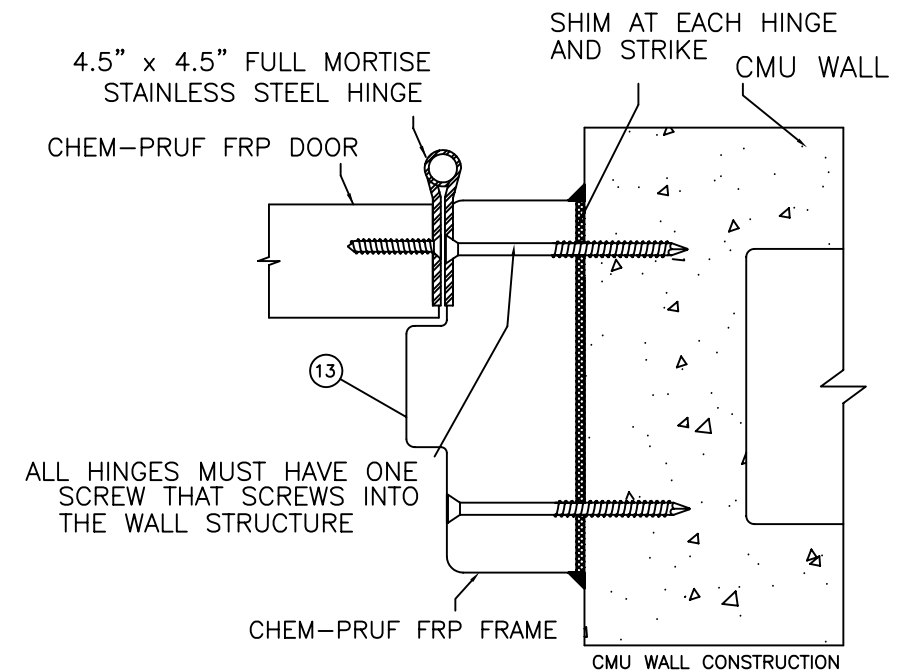
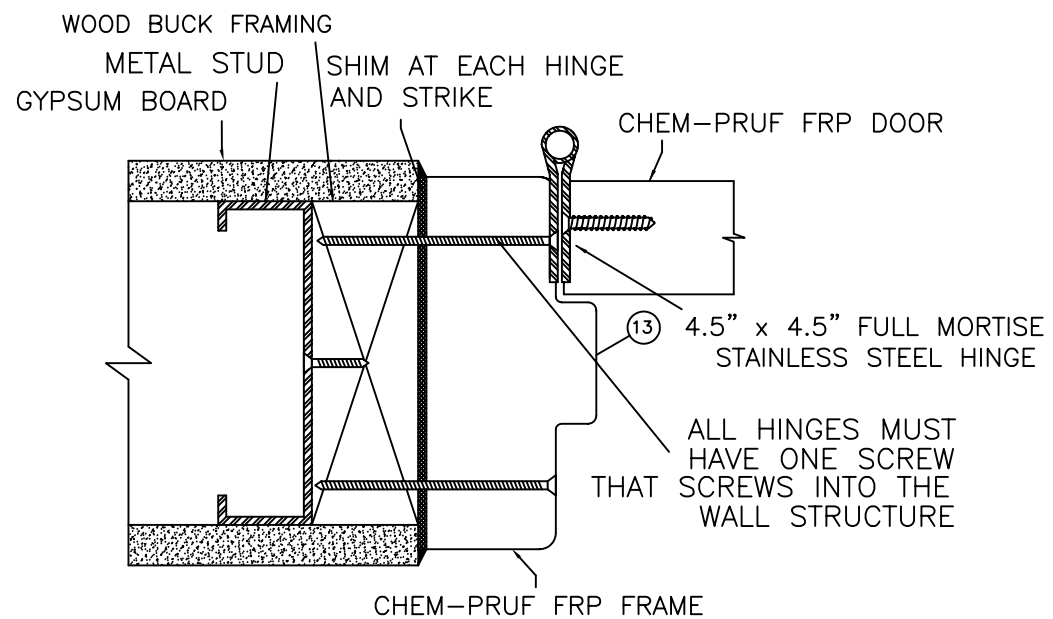

REVISIONS		MATERIAL	CHEM-PRUF DOOR CO. LTD P.O. BOX 4560, 5224 FM 802 BROWNSVILLE, TX 78521	SCALE	
		EST. AREA		NTS	
		EST. WT.		DWG NO. 100255D	
		EST. PERIM.		SHEET NO. 5 OF 7	
		DRAWN BY JMR		DATE 04/20/11	
			FIBERGLASS FIRE SINGLE OS DOOR FBC INSTALLATION DRAWINGS INSTALLATION DETAILS	EXTRUSION NO.	REV.

HINGE POCKET PREPARATION

CHEM-PRUF® STANDARD



HEADER AND JAMBS ARE ATTACHED USING (4)#10 x 2 1/2" FLAT HEAD PHILIPS SCREWS 2 SCREWS THRU JAMB AND 2 SCREWS THRU HEAD

FRAME HINGE RABBET

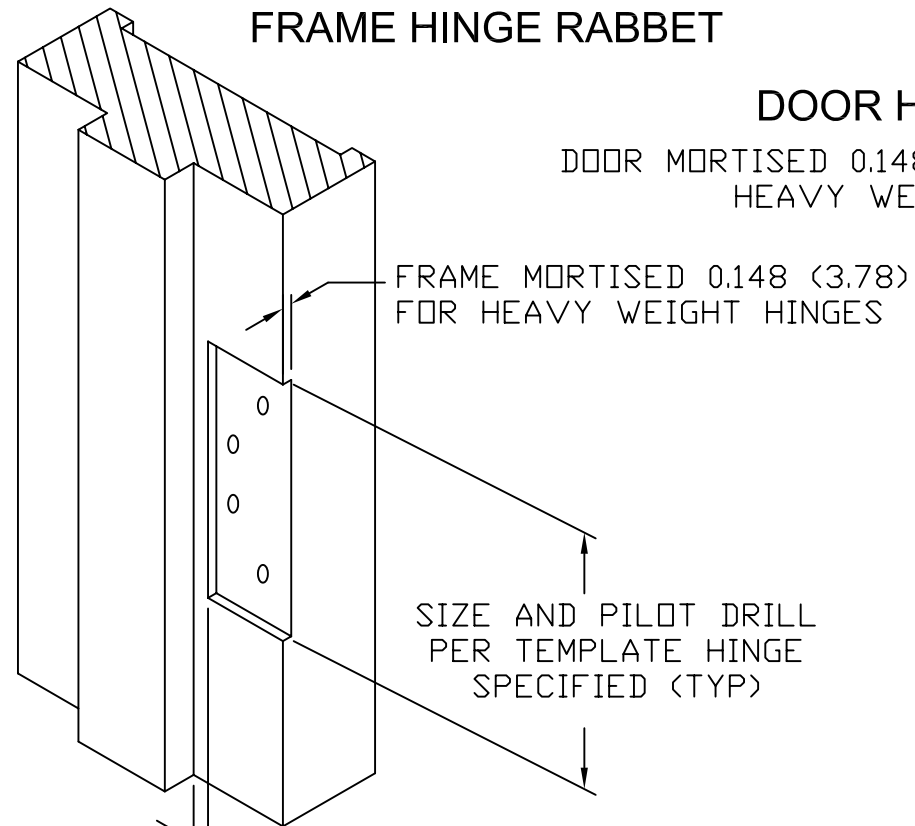

5/16" (15.88) STANDARD

DOOR HINGE RABBET

DOOR MORTISED 0.148 (3.78) FOR HEAVY WEIGHT HINGES

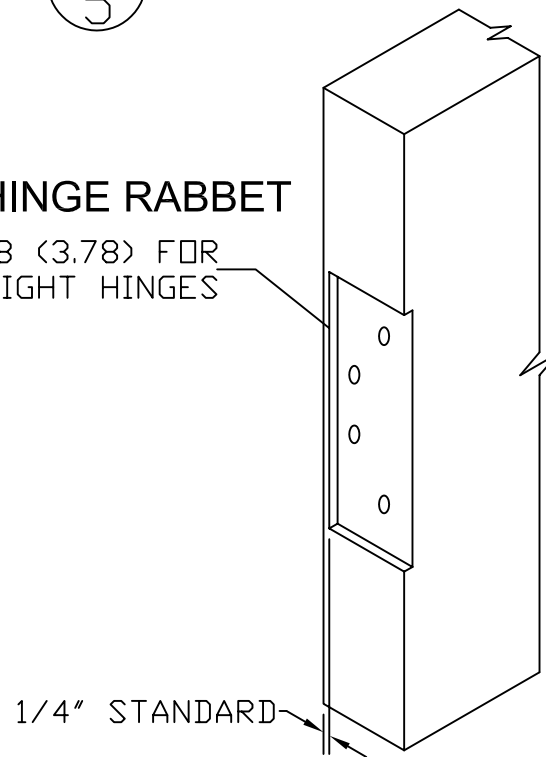

Ø1/4" PILOT DRILL THRU -3 HOLES PER JAMB

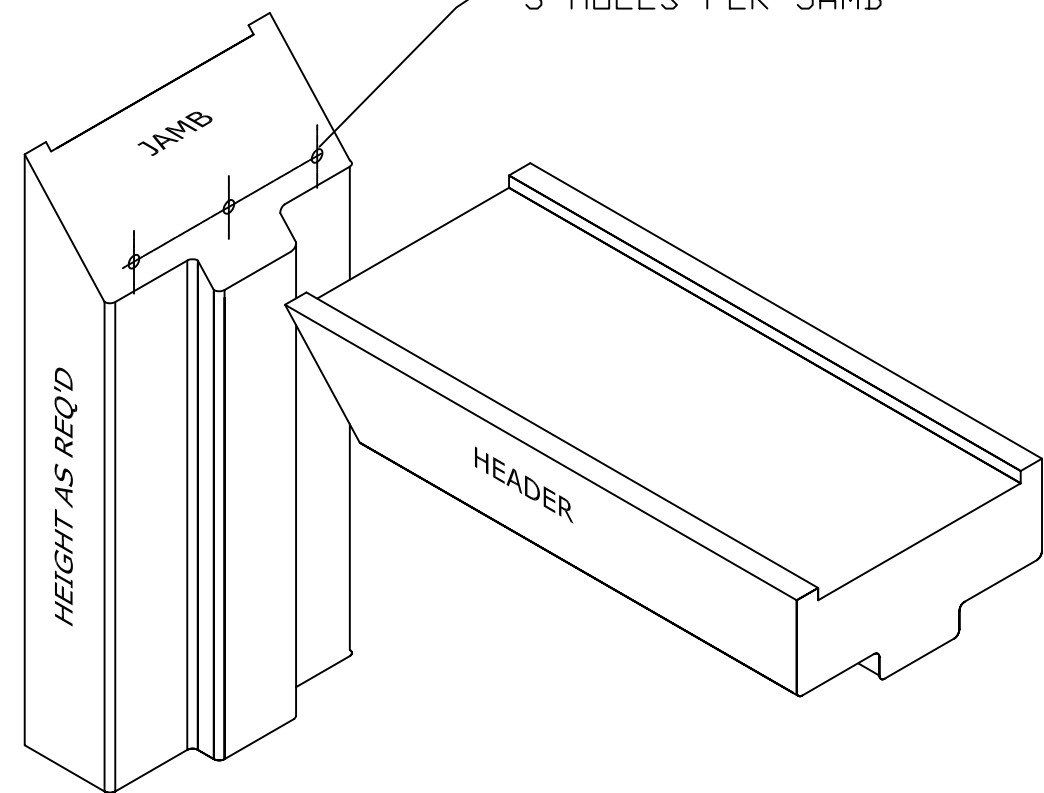

FRAME CORNER ASSEMBLY

REVISIONS		MATERIAL	CHEM-PRUF DOOR CO. LTD P.O. BOX 4560, 5224 FM 802 BROWNSVILLE, TX 78521	SCALE NTS	
		EST. AREA		FIBERGLASS FIRE SINGLE OS DOOR FBC INSTALLATION DRAWINGS HARDWARE DETAILS	DWG NO.
		EST. WT.	100255D		SHEET NO.
		EST. PERIM.		EXTRUSION NO.	REV.
		DRAWN BY JMR	DATE 04/20/11		

17 ADHESIVE SILICONE SEAL

- FEATURES AND CERTIFICATIONS
- ADHESIVE BACKED DOOR GASKET WEATHERSTRIPPING.
 - BEGINS COMPRESSING AT 1/4" AND CAN BE COMPRESSED SUFFICIENTLY TO SEAL OPENING WITH 1/8" GAPS- WILL NOT LOSE ITS FORM.
 - STAYS FLEXIBLE WELL BELOW -100 DEGREES FARENHEIT AND RELIENT ABOUT 400 DEGREES FARENHEIT.
 - IMPERVIOUS TO FUNGUS AND MILDEW.

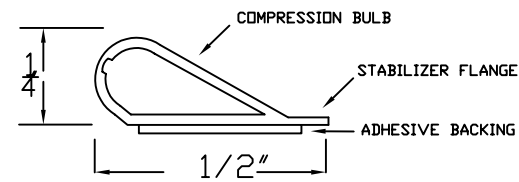

18 FRP ASTRAGAL

- FEATURES AND CERTIFICATIONS
- MOLDED FIBERGLASS DOOR SWEEP
 - MANUFACTURED BY CHEM-PRUF.
 - CORROSION RESISTANT.
 - COLOR MOLDED IN TO MATCH DOOR.
 - NEOPRENE WIPER
 - SUPPLIED WITH STAINLESS STEEL FASTENERS.

#	DESCRIPTION
1	STANDARD GELCOAT
2	FRP ASTRAGAL

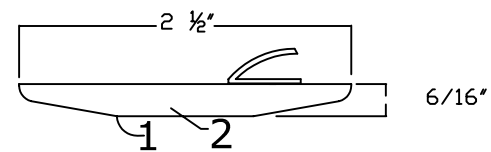

7 FLUSH BOLT, MANUAL TRIMCO 3917

- OVERALL SIZE: 1' x 6-3/4"
 THROW: 11/16" (3917 & W3917)
 ROD LENGTH: 12" STANDARD
- MATERIAL: EXTRUDED (3917 & 3917ET)
- 1-1/2" BOLT HEAD STANDARD (3917-1B)
 3" BOLT HEAD (3917-3B) IS ALSO AVAILABLE.
 LONGER ROD LENGTHS ARE AVAILABLE ON REQUEST.
 THE 3917 & W3917 ARE UL LISTED.

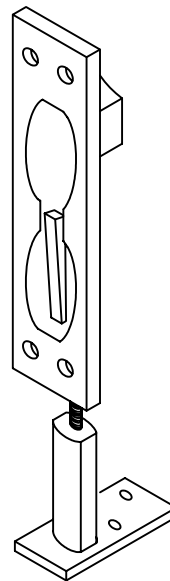

14 FRP WEATHERSTRIP

- FEATURES AND CERTIFICATIONS
- PULTRUDED WEATHERSTRIP.
 - CORROSION RESISTANT.
 - POST PAINTED TO MATCH DOOR COLOR.
 - BULB SEAL
 - SUPPLIED WITH STAINLESS STEEL FASTENERS.
 - # 6 x 1 1/4 (12) PHP

#	DESCRIPTION
1	STANDARD GELCOAT
14.2	PULTRUDED WEATHERSTRIP

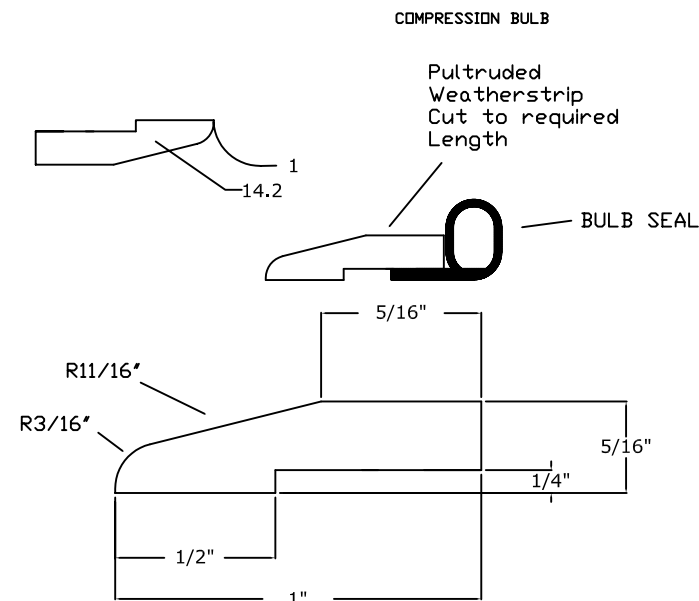

16 THRESHOLD

- FEATURES AND CERTIFICATIONS
- ALUMINUM FINISH
 - MEETS THE REQUIREMENTS OF ANSI A156.21
 - UL LISTED
 - THE BUMPER GASKET IS MADE OF VINYL AND IS USED TO PROVIDE A SEAL AGAINST THE DOOR AND INCREASE THE WEATHER RESISTANCE OF THE THRESHOLD.

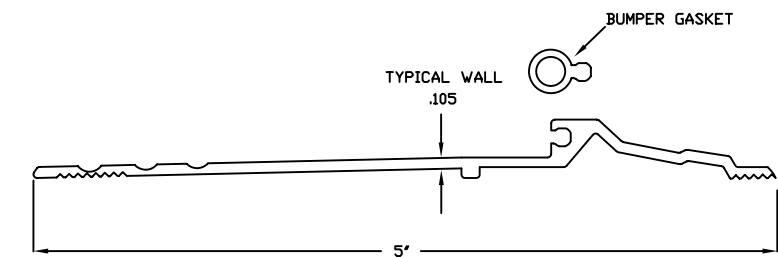

REVISIONS		MATERIAL	CHEM-PRUF DOOR CO. LTD P.O. BOX 4560, 5224 FM 802 BROWNSVILLE, TX 78521		SCALE NTS	
		EST. AREA	FIBERGLASS FIRE SINGLE OS DOOR FBC INSTALLATION DRAWINGS HARDWARE DETAILS		DWG NO. 100255D	
		EST. WT.			SHEET NO. 7 OF 7	
		EST. PERIM.			EXTRUSION NO.	REV.
		DRAWN BY JMR			DATE 04/20/11	