

FIBERGLASS 4080 FLUSH FIRE INSWING DOOR FBC PRODUCT APPROVAL DRAWINGS

ANCHORAGE SCHEDULE AND DESCRIPTION				
SUBSTRATE	ANCHOR	EMBEDMENT	ANCHOR SPACING	EDGE DISTANCE
WOOD FRAMING	#14 WOOD SCREW	MINIMUM 1-1/2"	MINIMUM 1-1/2"	MINIMUM 2"
CONCRETE	1/4" TAPPER	MINIMUM 1-3/8"	MINIMUM 2-1/2"	MINIMUM 2-1/2"
CONCRETE	1/4" TAPCON	MINIMUM 1-1/4"	MINIMUM 2-1/2"	MINIMUM 2-1/2"
CONCRETE	1/4" CRETE-FLEX	MINIMUM 1-1/4"	MINIMUM 2-1/2"	MINIMUM 2-1/2"
STEEL STUD	#14-20 GR 2 SMS	MINIMUM 1"	MINIMUM 1-1/2"	MINIMUM 2"

DESIGN PRESSURE RATING	IMPACT RATING
+/-40.0	LARGE AND SMALL MISSILE

DRAWINGS TABLE OF CONTENTS

- SHEET 1: INDEX TO DRAWINGS AND NOTES
- SHEET 2: ELEVATIONS
- SHEET 3: ANCHORAGE DETAILS
- SHEET 4: BOM AND HARDWARE OPTIONS
- SHEET 5: HARDWARE OPTIONS

OVERALL SIZE:
52-1/4" x 97-7/8"
(SINGLE DOOR)

PANEL DIMENSIONS:
48" X 96"

NOTES:

1. THE PRODUCT ILLUSTRATED SATISFIES THE REQUIREMENTS FOR THE FLORIDA BUILDING CODE INCLUDING HVHZ.
2. THE INSTALLATION DRAWINGS DEPICTED WITHIN ARE NECESSARY TO MEET THE STRUCTURAL LOAD REQUIREMENTS. PLEASE SEE THE MANUFACTURER'S INSTALLATION INSTRUCTIONS FOR SEALING, FLASHING AND DRAINAGE REQUIREMENTS.
3. THIS PRODUCT IS IMPACT RESISTANT AND THEREFORE AN APPROVED IMPACT PROTECTION SYSTEM IS NOT REQUIRED FOR THIS PRODUCT IF IT IS INSTALLED IN A WIND BORNE DEBRIS AREA.
4. THIS PRODUCT IS NOT APPROVED FOR USE WHERE WATER INFILTRATION RESISTANCE IS REQUIRED BY THE DOOR, UNLESS UNITS ARE INSTALLED IN A NON-HABITABLE AREA WHERE THE UNIT AND THE AREA ARE DESIGNED TO ACCEPT WATER INFILTRATION. UNITS SHALL BE INSTALLED ONLY AT LOCATIONS PROTECTED BY A CANOPY OR OVERHANG SUCH THAT THE ANGLE BETWEEN THE EDGE OF THE CANOPY OR OVERHANG TO THE SILL IS LESS THAN 45 DEGREES.
5. MAXIMUM ALLOWABLE SHIM STACK TO BE 1/4". SHIM ALL SPACES IN EXCESS OF 1/16".
6. WOOD FRAMING INSTALLATIONS ARE ASSUMED TO BE 2X S-P-F (G=0.42) OR DENSER. WOOD FRAMING SHALL BE GREATER THAN THE WINDOW FRAME WIDTH. TAPERED OR PARTIAL WOOD BUCKS ARE NOT ALLOWED. FOR INSTALLATION INTO WOOD FRAMING USE #14 WOOD SCREWS WITH SUFFICIENT LENGTH TO OBTAIN A 1-1/2" PENETRATION. ANCHORS SHALL BE LOCATED AS DESCRIBED IN THE ELEVATION DETAIL.
7. CONCRETE INSTALLATIONS ASSUME A MINIMUM COMPRESSIVE STRENGTH FOR CONCRETE OF 3,200 PSI . USE A 1/4" ITW TAPCON, A 1/4" POWERS TAPPER OR A 1/4" CRETE-FLEX SS4 ANCHOR FOR INSTALLATION INTO CONCRETE. THE ANCHOR SHALL HAVE A MINIMUM OF 1-1/4" EMBEDMENT. PLEASE SEE TABLE FOR EMBEDMENT REQUIREMENTS FOR EACH ANCHOR. ANCHORS SHALL BE LOCATED AS DESCRIBED IN THE ELEVATION DETAIL.
8. METAL FRAMING INSTALLATION SHALL BE A MINIMUM OF 16 GAUGE 33 KSI STRENGTH METAL. USE A #14 GRADE 2 SMS WITH SUFFICIENT LENGTH TO ACHIEVE FULL PENETRATION OF THE METAL FRAMING AND EMBED 1/4" BEYOND THE DRILL POINT.
9. CORROSIVE RESISTANT FASTENERS SHALL BE USED.
10. WINDOW FRAME MATERIAL SHALL BE FRP MATERIAL.
11. ALLOWABLE STRESS INCREASE OF 1/3 WAS NOT USED IN THE DESIGN OF THE PRODUCT SHOWN, WIND LOAD DURATION FACTOR Cd=1.6 WAS USED FOR WOOD ANCHOR CALCULATIONS.
12. UNITS SHALL BE INSTALLED AS DESCRIBED IN THESE INSTALLATION INSTRUCTIONS AND ALSO IN CONFORMANCE TO THE MANUFACTURER'S PUBLISHED INSTALLATION INSTRUCTIONS.

REVISIONS	MATERIAL	CHEM-PRUF DOOR CO. LTD P.O. BOX 4560, 5224 FM 802 BROWNSVILLE, TX 78521	SCALE NTS
	EST. AREA		DWG NO. 100480D
	EST. WT.		SHEET NO. 1 OF 7
	EST. PERIM.	FIBERGLASS 4080 FLUSH FIRE IS DOOR FBC INSTALLATION DRAWINGS GENERAL NOTES	EXTRUSION NO. REV.
	DRAWN BY JMR	DATE 04/02/12	

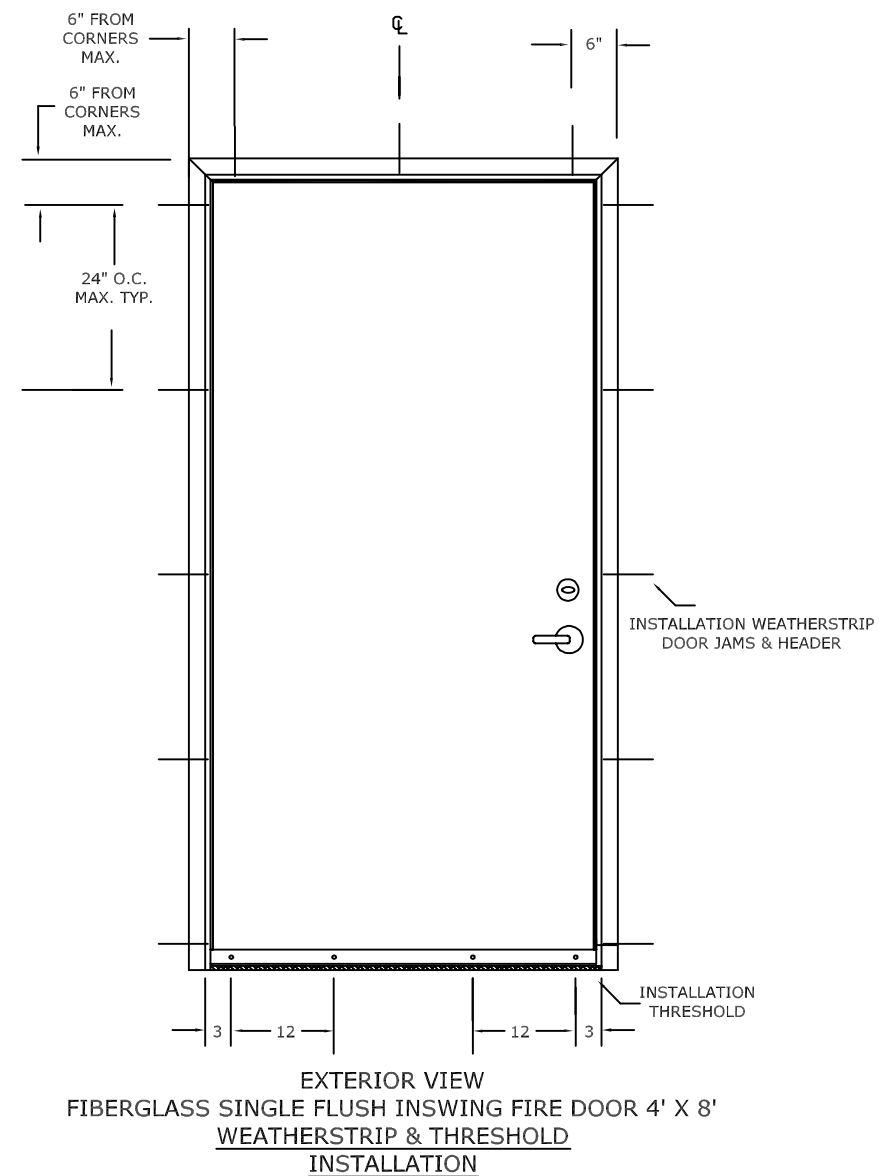
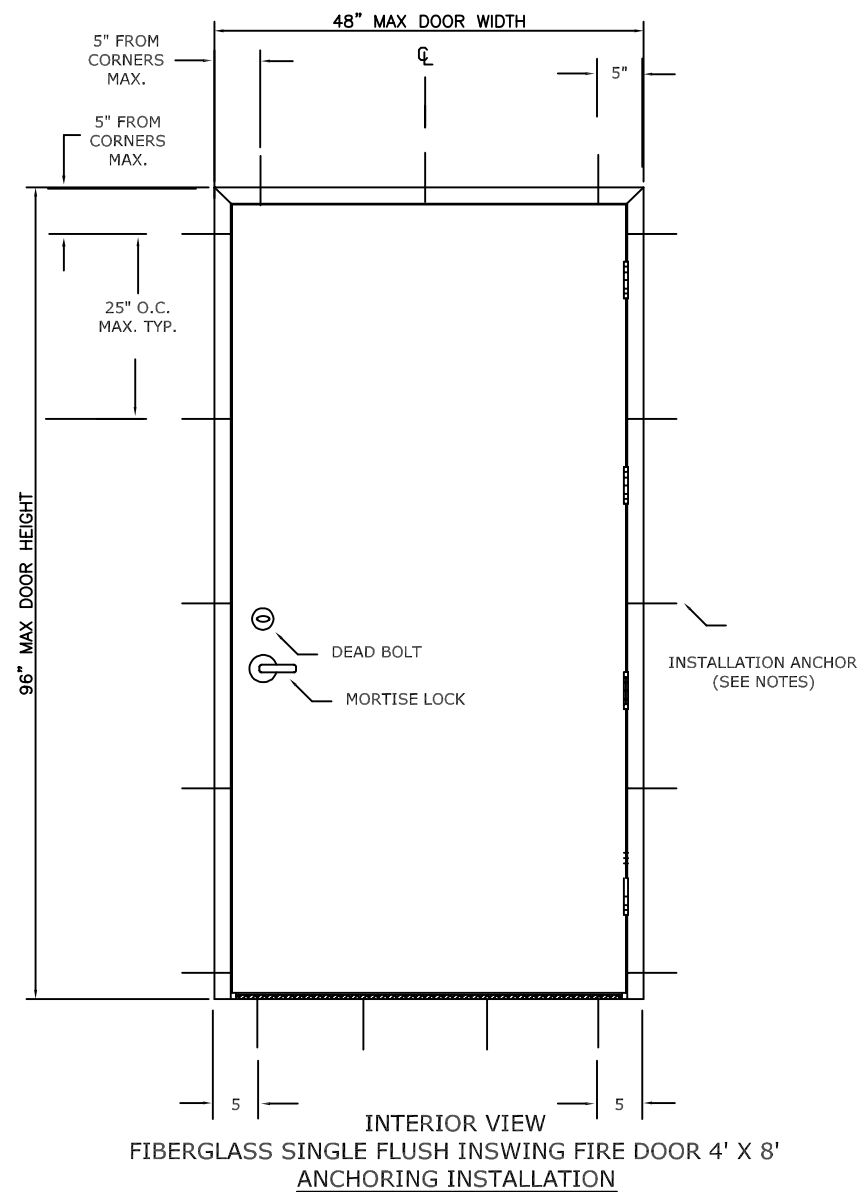

ANCHORING NOTES:

1. SET FRAME WITH SUPPLIED ANCHORS. FIELD DRILL 1/4" HOLE INTO FRAME AND COUNTER SINK ALL HOLES 82 DEGREES, SO ANCHOR HEAD WILL BE FLUSH WITH FRAME. PLACE ANCHORS SO THEY PENETRATE SOLID STRUCTURE.

ELEVATION AND ANCHOR LOCATIONS

REVISIONS		MATERIAL	CHEM-PRUF DOOR CO. LTD P.O. BOX 4560, 5224 FM 802 BROWNSVILLE, TX 78521		SCALE NTS	
		EST. AREA	FIBERGLASS 4080 FLUSH FIRE IS DOOR FBC INSTALLATION DRAWINGS ELEVATION AND ANCHOR NOTES		DWG NO. 100480D	
		EST. WT.			SHEET NO. 2 OF 7	
		EST. PERIM.			EXTRUSION NO.	REV.
		DRAWN BY JMR			DATE 04/02/12	

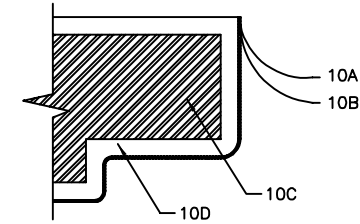
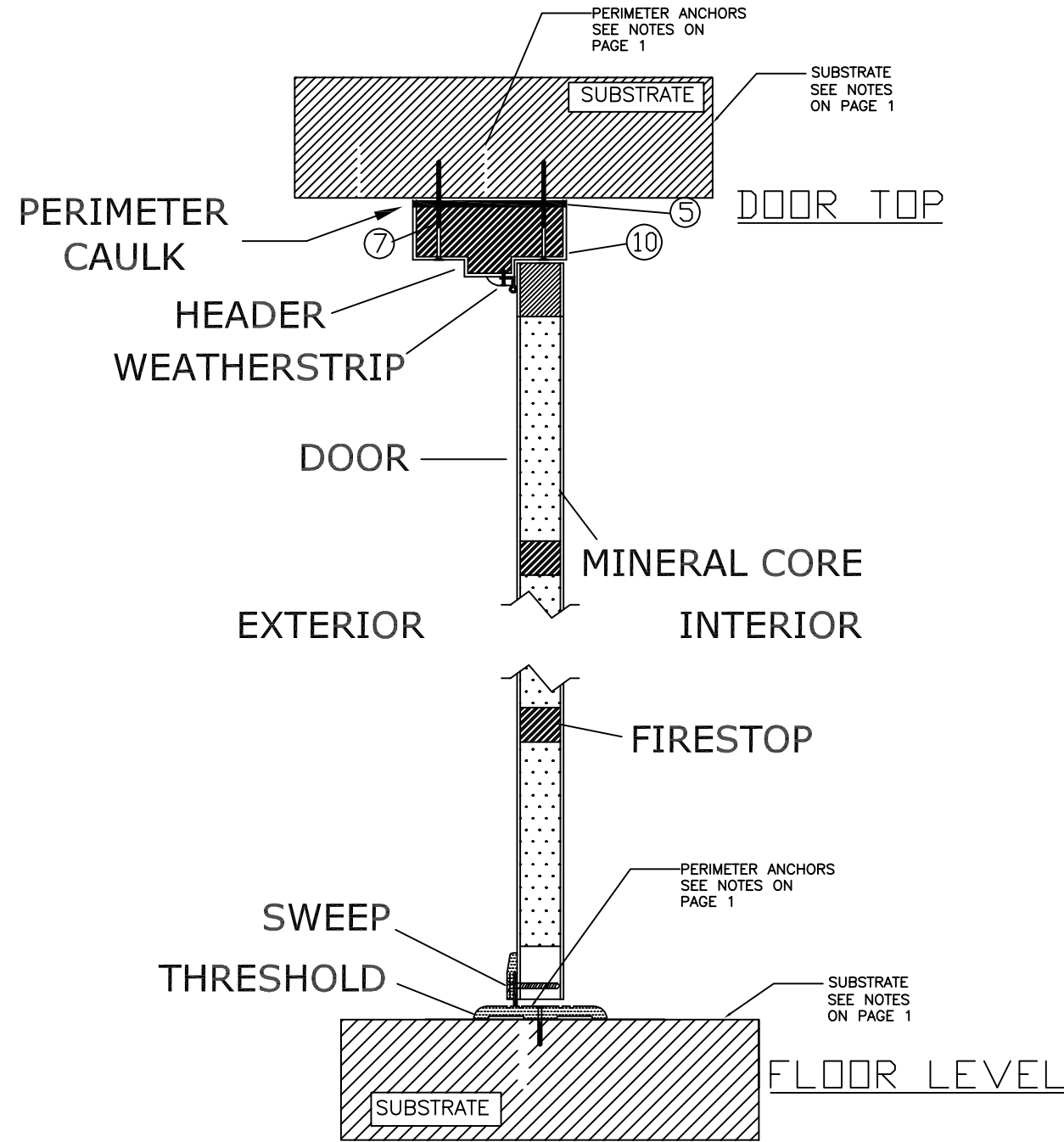

BILL OF MATERIAL	
#	DESCRIPTION
10A	FIRE RETARDANT GELCOAT
10B	COMBIFLOW MAT
10C	FIRE STOP CORE
10D	FIRE RETARDANT RESIN

FRAME CONSTRUCTION

- 10A). 1 LAYER COMBIFLO MAT.
- 10B). GELCOAT 25 MILLS FIRE RETARDANT.
- 10C). CORE – FIRE STOP
- 10D). RESIN – ASHLAND 6307 RT RESIN WITH 40% ATH FILLER.

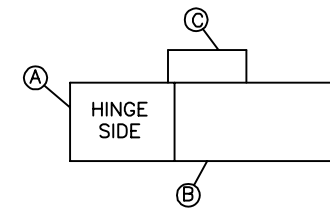
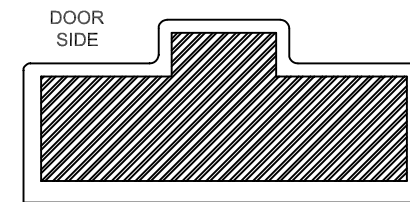

- CORE DIMENSIONS
- A) 2" x 1 1/2" FIRESTOP.
 - B) 3 1/4" x 1 1/2" FIRESTOP.
 - C) 1 1/2" x 5/8" FIRESTOP.

HEADER

② VERTICAL CROSS-SECTION

REVISIONS		MATERIAL	CHEM-PRUF DOOR CO. LTD P.O. BOX 4560, 5224 FM 802 BROWNSVILLE, TX 78521		SCALE NTS	
		EST. AREA	FIBERGLASS 4080 FLUSH FIRE IS DOOR FBC INSTALLATION DRAWINGS INSTALLATION DETAILS		DWG NO. 100480D	
		EST. WT.			SHEET NO. 3 OF 7	
		EST. PERIM.			EXTRUSION NO.	REV.
		DRAWN BY JMR			DATE 04/02/12	

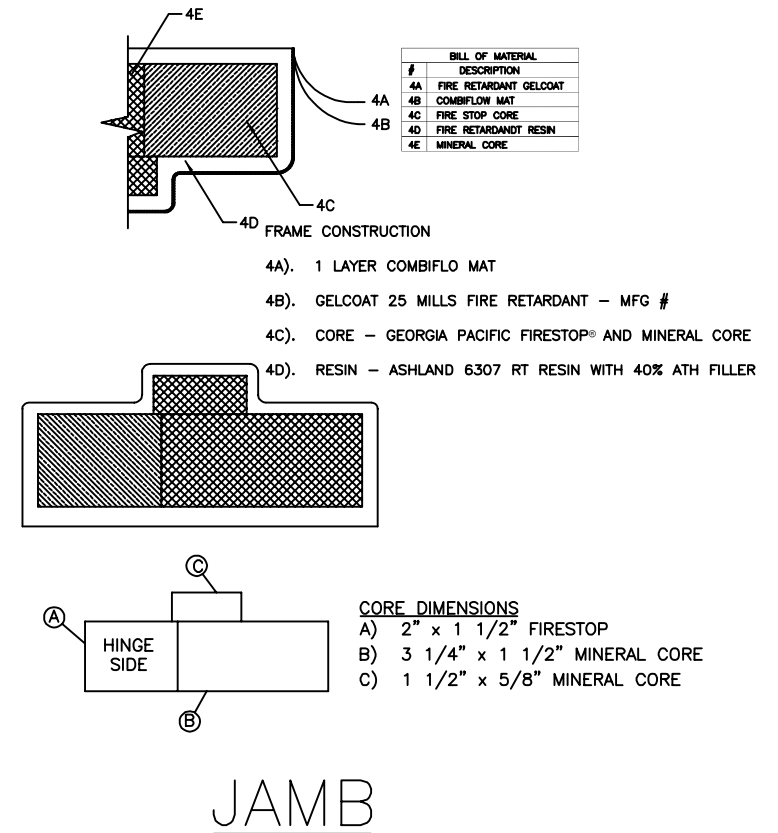
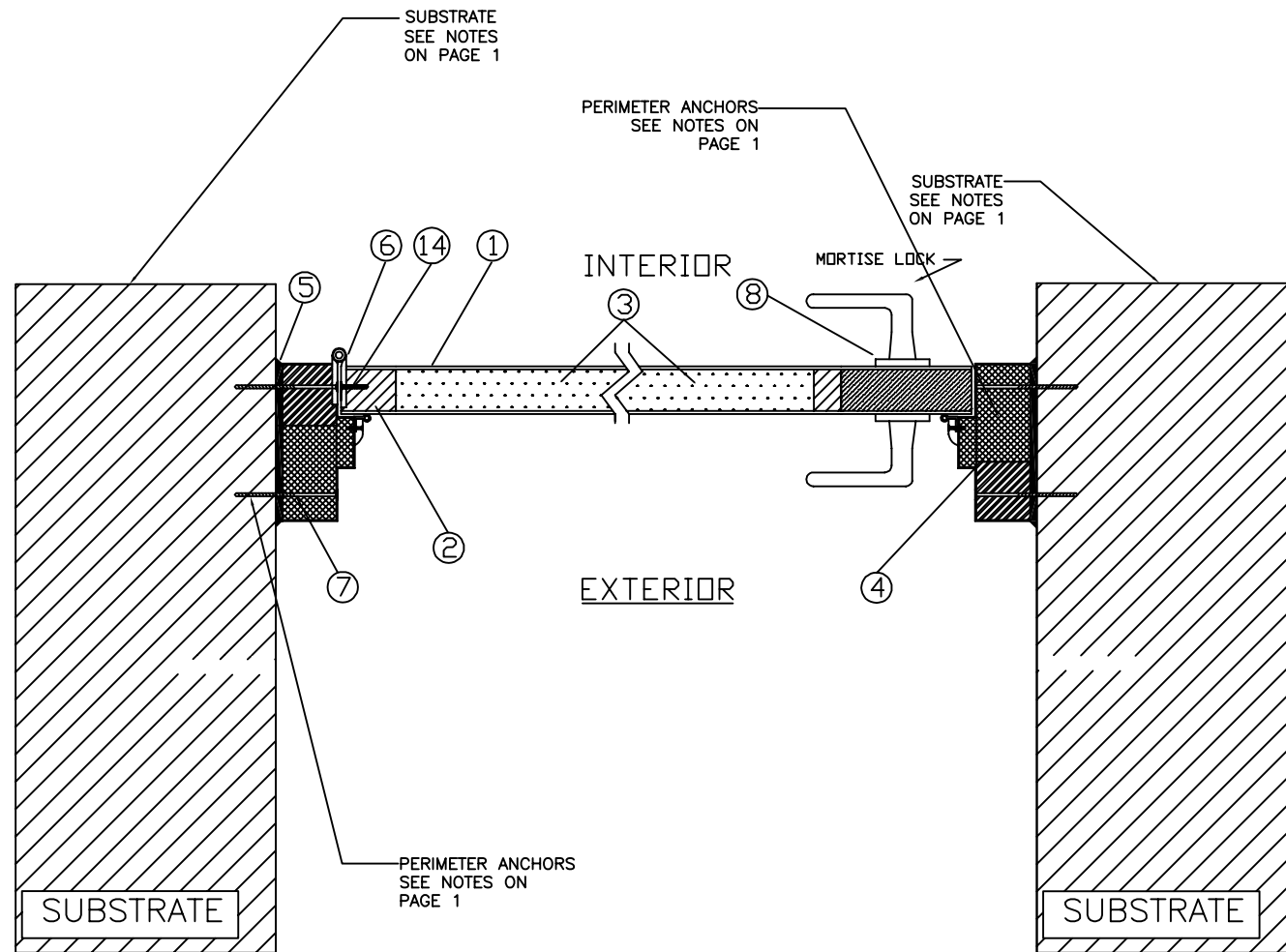

REVISIONS		MATERIAL	CHEM-PRUF DOOR CO. LTD P.O. BOX 4560, 5224 FM 802 BROWNSVILLE, TX 78521		SCALE NTS	
		EST. AREA	FIBERGLASS 4080 FLUSH FIRE IS DOOR FBC INSTALLATION DRAWINGS INSTALLATION DETAILS		DWG NO. 100480D	
		EST. WT.			SHEET NO. 4 OF 7	
		EST. PERIM.			EXTRUSION NO.	REV.
		DRAWN BY JMR			DATE 04/02/12	

FRAME CORNER ASSEMBLY

HEADER AND JAMBS ARE ATTACHED USING #10 x 2 1/2" FLAT HEAD PHILIPS SCREWS

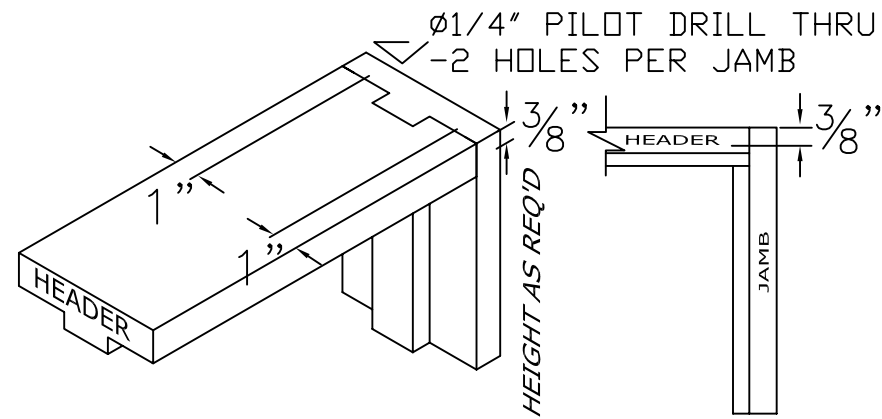

FRAME HINGE RABBET

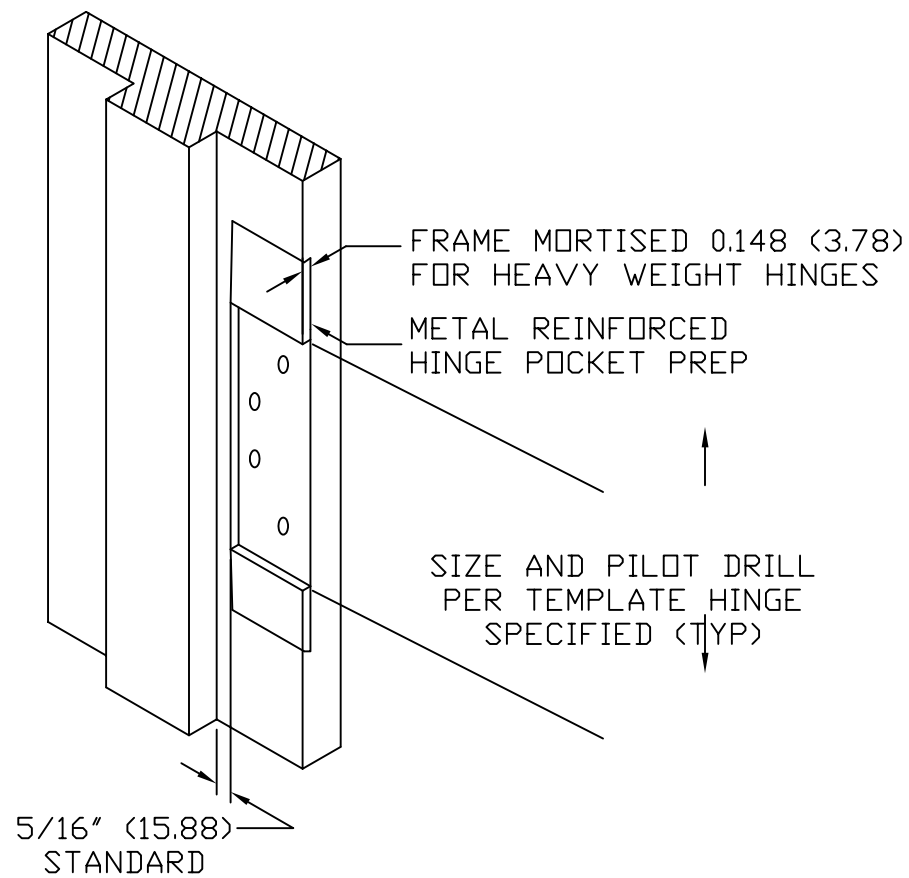

DOOR HINGE RABBET

DOOR MORTISED 0.148 (3.78) FOR HEAVY WEIGHT HINGES

1/4" STANDARD

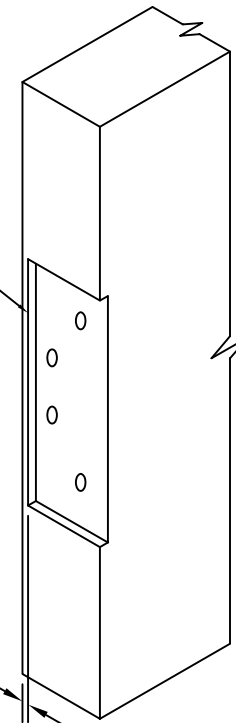

BILL OF MATERIAL

ITEM	DESCRIPTION	MATERIAL
1	FIRE RATED PLATE	
2	FIRE STOP	
3	MINERAL CORE	
4	2" FRAME JAMB 5-3/4" THICK	
4A	FIRE RETARDANT GELCOAT	
4B	COMBIFLOW MAT	
4C	FIRE STOP CORE	
4D	FIRE RETARDANT RESIN	
4E	MINERAL CORE	
5	CAULK MATERIAL (RTD Seal -Silicone-)	
6	HINGE (MCKINNEY 2714 SERIES)	
7	3 -3/4" CRETE-FLEX	
8	MORTISE LOCK (SARGET 8200 SERIES)	
9	CMU WALL CONSTRUCTION	
10	2" HEADER 5-3/4" THICK	
10A	FIRE RETARDANT GELCOAT	
10B	COMBIFLOW MAT	
10C	FIRE STOP CORE	
10D	FIRE RETARDANT RESIN	
11	CHEM-PRUF FIRE RATED WEATHERSTRIP	
11A	STANDARD GELCOAT	
11B	PULTRUDED WEATHERSTRIP	
12	CHEM-PRUF FIRE RATED THRESHOLD	
12A	STANDARD GELCOAT	
12B	FRP THRESHOLD	
13	CHEM-PRUF FIRE RATED SWEEP	
13A	STANDARD GELCOAT	
13B	FRP SWEEP	
14	3 -3/4" CRETE-FLEX	

REVISIONS

NO.	DESCRIPTION	MATERIAL	DATE
		EST. AREA	
		EST. WT.	
		EST. PERIM.	
		DRAWN BY	DATE
		JMR	04/02/12

CHEM-PRUF DOOR CO. LTD
P.O. BOX 4560, 5224 FM 802
BROWNSVILLE, TX 78521

FIBERGLASS 4080 FLUSH FIRE IS DOOR
FBC INSTALLATION DRAWINGS
B.O.M. AND HARDWARE NOTES

SCALE	
NTS	
DWG NO. 100480D	
SHEET NO. 5 OF 7	
EXTRUSION NO.	REV.

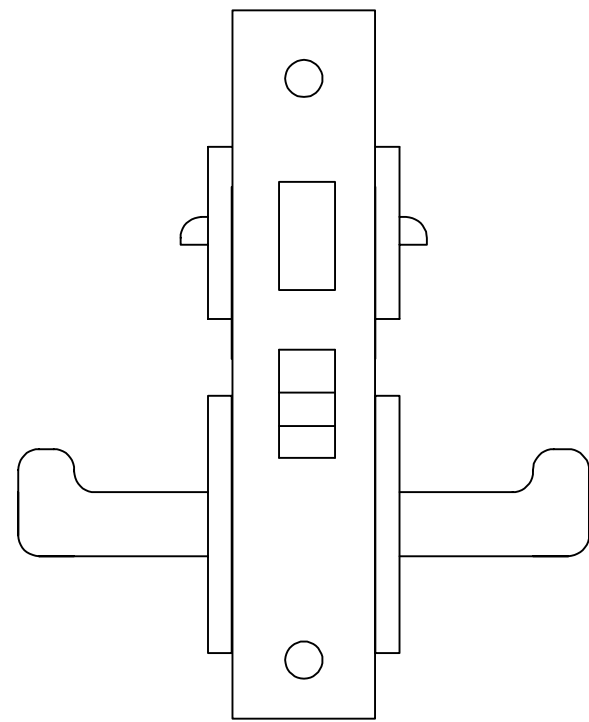

8 MORTISE LOCK W/ DEAD BOLT

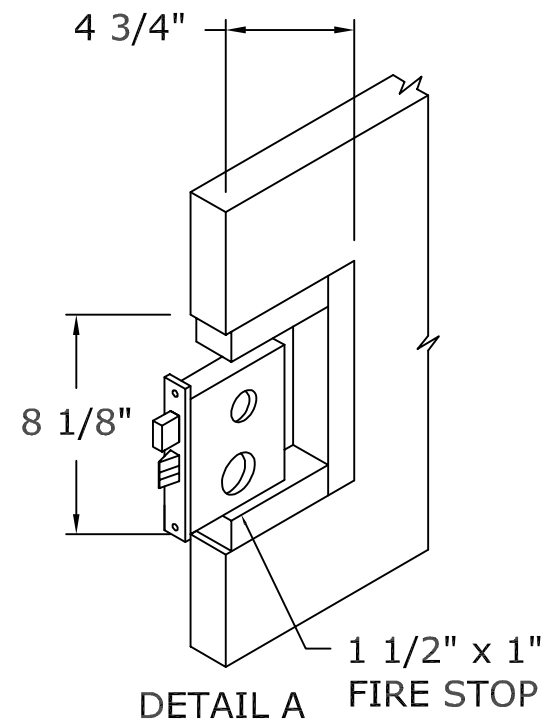

MORTISE POCKET

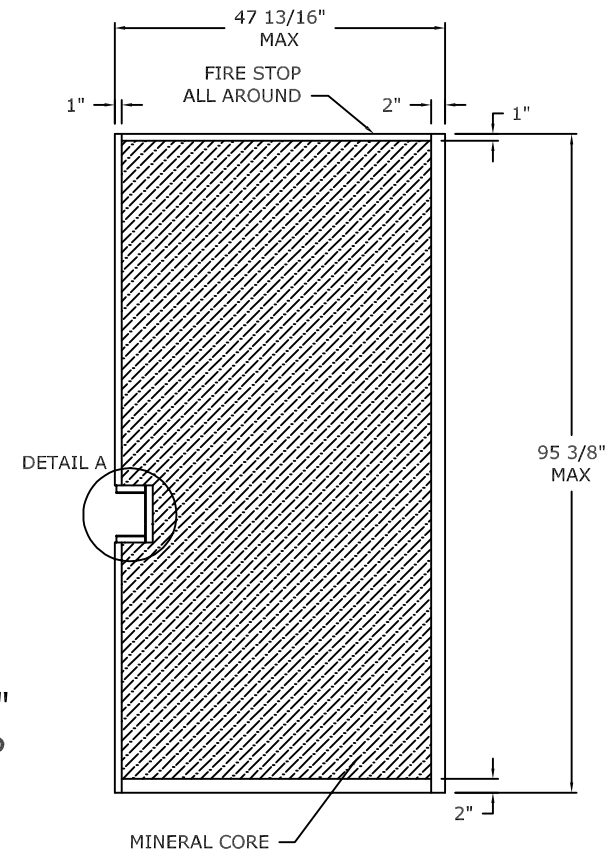
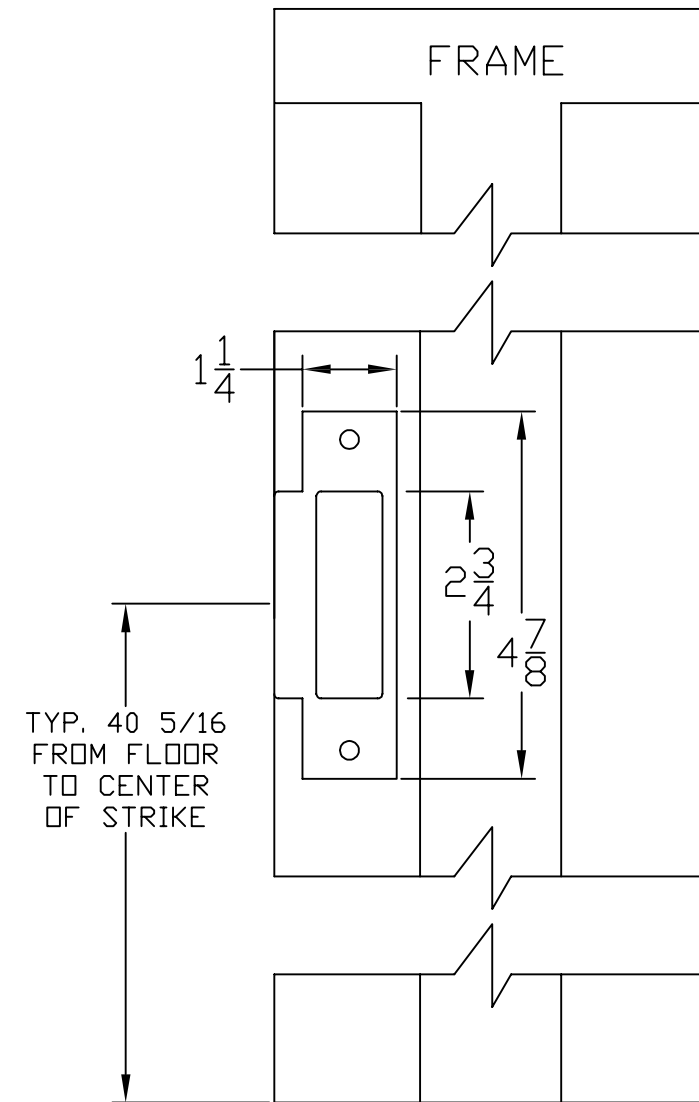

FIGURE 1



7 STRIKE DETAIL

4/4 MORTISE LOCK DETAIL

REVISIONS		MATERIAL	CHEM-PRUF DOOR CO. LTD P.O. BOX 4560, 5224 FM 802 BROWNSVILLE, TX 78521		SCALE NTS	
		EST. AREA	FIBERGLASS 4080 FLUSH FIRE IS DOOR FBC INSTALLATION DRAWINGS HARDWARE NOTES		DWG NO. 100480D	
		EST. WT.			SHEET NO. 6 OF 7	
		EST. PERIM.			EXTRUSION NO.	REV.
		DRAWN BY JMR			DATE 04/02/12	

FRP WEATHERSTRIP

FEATURES AND CERTIFICATIONS

- . PULTRUDED WEATHERSTRIP.
- . CORROSION RESISTANT.
- . POST PAINTED TO MATCH DOOR COLOR.
- . BULB SEAL
- . SUPPLIED WITH STAINLESS STEEL FASTENERS.
- # 6 x 1 1/4 (12) PHP

#	DESCRIPTION
11A	STANDARD GELCOAT
11B	PULTRUDED WEATHERSTRIP

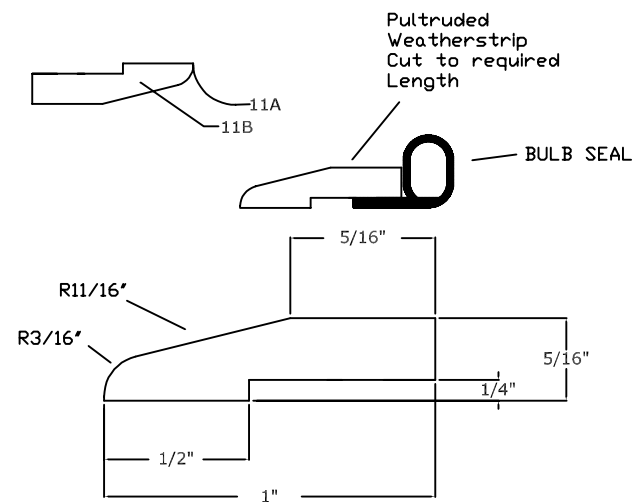

FRP THRESHOLD

FEATURES AND CERTIFICATIONS

- . MOLDED FIBERGLASS GROOVED THRESHOLD MANUFACTURED BY CHEM-PRUF.
- . CORROSION RESISTANT.
- . COLOR MOLDED IN (SPECIFY PREFERRED COLOR).
- . SADDLE TYPE, 5" WIDE BY 1/2" HIGH.
- . SUPPLIED WITH STAINLESS STEEL FASTENERS.
- #14 1 1/2 (4) OVAL HEAD PHP

#	DESCRIPTION
12A	STANDARD GELCOAT
12B	FRP THRESHOLD

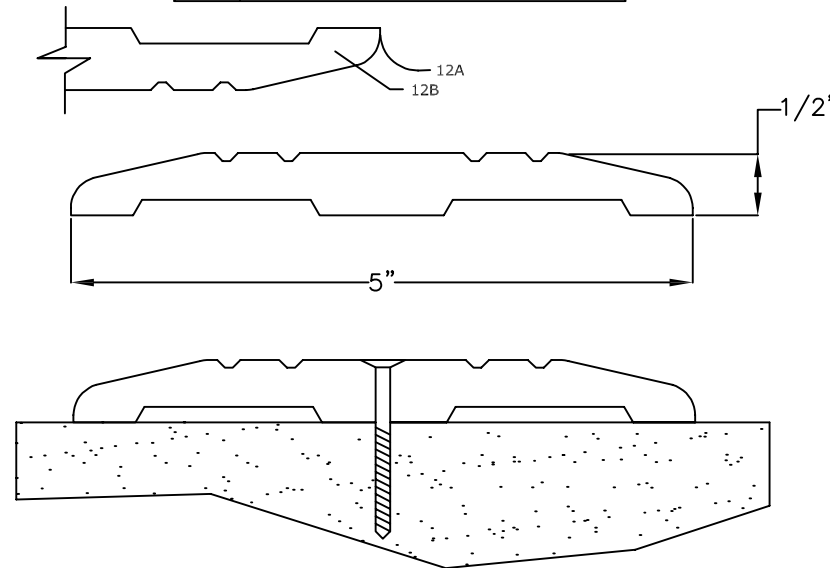

FRP DOOR SWEEP

FEATURES AND CERTIFICATIONS

- . MOLDED FIBERGLASS DOOR SWEEP
- . MANUFACTURED BY CHEM-PRUF.
- . CORROSION RESISTANT.
- . COLOR MOLDED IN TO MATCH DOOR.
- . NEOPRENE WIPER
- . SUPPLIED WITH STAINLESS STEEL FASTENERS.
- #8 1 1/4 (4) PHP

#	DESCRIPTION
13A	STANDARD GELCOAT
13B	FRP SWEEP

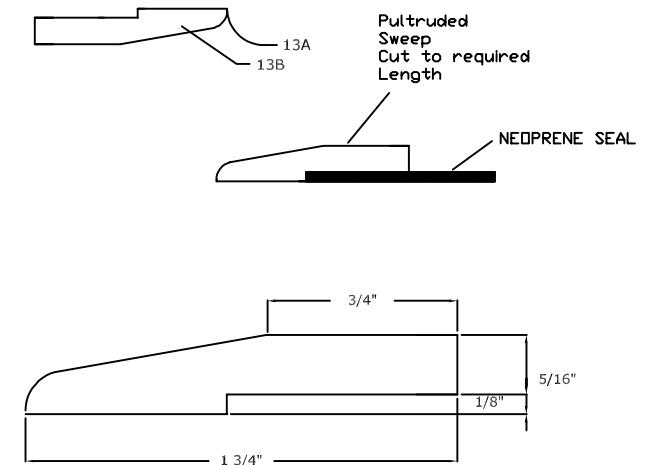

REVISIONS		MATERIAL	CHEM-PRUF DOOR CO. LTD P.O. BOX 4560, 5224 FM 802 BROWNSVILLE, TX 78521		SCALE NTS
		EST. AREA			DWG NO. 100480D
		EST. WT.			SHEET NO. 7 OF 7
		EST. PERIM.	FIBERGLASS 4080 FLUSH FIRE IS DOOR FBC INSTALLATION DRAWINGS HARDWARE NOTES		EXTRUSION NO.
		DRAWN BY JMR	DATE 04/02/12		REV.