

CLIENT:

701 4th Street

Interior Renovations

701 4th Street
Miami Beach, FL 33139
Folio: 02-4203-009-3040



333 SE 2ND AVENUE, SUITE 2066
MIAMI, FL 33131
Tel: 786.218.5335
License #AA 26002467
WWW.CASTELLANOSDESIGN.COM

No.	DATE	ISSUED /REVISED
1	02-16-17	RFC
2	02-03-17	RFC
3	05-22-17	RFC
4	08-13-17	RFC

CONSTRUCTION NOTES

- CONTRACTOR SHALL VERIFY BATHROOM RECEPTACLES ARE GFCI GROUND FAULT PROTECTED C/B AND PROVIDE IF REQUIRED.
- CONTRACTOR SHALL VERIFY KITCHEN SMALL APPL. ARE GFCI GROUND FAULT PROTECTED C/B AND PROVIDE IF REQUIRED.
- ADD NEW OUTLET FOR HOTEL USE AS PER NEC. 210.60(B) LISTED ON SECTION 210.52(A). HOWEVER THE MAXIMUM DISTANCE TO RECEPTACLE CAN BE INCREASED BECAUSE OF DURATION OF CONVENIENCE USE. NO OUTLET TO BE PLACED BEHIND BEDS.
- SUITE ROOM SMOKE ALARM 120V. INTERCONNECTED, TYPICAL ALL SUITE.
- RELOCATED EXISTING LIGHT SWITCH AND RECONNECT AT EXISTING LIGHTS SAME CIRCUIT.
- CONTRACTOR SHALL VERIFY NO OUTLET TO BE PLACED BEHIND BEDS.

SCOPE OF WORK:

INTERIOR REMODELING OF EXISTING BUILDING. CHANGE OF

EM-DENOTE LIGHT FIXTURE WITH EMERGENCY BATTERY BACK

UP 90 MINUTES MINIMUM BATTERY.

NOTE: EM TO BE CONNECTED AHEAD OF LIGHTING SWITCHES

TO LOCAL AREA GENERAL LIGHT CIRCUIT.

NOTES: ROSE LIGHTS, RECEPTACLES AND DATA OUTLETS

EXISTING TO REMAIN. CONTRACTOR MUST MAINTAIN

CONTINUITY OF ELECTRICAL AND DATA SYSTEM AFTER ALL

AS REQUIRED AFTER DEMOLITION.

E-EXISTING

RL-RELOCATED

RP-REPLACE

N-NEW

Symbol	Label	Description	UF	Lin. Mths	Total Mths
+	C	LUMINAIRE ABY17-40W-4000K-40L1-C9-EMR310	0.900	42.2	42.2
	W	HE WILLIAMS WWPV-160-740-13-SDBL-EM_4W	0.900	68.8	619.2
	W1	HE WILLIAMS WWPV-130-740-13-SDBL-EM_4W	0.900	36.1	288.8
	W2	HE WILLIAMS WWPV-160-740-13-SDBL-EM_4W	0.900	69.3	207.9

Luminaire Schedule

Project: 701 4TH STREET - NORMAL - REVZ --- JUN - 9 - 2017

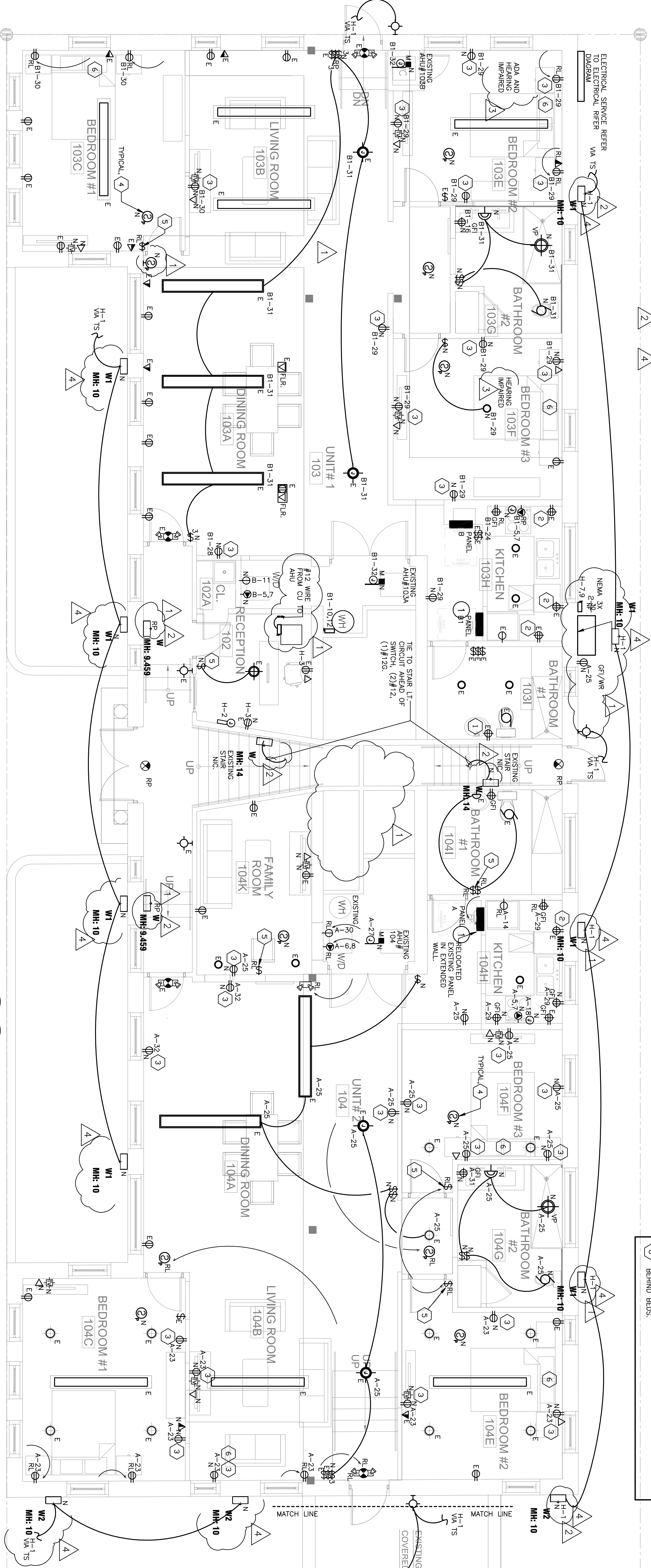

1 ELECTRICAL GROUND FLOOR PLAN

E-1 SCALE: 1/4"=1'-0"

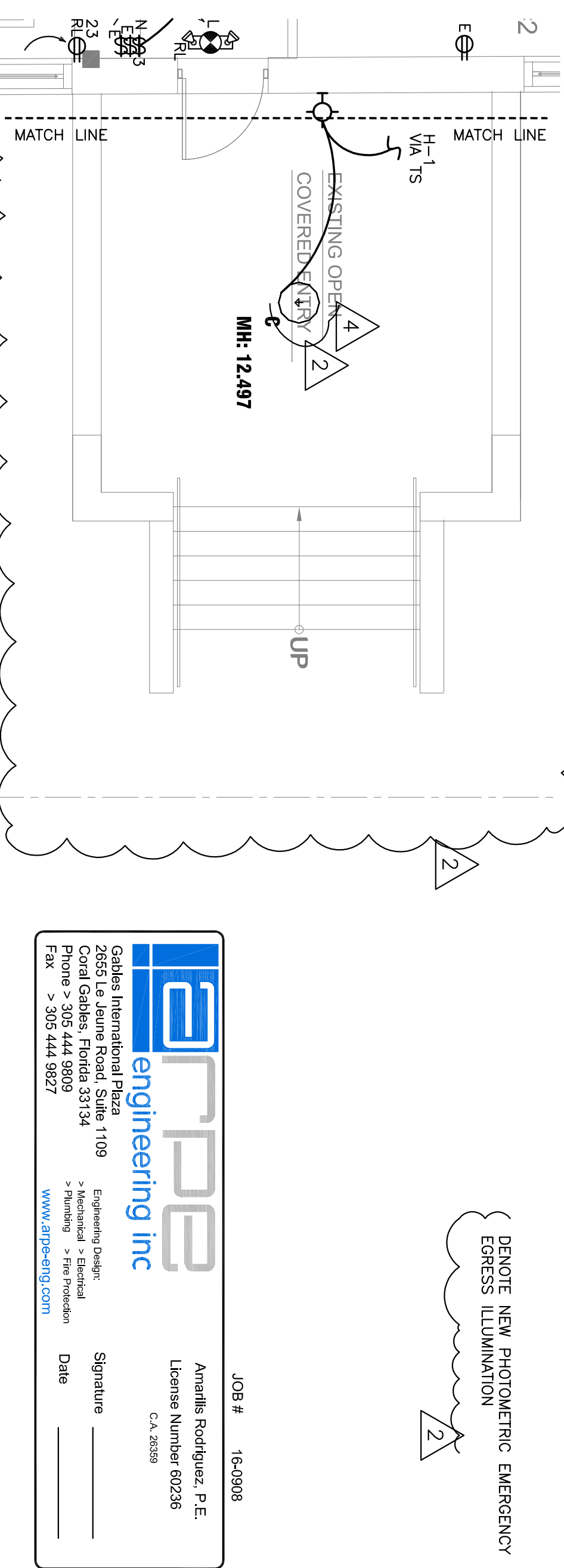
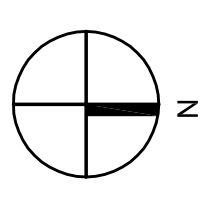

DENOTE NEW PHOTOMETRIC EMERGENCY EGRESS ILLUMINATION

SEAL:

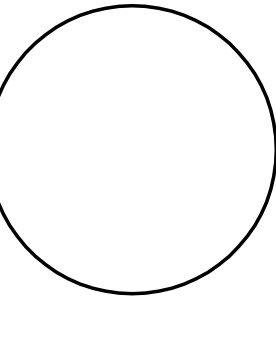

WESLEY ART CASTELLANOS
FLORIDA ARCHITECT LICENSE: RA 96133

PROJECT NO.: 2016-17

ELECTRICAL GROUND FLOOR PLAN

CHECKED BY: A.R. SHEET NO.:
DRAWN BY: A.R.
SCALE: AS SHOWN
E-1
©2016 BY CDS

engineer inc
Gables International Plaza
2055 Le Jeune Road, Suite 1109
Miami Beach, FL 33139
Phone: > 305.444.9809
Fax: > 305.444.9827
www.aip-engineer.com

Amalites Rodriguez, P.E.
License Number 60236
C.A. 26399

JOB # 16-0908
Signature _____
Date _____