

REQUEST FOR WAIVER FROM ACCESSIBILITY REQUIREMENTS
OF CHAPTER 553, PART V, FLORIDA STATUTES

Your application will be reviewed by the Accessibility Advisory Council and its recommendations will be presented to the Florida Building Commission. You will have the opportunity to answer questions and/or make a short presentation, not to exceed 15 minutes, at each meeting. The Commission will consider all information presented and the Council's recommendation before voting on the waiver request.

1. Name and address of project for which the waiver is requested.

Name: LOEWS MIAMI BEACH HOTEL / POOL CABANAS

Address: 1601 COLLINS AVE, MIAMI BEACH, FL 33139

2. Name of Applicant. If other than the owner, please indicate relationship of applicant to owner and written authorization by owner in space provided:

Applicant's Name: LOEWS MIAMI BEACH HOTEL

Applicant's Address: 1601 COLLINS AVE, MIAMI BEACH, FL 33139

Applicant's Telephone: 305-604-5431 FAX: _____

Applicant's E-mail Address: atonarelli@loewshotels.com

Relationship to Owner: SAME

Owner's Name: MB Redevelopment, Inc.

Owner's Address: 667 Madison Ave, New York, NY 10065

Owner's Telephone: 212-521-2996 FAX 212-521-2851

Owner's E-mail Address: jlam@loewshotel.com

Signature of Owner: Vincent J. Jurek

Contact Person: ALEX TONARELLI

Contact Person's Telephone: 305-604-5431 E-mail Address: same as above

Receipt 1

This application is available in alternate formats upon request.

Form No. 2001-01

3. Please check one of the following:

New construction.

Addition to a building or facility.

Alteration to an existing building or facility.

Historical preservation (addition).

Historical preservation (alteration).

4. **Type of facility.** Please describe the building (square footage, number of floors). Define the use of the building (i.e., restaurant, office, retail, recreation, hotel/motel, etc.)

This project is located on the pool deck of an existing hotel. The project is (2) buildings, each with a footprint of about 800 s.f. The lower/ground level has an indoor space including, toilet and shower room. The exterior of the space is dedicated to a private sun deck area. The structure is one story with the roof being used as additional sun deck space.

5. **Project Construction Cost** (Provide cost for new construction, the addition or the alteration):

\$ 1.5 Million

6. **Project Status:** Please check the phase of construction that best describes your project at the time of this application. Describe status.

Under Design Under Construction*

In Plan Review Completed*

* Briefly explain why the request has now been referred to the Commission.

The project was originally held-up in the Miami Beach Building Dept. As there was a request that it needed an elevator/lift to the 2nd Floor Roof Deck. The project needs to be complete by the upcoming season. So it was agreed by city and project owner that it could go into construction while we solved this code issue through your commission. The outcome of your decision will either be to leave the project as originally designed or to submit revised permit drawings showing an elevator/lift to the roof level of the structure. THE city is in agreement with either scenario.

7. **Requirements requested to be waived.** Please reference the applicable section of Florida law. Only Florida-specific accessibility requirements may be waived.

Issue EQUIVALENT FACILITATION

Section 2.2 of the ADA Accessibility Guidelines (ADAAG) which has ^{been} adopted by Florida, recognizes the concept of Equivalent Facilitation. This permits the departure from particular technical requirements where alternative designs will provide substantially equivalent or greater access or use of a facility.

2: FBC 11-4.1.3(5) exception 1 an elevator does not have to be provided if the building has less than three stories or less than 3,000 sq. per floor.

Issue

3: _____

8. **Reason(s) for Waiver Request:** The Florida Building Commission may grant waivers of Florida-specific accessibility requirements upon a determination of unnecessary, unreasonable or extreme hardship. Please describe how this project meets the following hardship criteria. Explain all that would apply for consideration of granting the waiver.

The hardship is caused by a condition or set of conditions affecting the owner which does not affect owners in general.

see attached letter

Substantial financial costs will be incurred by the owner if the waiver is denied.

The owner has made a **diligent investigation** into the costs of compliance with the code, but cannot find an efficient mode of compliance. Provide detailed cost estimates and, where appropriate, photographs. Cost estimates must include bids and quotes.

9. **Provide documented cost estimates for each portion of the waiver request and identify any additional supporting data which may affect the cost estimates.** For example, for vertical accessibility, the lowest documented cost of an elevator, ramp, lift or other method of providing vertical accessibility should be provided, documented by quotations or bids from at least two vendors or contractors.

a. N/A

b. _____

c. _____

10. **Licensed Design Professional:** Where a licensed design professional has designed the project, his or her comments **MUST** be included and certified by signature and affixing of his or her professional seal. The comments must include the reason(s) why the waiver is necessary.

see attached letter dated 7/22/11

Signature

Printed Name

Phone number 954.767.2122

(SEAL)

October 17th, 2011

Re: Loews Miami Beach permit application #B1103686
Request for Waiver from Accessibility Requirements

The project is located at the Loews Hotel in Miami Beach, Florida. The hotel has 790 rooms with convention center services and beach access. The pool area and grounds are existing, and the project under construction and for review by the board is the new Cabana Project. This project consists of 8 cabana units in a two building format. The cabanas themselves are fully accessible to hotel guests with disabilities, including guests with mobility impairments who use a wheelchair or a scooter, and one interior space has been adapted for accessible use (see cabana #2 in the plans provided). The only area under review and question is the roof deck of these two buildings, as both roof decks are used as additional sun deck space. Each building roof deck is approximately 731 square feet for a total of 1,462 square feet of roof deck area.

The roof of the cabanas is simply an open space for guests to use as additional sun deck space, and it is currently designed to be accessed by stairs only. Guests renting a cabana have other options for taking in the sun. The area immediately in front of the cabanas is a private sun deck area for guests renting the cabanas as is the sundeck space on the next lower level. These areas are at ground level and are fully accessible to guests with disabilities. Additionally, there is an elevated sun deck area on the roof of the Loews' spa building, which is immediately adjacent to the proposed cabanas and is accessible by elevator. Thus, in the event that a guest with a mobility impairment would like to use a 'rooftop sun deck', the Loews offers accessible facilities which are in close proximity to the cabanas, actually this location is directly across from the cabanas about 20 feet away from cabana #1.

Section 2.2 of the ADA Accessibility Guidelines (ADAAG) which has been adopted by Florida recognizes the concept of equivalent facilitation. This permits the departure from particular technical requirements where alternative designs will provide substantially equivalent or greater access or use of a facility. I respectfully suggest that the current cabana design plan should be approved as currently designed because the Loews has satisfied the criteria for equivalent facilitation. Property-wide, the Loews offers guests 49,700 square feet of sun deck area space, and 9,800 square feet of that space is assessable 'roof deck' that is one level above grade. In comparison, the proposed cabana roof sun deck area is only 1,462 square feet, or less than 3% of the total sun deck area space at the Loews. As discussed above, guests with disabilities will have full access and use of private sun deck area space at ground level immediately in front of the cabanas, as well as an elevated sun deck area in the building immediately adjacent to the cabanas. Thus, guests with disabilities will have substantially equivalent access and use of the Loews' sun deck area facilities.

In addition to the above, we believe that the code does not require a building of our size (1,462 s.f) to have accesses to this level. FBC 11-4.1.3 (5) Exception 1 states that an elevator does not have to be provided if the building has less than three stories or is less than 3,000 square feet per floor. Our local building department is also in agreement with us under this provision, and their recommendation is part of this application.

In conclusion, the purpose of the Americans With Disabilities Act (ADA) and the Florida accessibility laws and building code is to ensure that individuals with disabilities can use and access facilities at places of public accommodation, such as the Loews. The Loews' proposed cabana structure, in combination with its other guest facilities, satisfies this goal. We would thus appreciate your approval on this matter and thank you for your consideration.

Sincerely,

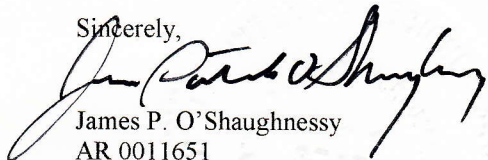

James P. O'Shaughnessy
AR 0011651
Principal, DEMA Architecture and Design

CERTIFICATION OF APPLICANT:

I hereby swear or affirm that the applicable documents in support of this Request for Waiver are attached for review by the Florida Building Commission and that all statements made in this application are to the best of my knowledge true and correct.

Dated this 20th day of AUGUST, 20 11

Vincent F. Vinleau
Signature

VINCENT F. VINLEAU
Printed Name

By signing this application, the applicant represents that the information in it is true, accurate and complete. If the applicant misrepresents or omits any material information, the Commission may revoke any order and will notify the building official of the permitting jurisdiction. Providing false information to the Commission is punishable as a misdemeanor under Section 775.083, Florida Statutes.

REVIEW AND RECOMMENDATION BY LOCAL BUILDING DEPARTMENT.

Please state why the issue is being referred to the Florida Building Commission as well as a recommendation for disposition. The Building Official or his or her designee should review the application and indicate that to the best of his or her knowledge, all information stipulated herein is true and accurate. Further, if this project is complete, explain why it is being referred to the Commission. The Building Official or his or her designee should sign a copy of the plans accompanying this application as certification that such plans are the same as those submitted for building department review. Please reference the applicable section of the Accessibility Code.

a. Florida statutes 553.509 Vertical Accessibility to all levels requirement. / 2007 FBC 11-4.1.6(1)(f)

b. _____

c. _____

Has there been any permitted construction activity on this building during the past three years? If so, what was the cost of construction?

Yes No Cost of Construction: \$1,499,956.82

Comments/Recommendation: During review we request compliance with vertical accessibility to all levels. We recommend that the waiver be issue since the building has less than three stories and the area is less than 3,000 square feet per floor; as per FBC 11-4.1.3(5) exception 1 an elevator do not have to be provided if the building has less than three stories or less than 3,000 sq ft per floor.

Jurisdiction City Of Miami Beach

Building Official or Designee Gladys N. Salas, PE (B.O. Designee)
Signature

Gladys N. Salas, PE
Printed Name

PX0001401
Certification Number

305-673-7610 ext. 6888/ 786-394-4087
Telephone/FAX

Address: 1700 Convention Center Dr. Miami Beach, FL 33139, 2ND Floor.

- 1601 Collins Av, Miami Beach, FL- Loews Hotel



1 LIFE SAFETY FLOOR PLAN
1/8" = 1'-0"

NOTE:
1- COMMON PATH OF EGRESS TRAVEL = 50 FT.
2- OCCUPANCY LOAD PER UNIT 7
2- A SUPERVISED AUTOMATIC SPRINKLER SYSTEM SHALL BE PROVIDED THROUGHOUT THE BUILDING IN ACCORDANCE WITH NFPA 13.

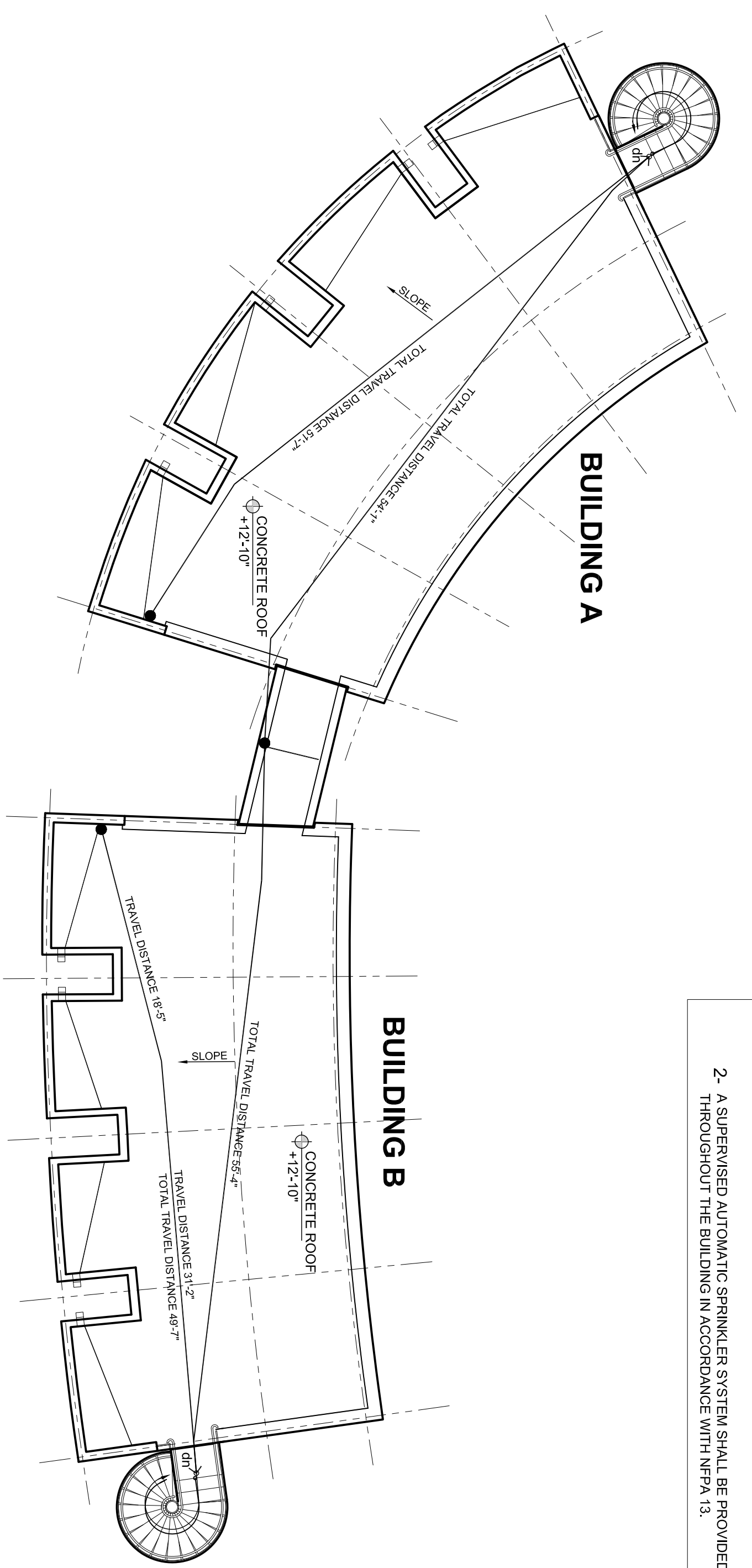

1 LIFE SAFETY FLOOR PLAN
1/8" = 1'-0"

NOTE:
1- ROOF OUTDOOR SPACE MAXIMUM TRAVEL DISTANCE 100 FEET
2- OCCUPANCY LOAD OF ROOF 50

2 LIFE SAFETY ROOF PLAN
1/8" = 1'-0"

RENOVATED SPACE IS CONSIDERED PART OF POOL DECK AREA

CODE ANALYSIS:

GENERAL:
NOTE: ALL MATERIALS AND APPLICATIONS SHALL COMPLY WITH FLORIDA BUILDING CODE HIGH VELOCITY HAZARDOUS ZONE REGULATIONS.

APPLICABLE BUILDING CODES:
2007 FLORIDA BUILDING CODE WITH 2009 REVISIONS.
2007 FLORIDA ACCESSIBILITY CODE
2007 FLORIDA FIRE PREVENTION CODE
2007 FLORIDA FLOODING CODE
2007 FLORIDA MECHANICAL CODE.

1st FL BUILDING A - APPROX.	638 SQ. FT.
1st FL BUILDING B - APPROX.	548 SQ. FT.
TOTAL GROUND LEVEL	1,184 SQ. FT.
ROOF FL BUILDING A - APPROX.	749 SQ. FT.
ROOF FL BUILDING B - APPROX.	713 SQ. FT.
TOTAL ROOF LEVEL	1,462 SQ. FT.

OCCUPANCY: GROUP R 1.
CONSTRUCTION TYPE II - B FULL SPRINKLED.
MAXIMUM AREA OF EXTERIOR WALL OPENING (TABLE 704.8)

SEPARATION FROM EXISTING BUILDING	14'-0"
TOTAL AREA OF EXTERIOR WALL	160 SQ. FT.
MAXIMUM ASPECT OF EXTERIOR WALL OPENINGS ALLOWED AS PER TABLE 704.8	45%
PROTECTED DISTANCE GREATER THAN 10 FEET	637.5 SQ. FT. OR 28.8%
AREA OF EXTERIOR WALL OPENING	
INTERIOR FINISHES CLASS C	

POOL CABANAS
1601 COLLINS AVENUE
MIAMI BEACH, FL 33139

OWNER:
LOEWIS HOTELS
667 MADISON AVENUE
NEW YORK, NY 10021-8087
T: 212-521-2752
F: 212-521-2753

ARCHITECT AND INTERIOR DESIGNER:
DEMA ARCHITECTURE
13011 SE 2ND COURT #1
FORT LAUDERDALE, FL 33301
TEL: (954) 767-2122
CELL: (954) 471-7749
SBUSGAV@DEMA-ARCHITECTURE.COM

LANDSCAPE ARCHITECT:
LANIVASCAPES, INC.
1420 N. W. 11TH AVE., SUITE 444
MIAMI GARDENS, FL 33169
T: 305-279-9914
F: 305-653-8209

STRUCTURAL / MEP ENGINEER:
G. BATISTA & ASSOCIATES
10400 GRIFFIN ROAD #201
COOPER CITY, FL 33328
T: 954-434-2053
F: 954-434-2058

CIVIL ENGINEER:
ALVAREZ ENGINEERS, INC.
10085 NW 41 STREET, SUITE 103
T: 305-640-1345
F: 305-640-1346

REVISIONS

No.	Description	Date
1	BID SET	07-21-2010
2	CITY COMMENTS	07-21-2011

SEAL

DEMA ARCHITECTURE © 2010
JAMES PATRICK O'SHAUGHNESSY
ARCHITECT # 04071051

ALL DRAWINGS AND WRITTEN MATERIAL PREPARED HEREIN OR UNDER THE SUPERVISION OF THE ARCHITECT OR DEMA ARCHITECTURE, AND MAY NOT BE DUPLICATED, USED, OR DISCLOSED WITHOUT THE EXPRESS WRITTEN CONSENT OF DEMA ARCHITECTURE (c) 2010

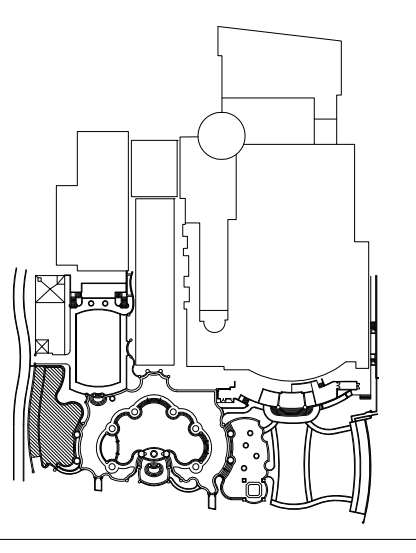

LIFE SAFETY PLAN

Project Number: 0705
Issue Date: 03/01/2010
Drawn By: Sam Vinasco
Checked By: Steve Dajay

LS-1

Scale: 1/8" = 1'-0"



FLOOR PLAN

1/4" = 1'-0"

- 1.0. ALL NEW OR RE-LOCATED ELECTRICAL PLUMBING AND MECHANICAL EQUIPMENT MUST BE REMOVED THEREAS.
- 2.0. ALL NEW MATERIAL, INSTALLED BELOW THE BFE MUST BE FLOOD RESISTANT MATERIAL.
- 3.0. ALL STAIRS TO HAVE NON-SLIP STRIPPING AT STAIR NOSE.
- 4.0. ALL WALKING SURFACES SHALL BE SLIP RESISTANT UNDER CONCRETEABLE CONDITIONS.
- 5.0. THERE IS NO ELECTRICAL OR MECHANICAL EQUIPMENT UNDER ALL OUTDOOR NOTIFICATIONS COME FROM THE EXISTING HOTEL BUILDING.
- 6.0. NEW LANDSCAPED LIGHTING SHALL BE CONNECTED TO EXISTING LANDSCAPE EMERGENCY LIGHTING SYSTEM.

FLOOR PLAN

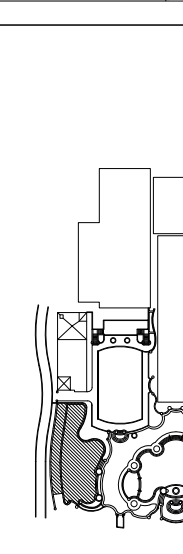

Project Number: 0705
 Issue Date: 03/01/2010
 Drawn By: Sam Viasco
 Checked By: Steve Dalry

A3

Scale: 1/4" = 1'-0"

REVISIONS

No.	Description	Date
1	BID SET	07/21/2010
2	CITY COMMENTS	07/21/2011
3	CITY COMMENTS	08/08/2011

OWNER:
LOUIS HOTELS
 667 MADISON AVENUE
 NEW YORK, NY 10021-8087
 T: 212-521-2122
 F: 212-521-2123

ARCHITECT AND INTERIOR DESIGNER:
ENVIROSCAPES INC.
 1301 SE 2nd COURT #1
 FORT LAUDERDALE, FL 33301
 TEL: (954) 471-7122
 SBURG@DEMA-ARCHITECTURE.COM

LANDSCAPE ARCHITECT:
ENVIROSCAPES INC.
 444
 MIAMI GARDENS, FL 33169
 T: 305-579-9914
 F: 305-553-8209

STRUCTURAL / MEP ENGINEER:
G. BAIKISTA & ASSOCIATES
 10400 GREEN ROAD #201
 COOPER CITY, FL 33328
 T: 954-434-2053
 F: 954-434-2058

CIVIL ENGINEER:
ALVAREZ ENGINEERS, INC.
 2008 NW 41 STREET, SUITE 103
 MIAMI, FL 33145
 T: 305-640-1345
 F: 305-640-1346

DEMA ARCHITECTURE © 2010
 JAMES PATRICK O'SHAUGHNESSY
 ARCHITECT # A610181

ALL DRAWINGS AND WRITTEN MATERIAL ARE THE PROPERTY OF DEMA ARCHITECTURE. NO PART OF THIS DOCUMENTATION MAY BE REPRODUCED OR TRANSMITTED IN ANY FORM OR BY ANY MEANS, ELECTRONIC OR MECHANICAL, WITHOUT THE EXPRESS WRITTEN CONSENT OF DEMA ARCHITECTURE (c) 2010

CABANA SITE
(project under construction)

EXISTING ROOF TOP SUN DECK



LOEWS HOTEL POOL DECK

POOL CABANAS
140 COLLETT AVENUE
MAYTOWN, NY 13154

OWNER:
LUGER HOTELS
100 WEST 17TH STREET
NEW YORK, NY 10011-4607
TEL: 212-260-2500
F: 212-260-2500

ARCHITECT AND INTERIOR DESIGNER:
LUGER HOTELS
100 WEST 17TH STREET, 11 FL
NEW YORK, NY 10011-4607
TEL: 212-260-2500
F: 212-260-2500

LANDSCAPE ARCHITECT:
LUGER HOTELS
100 WEST 17TH STREET, 11 FL
NEW YORK, NY 10011-4607
TEL: 212-260-2500
F: 212-260-2500

MECHANICAL ENGINEER:
LUGER HOTELS
100 WEST 17TH STREET, 11 FL
NEW YORK, NY 10011-4607
TEL: 212-260-2500
F: 212-260-2500

ELECTRICAL ENGINEER:
LUGER HOTELS
100 WEST 17TH STREET, 11 FL
NEW YORK, NY 10011-4607
TEL: 212-260-2500
F: 212-260-2500

CIVIL ENGINEER:
LUGER HOTELS
100 WEST 17TH STREET, 11 FL
NEW YORK, NY 10011-4607
TEL: 212-260-2500
F: 212-260-2500

DATE: 08/20/2010
SCALE: AS SHOWN

PROJECT NUMBER: 030102010
DATE: 08/20/2010
SCALE: 1" = 80'

OVERALL SITE PLAN

ALL DIMENSIONS AND SPACING ARE APPROXIMATE. ALL DIMENSIONS SHALL BE IN CONFORMANCE WITH THE CITY OF ALTON ZONING ORDINANCES AND ANY OTHER APPLICABLE REGULATIONS. THE ARCHITECT AND LANDSCAPE ARCHITECT SHALL BE RESPONSIBLE FOR OBTAINING ALL NECESSARY PERMITS AND APPROVALS FROM THE CITY OF ALTON AND ANY OTHER APPLICABLE AGENCIES. THE ARCHITECT AND LANDSCAPE ARCHITECT SHALL BE RESPONSIBLE FOR OBTAINING ALL NECESSARY PERMITS AND APPROVALS FROM THE CITY OF ALTON AND ANY OTHER APPLICABLE AGENCIES.



- EXISTING HOTEL BUILDING
- EXISTING ROOF/TERRACE DECK - ACCESSIBLE
- EXISTING SUN DECK - ACCESSIBLE
- CABANA PROJECT

OVERALL SITE PLAN
1" = 80'



BTM ARCHITECTS

RENDERING BY DIGITART3D.COM



BTM ARCHITECTS

RENDERING BY DIGITART3D.COM