

GENERAL NOTES

- 1 PROVIDE MOISTURE RESISTANT WALL BOARD AND SOUND BATT INSULATION AT ALL TOILET ROOMS AND SNACK AREAS.
- 2 UNLESS OTHERWISE NOTED HEREIN OR ELSEWHERE IN THESE DOCUMENTS, METAL STUDS SHALL BE 25 GA.
- 3 FOR PARTITION FINISHES, TILE, SPECIAL PAINT, ETC. (REFER TO FINISH SCHEDULE)
- 4 PARTITION TYPE DESCRIPTIONS ARE NOT TO BE INTERPRETED AS COMPLETE ASSEMBLY INSTRUCTIONS.
- 5 ALL PENETRATIONS IN FIRE RATED WALL OR PARTITIONS ASSEMBLIES SHALL MAINTAIN THE INTEGRITY OF THE FIRE RATING.
- 6 CONTRACTOR SHALL INSTALL THESE ASSEMBLIES IN ACCORDANCE WITH THE GYPSUM ASSOCIATION, AND PROVIDE FOR A LATERAL LIVE LOAD OF 5 LB. PER SQUARE FOOT AND DEFLECTION OF L/40.
- 7 PROVIDE FIRE STOPS IN ALL PARTITIONS AS REQUIRED PER LOCAL CODES.

1 TYPICAL WALL SECTION

2 1HR FR DEMISING WALL

3 PARTITION DETAILS

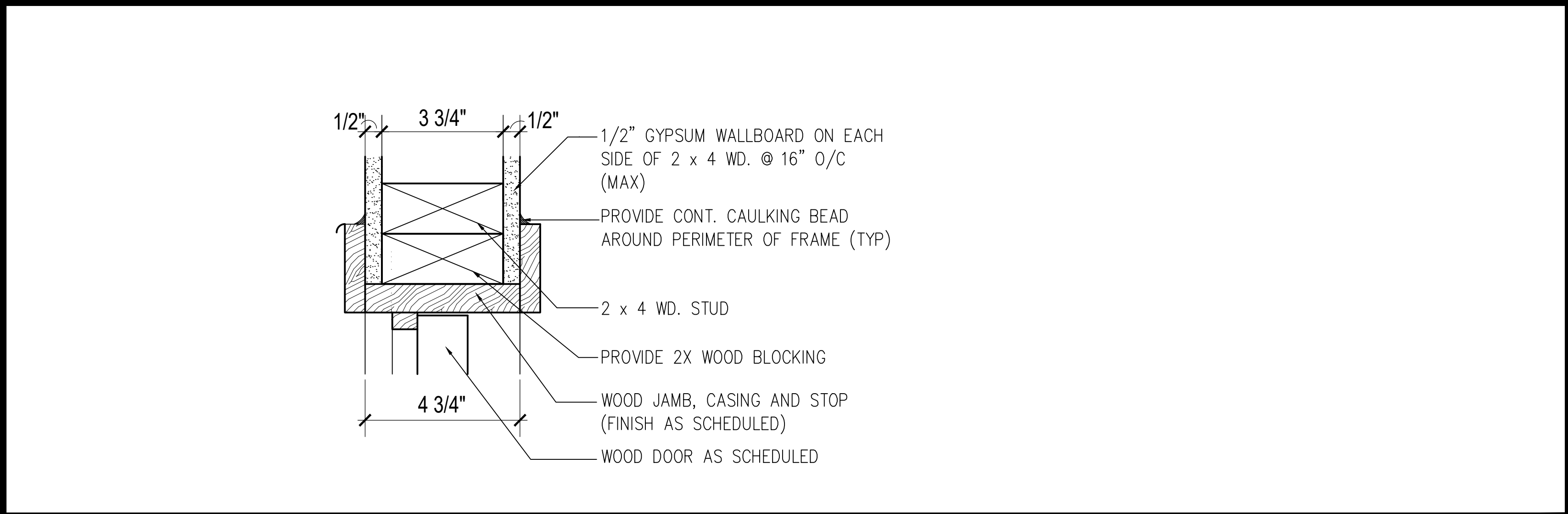
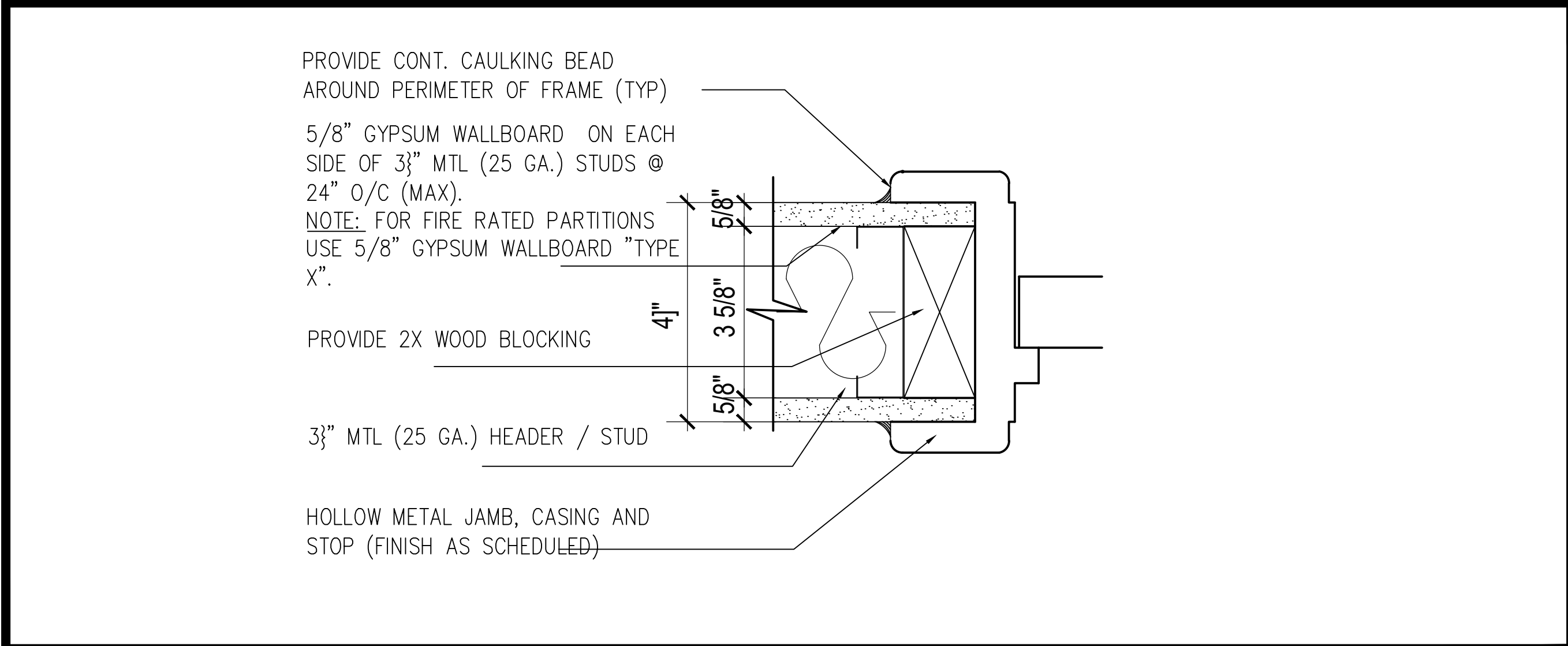

4 HOLLOW MTL. JAMB/HEADER DET.

4 WOOD JAMB / HEADER DETAIL

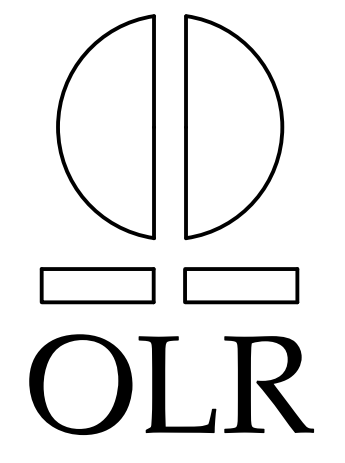

OLR ARCHITECT
ORESTES LOPEZ-RECIO
AR0009350

5895 SW 32 ST
MIAMI, FLORIDA
33155
PHONE: (305)360-2836

OWNER:
1820 SW 3 AVE LLC
90 SW 35TH UNIT 7 (JY LOBBY)
MIAMI FL 33130

PROPOSED INTERIOR
LEGALIZATION FOR:
1820 SW 3 AVE LLC
1820 SW 3RD AVE
MIAMI FLORIDA, 33129

SEAL

REVISIONS
B.D.C. 10.12.24

DATE 07-31-24
SCALE AS SHOWN
DRAWN : OLR
JOB NO. : 24-2670



A-011
SHEET NO.: OF