



**ALTERATIONS TO AN EXISTING WAREHOUSE BUILDING FOR:**  
**1943 NW 97TH AVENUE MIAMI, FL 33172**

No.	Description	Date
1	REVIEW COMMENTS	06/15/23
2	REVIEW COMMENTS	07/10/23
3	REVIEW COMMENTS	09/05/23
5	REVIEW COMMENTS	10/18/23
6	REVIEW COMMENTS	11/21/23

KENNETH C. DYMAN R.A.

AR 99987  
**SECOND FLOOR LIFE SAFETY PLAN**

Date	03/17/23
Drawn by	LGM
Checked by	KCD

**A1.1**  
 Scale As indicated

LIFE SAFETY LEGEND	
SYMBOL	DESCRIPTION
	EXIT SIGN (WHITE)
	EMERGENCY LIGHT W/ 90 MIN. BATTERY BACK-UP/ WALL MTD. 8'-0" TO 10'-0" AFF (WHITE)
	EMERGENCY EXIT LIGHT COMBO W/ 90 MIN. BATTERY BACK-UP/ WALL MTD. 8'-0" TO 10'-0" AFF (WHITE)
	FIRE EXTINGUISHER
	SMOKE DETECTOR
	MANUAL PULL STATION
	FIRE ALARM CONTROL PANEL
	HORN / STROBE
	STROBE LIGHT
	EGRESS DESIGNATION
	POINT OF TRAVEL DISTANCE
	TRAVEL DISTANCE
	RATED WALL. SEE PLAN FOR PROVIDED RATING IN HOURS

- LIFE SAFETY NOTES**
- ONE "UL" LISTED 2A-10B TYPE FIRE EXTINGUISHER SHALL BE INSTALLED FOR EACH 3,000 SQ. FT. OF FLOOR AREA, 75 FT. OF TRAVEL OR PART THEREOF. TOP OF FIRE EXTINGUISHER NOT TO EXCEED 5' A.F.F. SEE FLOOR PLAN FOR LOCATION(S). VERIFY EXTINGUISHER TYPE AND LOCATION WITH FIRE MARSHAL PRIOR TO ORDERING.
  - ALL INTERIOR WALL & CEILING FINISHES TO COMPLY WITH NFPA 101 SECTION 9.3.3.2, SECTION 10.2 AND FBC TABLE 803.11 AS FOLLOWS:
    - A. INTERIOR EXIT STAIRWAYS AND RAMPS AND EXIT PASSAGEWAYS CLASS B**  
 NOTE: CLASS C INTERIOR FINISH MATERIALS SHALL BE PERMITTED FOR WAINSCOTING OR PANELING OF NOT MORE THAN 1,000 SQUARE FEET OF APPLIED SURFACE AREA IN THE GRADE LOBBY WHERE APPLIED DIRECTLY TO A NONCOMBUSTIBLE BASE OR OVER FURRING STRIPS APPLIED TO A NONCOMBUSTIBLE BASE AND FIREBLOCKED AS REQUIRED BY SECTION 803.13.1.
    - B. CORRIDORS AND ENCLOSURE FOR EXIT ACCESS STAIRWAYS AND RAMPS CLASS B.**
    - C. ROOMS AND ENCLOSED SPACES CLASS C**
  - ALL FLOOR FINISHES TO COMPLY WITH NFPA 101 SECTION 9.3.3.3 AND FBC SECTION 804.
  - FURNISHINGS, DECORATIONS AND SCENERY: ALL FABRICS, FILMS, DRAPERIES AND CURTAINS SHALL MEET THE FLAME PROPAGATION PERFORMANCE CRITERIA CONTAINED IN NFPA 701.
  - UPHOLSTERED FURNITURE SHALL BE RESISTANT TO A CIGARETTE IGNITION PER NFPA 101 SECTION 10.3.2.1.
  - INTERIOR FLOOR FINISH MATERIALS SHALL HAVE SLIP RESISTANCE BETWEEN 0.5 & 0.9 STATIC COEFFICIENT OF FRICTION.
  - ANY FLOOR LEVEL CHANGES IN EXCESS OF 1/2" AT DOORWAYS SHALL BE BEVELED WITH A SLOPE NOT STEEPER THAN 1 IN 2.
  - ACCESSIBLE ROUTE SHALL BE MIN. 36" WIDE WITH CHANGE IN LEVEL NOT GREATER THAN 1/2" HIGH THROUGHOUT.
  - PENETRATIONS THROUGH FIRE RATED WALLS SHALL BE SEALED WITH AN APPROVED FIRE CAULKING. (FLAME STOP, INC.: FLAME STOP V PUTTY CAULK).
  - ONE-HOUR (1-HR) FIRE-RATED WALLS, DEMISING WALLS OR PARTY WALLS SHALL MEET THE REQUIREMENTS OF THE GYPSUM ASSOCIATION FILE #WP 1200; FIRE TEST: FM WP-45, 6-19-68; OSU T-1770, 8/61.
  - ALL WALLS TO BE FIRE-BLOCKED @ 8'-0" ON CENTER VERTICALLY.

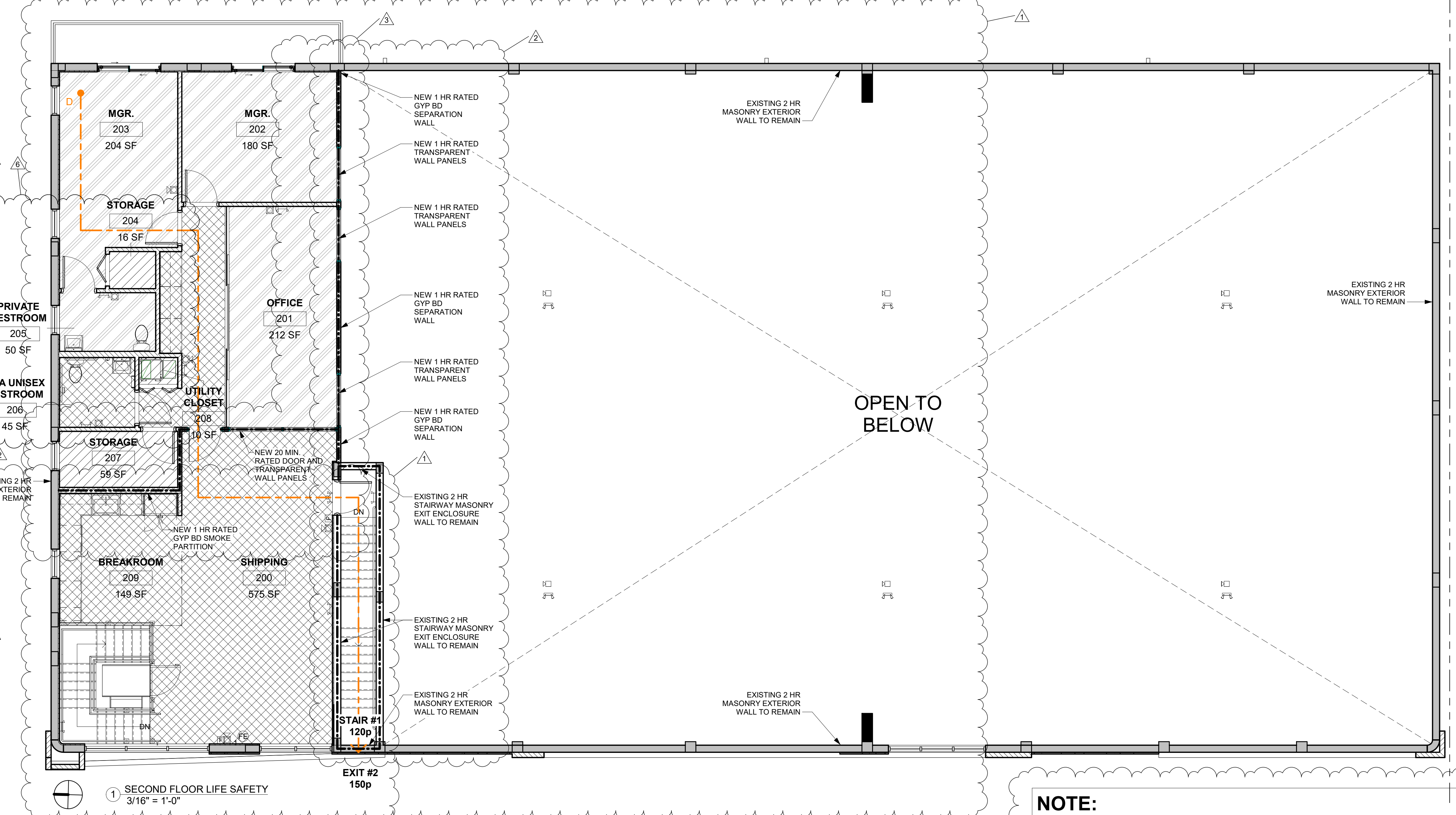

**NOTE:**  
 HIGH-PILED STORAGE OF COMBUSTIBLES OVER AN AREA EXCEEDING 2,500 SF IN AREA AND STORAGE COMMODITIES CLASSIFIED AS GROUP A PLASTICS IN EXCESS OF 5 FT IN HEIGHT OVER AN AREA EXCEEDING 2,500 SF IN AREA SHALL NOT BE PERMITTED IN THIS FACILITY TO COMPLY WITH FFPC NFPA 1 SECTION 13.3.2.27.

OCCUPANCY LOAD SCHEDULE - FBC		
TABLE 1004.5	GROUND FLOOR	OCC. #
STORAGE, STOCK SHIPPING AREAS- 300 SF GROSS	SHIPPING AREAS- 947 SF GROSS	4
	STORAGE AREAS- 7,164 SF GROSS	24
BUSINESS AREAS - 150 SF GROSS	SHIPPING AREAS- 769 SF GROSS	3
	STORAGE AREAS- 85 SF GROSS	1
	BUSINESS AREAS- 646 SF GROSS	5
<b>TOTAL OCCUPANT LOAD</b>		<b>37</b>

OCCUPANCY LOAD SCHEDULE - FFPC/NFPA 101		
TABLE 7.3.1.2	GROUND FLOOR	OCC. #
MERCANTILE USE FLOORS OR PORTIONS OF FLOOR USED ONLY FOR STORAGE, RECEIVING, AND SHIPPING, AND NOT OPEN TO THE GENERAL PUBLIC - 300 SF GROSS	MERCANTILE USE- 947 SF GROSS	4
	STORAGE USE- 7,164 SF GROSS	24
STORAGE USE IN MERCANTILE OCCUPANCIES - 300 SF GROSS	MERCANTILE USE- 769 SF GROSS	3
	STORAGE USE- 85 SF GROSS	1
BUSINESS USE 150 SF GROSS	BUSINESS USE- 646 SF GROSS	5
<b>TOTAL OCCUPANT LOAD</b>		<b>37</b>

CLASSIFICATION OF WORK - FFPC/NFPA 101	MODIFICATION
CODE REFERENCE	Florida Fire Prevention Code 7th Edition (2020) 2018 edition of the Life Safety Code (NFPA 101)

TRAVEL DISTANCE	
POINT 'D' TO EXIT #2	88'-5"
COMMON TRAVEL PATH	NA