

# SECOND FLOOR PLAN KEYNOTES

1. NEW STOREFRONT WALL, TYP. SEE STOREFRONT SCHEDULE.
2. NEW STOREFRONT TO REPLACE EXISTING, TYP. SEE STOREFRONT SCHEDULE.
3. NEW INTERIOR WALL, SEE WALL TYPES.
4. NEW FURRED WALL, SEE WALL TYPES.
5. EXISTING INTERIOR STAIR, SEE STAIR DETAILS.
6. NEW EXTERIOR GUARDRAIL, SEE STRUCT. DWGS.
7. NEW CONC. COLUMN, TYP. SEE STRUCT. DWGS.
8. EXISTING CONC. COLUMN, TYP.
9. EXISTING CONC. COLUMN AT EXTERIOR WALL, TYP.
10. EXISTING EGRESS STAIR, SEE FINISH SCHEDULE.
11. NEW PLUMBING FIXTURES, TYP. SEE INTERIOR DETAILS.
12. NEW MILLWORK AT PRINT STATION.
13. RELOCATED AHU, SEE MECH. DWGS.
14. NEW INTERIOR DOOR, TYP. SEE DOOR SCHEDULE.
15. EXISTING CONC. SLAB TO REMAIN, SEE FINISH SCHEDULE.
16. NEW EXTERIOR FRAMED WALL, SEE DETAILS & STRUCT. DWGS.
17. NEW TILE ON EXISTING CONC. BALCONY, PROVIDE SIKATOP SEAL 107 TWO-COMPONENT, POLYMER-MODIFIED CEMENTITIOUS WATERPROOFING.
18. NEW GYP. BD. RATED WALL, SEE WALL DETAILS.
19. NEW VERTICAL PLATFORM LIFT.
20. NEW UPPER 42" H. GLASS PANEL GATE @ VERTICAL PLATFORM LIFT.
21. NEW GLASS PANEL GUARDRAIL AND METAL HANDRAIL AT EXISTING STAIR, SEE STAIR DETAILS.

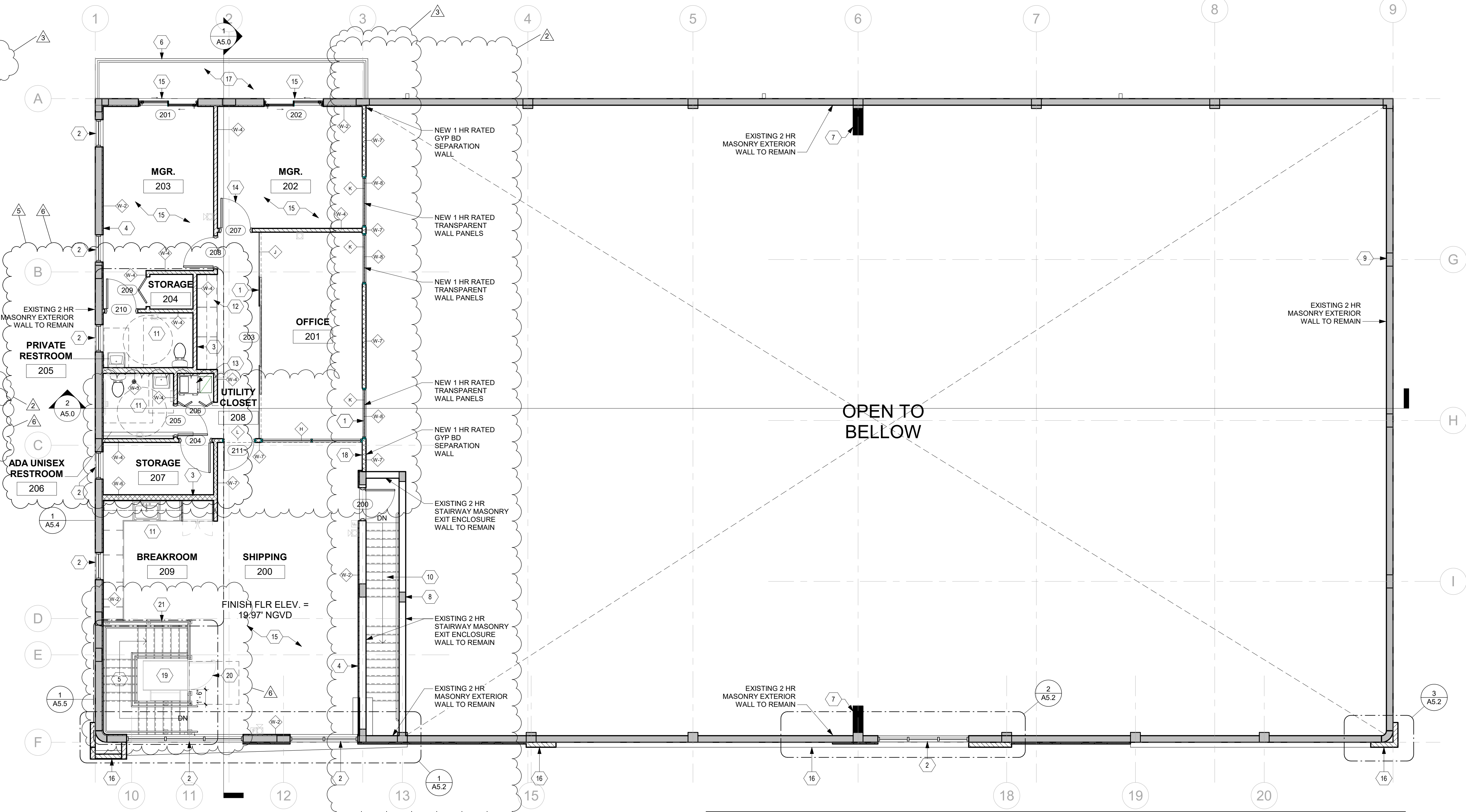

1 SECOND FLOOR PLAN  
3/16" = 1'-0"

| LEGEND |   |
|--------|---|
|        | EXISTING MASONRY PARTY WALL TO REMAIN           |
|        | EXISTING EXTERIOR MASONRY WALL TO REMAIN        |
|        | EXISTING INTERIOR PARTITION TO REMAIN           |
|        | NEW RATED PARTITION, SEE PLAN FOR WALL TYPE     |
|        | NEW NON-RATED PARTITION, SEE PLAN FOR WALL TYPE |

**SAFETY GLAZING NOTE:**  
GLAZING AT TEMPERED PANEL OF SAFETY INTERIOR DOORS AND OTHER HAZARDOUS INTERIOR LOCATIONS LARGER THAN 9 SF SHALL COMPLY WITH 16CFR1201, CATEGORY II SAFETY GLASS.

| SECOND FLOOR DOOR SCHEDULE |                              |            |        |          |          |             |          |                |              |                                     |  |
|----------------------------|------------------------------|------------|--------|----------|----------|-------------|----------|----------------|--------------|-------------------------------------|--|
| MARK                       | TYPE                         | WIDTH      | HEIGHT | MATERIAL | FINISH   | FIRE RATING | HARDWARE | FRAME MATERIAL | FRAME FINISH | REMARKS                             |  |
| 200                        | SINGLE SWING DOOR            | 3'-0"      | 7'-0"  | HM       | PT       | 60 MIN.     | IX       | ALUM           | ANOD         | PROVIDE CLOSER                      |  |
| 201                        | SLIDING PATIO DOOR           | 6'-0"      | 7'-0"  | ALUM/GL  | ANOD/CLR |             | VII      | ALUM           | ANOD         |                                     |  |
| 202                        | SLIDING PATIO DOOR           | 6'-0"      | 7'-0"  | ALUM/GL  | CLR      |             | VII      | ALUM           | ANOD         |                                     |  |
| 203                        | INTERIOR DOUBLE SLIDING DOOR | 5'-10 3/4" | 9'-8"  | GL       | CLR      |             | VIII     | ALUM           | ANOD         |                                     |  |
| 204                        | SINGLE SWING DOOR            | 3'-0"      | 7'-0"  | WD       | PT       |             | III      | HM             | PT           |                                     |  |
| 205                        | SINGLE SWING DOOR            | 3'-0"      | 7'-0"  | WD       | PT       |             | II       | HM             | PT           |                                     |  |
| 206                        | 4-PANEL BI-FOLD DOOR         | 3'-8"      | 7'-0"  | WD       | PT       |             | IV       | GYP BD         | PT           | LOUVERED FOR AC                     |  |
| 207                        | SINGLE SWING DOOR            | 3'-0"      | 7'-0"  | WD       | PT       |             | II       | HM             | PT           |                                     |  |
| 208                        | SINGLE SWING DOOR            | 3'-0"      | 7'-0"  | WD       | PT       |             | II       | HM             | PT           |                                     |  |
| 209                        | 2-PANEL BI-FOLD DOOR         | 3'-0"      | 7'-0"  | WD       | PT       |             | IV       | GYP BD         | PT           |                                     |  |
| 210                        | SINGLE SWING DOOR            | 3'-0"      | 7'-0"  | WD       | PT       |             | III      | HM             | PT           |                                     |  |
| 211                        | SINGLE SWING DOOR            | 3'-0"      | 7'-0"  | ALUM/GLY | ANOD/CLR | 20 MIN.     | III      | ALUM           | ANOD         | STOREFRONT SYSTEM LY PROVIDE CLOSER |  |

| SECOND FLOOR ROOM FINISH SCHEDULE |                     |              |             |              |                |                |         |
|-----------------------------------|---------------------|--------------|-------------|--------------|----------------|----------------|---------|
| NUMBER                            | NAME                | FLOOR FINISH | BASE FINISH | WALL FINISH  | CEILING FINISH | CEILING HEIGHT | REMARKS |
| 200                               | SHIPPING            | CONC-2       | VWB-1       | GYP-1 / GL-1 | CONC-3 / GYP-1 |                | 575 SF  |
| 201                               | OFFICE              | CONC-2       | VWB-1       | GYP-1 / GL-1 | CONC-3         |                | 212 SF  |
| 202                               | MGR.                | CONC-2       | VWB-1       | GYP-1        | CONC-3         |                | 180 SF  |
| 203                               | MGR.                | CONC-2       | VWB-1       | GYP-1        | CONC-3         |                | 204 SF  |
| 204                               | STORAGE             | CONC-2       | VWB-1       | GYP-1        | GYP-1          |                | 16 SF   |
| 205                               | PRIVATE RESTROOM    | CONC-2       | VWB-1       | GYP-1        | CONC-3 / GYP-1 |                | 50 SF   |
| 206                               | ADA UNISEX RESTROOM | CONC-2       | VWB-1       | GYP-1        | CONC-3         |                | 45 SF   |
| 207                               | STORAGE             | CONC-2       | VWB-1       | GYP-1        | CONC-3         |                | 59 SF   |
| 208                               | UTILITY CLOSET      | CONC-2       | VWB-1       | GYP-1        | CONC-3         |                | 10 SF   |
| 209                               | BREAKROOM           | CONC-2       | VWB-1       | GYP-1        | CONC-3         |                | 149 SF  |

| INTERIOR STOREFRONT SCHEDULE |   |  |        |        |             |          |      |         |         |          |
|------------------------------|---|--|--------|--------|-------------|----------|------|---------|---------|----------|
| MARK                         | MODEL   | TYPE   | SIZE   |        |             | MATERIAL | TYPE | GLAZING |         | REMARKS  |
|                              |   |  | WIDTH  | HEIGHT | HEAD HEIGHT |          |      | FINISH  | SIZE    |          |
| H                            | TGP FIREFRAMES ALUMINUM SERIES AND FIREGLASS 20     | 20 MIN. FIRE-RATED IMPACT SAFETY-RATED GLASS AND RATED PERIMETER FRAME | 10'-5" | 9'-8"  | 9'-8"       | ALUM/GL  | LAM  | CLR     | 1/4"    |          |
| J                            | CRL CLEAR VIEW                                      | GLASS WALL PARTITION W/ DOUBLE SLIDING DOOR                            | 21'-0" | 9'-8"  | 9'-8"       | ALUM/GL  | LAM  | CLR     | 1/2"    | DOOR 203 |
| K                            | TGP FIREFRAMES ALUMINUM SERIES AND CLEARVIEW SYSTEM | 60 MIN. FIRE-RATED IMPACT SAFETY-RATED GLASS AND RATED PERIMETER FRAME | 5'-3"  | 9'-8"  | 9'-8"       | ALUM/GL  | LAM  | CLR     | 1 1/16" |          |
| L                            | TGP FIREFRAMES ALUMINUM SERIES AND FIREGLASS 20     | 20 MIN. FIRE-RATED IMPACT SAFETY-RATED GLASS AND RATED PERIMETER FRAME | 3'-4"  | 9'-8"  | 9'-8"       | ALUM/GL  | LAM  | CLR     | 1/4"    | DOOR 211 |

DAFA Design, LLC  
680 NE 64th Street  
Suite PH-7  
Miami, FL 33138  
www.dafa-design.com  
786.508.2603

**DAFA**  
Dyman and Feinberg Architecture

**ALTERATIONS TO AN EXISTING WAREHOUSE BUILDING FOR:**  
1943 NW 97TH AVENUE  
MIAMI, FL 33172

| No. | Description     | Date     |
|-----|-----------------|----------|
| 1   | REVIEW COMMENTS | 06/15/23 |
| 2   | REVIEW COMMENTS | 07/10/23 |
| 3   | REVIEW COMMENTS | 09/05/23 |
| 5   | REVIEW COMMENTS | 10/18/23 |
| 6   | REVIEW COMMENTS | 11/21/23 |

KENNETH C. DYMAN R.A.

AR 99987  
**SECOND FLOOR PLAN**

|            |          |
|------------|----------|
| Date       | 03/17/23 |
| Drawn by   | LGM      |
| Checked by | KCD      |

**A2.3**

Scale As indicated