

TOTAL NUMBER OF REQUIRED PLUMBING FIXTURES :: INTERIOR OCCUPANT LOAD							
OCCUPANCY	OCCUPANTS	WATER CLOSETS		LAVATORIES		MEN	WOMEN
		MEN	WOMEN	MEN	WOMEN		
A-2	127.0	1 PER 40	1.59	1.59	1 PER 75	0.85	0.85
M	34.0	1 PER 500	0.13	0.13	1 PER 750	0.02	0.02
<b>TOTAL</b>	<b>161</b>		<b>2</b>	<b>2</b>		<b>1</b>	<b>1</b>

TOTAL NUMBER OF REQUIRED PLUMBING FIXTURES :: EXTERIOR EVENT SPACE OCCUPANT LOAD							
OCCUPANCY	OCCUPANTS	WATER CLOSETS		LAVATORIES		MEN	WOMEN
		MEN	WOMEN	MEN	WOMEN		
A-2	130.0	1 PER 40	1.63	1.63	1 PER 75	0.87	0.87
<b>TOTAL</b>	<b>130</b>		<b>2</b>	<b>2</b>		<b>1</b>	<b>1</b>

ADDITIONAL EVENT RESTROOM TO BE BROUGHT IN FOR EVENTS.

2 N.T.S. PLUMBING FIXTURES CALCULATIONS

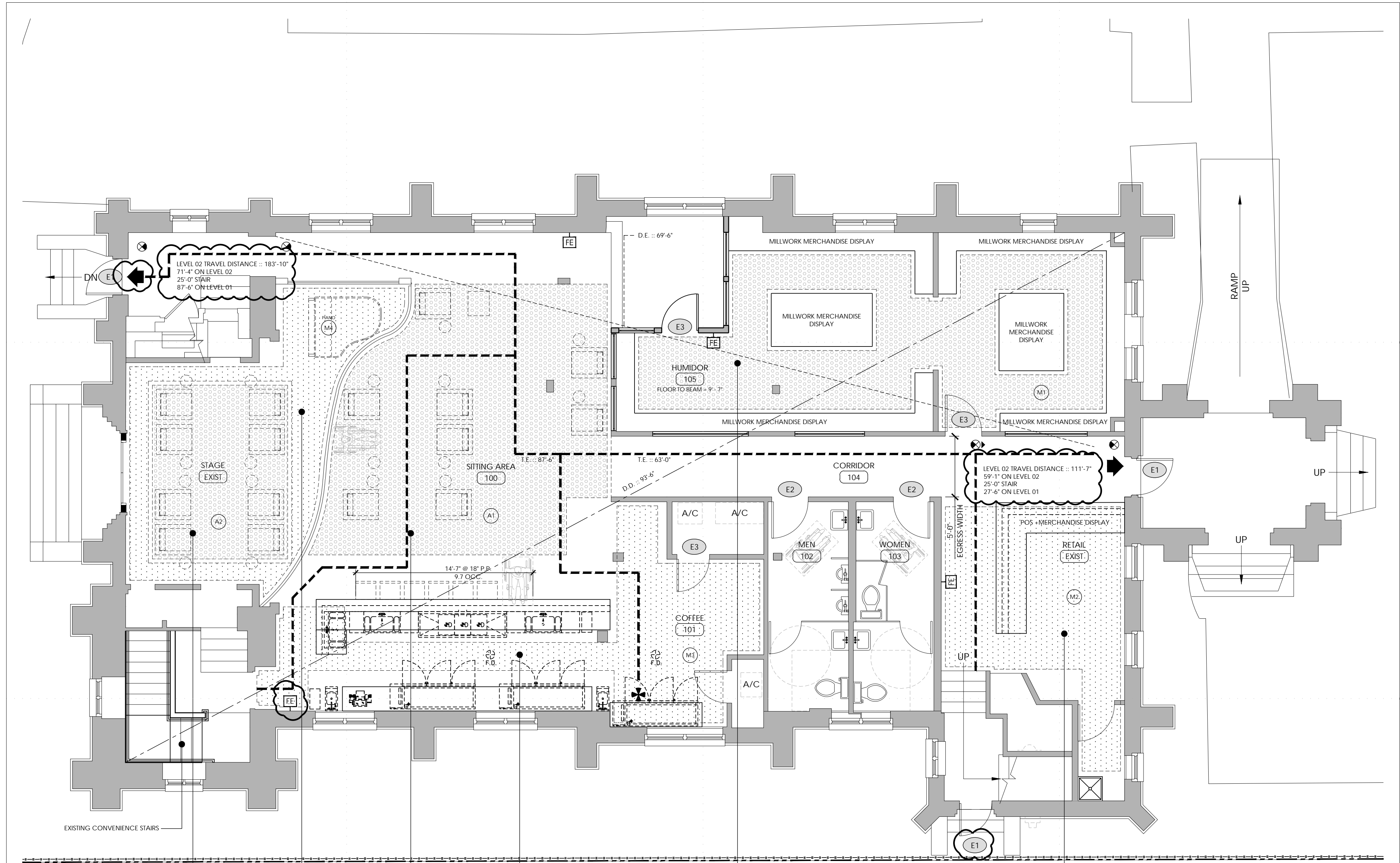

GROUP	INTERIOR WALL + CEILING FINISH REQ. BY OCCUPANCY	CLASS	2-AC	MAX DISTANCE	75'	AREA	3,000 SF
A2	INTERIOR EXIT STAIRWAYS, RAMP, EXIT PASSAGEWAYS	B					
A2	CORRIDORS AND ENCLOSURE FOR EXIT ACCESS STAIRWAYS AND RAMP	B					
A2	ROOMS AND ENCLOSED SPACES	C					
M	INTERIOR EXIT STAIRWAYS, RAMP, EXIT PASSAGEWAYS	B					
M	CORRIDORS AND ENCLOSURE FOR EXIT ACCESS STAIRWAYS AND RAMP	C					
M	ROOMS AND ENCLOSED SPACES	C					

NO. PROJECT SCOPE  
**\*\* LIFE SAFETY CODE SUMMARY**

BLDG : RENOVATION AREA 8,106 SF GROSS : 3,960 SF USABLE  
OCCUPANCY \*A-2\* ASSEMBLY \*M\* MERCANTILE (CIGAR STORE)

CONSTRUCTION TYPE TYPE III-B : SPRINKLERS TO BE ADDED

EGRESS CALCULATIONS LEVEL 01

MAXIMUM ALLOWABLE TRAVEL DISTANCE \*A+M\* : 250'-0" [FBC 1017.2] \*A\* : 250'-0" [FFPC 12.2.6] \*M\* : 250'-0" [FFPC 36.2.6] 113'-9" PROVIDED TO EXTERIOR

COMMON PATH OF TRAVEL \*A+M\* : 75'-0" [FBC TABLE 1006.2.1, FPC 12.2.5, 36.2.5]

DEAD END CORRIDOR \*A+M\* : 20'-0" [FBC 1020.5, FPC 12.2.5, 36.2.5]

REQUIRED NUMBER OF EXITS [2] TWO EXIT REQUIRED [TYP EA FLR.] [2] TWO EXIT PROVIDED [MIN EA FLR.]

REQUIRED EGRESS WIDTH PER OCCUPANT : [36" MIN.] FLOOR = 14" LEVEL REQUIRED FLOOR = 64" LEVEL PROVIDED LEVEL [2] / STAIR [3] STAIR = 21" LEVEL REQUIRED STAIR = 64" LEVEL PROVIDED [TABLE 1005.3]

EGRESS WIDTH PROVIDED [2] EXIT/LEVEL = 64" TOTAL

EXIT SEPARATION CALCULATION [1007.1.1] DIAGONAL DISTANCE 93'-6" x 1/2 = 46'-9" REQUIRED : 79'-2" PROVIDED

EGRESS CALCULATIONS LEVEL 02

MAXIMUM ALLOWABLE TRAVEL DISTANCE \*A+M\* : 250'-0" [FBC 1017.2] \*A\* : 250'-0" [FFPC 12.2.6] \*M\* : 250'-0" [FFPC 36.2.6] 98'-1" PROVIDED TO EXTERIOR

COMMON PATH OF TRAVEL \*A+M\* : 75'-0" [FBC TABLE 1006.2.1, FPC 12.2.5, 36.2.5]

DEAD END CORRIDOR \*A+M\* : 20'-0" [FBC 1020.5, FPC 12.2.5, 36.2.5]

REQUIRED NUMBER OF EXITS [2] TWO EXIT REQUIRED [TYP EA FLR.] [2] TWO EXIT PROVIDED [MIN EA FLR.]

REQUIRED EGRESS WIDTH PER OCCUPANT : [36" MIN.] FLOOR = 14" LEVEL REQUIRED FLOOR = 64" LEVEL PROVIDED LEVEL [2] / STAIR [3] STAIR = 21" LEVEL REQUIRED STAIR = 64" LEVEL PROVIDED [TABLE 1005.3]

EGRESS WIDTH PROVIDED [2] EXIT/LEVEL = 64" TOTAL

EXIT SEPARATION CALCULATION [1007.1.1] DIAGONAL DISTANCE 93'-6" x 1/2 = 46'-9" REQUIRED : 68'-6" PROVIDED

OCCUPANT LOAD :: LEVEL 01

#	SPACE FUNCTION	OCCUPANT LOAD FACTOR	AREA [SF]	OCCUPANT LOAD
A1	'A-2' ASSEMBLY UNCONCENTRATED	15 NET	450	30.0
A2	'A-2' ASSEMBLY UNCONCENTRATED	15 NET	160	10.7
A3	COUNTER SEATING	18 LINEAR INCH	313.2	17.4
M1	'M' MERCANTILE	30 GROSS	328	10.9
M2	'M' MERCANTILE	30 GROSS	245	8.2
M3	'M' MERCANTILE	30 GROSS	218	7.3
M4	'M' MERCANTILE	30 GROSS	147	4.9
<b>TOTAL OCCUPANT LOAD :: LEVEL 01</b>				<b>89</b>

OCCUPANT LOAD :: LEVEL 02

#	SPACE FUNCTION	OCCUPANT LOAD FACTOR	AREA [SF]	OCCUPANT LOAD
A1	'A-2' ASSEMBLY UNCONCENTRATED	15 NET	712	47.5
A2	'A-2' ASSEMBLY UNCONCENTRATED	15 NET	223	14.9
A2	'A-2' ASSEMBLY SERVICE	100 GROSS	92	0.9
A3	'A-2' ASSEMBLY UNCONCENTRATED	15 NET	62	4.1
S1	'S' STORAGE	30	245	8.2
<b>TOTAL OCCUPANT LOAD :: LEVEL 02</b>				<b>76</b>

OCCUPANT LOAD :: LEVEL 03

#	SPACE FUNCTION	OCCUPANT LOAD FACTOR	AREA [SF]	OCCUPANT LOAD
B	'B' BUSINESS OFFICE	150	226	1.5
S1	'S' STORAGE	300	71	0.2
<b>TOTAL INTERIOR OCCUPANT LOAD :: LEVEL 03</b>				<b>2</b>
<b>TOTAL INTERIOR OCCUPANT LOAD :: LEVEL 01 + 02 + 03</b>				<b>167</b>

OCCUPANT LOAD :: EXTERIOR SPACES

#	SPACE FUNCTION	OCCUPANT LOAD FACTOR	AREA [SF]	OCCUPANT LOAD
X1+X2	'A-2' ASSEMBLY UNCONCENTRATED	15 NET	1,679	111.9
<b>TOTAL OCCUPANT LOAD :: EXTERIOR SPACES</b>				<b>112</b>
<b>TOTAL OCCUPANT LOAD :: INTERIOR + EXTERIOR</b>				<b>279</b>

LIFE SAFETY CODE LEGEND AND SYMBOLS

- D.E. DISTANCE BETWEEN EXITS - LINEAR FT.
- D.D. DIAGONAL DISTANCE THRU BUILDING.
- T.E. TRAVEL DISTANCE MOST REMOTE POINT.
- M.R.P. = MOST REMOTE POINT.
- EXIT / ENTRY.
- EXIT LIGHT
- FIRE EXTINGUISHER

XXXXXXX - OCCUPANT USE  
XXXX - ROOM NUMBER  
XX - AREA OR LENGTH  
XX - OCCUPANT LOAD  
XX - OCCUPANT LOAD FACTOR

No.	Phase Description	Date
1	Permit Documents	01.23.2024

No.	Revision Description	Date
2	Permit Comments	07.30.2024

THIS ITEM HAS BEEN ELECTRONICALLY SIGNED AND SEALED BY JOHN A. MISTRETTA USING A DIGITAL SIGNATURE AND DATE. PRINTED COPIES OF THIS DOCUMENT ARE NOT CONSIDERED SIGNED AND SEALED AND THE SIGNATURE MUST BE VERIFIED ON ANY ELECTRONIC COPIES.

Professional Seal:

John A. Mistretta AR 94004  
Project Number: 23.704.01

Sheet Title:  
**LIFE SAFETY PLAN : LEVEL 1 ASSEMBLY SECTIONS + CODE SUMMARY**  
Original size is 24"x36" Copy Reductions N.T.S.  
Sheet Number:

**A111**