

CORAL WAY

**FOG 2.0 RER-DERM  
FOG Control Device (FCD)  
Installation Inspection**

Approval Date: \_\_\_\_\_  
Inspector: \_\_\_\_\_

DERM's FCD Installation Inspection Required Prior to Plumbing Final for all Municipal projects. Failure to secure DERM's FCD Installation Inspection will result in disapproval of Final Inspection by the Municipal Building Official, pursuant to Section 24.42-6, MDC Code.

To schedule DERM's FCD Installation inspection for Municipal projects please send an email to [IFOG2@miamidade.gov](mailto:IFOG2@miamidade.gov), 24 hours prior to desired date. Provide DERM plans process M-number, complete address of the site, folio number, and contact person name and phone number.

Updated: 4/26/2018

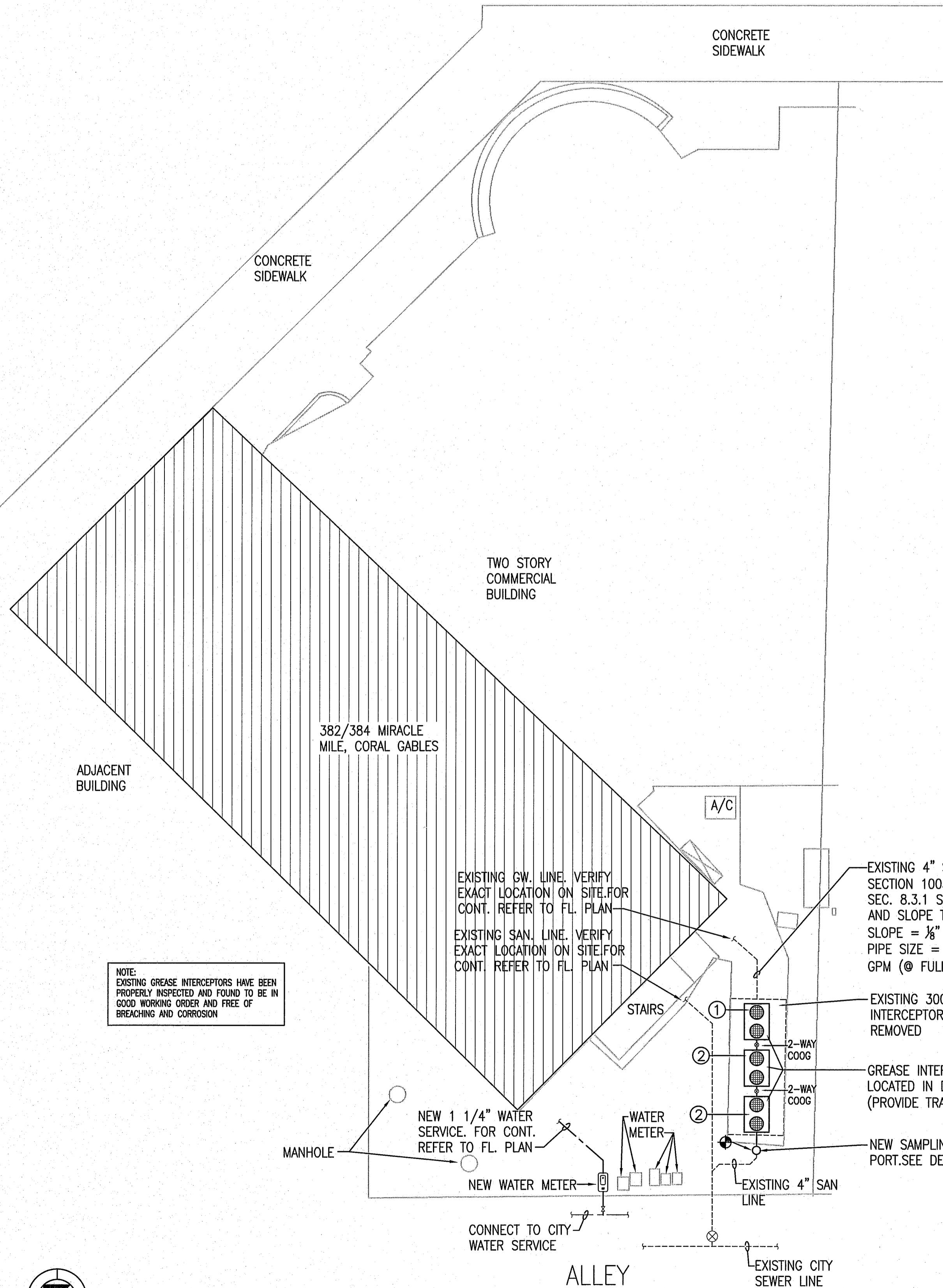

**PUMP OUT FREQUENCY CALCULATION:**  
FOOD COURT  
GREASE PRODUCTION FACTOR = 0.0455 LB/MEAL  
# OF SEATS = 150 SEATS  
# OF MEALS/DAY = 150 SEATS X 4 MEALS/DAY  
# OF MEALS/DAY = 600  
# OF TAKE OUT MEALS/DAY = 50  
LB GREASE PER DAY = 650 MEALS/DAY X 0.0455 = 29.58 LBS.  
POF = 90 DAYS  
18.3 LBS/DAY X 90 DAYS = 1646 LBS GREASE

**NOTE:**  
ALL LABELS AND MARKINGS OF GREASE INTERCEPTOR SHALL REMAIN VISIBLE.

GREASE INTERCEPTORS & SAMPLING PORT SHALL BE ACCESSIBLE AT ALL TIMES WITHOUT HAVING TO REMOVE ANY MERCHANDISE AND WITHOUT STANDING WATER ON GROUND SURFACE; WITH A 36 INCHES HORIZONTAL CLARENCE FROM ANY WALL, FIXED EQUIPMENT OR STORED MATERIALS AND 48 INCHES VERTICAL CLEARANCE FROM ANY FIXED EQUIPMENT OR STORED MATERIALS.

**REFERENCED NOTES:**

- ① NEW SOLID INTERCEPTOR STRIEM MODEL # CB-125-FSL, 4" INLET/OUTLET, LIQUID CAPACITY 125 GAL., SOLIDS CAPACITY 70 GAL. (SEE DETAIL) (PROVIDE TRAFFIC RATED LID)
- ② NEW GREASE INTERCEPTOR SYSTEM SCHIER MODEL GB-250-2-SERIES 100 GPM, 4" INLET/OUTLET (SEE DETAIL) (PROVIDE TRAFFIC RATED LIDS)
- ③ NEW SAMPLING PORT (SEE DETAIL)

NOTE: EXISTING GREASE INTERCEPTORS HAVE BEEN PROPERLY INSPECTED AND FOUND TO BE IN GOOD WORKING ORDER AND FREE OF BREACHING AND CORROSION

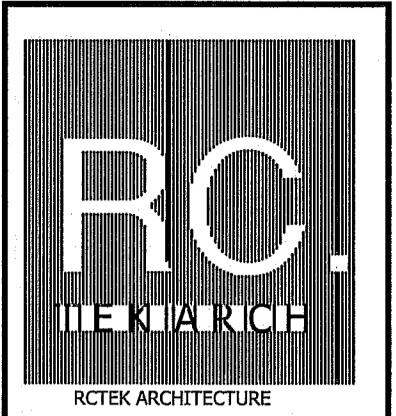

Lic# AA-26003585  
1375 SW 8th Ave  
Miami, FL 33135  
PH: (784) 277-7145

NO.	DESCRIPTION	DATE
1	BLDG. DPT. COMMS	6/12/20

DATE:	6/12/20
BY:	AS
CHECKED BY:	AS/RC
SCALE:	AS SHOWN

REVISION PLAN  
REVISION & MISC. REPAIRS  
OWNER INFORMATION 382 / 384 MIRACLE MILE CORAL GABLES FL 33134  
FLOOR PLANS

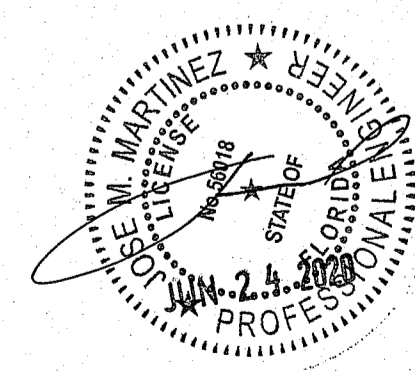

**JMM**  
Consulting Engineers, LLC  
10201 SUNSET DRIVE, SUITE 103, MIAMI, FL 33175  
TEL: (305) 255-1621 FAX: (305) 271-0500  
Certificate of Authorization #9892  
Jose M. Martinez P.E. #50018

To the best of my knowledge, the plans and specifications submitted herewith comply with existing interpretations and provisions of the applicable building codes. This drawing is the sole property of JMM Consulting Engineers, LLC and is an instrument of service not to be reproduced in whole or in part without express written permission of JMM Consulting Engineers, LLC.