



ZHLA.48
Windstorm-rated Assemblies

[Page Bottom](#)

Windstorm-rated Assemblies

[See General Information for Windstorm-rated Assemblies](#)

Assembly No. 48

November 08, 2017



Keepa Vent Series

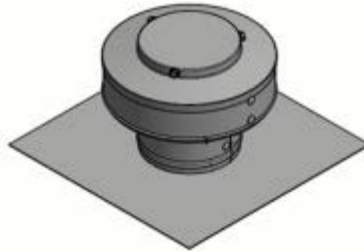

Round Back Vent Series



Universal Vent Series



Aura Vent Series



Pop Vent Series

TAS 202 (Structural Load Only) and ASTM E330

Assembly Type	Permitted Size	Design Pressure (psf)	Test Pressure (psf)	Missile Criteria
Roof Vent - Keepa Vent Series, Round Back Vent Series, Universal Vent Series (Model UV-15 only)	Refer to Model/Series Below	±68	±136	N/A
Roof Vent - Universal Vent Series	Refer to Model/Series Below	±51	±102	N/A
Roof Vent - Aura Vent Series (Model Model AV-04-C12 only), Pop Vent Series (Model PV-04-C12 only)	Refer to Model/Series Below	±112.5	±225	N/A
Roof Vent - Aura Vent Series, Pop Vent Series	Refer to Model/Series Below	+60 - 112.5	+120 - 225	N/A

Note: Refer to the table(s) below for product type requirements and options.

Product Type	Manufacturer	Model/Series
Roof Vent	ACTIVE VENTILATION PRODUCTS INC (View Classification)	Keep Vent Series: Models KV-04, KV-06, KV-08, KV-10, KV-12
		Round Back Vent Series: Models RBV-3-C2, RBV-3-C4, RBV-4-C2, RBV-4-C4, RBV-5-C2, RBV-5-C4, RBV-6-C2, RBV-6-C4, RBV-8-C2, RBV-8-C4, RBV-10-C2, RBV-10-C4
		Universal Vent Series: Models UV-15, UV-30, UV-45, UV-60, UV-75, UV-90, UV-105, UV-120, UV-135
		Aura Vent Series: Models AV-04-C02, AV-04-C04, AV-04-C06, AV-04-C08, AV-04-C12, AV-06-C02, AV-06-C04, AV-06-C06, AV-06-C08, AV-06-C10, AV-08-C02, AV-08-C04, AV-08-C06, AV-08-C08, AV-08-C12, AV-10-C02, AV-10-C04, AV-10-C06, AV-10-C08, AV-10-C12, AV-12-C02, AV-12-C04, AV-12-C06, AV-12-C08, AV-12-C12, AV-14-C02, AV-14-C04, AV-14-C06, AV-14-C08, AV-14-C12, AV-16-C02, AV-16-C04, AV-16-C06, AV-16-C08, AV-16-C12, AV-18-C02, AV-18-C04, AV-18-C06, AV-18-C08, AV-18-C12, AV-20-C02, AV-20-C04, AV-20-C06, AV-20-C08, AV-20-C12, AV-24-C02, AV-24-C04, AV-24-C06, AV-24-C08, AV-24-C12
Pop Vent Series: Models PV-04-C01, PV-04-C02, PV-04-C04, PV-04-C06, PV-04-C08, PV-04-C12, PV-06-C01, PV-06-C02, PV-06-C04, PV-06-C06, PV-06-C08, PV-06-C10, PV-08-C01, PV-08-C02, PV-08-C04, PV-08-C06, PV-08-C08, PV-08-C12, PV-10-C01, PV-10-C02, PV-10-C04, PV-10-C06, PV-10-C08, PV-10-C12, PV-12-C01, PV-12-C02, PV-12-C04, PV-12-C06, PV-12-C08, PV-12-C12, PV-14-C01, PV-14-C02, PV-14-C04, PV-14-C06, PV-14-C08, PV-14-C12, PV-16-C02, PV-16-C04, PV-16-C06, PV-16-C08, PV-16-C12, PV-18-C02, PV-18-C04, PV-18-C06, PV-18-C08, PV-18-C12, PV-20-C02, PV-20-C04, PV-20-C06, PV-20-C08, PV-20-C12, PV-24-C02, PV-24-C04, PV-24-C06, PV-24-C08, PV-24-C12		

Note: All products bear the UL Classification Mark or Enhanced UL Certification Mark unless otherwise noted.

Roof Substrate (Not Shown) — Min. 15/32" plywood.

[Last Updated](#) on 2017-11-08

[Questions?](#)

[Print this page](#)

[Terms of Use](#)

[Page Top](#)

© 2017 UL LLC

The appearance of a company's name or product in this database does not in itself assure that products so identified have been manufactured under UL's Follow-Up Service. Only those products bearing the UL Mark should be considered to be Certified and covered under UL's Follow-Up Service. Always look for the Mark on the product.

UL permits the reproduction of the material contained in the Online Certification Directory subject to the following conditions: 1. The Guide Information, Assemblies, Constructions, Designs, Systems, and/or Certifications (files) must be presented in their entirety and in a non-misleading manner, without any manipulation of the data (or drawings). 2. The statement "Reprinted from the Online Certifications Directory with permission from UL" must appear adjacent to the extracted material. In addition, the reprinted material must include a copyright notice in the following format: "© 2017 UL LLC".

