

HEAD JAMB

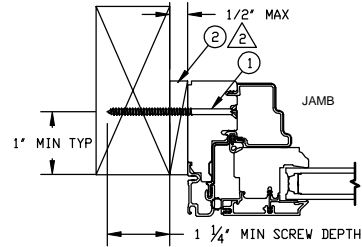

JAMB

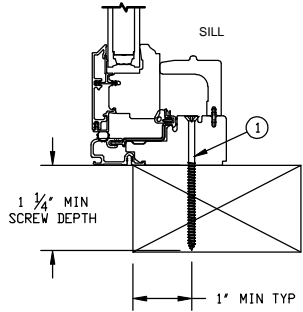

SILL

REPLACEMENT PRODUCT DETAILS

JAMB SCREW INSTALLATION

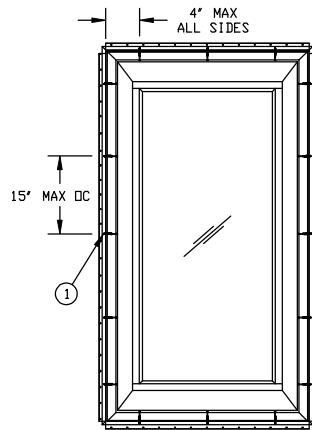

JAMB SCREW INSTALLATION METHOD:
 - UNIT MUST NOT BE IN DIRECT CONTACT WITH EITHER CONCRETE OR TREATED BUCK MATERIAL. IF SHIM SPACE IS LESS THAN 1/8" WRAPPING THE UNIT ON ALL 4 SIDES WITH WINDOW FLASHING TAPE IS REQUIRED AS A BARRIER BETWEEN THE UNIT AND CONCRETE OR TREATED LUMBER.
 - MINIMUM OF 2 SCREWS PER SIDE.
 - SHIM AT EACH SCREW LOCATION.
 - ALTERNATE SUBSTRATES ALSO APPLY PROVIDED SCREW SIZE IS EQUAL TO OR LARGER THAN A #8 SCREW.
 - FOR DIRECT MOUNT TO CONCRETE 3/16" CONCRETE SCREWS MAY BE SUBSTITUTED FOR THE # 8 SCREWS; THE SCREW MUST BE FULLY SUPPORTED BY SHIM MATERIAL AND HAVE A MINIMUM EDGE DISTANCE OF 2" AND MINIMUM PENETRATION OF 1 1/4".

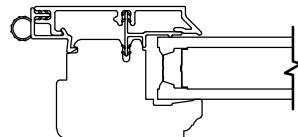

*GLASS COMPLIES WITH ASTM E1300"
 GLAZING DETAIL

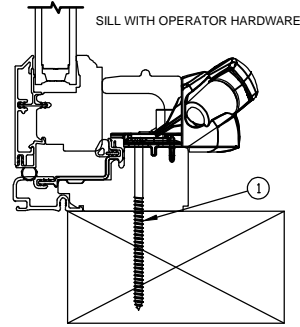

SILL WITH OPERATOR HARDWARE

NOTE: Additional #8 x 3inch screws must be installed through each side of the Operator Base Hardware.
 This does not apply to Fixed Units.

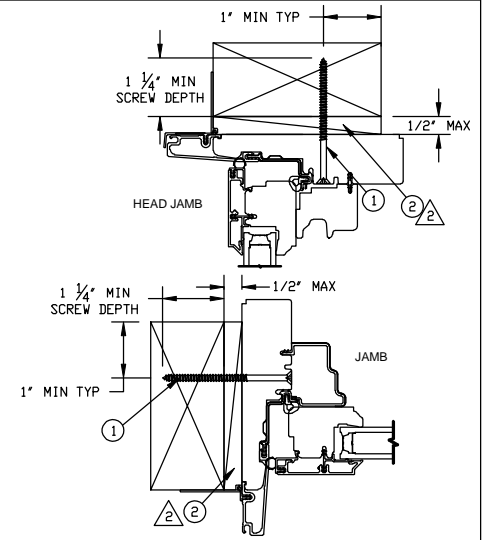

HEAD JAMB

JAMB

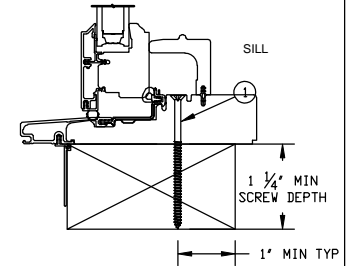

SILL

FULL FRAME PRODUCT DETAILS

UNIT	MAX FRAME SIZE	DP RATING
UL AWN NF	48 X 96	+40/-40
UL AWN NF	64 X 81 1/8	+30/-30
UL AWN NF	81 1/8 X 64	+30/-30
UL AWN NF	96 X 48 1/8	+30/-30
UL AWN	48 X 96	+40/-40
UL AWN	64 X 81 1/8	+30/-30
UL AWN	81 1/8 X 64	+30/-30
UL AWN	96 X 48 1/8	+30/-30

NOTES FOR ALL METHODS:
 1. THIS PRINT IS FOR STRUCTURAL PERFORMANCE ONLY. FOR FLASHING & SEALING INSTRUCTIONS, REFER TO THE INSTALLATION INSTRUCTIONS.
 2. SHIMS
 -PLACE A SHIM WITHIN 4-6 INCHES OF EACH CORNER AND SPACE ALL OTHERS EVELY A MAXIMUM OF 15" APART.
 3. IF CHEMICALLY TREATED LUMBER IS USED FOR BUCK MATERIAL, FASTENERS INTO THE BUCK MUST BE A MINIMUM OF 0.90 OZ/FT² ZINC HOT DIPPED GALVANIZED OR STAINLESS STEEL TYPE 304 OR 316.

CATEGORY:
 CASEMENT
 UNIT TYPE:
 UAWN, UAWN NF

UNSPECIFIED TOLERANCES

DECIMALS: XX ± .03 XXX ± .012	ANGLE DEG: ± .5
LINEAL: + .125 - .000	FAB LINEAL: ± NA

MATERIAL:
 NA

ITEM NO	REF NO	DESCRIPTION
2	-----	SHIM
1	-----	#8 X 3.000 WOOD SCREW

MARVIN RESEARCH & DEVELOPMENT

COLLECTION: ULTIMATE

DWG TYPE: INSTALLATION
 DESCRIPTION: INSTALLATION FL# 10323

CHK:	SIZE: B	CLASS: MISC	DWG NO: 00100230
APP:	SCALE: NA	DATE: 04/20/16	DWG BY: BORNEMAN, SKIP

SHEET: 1 OF 1

NOTICE - CONFIDENTIAL INFORMATION

The information in this document is privileged and strictly confidential. The information contained herein shall be used only by Marvin Windows and Doors employees and by those agents or suppliers granted official written permission. If the reader of this document is not the intended recipient, or the employee or agent of the intended recipient, please delete this document from all data storage devices, and destroy all hard copies. Any unauthorized dissemination, distribution, copying or other use of the information contained in this document is strictly prohibited.