

-FOR USE IN NON-HABITABLE SUNROOMS ONLY AS DESCRIBED IN AAMA/NPEA/NSA 2100.
-FOR USE AS A CATEGORY IV SUNROOM IF SYSTEM MEETS THERMAL PERFORMANCE AS DESCRIBED
IN SECTION 7 IN AAMA/NPEA/NSA 2100.

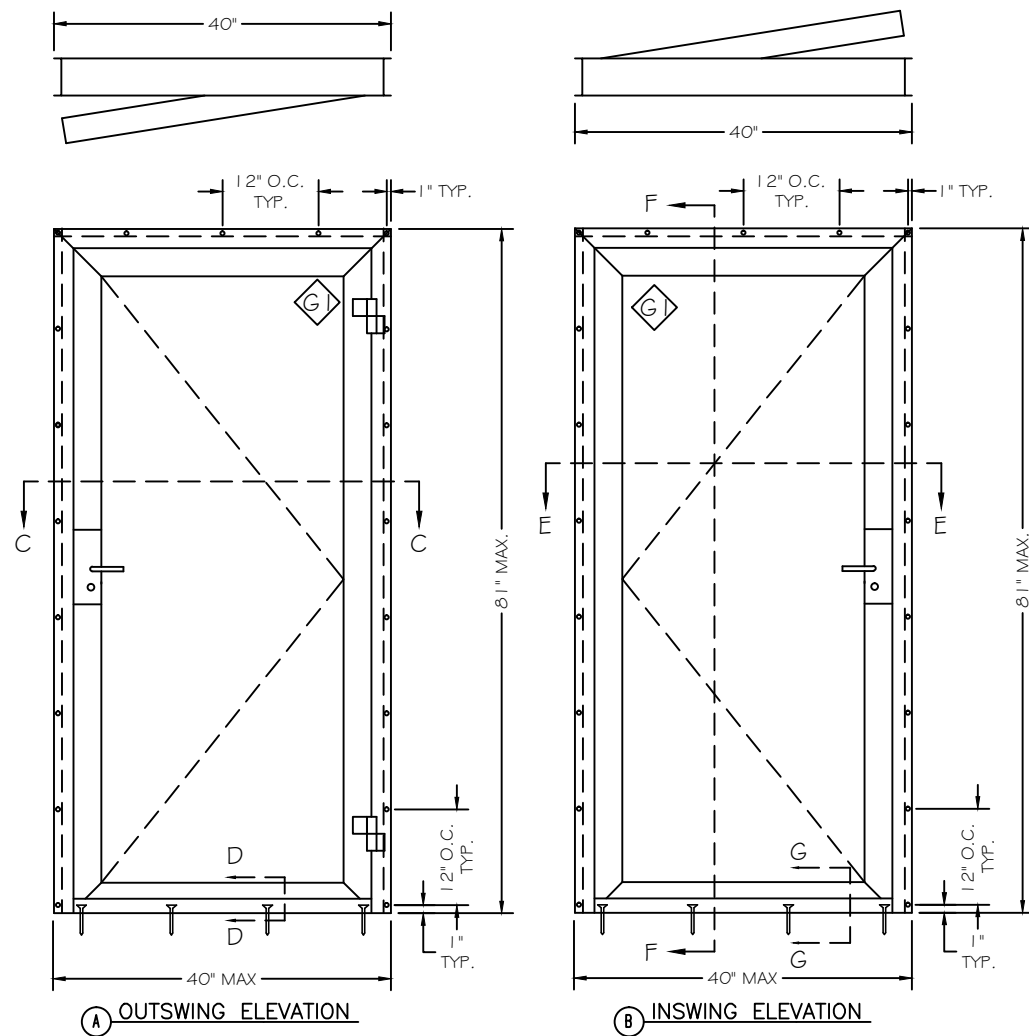

NOTE:
1. GLASS THICKNESS COMPLIES WITH ASTM E 1300 REQUIREMENTS.
2. SETTING BLOCK SHALL COMPLY WITH 24 I.F.3.3.1 OF THE FLORIDA BUILDING CODE SEVENTH EDITION (2020)

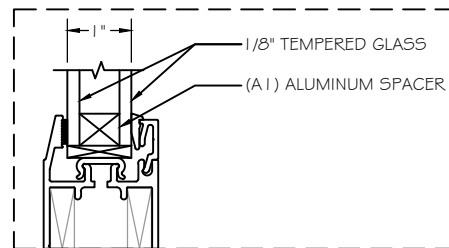

(G1) GLASS DETAIL
(NON IMPACT)

ALL ELEVATIONS ARE
LOOKING FROM THE OUTSIDE

OUTSWING DOOR
DESIGN PRESSURE CAPACITY
+/- 50.0 PSF A.S.D.

WATER PENETRATION PER ASTM E547: 7.5 PSF
AIR INFILTRATION PER ASTM E283

INSWING DOOR
DESIGN PRESSURE CAPACITY
+/- 40.0 PSF A.S.D.

WATER PENETRATION PER ASTM E547: 6.1 PSF
AIR INFILTRATION PER ASTM E283

NOTES:

1. THIS WINDOW IS APPROVED ONLY FOR INSTALLATION INTO SEPARATELY ENGINEERED FOUR SEASONS ALUMINUM SUNROOM. INSTALLATION INTO ANY OTHER SUBSTRATE SHALL REQUIRE A SEPARATE, SITE SPECIFIC DESIGN TO BE PREPARED BY A FL-REGISTERED PROFESSIONAL ENGINEER, AND SUBMITTED TO THE AUTHORITY HAVING JURISDICTION FOR APPROVAL.

2. ALL FASTENERS SHALL PENETRATE SHEET METAL WITH THREE FULL THREAD PITCHES.

REFER TO MFR. INFORMATION
& TEST DATA FOR MORE
INFORMATION ON EXTRUSIONS

[VISIT ECALC.IO/39504](https://www.ecalc.io/39504)

FOR HELPFUL RESOURCES, SITE
SPECIFIC JOB ORDERING & MORE
INFORMATION ABOUT THIS PRODUCT
& RELATED SERVICES

SCAN HERE:



(NON IMPACT APPROVED)
MAXIMUM ALLOWABLE DESIGN PRESSURES (A.S.D.):

OUTSWING :

+ 50 PSF
- 50 PSF

INSWING:

+ 40 PSF
- 40 PSF

DESIGN NOTES:

1. POSITIVE AND NEGATIVE DESIGN PRESSURES CALCULATED FOR USE WITH THIS SYSTEM SHALL BE DETERMINED BY OTHERS ON A JOB-SPECIFIC BASIS IN ACCORDANCE WITH THE GOVERNING CODE. SITE-SPECIFIC PRESSURE REQUIREMENTS AS DETERMINED IN ACCORDANCE WITH ASCE 7-16 AND CHAPTER 1609 OF THE FLORIDA BUILDING CODE SEVENTH EDITION (2020) SHALL BE LESS THAN OR EQUAL TO THE POSITIVE OR NEGATIVE DESIGN PRESSURE CAPACITY VALUES LISTED HEREIN FOR ANY ASSEMBLY AS SHOWN.

2. FOR USE IN SUNROOMS, SYSTEM TO BE USED AS AN AAMA 2100 CATEGORY I-IV ONLY & AS PER FBC 2002.6

3. THE HOST STRUCTURE IS NOT TO BE MODIFIED WITH THE ADDITION OF THIS UNIT.

GENERAL NOTES:

1. THIS SYSTEM DESCRIBED HEREIN HAS BEEN DESIGNED AND TESTED IN ACCORDANCE WITH THE FLORIDA BUILDING CODE SEVENTH EDITION (2020) PER AAMA/WDMA/CSA 101/I.S.2/A440-05 FOR USE OUTSIDE THE HIGH VELOCITY HURRICANE ZONE (HVHZ).
2. DESIGN PRESSURES NOTED HEREIN ARE BASED ON MAXIMUM TESTED PRESSURES DIVIDED BY A 1.5 SAFETY FACTOR.
3. NO 33-1/3% INCREASE IN ALLOWABLE STRESS HAS BEEN USED IN THE DESIGN OF THIS SYSTEM. WIND LOAD DURATION FACTOR Cd= 1.6 HAS BEEN USED FOR WOOD ANCHOR DESIGN.
4. THE ARCHITECT/ENGINEER OF RECORD FOR THE PROJECT SUPERSTRUCTURE WITH WHICH THIS DESIGN IS USED SHALL BE RESPONSIBLE FOR THE INTEGRITY OF ALL SUPPORTING SURFACES TO THIS DESIGN WHICH SHALL BE COORDINATED BY THE PERMITTING CONTRACTOR.
5. THE SYSTEM DETAILED HEREIN IS GENERIC AND DOES NOT PROVIDE INFORMATION FOR A SPECIFIC SITE. FOR SITE CONDITIONS DIFFERENT FROM THE CONDITIONS DETAILED HEREIN, A LICENSED ENGINEER OR REGISTERED ARCHITECT SHALL PREPARE SITE SPECIFIC DOCUMENTS FOR USE IN CONJUNCTION WITH THIS DOCUMENT.
6. ALL ALUMINUM EXTRUSION SHALL BE EQUIVALENT TO OR GREATER THAN THE MINIMUM ALLOYS AND TEMPERAS AS SPECIFIED HEREIN.
7. ALL FASTENERS TO BE SAE GRADE 5 STEEL UNLESS NOTED OTHERWISE. FASTENERS SHALL BE CADMIUM-PLATED OR OTHERWISE CORROSION-RESISTANT MATERIAL PER THE ALUMINUM ASSOCIATION, INC., & ANY APPLICABLE FEDERAL, STATE, AND/OR LOCAL CODES.
8. THE CONTRACTOR IS RESPONSIBLE TO INSULATE ALL MEMBERS FROM DISSIMILAR MATERIALS TO PREVENT ELECTROLYSIS.
9. ENGINEER SEAL AFFIXED HERE TO VALIDATES STRUCTURAL DESIGN AS SHOWN ONLY. USE OF THIS SPECIFICATION BY CONTRACTOR, et. al. INDEMNIFIES & SAVES HARMLESS THIS ENGINEER FOR ALL COST & DAMAGES INCLUDING LEGAL FEES & APPELLATE FEES RESULTING FROM MATERIAL FABRICATION, SYSTEM ERECTION, & CONSTRUCTION PRACTICES BEYOND THAT WHICH IS CALLED FOR BY LOCAL, STATE, & FEDERAL CODES & FROM DEVIATIONS OF THIS PLAN.
10. EXCEPT AS EXPRESSLY PROVIDED HEREIN, NO ADDITIONAL CERTIFICATIONS OR AFFIRMATIONS ARE INTENDED.
11. ALTERATIONS, ADDITIONS, OR OTHER MARKINGS TO THIS DOCUMENT ARE NOT PERMITTED AND INVALIDATE THIS CERTIFICATION.
12. PRODUCT SHALL BE PERMANENTLY LABELED WITH A MINIMUM OF ONE LABEL PER WINDOW CONTAINING THE FOLLOWING:
FOUR SEASONS SOLAR PRODUCTS
HOLBROOK, NY
AAMA/WDMA/CSA 101/I.S.2/A440-05
PRODUCT APPROVAL NUMBER
13. THE SYSTEM DETAILED HEREIN HAS BEEN TESTED PER THE TEST STANDARD(S) LISTED ABOVE AS REFERENCED IN TEST REPORT(S) #73507.02-301-44 AND 73506.02-301-44 BY ARCHITECTURAL TESTING, INC.

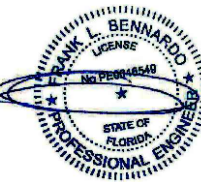

06/08/2021

FL#12155.2



160 SW 12th AVE, SUITE 106
DEERFIELD BEACH, FL 33442
(954) 354-0660 | (866) 396-9999
TEAM@ENGINEERINGEXPRESS.COM
ENGINEERINGEXPRESS.COM

FOUR SEASONS SOLAR PRODUCTS, LLC.
5005 VETERANS MEMORIAL HIGHWAY

5005 VETERANS MEMORIAL HIGHWAY

HOLBROOK, NY 11741

PH: (631) 563-4000

SUNROOM ALUMINUM SINGLE IN-SWING DOOR
FLORIDA PRODUCT APPROVAL

REMARKS	DRWN	CHRD	DATE
INIT ISSUE	JAC	FLB	02/15/17
REV (2017 FBC)	RWN	FLB	08/14/17
REV (2020 FBC)	TAE	AJP	04/24/21
-	-	-	-
-	-	-	-

COPYRIGHT ENGINEERING EXPRESS®

21-39504

SCALE: NTS UNLESS NOTED

1

2

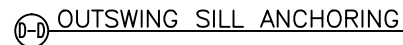

INSWING SILL ANCHORING

(F-F) HORIZONTAL SECTION

(C-C) HORIZONTAL SECTION

(E-E) HORIZONTAL IN-SWING SECTION

OF 2