

Doors tested per ANSI/DASMA 108 for static air pressure

Door Width	Design Load
Up to 16' - 0"	+ 23.3 - 28.0

Scott A. Brown P.E.
F.P.E. #65940
698 Timber Creek Road
Dixon Illinois 61021

Scale: None	Drawn by: R. Frey	Checked by: G. Wedekind	Date: 11/14/18
Rev. A	New release for production.	ECO: 8127.01	Date: 11/14/18
Rev.	Description	ECO	Date



Title: Spec, Wind Load BuildMark / TradeMark		
No. P-2368	Sheet 1 of 3	Rev A

Qty. of Center Stiles			
Door Width	Colonial Spacing	Ranch Spacing	Carriage House Spacing
8'	1	1	1
9'	1	1	1
10'	2	1	1
11'	2	1	1
12'	3	2	2
13'	3	2	2
14'	4	2	2
15'	4	2	2
16'	3	3	3

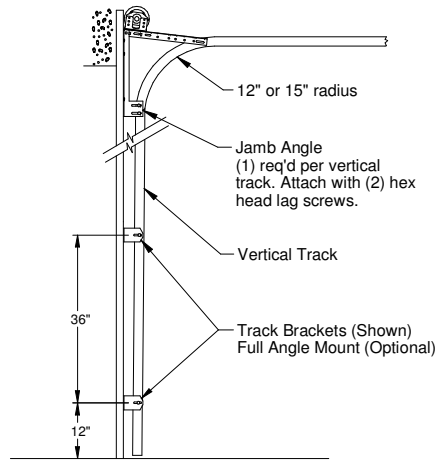

Typical Track Installation
Normal headroom track shown, low headroom, lift clearance and vertical lift track available

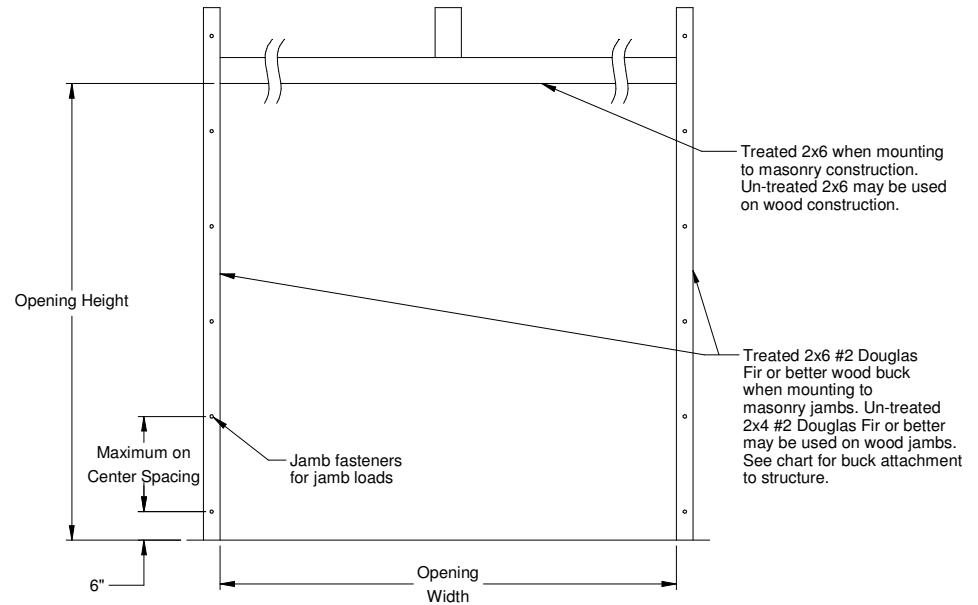

Jamb Attachment Notes:

1. Maximum Positive Load per Jamb = (16'-0" x 23.3 PSF) / 2 = 187 lbs. per foot.
2. Maximum Negative Load per Jamb = (16'-0" x -28.0 PSF) / 2 = 224 lbs. per foot.
3. Design of the supporting structure shall be the sole responsibility of the building designer and shall be designed for the jamb loads listed in notes 1 and 2.
4. Alternate jamb attachments may be used if approved by a registered Professional Engineer.
5. DASMA Technical Data Sheet TDS-161 may be used for alternate jamb attachments.
6. 3/8" diameter lag screws required 1/16" pilot hole and 1-1/2" minimum required distance.

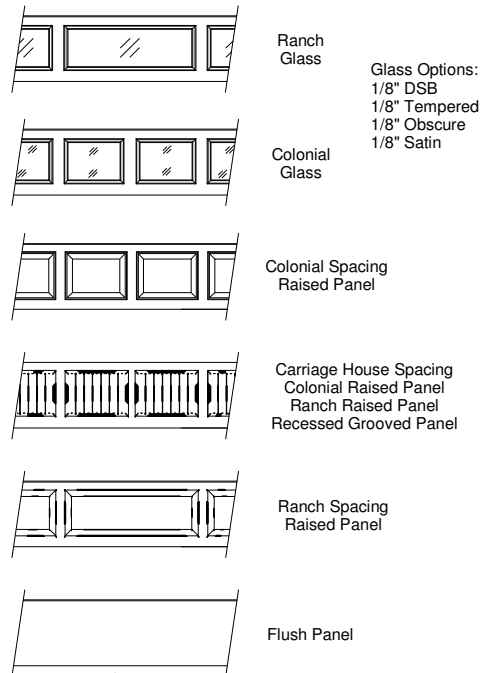

Panel Options Exterior View

2x6 Attachment to Structure						
Structure Type	Fastener Type	Minimum Embedment	Minimum Edge Distance	Minimum on Center Spacing	Maximum on Center Spacing	Allowable Tension Load
2500 PSI Min. Concrete	1/4" Tapcon+ (Plus) with 1-1/8" OD Washer	2"	2.5	6"	24"	526
Southern Pine	3/8" x 3" Lag with 1-1/8" OD Washer	1.50"	1.50"	1.50"	24"	655
Spruce Pine Fir	3/8" x 3" LAG with 1-1/8" OD Washer	1.50"	1.50"	1.50"	24"	482

Scott A. Brown P.E.
F.P.E. #65940
698 Timber Creek Road
Dixon Illinois 61021

Scale: None
Drawn by: R. Frey
Checked by: G. Wedekind
Date: 11/05/18
ECO: 8127.01



1101 East River Road
Dixon, IL 61021

Title: Spec, Wind Load
BuildMark / TradeMark

No. P-2368 Sheet 2 Rev A

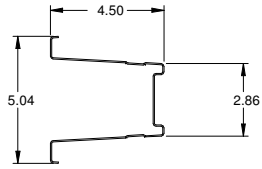

Steel Box Strut Detail
 20 Ga. (.035" Min.) Galvanized
 High Tensile Steel
 80 KSI Minimum Yield

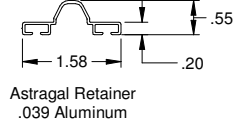

Astragal Retainer
 .039 Aluminum

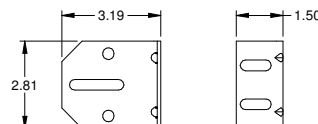

3" Track Bracket
 .116 Galv. Steel

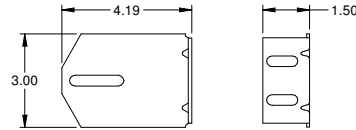

4" Track Bracket
 .116 Galv. Steel

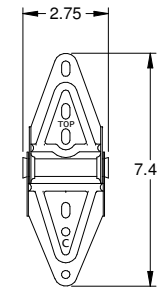

Center Hinge
 .070 Galv. Steel

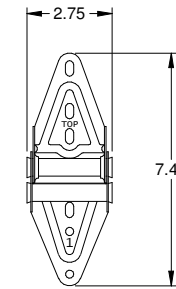

Edge Hinge
 .086 Galv. Steel

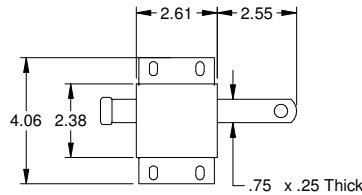

Slide Lock Case
 .086 Galv. Steel
Optional Interior Lock Detail

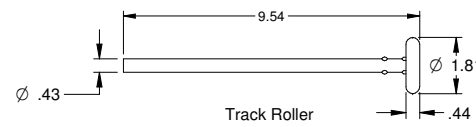

Track Roller

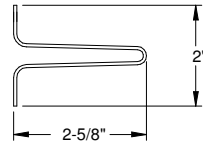

Steel U-bar Detail
 18 Ga. (.049" Min.) Galvanized
 High Tensile Steel
 80 KSI Minimum Yield

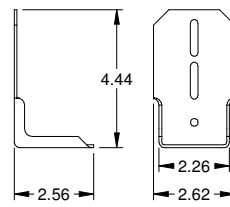

Top Fixture
 .086 Galv. Steel

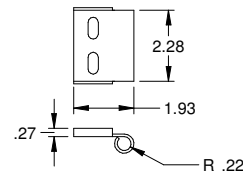

Top Fixture Roller Carrier
 .086 Galv. Steel
 Attached to top fixture with
 (2) track bolts and whiz nuts

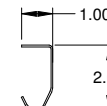

Track
 .055 Galv. Steel

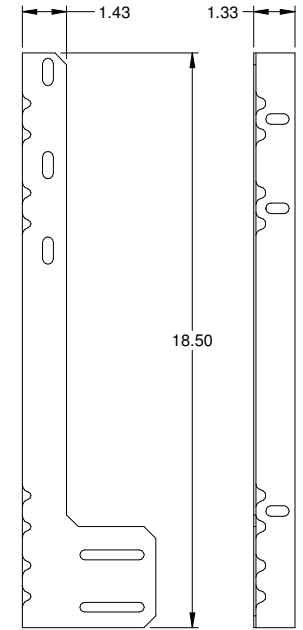

Jamb Angle
 .078 Galv. Steel

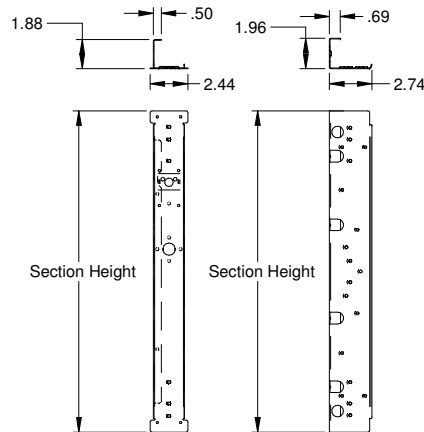

Center Stile
 .034 Galv. Steel

End Stile
 .043 Galv. Steel

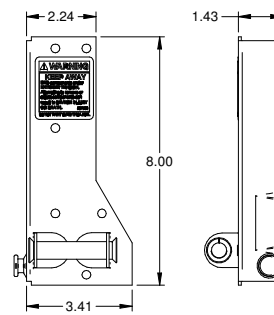

Corner Bracket
 .086 Galv. Steel

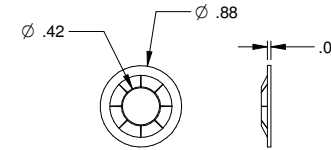

Retaining Nut

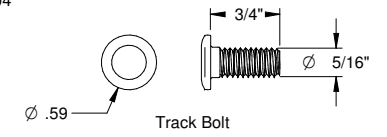

Track Bolt

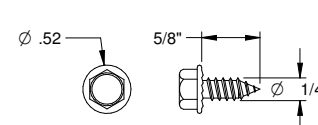

Sheet Metal Screw

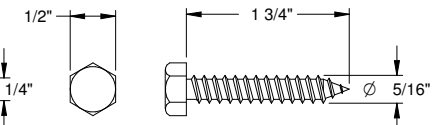

Hex Head Lag Screw

Scott A. Brown P.E.
 F.P.E. #65940
 698 Timber Creek Road
 Dixon Illinois 61021

Scale: None
Drawn by: R. Frey
Checked by: G. Wedekind
Date: 11/05/18
ECO: 8127.01



1101 East River Road
 Dixon, IL 61021

Title: Spec, Wind Load
 BuildMark / TradeMark

No. P-2368	Sheet 3	Rev A
------------	---------	-------