

Door Width	Design Load
Up to 16' - 0"	+ 29.7 - 33.1

Doors tested per ANSI/DASMA 108 for static air pressure

Scott A. Brown P.E.  
F.P.E. #65940  
698 Timber Creek Road  
Dixon Illinois 61021

Scale: None	Drawn by: R. Frey	Checked by: G. Wedekind	Date: 12/06/18
Rev. A	New release for production.	ECO: 8127.01	Date: 12/06/18
Rev.	Description	ECO	Date



Title: Spec, Wind Load BuildMark / TradeMark	
No. P-2369	Sheet 1 of 3
Rev. A	

Qty. of Center Stiles			
Door Width	Colonial Spacing	Ranch Spacing	Carriage House Spacing
8'	3	3	3
9'	3	3	3
10'	4	4	3
11'	4	4	3
12'	3	2	3
13'	3	2	3
14'	4	3	3
15'	4	3	3
16'	5	5	5

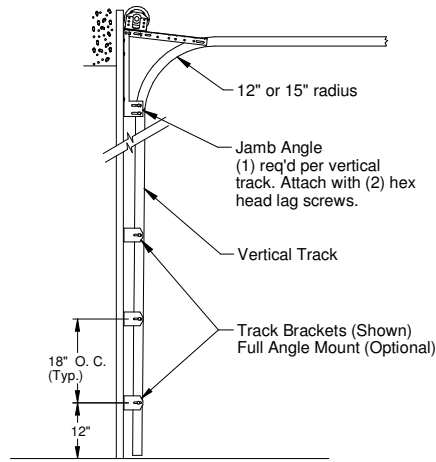

**Typical Track Installation**  
Normal headroom track shown, low headroom, lift clearance and vertical lift track available

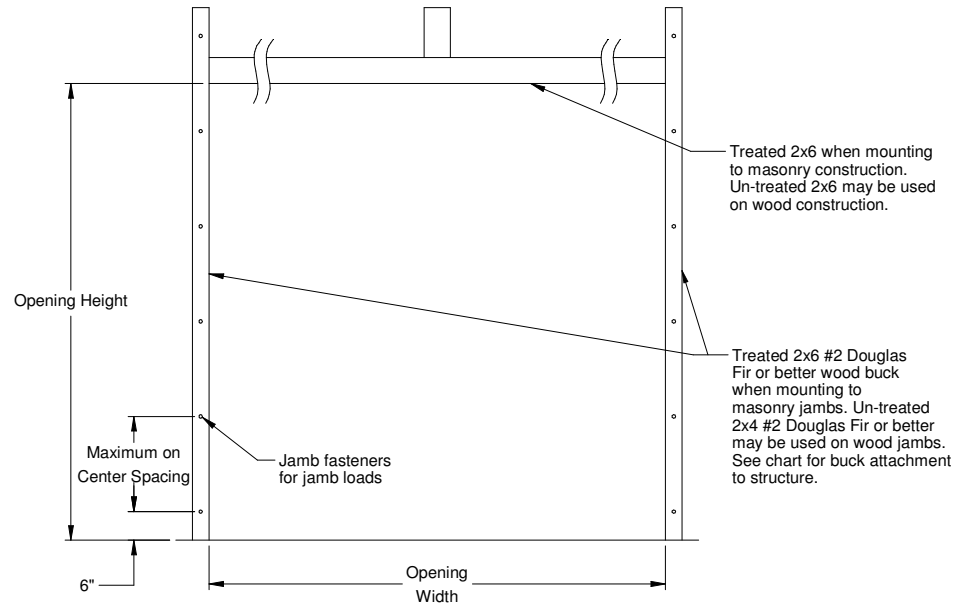

**Jamb Attachment Notes:**

1. Maximum Positive Load per Jamb = (16'-0" x 29.7 PSF) / 2 = 238 lbs. per foot.
2. Maximum Negative Load per Jamb = (16'-0" x -33.1 PSF) / 2 = 265 lbs. per foot.
3. Design of the supporting structure shall be the sole responsibility of the building designer and shall be designed for the jamb loads listed in notes 1 and 2.
4. Alternate jamb attachments may be used if approved by a registered Professional Engineer.
5. DASMA Technical Data Sheet TDS-161 may be used for alternate jamb attachments.
6. 3/8" diameter lag screws required 1/16" pilot hole and 1-1/2" minimum required distance.

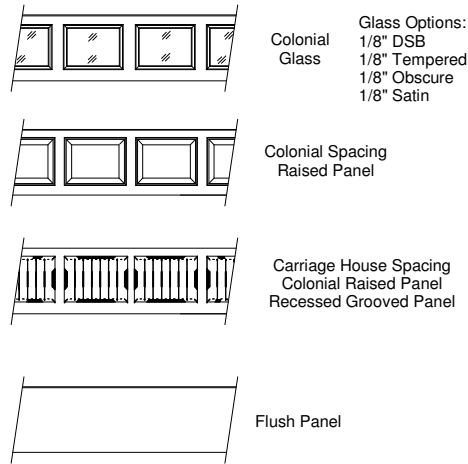

**Panel Options Exterior View**

2x6 Attachment to Structure						
Structure Type	Fastener Type	Minimum Embedment	Minimum Edge Distance	Minimum on Center Spacing	Maximum on Center Spacing	Allowable Tension Load
2500 PSI Min. Concrete	1/4" Tapcon+ (Plus) with 1-1/8" OD Washer	2"	2.5"	6"	24"	526
Southern Pine	3/8" x 3" Lag with 1-1/8" OD Washer	1.50"	1.50"	1.50"	24"	655
Spruce Pine Fir	3/8" x 3" LAG with 1-1/8" OD Washer	1.50"	1.50"	1.50"	24"	482

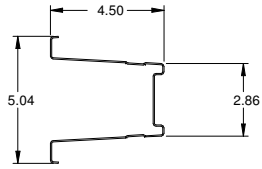

**Steel Box Strut Detail**  
 20 Ga. (.035" Min.) Galvanized  
 High Tensile Steel  
 80 KSI Minimum Yield

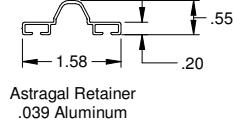

**Astragal Retainer**  
 .039 Aluminum

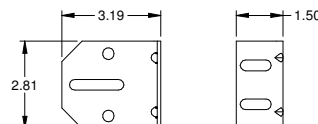

**3" Track Bracket**  
 .116 Galv. Steel

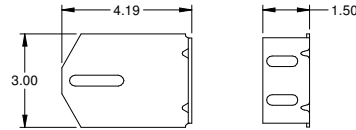

**4" Track Bracket**  
 .116 Galv. Steel

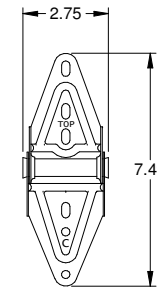

**Center Hinge**  
 .070 Galv. Steel

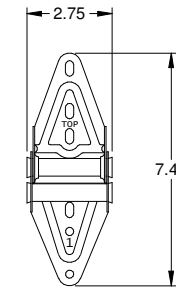

**Edge Hinge**  
 .086 Galv. Steel

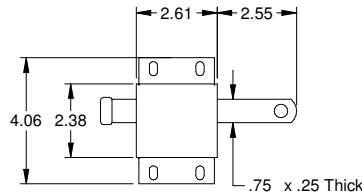

**Slide Lock Case**  
 .086 Galv. Steel  
**Optional Interior Lock Detail**

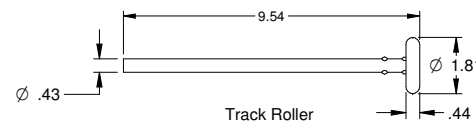

**Track Roller**

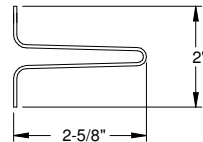

**Steel U-bar Detail**  
 18 Ga. (.049" Min.) Galvanized  
 High Tensile Steel  
 80 KSI Minimum Yield

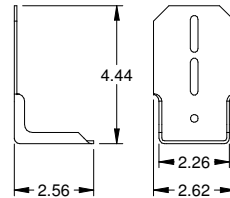

**Top Fixture**  
 .086 Galv. Steel

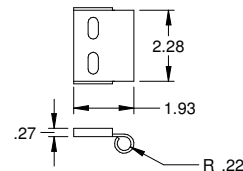

**Top Fixture Roller Carrier**  
 .086 Galv. Steel  
 Attached to top fixture with  
 (2) track bolts and whiz nuts

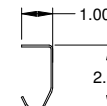

**Track**  
 .055 Galv. Steel

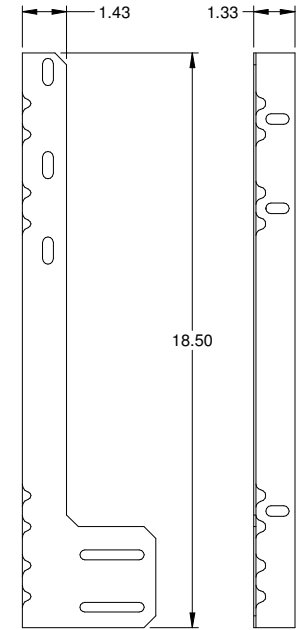

**Jamb Angle**  
 .078 Galv. Steel

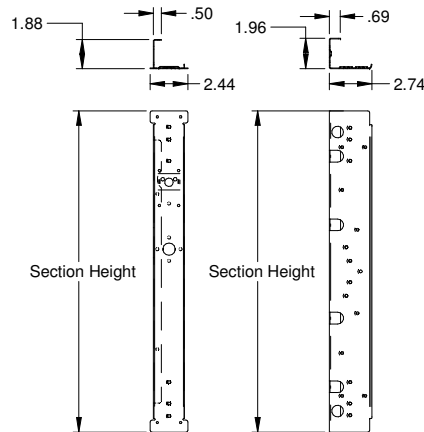

**Center Stile**  
 .034 Galv. Steel

**End Stile**  
 .043 Galv. Steel

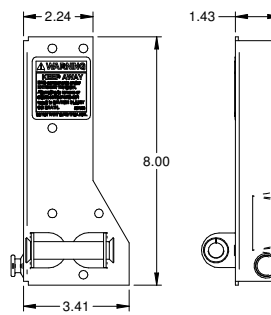

**Corner Bracket**  
 .086 Galv. Steel

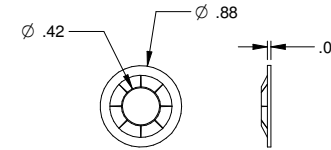

**Retaining Nut**

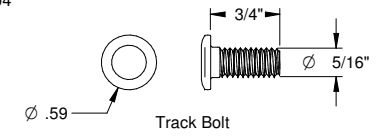

**Track Bolt**

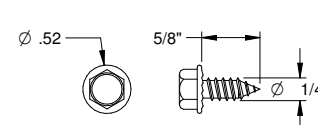

**Sheet Metal Screw**

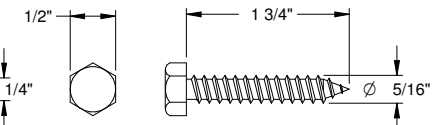

**Hex Head Lag Screw**

Scott A. Brown P.E.  
 F.P.E. #65940  
 698 Timber Creek Road  
 Dixon Illinois 61021

Scale: None
Drawn by: R. Frey
Checked by: G. Wedekind
Date: 12/06/18
ECO: 8127.01



Title: Spec, Wind Load  
 BuildMark / TradeMark

No. P-2369	Sheet 3	Rev A
------------	---------	-------