

Scott A. Brown P.E.
 F.P.E #65940
 698 Timber Creek Road
 Dixon Illinois 61021

REV.	DESCRIPTION	ECO	DATE	ECO: 6338.02
B	1) WAS RICHARD A. BAUMANN, P.E., 2) UPDATED JAMB ATTACHMENTS	7802.01	09/25/17	
A	RELEASE FOR PRODUCTION	6338.02	08/02/12	

SCALE: NONE
 DRAWN BY: G. WEDEKIND
 CHECKED BY: G. WEDEKIND
 DATE: 08/02/12

RAYNOR
 1101 EAST RIVER ROAD
 DIXON, IL 61021

TITLE: SPEC, WINDLOAD TC200

NO. P-2413

SHEET 1 OF 4	REV B
--------------	-------

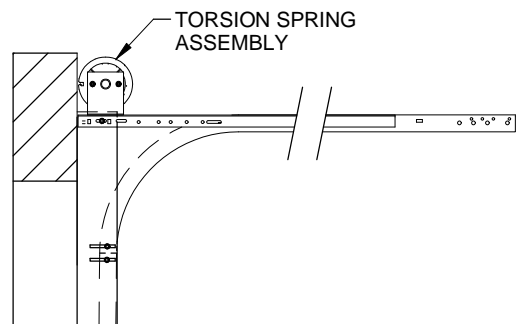

NORMAL HEADROOM TRACK
2" TRACK ANGLE MOUNT SHOWN
2" TRACK BRACKET MOUNT AVAILABLE
3" TRACK ANGLE MOUNT AVAILABLE

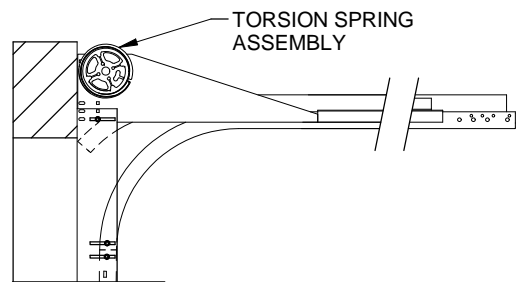

FRONT MOUNT LOW HEADROOM TRACK
2" TRACK ANGLE MOUNT SHOWN
2" TRACK BRACKET MOUNT AVAILABLE
3" TRACK ANGLE MOUNT AVAILABLE

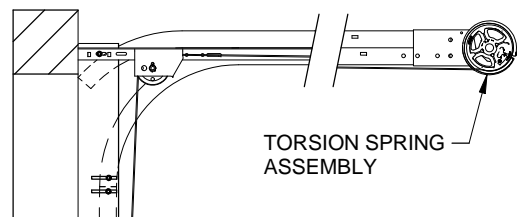

REAR MOUNT LOW HEADROOM TRACK
2" TRACK ANGLE MOUNT SHOWN
2" TRACK BRACKET MOUNT AVAILABLE
3" TRACK ANGLE MOUNT AVAILABLE

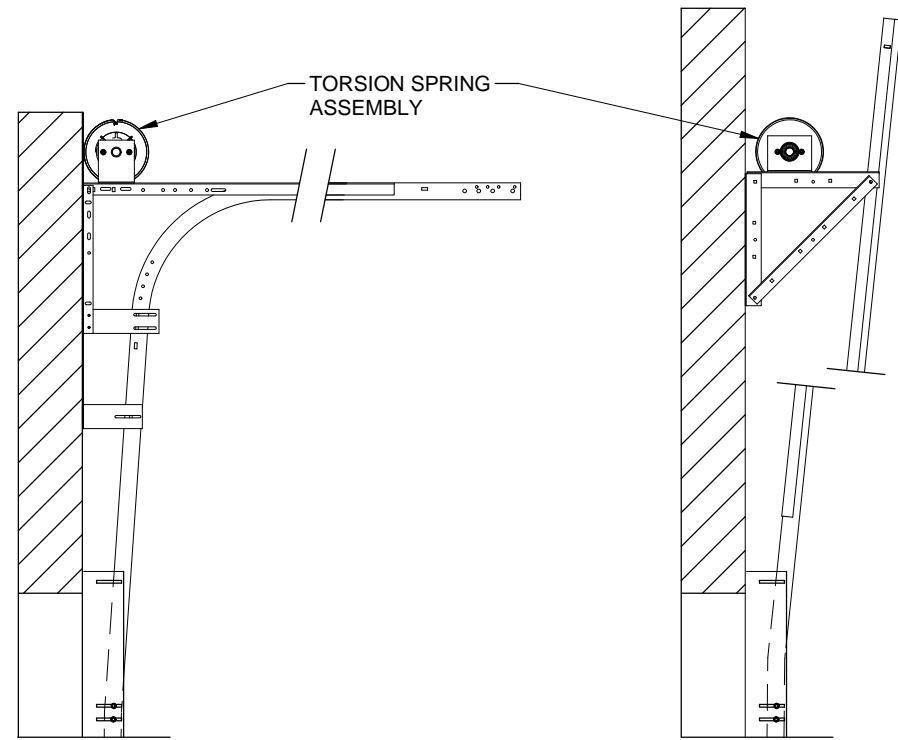

LIFT CLEARANCE TRACK
2" TRACK ANGLE MOUNT SHOWN
2" TRACK BRACKET MOUNT AVAILABLE
3" TRACK ANGLE MOUNT AVAILABLE

VERTICAL LIFT TRACK
2" TRACK ANGLE MOUNT SHOWN
2" TRACK BRACKET MOUNT AVAILABLE
3" TRACK ANGLE MOUNT AVAILABLE

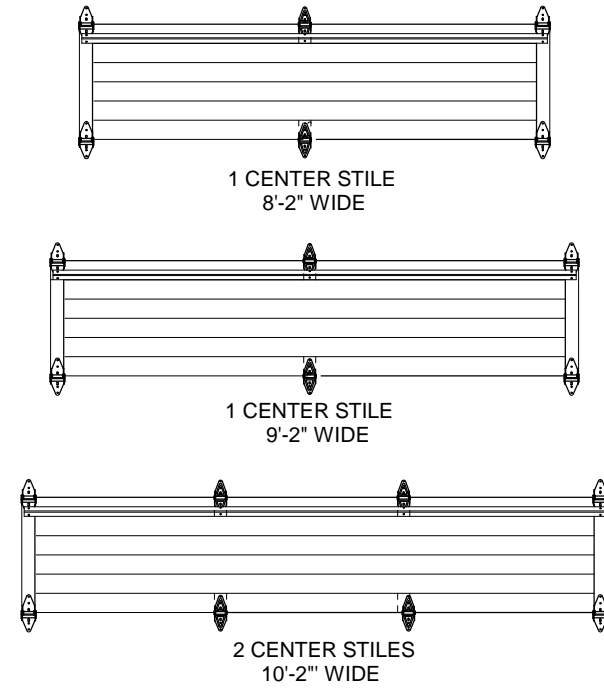

HINGE ROW LAYOUT
INTERIOR VIEW

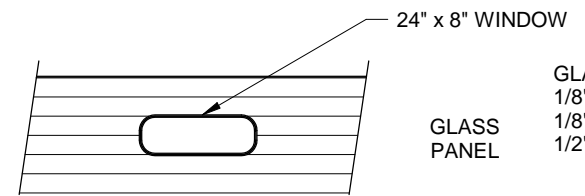

GLASS OPTIONS:
1/8" DSB
1/8" ACRYLIC
1/2" INSULATED GLASS

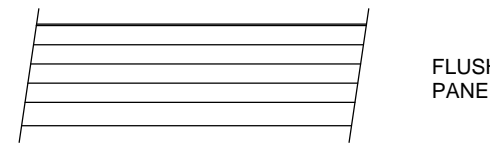

PANEL OPTIONS
EXTERIOR VIEW

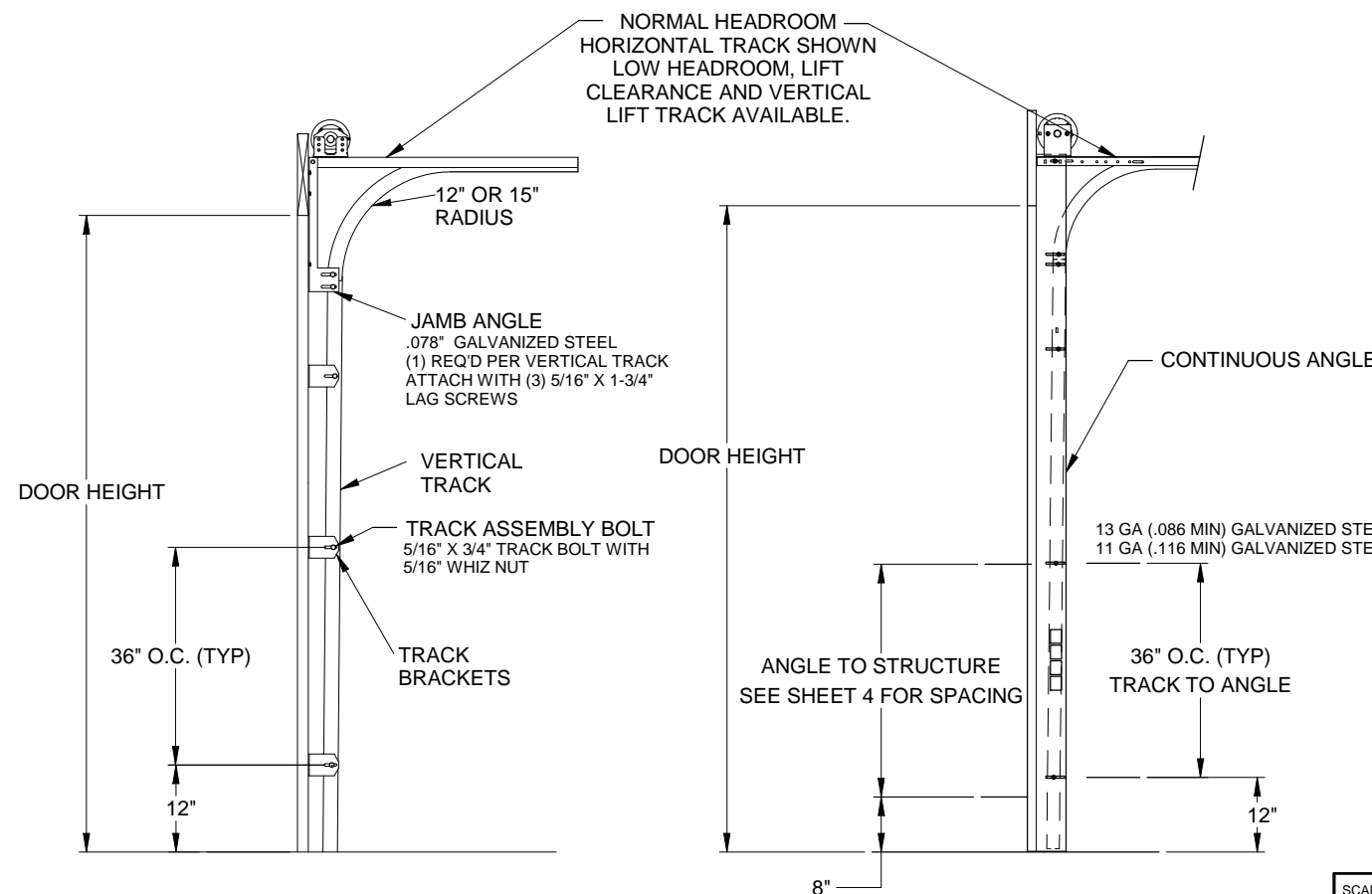

TYPICAL TRACK INSTALLATION
BRACKET MOUNT
WOOD JAMBS

TYPICAL TRACK INSTALLATION
ANGLE MOUNT
WOOD, STEEL OR MASONRY
JAMBS

SCALE: NONE
DRAWN BY: G. WEDEKIND
CHECKED BY: G. WEDEKIND
DATE: 08/02/12
ECO: 6338.02



TITLE: SPEC. WINDLOAD
TC200

NO. P-2413

SHEET
2 OF 4

REV
B

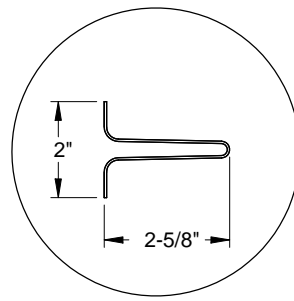

STEEL U-BAR DETAIL
18 GA. (.049" MIN) GALVANIZED
HIGH TENSILE STEEL 80 KSI MINIMUM YIELD

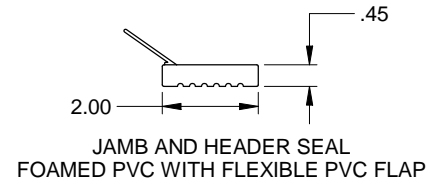

JAMB AND HEADER SEAL
FOAMED PVC WITH FLEXIBLE PVC FLAP

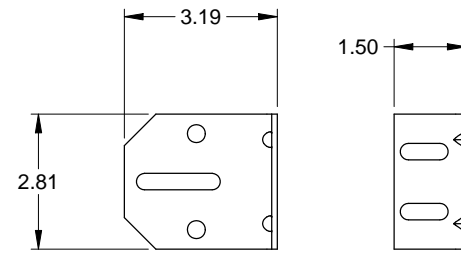

3" TRACK BRACKET
.116 GALV. STEEL

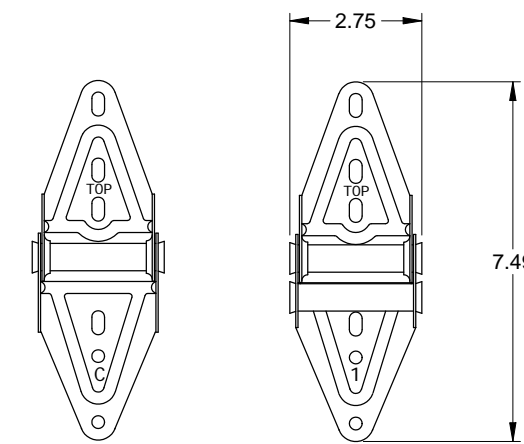

CENTER HINGE
.045 GALV. STEEL

EDGE HINGE
.086 GALV. STEEL

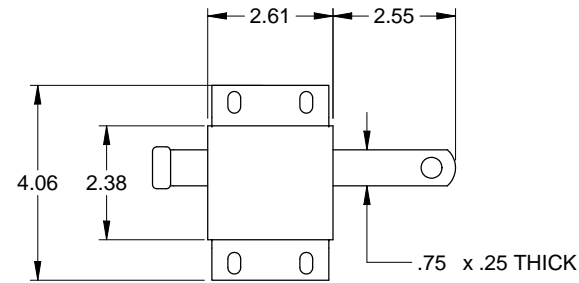

SLIDE LOCK
CASE .086 GALV. STEEL

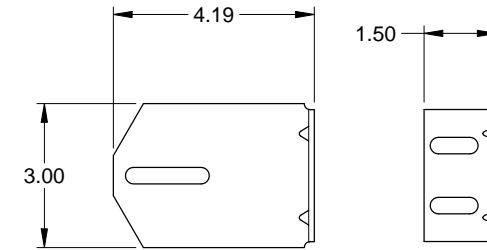

4" TRACK BRACKET
.116 GALV. STEEL

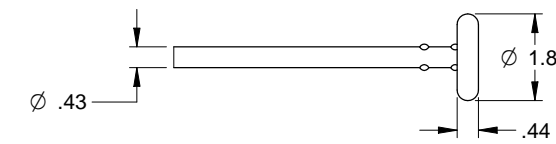

TRACK ROLLER

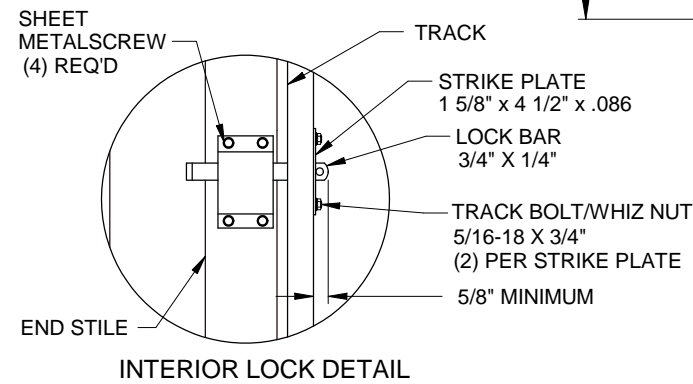

INTERIOR LOCK DETAIL

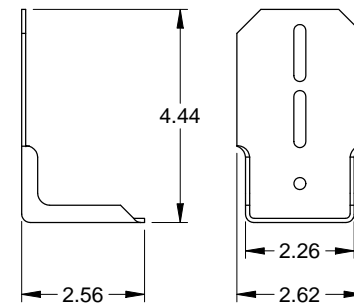
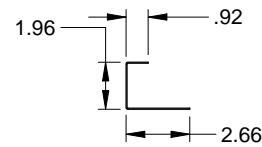

TOP FIXTURE
.086 GALV. STEEL

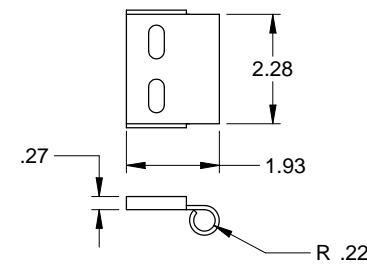

TOP ROLLER CARRIER
.086 GALV. STEEL
ATTACHED TO TOP FIXTURE WITH
(2) TRACK BOLTS AND WHIZ NUTS

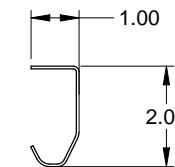

TRACK
.055 GALV. STEEL

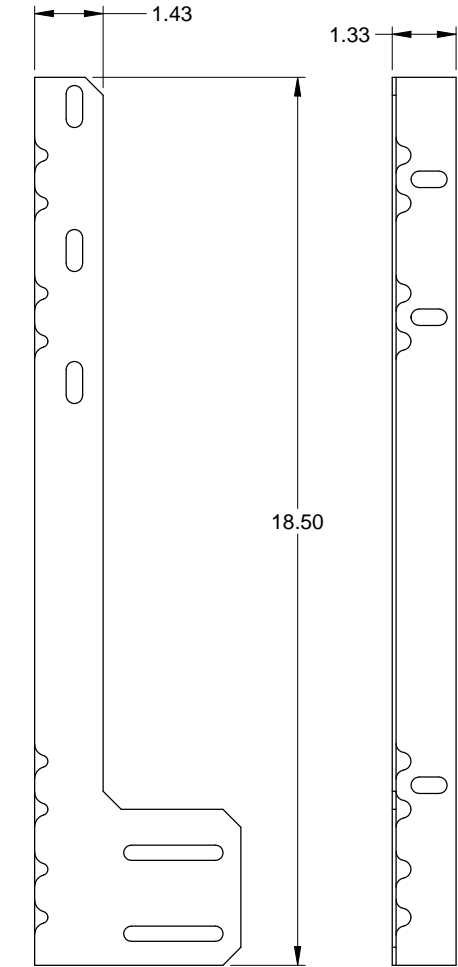

JAMB ANGLE
.078 GALV. STEEL

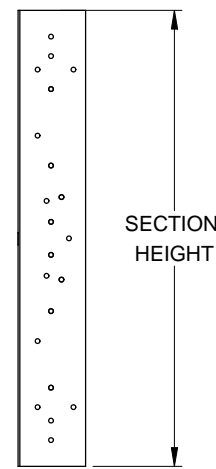

END STILE
.043 GALV. STEEL

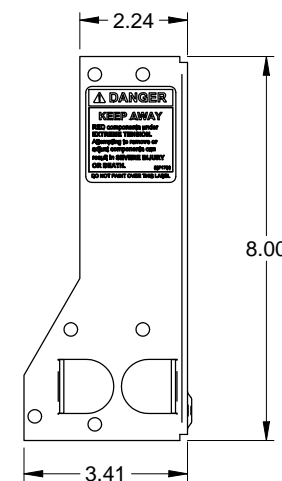

CORNER BRACKET
.086 GALV. STEEL

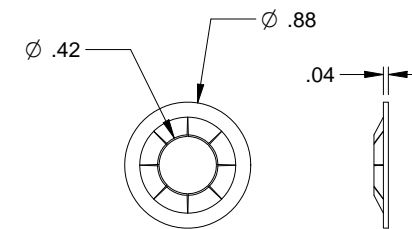
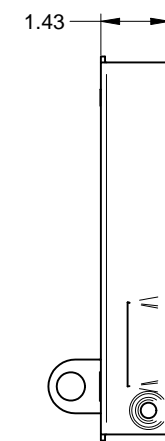

RETAINING NUT

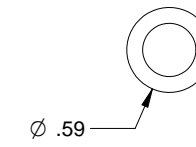

TRACK BOLT

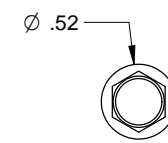

SHEET METAL SCREW

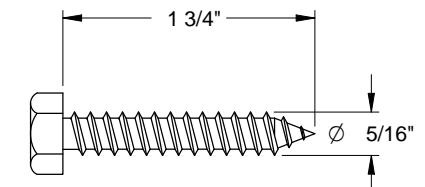
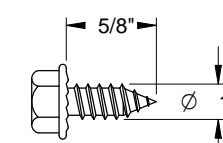

HEX HEAD LAG SCREW

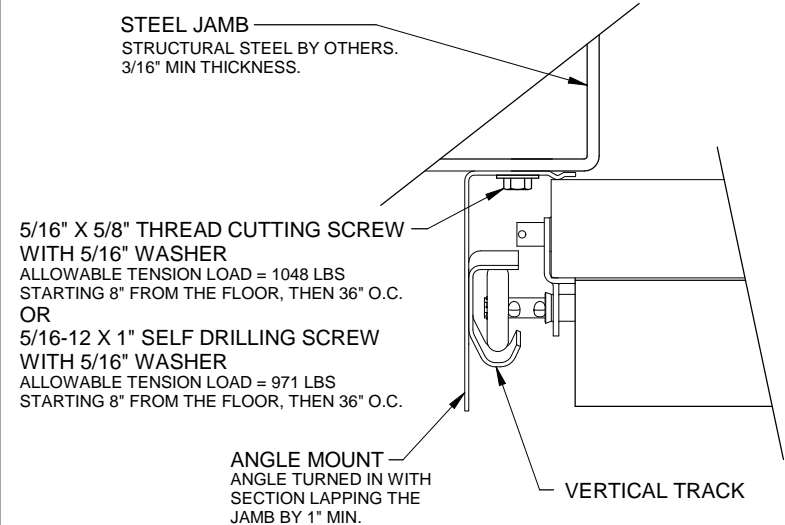

TRACK ASSEMBLY ATTACHMENT TO STEEL JAMB
2\"/>

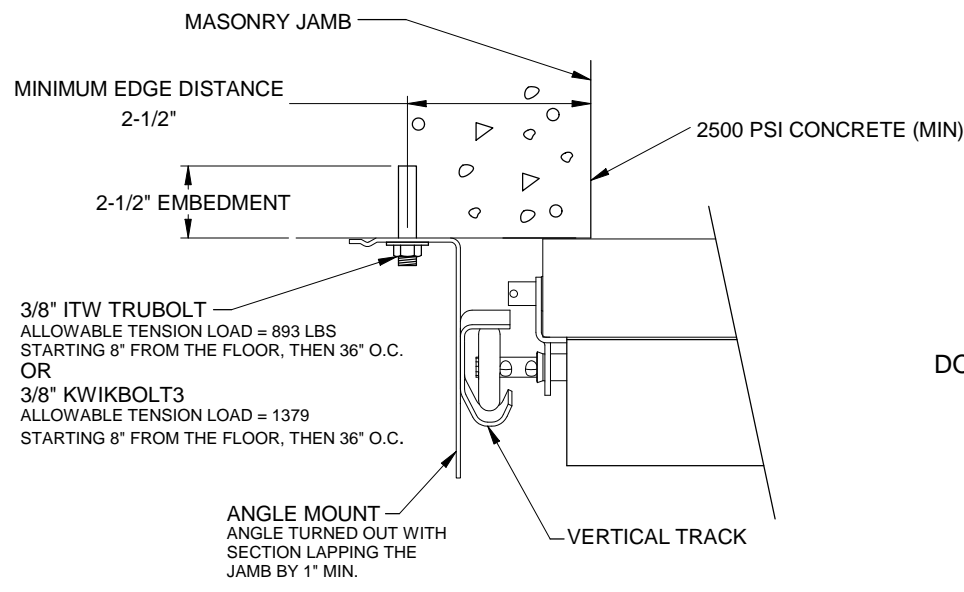

TRACK ASSEMBLY ATTACHMENT TO MASONRY JAMB
2\"/>

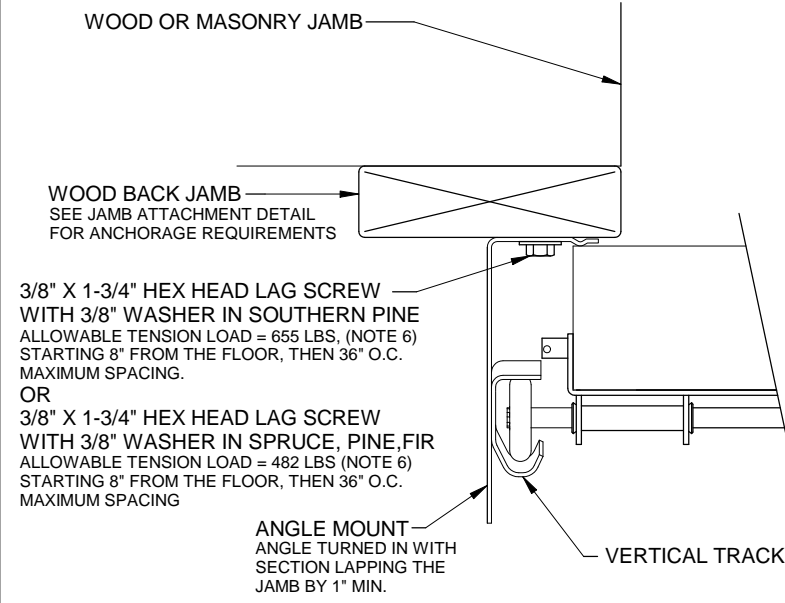

TRACK ASSEMBLY ATTACHMENT TO WOOD BACK JAMB
2\"/>

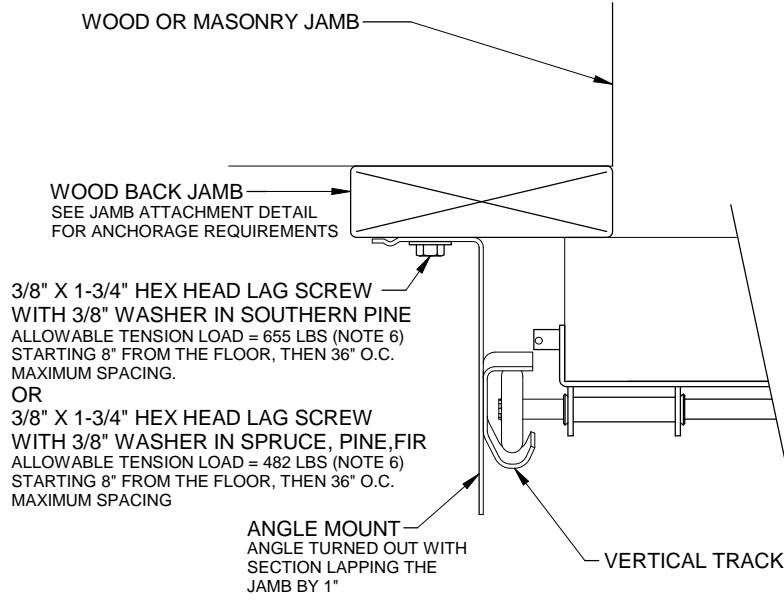

TRACK ASSEMBLY ATTACHMENT TO WOOD BACK JAMB
2\"/>

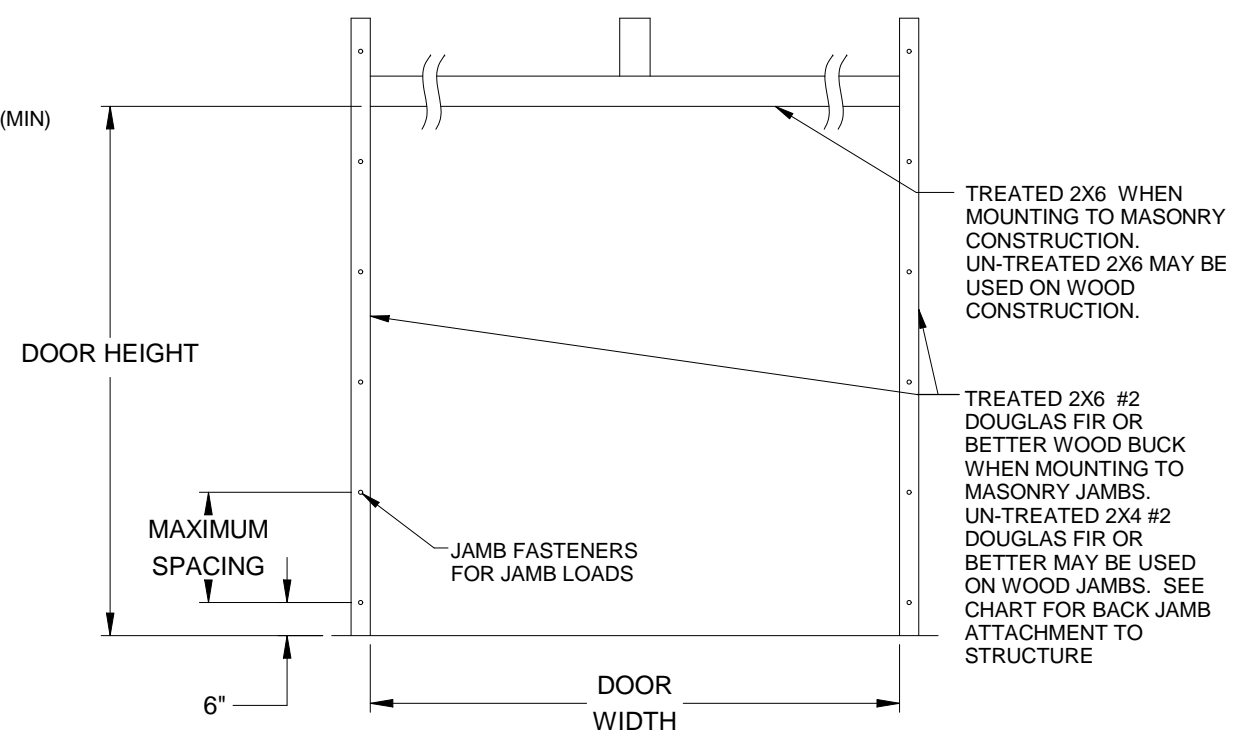

JAMB ATTACHMENT

JAMB ATTACHMENT NOTES

1. MAXIMUM POSITIVE LOAD PER JAMB = $(10' \cdot 2" \times 30.0 \text{ PSF}) / 2 = 153 \text{ LBS PER FOOT}$
2. MAXIMUM NEGATIVE LOAD PER JAMB = $(10' \cdot 2" \times -34.0 \text{ PSF}) / 2 = 173 \text{ LBS PER FOOT}$.
3. DESIGN OF THE SUPPORTING STRUCTURE SHALL BE THE SOLE RESPONSIBILITY OF THE BUILDING DESIGNER AND SHALL BE DESIGNED FOR THE JAMB LOADS LISTED IN NOTES 1 AND 2.
4. ALTERNATE JAMB ATTACHMENTS MAY BE USED IF APPROVED BY A REGISTERED PROFESSIONAL ENGINEER.
5. DASMA TECHNICAL DATA SHEET TDS-161 MAY BE USED FOR ALTERNATE JAMB ATTACHMENTS.
6. 3/8" DIAMETER LAG SCREWS REQUIRE 1/16" DIAMETER PILOT HOLE AND 1-1/2" MINIMUM EDGE DISTANCE.

2X6 ATTACHMENT TO STRUCTURE						
STRUCTURE TYPE	FASTENER TYPE	MINIMUM EMBEDMENT	MINIMUM EDGE DISTANCE	MINIMUM ON CENTER SPACING	DIMENSION A (MAXIMUM ON CENTER SPACING)	ALLOWABLE TENSION LOAD
2500 PSI MIN. CONCRETE	1/4" TAPCON+ (PLUS) WITH 1-1/8" OD WASHER	2"	2.5"	6"	24"	691
SOUTHERN PINE	3/8" X 3" LAG WITH 1-1/8" OD WASHER	1.50"	1.50"	1.50"	24"	620
SPRUCE PINE FIR	3/8" X 3" LAG WITH 1-1/8" OD WASHER	1.50"	1.50"	1.50"	24"	482

Scott A. Brown P.E.
F.P.E #65940
698 Timber Creek Road
Dixon Illinois 61021

SCALE: NONE
DRAWN BY: G. WEDEKIND
CHECKED BY: G. WEDEKIND
DATE: 08/02/12
ECO: 6338.02



TITLE: SPEC, WINDLOAD TC200
NO. P-2413
SHEET 4 OF 4
REV B