

Scott A. Brown P.E.
 F.P.E #65940
 698 Timber Creek Road
 Dixon Illinois 61021

REV.	DESCRIPTION	ECO	DATE	ECO: 6338.03
B	1) WAS RICHARD A. BAUMANN, P.E., 2) UPDATED JAMB ATTACHMENTS	7802.01	09/25/17	
A	RELEASED FOR PRODUCTION	6338.03	10/22/12	

SCALE: NONE
 DRAWN BY: G. WEDEKIND
 CHECKED BY: G. WEDEKIND
 DATE: 10/22/12
 ECO: 6338.03



1101 EAST RIVER ROAD
 DIXON, IL 61021

TITLE:
 SPEC, WINDLOAD
 SHOWCASE, MASTERPIECE

NO. P-2418

SHEET 1 OF 3

REV B

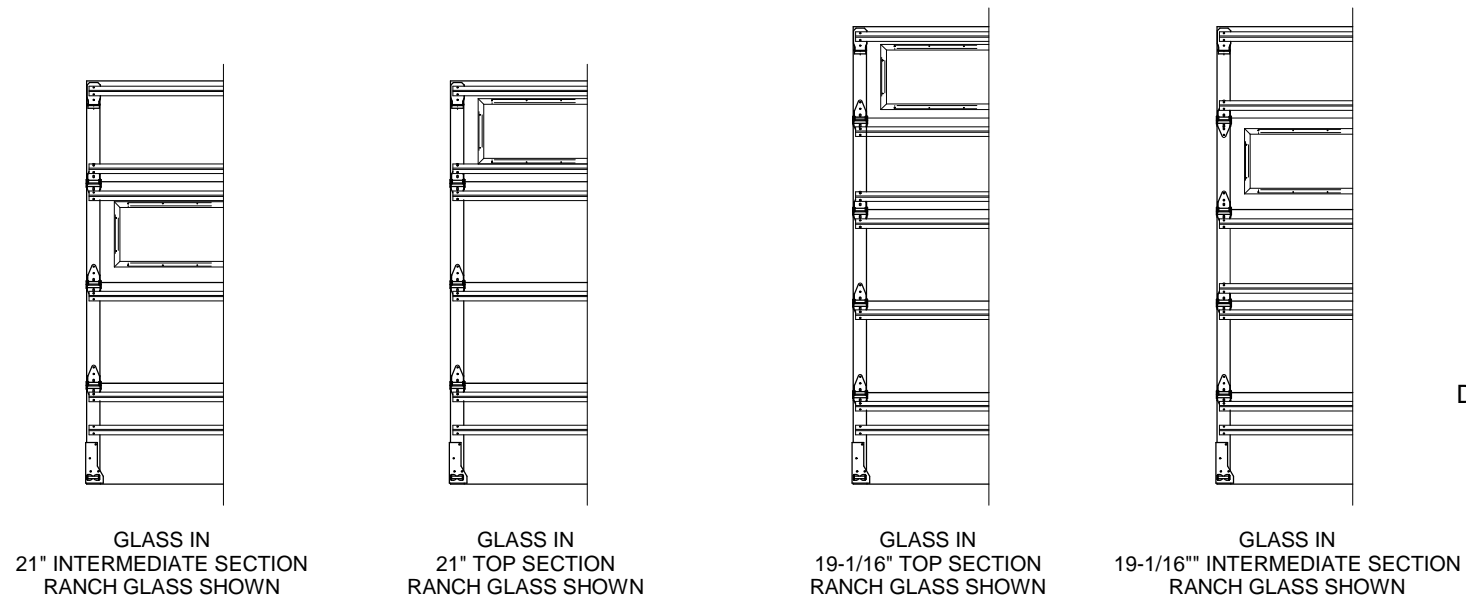

WINDOW AND U-BAR LAYOUT

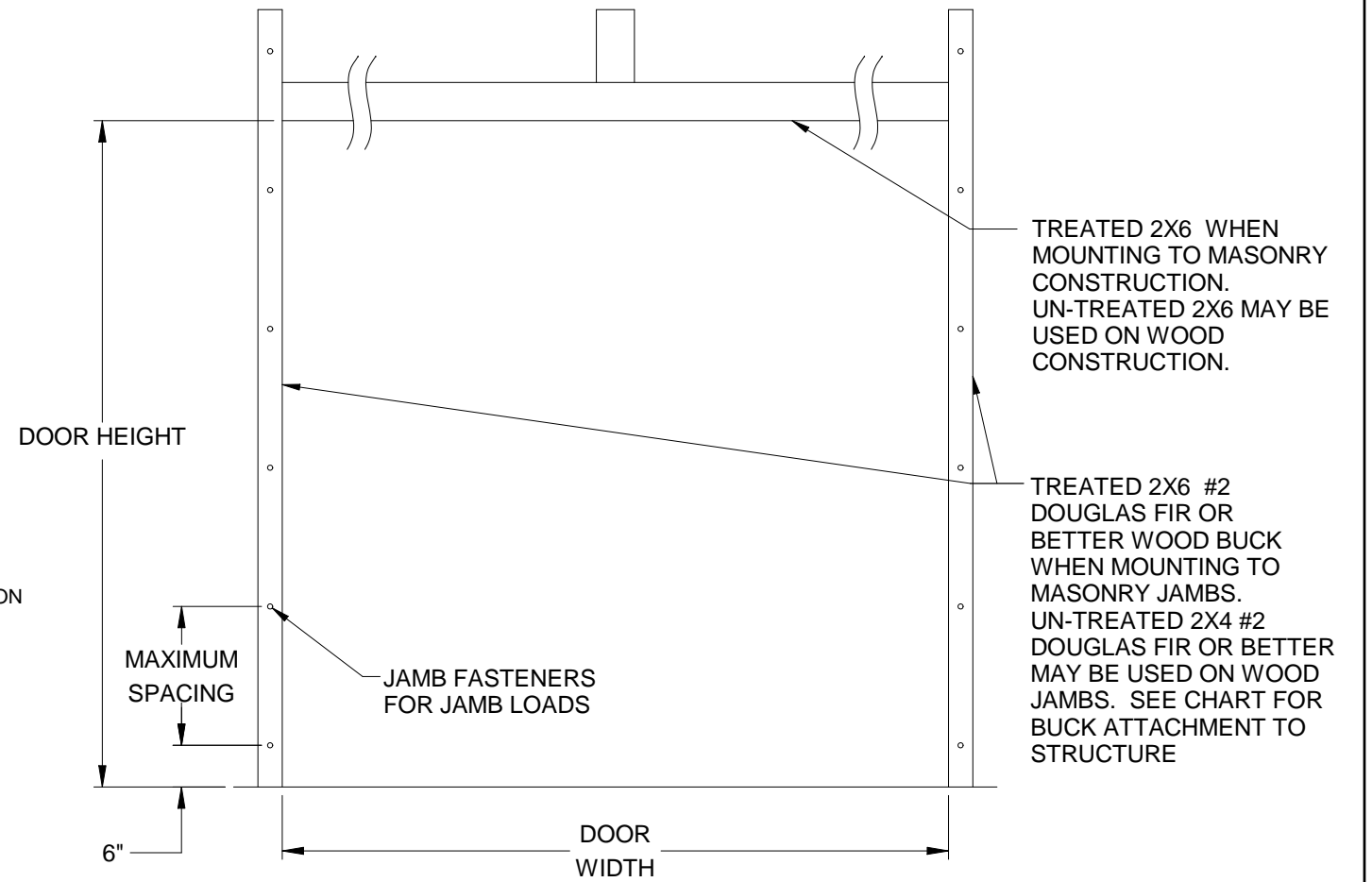

COLONIAL WINDOWS RANCH WINDOWS

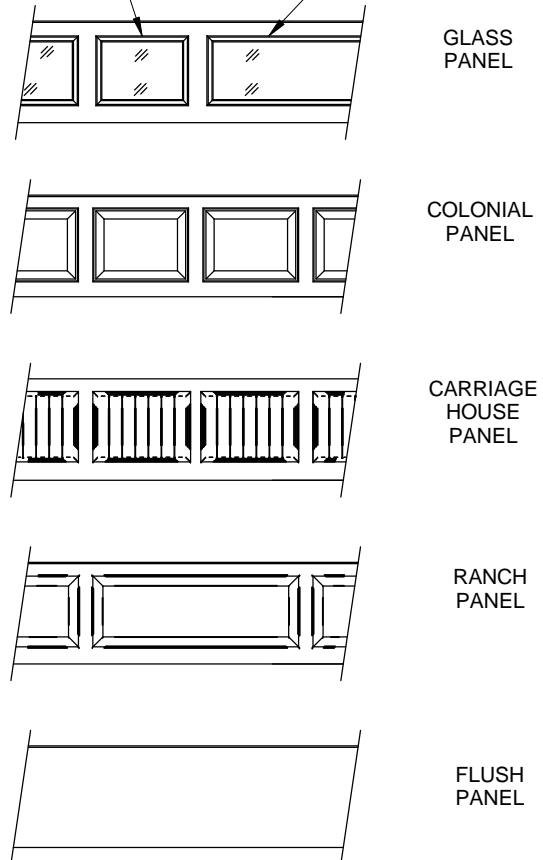

PANEL OPTIONS EXTERIOR VIEW

GLASS OPTIONS:
 1/8" DSB
 1/8" ACRYLIC
 1/2" INSULATED GLASS

JAMB ATTACHMENT NOTES

1. MAXIMUM POSITIVE LOAD PER JAMB = (18' X 18.0 PSF) / 2 = 162 LBS PER FOOT
2. MAXIMUM NEGATIVE LOAD PER JAMB = (18' X -20.0 PSF) / 2 = 180 LBS PER FOOT.
3. DESIGN OF THE SUPPORTING STRUCTURE SHALL BE THE SOLE RESPONSIBILITY OF THE BUILDING DESIGNER AND SHALL BE DESIGNED FOR THE JAMB LOADS LISTED IN NOTES 1 AND 2.
4. ALTERNATE JAMB ATTACHMENTS MAY BE USED IF APPROVED BY A REGISTERED PROFESSIONAL ENGINEER.
5. DASMA TECHNICAL DATA SHEET TDS-161 MAY BE USED FOR ALTERNATE JAMB ATTACHMENTS.
6. 3/8" DIAMETER LAG SCREWS REQUIRE 1/16" DIAMETER PILOT HOLE AND 1-1/2" MINIMUM EDGE DISTANCE.

2X6 ATTACHMENT TO STRUCTURE						
STRUCTURE TYPE	FASTENER TYPE	MINIMUM EMBEDMENT	MINIMUM EDGE DISTANCE	MINIMUM ON CENTER SPACING	DIMENSION A (MAXIMUM ON CENTER SPACING)	ALLOWABLE TENSION LOAD
2500 PSI MIN. CONCRETE	1/4" TAPCON+ (PLUS) WITH 1-1/8" OD WASHER	2"	2.5	6"	24"	691
SOUTHERN PINE	3/8" X 3" LAG WITH 1-1/8" OD WASHER	1.50"	1.50"	1.50"	24"	655
SPRUCE PINE FIR	3/8" X 3" LAG WITH 1-1/8" OD WASHER	1.50"	1.50"	1.50"	24"	482

Scott A. Brown P.E.
 F.P.E #65940
 698 Timber Creek Road
 Dixon Illinois 61021

SCALE: NONE
DRAWN BY: G. WEDEKIND
CHECKED BY: G. WEDEKIND
DATE: 10/22/12
ECO: 6338.03



TITLE: SPEC, WINDLOAD SHOWCASE, MASTERPIECE, TC200	
NO. P-2418	SHEET 2 OF 3
REV B	

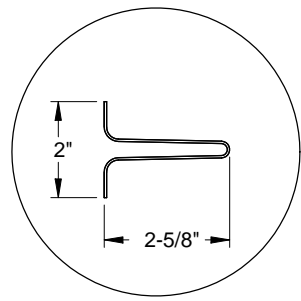

STEEL U-BAR DETAIL
18 GA. (.049" MIN) GALVANIZED
HIGH TENSILE STEEL 80 KSI MINIMUM YIELD

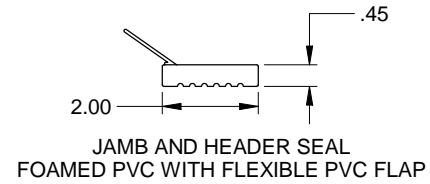

JAMB AND HEADER SEAL
FOAMED PVC WITH FLEXIBLE PVC FLAP

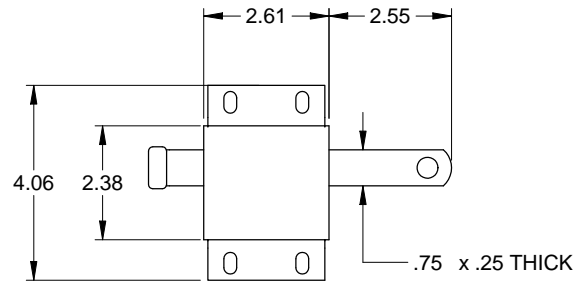

SLIDE LOCK
CASE .086 GALV. STEEL

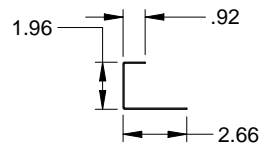
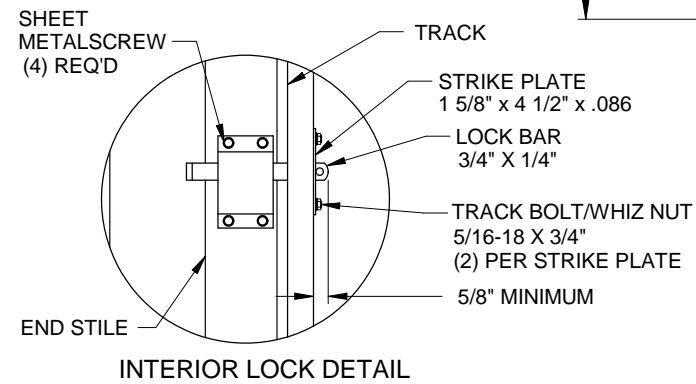

END STILE
.043 GALV. STEEL

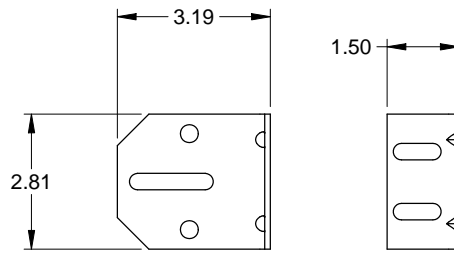

3" TRACK BRACKET
.116 GALV. STEEL

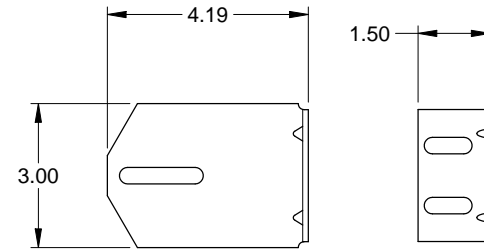

4" TRACK BRACKET
.116 GALV. STEEL

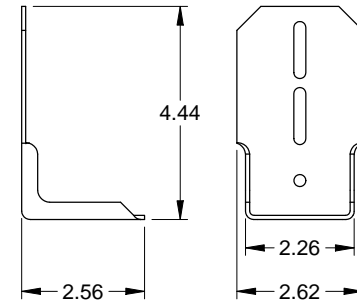

TOP FIXTURE
.086 GALV. STEEL

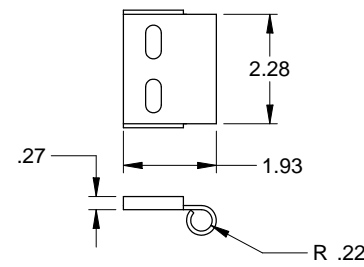

TOP ROLLER CARRIER
.086 GALV. STEEL
ATTACHED TO TOP FIXTURE WITH
(2) TRACK BOLTS AND WHIZ NUTS

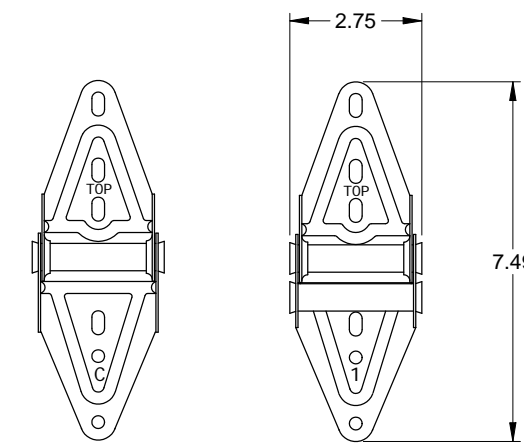

CENTER HINGE
.045 GALV. STEEL

EDGE HINGE
.086 GALV. STEEL

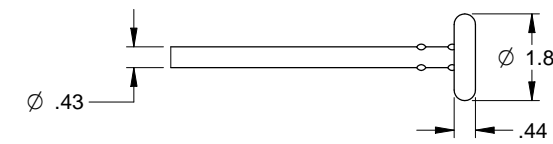

TRACK ROLLER

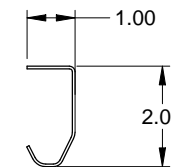

TRACK
.086 GALV. STEEL

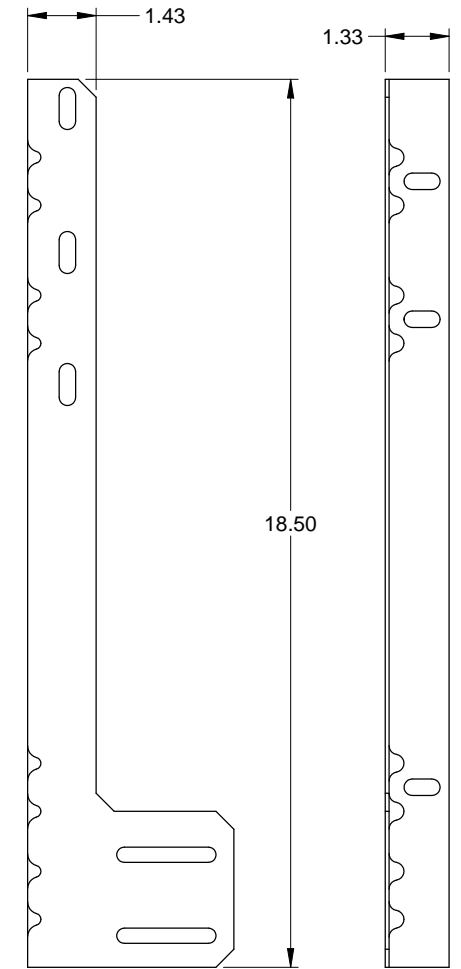

JAMB ANGLE
.078 GALV. STEEL

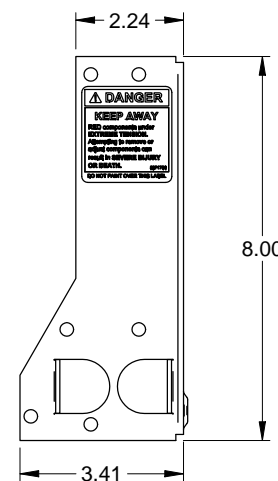

CORNER BRACKET
.086 GALV. STEEL

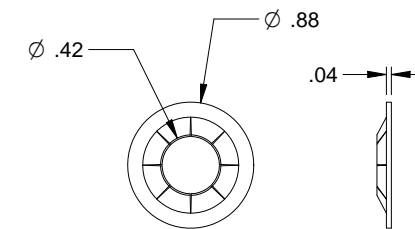

RETAINING NUT

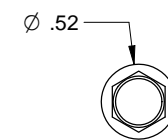

SHEET METAL SCREW

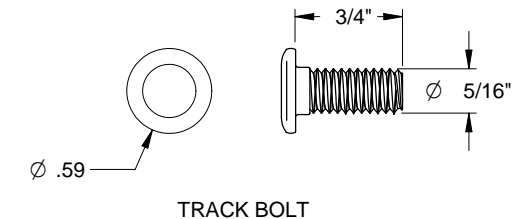

TRACK BOLT

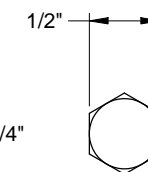

HEX HEAD LAG SCREW

Scott A. Brown P.E.
F.P.E #65940
698 Timber Creek Road
Dixon Illinois 61021

REV.	DESCRIPTION	ECO	DATE

SCALE: NONE
DRAWN BY: G. WEDEKIND
CHECKED BY: G. WEDEKIND
DATE: 10/22/12
ECO: 6338.03



TITLE: SPEC, WINDLOAD SHOWCASE, MASTERPIECE, TC200	
NO. P-2418	REV B
SHEET 3 OF 3	