

REVISIONS			
REV	DESCRIPTION	DATE	APPROVED
D	REVISED PER NEW STANDARDS	01/10/2022	R.L.

NOTES:

- 1) THE PRODUCT SHOWN HEREIN IS DESIGNED AND MANUFACTURED TO COMPLY WITH REQUIREMENTS OF THE FLORIDA BUILDING CODE.
- 2) WOOD FRAME OPENING TO BE DESIGNED AND ANCHORED TO PROPERLY TRANSFER ALL LOADS TO STRUCTURE. FRAMING IS THE RESPONSIBILITY OF THE ARCHITECT OR ENGINEER OF RECORD.
- 3) ALLOWABLE STRESS INCREASE OF 1/3 WAS NOT USED IN THE DESIGN OF THE PRODUCT SHOWN HEREIN. WIND LOAD DURATION FACTOR Cd=1.6 WAS USED FOR WOOD ANCHOR CALCULATIONS.
- 4) FRAME AND SASH MATERIAL SILL: EXTRUDED PVC.
- 5) UNITS MUST BE GLAZED PER ASTM E1300, SEE SHEET 2 FOR GLAZING.
- 6) APPROVED IMPACT PROTECTIVE SYSTEM IS NOT REQUIRED FOR THIS PRODUCT IN WIND BORNE DEBRIS REGIONS.
- 7) SHIM AS REQUIRED AT EACH INSTALLATION ANCHOR WITH LOAD BEARING SHIM. SHIM WHERE SPACE OF 1/16" OR GREATER OCCURS. MAXIMUM ALLOWABLE SHIM STACK TO BE 1/4".
- 8) FOR ANCHORING INTO WOOD FRAMING OR 2X BUCK USE #8 WOOD SCREW WITH SUFFICIENT LENGTH TO ACHIEVE A 1 1/2" MINIMUM EMBEDMENT INTO SUBSTRATE. LOCATE ANCHORS AS SHOWN IN ELEVATIONS AND INSTALLATION DETAILS.
- 9) ALL FASTENERS TO BE CORROSION RESISTANT.
- 10) INSTALLATION ANCHORS SHALL BE INSTALLED IN ACCORDANCE WITH ANCHOR MANUFACTURER'S INSTALLATION INSTRUCTIONS, AND ANCHORS SHALL NOT BE USED IN SUBSTRATES WITH STRENGTHS LESS THAN THE MINIMUM STRENGTH SPECIFIED BELOW:
 - A. WOOD – MINIMUM SPECIFIC GRAVITY OF G=0.42

SIGNED: 03/25/2022

TABLE OF CONTENTS	
SHEET NO.	DESCRIPTION
1	NOTES
2	ELEVATION
3	INSTALLATION DETAILS

STERGIS WINDOWS & DOORS, INC. 79 WALTON ST. ATTLEBORO, MA 02703		
STORMGATE 142.194 DH-018 IMPACT DOUBLE HUNG 48" X 72" NOTES		
DRAWN: TJH	DWG NO. 08-00833	REV D
SCALE NTS	DATE 08/25/09	SHEET 1 OF 3
L. ROBERTO LOMAS P.E. 400 S. PALM AVE, INDIALANTIC, FL 32903 434-688-0609 rllomas@rlomaspe.com		

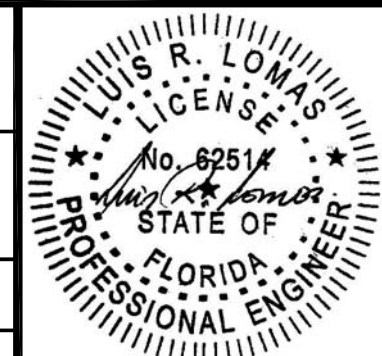

Luis R. Lomas P.E.
FL No.: 62514

REVISIONS			
REV	DESCRIPTION	DATE	APPROVED
D	REVISED PER NEW STANDARDS	01/10/2022	R.L.

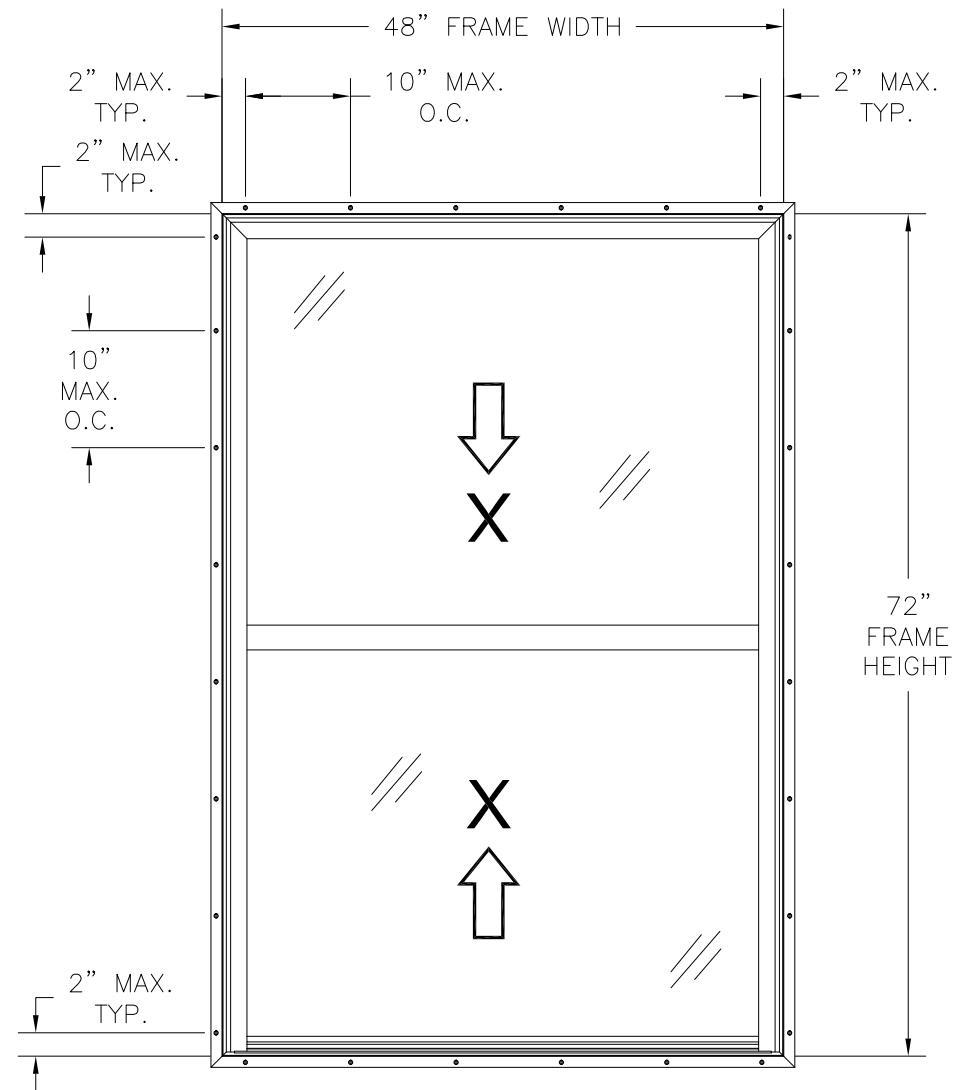

STORMGATE NC DH PVC DOUBLE HUNG WINDOW
EXTERIOR VIEW

DESIGN PRESSURE RATING	IMPACT RATING
±50.0PSF	LARGE AND SMALL MISSILE IMPACT

MISSILE LEVEL D, WIND ZONE 4

48" X 72" UNIT SHOWN. OTHER SIZES APPROVED AS LONG AS FRAME AREA DOES NOT EXCEED 24.0" FT²

NOTES:

- SASH SIZE: 44 3/8" X 35 3/8"
- D.L.O: 37 1/4" X 32 1/4"

HARDWARE SCHEDULE

A.	(2) 1/2 COIL SPRING BALANCE SYSTEM BY FOUR JACKS
B.	(2) METALLIC SPRING LOADED TILT LATCHES AT 1/2" FROM RAIL CORNER
C.	(2) PLASTIC SPRING LOADED TILT LATCHES AT 1/2" FROM RAIL CORNER
D.	(4) PIVOT BAR AT END OF SASH BOTTOM RAIL
E.	(2) ALUMINUM IMPACT CLIP (10300133/10300134) AT 1 1/2" FROM SASH BOTTOM LOCK RAIL
F.	(2) DIE CAST ZINC CAM LOCK 8" FROM JAMB CORNER
G.	ALUMINUM REINFORCEMENT (1030082) AT ACTIVE SASH STIULES AND TOP RAILS
H.	ALUMINUM REINFORCEMENT (1030083) AT LOCK RAIL
J.	ALUMINUM REINFORCEMENT (1030096) AT SILL

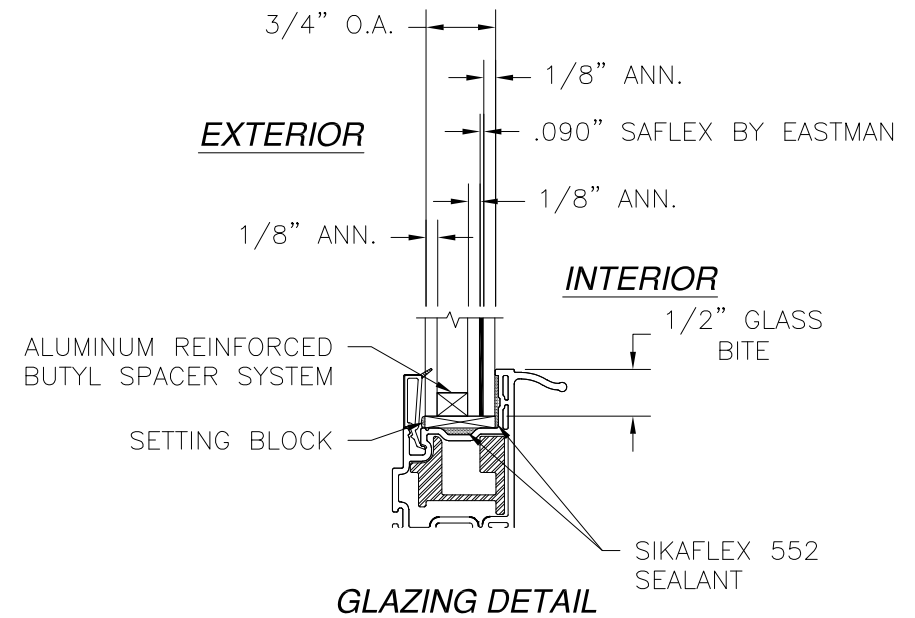

GLAZING DETAIL

SIGNED: 03/25/2022

STERGIS WINDOWS & DOORS, INC.

79 WALTON ST.
ATTLEBORO, MA 02703

STORMGATE 142.194 DH-018 IMPACT DOUBLE HUNG
48" X 72"
ELEVATION

DRAWN: TJH	DWG NO. 08-00833	REV D
SCALE NTS	DATE 08/25/09	SHEET 2 OF 3

L. ROBERTO LOMAS P.E.
400 S. PALM AVE, INDIALANTIC, FL 32903
434-688-0609 rllomas@rlomaspe.com

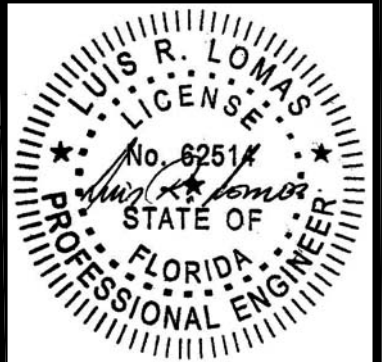

Luis R. Lomas P.E.
FL No.: 62514

REVISIONS			
REV	DESCRIPTION	DATE	APPROVED
D	REVISED PER NEW STANDARDS	01/10/2022	R.L.

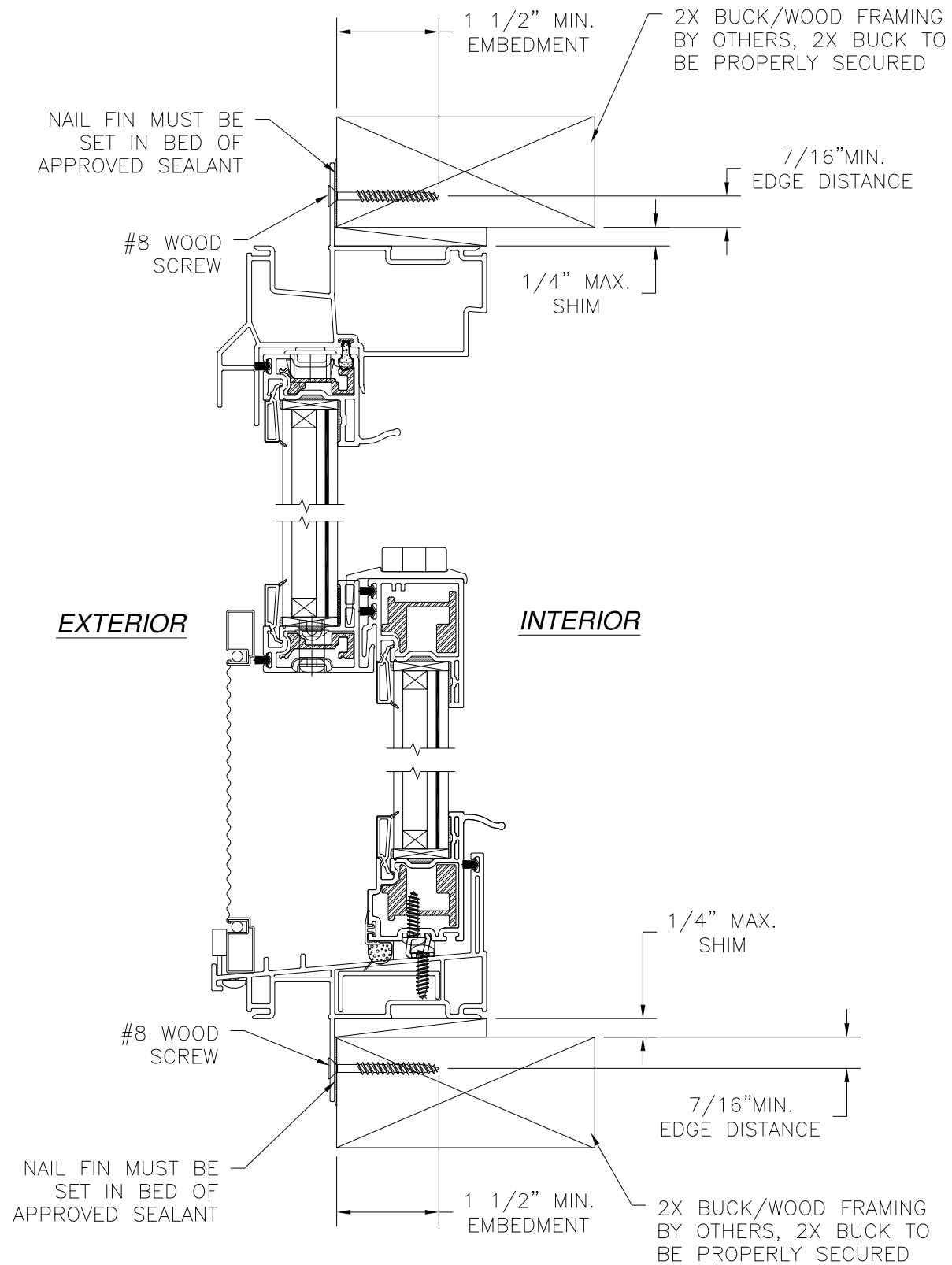

VERTICAL CROSS SECTION
2X BUCK/WOOD FRAMING

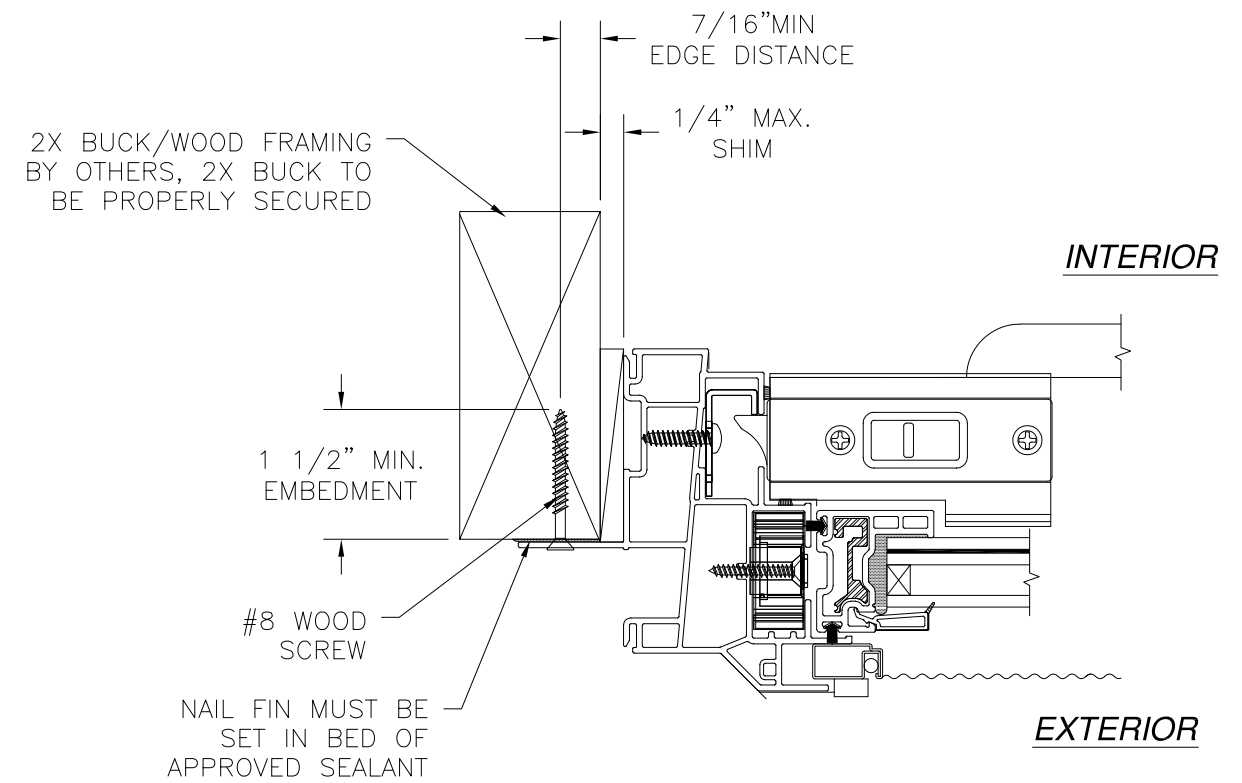

HORIZONTAL CROSS SECTION
2X BUCK/WOOD FRAMING

- NOTES:**
1. INTERIOR AND EXTERIOR FINISHES, BY OTHERS, NOT SHOWN FOR CLARITY.
 2. PERIMETER AND JOINT SEALANT BY OTHERS TO BE DESIGNED IN ACCORDANCE WITH ASTM E2112

SIGNED: 03/25/2022

<p>STERGIS WINDOWS & DOORS, INC. 79 WALTON ST. ATTLEBORO, MA 02703</p>		
<p>STORMGATE 142.194 DH-018 IMPACT DOUBLE HUNG 48" X 72" INSTALLATION DETAILS</p>		
<p>DRAWN: TJH</p>	<p>DWG NO. 08-00833</p>	<p>REV D</p>
<p>SCALE NTS</p>	<p>DATE 08/25/09</p>	<p>SHEET 3 OF 3</p>
<p>L. ROBERTO LOMAS P.E. 400 S. PALM AVE, INDIALANTIC, FL 32903 434-688-0609 rllomas@rlomaspe.com</p>		

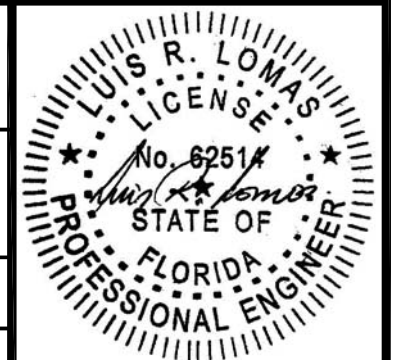

Luis R. Lomas P.E.
FL No.: 62514