

HARDWARE SCHEDULE

A.	(1) ROTORY OPERATOR AT SILL
B.	(1) SINGLE ARM HINGE AT HEAD
C.	(1) FOUR POINT LEVER LOCK AT LOCK JAMB
D.	(4) METAL LOCK KEEPER AT LOCK STILE
E.	(2) METAL SNUBBER AT HINGE JAMB, 24 1/2" FROM CORNERS
F.	(2) METAL SNUBBER AT HINGE STILE, 24 1/2" FROM CORNERS
G.	ALUMINUM REINFORCEMENT AT EXTERIOR PERIMETER OF SASH, INTERIOR SASH HOLLOW OF LOCK STILE AND JAMBS

REVISIONS			
REV	DESCRIPTION	DATE	APPROVED
A	REVISED PER NEW REQUIREMENTS	02/27/18	R.L.
B	REVISED PER NEW STANDARDS	01/11/2022	R.L.

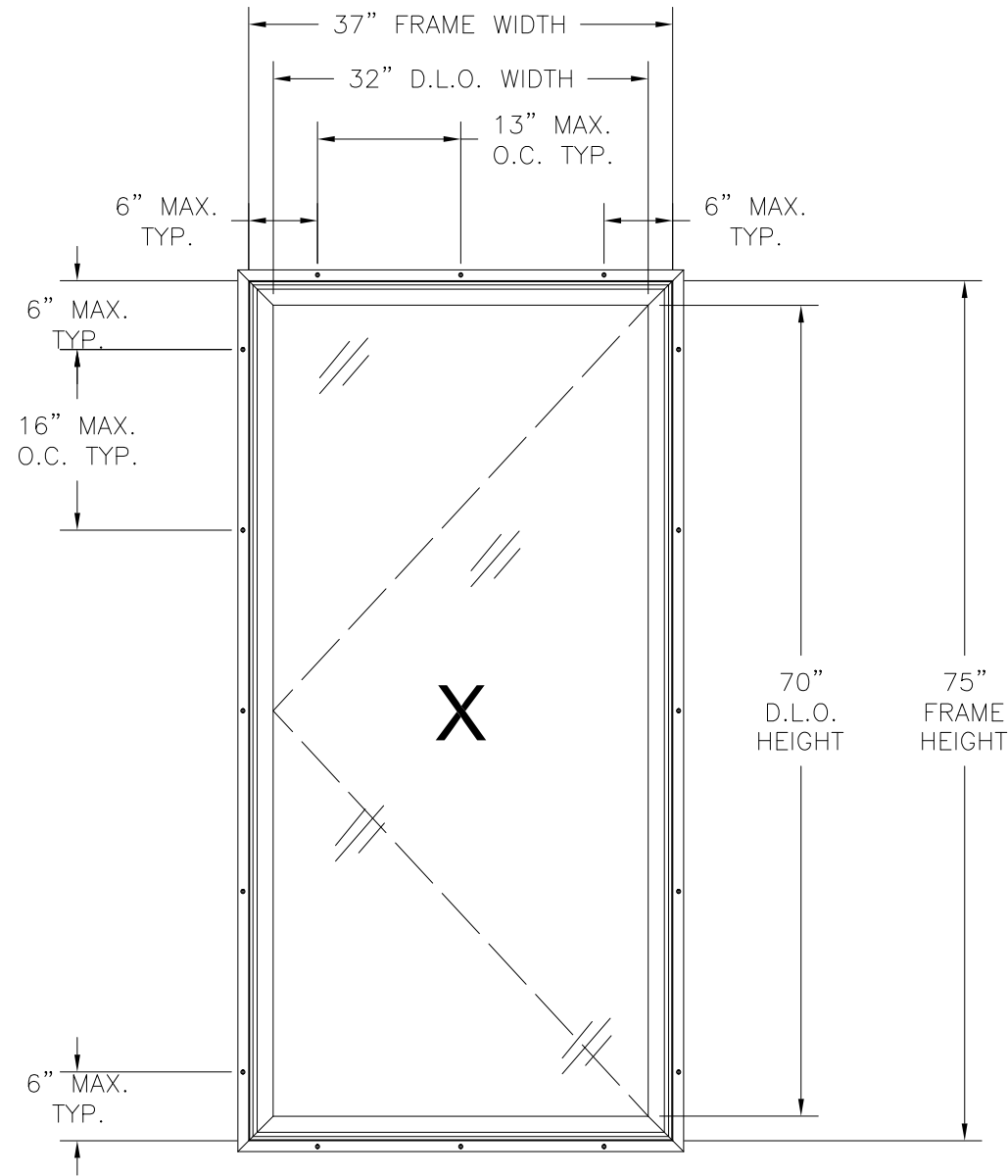

STORMGATE NC CA PVC CASEMENT WINDOW
EXTERIOR VIEW

DESIGN PRESSURE RATING	IMPACT RATING
±50PSF	LARGE AND SMALL MISSILE IMPACT

37" X 75" UNIT SHOWN. OTHER SIZES APPROVED AS LONG AS FRAME AREA DOES NOT EXCEED 19.27" FT²

TABLE OF CONTENTS	
SHEET NO.	DESCRIPTION
1	ELEVATION, ANCHORING AND NOTES
2	INSTALLATION DETAILS AND GLAZING DETAIL

NOTES:

- 1) THE PRODUCT SHOWN HEREIN IS DESIGNED AND MANUFACTURED TO COMPLY WITH REQUIREMENTS OF THE FLORIDA BUILDING CODE.
- 2) WOOD FRAME OPENING TO BE DESIGNED AND ANCHORED TO PROPERLY TRANSFER ALL LOADS TO STRUCTURE. FRAMING IS THE RESPONSIBILITY OF THE ARCHITECT OR ENGINEER OF RECORD.
- 3) ALLOWABLE STRESS INCREASE OF 1/3 WAS NOT USED IN THE DESIGN OF THE PRODUCT SHOWN HEREIN. WIND LOAD DURATION FACTOR Cd=1.6 WAS USED FOR WOOD ANCHOR CALCULATIONS.
- 4) FRAME AND SASH MATERIAL: EXTRUDED WHITE PVC .070" THICK.
- 5) UNITS MUST BE GLAZED PER ASTM E1300, SEE SHEET 2 FOR GLAZING DETAILS.
- 6) APPROVED IMPACT PROTECTIVE SYSTEM IS NOT REQUIRED FOR THIS PRODUCT IN WIND BORNE DEBRIS REGIONS.
- 7) SHIM AS REQUIRED AT EACH INSTALLATION ANCHOR WITH LOAD BEARING SHIM. SHIM WHERE SPACE OF 1/16" OR GREATER OCCURS. MAXIMUM ALLOWABLE SHIM STACK TO BE 1/4".
- 8) FOR ANCHORING INTO WOOD FRAMING OR 2X BUCK USE #8 WOOD SCREW WITH SUFFICIENT LENGTH TO ACHIEVE A 1 1/2" MINIMUM EMBEDMENT INTO SUBSTRATE. LOCATE ANCHORS AS SHOWN IN ELEVATIONS AND INSTALLATION DETAILS.
- 9) ALL FASTENERS TO BE CORROSION RESISTANT.
- 10) INSTALLATION ANCHORS SHALL BE INSTALLED IN ACCORDANCE WITH ANCHOR MANUFACTURER'S INSTALLATION INSTRUCTIONS, AND ANCHORS SHALL NOT BE USED IN SUBSTRATES WITH STRENGTHS LESS THAN THE MINIMUM STRENGTH SPECIFIED BELOW:
A. WOOD - MINIMUM SPECIFIC GRAVITY OF G=0.42

SIGNED: 03/25/2022

STERGIS WINDOWS & DOORS, INC.

79 WALTON ST.
ATTLEBORO, MA 02703

STORMGATE NC CA PVC CASEMENT WINDOW
IMPACT 37" X 75"
ELEVATION, ANCHORING AND NOTES

DRAWN: TJH	DWG NO. 08-00834	REV B
SCALE NTS	DATE 08/25/09	SHEET 1 OF 2

L. ROBERTO LOMAS P.E.
400 S. PALM AVE, INDIALANTIC, FL 32903
434-688-0609 rllomas@rlomaspe.com

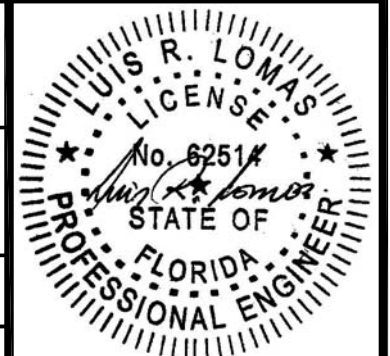

Luis R. Lomas P.E.
FL No.: 62514

REVISIONS			
REV	DESCRIPTION	DATE	APPROVED
A	REVISED PER NEW REQUIREMENTS	02/27/18	R.L.
B	REVISED PER NEW STANDARDS	01/11/2022	R.L.

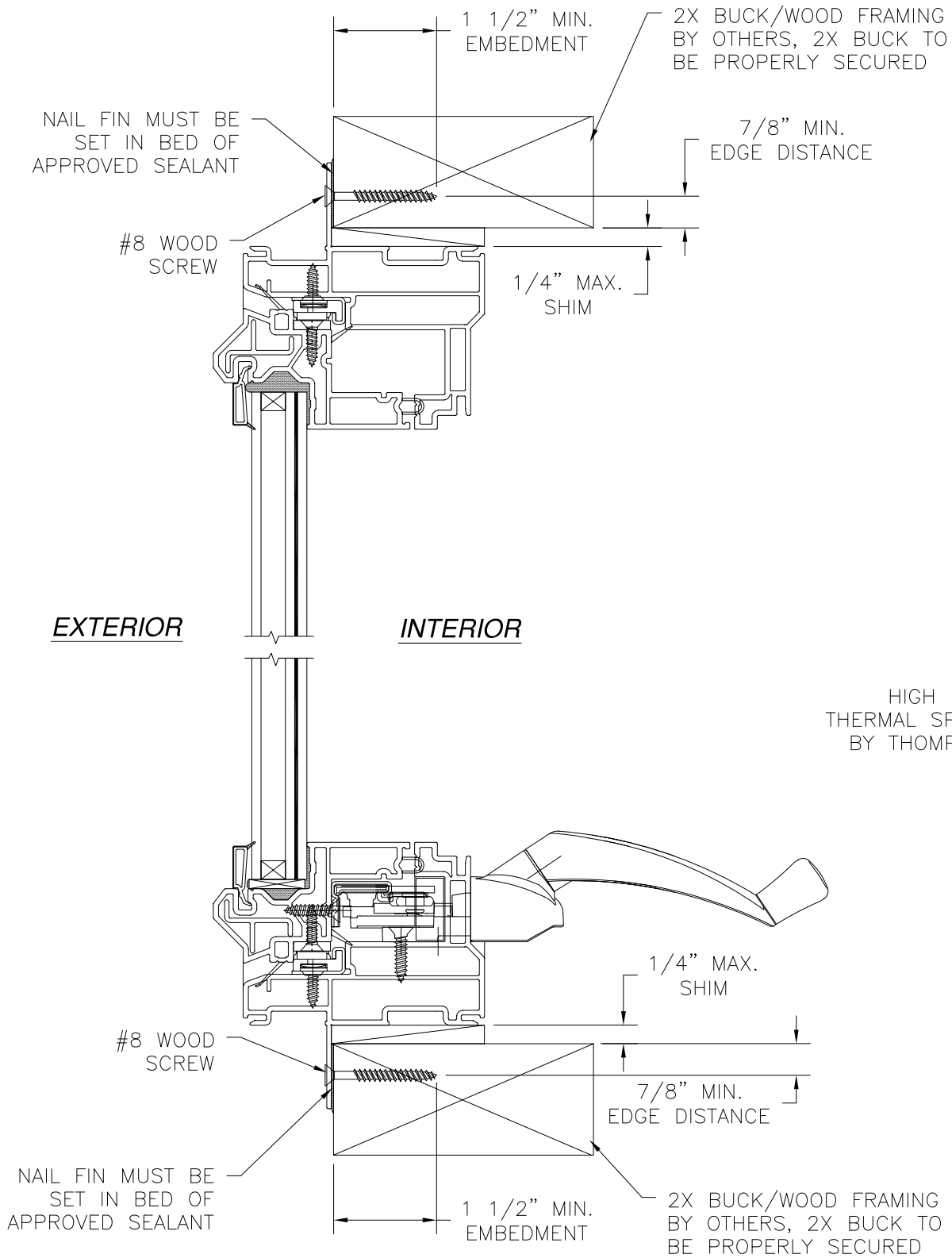

VERTICAL CROSS SECTION
2X BUCK/WOOD FRAMING

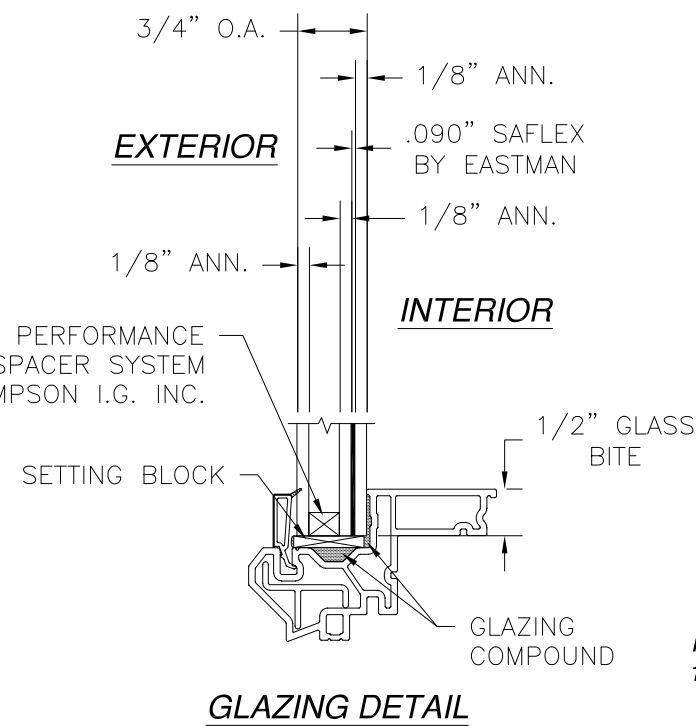

GLAZING DETAIL

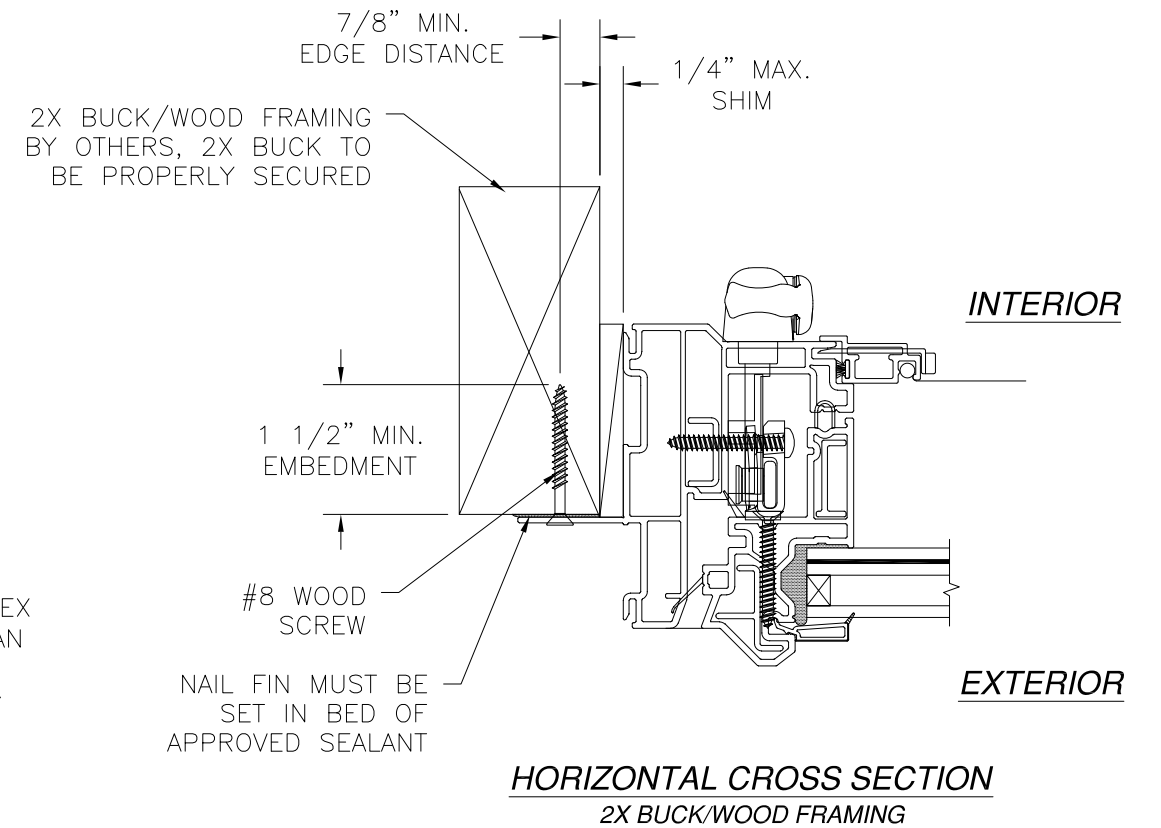

HORIZONTAL CROSS SECTION
2X BUCK/WOOD FRAMING

NOTES:

1. INTERIOR AND EXTERIOR FINISHES, BY OTHERS, NOT SHOWN FOR CLARITY.
2. PERIMETER AND JOINT SEALANT BY OTHERS TO BE DESIGNED IN ACCORDANCE WITH ASTM E2112

SIGNED: 03/25/2022

STERGIS WINDOWS & DOORS, INC.

79 WALTON ST.
ATTLEBORO, MA 02703

STORMGATE NC CA PVC CASEMENT WINDOW
IMPACT 37" X 75"
INSTALLATION DETAILS

DRAWN: TJH	DWG NO. 08-00834	REV B
SCALE NTS	DATE 08/25/09	SHEET 2 OF 2

L. ROBERTO LOMAS P.E.
400 S. PALM AVE, INDIALANTIC, FL 32903
434-688-0609 rllomas@rlomaspe.com

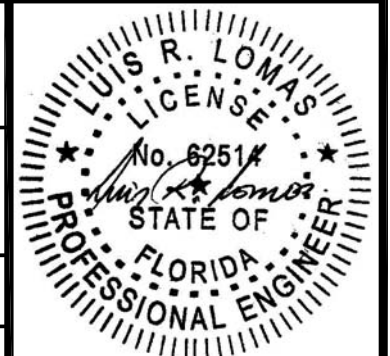

Luis R. Lomas P.E.
FL No.: 62514