

Scott A. Brown P.E.  
F.P.E #65940  
698 Timber Creek Road  
Dixon Illinois 61021

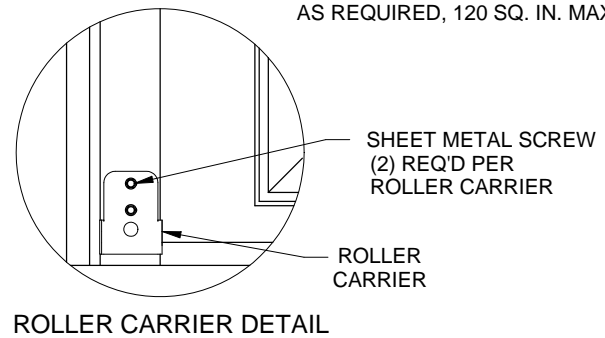

REV.	DESCRIPTION	ECO	DATE	ECO: 4885-A
B	1) WAS RICHARD A BAUMANN, P.E., 2) UPDATED JAMB ATTACHMENTS	7804.01	10/02/17	
A	Re-tested at accredited lab, added shts 2 and 3	6338.01	04/26/12	

SCALE: NONE  
DRAWN BY: M. McCormick  
CHECKED BY: G. Wedekind  
DATE: 07/18/05



TITLE: SPEC, WINDLOAD BUILDMARK / TRADEMARK	
NO. P-2357	SHEET 1 OF 3
REV B	

DOOR WIDTH	DESIGN LOAD
16' - 0"	+ 16.0 - 17.7

DOORS TESTED PER TAS 202 AND ANSI/DASMA 108 FOR STATIC AIR PRESSURE

DOOR WIDTH - 16' - 0" MAXIMUM  
16' - 0" WIDE SHOWN  
SEE SHEET 2 FOR OTHER DOOR WIDTHS  
INTERIOR ELEVATION

VENTS (OPTIONAL)  
VENT OPENINGS MAY BE LOCATED IN BOTTOM SECTION AS REQUIRED, 120 SQ. IN. MAX

ROLLER CARRIER  
SEE DETAIL ON SHT 3

LOCKS REQUIRED ON DOORS NOT ELECTRICALLY OPERATED. SEE DETAILS ON SHT 2.

STEEL REINFORCEMENT  
ONE (1) U-BAR PER SECTION, FASTENED TO ALL CENTER AND END STILES USING (2) SHEET METAL SCREWS AT EACH STILE

DOOR HEIGHT  
7'- 0" HIGH SHOWN  
OTHER DOOR HEIGHTS AVAILABLE UP TO 16'-0" USING 18" OR 21" HIGH SECTIONS

TOP FIXTURE  
SEE DETAIL ON SHT 3

SHEET METALSCREW (6) REQ'D PER HINGE

SPRING COUNTERBALANCE  
SPRING WIRE INDIVIDUALLY CALCULATED TO COUNTERBALANCE DOOR. QUANTITY AND SIZE OF SPRING WILL VARY BASED ON DOOR SIZE.

TOP FIXTURE DETAIL

SHEET METALSCREW (3) REQ'D PER TOP FIXTURE

SECTION B-B

RETAINING NUT 7/16" PUSH ON  
RETAINING NUT (1) REQUIRED PER ROLLER  
SEE DETAIL ON SHT 3

CENTER HINGE  
SEE DETAIL ON SHT 3

U-BAR  
SEE DETAIL ON SHT 3

JAMBS  
2X6 #2 DOUGLAS FIR OR BETTER WOOD JAMB SEE SHT 2 FOR ATTACHMENT  
HEX HEAD LAG SCREW (2) PER BRACKET, SEE DETAIL ON SHT 3  
TRACK BRACKET SHOWN, FULL ANGLE OPTIONAL SEE DETAIL ON SHT 3  
TRACK BOLT / WHIZ LOCK NUT SEE DETAIL ON SHT 3  
TRACK ROLLER SEE DETAIL ON SHT 3  
TRACK, 2" SHOWN, 3" OPTIONAL SEE DETAIL ON SHT 3

CENTER STILE  
TOX LOCKED AND GLUED TO PANEL  
SEE DETAIL ON SHT 3

END STILE  
TOX LOCKED TO SECTION  
SEE DETAIL ON SHT 3

STEEL SECTION  
BUILDMARK .017 THICK G-40 GALVANIZED STEEL TRADEMARK .023 THICK G-40 GALVANIZED STEEL WITH AN EPOXY PRIMER AND BAKED ON POLYESTER FINISH WHICH IS ROLL-FORMED WITH WOOD GRAIN TEXTURE AND STAMPED WITH EMBOSSED OR FLUSH PANELS.

TYPICAL TRACK INSTALLATION  
NORMAL HEADROOM TRACK SHOWN, LOW HEADROOM, LIFT CLEARANCE AND VERTICAL LIFT TRACK AVAILABLE

SECTION A-A

EDGE HINGE DETAIL

EDGE HINGE

B

A

A

36" O.C. (TYP)

VERTICAL TRACK

JAMB ANGLE  
ONE (1) REQ'D PER VERTICAL TRACK. ATTACH WITH (3) HEX HEAD LAG SCREWS

12" OR 15" RADIUS

2" SECTION THICKNESS

TOP SECTION

INTERMEDIATE SECTION

U-BAR

BOTTOM SECTION

ASTRAGAL RETAINER  
SEE DETAIL ON SHT 3

ROLLER CARRIER

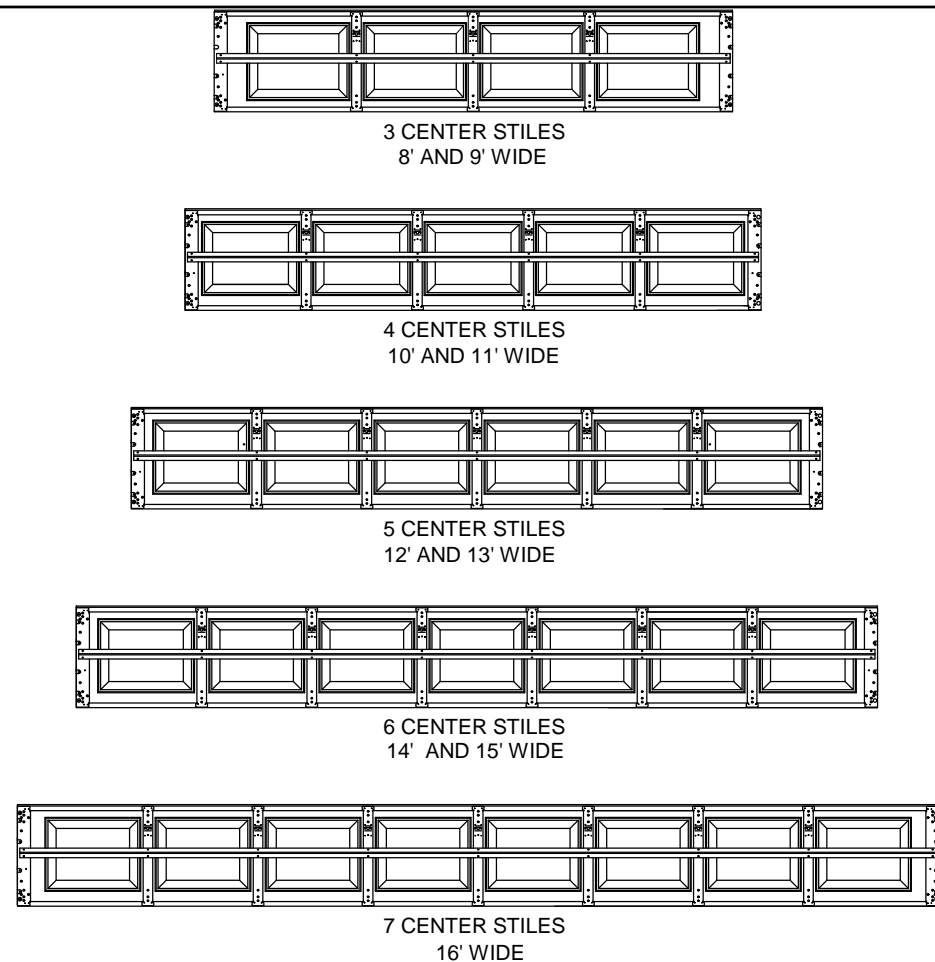

CENTER STILE LAYOUT INTERIOR VIEW

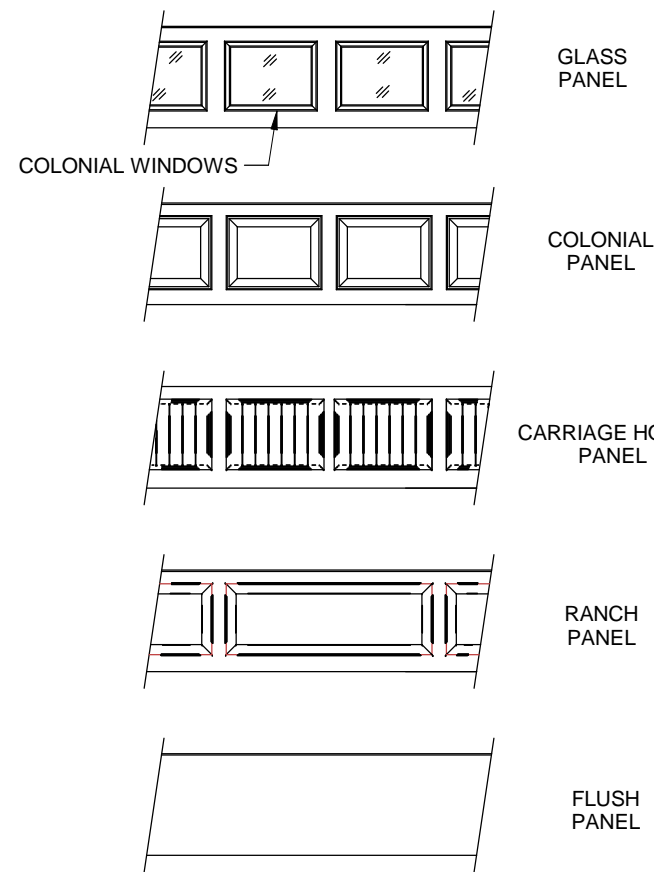

PANEL OPTIONS EXTERIOR VIEW

GLASS OPTIONS:  
 1/8" DSB  
 1/8" ACRYLIC  
 1/8" TEMPERED  
 1/2" INSULATED GLASS

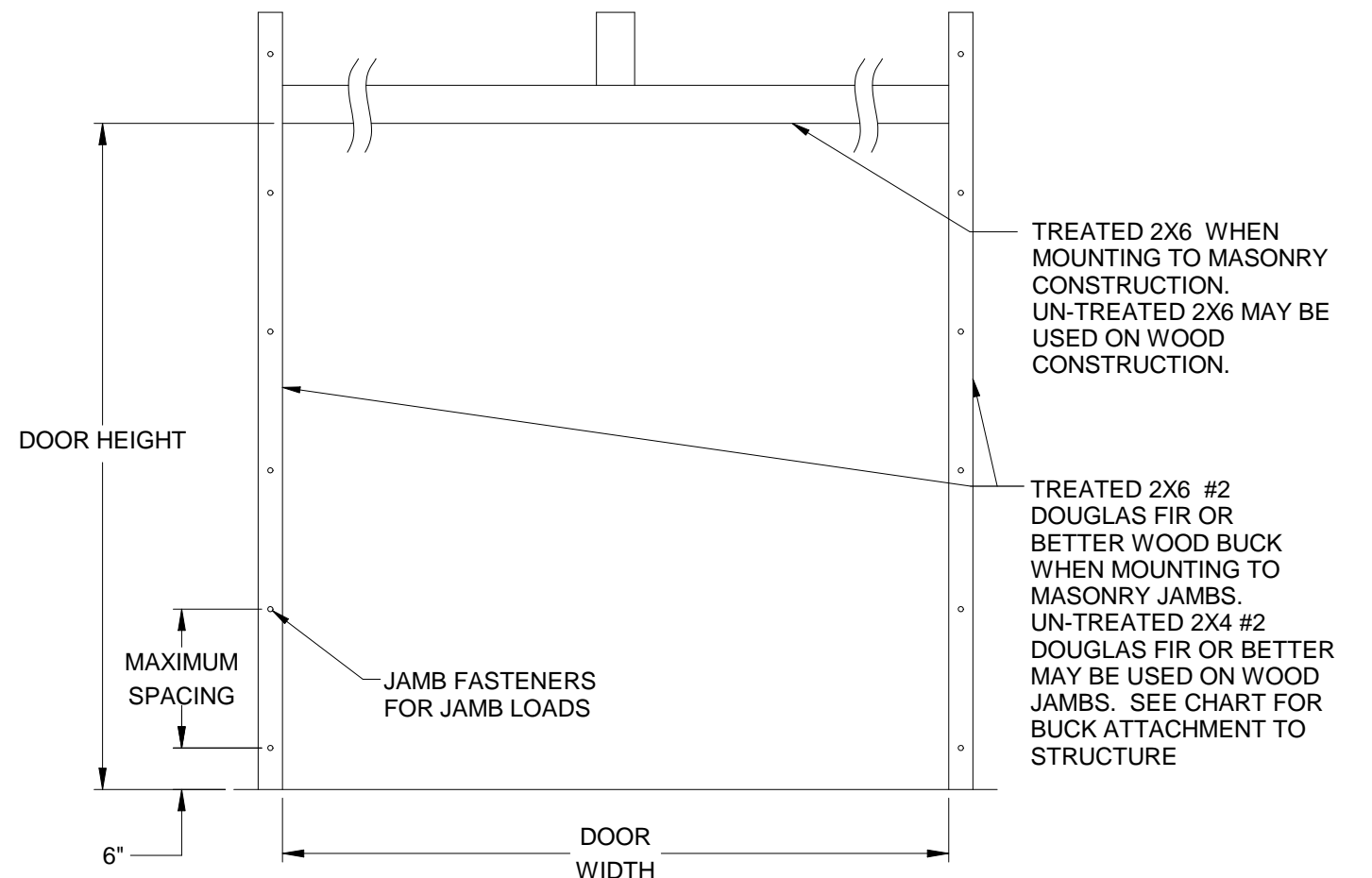

JAMB ATTACHMENT NOTES

1. MAXIMUM POSITIVE LOAD PER JAMB = (16'-0" X 16.0 PSF) / 2 = 128 LBS PER FOOT
2. MAXIMUM NEGATIVE LOAD PER JAMB = (16'-0" X -17.7 PSF) / 2 = 142 LBS PER FOOT.
3. DESIGN OF THE SUPPORTING STRUCTURE SHALL BE THE SOLE RESPONSIBILITY OF THE BUILDING DESIGNER AND SHALL BE DESIGNED FOR THE JAMB LOADS LISTED IN NOTES 1 AND 2.
4. ALTERNATE JAMB ATTACHMENTS MAY BE USED IF APPROVED BY A REGISTERED PROFESSIONAL ENGINEER.
5. DASMA TECHNICAL DATA SHEET TDS-161 MAY BE USED FOR ALTERNATE JAMB ATTACHMENTS.
6. 3/8" DIAMETER LAG SCREWS REQUIRED 1/16" PILOT HOLE AND 1-1/2" MINIMUM EDGE DISTANCE.

2X6 ATTACHMENT TO STRUCTURE						
STRUCTURE TYPE	FASTENER TYPE	MINIMUM EMBEDMENT	MINIMUM EDGE DISTANCE	MINIMUM ON CENTER SPACING	DIMENSION A (MAXIMUM ON CENTER SPACING)	ALLOWABLE TENSION LOAD
2500 PSI MIN. CONCRETE	1/4" TAPCON+ (PLUS) WITH 1-1/8" OD WASHER	2"	2.5"	6"	24"	691
SOUTHERN PINE	3/8" X 3" LAG WITH 1-1/8" OD WASHER	1.50"	1.50"	1.50"	24"	655
SPRUCE PINE FIR	3/8" X 3" LAG WITH 1-1/8" OD WASHER	1.50"	1.50"	1.50"	24"	482

Scott A. Brown P.E.  
 F.P.E #65940  
 698 Timber Creek Road  
 Dixon Illinois 61021

SCALE: NONE
DRAWN BY: G. WEDEKIND
CHECKED BY: G. WEDEKIND
DATE: 04/26/12
ECO: 6338.01



TITLE: SPEC, WINDLOAD BUILDMARK / TRADEMARK	
NO. P-2357	SHEET 2 OF 3
REV B	

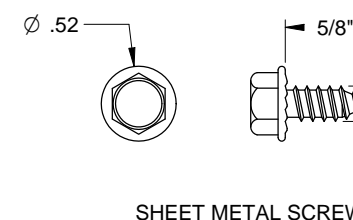
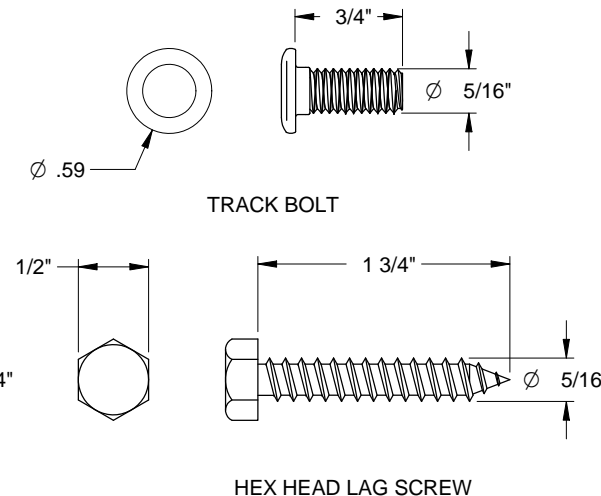
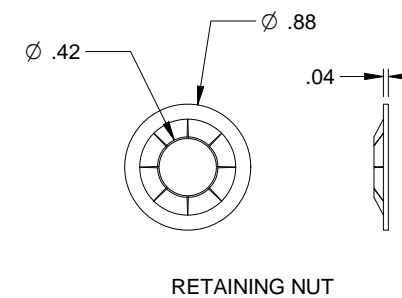
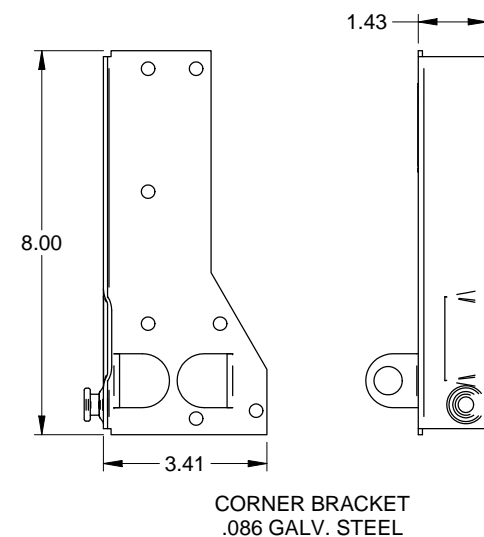
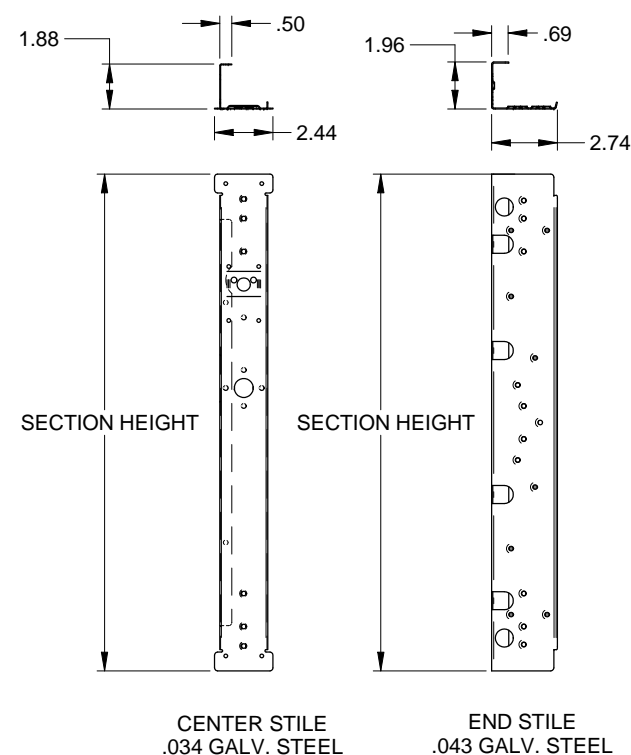
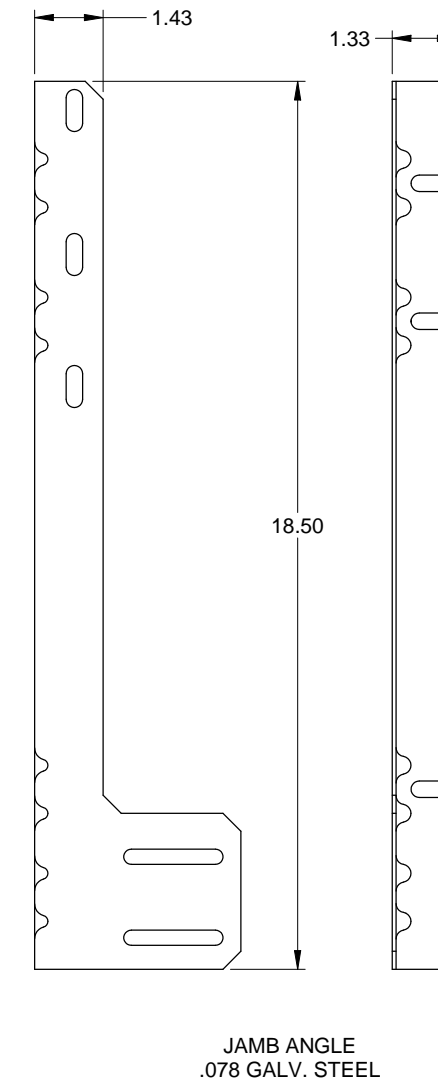
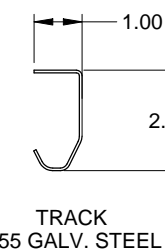
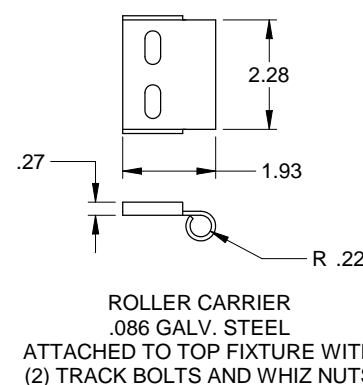
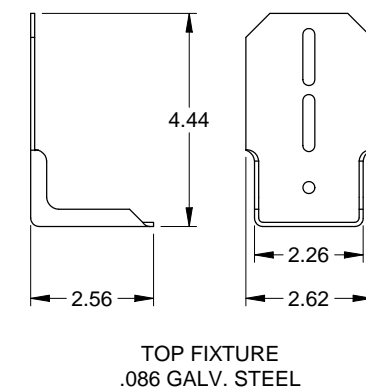
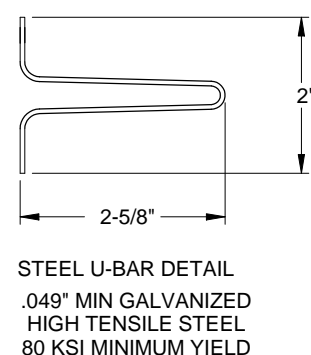
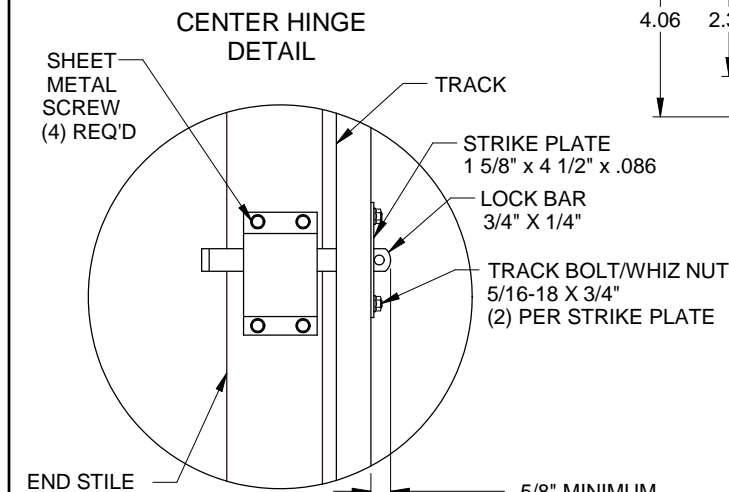
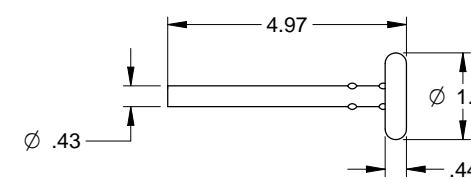
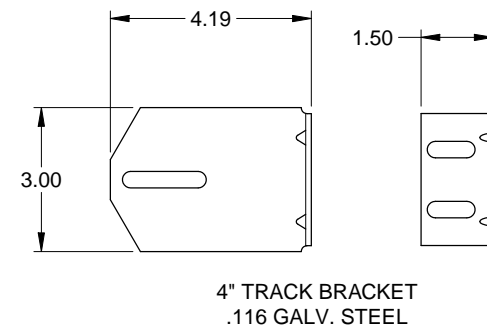
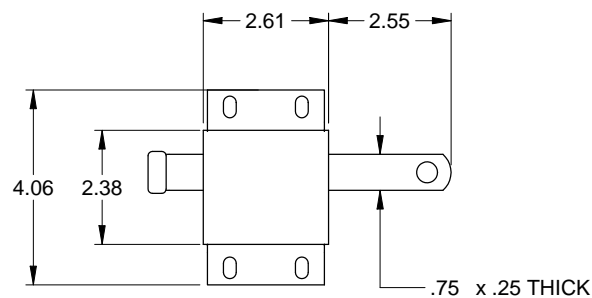
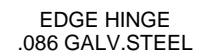
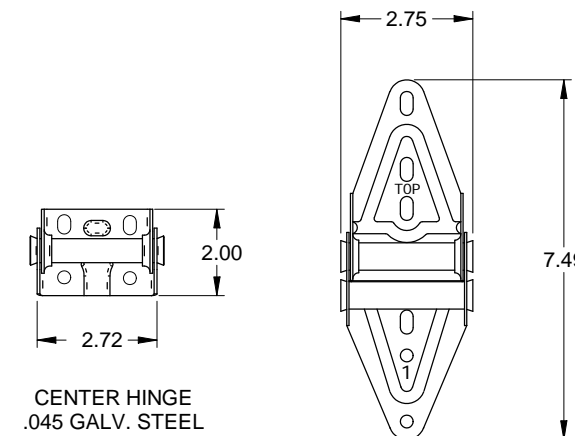
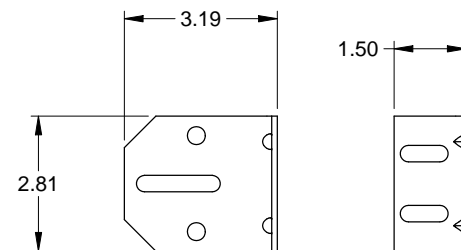
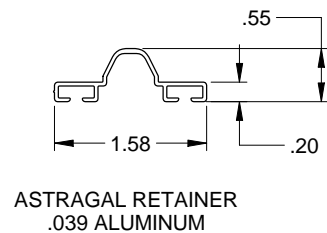
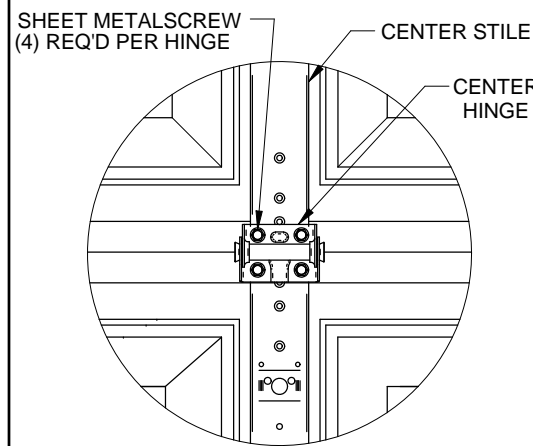

Scott A. Brown P.E.  
F.P.E #65940  
698 Timber Creek Road  
Dixon Illinois 61021

REV.	DESCRIPTION	ECO	DATE

SCALE: NONE  
DRAWN BY: G. WEDEKIND  
CHECKED BY: G. WEDEKIND  
DATE: 04/26/12  
ECO: 6338.01



TITLE:  
SPEC, WINDLOAD  
BUILDMARK / TRADEMARK

NO. P-2357

SHEET  
3 OF 3

REV  
B