

Scott A. Brown P.E.
 F.P.E #65940
 698 Timber Creek Road
 Dixon Illinois 61021

CORNER BRACKET DETAIL

REV.	DESCRIPTION	ECO	DATE	ECO: 6338.01
B	1) WAS RICHARD A BAUMANN, P.E., 2) UPDATED JAMB ATTACHMENTS	7804.01	10/02/17	
A	PRELIMINARY RELEASE	6338.01	04/20/12	

SCALE: NONE
 DRAWN BY: G. WEDEKIND
 CHECKED BY: G. WEDEKIND
 DATE: 04/20/12



TITLE:
 SPEC, WINDLOAD
 SHOWCASE, MASTERPIECE

NO. P-2365

SHEET 1 OF 3

REV B

DOORS TESTED PER ANSI/DASMA 108 FOR STATIC AIR PRESSURE DESIGN LOAD WITH NO WINDOWS + 26.4 / - 29.4 PSF DESIGN LOAD WITH (1) ROW OF WINDOWS + 18.0 / - 20.0 PSF

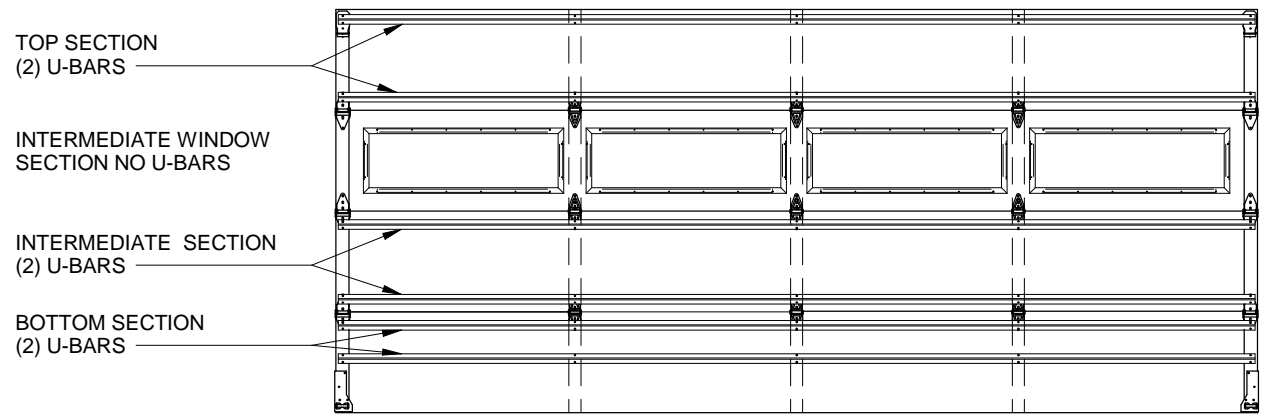

GLASS IN INTERMEDIATE SECTION
RANCH GLASS SHOWN

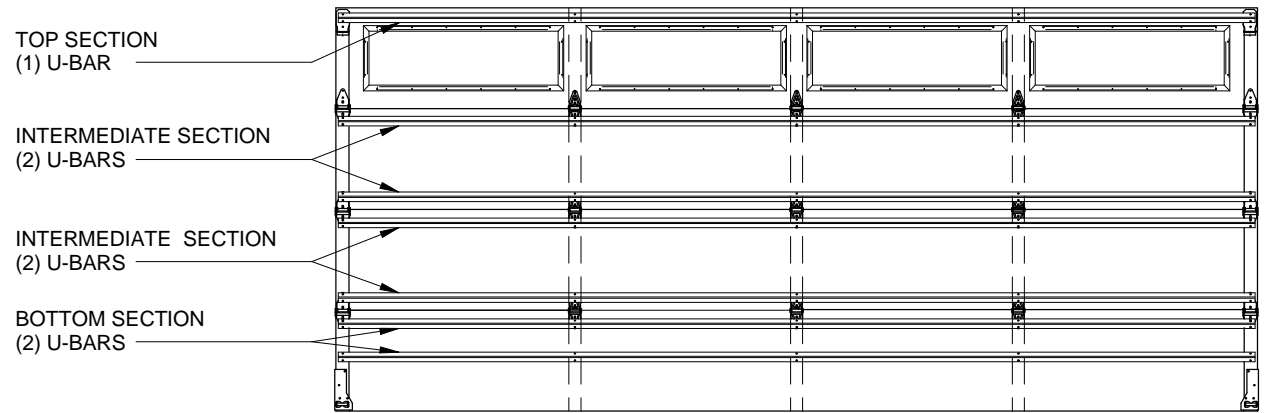

GLASS IN TOP SECTION
RANCH GLASS SHOWN

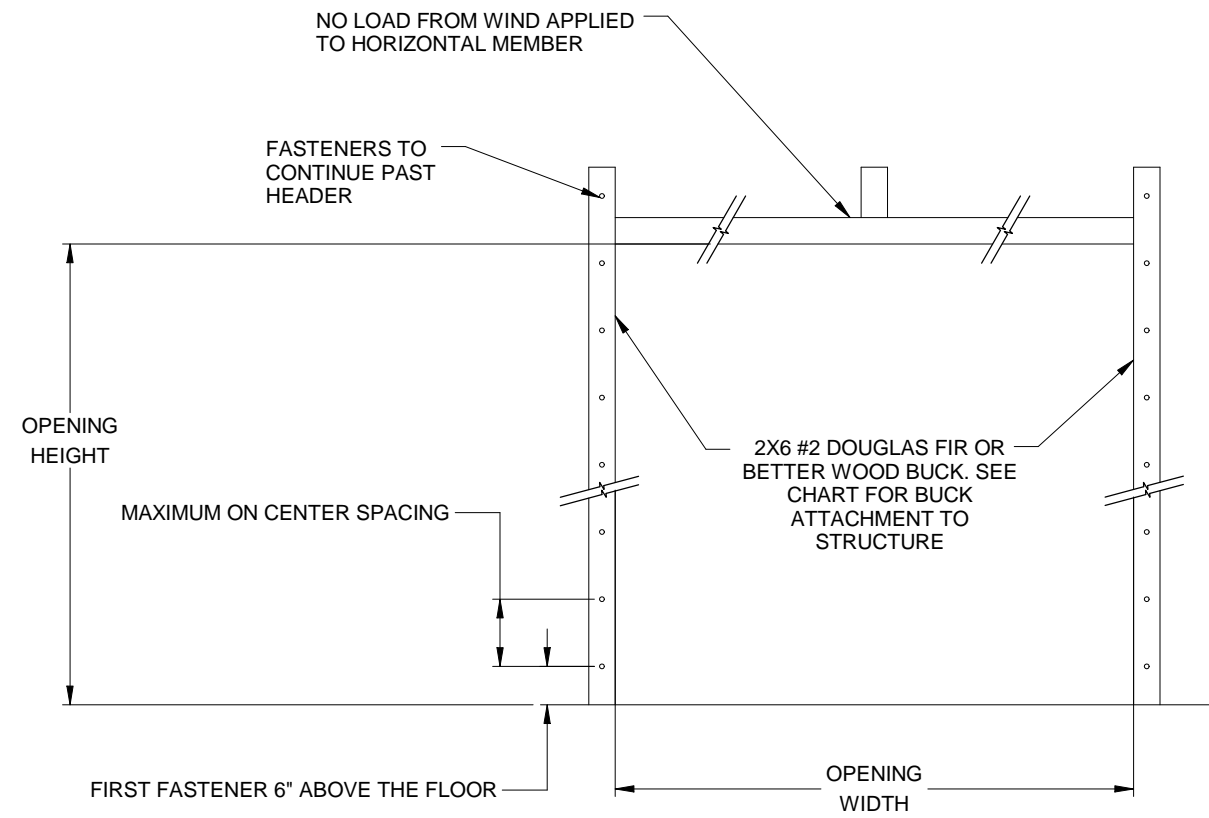

JAMB ATTACHMENT NOTES

1. MAXIMUM POSITIVE LOAD PER JAMB = (16'-0" X 26.4 PSF) / 2 = 212 LBS PER FOOT
2. MAXIMUM NEGATIVE LOAD PER JAMB = (16'-0" X -29.4 PSF) / 2 = 236 LBS PER FOOT.
3. DESIGN OF THE SUPPORTING STRUCTURE SHALL BE THE SOLE RESPONSIBILITY OF THE BUILDING DESIGNER AND SHALL BE DESIGNED FOR THE JAMB LOADS LISTED IN NOTES 1 AND 2.
4. ALTERNATE JAMB ATTACHMENTS MAY BE USED IF APPROVED BY A REGISTERED PROFESSIONAL ENGINEER.
5. DASMA TECHNICAL DATA SHEET TDS-161 MAY BE USED FOR ALTERNATE JAMB ATTACHMENTS.
6. 3/8" DIAMETER LAG SCREWS REQUIRED 1/16" PILOT HOLE AND 1-1/2" MINIMUM EDGE DISTANCE.

COLONIAL WINDOWS RANCH WINDOWS

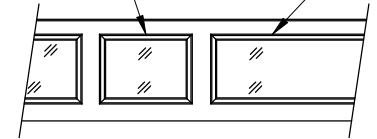

GLASS PANEL
GLASS OPTIONS:
1/8" DSB
1/8" ACRYLIC
1/2" INSULATED GLASS

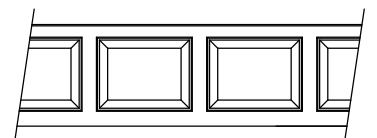

COLONIAL PANEL

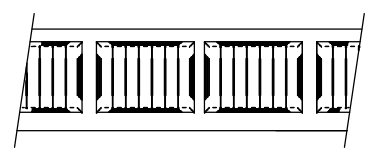

CARRIAGE HOUSE PANEL

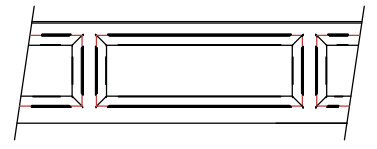

RANCH PANEL

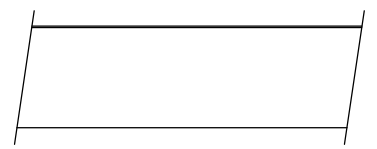

FLUSH PANEL

PANEL OPTIONS
EXTERIOR VIEW

2X6 ATTACHMENT TO STRUCTURE						
STRUCTURE TYPE	FASTENER TYPE	MINIMUM EMBEDMENT	MINIMUM EDGE DISTANCE	MINIMUM ON CENTER SPACING	DIMENSION A (MAXIMUM ON CENTER SPACING)	ALLOWABLE TENSION LOAD
2500 PSI MIN. CONCRETE	1/4" TAPCON+ (PLUS) WITH 1-1/8" OD WASHER	2"	2.5"	6"	24"	691
SOUTHERN PINE	3/8" X 3" LAG WITH 1-1/8" OD WASHER	1.50"	1.50"	1.50"	24"	655
SPRUCE PINE FIR	3/8" X 3" LAG WITH 1-1/8" OD WASHER	1.50"	1.50"	1.50"	24"	482

Scott A. Brown P.E.
F.P.E #65940
698 Timber Creek Road
Dixon Illinois 61021

SCALE: NONE	DATE: 04/20/12		
DRAWN BY: G. WEDEKIND	ECO: 6338.01		
CHECKED BY: G. WEDEKIND			
REV.	DESCRIPTION	ECO	DATE



TITLE: SPEC, WINDLOAD SHOWCASE, MASTERPIECE, TC200	
NO. P-2365	REV B
SHEET 2 OF 3	

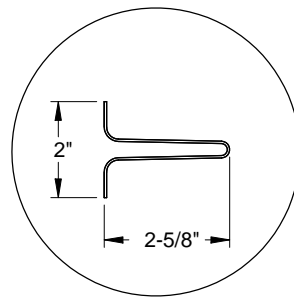

STEEL U-BAR DETAIL
18 GA. (.049" MIN) GALVANIZED
HIGH TENSILE STEEL 80 KSI MINIMUM YIELD

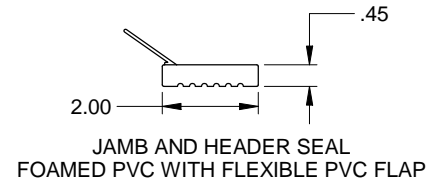

JAMB AND HEADER SEAL
FOAMED PVC WITH FLEXIBLE PVC FLAP

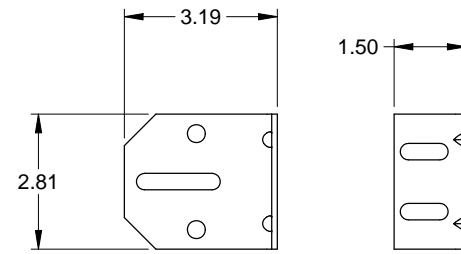

3" TRACK BRACKET
.116 GALV STEEL

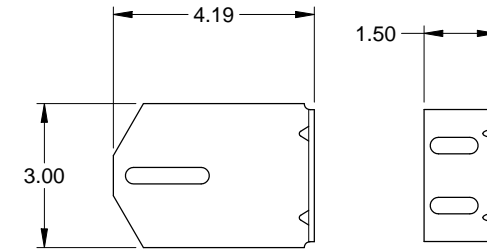

4" TRACK BRACKET
.116 GALV. STEEL

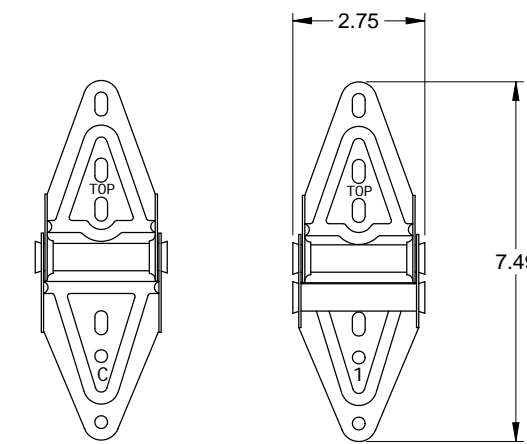

CENTER HINGE
.045 GALV. STEEL

EDGE HINGE
.086 GALV. STEEL

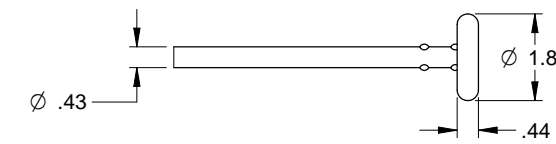

TRACK ROLLER

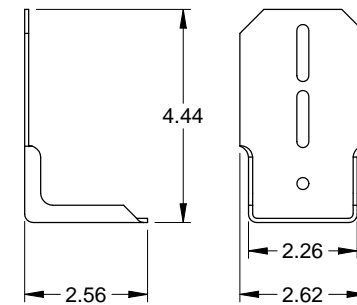

TOP FIXTURE
.086 GALV. STEEL

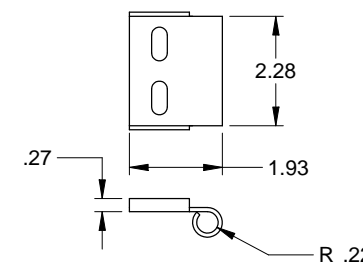

TOP ROLLER CARRIER
.086 GALV. STEEL
ATTACHED TO TOP FIXTURE WITH
(2) TRACK BOLTS AND WHIZ NUTS

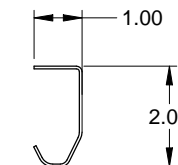

TRACK
.055 GALV. STEEL

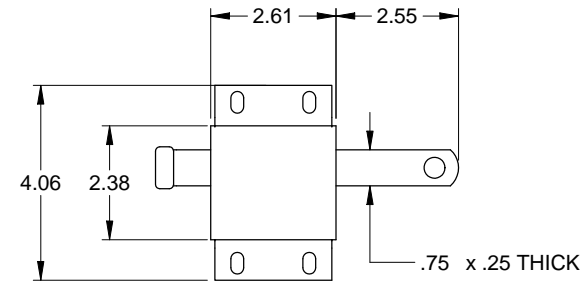

SLIDE LOCK
CASE .086 GALV. STEEL

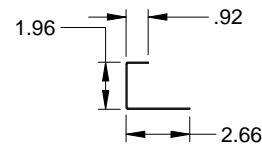

END STILE
.043 GALV. STEEL

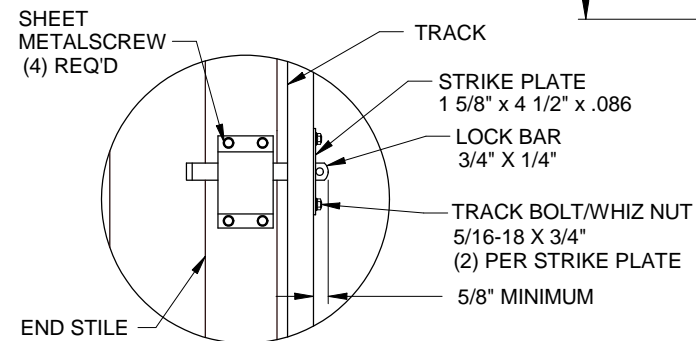

INTERIOR LOCK DETAIL

SHEET METAL SCREW (4) REQ'D
TRACK
STRIKE PLATE 1 5/8" x 4 1/2" x .086
LOCK BAR 3/4" x 1/4"
TRACK BOLT/WHIZ NUT 5/16-18 X 3/4" (2) PER STRIKE PLATE
5/8" MINIMUM
END STILE

Scott A. Brown P.E.
F.P.E #65940
698 Timber Creek Road
Dixon Illinois 61021

REV.	DESCRIPTION	ECO	DATE

SCALE: NONE	<p>1101 EAST RIVER ROAD DIXON, IL 61021</p>	TITLE: SPEC, WINDLOAD SHOWCASE, MASTERPIECE, TC200
DRAWN BY: G. WEDEKIND		NO. P-2365
CHECKED BY: G. WEDEKIND		
DATE: 04/20/12		REV B
ECO: 6338.01		

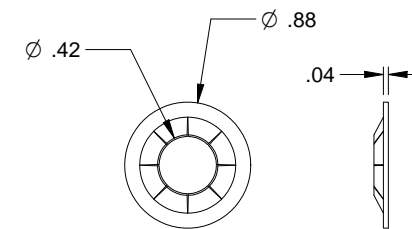

RETAINING NUT

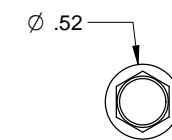

SHEET METAL SCREW

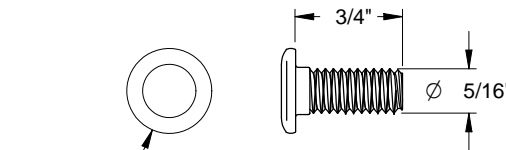

TRACK BOLT

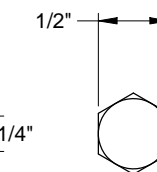

HEX HEAD LAG SCREW

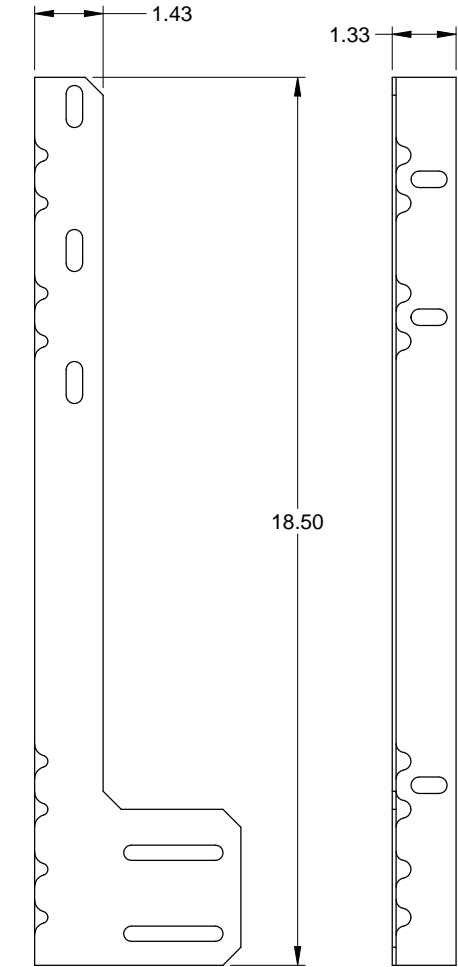

JAMB ANGLE
.078 GALV. STEEL

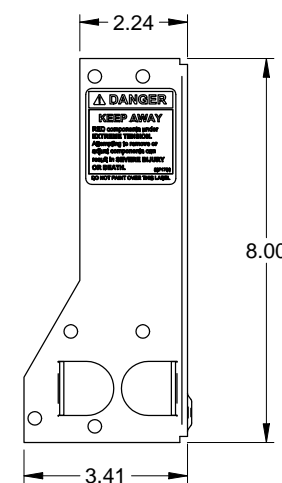

CORNER BRACKET
.086 GALV. STEEL

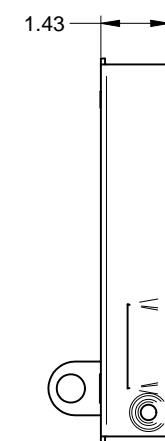

END STILE
.043 GALV. STEEL

SECTION
HEIGHT