

TRACK AND COUNTER BALANCE ASSEMBLIES WERE OMITTED FROM ALL DETAILS ON THIS PAGE FOR CLARITY. SEE SHEET 2 FOR TRACK AND COUNTER BALANCE DETAILS
 18' - 2" MAX DOOR WIDTH
 SEE SHEET 2 FOR OTHER DOOR WIDTHS

DOORS TESTED PER TAS 202 FOR STATIC AIR PRESSURE
 PER TAS 201, TAS 203 FOR LARGE MISSILE IMPACT AND CYCLIC WIND PRESSURE

DOOR WIDTH	DESIGN LOAD	
9' - 2"	+ 80.0	- 85.8
10' - 2"	+ 60.0	- 74.5
11' - 2"	+ 60.0	- 74.5
12' - 2"	+ 60.0	- 74.5
13' - 2"	+ 40.0	- 52.0
14' - 2"	+ 40.0	- 52.0
15' - 2"	+ 40.0	- 52.0
16' - 2"	+ 40.0	- 52.0
17' - 2"	+ 40.0	- 52.0
18' - 2"	+ 40.0	- 52.0

Scott A. Brown P.E.
 F.P.E #65940
 698 Timber Creek Road
 Dixon Illinois 61021

C	UPDATED JAMB ATTACHMENTS	7804.01	10/13/17	SCALE: NOTED OR NONE	DRAWN BY: G.WEDEKIND
B	RELEASED TO PRODUCTION	5807.01	06/16/10	CHECKED BY: GW	
A	PRELIMINARY RELEASE		02/25/10	DATE: 02/25/10	
REV.	DESCRIPTION	ECN NO.	DATE	ECN NO.: 5807.01	

RAYNOR
 GARAGE DOORS
BOX 448 EAST RIVER ROAD
 DIXON, ILL. 61021

TITLE: SPEC, WIND LOAD
 STEELFORM STANDARD
 24 GAUGE AND 20 GAUGE

NO. P-3313 SHEET 1 OF 4 REV C

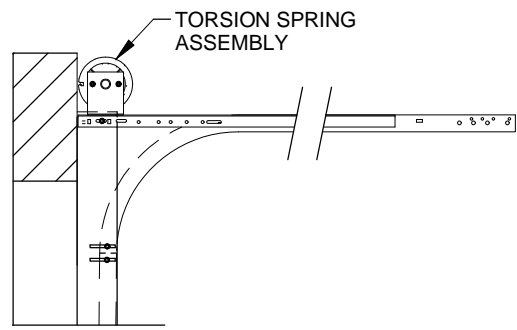

NORMAL HEADROOM TRACK
2" TRACK ANGLE MOUNT SHOWN
3" TRACK ANGLE MOUNT AVAILABLE

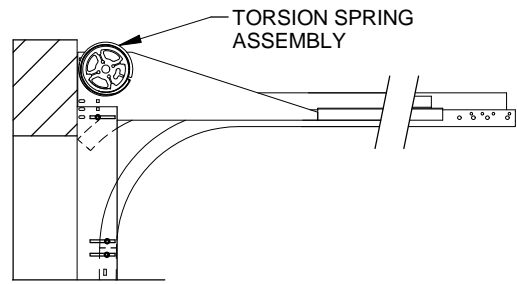

FRONT MOUNT LOW HEADROOM TRACK
2" TRACK ANGLE MOUNT SHOWN
3" TRACK ANGLE MOUNT AVAILABLE

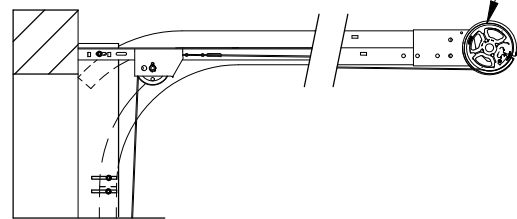

REAR MOUNT LOW HEADROOM TRACK
2" TRACK ANGLE MOUNT SHOWN
3" TRACK ANGLE MOUNT AVAILABLE

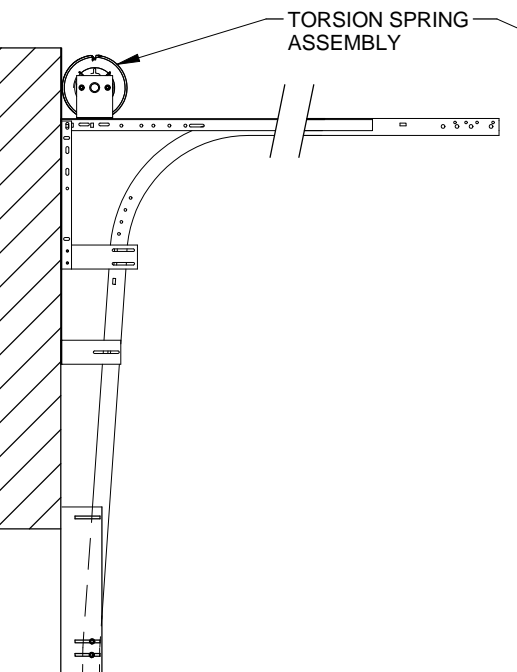

LIFT CLEARANCE TRACK
2" TRACK ANGLE MOUNT SHOWN
3" TRACK ANGLE MOUNT AVAILABLE

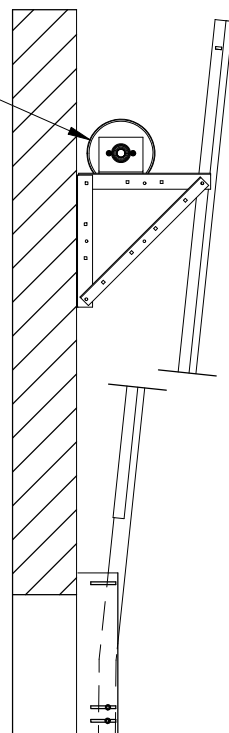

VERTICAL LIFT TRACK
2" TRACK ANGLE MOUNT SHOWN
3" TRACK ANGLE MOUNT AVAILABLE

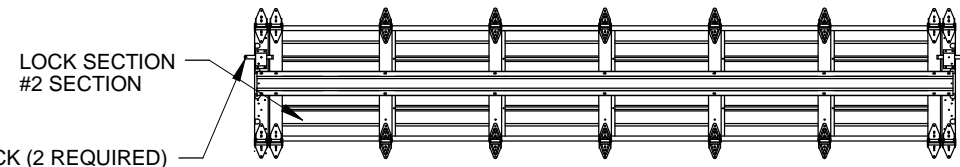

INTERIOR SLIDE LOCK (2 REQUIRED)
LOCATE ON #2 SECTION AND
ATTACHED WITH (4) 1/4" X 5/8"
SELF TAPPING SCREWS.

12'-2" WIDE SECTION SHOWN
REQUIRED ON ALL DOOR WIDTHS

INTERIOR LOCK SECTION DETAIL

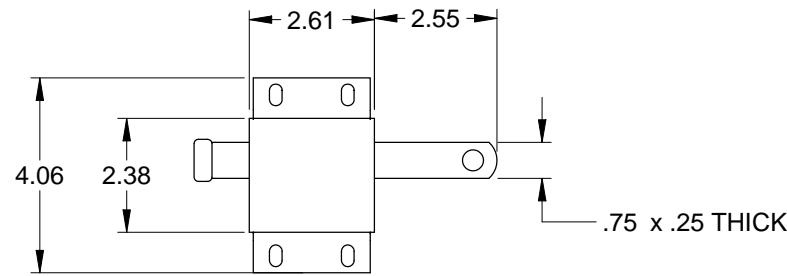

SLIDE LOCK
CASE .086 GALV. STEEL

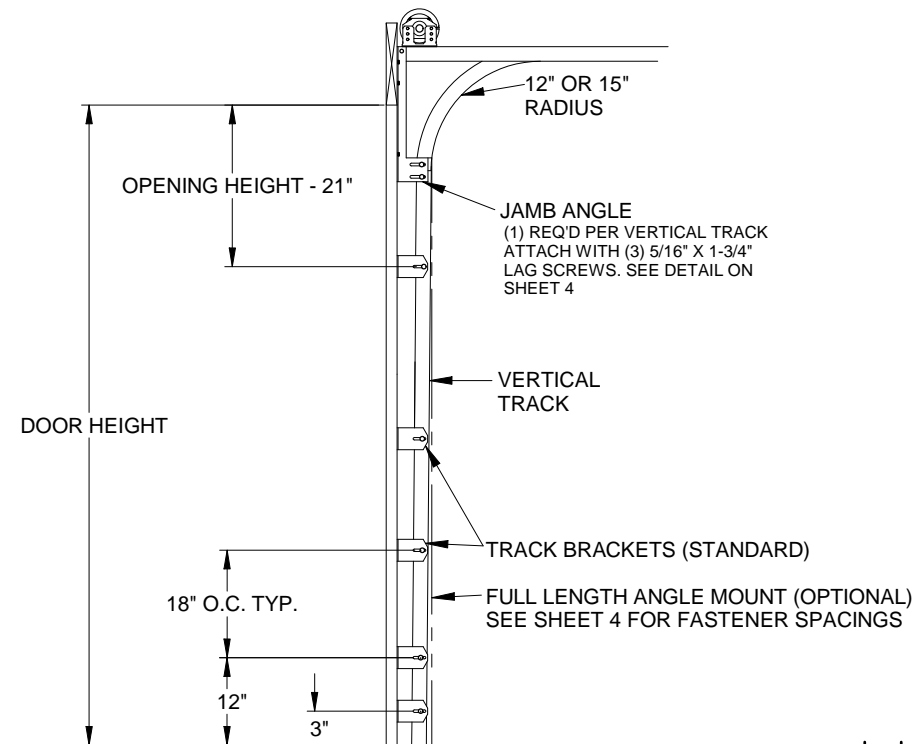
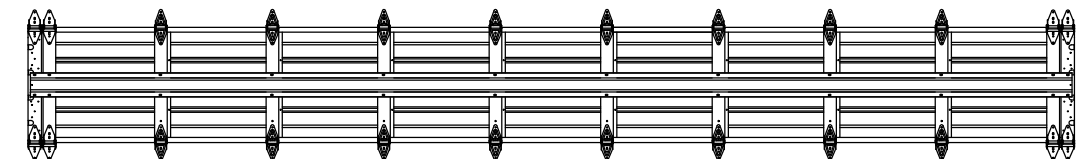
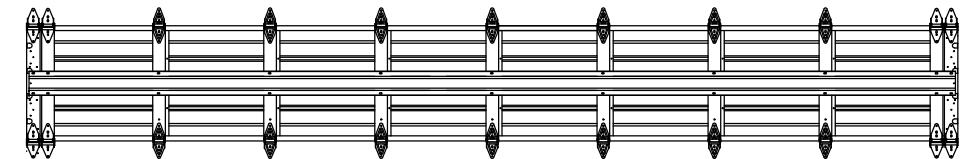
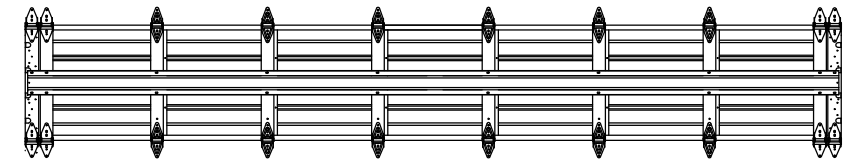
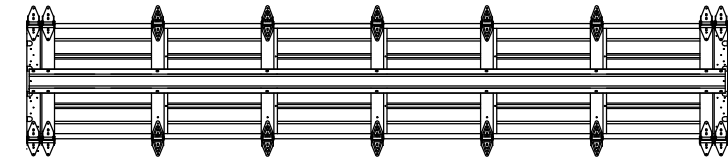
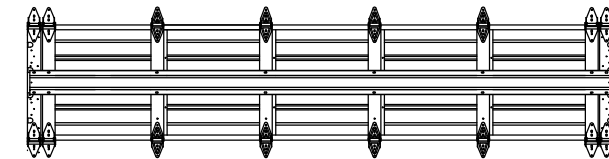
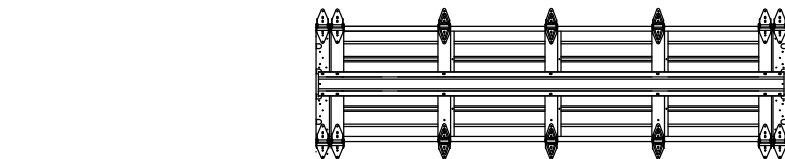

TYPICAL TRACK INSTALLATION

SCALE: NOTED OR NONE	 BOX 448 EAST RIVER ROAD DIXON, ILL. 61021	TITLE: SPEC, WIND LOAD STEELFORM STANDARD 24 GAUGE AND 20 GAUGE	
DRAWN BY: G.WEDEKIND		NO. P-3313	SHEET 2 OF 4
CHECKED BY: GW		REV C	
DATE: 02/25/10			
REV.	DESCRIPTION	ECN NO.	DATE

Scott A. Brown P.E.
F.P.E #65940
698 Timber Creek Road
Dixon Illinois 61021

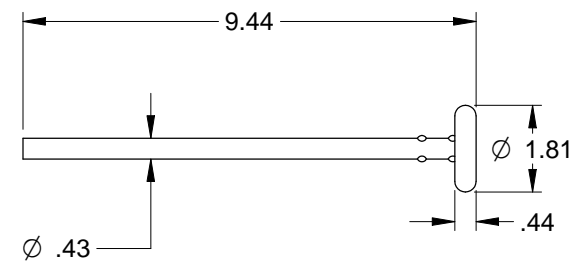

SCALE 1:2
TRACK ROLLER

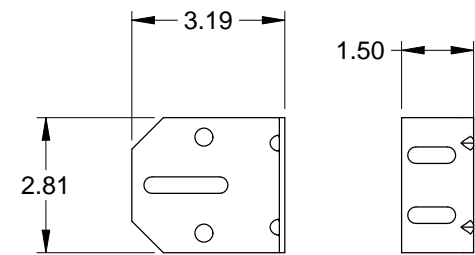

SCALE 1:2
3" TRACK BRACKET
.116 GALV. STEEL

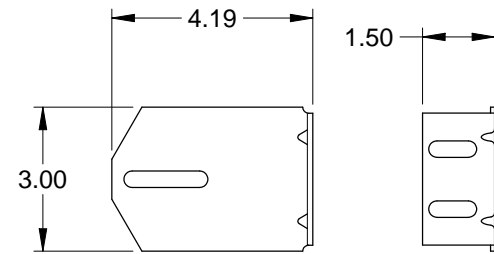

SCALE 1:2
4" TRACK BRACKET
.116 GALV. STEEL

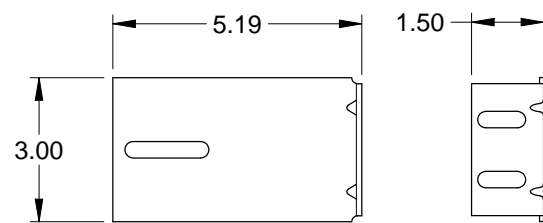

SCALE 1:2
5" TRACK BRACKET
.116 GALV. STEEL

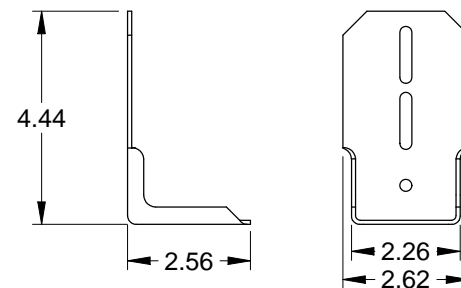

SCALE 1:2
LIGHT COMMERCIAL TOP FIXTURE
.086 GALV. STEEL

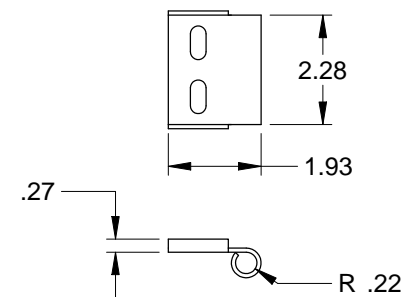

SCALE 1:2
ROLLER CARRIER
.116 GALV. STEEL
ATTACHED TO LIGHT COMMERCIAL TOP FIXTURE
WITH (2) TRACK BOLTS AND WHIZ NUTS

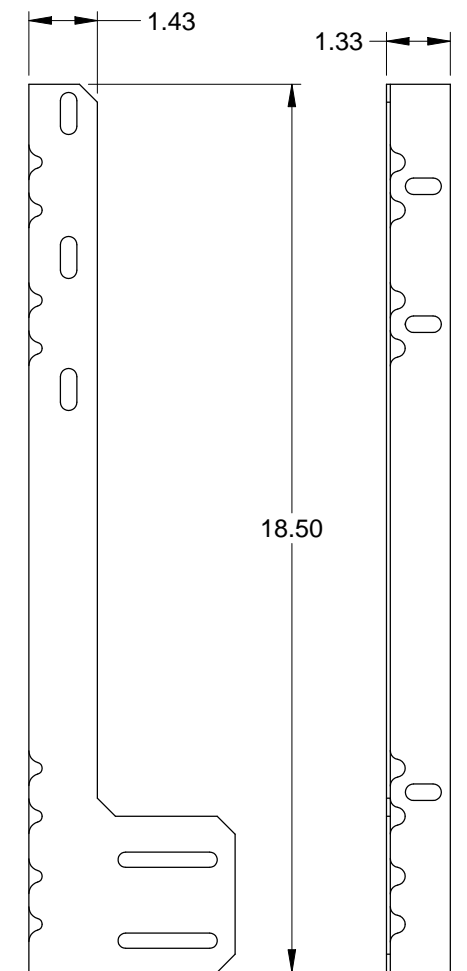

SCALE 1:2
JAMB ANGLE
.078 GALV. STEEL

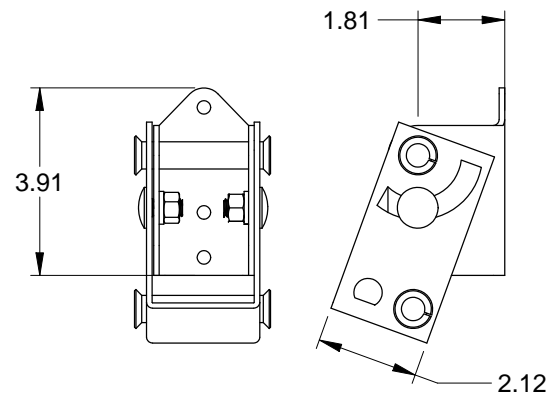

SCALE 1:2
HEAVY COMMERCIAL TOP FIXTURE
.116 GALV. STEEL

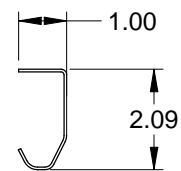

SCALE 1:2
2" TRACK
.086 GALV. STEEL

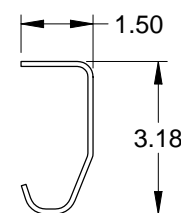

SCALE 1:2
3" TRACK (OPTIONAL)
.105 GALV. STEEL

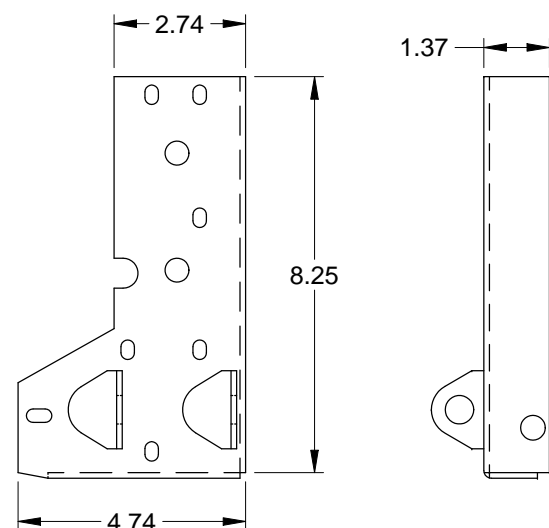

SCALE 1:2
CORNER BRACKET
.116 GALV. STEEL

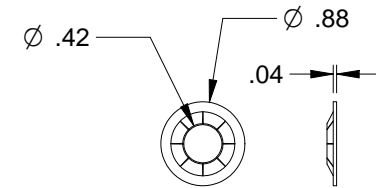

SCALE: 1:1
RETAINING NUT

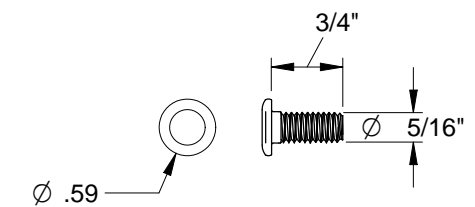

SCALE 1:1
TRACK BOLT

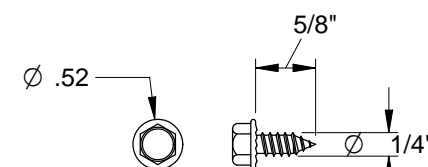

SCALE: 1:1
SHEET METAL SCREW

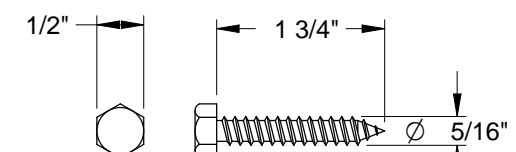

SCALE: 1:1
HEX HEAD LAG SCREW

Scott A. Brown P.E.
F.P.E #65940
698 Timber Creek Road
Dixon Illinois 61021

REV.	DESCRIPTION	ECN. NO.	DATE	SCALE: NOTED OR NONE	DRAWN BY: G.WEDEKIND	RAYNOR GARAGE DOORS <small>BOX 448 EAST RIVER ROAD DIXON, ILL. 61021</small>	TITLE: SPEC, WIND LOAD STEELFORM STANDARD 24 GAUGE AND 20 GAUGE NO. P-3313	SHEET	REV
				CHECKED BY: GW	3 OF 4			C	
				DATE: 02/25/10					
				ECN. NO.:					

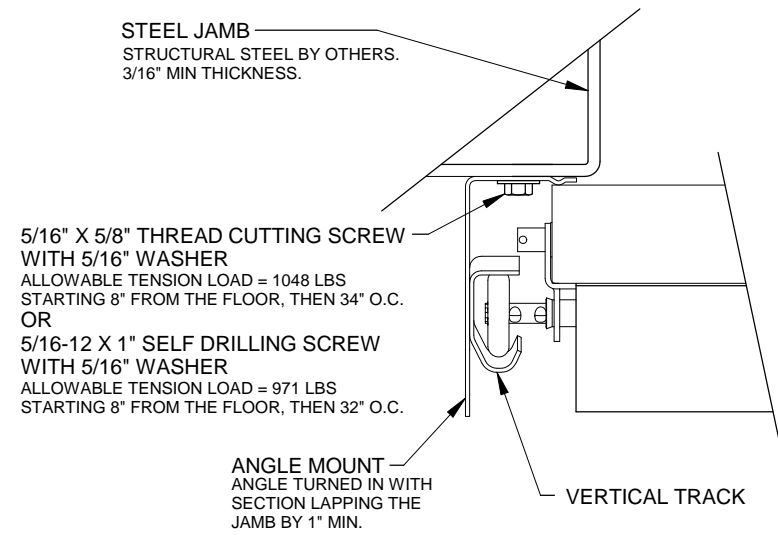

TRACK ASSEMBLY ATTACHMENT TO STEEL JAMB
2" TRACK ANGLE MOUNT TURNED IN SHOWN
3" TRACK ANGLE MOUNT AVAILABLE

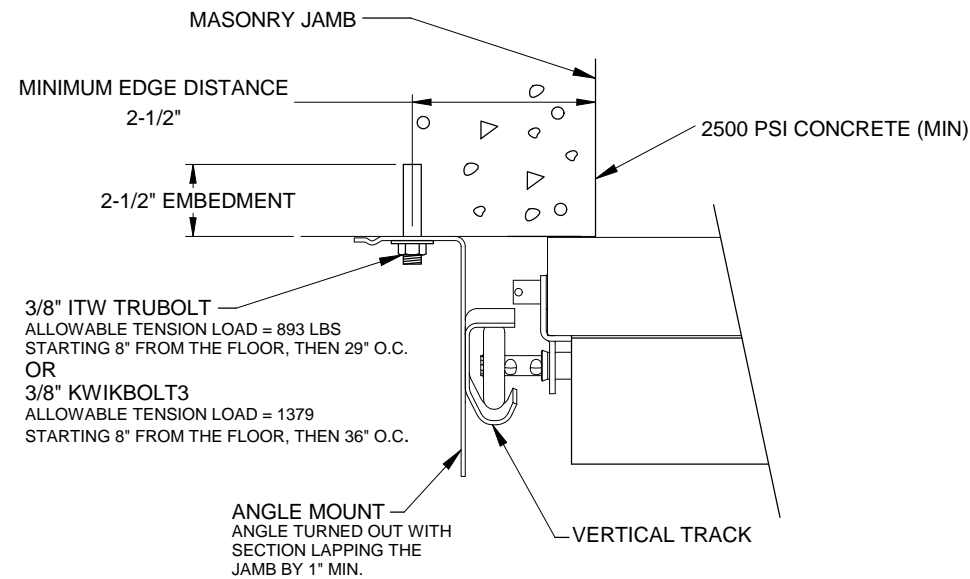

TRACK ASSEMBLY ATTACHMENT TO MASONRY JAMB
2" TRACK ANGLE MOUNT TURNED OUT SHOWN
3" TRACK ANGLE MOUNT AVAILABLE

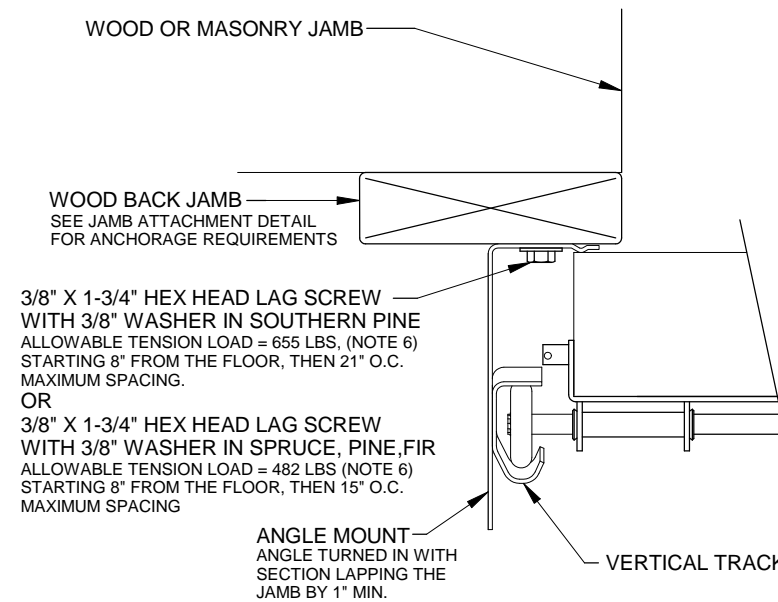

TRACK ASSEMBLY ATTACHMENT TO WOOD BACK JAMB
2" TRACK ANGLE MOUNT TURNED IN SHOWN
3" TRACK ANGLE MOUNT AVAILABLE

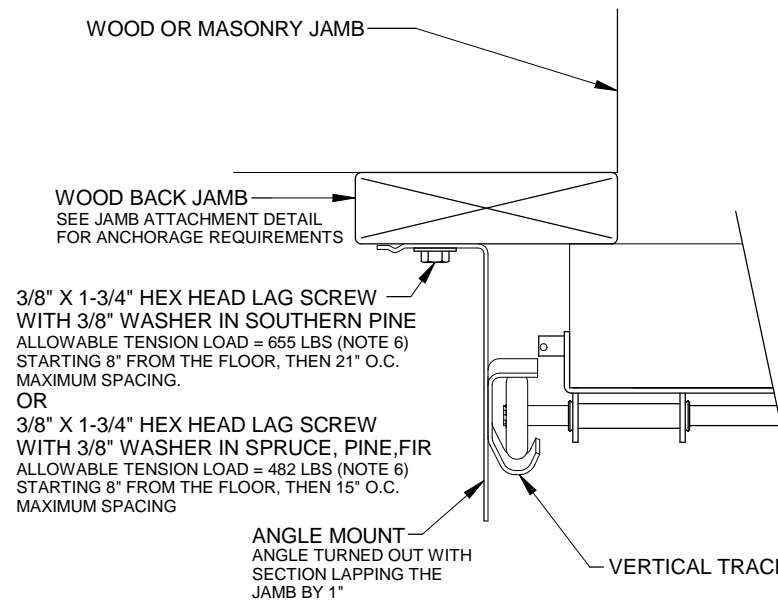

TRACK ASSEMBLY ATTACHMENT TO WOOD BACK JAMB
2" TRACK ANGLE MOUNT TURNED OUT SHOWN
3" TRACK ANGLE MOUNT AVAILABLE

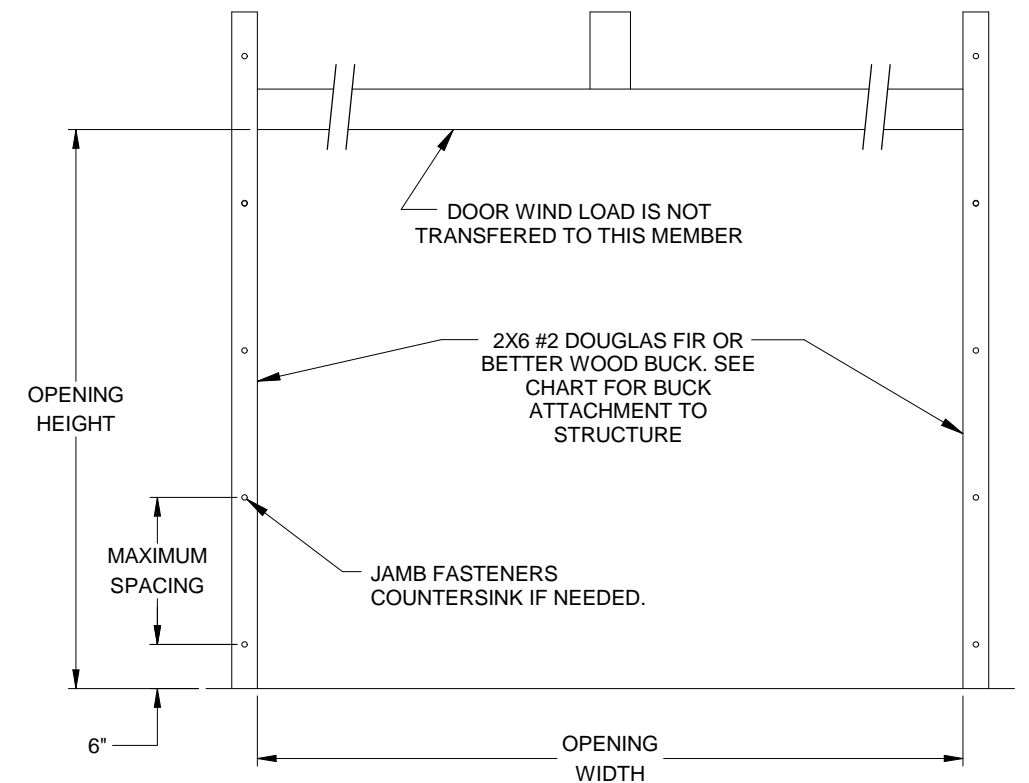

JAMB ATTACHMENT

JAMB ATTACHMENT NOTES

1. MAXIMUM POSITIVE LOAD PER JAMB = (18'-2" X 40.0 PSF) / 2 = 363 LBS PER FOOT
2. MAXIMUM NEGATIVE LOAD PER JAMB = (18'-2" X -52.0 PSF) / 2 = 473 LBS PER FOOT.
3. DESIGN OF THE SUPPORTING STRUCTURE SHALL BE THE SOLE RESPONSIBILITY OF THE BUILDING DESIGNER AND SHALL BE DESIGNED FOR THE JAMB LOADS LISTED IN NOTES 1 AND 2.
4. ALTERNATE JAMB ATTACHMENTS MAY BE USED IF APPROVED BY A REGISTERED PROFESSIONAL ENGINEER.
5. DASMA TECHNICAL DATA SHEET TDS-161 MAY BE USED FOR ALTERNATE JAMB ATTACHMENTS.
6. 3/8" DIAMETER LAG SCREWS REQUIRED 1/16" PILOT HOLE AND 1-1/2" MINIMUM EDGE DISTANCE.

2X6 ATTACHMENT TO STRUCTURE						
STRUCTURE TYPE	FASTENER TYPE	MINIMUM EMBEDMENT	MINIMUM EDGE DISTANCE	MINIMUM ON CENTER SPACING	DIMENSION A (MAXIMUM ON CENTER SPACING)	ALLOWABLE TENSION LOAD
2500 PSI MIN. CONCRETE	1/4" TAPCON+ (PLUS) WITH 1-1/8" OD WASHER	2"	2.5	6"	22"	691
SOUTHERN PINE	3/8" X 3" LAG WITH 1-1/8" OD WASHER	1.50"	1.50"	1.50"	21"	655
SPRUCE PINE FIR	3/8" X 3" LAG WITH 1-1/8" OD WASHER	1.50"	1.50"	1.50"	15"	482