

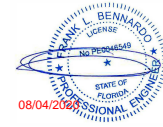

# STRUCTALL BUILDING SYSTEMS

## SNAP-N-LOCK FOAM CORE ROOF PANELS - 3", 4", 6" ALUMINIUM & STEEL SPANS

FRANK BENNARDO PE  
PE# 0046549 CA# 9885



08/04/2020

FL#15491.1

**ENGINEERING EXPRESS**  
CORPORATE OFFICE:  
160 SW 12th AVE, SUITE 106  
DEERFIELD BEACH, FL 33442  
(954) 354-0660 | (866) 396-9999  
TEAM@ENGINEERINGEXPRESS.COM  
ENGINEERINGEXPRESS.COM

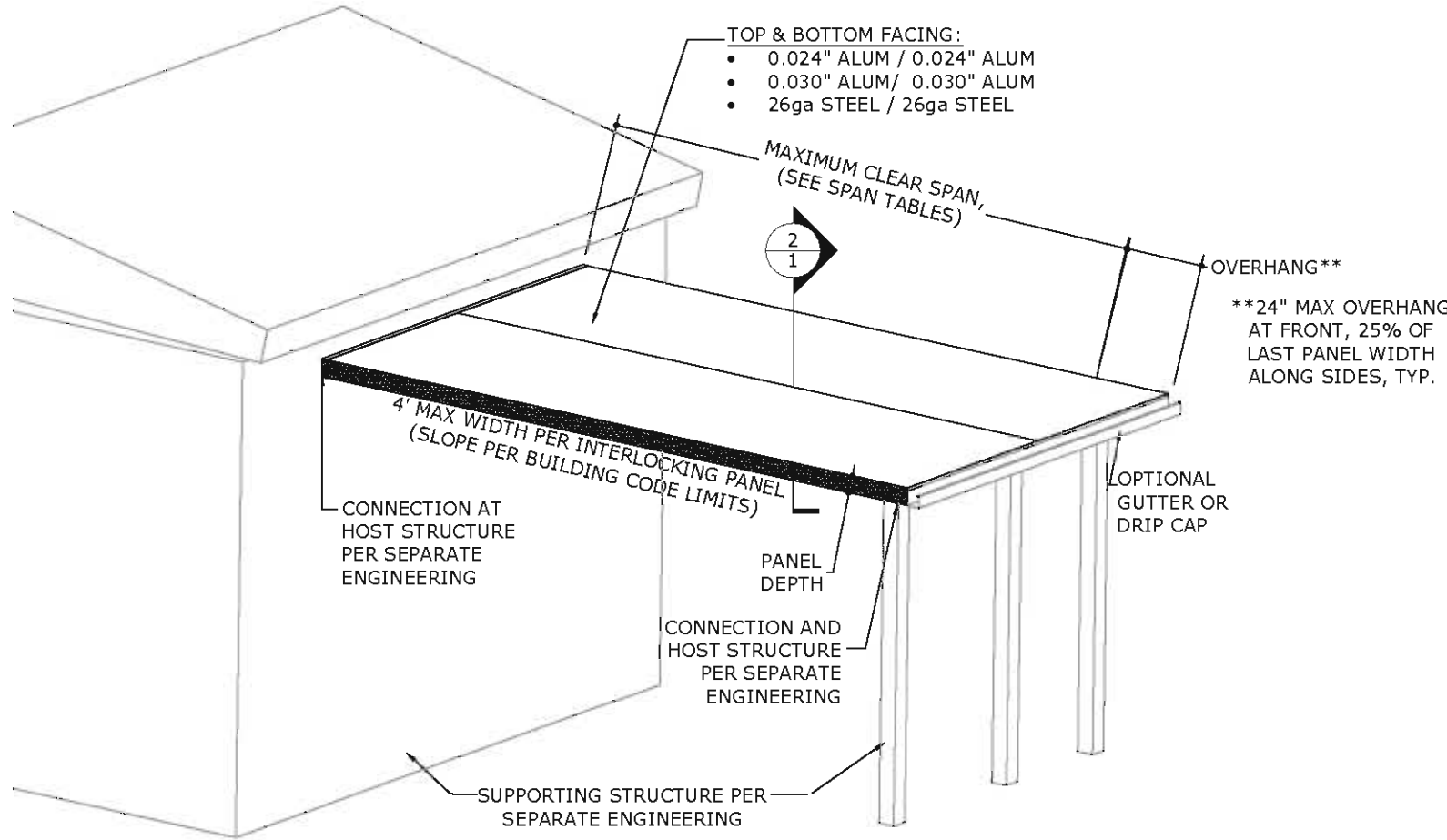

**1 CLEAR SPAN ISOMETRIC**  
1 N.T.S. TYPICAL USE EXAMPLE, MAY VARY

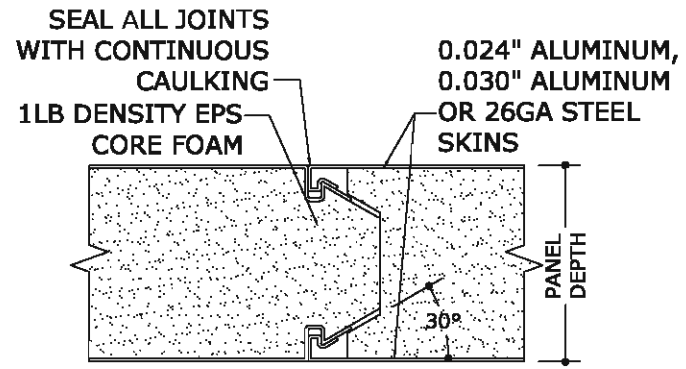

**2 SNAP-N-LOCK PANEL INTERLOCK DETAIL**  
1 N.T.S. DETAIL

### MAXIMUM ALLOWABLE DESIGN PRESSURES:

VARIES AS NOTED IN CLEAR SPAN TABLES

### DESIGN NOTES:

1. POSITIVE AND NEGATIVE DESIGN PRESSURES CALCULATED FOR USE WITH THIS SYSTEM SHALL BE DETERMINED BY OTHERS ON A JOB-SPECIFIC BASIS IN ACCORDANCE WITH THE STRUCTURAL REQUIREMENTS OF THE 7TH EDITION FLORIDA BUILDING CODE (2020) AS WELL AS CURRENT VERSIONS OF THE FLORIDA RESIDENTIAL CODE, INTERNATIONAL BUILDING CODE AND THE INTERNATIONAL RESIDENTIAL CODE.
2. SEPARATE 'SITE-SPECIFIC' SEALED ENGINEERING SHALL BE REQUIRED IN ORDER TO DEVIATE FROM LOADS, DEFLECTIONS, OR SPANS CONTAINED HEREIN. LINEAR INTERPOLATION OF THE ALLOWABLE SPAN TABLES LISTED HEREIN SHALL NOT BE PERMITTED. CONTACT THIS FIRM FOR ALTERNATE SPAN CALCULATIONS AS MAY BE REQUIRED OR VISIT THE EMAIL/QR BELOW.
3. EPS CORE COMPOSITE PANELS SHALL BE CONSTRUCTED USING TYPE 3105-H254 ALUMINUM FACINGS OR ASTM A653, CS, TYPE B HOT DIP GALVANIZED G90 COATED STEEL FACINGS. EXPANDED POLYSTYRENE FOAM SHALL HAVE TYPICAL DENSITY OF 1.0 PCF. THE EPS FOAM SHALL BE ADHERED TO THE ALUMINUM FACING WITH MORAD M640 SERIES ADHESIVE (BY ROHM AND HAAS COMPANY). FABRICATION SHALL BE IN ACCORDANCE WITH APPROVED FABRICATION METHODS BY MANUFACTURER FOR ALL PANELS. REFER TO MANUFACTURER SPECS FOR MORE INFORMATION.
4. IF APPLICABLE, COMPOSITE ROOF PANELS SHALL COMPLY WITH CHAPTER 7 SECTION 720, CHAPTER 8 SECTION 803, CLASS A INTERIOR FINISH, AND CHAPTER 26 SECTION 2603 OF THE FBC.
5. EPS PANEL PERFORMANCE CHARACTERISTICS FOR SELF IGNITION, FLAME SPREAD AND SMOKE DENSITY HAVE BEEN QUALIFIED THROUGH APPLICABLE ASTM TEST STANDARDS AND SHALL BE PROVIDED BY THE MANUFACTURER AS REQUIRED.
6. DESIGN PRESSURES AS NOTED HEREIN ARE BASED ON A MAXIMUM TESTED PRESSURE DIVIDED BY A 2.0 FACTOR OF SAFETY. FOR ALTERNATE SAFETY FACTORS, SPANS SHALL BE ADJUSTED ACCORDINGLY.

### GENERAL NOTES:

1. THIS SPECIFICATION HAS BEEN DESIGNED AND SHALL BE FABRICATED IN ACCORDANCE WITH THE REQUIREMENTS OF THE 7TH EDITION FLORIDA BUILDING CODE (2020).
2. THIS DOCUMENT IS ONLY VALID WITH ORIGINAL SIGNATURE AND SEAL OR DIGITAL SIGNATURE OF A P.E. OF THIS FIRM.
3. CONTRACTOR SHALL INVESTIGATE AND CONFORM TO ALL LOCAL BUILDING CODE AMENDMENTS WHICH MAY APPLY. DESIGN CRITERIA BEYOND AS STATED HEREIN MAY REQUIRE ADDITIONAL SITE-SPECIFIC SEALED ENGINEERING.
4. THE ARCHITECT/ENGINEER OF RECORD FOR THE PROJECT SUPERSTRUCTURE WITH WHICH THIS DESIGN IS USED SHALL BE RESPONSIBLE FOR THE INTEGRITY OF ALL SUPPORTING SURFACES TO THIS DESIGN WHICH SHALL BE COORDINATED BY THE PERMITTING CONTRACTOR.
5. THE SYSTEM DETAILED HEREIN IS GENERIC AND DOES NOT PROVIDE INFORMATION FOR A SPECIFIC SITE. FOR SITE CONDITIONS DIFFERENT FROM THE CONDITIONS DETAILED HEREIN, A LICENSED ENGINEER OR REGISTERED ARCHITECT SHALL PREPARE SITE SPECIFIC DOCUMENTS FOR USE IN CONJUNCTION WITH THIS DOCUMENT. THIS DOCUMENT ALONE IS NOT INTENDED FOR PERMIT.
6. THE CONTRACTOR SHALL CAREFULLY CONSIDER POSSIBLE IMPOSING LOADS ON ROOF, INCLUDING BUT NOT LIMITED TO ANY CONCENTRATED LOADS WHICH MAY JUSTIFY GREATER DESIGN CRITERIA. THIS ADDITIONAL ROOF LOAD CRITERIA SHALL BE PROPERLY ANALYZED BY A LICENSED ENGINEER OR REGISTERED ARCHITECT.
7. THE CONTRACTOR IS RESPONSIBLE TO INSULATE ALL MEMBERS FROM DISSIMILAR MATERIALS TO PREVENT ELECTROLYSIS.
8. ENGINEER SEAL AFFIXED HERE TO VALIDATES STRUCTURAL DESIGN AS SHOWN ONLY. USE OF THIS SPECIFICATION BY CONTRACTOR, et. al. INDEMNIFIES & SAVES HARMLESS THIS ENGINEER FOR ALL COST & DAMAGES INCLUDING LEGAL FEES & APPELLATE FEES RESULTING FROM MATERIAL FABRICATION, SYSTEM ERECTION, & CONSTRUCTION PRACTICES BEYOND THAT WHICH IS CALLED FOR BY LOCAL, STATE, & FEDERAL CODES & FROM DEVIATIONS OF THIS PLAN.
9. EXCEPT AS EXPRESSLY PROVIDED HEREIN, NO ADDITIONAL CERTIFICATIONS OR AFFIRMATIONS ARE INTENDED.
10. ALTERATIONS, ADDITIONS, OR OTHER MARKINGS TO THIS DOCUMENT ARE NOT PERMITTED AND INVALIDATE THIS CERTIFICATION.

VISIT [ECALC.IO/26243](http://ECALC.IO/26243)

FOR SITE SPECIFIC DEVIATIONS & MORE INFORMATION ABOUT THIS DOCUMENT OR SCAN THIS QR CODE

VISIT [ENGINEERINGEXPRESS.COM/STRUCTALL](http://ENGINEERINGEXPRESS.COM/STRUCTALL) FOR ADDITIONAL PLANS, REPORTS & RESOURCES



**STRUCTALL BUILDING SYSTEMS, INC.**  
350 BURBANK RD  
OLDSMAR, FL  
(813) 855-2627

FL15491 - EPS FOAM CORE COMPOSITE PANEL  
3IN, 4IN & 6IN WITH ALUMINIUM OR STEEL SKINS  
PRODUCT APPROVAL #FL15941.1

REMARKS	DRWN	CHKD	DATE
INIT ISSUE	JC	RN	06/04/20

THIS DOCUMENT IS THE PROPERTY OF ENGINEERING EXPRESS AND SHALL NOT BE REPRODUCED IN WHOLE OR PART WITHOUT WRITTEN CONSENT OF ENGINEERING EXPRESS. ALTERATIONS, ADDITIONS OR OTHER MARKINGS TO THIS DOCUMENT ARE NOT PERMITTED AND INVALIDATE OUR CERTIFICATION.

COPYRIGHT ENGINEERING EXPRESS®

20-26243

SCALE: NTS UNLESS NOTED

1 OF 2

C:\Users\colby\Engineering\Express\Production - Documents\Projects\20-26243 - FL15491 - EPS Foam Core Comp Panel.3,4,6in with Alum or Steel Skins\WP\2020\FBC\20-26243g-Dwg-FL15491.1-FB.dwg 08/04/2020 - 6:10pm colby

MAXIMUM ALLOWABLE CLEAR SPAN TABLE:

Total Load*	Deflection Limit (L/...)	3" Panels		4" Panels			6" Panels		
		0.024" Alum Skin	0.030" Alum Skin	0.024" Alum Skin	0.030" Alum Skin	26ga Steel Skin	0.024" Alum Skin	0.030" Alum Skin	26ga Steel Skin
		1-LB EPS	1-LB EPS	1-LB EPS	1-LB EPS	1-LB EPS	1-LB EPS	1-LB EPS	1-LB EPS
+/- 10 PSF	80	16'-11"	16'-0"	20'-0"	20'-0"	20'-2"	22'-1"	24'-0"	23'-0"
	120	14'-10"	16'-0"	17'-6"	19'-9"	20'-2"	21'-9"	24'-0"	23'-0"
	180	12'-11"	16'-0"	15'-3"	17'-3"	18'-5"	19'-0"	21'-4"	22'-9"
	240	11'-9"	15'-8"	13'-11"	15'-8"	16'-9"	17'-3"	19'-5"	20'-8"
+/- 15 PSF	80	14'-2"	16'-0"	16'-5"	17'-7"	16'-6"	18'-0"	20'-2"	20'-4"
	120	12'-11"	16'-0"	15'-3"	17'-3"	16'-6"	18'-0"	20'-2"	20'-4"
	180	11'-3"	15'-1"	13'-4"	15'-1"	16'-1"	16'-7"	18'-8"	19'-11"
	240	10'-3"	13'-8"	12'-1"	13'-8"	14'-8"	15'-1"	16'-11"	18'-1"
+/- 20 PSF	80	12'-3"	13'-10"	14'-3"	15'-3"	14'-3"	15'-7"	17'-5"	17'-8"
	120	11'-9"	13'-10"	13'-11"	15'-3"	14'-3"	15'-7"	17'-5"	17'-8"
	180	10'-3"	13'-8"	12'-1"	13'-8"	14'-3"	15'-1"	16'-11"	17'-8"
	240	9'-4"	12'-5"	11'-0"	12'-5"	13'-3"	13'-8"	15'-4"	16'-5"
+/- 25 PSF	80	10'-11"	12'-5"	12'-9"	13'-8"	12'-9"	14'-0"	15'-7"	15'-9"
	120	10'-11"	12'-5"	12'-9"	13'-8"	12'-9"	14'-0"	15'-7"	15'-9"
	180	9'-6"	12'-5"	11'-3"	12'-8"	12'-9"	14'-0"	15'-7"	15'-9"
	240	8'-8"	11'-6"	10'-3"	11'-6"	12'-4"	12'-8"	14'-3"	15'-3"
+/- 30 PSF	80	10'-0"	11'-4"	11'-7"	12'-5"	11'-8"	12'-9"	14'-3"	14'-5"
	120	10'-0"	11'-4"	11'-7"	12'-5"	11'-8"	12'-9"	14'-3"	14'-5"
	180	8'-11"	11'-4"	10'-7"	11'-11"	11'-8"	12'-9"	14'-3"	14'-5"
	240	8'-2"	10'-10"	9'-7"	10'-10"	11'-7"	11'-11"	13'-5"	14'-4"
+/- 35 PSF	80	9'-3"	10'-5"	10'-9"	11'-6"	10'-9"	11'-9"	13'-2"	13'-4"
	120	9'-3"	10'-5"	10'-9"	11'-6"	10'-9"	11'-9"	13'-2"	13'-4"
	180	8'-6"	10'-5"	10'-1"	11'-4"	10'-9"	11'-9"	13'-2"	13'-4"
	240	7'-9"	10'-4"	9'-2"	10'-4"	10'-9"	11'-4"	12'-9"	13'-4"
+/- 40 PSF	80	8'-8"	9'-9"	10'-1"	10'-9"	10'-1"	11'-0"	12'-4"	12'-5"
	120	8'-8"	9'-9"	10'-1"	10'-9"	10'-1"	11'-0"	12'-4"	12'-5"
	180	8'-2"	9'-9"	9'-7"	10'-9"	10'-1"	11'-0"	12'-4"	12'-5"
	240	7'-5"	9'-9"	8'-9"	9'-10"	10'-1"	10'-10"	12'-2"	12'-5"
+/- 45 PSF	80	8'-2"	9'-3"	9'-6"	10'-2"	9'-6"	10'-5"	11'-7"	11'-9"
	120	8'-2"	9'-3"	9'-6"	10'-2"	9'-6"	10'-5"	11'-7"	11'-9"
	180	7'-10"	9'-3"	9'-3"	10'-2"	9'-6"	10'-5"	11'-7"	11'-9"
	240	7'-1"	9'-3"	8'-5"	9'-6"	9'-6"	10'-5"	11'-7"	11'-9"
+/- 50 PSF	80			9'-0"	9'-7"	9'-0"	9'-10"	11'-0"	11'-2"
	120			9'-0"	9'-0"	9'-0"	9'-10"	11'-0"	11'-2"
	180			8'-11"	8'-11"	9'-0"	9'-10"	11'-0"	11'-2"
	240			8'-1"	8'-1"	9'-0"	9'-10"	11'-0"	11'-2"
+/- 55 PSF	80			8'-7"	8'-7"	8'-7"	9'-5"	10'-6"	10'-7"
	120			8'-7"	8'-7"	8'-7"	9'-5"	10'-6"	10'-7"
	180			8'-7"	8'-7"	8'-7"	9'-5"	10'-6"	10'-7"
	240			7'-10"	8'-10"	8'-7"	9'-5"	10'-6"	10'-7"
+/- 60 PSF	80			8'-2"	8'-9"	8'-3"	9'-0"	10'-1"	10'-2"
	120			8'-2"	8'-9"	8'-3"	9'-0"	10'-1"	10'-2"
	180			8'-2"	8'-9"	8'-3"	9'-0"	10'-1"	10'-2"
	240			7'-7"	8'-7"	8'-3"	9'-0"	10'-1"	10'-2"
+/- 65 PSF	80			7'-9"	7'-9"	7'-11"	8'-8"	9'-8"	9'-9"
	120			7'-9"	7'-9"	7'-11"	8'-8"	9'-8"	9'-9"
	180			7'-9"	7'-9"	7'-11"	8'-8"	9'-8"	9'-9"
	240			7'-5"	7'-5"	7'-11"	8'-8"	9'-8"	9'-9"
+/- 70 PSF	80			7'-3"	7'-3"	7'-7"	8'-4"	9'-4"	9'-5"
	120			7'-3"	7'-3"	7'-7"	8'-4"	9'-4"	9'-5"
	180			7'-3"	7'-3"	7'-7"	8'-4"	9'-4"	9'-5"
	240			7'-3"	7'-3"	7'-7"	8'-4"	9'-4"	9'-5"
+/- 75 PSF	80					7'-4"	8'-0"	9'-0"	9'-1"
	120					7'-4"	8'-0"	9'-0"	9'-1"
	180					7'-4"	8'-0"	9'-0"	9'-1"
	240					7'-4"	8'-0"	9'-0"	9'-1"
+/- 80 PSF	80							8'-8"	8'-10"
	120							8'-8"	8'-10"
	180							8'-8"	8'-10"
	240							8'-8"	8'-10"

CLEAR SPAN TABLE USE INSTRUCTIONS:

1. DETERMINE TYPE OF ENCLOSURE TO BE COVERED (ENCLOSED, SCREENED WALLS, OR OPEN STRUCTURE). USE QR CODE/WEB ADDRESS ON S1 FOR HELP.
2. DETERMINE THE SITE SPECIFIC REQUIRED DESIGN PRESSURE PROVIDED BY SEPARATE ENGINEERING BY A LICENSED ENGINEER OR REGISTERED ARCHITECT, IN ACCORDANCE WITH THE APPLICABLE BUILDING CODE.
3. (SEE LINK BELOW FOR ADDITIONAL RESOURCES)
4. FIND ALLOWABLE COMPOSITE PANEL CLEAR SPAN IN TABLES FOR APPROPRIATE PANEL DEPTH, FACING THICKNESS SELECTED.
5. A 2PSF PANEL DEAD LOAD HAS BEEN CONSIDERED IN THESE TABLES.
6.  INDICATES VALUES NOT VALID FOR USE.

VALUES ARE UNIFORMLY DISTRIBUTED LOAD. FOR NON-LINEAR LOADS SUCH AS SNOW DRIFT, SITE SPECIFIC RESULTS SHALL BE CONVERTED TO AN EQUIVALENT UNIFORM LOAD FOR TABLE COMPARISON.

\*TOTAL LOAD = SUM OF ALL LOADS (WIND, SNOW, LIVE, DEAD, ETC.) ACTING IN THE WORST CASE LOAD COMBINATION AS DETERMINED PER SEPARATE ENGINEERING.

**ENGINEERING EXPRESS**  
CORPORATE OFFICE:  
160 SW 12th AVE, SUITE 106  
DEERFIELD BEACH, FL 33442  
(954) 354-0660 | (866) 396-9999  
TEAM@ENGINEERINGEXPRESS.COM  
ENGINEERINGEXPRESS.COM

**STRUCTURAL BUILDING SYSTEMS, INC.**  
350 BURBANK RD  
OLDSMAR, FL  
(813) 855-2627  
FL15491.1 - EPS FOAM CORE COMPOSITE PANEL  
3IN, 4IN & 6IN WITH ALUMINUM OR STEEL SKINS  
PRODUCT APPROVAL #FL15941.1

REMARKS	DRWN	CHKD	DATE
INIT ISSUE	JC	RN	06/04/20

THIS DOCUMENT IS THE PROPERTY OF ENGINEERING EXPRESS AND SHALL NOT BE REPRODUCED IN WHOLE OR PART WITHOUT WRITTEN CONSENT OF ENGINEERING EXPRESS. ALTERATIONS, ADDITIONS, OR OTHER MARKINGS TO THIS DOCUMENT ARE NOT PERMITTED AND INVALIDATE OUR CERTIFICATION.

C:\Users\colby\Engineering\Express\Production - Documents\Projects\20-26243 - FL15491.1 - EPS Foam Core Comp Panel. 3.4.6in with Alum or Steel Skins\WP2020\FBC\20-26243-Dwg-FL15491.1-FB.dwg 08/04/2020 - 6:11pm colby