



1 COCHRANE AVE. PENNSBORO, WV 26415 PH.
800-426-2249

07-09 / 07-10

**STORMBREAKER PLUS 300VL
IMPACT RESISTANT VINYL
HORIZONTAL 3-LITE SLIDING WINDOW**

REV. #:	REVISIONS:	REVISED BY:	DATE:

GENERAL NOTES:

1. THIS WINDOW SYSTEM IS DESIGNED TO COMPLY WITH THE 6TH EDITION (2017) FLORIDA BUILDING CODE, INCLUDING HVHZ, AND WAS TESTED USING METHODS TAS 201, TAS 202, AND TAS 203.
2. HIGH QUALITY CAULK SHALL BE USED AROUND THE ENTIRE WINDOW PERIMETER, INSIDE AND OUT. EXTERIOR CAULKING SHALL BE CAP BEAD FOR EQUAL LEG FRAMES, OR BEHIND FINNS/FLANGES FOR THOSE FRAME TYPES.
3. THE CONTRACTOR IS RESPONSIBLE FOR MAINTAINING WINDOW OPENING AND ALL WOOD FRAMING AROUND THE WINDOW.
4. WOOD BUCKS, BY OTHERS, MUST SUSTAIN ALL IMPOSED LOADS AND MUST BE PROPERLY ANCHORED TO TRANSFER LOADS TO THE STRUCTURE AND SHALL BE INSPECTED BY A BUILDING OFFICIAL. WOOD BUCK MIN. G = 0.42.
5. FOR INSTALLATION INTO CONCRETE/MASONRY, USE ITW/BUILDEX TAPCONS WITH ADVANCED THREADFORM TECHNOLOGY. ANCHORS MUST NOT BE INSTALLED INTO MORTAR JOINTS. ANCHOR SPACING SHOULD BE REDUCED AS NEEDED SO THAT THE ANCHOR IS AT LEAST 2" FROM MORTAR JOINTS. MAINTAIN 3" MIN. SPACING BETWEEN ANY TWO TAPCONS. CONCRETE/MASONRY SUBSTRATES SHALL CONSIST OF NON-CRACKED SOLID CONCRETE (2000 PSI MIN. COMPRESSIVE STRENGTH) OR GROUT-FILLED CMU (117 PCF MIN. DENSITY).
6. SHIMS MUST BE USED WHEN GAP OF GREATER THAN 1/16" BETWEEN FRAME AND OPENING IS PRESENT AT THE ANCHOR LOCATION. MAX. SHIM STACK IS 1/4".
7. ONLY MIAMI-DADE COUNTY APPROVED CORROSION RESISTANT FASTENERS AND ITW TAPCON FASTENERS SHALL BE USED.
8. WINDOW INSTALLERS SHALL FOLLOW ALL MANUFACTURER'S INSTRUCTIONS.
9. NO SHUTTERS OR EXTERNAL PROTECTION DEVICES ARE REQUIRED.
10. GLAZING INDICATED HEREIN COMPLIES WITH ASTM E 1300-04.

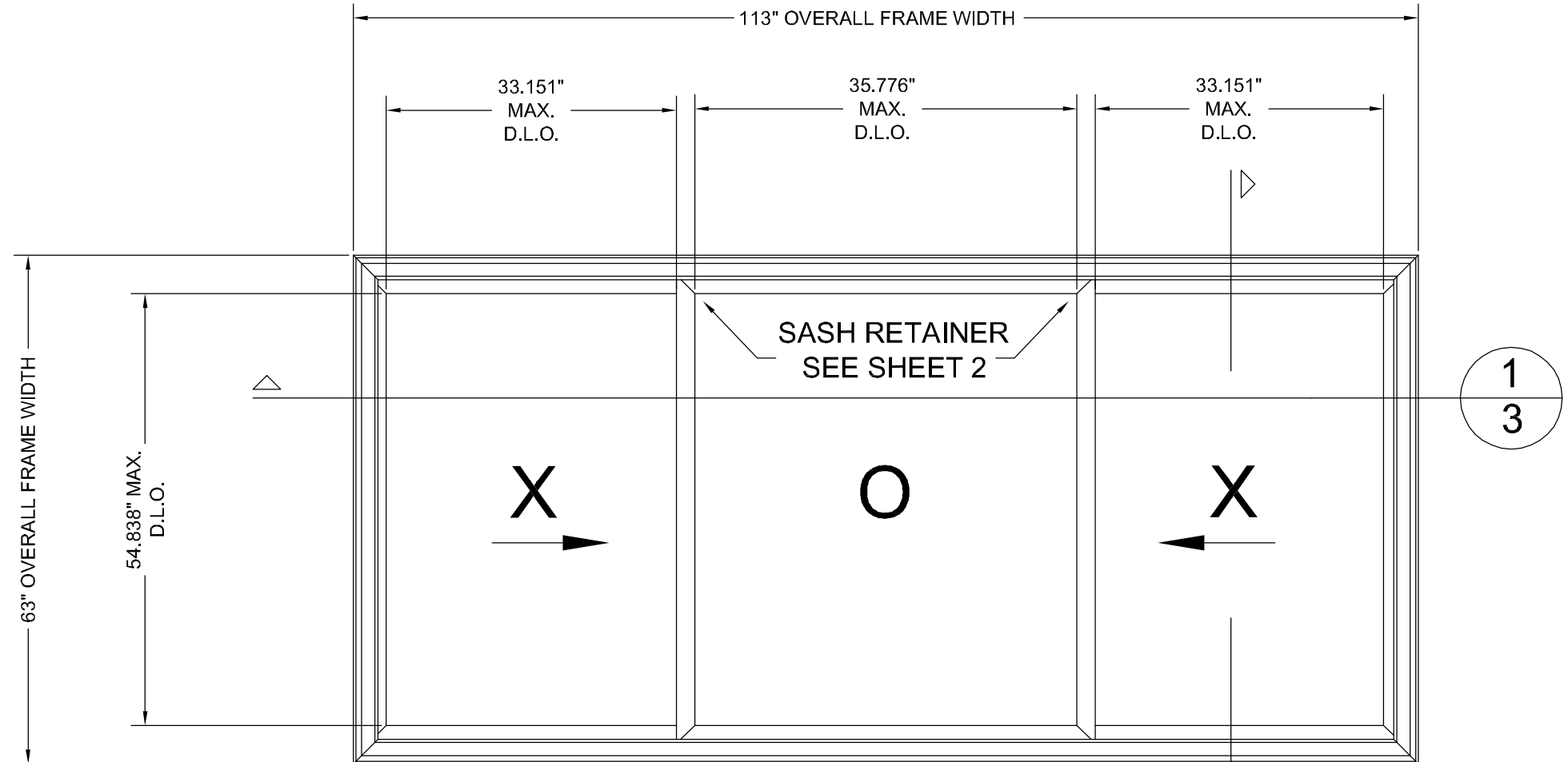

DESIGN PRESSURE RATING	IMPACT RATING
+50.0 PSF -50.0 PSF	LARGE MISSILE

1
2

TABLE OF CONTENTS	
SHEET #	DESCRIPTION
1	GENERAL NOTES & TYPICAL ELEVATIONS
2	VERTICAL CROSS SECTIONS - 07-09 RETRO / 07-10 FLANGE
3	HORIZONTAL CROSS SECTIONS - 07-09 / 07-10
4	ANCHORING LOCATIONS & GLAZING DETAILS (RETRO & FLANGE)
5	COMPONENTS & BILL OF MATERIALS

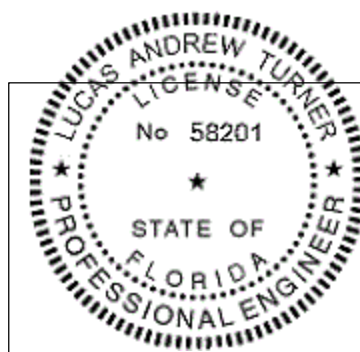

8/25/2017
LUCAS A. TURNER, P.E.
FL PE # 58201
TURNER ENGINEERING & CONSULTING, INC.
(COA # 29779)
1239 JABARA AVE.
NORTH PORT, FL 34288
PH. 941-380-1574



SIZE: B	DRAWING NO.: DA0015	REV.: -
DRAWN BY: LMH	DATE: 02/01/17	
CHECKED BY:	DATE:	
SCALE: FIT	SHEET: 1 of 5	APPR'D BY: DATE:
SERIES: STORMBREAKER PLUS 300VL 3-LITE END VENT SLIDER - 1X		
TITLE: GENERAL NOTES & TYPICAL ELEVATIONS		

REV. #:	REVISIONS:	REVISED BY:	DATE:

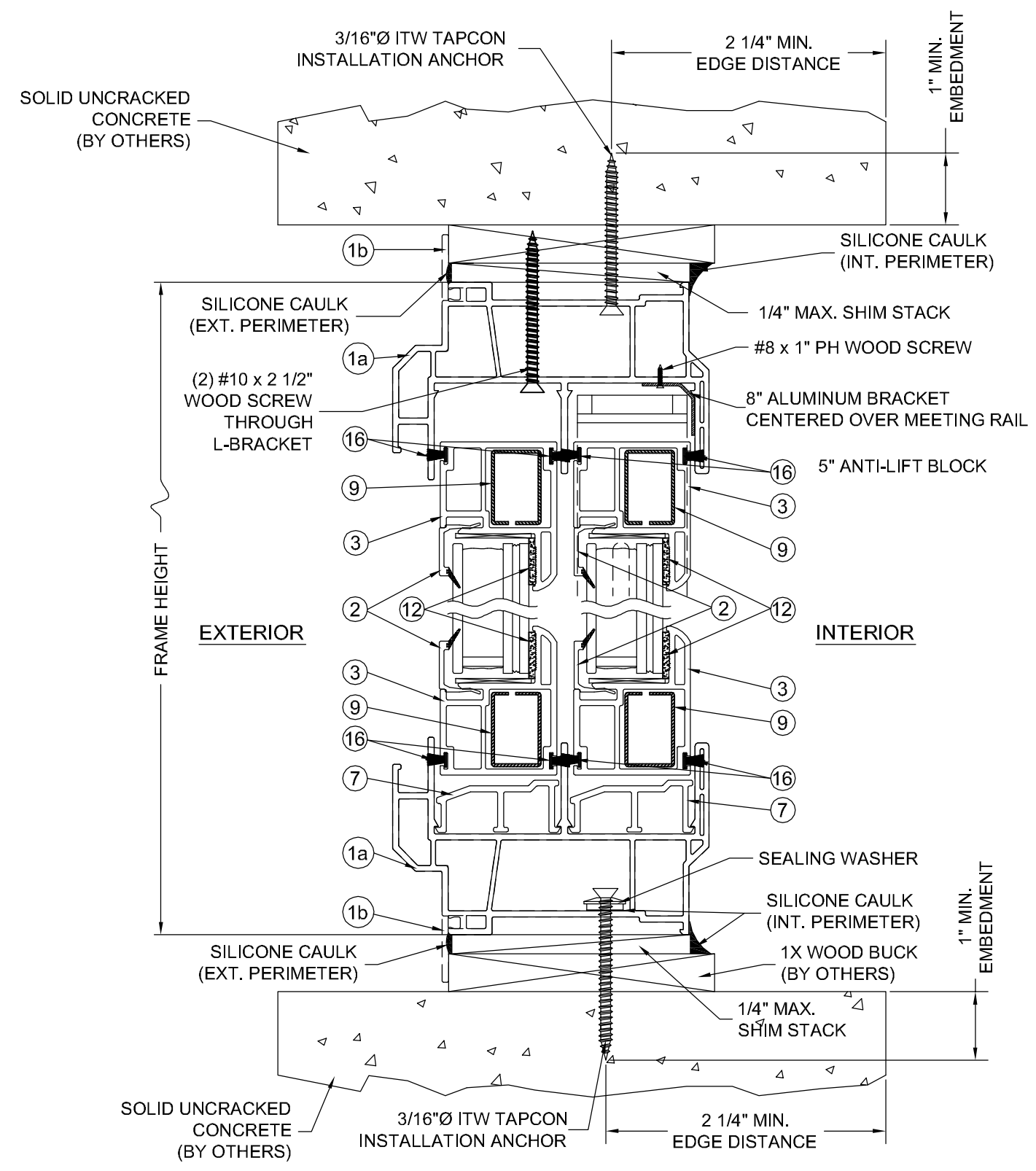

- NOTES:**
1. SHIMS TO BE A "RIGID/STIFF" MATERIAL THAT COMPLIES WITH THE REQUIREMENTS OF THE MIAMI-DADE COUNTY, FL AND FLORIDA BUILDING CODE.
 2. APPLY CAULK AROUND SCREWS AT THE SILL ONLY.
 3. REPLACE ONE L-BRACKET SCREW WITH AN INSTALLATION SCREW. (APPROX. 1 3/4" FROM CENTERLINE) IN HEAD.
 4. CORROSION RESISTANT FASTENERS AND MATERIALS THAT COME INTO CONTACT WITH OTHER DISSIMILAR MATERIALS SHALL MEET THE REQUIREMENTS OF THE FLORIDA BUILDING CODE.

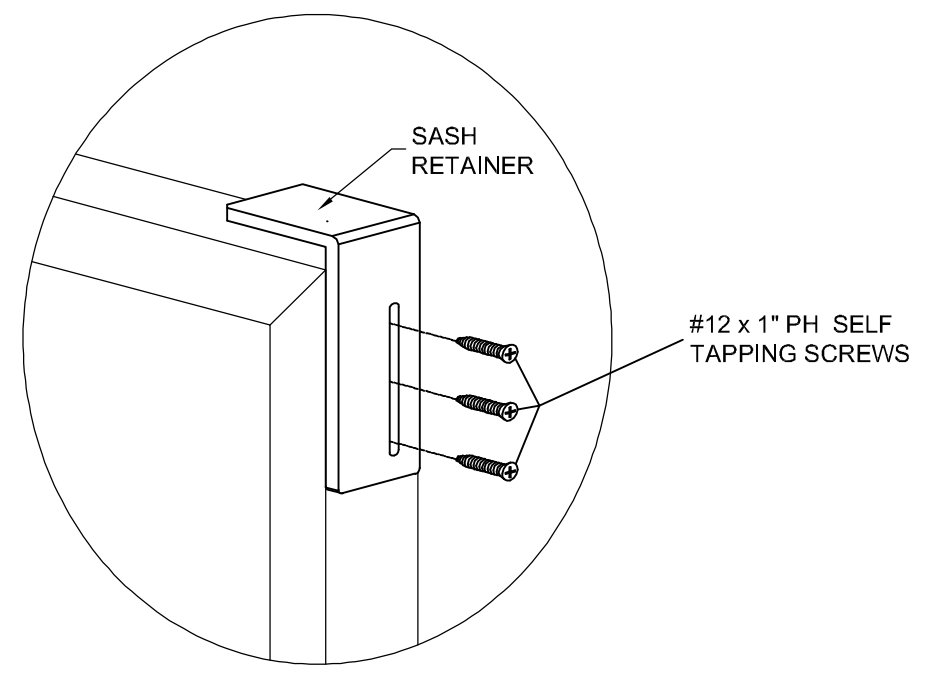

OPERATING SASH
SASH RETAINER INSTALLATION

- 1 VERTICAL CROSS SECTION (1X BUCK)
- 2 07-09 RETRO / 07-10 FLANGE INSTALLATION

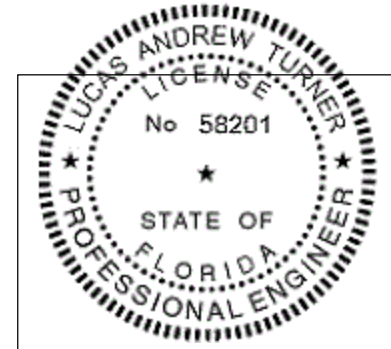

201
8/25/2017
LUCAS A. TURNER, P.E.
FL PE # 58201
TURNER ENGINEERING & CONSULTING, INC.
(COA # 29779)
1239 JABARA AVE.
NORTH PORT, FL 34288
PH. 941-380-1574

SIMONTON
WINDOWS
1 Cochrane Avenue
Pennsboro, WV 26415

SIZE: B	DRAWING NO.: DA0015	REV.: -
DRAWN BY: LMH	DATE: 02/01/17	
CHECKED BY:	DATE:	
SCALE: FIT	SHEET: 2 of 5	APPR'D BY: DATE:
SERIES: STORMBREAKER PLUS 300VL 3-LITE END VENT SLIDER - 1X		
TITLE: VERTICAL CROSS SECTIONS - 07-09 RETRO / 07-10 FLANGE		

REV. #:	REVISIONS:	REVISED BY:	DATE:

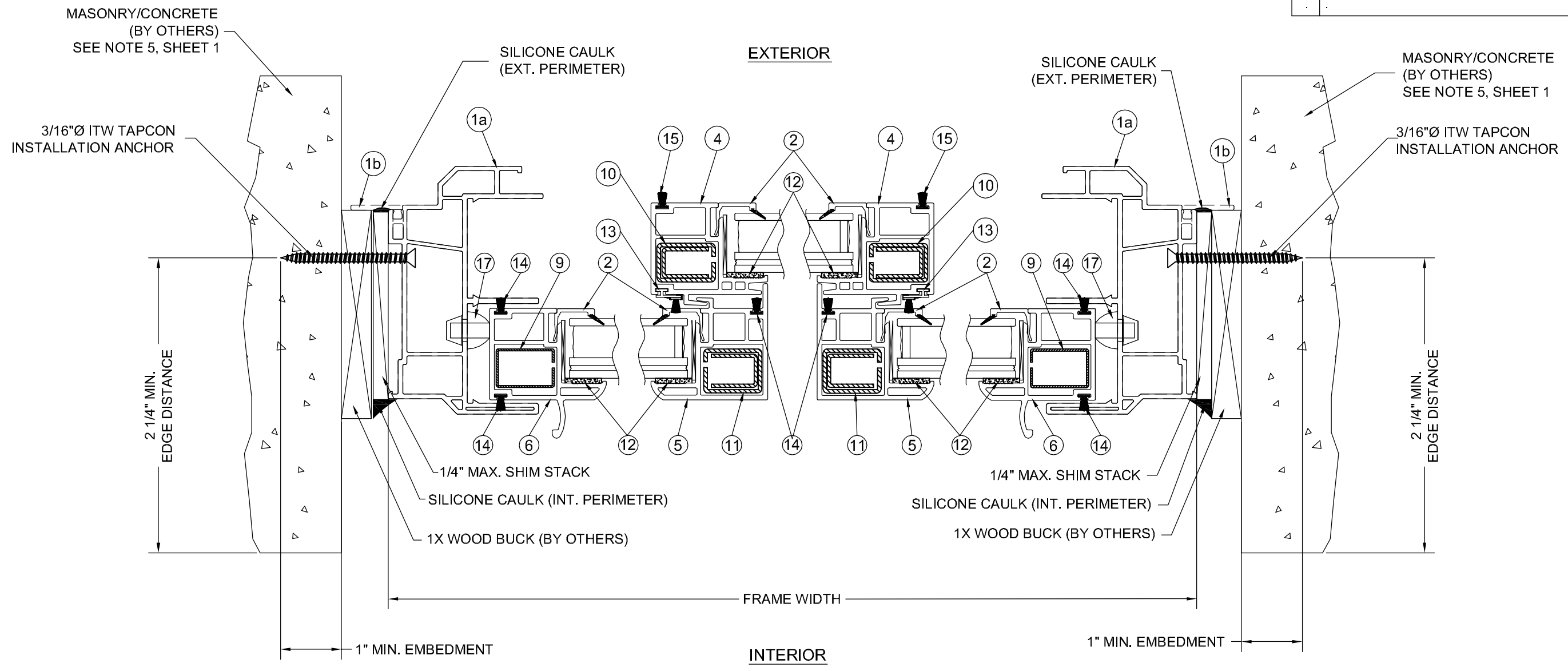

1 HORIZONTAL CROSS SECTION (1X BUCK)
 3 07-09 RETRO / 07-10 FLANGE INSTALLATION

NOTES:
 1. SHIMS TO BE A "RIGID/STIFF" MATERIAL THAT COMPLIES WITH THE REQUIREMENTS OF THE MIAMI-DADE COUNTY, FL AND FLORIDA BUILDING CODE.
 2. CORROSION RESISTANT FASTENERS AND MATERIALS THAT COME INTO CONTACT WITH OTHER DISSIMILAR MATERIALS SHALL MEET THE REQUIREMENTS OF THE FLORIDA BUILDING CODE.

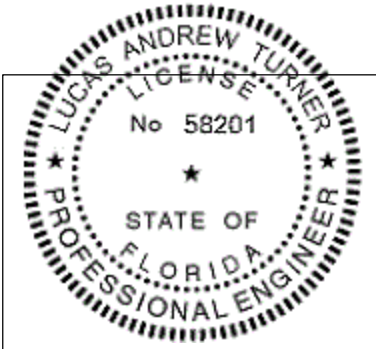

LT
 8/25/2017
 LUCAS A. TURNER, P.E.
 FL PE # 58201
 TURNER ENGINEERING & CONSULTING, INC.
 (COA # 29779)
 1239 JABARA AVE.
 NORTH PORT, FL 34288
 PH. 941-380-1574

	SIZE: B DRAWING NO.: DA0015 DRAWN BY: LMH CHECKED BY:	REV.: - DATE: 02/01/017 DATE:
	SCALE: FIT SHEET: 3 of 5 SERIES: STORMBREAKER PLUS 300VL 3-LITE END VENT SLIDER - 1X TITLE: HORIZONTAL CROSS SECTIONS - 07-09 RETRO / 07-10 FLANGE	APPR'D BY: DATE:

REV. #:	REVISIONS:	REVISED BY:	DATE:

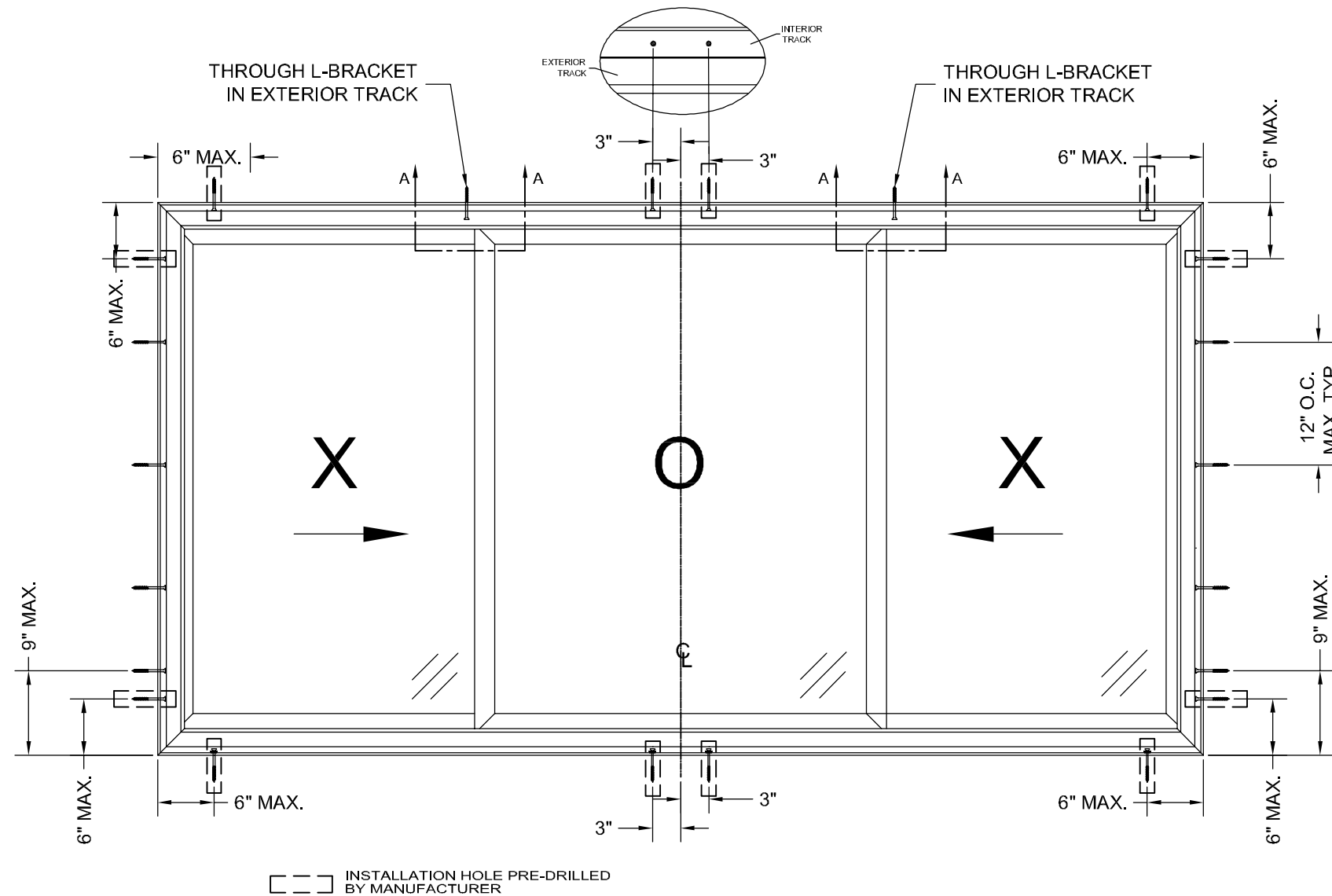

**1X ANCHOR LAYOUT - 07-09 RETRO / 07-10 FLANGE
113" x 63" HORIZONTAL SLIDING WINDOW (XOX)-EQ**

□ □ □ □ INSTALLATION HOLE PRE-DRILLED BY MANUFACTURER

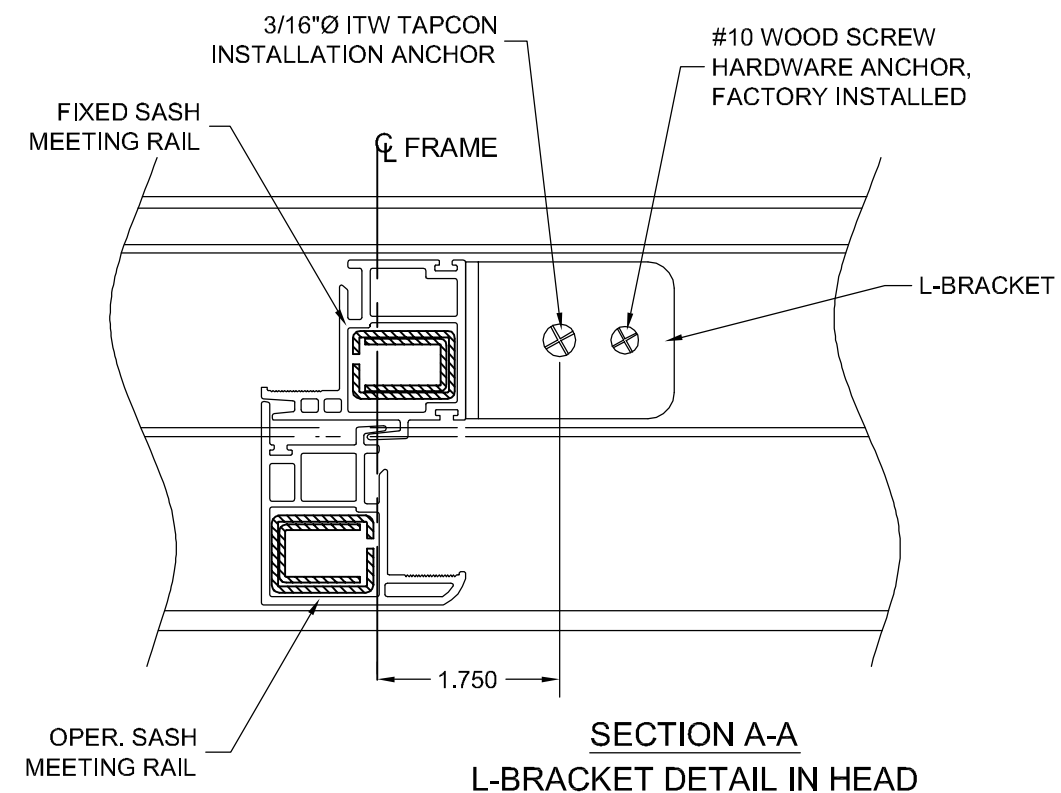

**SECTION A-A
L-BRACKET DETAIL IN HEAD
BRACKET AND HARDWARE ANCHOR SUPPLIED BY MANUFACTURER, INSTALLED IN FIELD.**

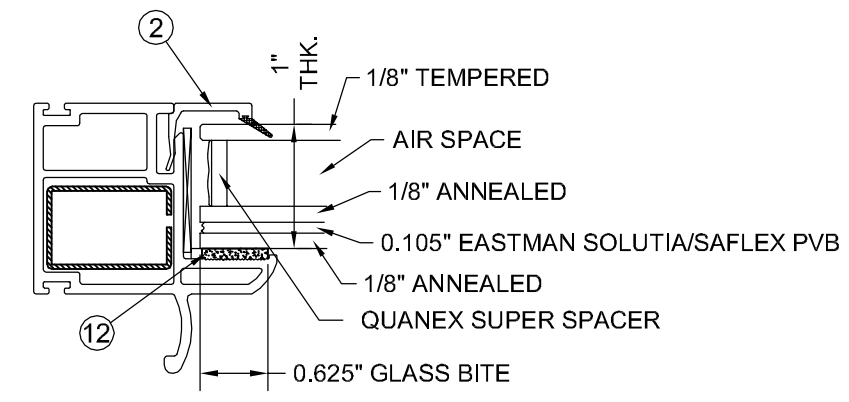

**GLAZING DETAIL
WITH SOLUTIA/SAFLEX LAMINATE**

NOTES:
1. WHEN ANCHORING WINDOW TO A 1X WOOD BUCK AND MASONRY/CONCRETE, USE 3/16"Ø ITW TAPCON ANCHORS OF SUFFICIENT LENGTH TO ACHIEVE 1" MINIMUM EMBEDMENT INTO THE MASONRY/CONCRETE.

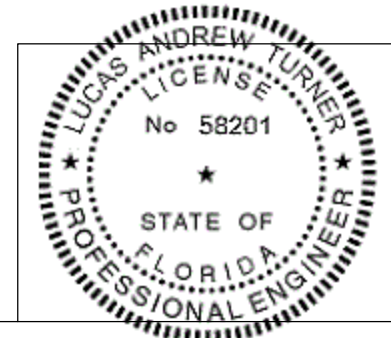

22
8/25/2017
LUCAS A. TURNER, P.E.
FL PE # 58201
TURNER ENGINEERING & CONSULTING, INC.
(COA # 29779)
1239 JABARA AVE.
NORTH PORT, FL 34288
PH. 941-380-1574



SIZE: B	DRAWING NO.: DA0015	REV.: -
DRAWN BY: LMH	DATE: 02/01/17	
CHECKED BY:	DATE:	
SCALE: FIT	SHEET: 4 of 5	APPR'D BY: DATE:
SERIES: STORMBREAKER PLUS 300VL 3-LITE END VENT SLIDER - 1X		
TITLE: ANCHORING LOCATIONS & GLAZING DETAILS - AS TESTED		

BILL OF MATERIALS		
ITEM #	DESCRIPTION	MANUFACTURER
1a	SL0901S VINYL FRAME (HEAD/JAMB/SILL)	SIMEX, INC.
1b	SL1101S VINYL FRAME WITH FLANGE	SIMEX, INC.
2	BV18 VINYL GLAZING BEAD FOR 1" I.G.U.	SIMEX, INC.
3	SL75S VINYL COMMON SASH	SIMEX, INC.
4	SL74S VINYL KEEPER SASH	SIMEX, INC.
5	SL77S VINYL LOCK STILE	SIMEX, INC.
6	SL79S VINYL PULL STILE	SIMEX, INC.
7	V355 VINYL SILL TRACK INSERT	SIMEX, INC.
8	6063-T5 ALUMINUM L-BRACK (HEAD/SILL)	TRUTH
9	SIMRECT1 GALVANIZED STEEL REINFORCEMENT	HYGRADE
10	ST-336/ST-339 GALVANIZED STEEL REINFORCEMENT	HYGRADE
11	ST-337/ST-338 GALVANIZED STEEL REINFORCEMENT	HYGRADE
12	896-HIS GLAZING COMPOUND	PECORA
13	OFFSET FINSEAL WEATHERSTRIPPING	AMESBURY
14	0.250" FINSEAL WEATHERSTRIPPING	AMESBURY
15	0.340" FINSEAL WEATHERSTRIPPING	AMESBURY
16	0.460" FINSEAL WEATHERSTRIPPING	AMESBURY
17	PRESS FIT BUMPER STOPS	KASO
18	8" ALUMINUM SUPPORT BRACKET - HEAD	SHAPES UNLIMITED

REV. #:	REVISIONS:	REVISED BY:	DATE:

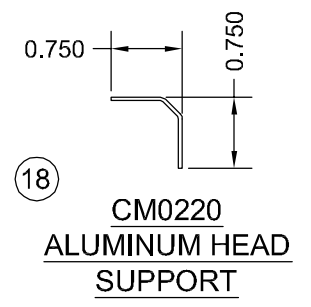
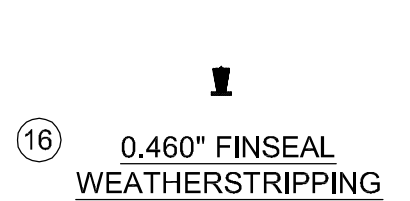
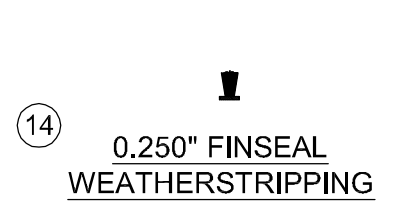
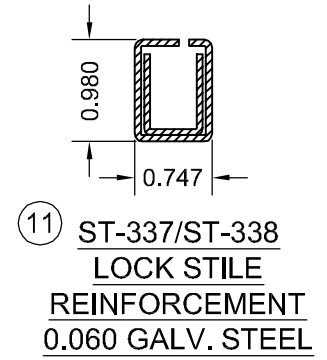
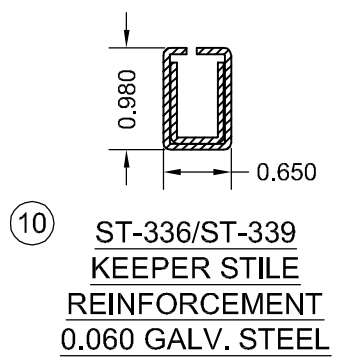
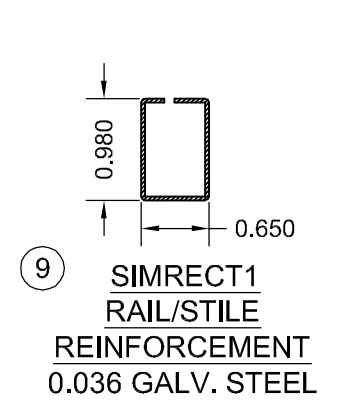
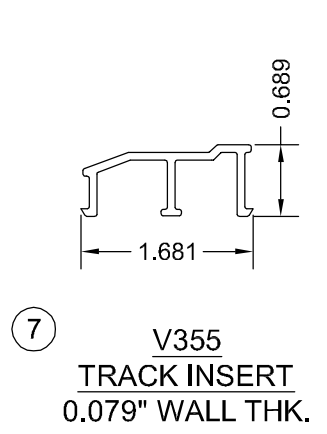
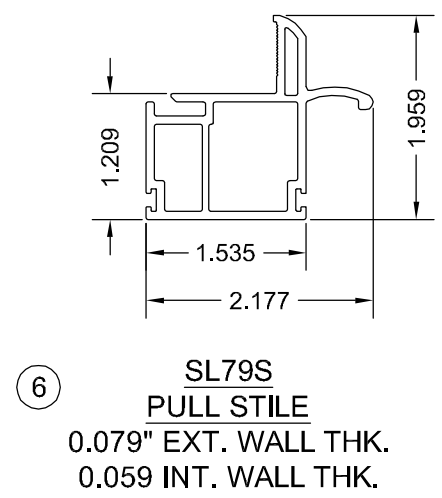
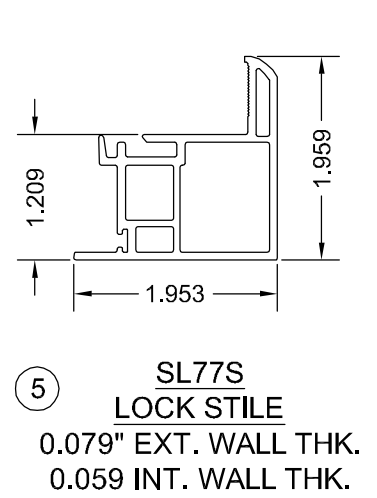
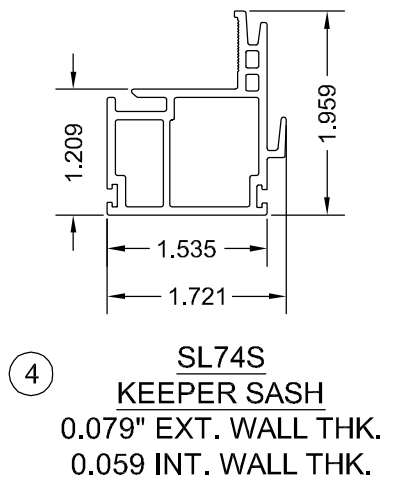
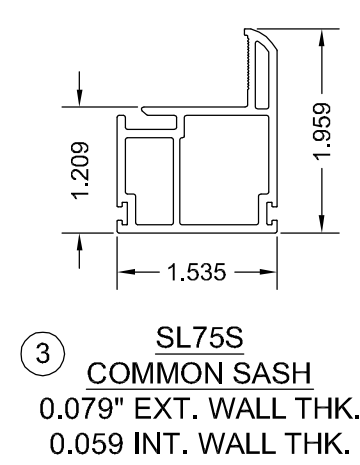
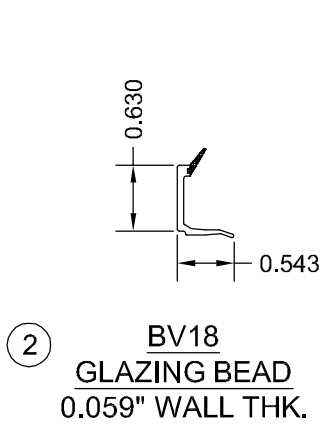
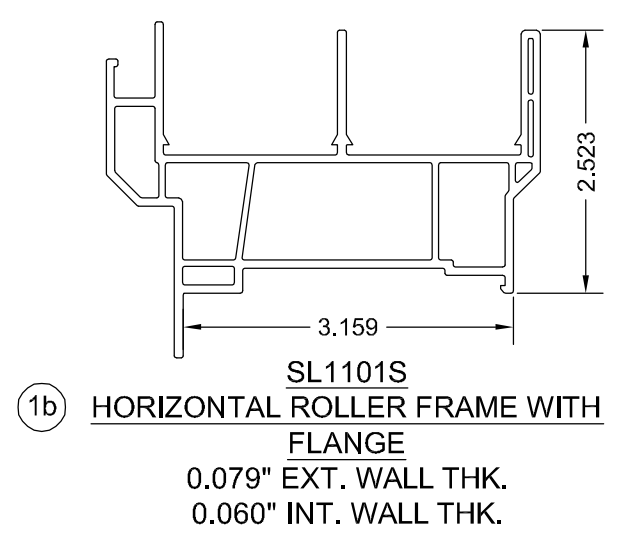
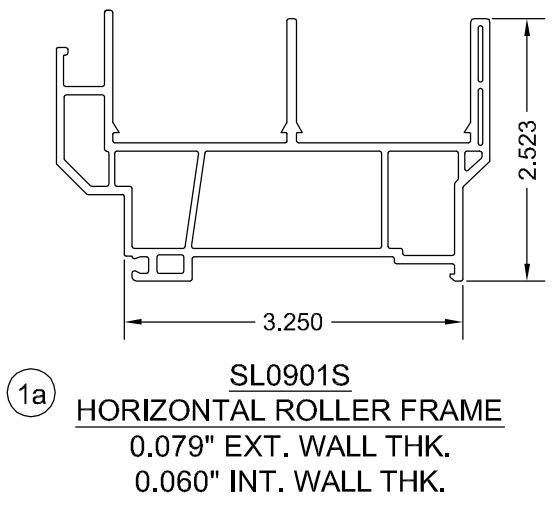

ZZ
8/25/2017
LUCAS A. TURNER, P.E.
FL PE # 58201
TURNER ENGINEERING & CONSULTING, INC.
(COA # 29779)
1239 JABARA AVE.
NORTH PORT, FL 34288
PH. 941-380-1574

SIMONTON
WINDOWS
1 Cochrane Avenue
Pennsboro, WV 26415

SIZE: B	DRAWING NO.: DA0015	REV.: -
DRAWN BY: LMH	DATE: 02/01/17	
CHECKED BY:	DATE:	
SCALE: FIT	SHEET: 5 of 5	APPRV'D BY:
SERIES: STORMBREAKER PLUS 300VL 3-LITE END VENT SLIDER - 1X		DATE:
TITLE: BILL OF MATERIALS AND COMPONENTS		