

JAMB SCREW THROUGH JAMB INSTALLATION

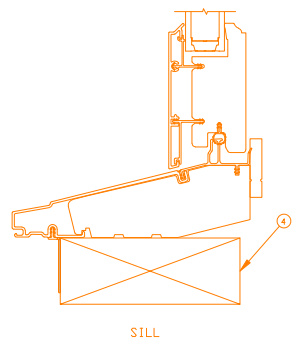
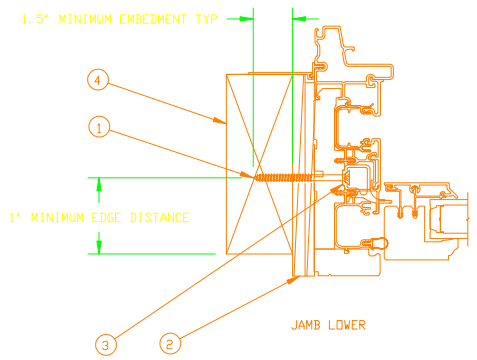
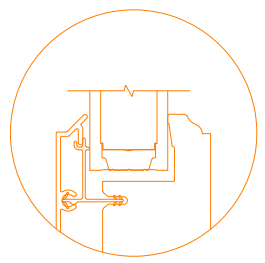
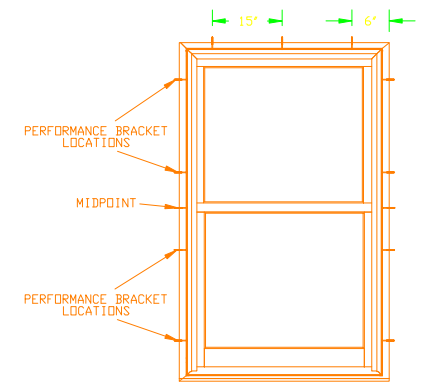
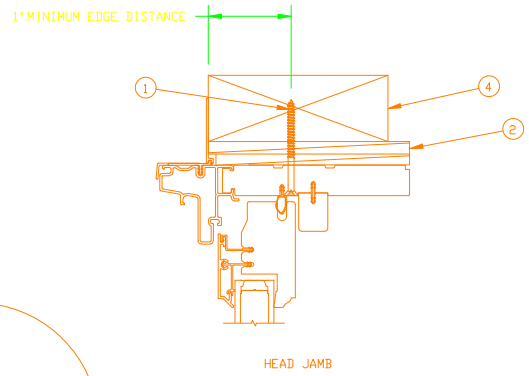
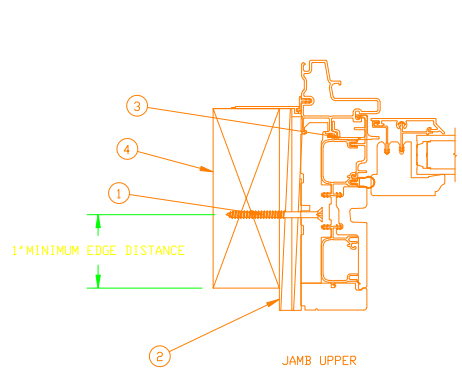

UNIT	MAX FRAME SIZE	DP RATING
UL DBLHNG G2	65 1/4 X 127 1/2	+30/-30

INSTALLATION METHOD:

- NON STRUCTURAL NAIL FIN OPTIONAL FOR PLACEMENT ONLY
- JAMB SCREWS: ONE AT EACH PERFORMANCE BRACKET LOCATION AND ONE AT MIDPOINT OF EACH JAMB.
- HEAD JAMB SCREWS: 6" FROM CORNERS AND 15" ON CENTER

NOTES:

- THIS PRINT IS FOR STRUCTURAL PERFORMANCE ONLY. FOR FLASHING & SEALING REQUIREMENTS, REFER TO THE INSTALLATION INSTRUCTIONS.
- SHIMS:
- A SHIM MUST BE PLACED AT EACH SCREW LOCATION.
UNIT MUST NOT BE IN DIRECT CONTACT WITH EITHER CONCRETE OR TREATED BUCK MATERIAL.
- IF SHIM SPACE IS LESS THEN 1/4", WRAP THE UNIT ON ALL 4 SIDES WITH WINDOW FLASHING TAPE AS REQUIRED FOR A BARRIER BETWEEN THE UNIT AND CONCRETE OR TREATED LUMBER.
- IF CHEMICALLY TREATED LUMBER IS USED FOR BUCK MATERIAL, FASTENERS INTO THE BUCK MUST BE A MINIMUM OF 0.90 OZ/FT² ZINC HOT DIPPED GALVANIZED OR STAINLESS STEEL TYPE 304 OR 316.

CATEGORY:
DOUBLE HUNG

UNIT TYPE:
UDHG2

ITEM NO	REF NO	DESCRIPTION
4	-----	2X WOOD BUCK BY OTHERS
3	-----	PERFORMANCE BRACKET
2	-----	SHIM
1	-----	#8 X 3.000 WOOD SCREW

UNSPECIFIED TOLERANCES

DECIMALS: XX ± .03 XXX ± .012	ANGLE DEG: ± .5
LINEAL: + .125 - .000	FAB LINEAL: ± .125

MATERIAL:
NA

MARVIN RESEARCH & DEVELOPMENT

COLLECTION: ULTIMATE

DWG TYPE: INSTALLATION
DESCRIPTION: SCREW THRU JAMB

CHK:	SIZE: B	CLASS: MISC	DWG NO: 00116710
APP:	SCALE: NA	DATE: 05/15/19	DWG BY: BRUCE, KEVIN

SHEET:
1 OF 1

Template Version 13.0

NOTICE - CONFIDENTIAL INFORMATION

The information in this document is privileged and strictly confidential. The information contained herein shall be used only by Marvin Windows and Doors employees and by those agents or suppliers granted official written permission. If the reader of this document is not the intended recipient, or the employee or agent of the intended recipient, please delete this document from all data storage devices, and destroy all hard copies. Any unauthorized dissemination, distribution, copying or other use of the information contained in this document is strictly prohibited.