

ASTM A653 GR 40 ZINC COATED STEEL  
 PRE-PAINTED WITH FULL COAT OF PRIMER AND BAKED SILICONIZED POLYESTER FINISH COAT  
 INSULATION FOAM IN PLACE POLYURETHANE

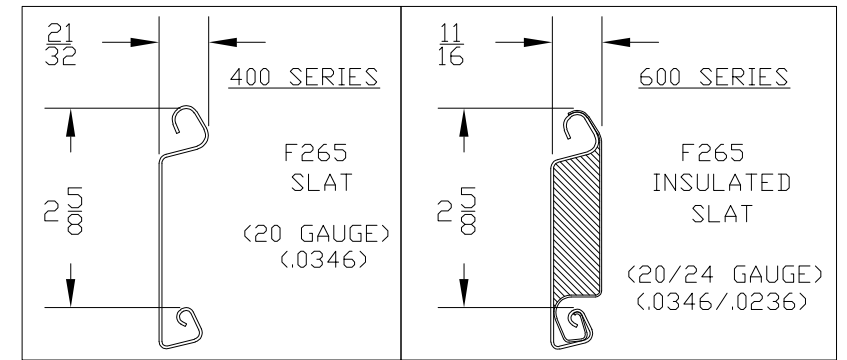

**ALLOWABLE TRANSVERSE DESIGN WIND LOADS  
 NON-IMPACT RATED SERIES 400 DOORS ONLY  
 (PSF)**

MAX OPENING WIDTH	MAX OPENING HEIGHT	DESIGN LOAD POSITIVE (PSF)	DESIGN LOAD NEGATIVE (PSF)
12'-0"	30'-0"	100.0	100.0
13'-0"	30'-0"	92.3	100.0
14'-0"	30'-0"	85.7	92.9
15'-0"	30'-0"	80.0	86.7
16'-0"	30'-0"	75.0	81.3
17'-0"	30'-0"	70.6	76.5
18'-0"	30'-0"	66.6	72.2
19'-0"	30'-0"	63.1	68.4
20'-0"	30'-0"	60.0	65.0
21'-0"	30'-0"	55.4	60.1
22'-0"	30'-0"	51.5	55.8
23'-0"	30'-0"	48.0	52.0
24'-0"	30'-0"	44.9	48.7
25'-0"	30'-0"	42.1	45.7
26'-0"	30'-0"	39.6	42.9
27'-0"	30'-0"	37.3	40.5
28'-0"	30'-0"	35.3	38.3

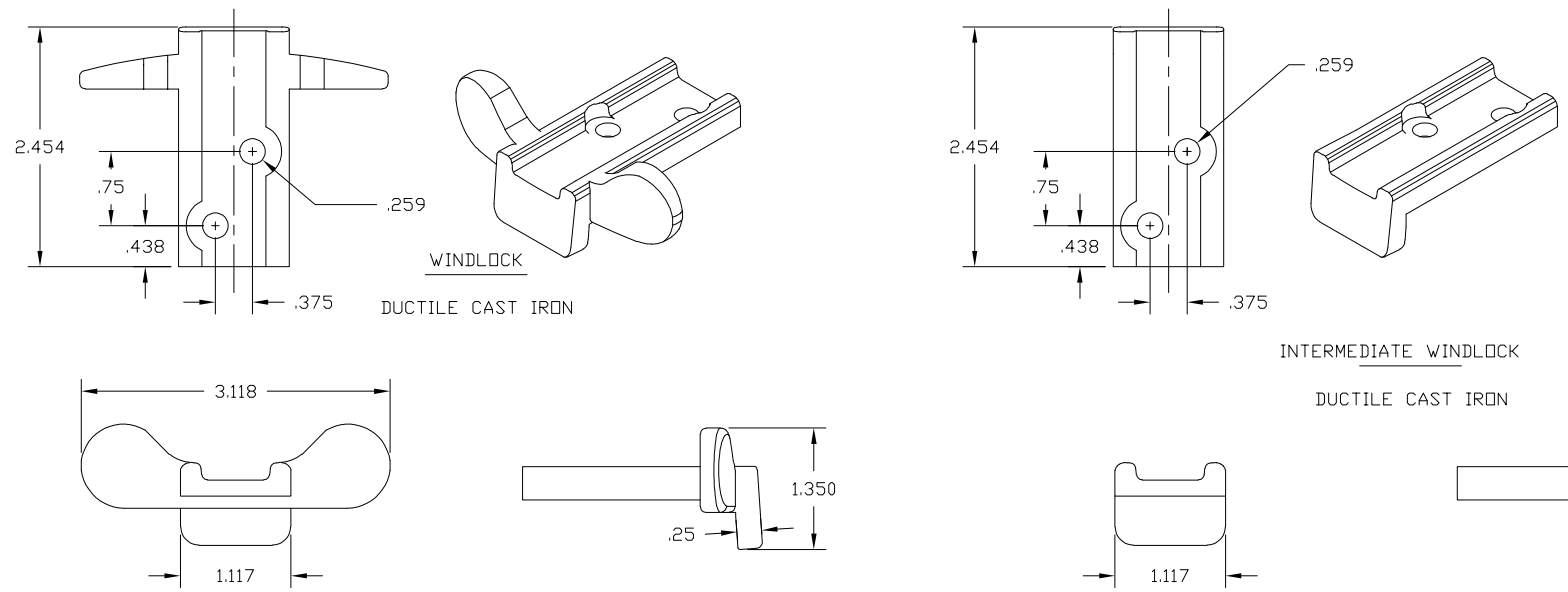
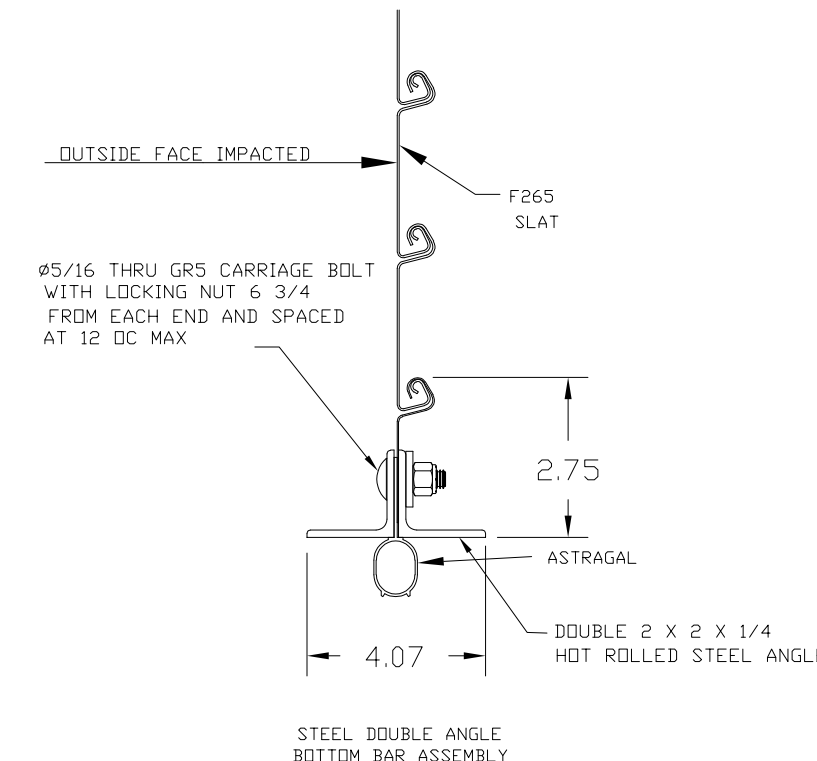

John E. Scates, P.E.  
 2560 King Arthur Blvd, Ste 124-54  
 Lewisville, TX 75056  
 FL PE 51737  
 TX PE 56308 / F2203

Printed copies of this document are not considered signed and sealed and the signature must be verified on any electronic copies."

SEE SHEET 2 FOR NOTES

**CERTIFIED WIND LOAD  
 400HD-WL/600HD-WL SERIES ROLL-UP DOOR**

UNLESS OTHERWISE SPECIFIED, DIMENSIONS ARE IN INCHES AND TOLERANCES ARE: <b>ANGLES</b> ± 0° 30' <b>DECIMAL</b> .XX ±.03 .XXX ±.005 <b>FRACTIONS</b> ± 1/16 <b>HOLE DIAMETERS</b> UNDER .251 +.004 .251 TO .500 -.003 OVER .500 +.008 -.003	APPROVALS	DATE	APPROVALS	DATE	PART NUMBER	DRAWING NUMBER			
	DRAWN <b>ADAM HICKS</b>	3-31-23	APPROVED <b>SCOTT ROBILLARD</b>	3-31-23	NA	<b>400HD-WL</b>			
	CHECKED <b>SCOTT ROBILLARD</b>	3-31-23			NA	APPLIED FINISH NA			
THESE CONFIDENTIAL DOCUMENTS SUBMITTED BY ASTA CONTAIN INFORMATION OF A PROPRIETARY NATURE AND MAY NOT BE REPRODUCED OR USED TO MANUFACTURE ANYTHING IN PART OR IN WHOLE FOR ANY PURPOSE OTHER THAN THAT WHICH IS NECESSARY FOR PREPARATION OF BIDS OR ENGINEERING WITHOUT THE EXPRESS PERMISSION OF ASTA WHICH MAY RECALL DOCUMENTS AT ANY TIME.					UNIT OF MEASURE	SIZE	SCALE	SHEET OF	REV
					NA	<b>B</b>	NONE	1 2	

**ASTA AMERICA**  
 BY JANUS INTERNATIONAL  
 ASTA America  
 638 Cassville White Rd NW  
 Cartersville, GA 30121  
 (770) 562-2850 Fax: (770) 562-1991  
 Web Site: www.astaamerica.com

**GENERAL NOTES**

- THIS ROLL-UP DOOR SYSTEM IS DESIGNED IN ACCORDANCE WITH THE FLORIDA BUILDING CODE AND THE INTERNATIONAL BUILDING CODE. THE REQUIRED DESIGN WIND PRESSURES FOR A DOOR IN ANY PARTICULAR BUILDING SHALL BE DETERMINED IN ACCORDANCE WITH LOCAL REQUIREMENTS. COMPLIES WITH THE WINDLOAD REQUIREMENTS OF THE IRC/IBC 2018.
- THIS ROLL-UP DOOR HAS BEEN SUCCESSFULLY TESTED ACCORDING TO THE UNIFORM STATIC AIR PRESSURE TEST PER TAS 202 TO RESIST A POSITIVE AND NEGATIVE WIND LOAD AS NOTED BELOW. TEST DOOR WALL OPENING SIZE: 20'-0" x 10'-0". A TEST LOAD OF 1.5 X DESIGN LOAD HAS BEEN USED.  
DESIGN LOAD = +60.0 PSF  
-65.0
- WIND LOADS FOR BUILDING OPENINGS SHALL BE DETERMINED BY A PROFESSIONAL ENGINEER USING APPROPRIATE WIND SPEED AND DESIGN CRITERIA. THIS DOOR MAY BE USED WHERE THE DESIGN LOAD MEETS OR EXCEEDS THE DESIGN LOAD FOR THE BUILDING OPENING.
- SUPERIMPOSED LOADS ON THE JAMBS FROM THIS DOOR ARE DESIGNATED AS  $V_x$  AND  $V_y$  HEREIN. CONTRACTORS SHALL HAVE BUILDING ENGINEER VERIFY ADEQUACY OF BUILDING STRUCTURE TO RESIST SUPERIMPOSED LOADS  $V_x$ ,  $V_y$
- ALL WELDING SHALL BE PERFORMED BY QUALIFIED WELDERS IN ACCORDANCE WITH AWS SPECIFICATIONS, LATEST EDITION. ALL WELDING ELECTRODES SHALL CONFORM TO AWS A5.1 GRADE E-60.
- BOLTS AND WASHERS SHALL BE GALVANIZED OR STAINLESS STEEL WITH A MINIMUM TENSILE STRENGTH OF 60 KSI EXCEPT WHERE OTHERWISE SPECIFIED.
- ANCHOR NOTES:  
A. EMBEDMENT LENGTH DOES NOT INCLUDE STUCCO FINISH.  
B. ANCHORS SHALL BE INSTALLED IN ACCORDANCE WITH MANUFACTURER'S SPECIFICATIONS.
- GUIDE TO JAMB ATTACHMENT FASTENERS IN OPENING AREA BEGIN 2" FROM FLOOR AND ARE SPACED 12" OC MAX THROUGH TOP OF WALL OPENING.  
3/4 X 1/2 WINDBAR
- WINDLOCKS ATTACHED TO EVERY SLAT THROUGH OPENING HEIGHT BEGINNING AT BOTTOM SLAT. WINDLOCKS FASTENED TO SLATS UTILIZING TWO SWAGED MALLEABLE CAST STUDS, .24 BASE DIAMETER, PER WINDLOCK.
- ALTERNATE SLAT GAUGE OF 18 (.0466) MAY BE SUBSTITUTED, BUT WITH NO INCREASE IN DESIGN LOAD RATING.
- SLIP AND SUPERIMPOSED LOADS ARE THE SAME FOR ALL JAMB TYPES.
- PROFESSIONAL ENGINEER'S SEAL PROVIDED ONLY FOR VERIFICATION OF WINDLOAD CONSTRUCTION DETAILS.

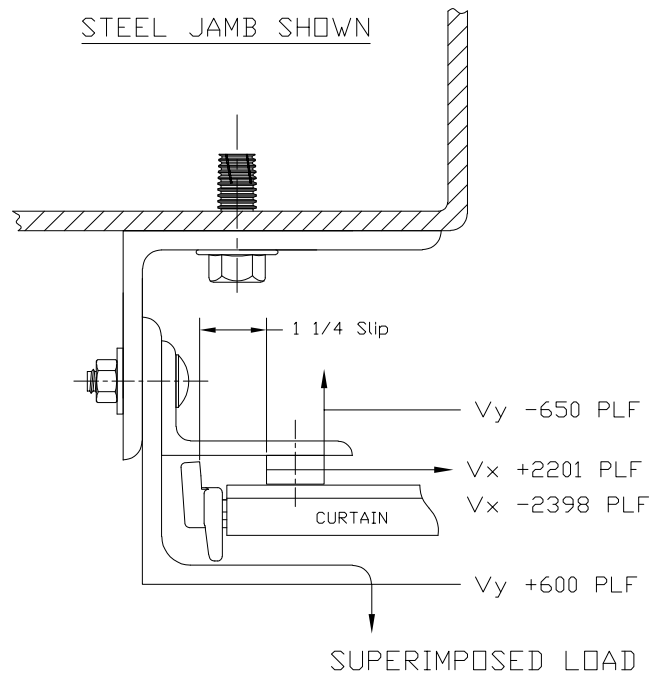
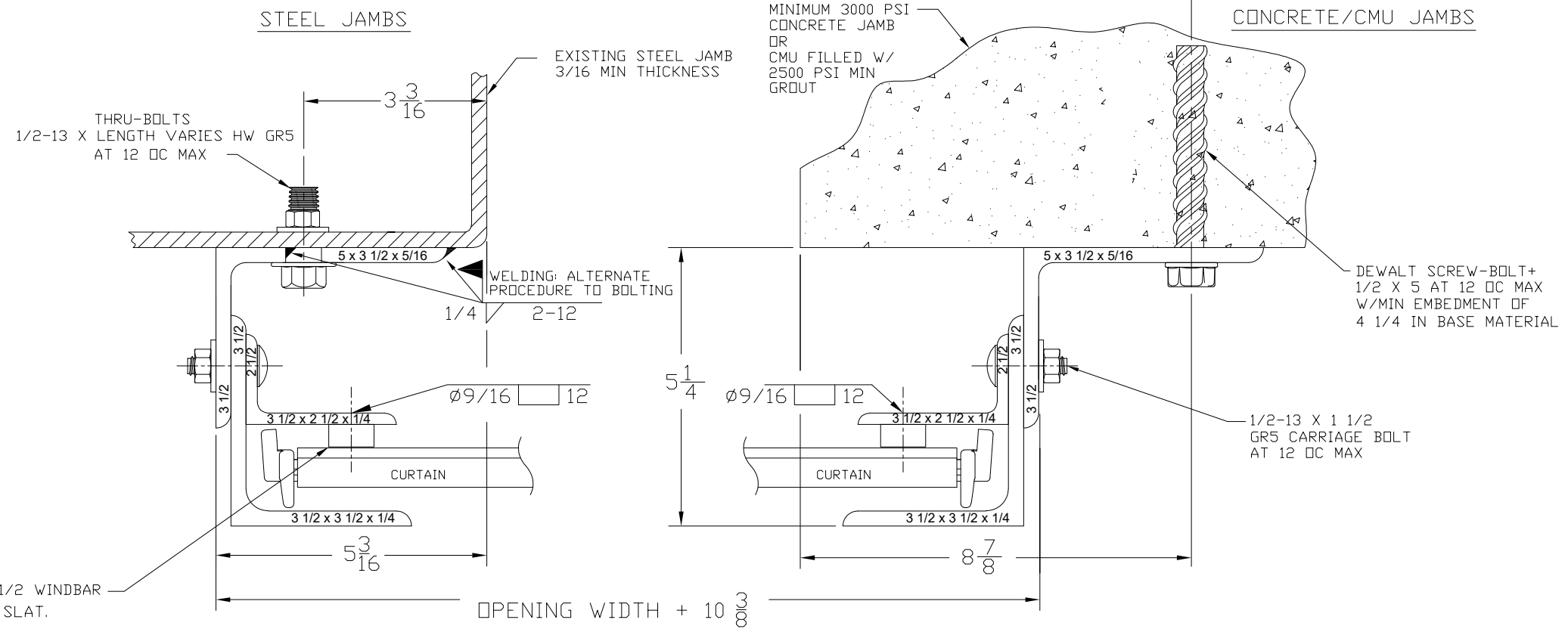

John E. Scates, P.E.  
2560 King Arthur Blvd, Ste 124-54  
Lewisville, TX 75056  
FL PE 51737  
TX PE 56308 / F2203

**CERTIFIED WIND LOAD**  
**400HD-WL/600HD-WL SERIES ROLL-UP DOOR**



ASTA America  
638 Cassville White Rd NW  
Cartersville, GA 30121  
(770) 562-2850 Fax: (770) 562-1991  
Web Site: www.astaamerica.com

<small>UNLESS OTHERWISE SPECIFIED, DIMENSIONS ARE IN INCHES AND TOLERANCES ARE</small> <b>ANGLES</b> ± 0° 30' <b>DECIMAL</b> .XX ±.03 .XXX ±.005 <b>FRACTIONS</b> ± 1/16	APPROVALS		DATE		PART NUMBER	DRAWING NUMBER						
	DRAWN <b>ADAM HICKS</b>		3-31-23		APPROVED <b>SCOTT ROBILLARD</b>	3-31-23		<b>400HD-WL</b>		MATERIAL		
	CHECKED <b>SCOTT ROBILLARD</b>		3-31-23				UNIT OF MEASURE		SIZE	SCALE	SHEET	OF
<small>THESE CONFIDENTIAL DOCUMENTS SUBMITTED BY ASTA CONTAIN INFORMATION OF A PROPRIETARY NATURE AND MAY NOT BE REPRODUCED OR USED TO MANUFACTURE ANYTHING IN PART OR IN WHOLE FOR ANY PURPOSE OTHER THAN THAT WHICH IS NECESSARY FOR PREPARATION OF BIDS OR ENGINEERING WITHOUT THE EXPRESS PERMISSION OF ASTA WHICH MAY RECALL DOCUMENTS AT ANY TIME.</small>						NA	<b>B</b>	NONE	2	2		