

Series 3900-T

Aluminum Side Hinged Double Door

Inswing/Outswing

"IMPACT"

GENERAL NOTES

- This product has been evaluated and is in compliance with the 7th Edition (2020) Florida Building Code (FBC) structural requirements including the "High Velocity Hurricane Zone" (HVHZ).
- Product anchors shall be as listed and spaced as shown on details. Anchor embedment to base material shall be beyond wall dressing or stucco.
- When used in the "HVHZ" this product complies with Section 1626 of the Florida Building Code and does not require an impact resistant covering.
- When used in areas outside of the "HVHZ" requiring wind borne debris protection this product complies with FBC Sections 1609.1.2 & R301.2.1.2 and does not require an impact resistant covering. This product meets missile level "D" and includes Wind Zone 4 as defined in ASTM E 1996 and FBC Sections 1609.1.2.2 & R301.2.1.2.1.
- For 2x stud framing construction, anchoring of these units shall be the same as that shown for 2x buck masonry construction.
- Site conditions that deviate from the details of this drawing require further engineering analysis by a licensed engineer or registered architect.
- This product meets water infiltration requirements for "HVHZ".
- Aluminum components, including fasteners, shall meet the requirements of FBC Section 2003.
- Gaskets shall comply with FBC Section 2411.3.4.

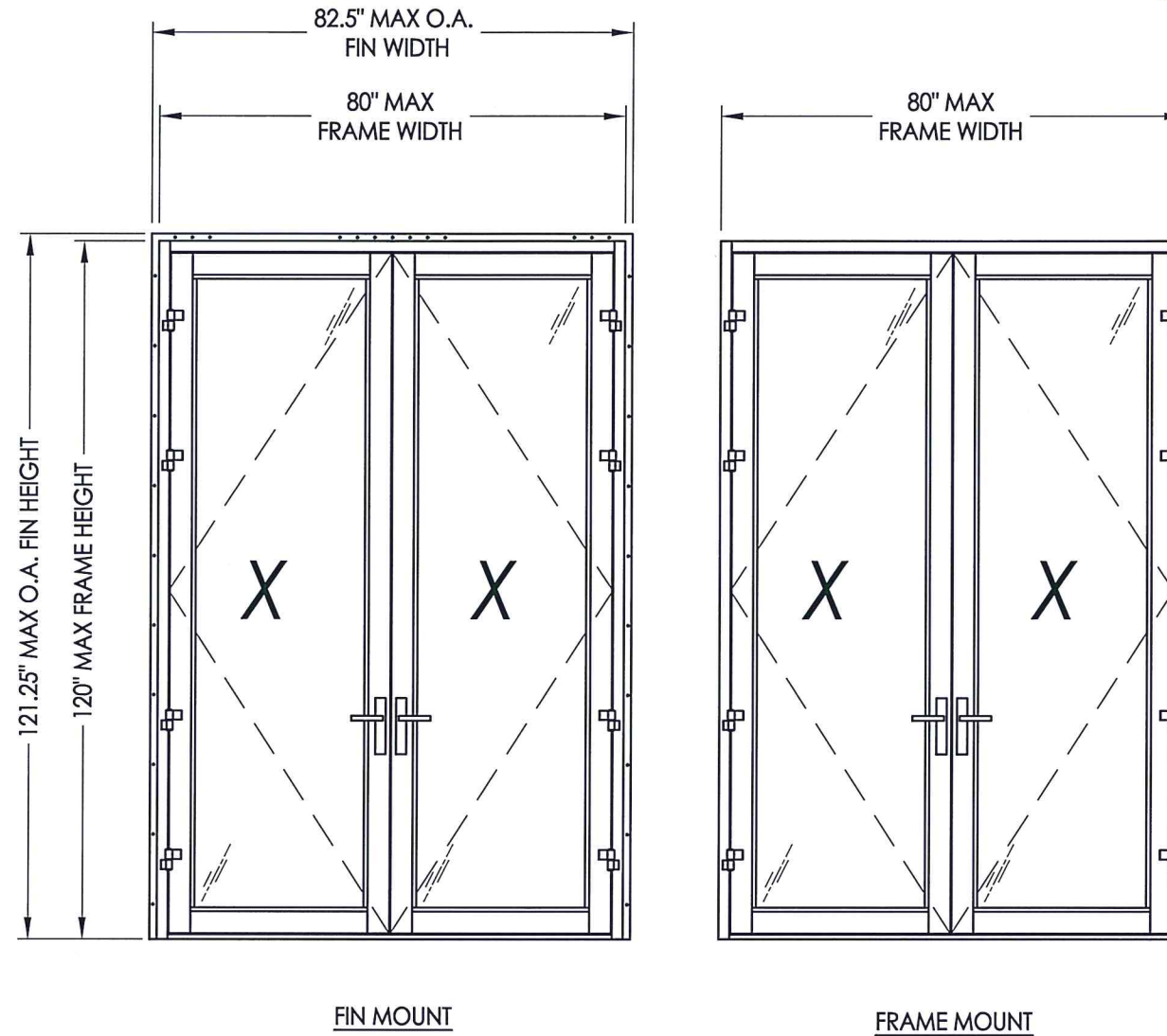
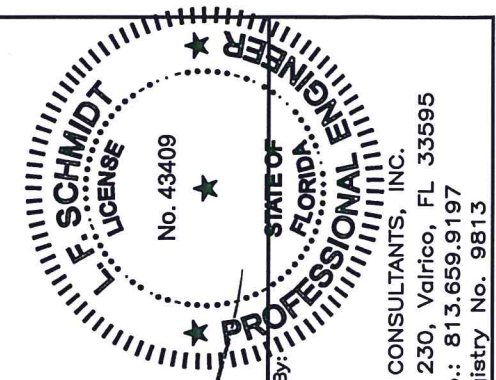

TABLE OF CONTENTS	
SHEET#	DESCRIPTION
1	Typical elevations, design pressures and general notes
2	Door panel details
3	Elevations
4	Horizontal cross sections
5	Vertical cross sections
6	Fin vertical and horizontal cross sections
7	Buck and frame anchoring
8	Glazing details
9	Bill of materials and components

SWING	MAX O.A. FIN DIMENSION	MAX O.A. FRAME DIMENSION	MAX DOOR D.L.O. DIMENSION	GLASS TYPE	DESIGN PRESSURE (PSF)	
					POSITIVE	NEGATIVE
OUTSWING	82.5" X 121.25"	80.0" X 120.0"	29.0" X 108.0"	G1, G2, G3, G4	+55.0*	-55.0*
INSWING	82.5" X 121.25"	80.0" X 120.0"	29.0" X 108.0"	G1, G2, G3, G4	+55.0*	-65.0*

*Requires welded shoot bolts for Design Pressure > 50 PSF



August 11, 2020
 Documents Prepared By:
 Lyndon F. Schmidt
 P.E. No. 43409

R.W. BUILDING CONSULTANTS, INC.
 P.O. Box 230, Valrico, FL 33595
 Phone No.: 813.659.9197
 FBPE Registry No. 9813

PRODUCT:		PART OR ASSEMBLY:		REVISIONS	
FLEETWOOD WINDOWS AND DOORS		TYPICAL ELEVATION, DESIGN PRESSURES & GENERAL NOTES		NO.	DATE
		3	8/11/20	UPDATE TO 7TH ED. (2020) FBC	DAC
		2	08/07/17	UPDATE TO 6TH ED. (2017) FBC	LFS
		1	11/2/15	REVISE DESIGN PRESSURES	JK
DATE: 7/22/15					
SCALE: N.T.S.					
DWG. BY: JK					
CHK. BY: LFS					
DRAWING NO.: FL-17954.2					
SHEET 1 OF 9					

\\dc01\work\clients\Electrowood_PERMANENTVA - Florida Product Approval\EL-17954 (2020)\EL-17954.2.dwg

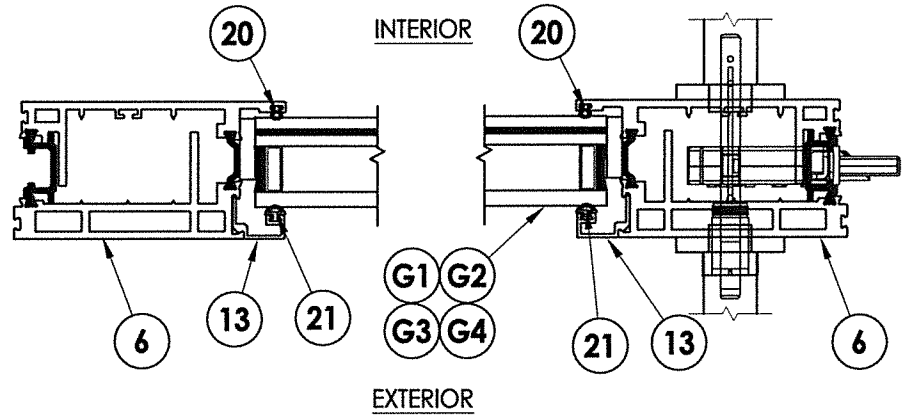

1 HORIZONTAL CROSS SECTION
2

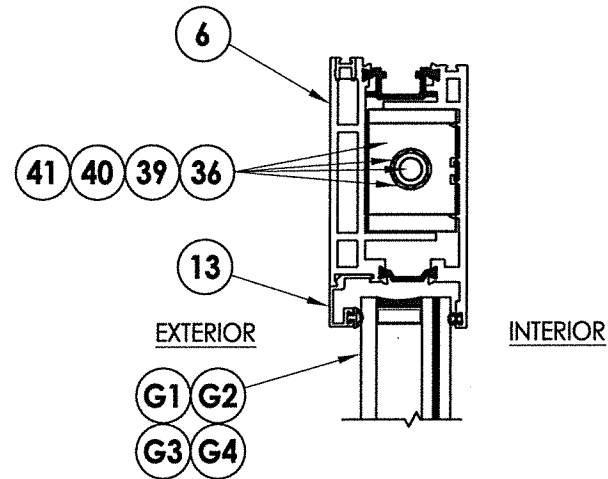

2 VERTICAL CROSS SECTION
2

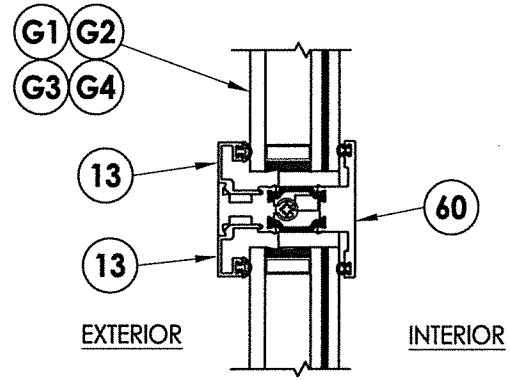

4 VERTICAL CROSS SECTION
2

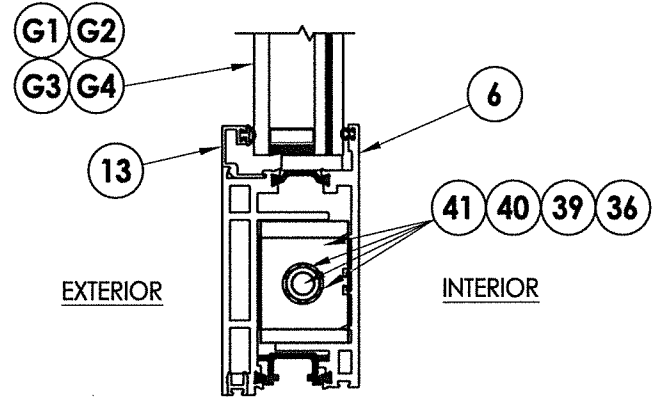

3 VERTICAL CROSS SECTION
2

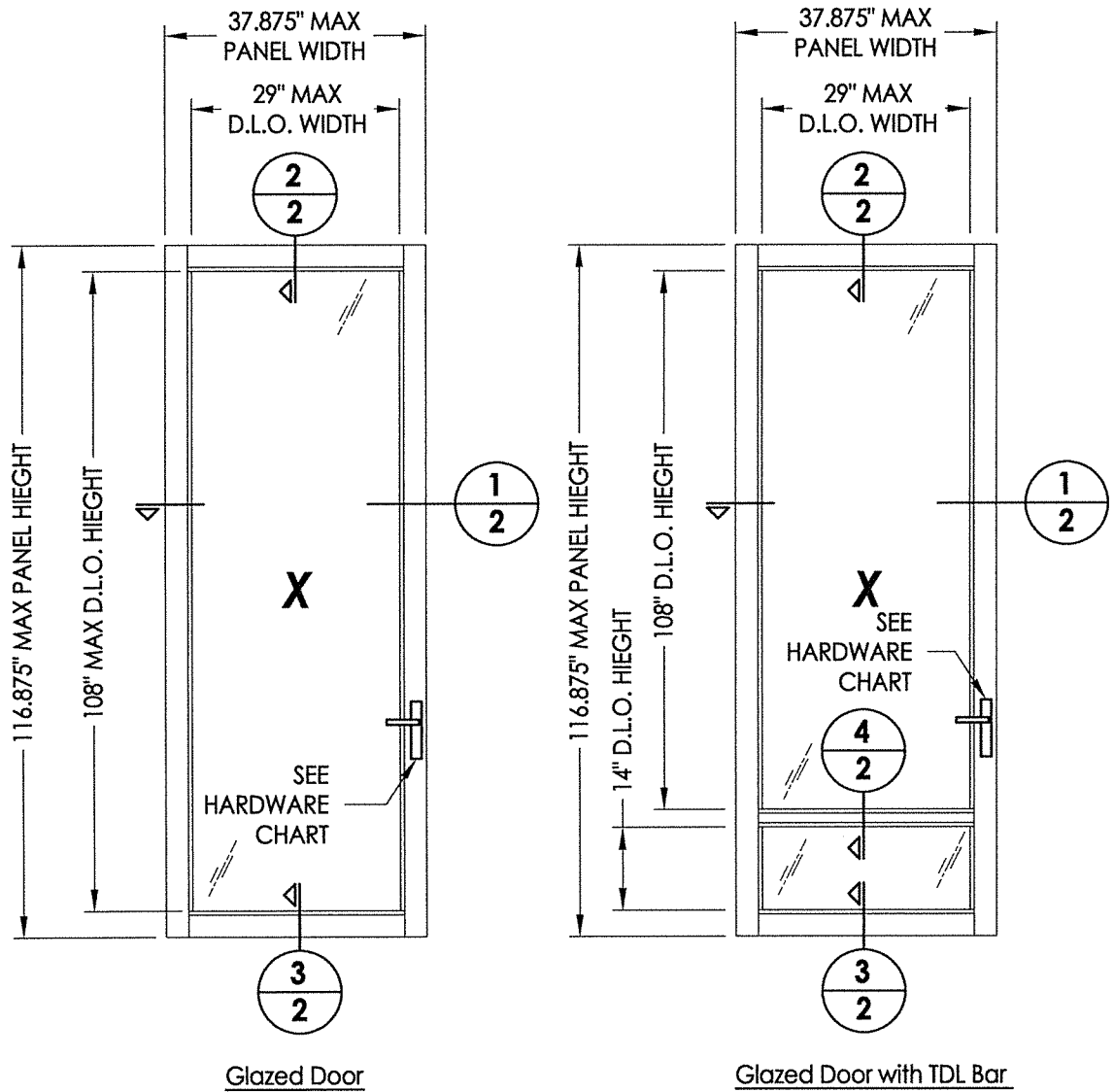

HARDWARE TABLE	
MANUFACTURER	MODEL
TRUTH	MULTI-POINT LOCK: 5 POINT LOCK

August 11, 2020
 Documents Prepared By:
 Lyndon F. Schmidt
 P.E. No. 43409

FLORIDA PROFESSIONAL ENGINEER
 L. F. SCHMIDT
 LICENSE No. 43409

RW BUILDING CONSULTANTS, INC.
 P.O. Box 230, Valrico, FL 33595
 Phone No.: 813.659.9197
 FBPE Registry No. 9813

PRODUCT:		FLEETWOOD WINDOWS AND DOORS	
PART OR ASSEMBLY:		DOOR PANEL DETAILS	
NO.	DATE	REVISIONS	BY
3	8/11/20	UPDATE TO 7th ED. (2020) FBC	DAC
2	08/07/17	UPDATE TO 6TH ED. (2017) FBC	LFS
1	11/2/15	REVISE DESIGN PRESSURES	JK
DATE: 7/22/15			
SCALE: N.T.S.			
DWG. BY: JK			
CHK. BY: LFS			
DRAWING NO.: FL-17954.2			
SHEET 2 OF 9			

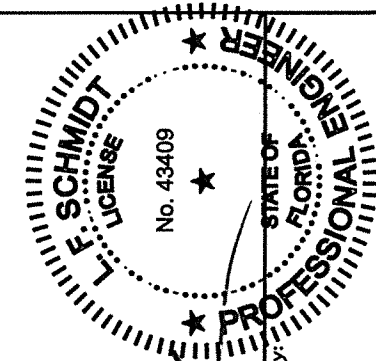
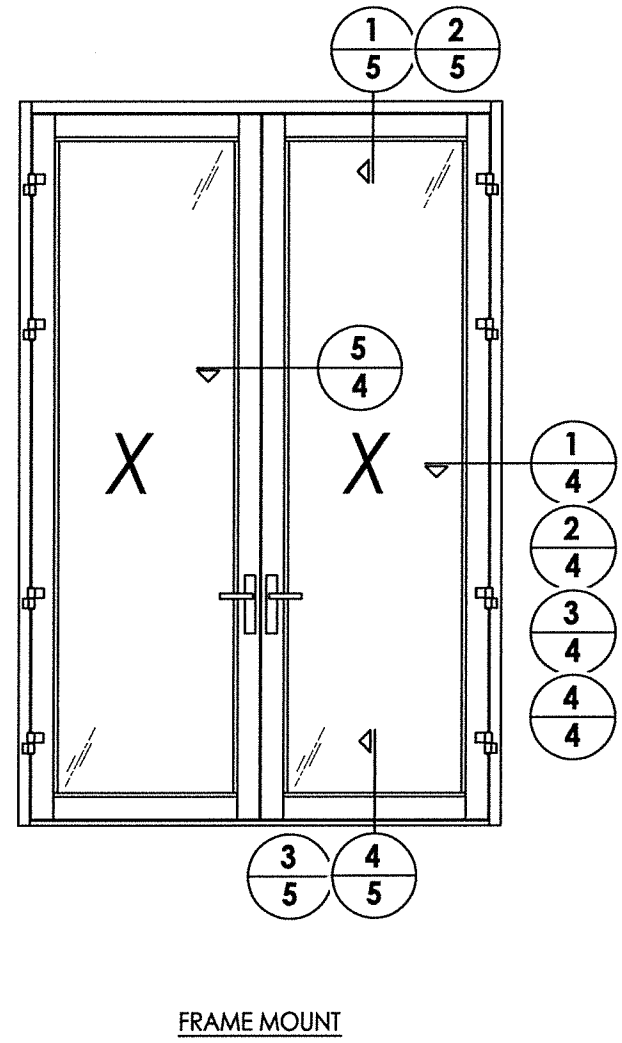
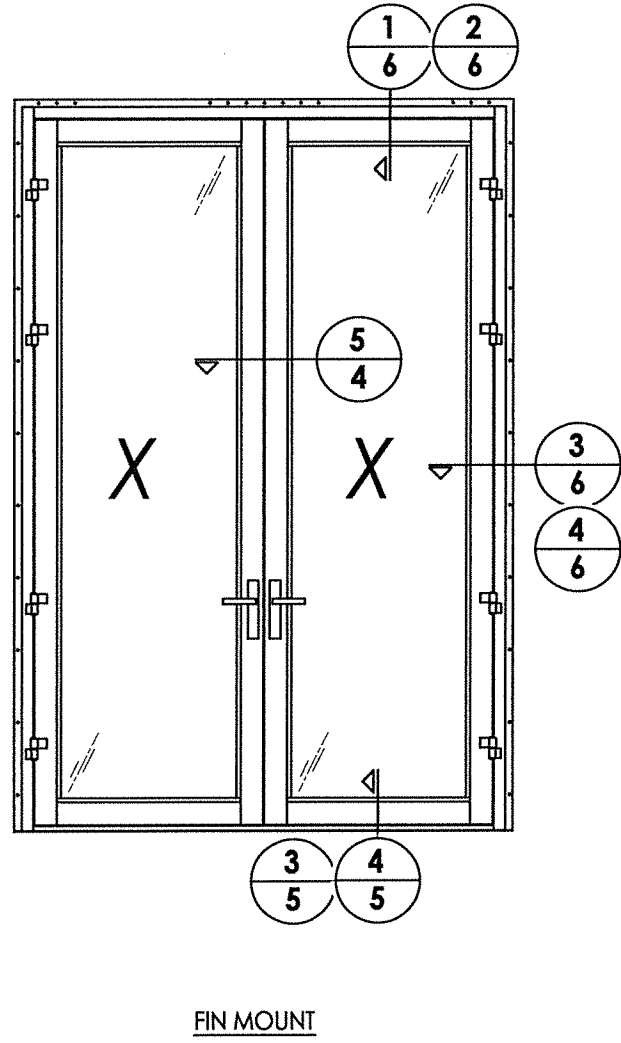

F. Schmidt
 August 11, 2020
 Documents Prepared By:
 Lyndon F. Schmidt
 P.E. No. 43409

RW BUILDING CONSULTANTS, INC.
 P.O. Box 230, Vairico, FL 33595
 Phone No.: 813.659.9197
 FBPE Registry No. 9813

PRODUCT:		FLEETWOOD WINDOWS AND DOORS	
PART OR ASSEMBLY:		ELEVATIONS	
NO.	DATE	BY	REVISIONS
3	8/11/20	DAC	UPDATE TO 7th ED. (2020) FBC
2	08/07/17	LFS	UPDATE TO 6TH ED. (2017) FBC
1	11/2/15	JK	REVISE DESIGN PRESSURES

DATE: 7/22/15
 SCALE: N.T.S.
 DWG. BY: JK
 CHK. BY: LFS
 DRAWING NO.: FL-17954.2
 SHEET 3 OF 9

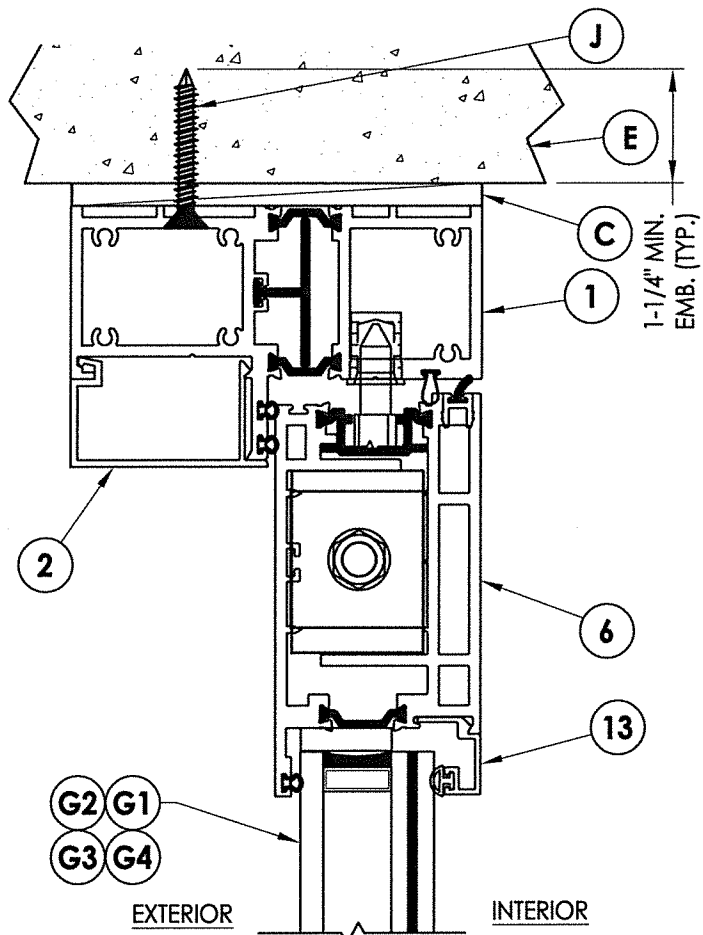

1 VERTICAL CROSS SECTION
5 Inswing Shown

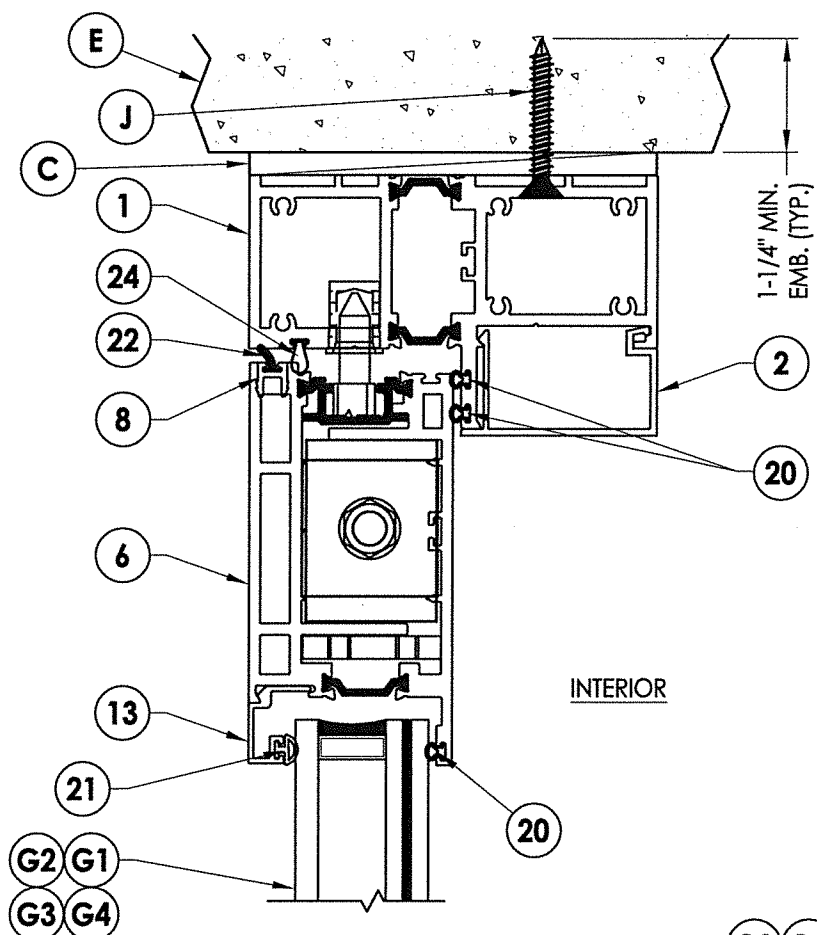

2 VERTICAL CROSS SECTION
5 Outswing Shown

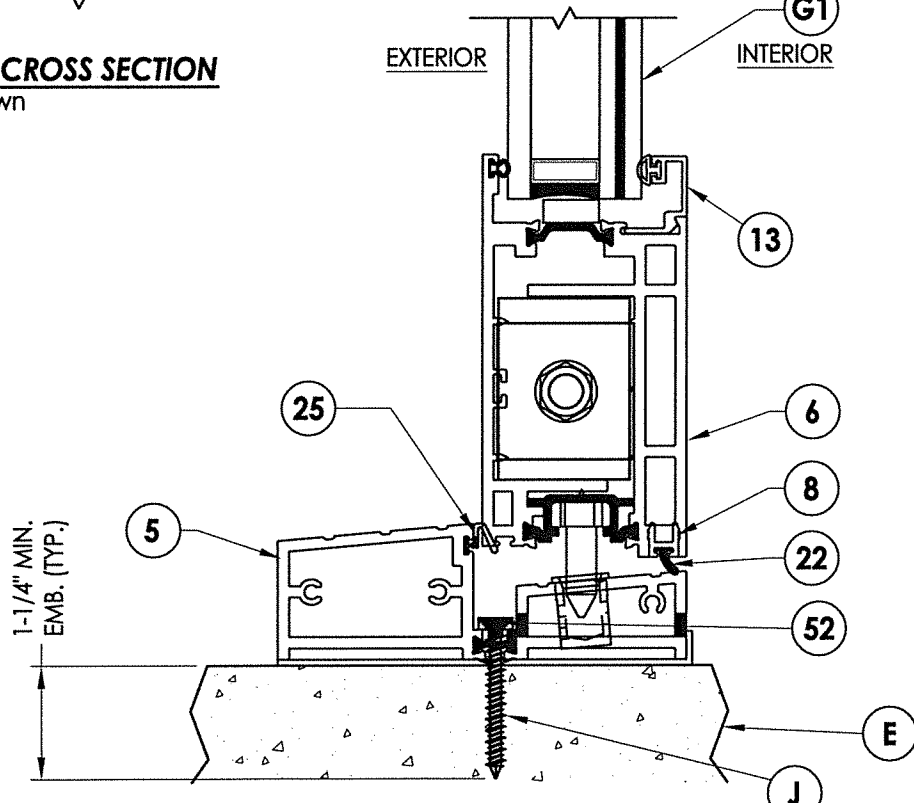

3 VERTICAL CROSS SECTION
5 Inswing Shown

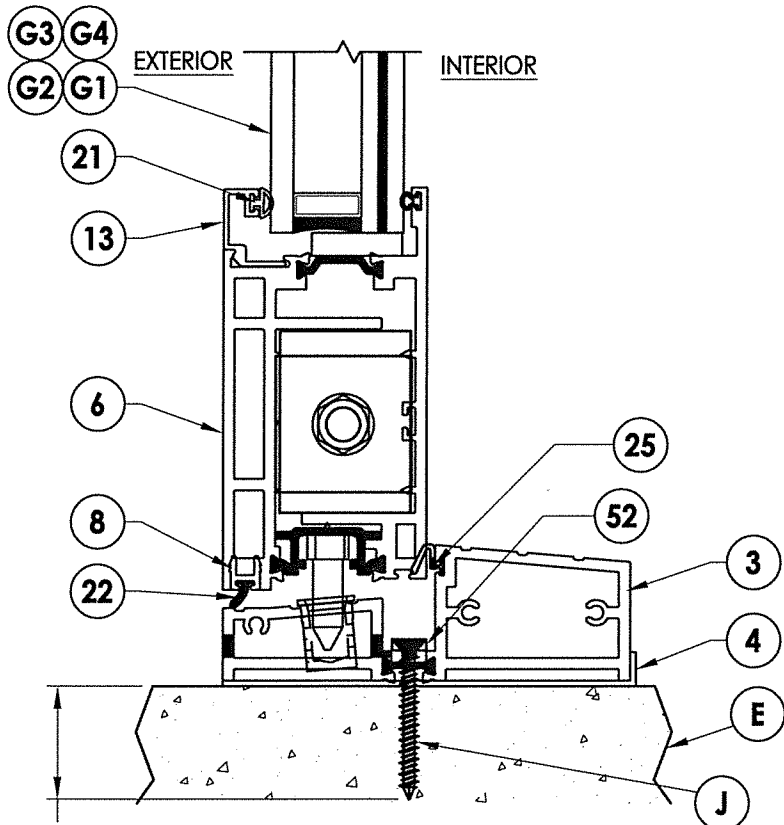

4 VERTICAL CROSS SECTION
5 Outswing Shown

August 11, 2020
 Documents Prepared By:
 Lyndon F. Schmidt
 P.E. No. 43409

RW
 BUILDING CONSULTANTS, INC.
 P.O. Box 230, Valrico, FL 33595
 Phone No.: 813.659.9197
 FBPE Registry No. 9813

FLEETWOOD WINDOWS AND DOORS		PART OR ASSEMBLY:	
VERTICAL CROSS SECTIONS		REVISIONS	
NO.	DATE	BY	DESCRIPTION
3	8/11/20	FBC	UPDATE TO 7th ED. (2020)
2	08/07/17	FBC	UPDATE TO 6TH ED. (2017)
1	11/2/15	JK	REVISE DESIGN PRESSURES
DATE: 7/22/15			
SCALE: N.T.S.			
DWG. BY: JK			
CHK. BY: LFS			
DRAWING NO.: FL-17954.2			
SHEET 5 OF 9			

R:\Clients\Fleetwood PERMANENTA - Florida Product Approvals\FL-17954 Side Hinged Door\C - Drawings\FL 17954 (2020)\FL-17954.2.5.dwg, 6.2

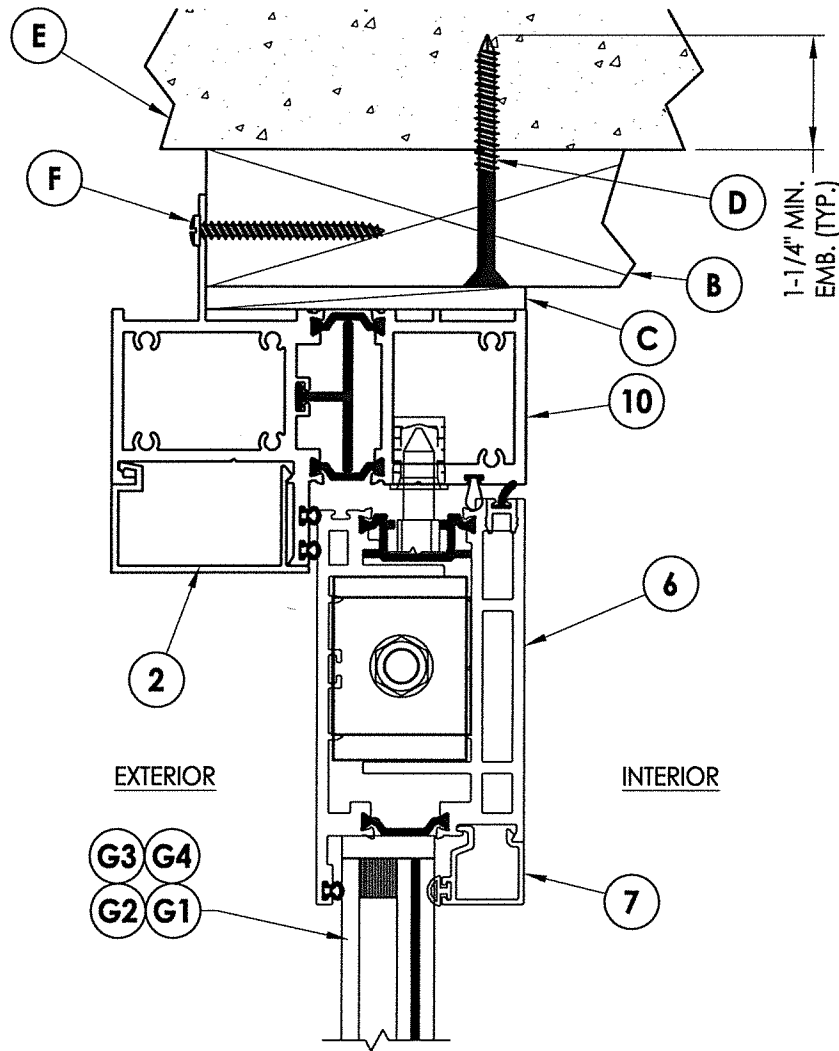

1 VERTICAL CROSS SECTION
6 Inswing shown

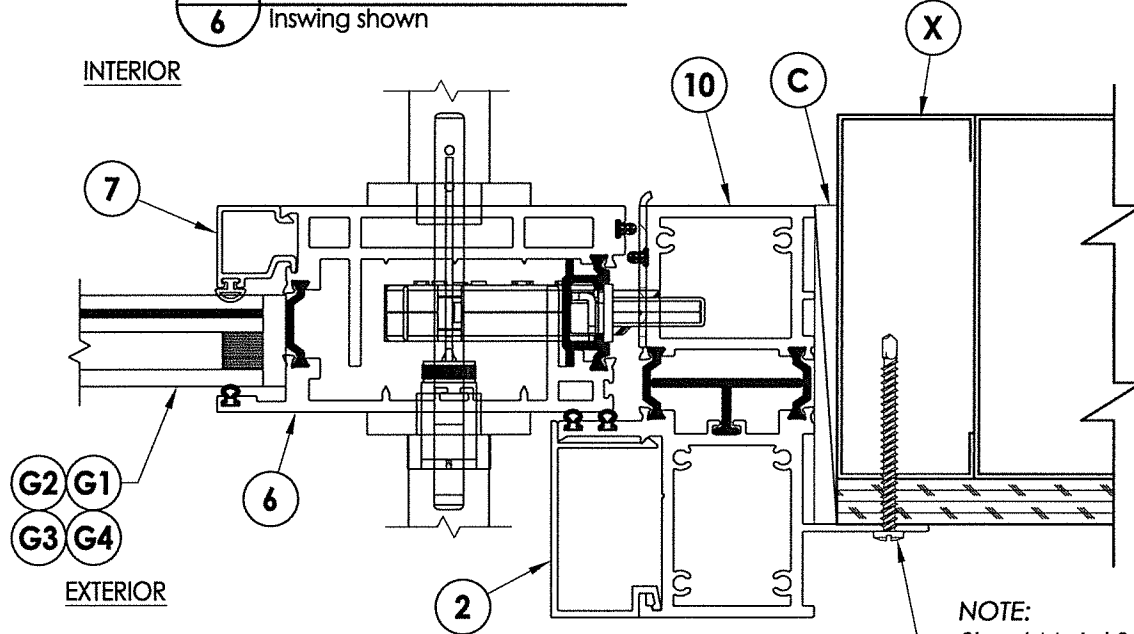

3 HORIZONTAL CROSS SECTION
6 Steel Stud Construction Inswing shown

NOTE:
Sheet Metal Screws must penetrate a min. of 3 threads through metal stud.

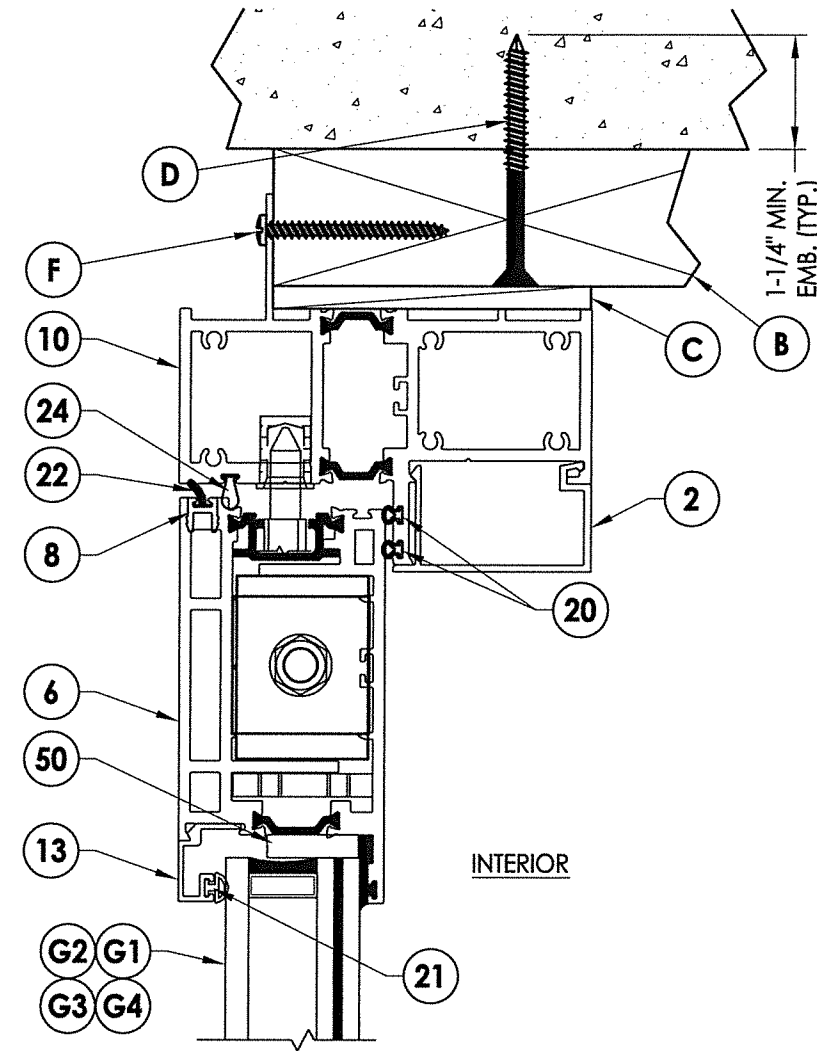

2 VERTICAL CROSS SECTION
6 Outswing shown

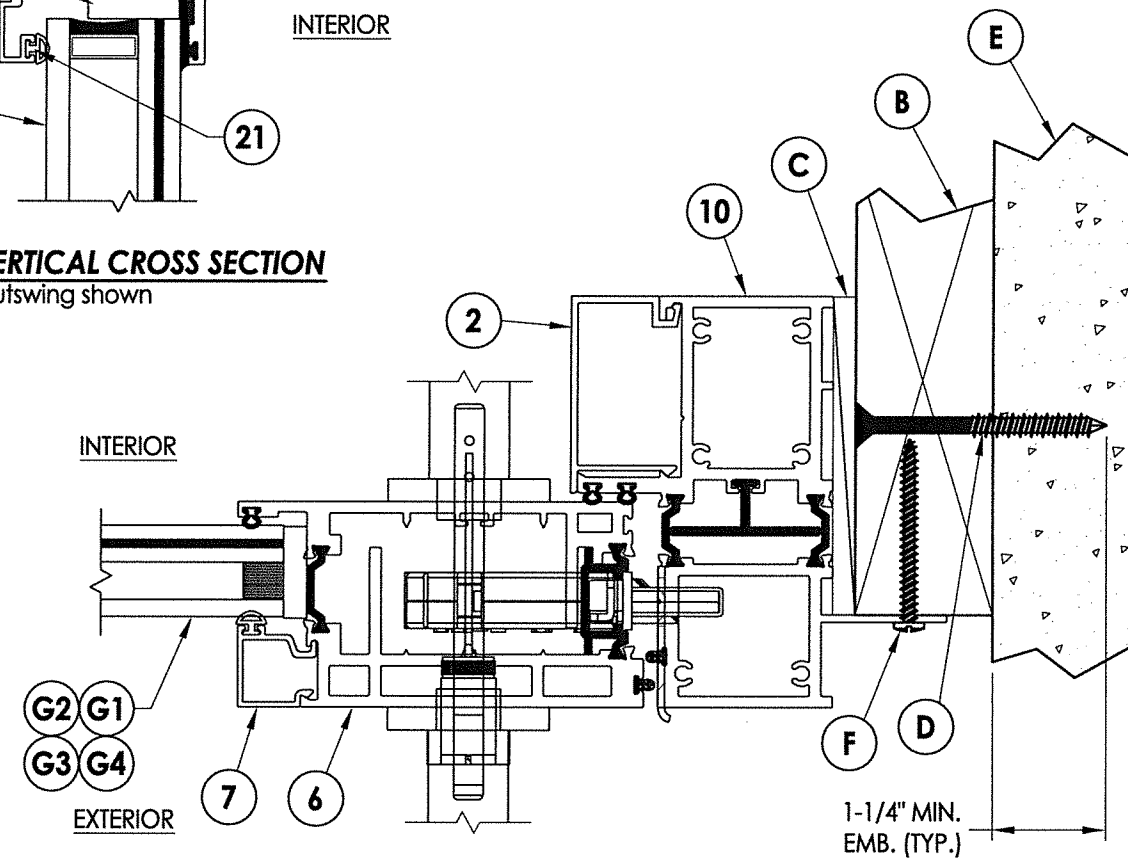

4 HORIZONTAL CROSS SECTION
6 2X Buck Construction Outswing shown

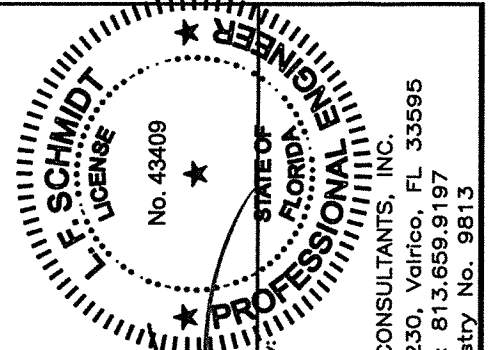

August 11, 2020
Documents Prepared By:
Lyndon F. Schmidt
P.E. No. 43409
RW BUILDING CONSULTANTS, INC.
P.O. Box 230, Valrico, FL 33595
Phone No.: 813.659.9197
FBPE Registry No. 9813

FLEETWOOD WINDOWS AND DOORS
PART OR ASSEMBLY:
FIN HORIZONTAL AND VERTICAL CROSS SECTIONS

NO.	DATE	REVISIONS
3	8/11/20	UPDATE TO 7th ED. (2020) FBC
2	08/07/17	UPDATE TO 6TH ED. (2017) FBC
1	11/2/15	REVISE DESIGN PRESSURES

DATE: 7/22/15
SCALE: N.T.S.
DWG. BY: JK
CHK. BY: LFS
DRAWING NO.: FL-17954.2
SHEET 6 OF 9

\\dc01\rbw\clients\Fleetwood PERMANENTVA - Florida Product Approvals\FL-17954 (2020)\FL-17954.2.5.dwg

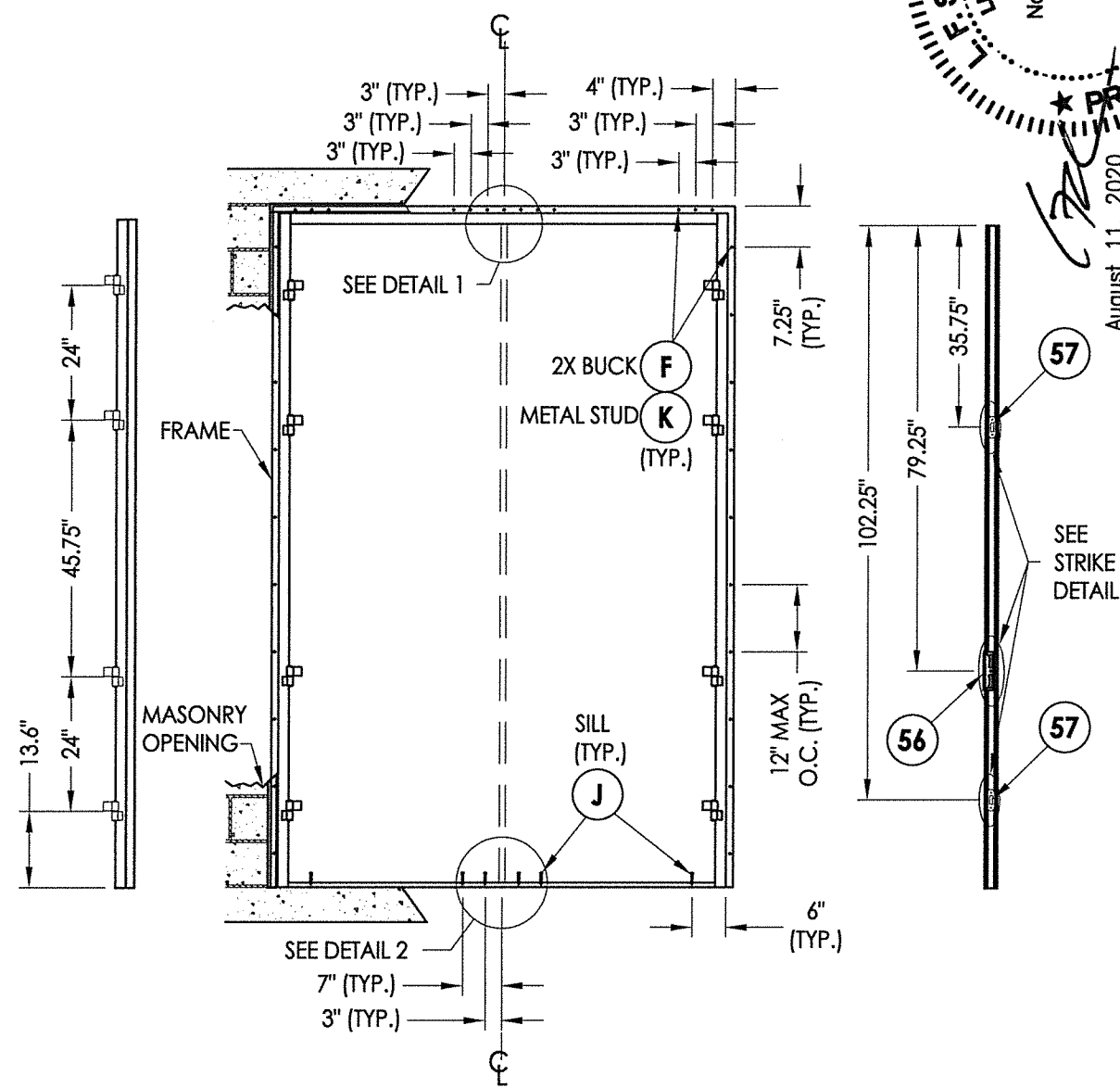
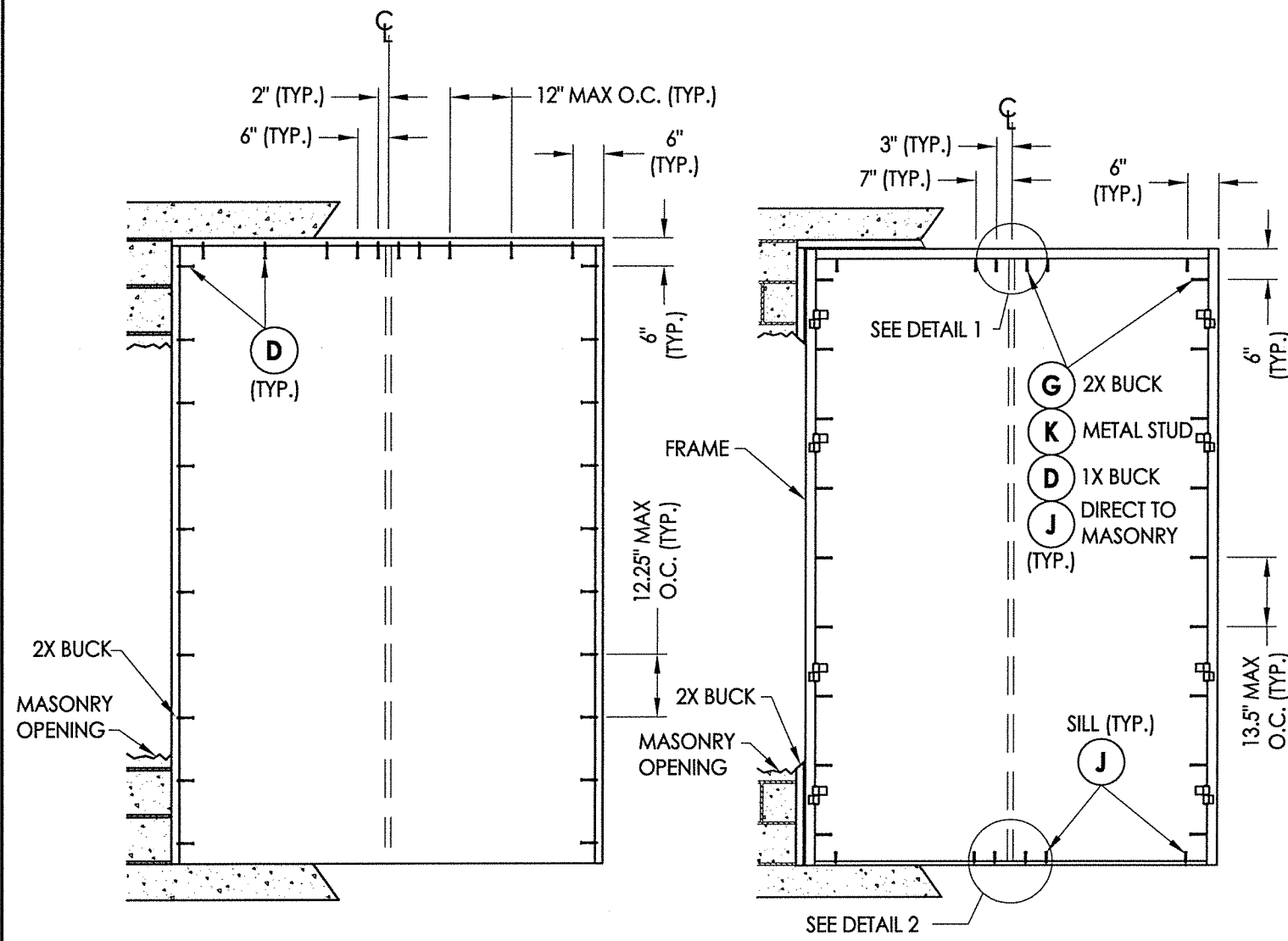

2X BUCK ANCHORING

FRAME ANCHORING

HINGE DETAIL

FIN ANCHORING

ASTRAGAL DETAIL

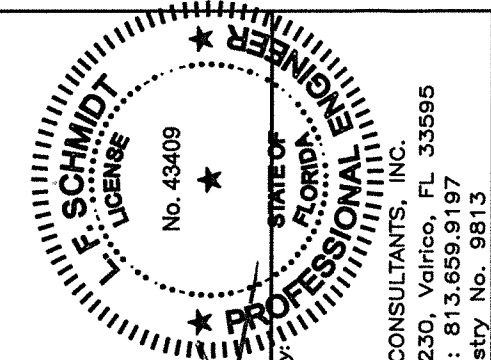
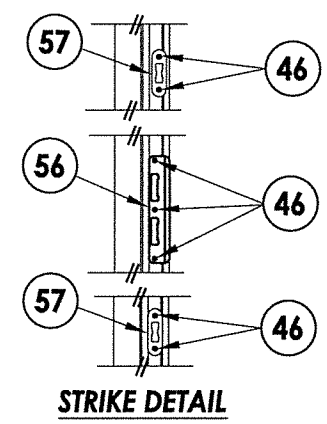
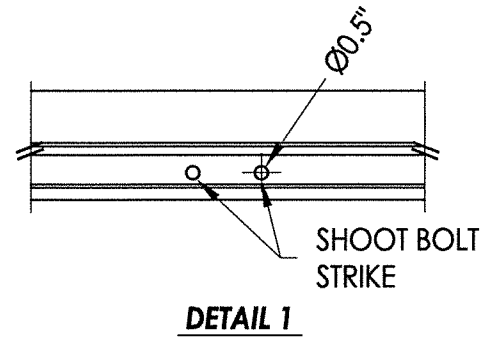
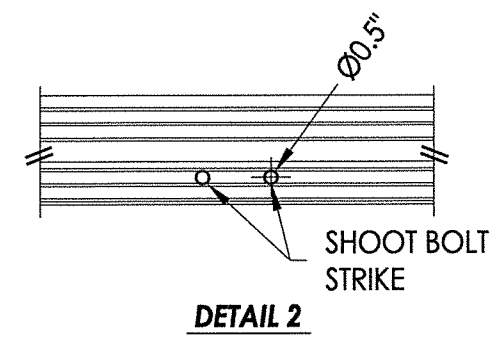

August 11, 2020
Documents Prepared By:
Lyndon F. Schmidt
P.E. No. 43409

PRODUCT:
FLEETWOOD WINDOWS AND DOORS
PART OR ASSEMBLY:
BUCK AND FRAME ANCHORING

NO.	DATE	REVISIONS
3	8/11/20	UPDATE TO 7TH ED. (2020) FBC
2	08/07/17	UPDATE TO 6TH ED. (2017) FBC
1	11/2/15	REVISE DESIGN PRESSURES

DATE: 7/22/15
SCALE: N.T.S.
DWG. BY: JK
CHK. BY: LFS
DRAWING NO.: FL-17954.2
SHEET 7 of 9

STATE OF FLORIDA
PROFESSIONAL ENGINEER
No. 43409
BUILDING CONSULTANTS, INC.
P.O. Box 230, Valrico, FL 33595
Phone No.: 813.659.9197
FBPE Registry No. 9813

\\dc01\rbcc\clients\Fleetwood PERMANENTVA - Florida Product Approvals\FL-17954 Side Hinged Door\C - Drawings\FL-17954 (2020)\FL-17954.2.5.dwg

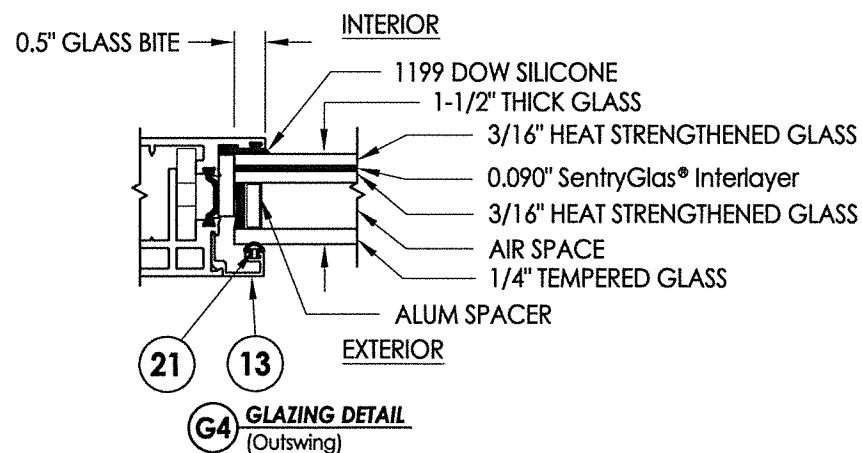
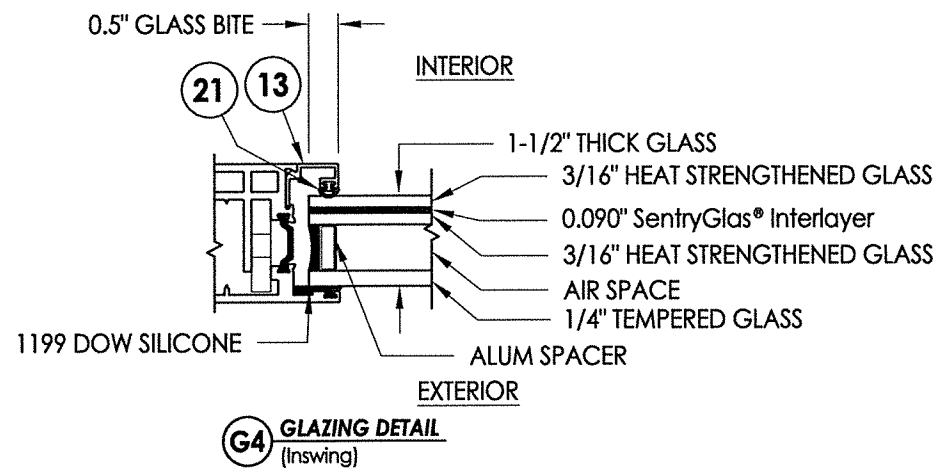
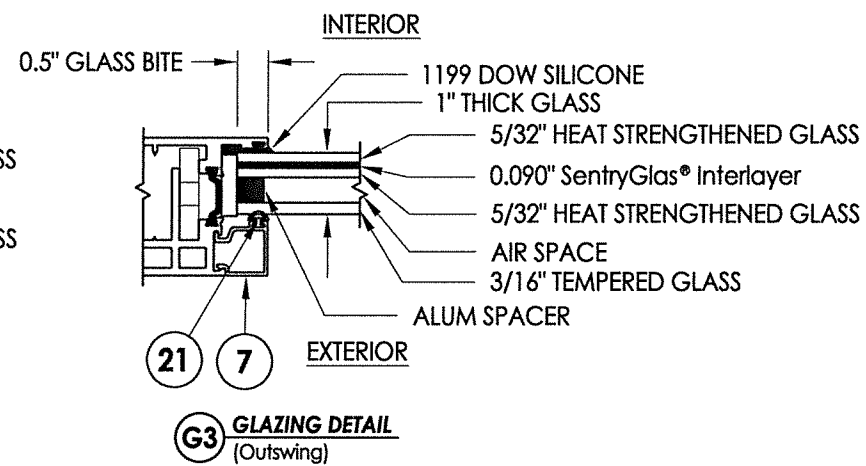
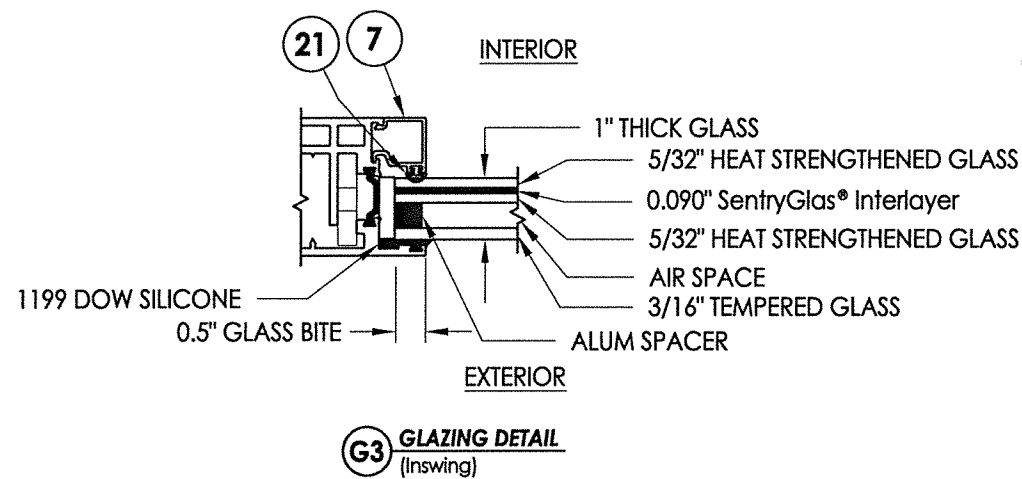
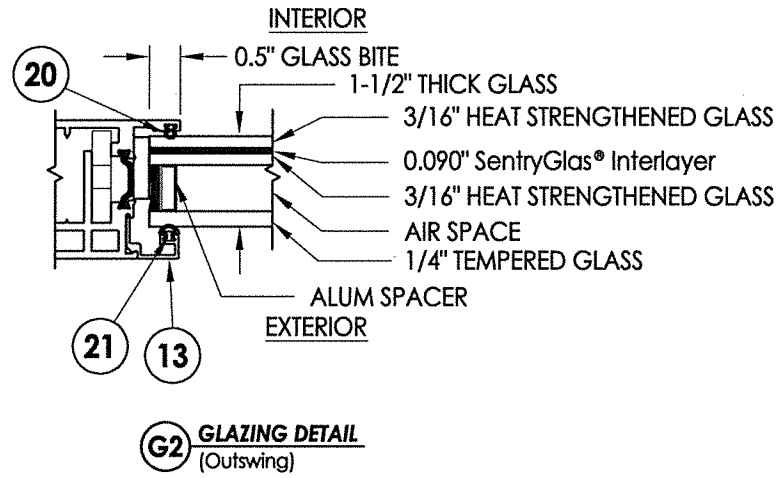
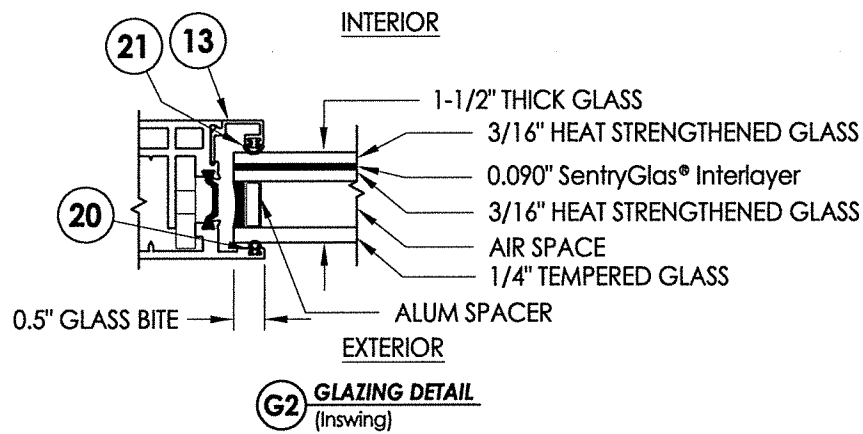
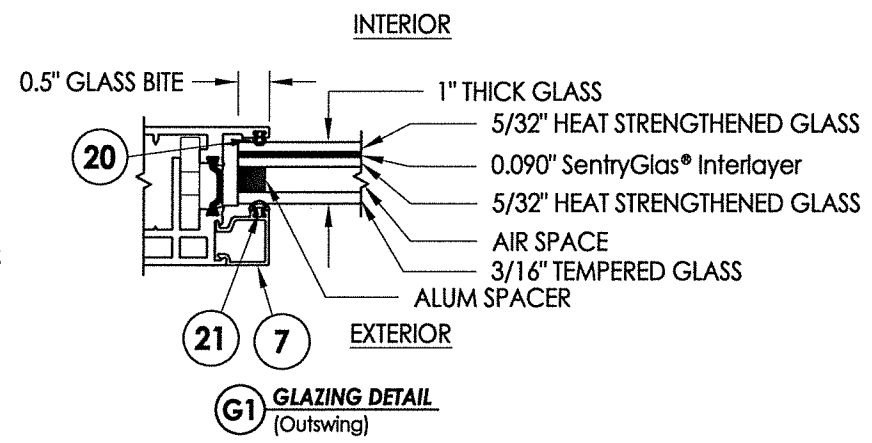
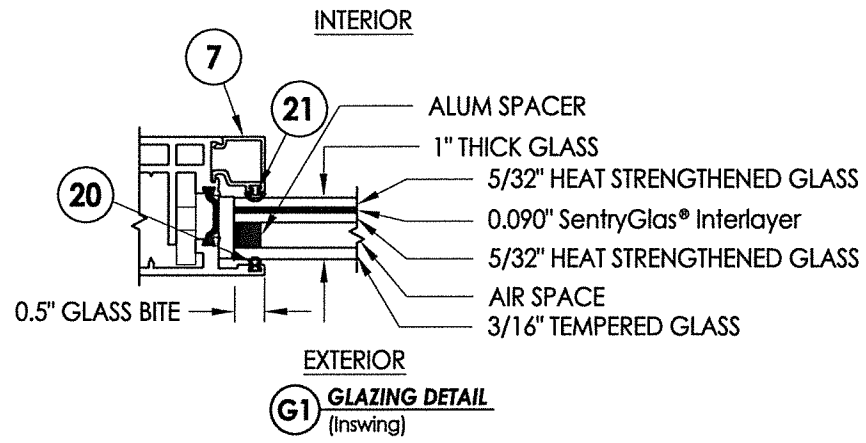

NOTE: GLAZING > 36" WIDE REQUIRES AT LEAST TWO (2) SETTING BLOCKS CONFORMING TO FBC SECTION 2411.3.3.1.

August 11, 2020
 Documents Prepared By:
 Lyndon F. Schmidt
 P.E. No. 43409

STATE OF FLORIDA
PROFESSIONAL ENGINEER
 No. 43409

R.W.
 BUILDING CONSULTANTS, INC.
 P.O. Box 230, Valrico, FL 33595
 Phone No.: 813.659.9197
 FBPE Registry No. 9813

PRODUCT:		FLEETWOOD WINDOWS AND DOORS	
PART OR ASSEMBLY:		GLAZING DETAILS	
NO.	DATE	BY	REVISIONS
3	8/11/20	DAC	UPDATE TO 7th ED. (2020)
2	08/07/17	FBC	UPDATE TO 6TH ED. (2017)
1	11/2/15	LFS	REVISE DESIGN PRESSURES

DATE:	7/22/15
SCALE:	N.T.S.
DWG. BY:	JK
CHK. BY:	LFS
DRAWING NO.:	FL-17954.2
SHEET	8 OF 9

© 2015 R.W. BUILDING CONSULTANTS INC.

\\dc01\ywb\clients\Fleetwood PERMANENTVA - Florida Product Approvals\FL-17954 Side Hinged Door\C - Drawings\FL 17954 (2020)\FL-17954.2.5.dwg

BILL OF MATERIALS		
ITEM #	DESCRIPTION	MATERIAL - MANUFACTURER
A	1X BUCK SG >= 0.55	WOOD
B	2X BUCK SG >= 0.55	WOOD
C	1/4" MAX. SHIM SPACE	-
D	1/4" X 2-3/4" DeWALT OR ITW PFH CONCRETE SCREW	STEEL
E	MASONRY - 3,000 PSI MIN. CONCRETE CONFORMING TO ACI 301 OR HOLLOW BLOCK CONFORMING TO ASTM C90	CONCRETE
F	#10 x 1-3/4" PPH WOOD SCREW (1-1/2" MIN. EMBEDMENT)	STEEL
G	#10 x 2" PPH WOOD SCREW (1-1/2" MIN. EMBEDMENT)	STEEL
J	1/4" X 2-1/4" ITW PFH CONCRETE SCREW	STEEL
K	#10 FH SELF-DRILLING SMS	STEEL
X	STEEL STUD Min. Thk .033" (ASTM A653 GRADE 33 Fy=33 Ksi Min, Fu=45 Ksi Min)	STEEL
1	FRAME	6063-T6 ALUM
2	FRAME SNAP-IN	6063-T6 ALUM
3	OUTSWING SILL	6063-T6 ALUM
4	SILL PAN	6063-T6 ALUM
5	INSWING SILL	6063-T6 ALUM
6	SASH	6063-T6 ALUM
7	1" GLASS STOP	6063-T6 ALUM
8	ATLANTIC SEAL CLIP	6063-T6 ALUM
10	FRAME (FIN)	6063-T6 ALUM
11	ASTRAGAL	6063-T6 ALUM
13	1.5" GLASS STOP	6063-T6 ALUM
20	BULB VINYL - MINI (EPDM 70 Durometer)	TREMCO, # TX20801E
21	BULB VINYL - LARGE (EPDM 70 Durometer)	TREMCO, # TX19638E
22	FOAM SEAL	EMESBURY, # 32390
23	Q-LON FOAM SEAL	SCHLEGEL CORP., # Q225T190
24	Q-LON FOAM SEAL	SCHLEGEL CORP., # Q375T190
25	Q-LON FOAM SEAL	SCHLEGEL CORP., # QEZ 376
31	BUTT HINGE	SAVIO
32	BACK UP KIT	SAVIO
33	HINGE BOLT, 8M X 48MM (FOR PANEL)	SAVIO
36	BACK UP PLATE FOR CORNER BLOCK	-
37	MACHINE SCREW NO 10-32, FHP 1.125"	STAINLESS STEEL
38	MACHINE SCREW NO 10-32, FHP .75"	STAINLESS STEEL
39	HEX HEAD CAP SCREW .375-16, 2.250"	STAINLESS STEEL
40	.375-16 SS. HEX NUT	STAINLESS STEEL
41	.375 SPLIT LOCK WASHER	STAINLESS STEEL
46	#10 X 1/2" PFH SMS	STAINLESS STEEL
47	#10 X 2" PFH SMS	STAINLESS STEEL
50	4" LONG SETTING BLOCK	-
56	LATCH AND DEADBOLT STRIKE PLATE	STAINLESS STEEL
57	STRIKE PLATE	STAINLESS STEEL
60	TDL BAR	6063-T6 ALUM

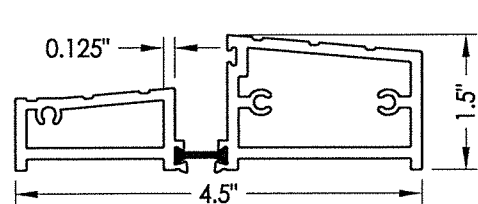

3 OUT-SWING SILL

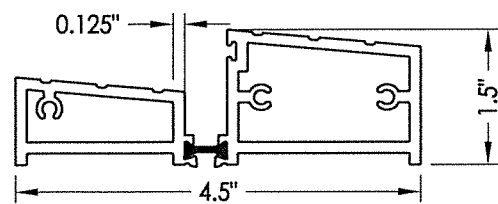

5 INSWING SILL

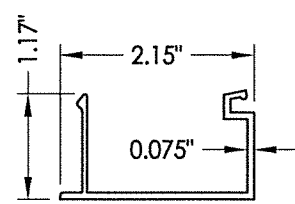

2 FRAME SNAP-IN

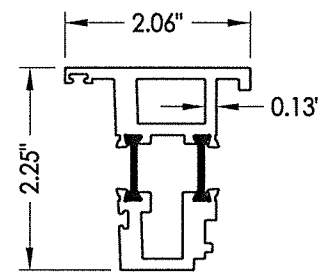

11 ASTRAGAL

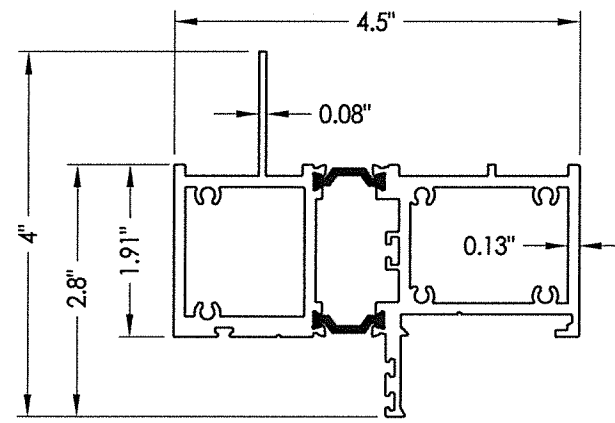

10 FRAME (FIN)

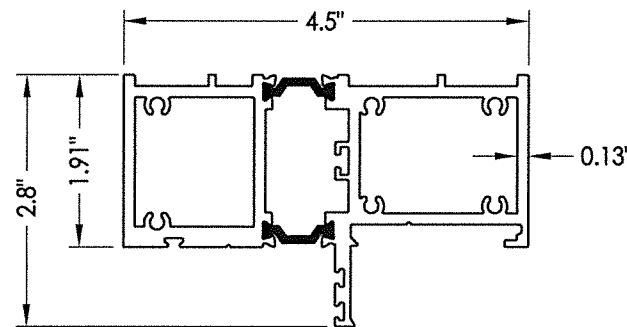

1 FRAME

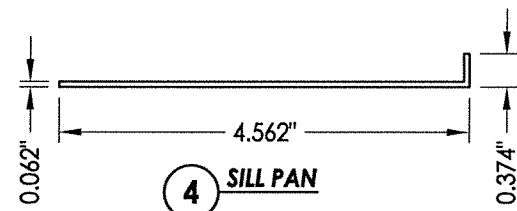

4 SILL PAN

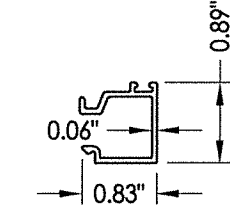

7 1" GLASS STOP

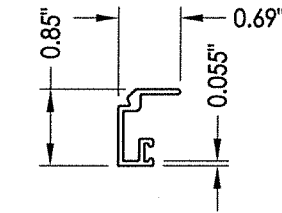

13 1.5" GLASS STOP

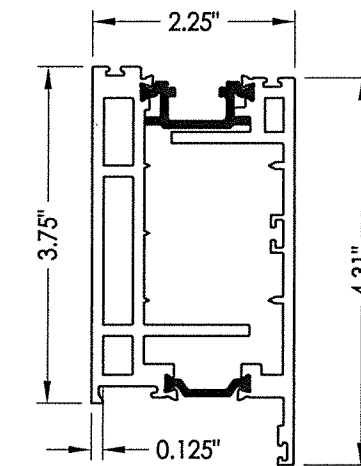

6 SASH

CONCRETE ANCHOR NOTES:

- Concrete anchor locations at the corners may be adjusted to maintain the min. edge distance to mortar joints.
- Concrete anchor locations noted as "MAX. ON CENTER" must be adjusted to maintain the min. edge distance to mortar joints, additional concrete anchors may be required to ensure the "MAX. ON CENTER" dimension are not exceeded.
- Concrete anchor table:

ANCHOR TYPE	ANCHOR SIZE	MIN. EMBEDMENT	MIN. CLEARANCE TO MASONRY EDGE	MIN. CLEARANCE TO ADJACENT ANCHOR
ITW TAPCON®	1/4"	1-1/4"	2"	4"
DeWALT ULTRACON®	1/4"	1-1/4"	1"	4"
ITW TAPCON®	3/16"	1-1/4"	3"	1-1/2"

WOOD SCREW INSTALLATION NOTES:

- Maintain a minimum 5/8" edge distance, 1" end distance, & 1" o.c. spacing of wood screws to prevent the splitting of wood.

August 11, 2020
 Documents Prepared By:
 Lyndon F. Schmidt
 P.E. No. 43409

BUILDING CONSULTANTS, INC.
 P.O. Box 230, Valrico, FL 33595
 Phone No.: 813.659.9197
 FBPE Registry No. 9813

PRODUCT:		FLEETWOOD WINDOWS AND DOORS	
PART OR ASSEMBLY:		BILL OF MATERIALS AND COMPONENTS	
NO.	DATE	REVISIONS	BY
3	8/11/20	UPDATE TO 7th ED. (2020) FBC	DAC
2	08/07/17	UPDATE TO 6TH ED. (2017) FBC	LFS
1	11/2/15	REVISE DESIGN PRESSURES	JK
DATE: 7/22/15			
SCALE: N.T.S.			
DWG. BY: JK			
CHK. BY: LFS			
DRAWING NO.: FL-17954.2			
SHEET 9 OF 9			

© 2015 R.W. BUILDING CONSULTANTS INC.