

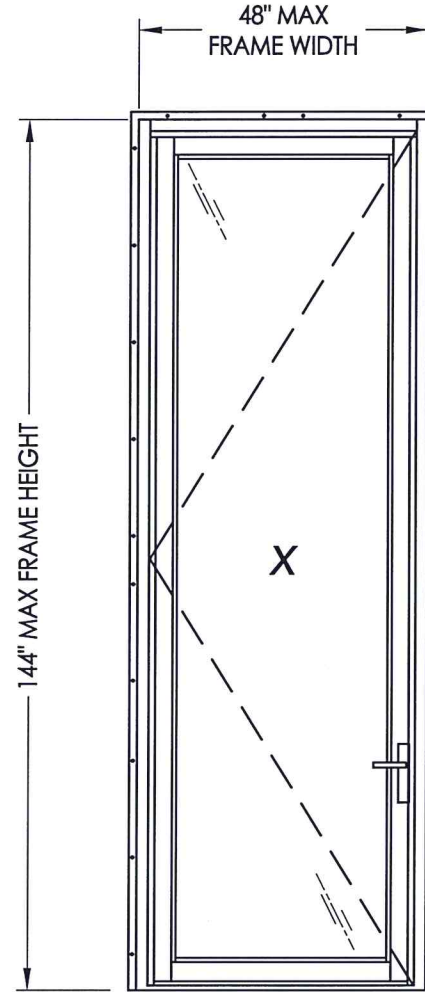

Series 3900-T

Aluminum Side Hinged Single Door

Inswing/Outswing "IMPACT"



FIN MOUNT

GENERAL NOTES

1. This product has been evaluated and is in compliance with the 7th Edition (2020) Florida Building Code (FBC) structural requirements including the "High Velocity Hurricane Zone" (HVHZ).
2. Product anchors shall be as listed and spaced as shown on details. Anchor embedment to base material shall be beyond wall dressing or stucco.
3. When used in the "HVHZ" this product complies with Section 1626 of the Florida Building Code and does not require an impact resistant covering.
4. When used in areas outside of the "HVHZ" requiring wind borne debris protection this product complies with FBC Sections 1609.1.2 & R301.2.1.2 and does not require an impact resistant covering. This product meets missile level "D" and includes Wind Zone 4 as defined in ASTM E 1996 and FBC Sections 1609.1.2.2 & R301.2.1.2.1.
5. Site conditions that deviate from the details of this drawing require further engineering analysis by a licensed engineer or registered architect.
7. This product meets water infiltration requirements for "HVHZ".
8. Aluminum components, including fasteners, shall meet the requirements of FBC Section 2003.
9. Gaskets shall comply with FBC Section 2411.3.4.

TABLE OF CONTENTS	
SHEET#	DESCRIPTION
1	Typical elevations, design pressures and general notes
2	Door panel & glazing details
3	Vertical cross sections
4	Vertical cross sections
5	Horizontal cross sections
6	Buck and frame anchoring
7	Bill of materials & components

MAX O.A. FRAME DIMENSION	MAX DOOR D.L.O. DIMENSION	GLASS TYPE	DESIGN PRESSURE (PSF) INSWING		DESIGN PRESSURE (PSF) OUTSWING	
			POSITIVE	NEGATIVE	POSITIVE	NEGATIVE
			48.0" X 144.0"	35.0" X 132.13"	G1, G2	+60.0

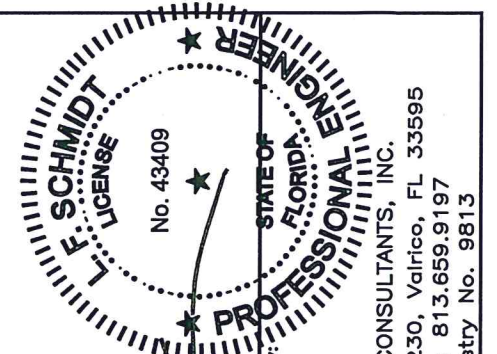

December 14, 2020
 Documents Prepared By:
 Lyndon F. Schmidt
 P.E. No. 43409

RW
 BUILDING CONSULTANTS, INC.
 P.O. Box 230, Valrico, FL 33595
 Phone No.: 813.659.9197
 FBPE Registry No. 9813

PRODUCT: FLEETWOOD WINDOWS & DOORS	PART OR ASSEMBLY: TYPICAL ELEVATION, DESIGN PRESSURES & GENERAL NOTES
NO. DATE	REVISIONS
DATE: 12/7/20 SCALE: N.T.S. DWG. BY: RW CHK. BY: LFS DRAWING NO.: FL-17954.8 SHEET 1 OF 7	

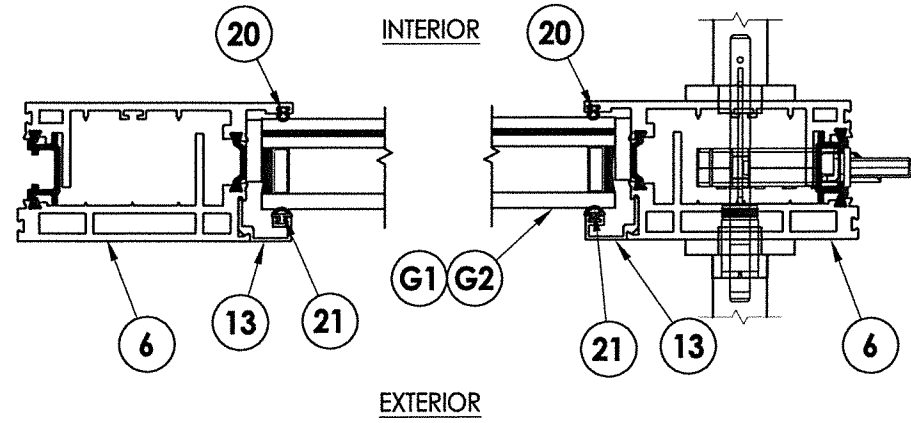

1
2
HORIZONTAL CROSS SECTION

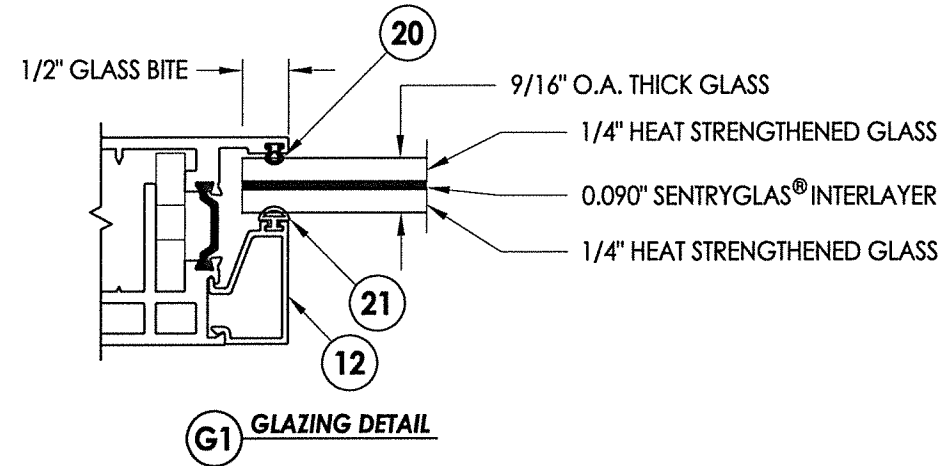
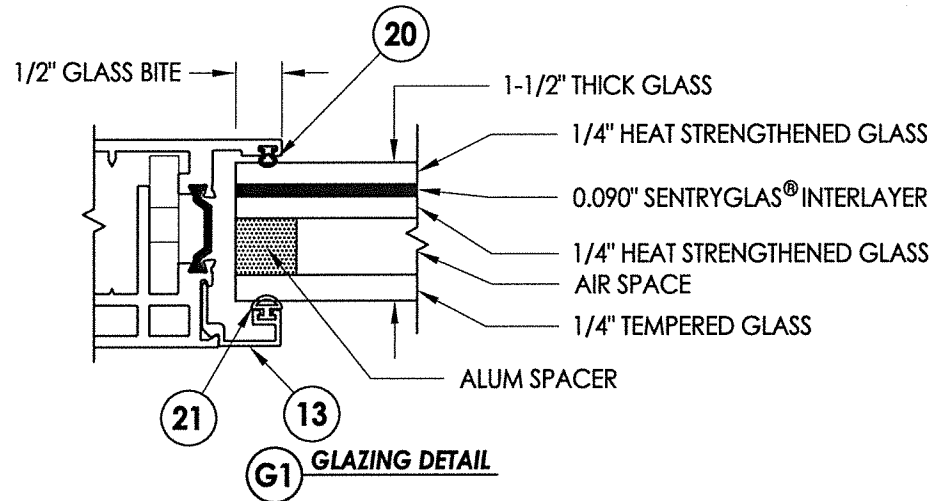
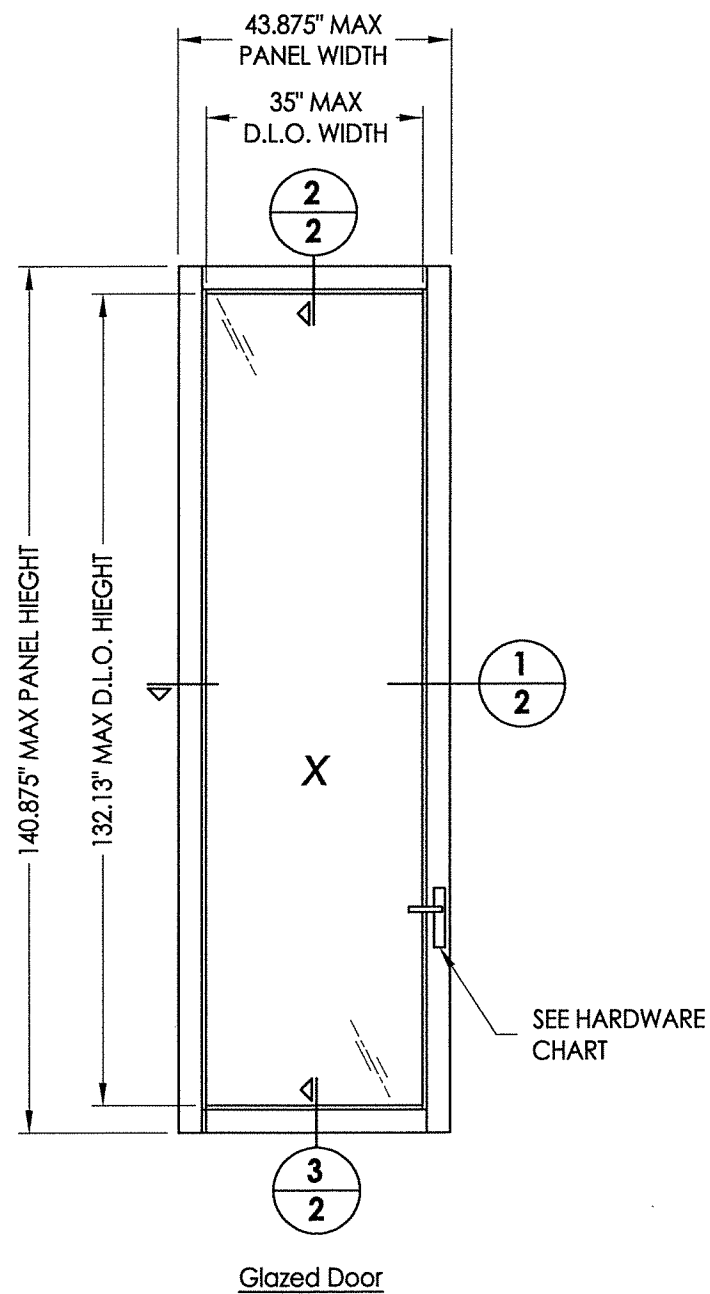

NOTE: GLAZING > 36\"/>

HARDWARE TABLE	
MANUFACTURER	MODEL
TRUTH	MULTI-POINT LOCK: 5 POINT LOCK
FUHR	MULTI-POINT ELECTRONIC LOCK: 5 POINT LOCK

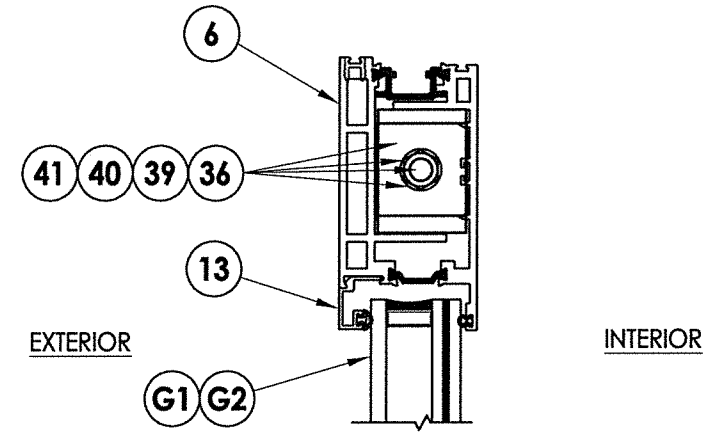

2
2
VERTICAL CROSS SECTION

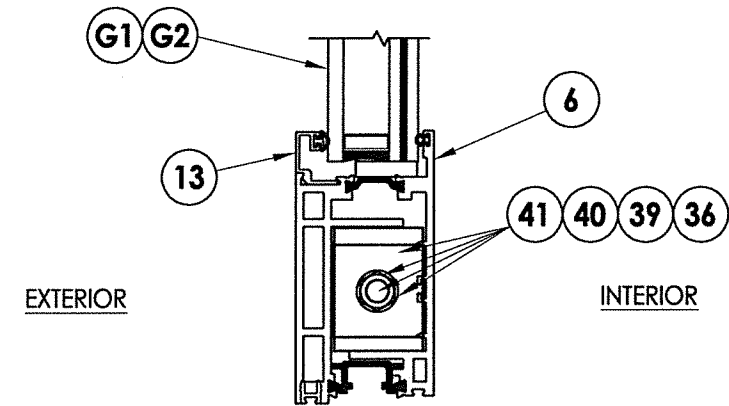

3
2
VERTICAL CROSS SECTION

December 14, 2020
 Documents Prepared By: Lyndon F. Schmidt
 P.E. No. 43409

FLORIDA PROFESSIONAL ENGINEER
 L. SCHMIDT LICENSE No. 43409

RW BUILDING CONSULTANTS, INC.
 P.O. Box 230, Vairico, FL 33595
 Phone No.: 813.659.9197
 FBPE Registry No. 9813

PRODUCT:	FLEETWOOD WINDOWS & DOORS	
PART OR ASSEMBLY:	DOOR PANEL & GLAZING DETAILS	
NO.	DATE	BY
REVISIONS		
DATE:	12/7/20	
SCALE:	N.T.S.	
DWG. BY:	RW	
CHK. BY:	LFS	
DRAWING NO.:	FL-17954.8	
SHEET	2	OF 7

