

SEE JAMB EXTENSION ASSEMBLY DETAIL, OPTIONAL Z-CLIP AND OPTIONAL HI-HAT DETAILS SHEET 2

SEE FLOOR BASE ANGLE DETAIL SHEET 2

TIIGA DOORWAY SYSTEM TDS-D-KD-WS  
EXTERIOR VIEW

DESIGN PRESSURE RATING	IMPACT RATING
± 50PSF	LARGE AND SMALL MISSILE IMPACT
THIS SYSTEM WAS NOT TESTED FOR WATER INFILTRATION AND IS TO BE INSTALLED ONLY WHERE THE WATER REQUIREMENT IS NOT NEEDED.	

NOTES:

- 1) THE PRODUCT SHOWN HEREIN IS DESIGNED AND MANUFACTURED TO COMPLY WITH REQUIREMENTS OF THE FLORIDA BUILDING CODE INCLUDING THE HVHZ.
- 2) STEEL FRAMING AND CONCRETE OPENING TO BE DESIGNED AND ANCHORED TO PROPERLY TRANSFER ALL LOADS TO STRUCTURE. FRAMING AND CONCRETE OPENING IS THE RESPONSIBILITY OF THE ARCHITECT OR ENGINEER OF RECORD.
- 3) BUILDING GIRT AND OPTIONAL INTERMEDIATE BUILDING GIRT TO BE DESIGNED AND ANCHORED TO PROPERLY TRANSFER ALL LOADS TO STRUCTURE. BUILDING GIRT AND OPTIONAL INTERMEDIATE GIRT ARE THE RESPONSIBILITY OF THE ARCHITECT OR ENGINEER OF RECORD.
- 4) ALLOWABLE STRESS INCREASE OF 1/3 WAS NOT USED IN THE DESIGN OF THE PRODUCT SHOWN HEREIN. WIND LOAD DURATION FACTOR Cd=1.6 WAS USED FOR WOOD ANCHOR CALCULATIONS.
- 5) FRAME MATERIAL: FORMED 16GA. (.053" MIN.) GALVANNEALED STEEL.
- 6) DOOR PANEL MATERIAL: FORMED 18GA. (.044" MIN.) GALVANNEALED STEEL.
- 7) APPROVED IMPACT PROTECTIVE SYSTEM IS NOT REQUIRED FOR THIS PRODUCT IN WIND BORNE DEBRIS REGIONS.
- 8) EACH PANEL IS FITTED WITH THREE HINGES LOCATED AT 6" MINIMUM UPTO 10" MAXIMUM FROM EACH END WITH ONE AT PANEL MIDSPAN.

HARDWARE SCHEDULE

A. ML 1300 MORTISE LOCK BY TELL MANUFACTURING, INC.
B. STEEL SURFACE BOLTS 988Y BY YALE SECURITY, INC.
C. STEEL ASTRAGAL .140" THICK BY TELL DOORS & WINDOWS, LLC
D. STEEL HINGES H4545 BY TELL MANUFACTURING, INC.
E. ALUMINUM THRESHOLD 1/2" HIGH BY HOUSTON NON-FERROUS

TABLE OF CONTENTS

SHEET NO	DESCRIPTION
1	ELEVATION, ANCHORING LAYOUT AND NOTES
2	DETAILS AND NOTES
3	BILL OF MATERIALS AND CROSS SECTION
4	CROSS SECTION
5 - 6	INSTALLATION DETAILS
7 - 8	COMPONENTS

Robert J. Amoruso, P.E.  
Florida P.E. No. 49752



PTC PRODUCT DESIGN GROUP, LLC  
PO BOX 520775 | LONGWOOD, FLORIDA 32752  
FBPE C.A. NO. 25935  
Phone: 321.690.1788 | Email: info@ptc-corp.com

DRAFTER	DATE	TELL DOORS & WINDOWS, LLC. 6535 GUHN RD, STE 100, HOUSTON, TX 77040	
CHECKED	DATE	TITLE TIIGA DOORWAY SYSTEM TDS-D-KD-WS OS STEEL DOUBLE DOOR - IMPACT ELEVATION, ANCHORING LAYOUT AND NOTES	
ENGINEER	DATE TJH 06/03/10	SIZE B	DWG NO 08-01018
APPROVED	DATE R.J.A. 10/17/23	RELEASE STATE FINAL	
THIRD ANGLE PROJECTION 		SCALE NTS	REV B
		SHEET 1 OF 8	



THIS DOCUMENT IS THE PROPERTY OF SPECTRUM BRANDS, INC. AND/OR ITS AFFILIATES. THE CONTENTS OF THIS DOCUMENT ARE CONFIDENTIAL AND CONSTITUTE TRADE SECRETS PROPRIETARY TO SPECTRUM BRANDS. NEITHER THIS DOCUMENT NOR ITS CONTENTS SHALL BE DISCLOSED TO ANY UNAUTHORIZED PERSON, COPIED, OR PUBLISHED WITHOUT SPECTRUM BRANDS' PRIOR WRITTEN CONSENT.

TELL MANUFACTURING, INC.  
18 RICHARD DRIVE, LITITZ, PA 17543

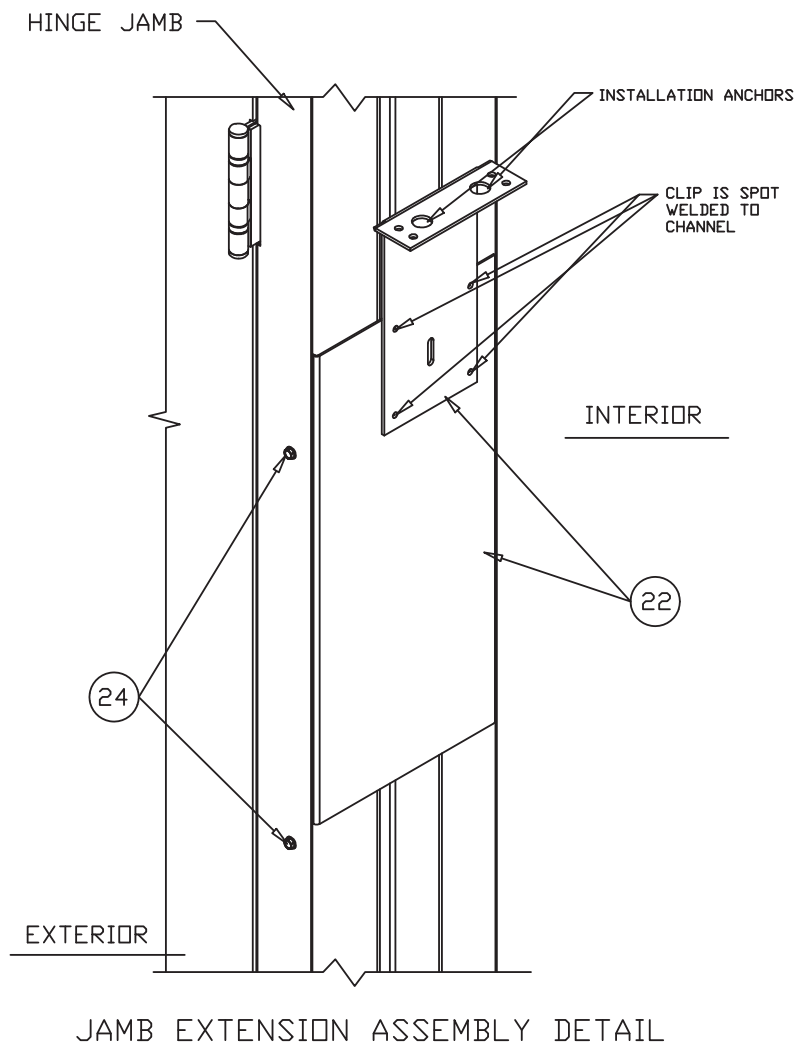
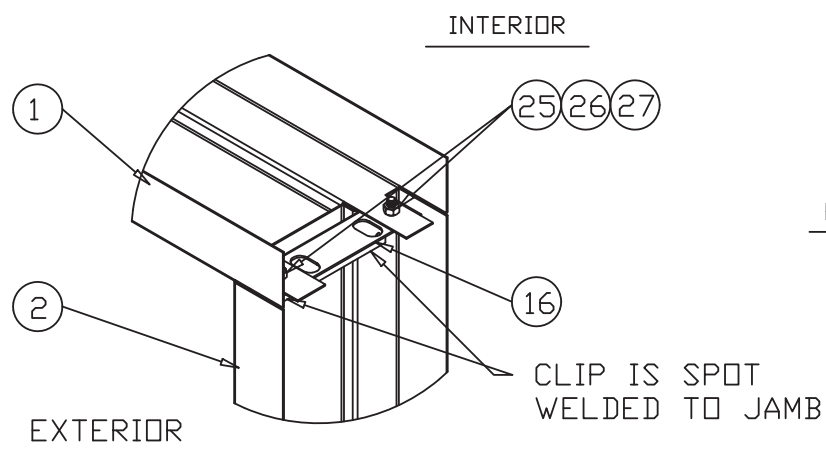
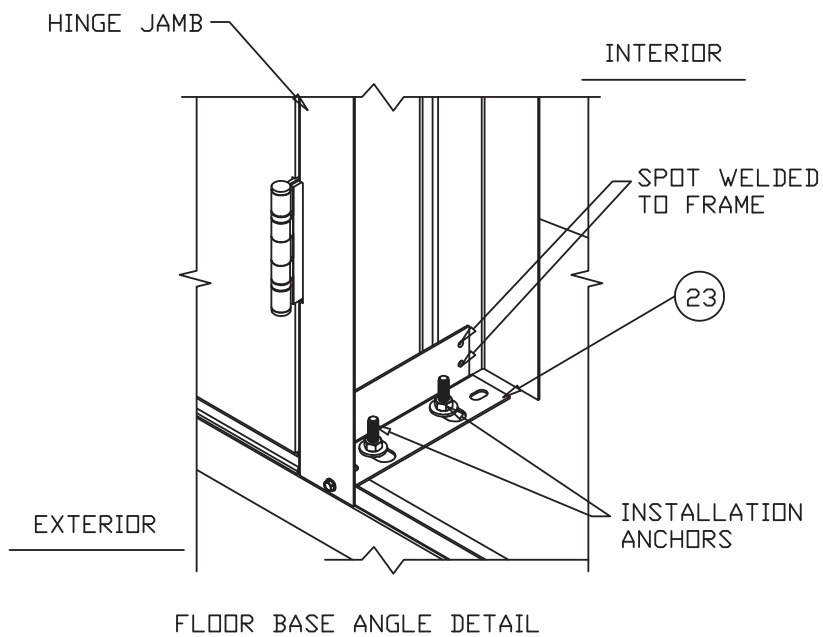

CORNER CONSTRUCTION DETAIL

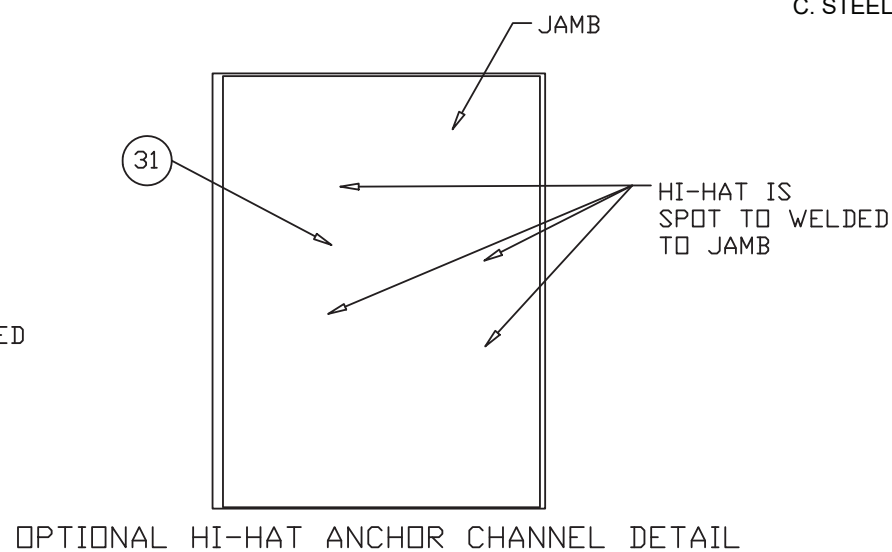
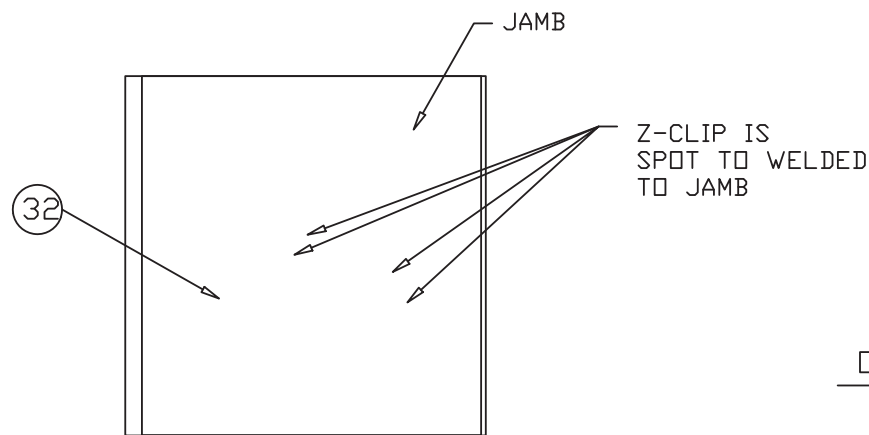

NOTES:

- 1) FOR ANCHORING JAMB EXTENSION ASSEMBLY TO 16GA. (.060" MIN.) STEEL FRAMING USE 5/16"-18 BOLT WITH 5/16"-18 NUT AND 5/16" WASHER. BOLT TO BE OF SUFFICIENT LENGTH TO ACHIEVE 3-THREADS MINIMUM BEYOND NUT. LOCATE ANCHORS AS SHOWN IN ELEVATIONS AND INSTALLATION DETAILS.
- 2) FOR ANCHORING OPTIONAL Z-CLIP AND HI-HAT ANCHOR CHANNELS TO 16GA. (.060" MIN.) STEEL FRAMING USE (2) 5/16" SELF TAPPING SCREWS OR (4) #12 TEK SCREWS, BOTH OF SUFFICIENT LENGTH TO ACHIEVE 3-THREADS MINIMUM BEYOND ANCHOR CHANNELS. LOCATE ANCHORS AS SHOWN IN ELEVATIONS AND INSTALLATION DETAILS. SEE NOTE SHEET 6.
- 3) FOR ANCHORING FLOOR BASE ANGLE INTO CONCRETE USE:
  - 5/16" MINIMUM 90° L-BOLT SET IN CONCRETE WITH 5/16" NUT AND WASHER. BOLT TO BE OF SUFFICIENT LENGTH TO ACHIEVE 6" MINIMUM EMBEDMENT INTO CONCRETE AND 3-THREADS MINIMUM BEYOND NUT AND WASHER WITH 2 3/4" MINIMUM EDGE DISTANCE. 90° L-BOLT TO BE MINIMUM A36 STEEL.
  - 3/8" HILTI KWIK BOLT 3 OF SUFFICIENT LENGTH TO ACHIEVE 2 1/2" MINIMUM EMBEDMENT INTO CONCRETE WITH 4 1/2" MINIMUM EDGE DISTANCE
  - 3/8" WEDGE BOLT OF SUFFICIENT LENGTH TO ACHIEVE 2" MINIMUM EMBEDMENT INTO CONCRETE WITH 4 1/2" MINIMUM EDGE DISTANCE.
  - 5/16" ITW TAPCON OF SUFFICIENT LENGTH TO ACHIEVE 1 3/4" MINIMUM EMBEDMENT INTO CONCRETE WITH 3 3/16" MINIMUM EDGE DISTANCE. LOCATE ALL ANCHORS AS SHOWN IN ELEVATIONS AND INSTALLATION DETAILS.
- 4) FOR ANCHORING THRESHOLD INTO CONCRETE USE 3/16" ITW TAPCONS WITH SUFFICIENT LENGTH TO ACHIEVE A 1 3/4" MINIMUM EMBEDMENT INTO SUBSTRATE WITH 2 1/4" MINIMUM EDGE DISTANCE. LOCATE ANCHORS AS SHOWN IN ELEVATIONS AND INSTALLATION DETAILS.
- 5) FOR ANCHORING JAMB EXTENSION ASSEMBLY, FLOOR BASE ANGLE, OPTIONAL Z-CLIP ANCHOR CHANNEL OR OPTIONAL HI-HAT ANCHOR CHANNEL TO WOOD SUBSTRATE USE 5/16" LAG SCREW WITH MINIMUM EMBEDMENT OF 1-3/4", MINIMUM EDGE DISTANCE OF 1-1/4" AND MINIMUM SPACING OF 1-1/4". LOCATE ALL ANCHORS AS SHOWN IN ELEVATIONS AND INSTALLATION DETAILS.
- 6) WASHERS SHALL BE USED WHEN ANCHORS ARE INSTALLED IN OVERSIZE HOLES (CLIP HOLE DIAMETER 1/16" GREATER DIAMETER THAN ANCHOR DIAMETER).
- 7) MINIMUM 2 ANCHORS PER JAMB EXTENSION ASSEMBLY, FLOOR BASE ANGLE, OPTIONAL Z-CLIP ANCHOR CHANNEL OR OPTIONAL HI-HAT ANCHOR CHANNEL FOR ATTACHMENT TO SUPPORTING SUBSTRATE.
- 8) ALL FASTENERS TO BE CORROSION RESISTANT.
- 9) INSTALLATION ANCHORS SHALL BE INSTALLED IN ACCORDANCE WITH ANCHOR MANUFACTURER'S INSTALLATION INSTRUCTIONS, AND ANCHORS SHALL NOT BE USED IN SUBSTRATES WITH STRENGTHS LESS THAN THE MINIMUM STRENGTH SPECIFIED BELOW:
  - A. WOOD - MINIMUM SPECIFIC GRAVITY OF G=0.42 (NON-HVHZ) AND G=0.55 (HVHZ).
  - B. CONCRETE - MINIMUM COMPRESSIVE STRENGTH OF 3,192 PSI.
  - C. STEEL FRAMING, 16GA. (.060" MIN.)

Robert J. Amoruso, P.E.  
Florida P.E. No. 49752

PTC PRODUCT DESIGN GROUP, LLC  
PO BOX 520775 | LONGWOOD, FLORIDA 32752  
FBPE C.A. NO. 25935  
Phone: 321.690.1788 | Email: info@ptc-corp.com

DRAFTER	DATE	TELL DOORS & WINDOWS, LLC. 6535 GUHN RD, STE 100, HOUSTON, TX 77040	
CHECKED	DATE	TITLE TIOGA DOORWAY SYSTEM TDS-D-KD-WS OS STEEL DOUBLE DOOR - IMPACT DETAILS AND NOTES	
ENGINEER	DATE TJH 06/03/10	SIZE B	DWG NO 08-01018
APPROVED	DATE R.J.A. 10/17/23	RELEASE STATE	FINAL
THIRD ANGLE PROJECTION 		SCALE NTS	REV B ITER SHEET 2 OF 8

TELL MANUFACTURING, INC.  
18 RICHARD DRIVE, LITITZ, PA 17543

TELL MFG

**Spectrum Brands** | Hardware & Home Improvement

THIS DOCUMENT IS THE PROPERTY OF SPECTRUM BRANDS, INC AND/OR ITS AFFILIATES. THE CONTENTS OF THIS DOCUMENT ARE CONFIDENTIAL AND CONSTITUTE TRADE SECRETS PROPRIETARY TO SPECTRUM BRANDS. NEITHER THIS DOCUMENT NOR ITS CONTENTS SHALL BE DISCLOSED TO ANY UNAUTHORIZED PERSON, COPIED, OR PUBLISHED WITHOUT SPECTRUM BRANDS' PRIOR WRITTEN CONSENT.

PARTS LIST

NO.	PART NUMBER	DESCRIPTION	MANUFACTURER	MATERIAL
1	T-1.3.1	TIOGA KD HEAD JAMB 16GA.	TELL MANUFACT.	GALVANNEALED STEEL
2	T-1.2	TIOGA KD HINGE JAMB 16GA.	TELL MANUFACT.	GALVANNEALED STEEL
3	T-1.7	THRESHOLD, 1/2" HIGH	HOUSTON NON-FER.	ALUMINUM 6063-T5
4	T-1.2.2	FRAME HINGE REINFORCEMENT 10GA.	DAYTON INDUSTRIES	GALVANNEALED STEEL
5	T-1.1.1	TIOGA BOTTOM DOOR SKIN 18GA.	TELL MANUFACT.	GALVANNEALED STEEL
6	T-1.1.2	TIOGA TOP DOOR SKIN 18GA.	TELL MANUFACT.	GALVANNEALED STEEL
7	T-1.1.3	TOP CAP DOOR CHANNEL 20GA.	TELL MANUFACT.	GALVANNEALED STEEL
8	T-1.1.4	TOP DOOR CHANNEL 16GA.	TELL MANUFACT.	GALVANNEALED STEEL
9	T-1.1.5	BOTTOM DOOR CHANNEL 16GA.	TELL MANUFACT.	GALVANNEALED STEEL
10	T-1.1.6	DOOR HINGE REINFORCEMENT 10GA.	DAYTON INDUSTRIES	GALVANNEALED STEEL
11	T-1.1.7	DOOR FOAM CORE 1 LB/FT <sup>3</sup> DENSITY		POLYSIYRENE
12	T-1.1.8	DOOR CLOSER REINFORCEMENT 12GA.	TELL MANUFACT.	GALVANNEALED STEEL
13	T-1.1.10	MORTISE LOCK REINFORCEMENT 14GA.	TELL MANUFACT.	GALVANNEALED STEEL
14	T-1.1.11	OVERLAP STRIP ASTRAGAL 11 GA.	TELL MANUFACT.	GALVANNEALED STEEL
15	T-1.1.12	INACTIVE DOOR EDGE CHANNEL 16GA.	TELL MANUFACT.	GALVANNEALED STEEL
16	T-1.2.3	HINGE JAMB CLIP 12GA	TELL MANUFACT.	GALVANNEALED STEEL
17	T-1.2.4	FRAME WEATHERSTRIPPING		FOAM
18	T-1.5	HINGES - H4545 SERIES	TELL MANUFACT.	STEEL
19	T-1.68	MORTISE LOCK ML 1300	TELL MANUFACT.	STEEL
20	988Y	SURFACE BOLT	YALE SECURITY	STEEL
21	T-1.8	DOOR SWEEP, DT100101	TELL MANUFACT.	ALUMINUM 6063-T5
22	T-2	JAMB EXTENSION ASSEMBLY 16 / 12GA	TELL MANUFACT.	GALVANNEALED STEEL
23		FLOOR BASE ANGLE		GALVANNEALED STEEL
24	S1	#12-24 X 1 1/4" HEX HEAD TEK		STEEL
25	B1	5/16"-18 X 3/4" HEX CAP SCREW		STEEL
26	N1	HEX NUT 5/16"		STEEL
27	W1	FLAT WASHER 5/16"		STEEL
28	S2	#8-32 X 1/2" PPH SMS		STEEL
29	S2	#14 X 1/2" PFH SMS		STEEL
30	S3	#10-24 X 1/2" UC PFH SMS		STEEL
31		HI HAT ANCHOR CHANNEL 16GA.	TELL MANUFACT.	GALVANNEALED STEEL
32		Z CLIP ANCHOR CHANNEL 16GA	TELL MANUFACT.	GALVANNEALED STEEL

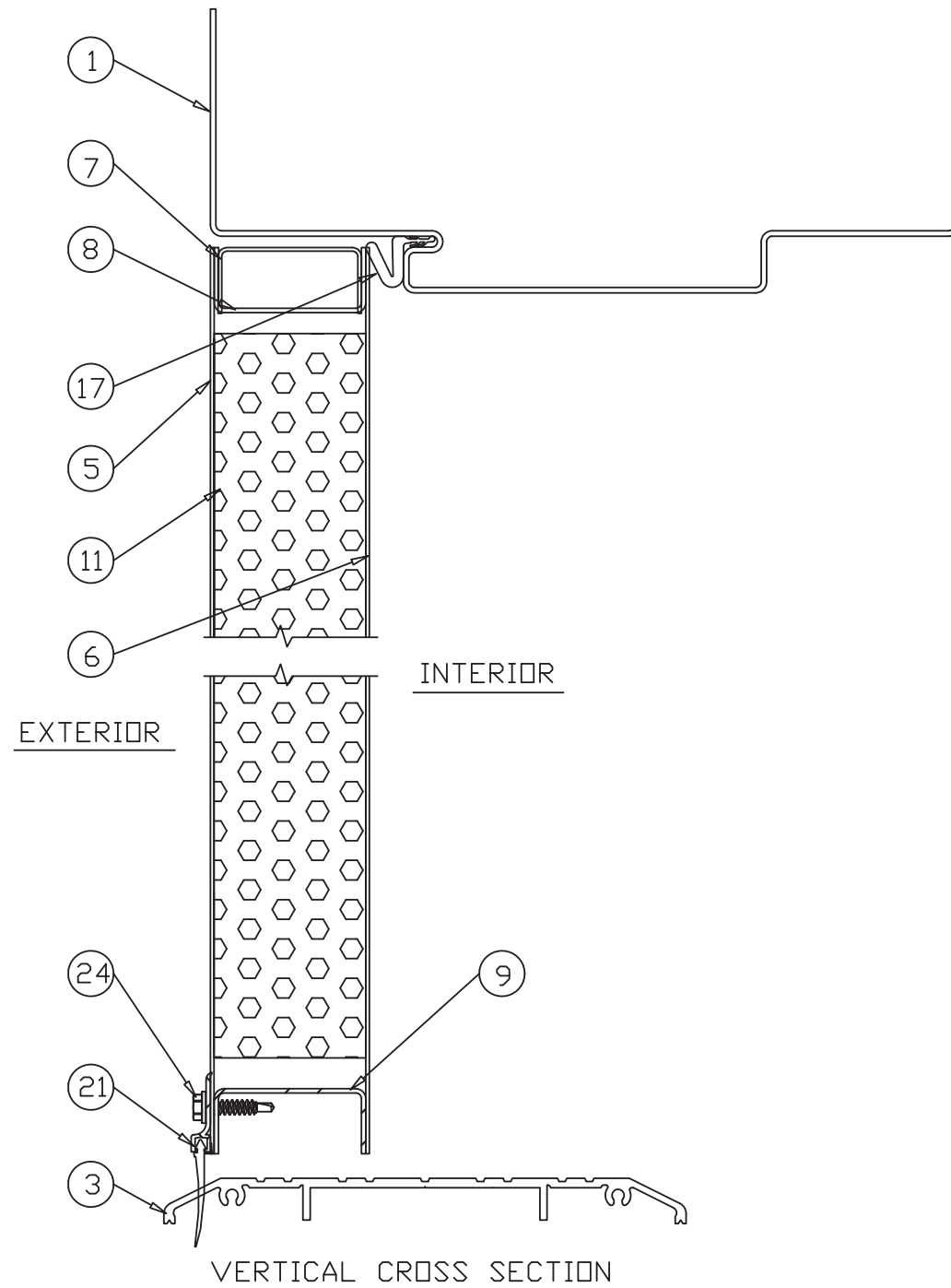

Robert J. Amoruso, P.E.  
Florida P.E. No. 49752

PTC PRODUCT DESIGN GROUP, LLC  
PO BOX 520775 | LONGWOOD, FLORIDA 32752  
FBPE C.A. NO. 25935  
Phone: 321.690.1788 | Email: info@ptc-corp.com

DRAFTER	DATE	TELL DOORS & WINDOWS, LLC. 6535 GUHN RD, STE 100, HOUSTON, TX 77040	
CHECKED	DATE	TITLE TIOGA DOORWAY SYSTEM TDS-D-PA-WS DS STEEL DOUBLE DOOR - IMPACT BILL OF MATERIALS AND CROSS SECTION	
ENGINEER TJH	DATE 06/03/10	SIZE B	DWG NO 08-01018
APPROVED R.J.A.	DATE 10/17/23	RELEASE STATE FINAL	
THIRD ANGLE PROJECTION 		SCALE NTS	SHEET 3 OF 8

TELL MANUFACTURING, INC.  
18 RICHARD DRIVE, LITITZ, PA 17543

TELL MFG  
**Spectrum Brands** | Hardware & Home Improvement

THIS DOCUMENT IS THE PROPERTY OF SPECTRUM BRANDS, INC AND/OR ITS AFFILIATES. THE CONTENTS OF THIS DOCUMENT ARE CONFIDENTIAL AND CONSTITUTE TRADE SECRETS PROPRIETARY TO SPECTRUM BRANDS. NEITHER THIS DOCUMENT NOR ITS CONTENTS SHALL BE DISCLOSED TO ANY UNAUTHORIZED PERSON, COPIED, OR PUBLISHED WITHOUT SPECTRUM BRANDS' PRIOR WRITTEN CONSENT.

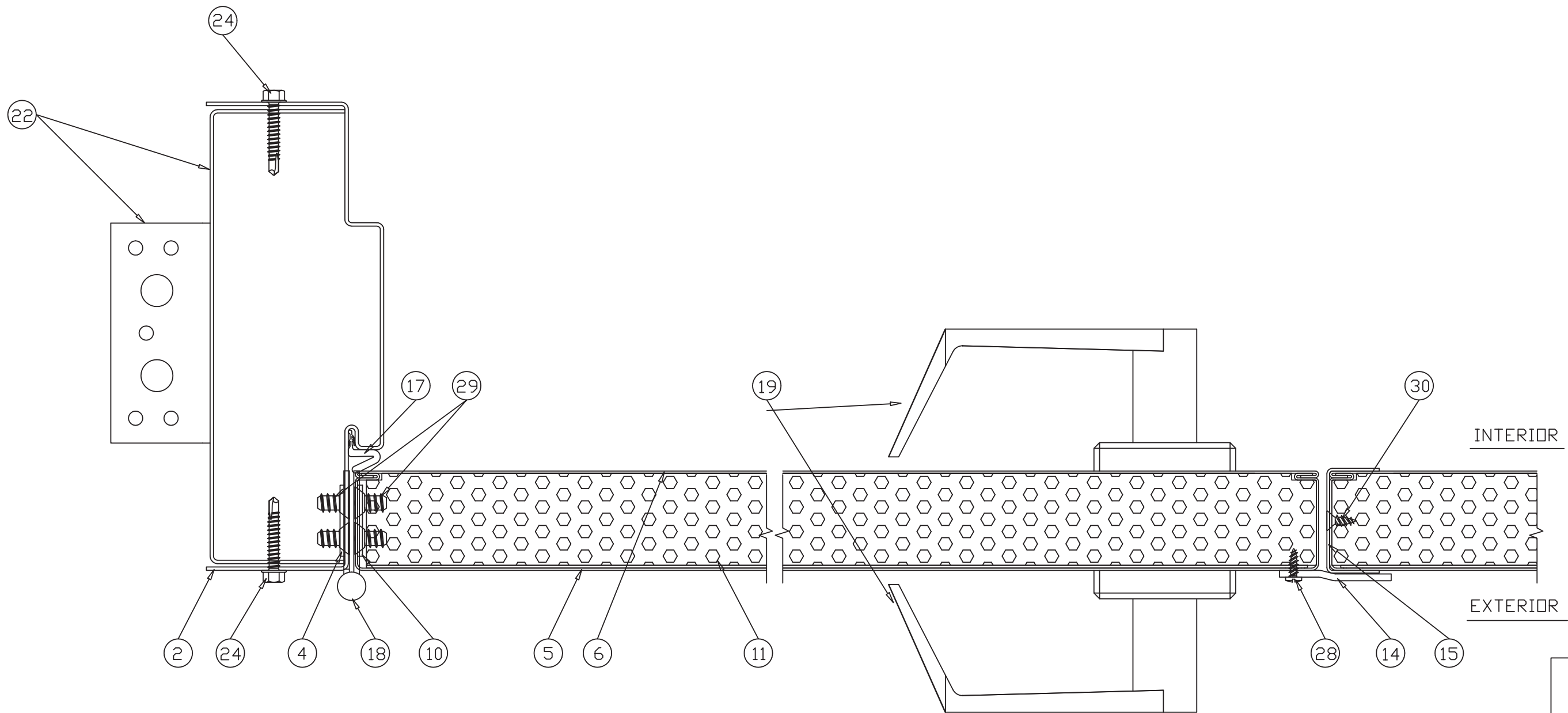

HORIZONTAL CROSS SECTION

Robert J. Amoruso, P.E.  
 Florida P.E. No. 49752

PTC PRODUCT DESIGN GROUP, LLC  
 PO BOX 520775 | LONGWOOD, FLORIDA 32752  
 FBPE C.A. NO. 25935  
 Phone: 321.690.1788 | Email: info@ptc-corp.com

TELL MANUFACTURING, INC.  
 18 RICHARD DRIVE, LITITZ, PA 17543

TELL MFG  
**Spectrum Brands** | Hardware & Home Improvement

THIS DOCUMENT IS THE PROPERTY OF SPECTRUM BRANDS, INC AND/OR ITS AFFILIATES. THE CONTENTS OF THIS DOCUMENT ARE CONFIDENTIAL AND CONSTITUTE TRADE SECRETS PROPRIETARY TO SPECTRUM BRANDS. NEITHER THIS DOCUMENT NOR ITS CONTENTS SHALL BE DISCLOSED TO ANY UNAUTHORIZED PERSON, COPIED, OR PUBLISHED WITHOUT SPECTRUM BRANDS' PRIOR WRITTEN CONSENT.

DRAFTER	DATE	TELL DOORS & WINDOWS, LLC. 6535 GUHN RD, STE 100, HOUSTON, TX 77040			
CHECKED	DATE	TITLE TIOGA DOORWAY SYSTEM TDS-D-KD-WS DS STEEL DOUBLE DOOR - IMPACT CROSS SECTION			
ENGINEER	DATE	SIZE	DWG NO	REV	
TJH	06/03/10	B	08-01018	B	ITER
APPROVED	DATE	RELEASE STATE		SCALE	
R.J.A.	10/17/23	FINAL		NTS	
THIRD ANGLE PROJECTION 		SHEET		4 OF 8	



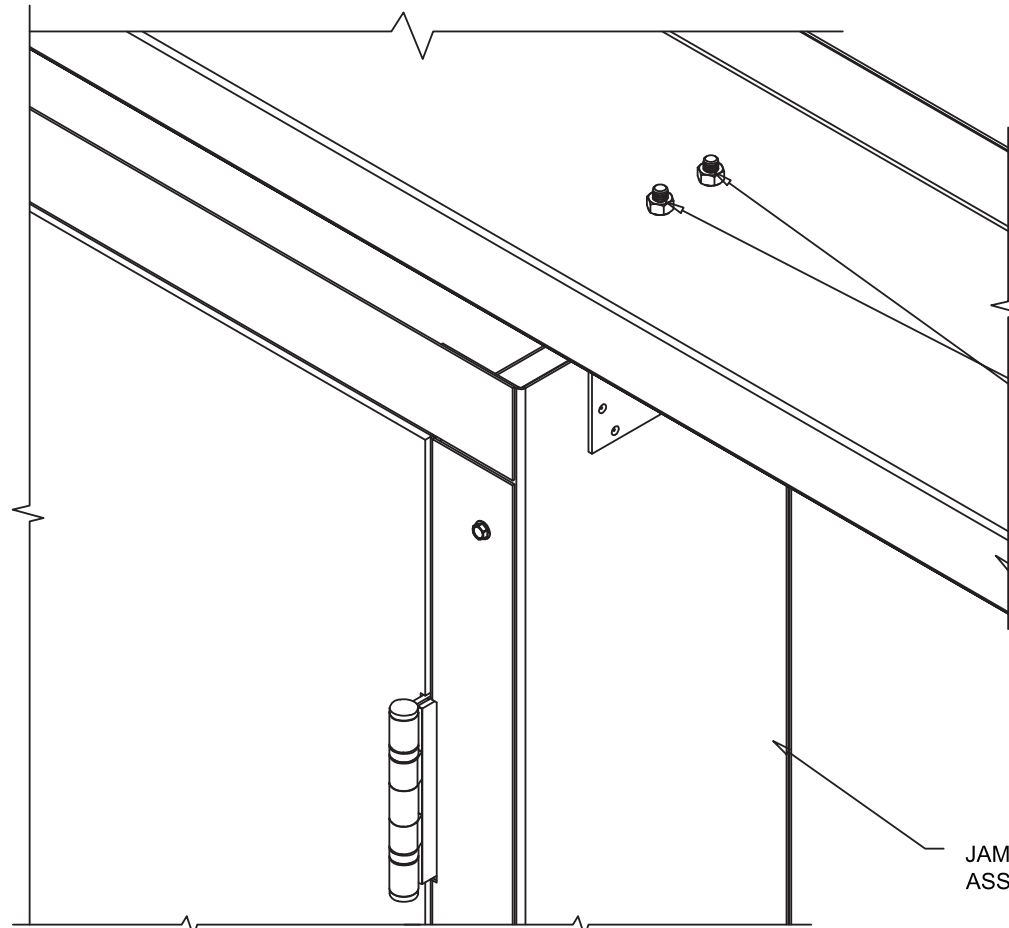

5/16" BOLT WITH 5/16" NUT AND WASHER. BOLT MUST BE 3-THREADS BEYOND NUT MIN. ENGAGEMENT

BUILDING GIRT BY OTHERS

JAMB EXTENSION ASSEMBLY

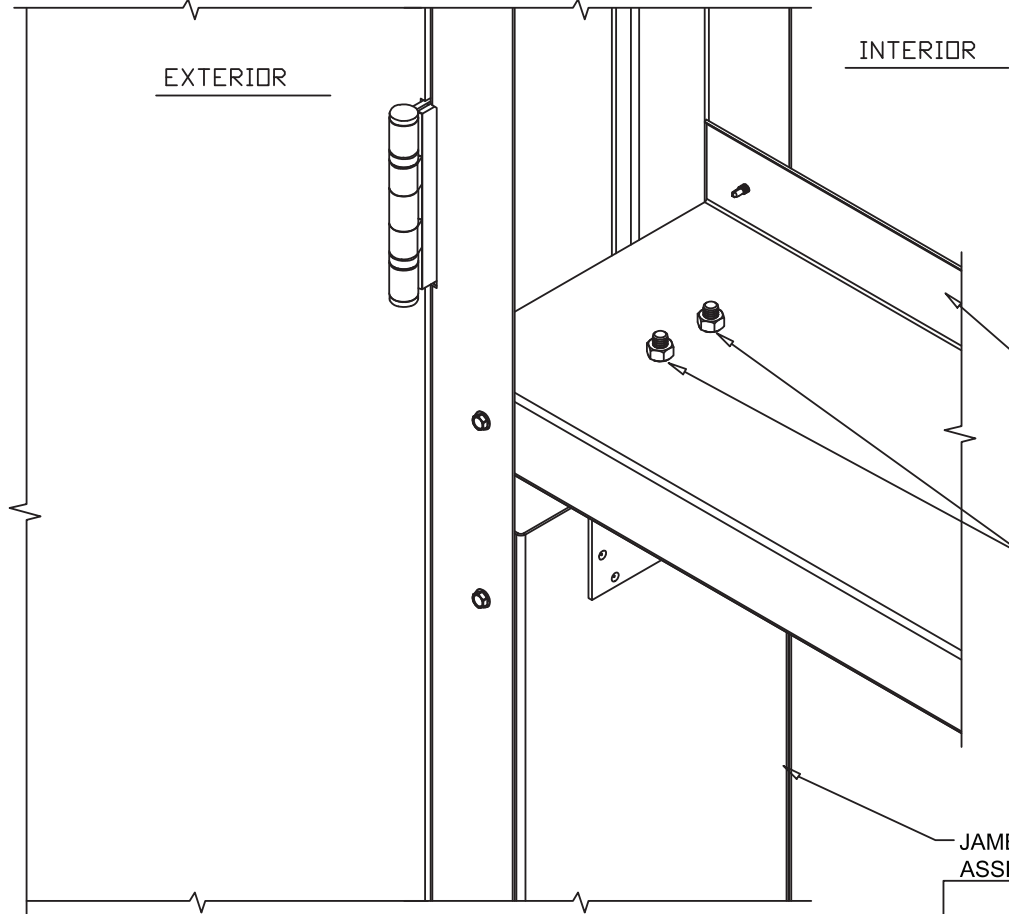

OPTIONAL BUILDING INTERMEDIATE GIRT BY OTHERS

5/16" BOLT WITH 5/16" NUT AND WASHER. BOLT MUST BE 3-THREADS BEYOND NUT MIN. ENGAGEMENT

JAMB EXTENSION ASSEMBLY

VERTICAL CROSS SECTION  
JAMB EXTENSION ASSEMBLY TO METAL BUILDING INSTALLATION

TELL MANUFACTURING, INC.  
18 RICHARD DRIVE, LITITZ, PA 17543



THIS DOCUMENT IS THE PROPERTY OF SPECTRUM BRANDS, INC AND/OR ITS AFFILIATES. THE CONTENTS OF THIS DOCUMENT ARE CONFIDENTIAL AND CONSTITUTE TRADE SECRETS PROPRIETARY TO SPECTRUM BRANDS. NEITHER THIS DOCUMENT NOR ITS CONTENTS SHALL BE DISCLOSED TO ANY UNAUTHORIZED PERSON, COPIED, OR PUBLISHED WITHOUT SPECTRUM BRANDS' PRIOR WRITTEN CONSENT.

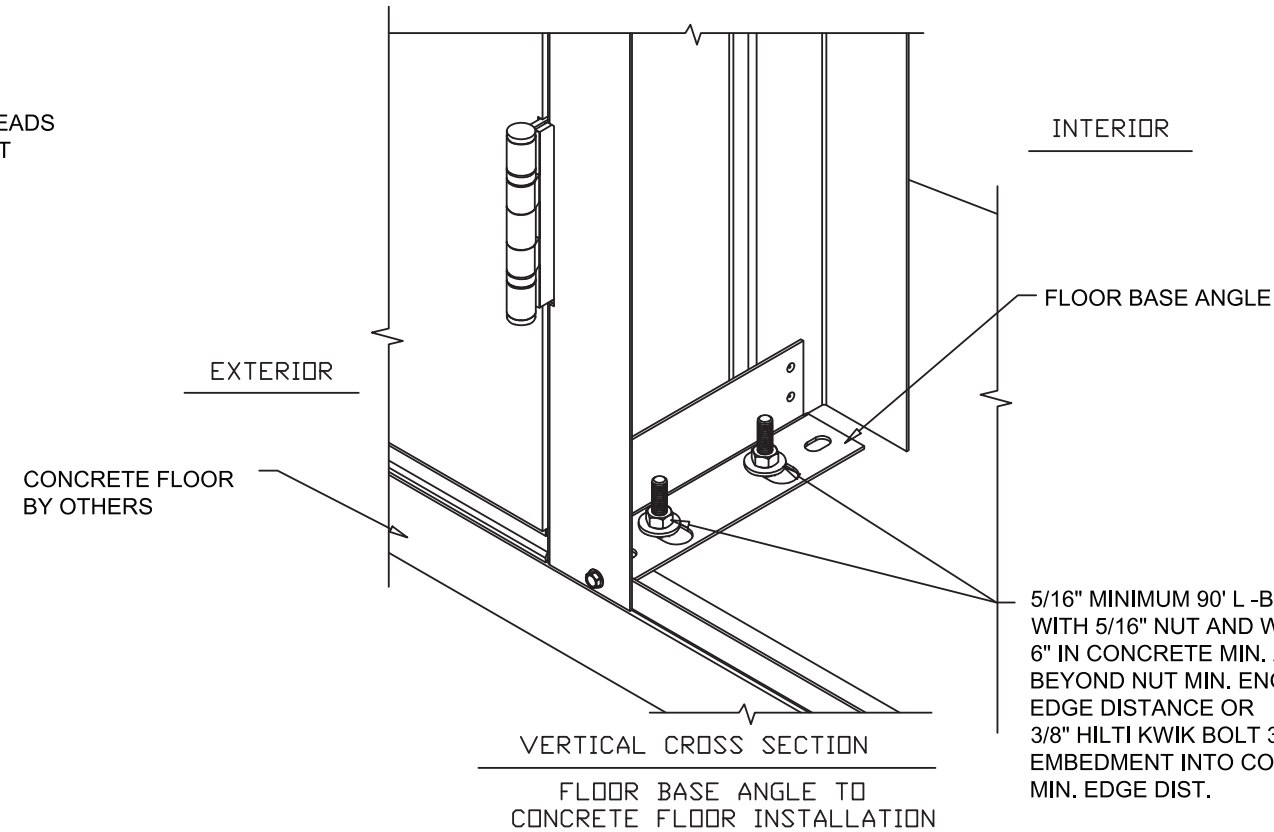

INTERIOR

FLOOR BASE ANGLE

EXTERIOR

CONCRETE FLOOR BY OTHERS

5/16" MINIMUM 90° L-BOLT SET IN CONCRETE WITH 5/16" NUT AND WASHER. BOLT TO BE SET 6" IN CONCRETE MIN. AND HAVE 3-THREADS MIN. BEYOND NUT MIN. ENGAGEMENT AND 2 3/4" MIN. EDGE DISTANCE OR 3/8" HILTI KWIK BOLT 3 WITH 2 1/2" MIN. EMBEDMENT INTO CONCRETE AND 4 1/2" MIN. EDGE DIST.

VERTICAL CROSS SECTION  
FLOOR BASE ANGLE TO CONCRETE FLOOR INSTALLATION

Robert J. Amoruso, P.E.  
Florida P.E. No. 49752

PTC PRODUCT DESIGN GROUP, LLC  
PO BOX 520775 | LONGWOOD, FLORIDA 32752  
FBPE C.A. NO. 25935  
Phone: 321.690.1788 | Email: info@ptc-corp.com

DRAFTER	DATE	TELL DOORS & WINDOWS, LLC. 6535 GUHN RD, STE 100, HOUSTON, TX 77040	
CHECKED	DATE	TITLE TIOGA DOORWAY SYSTEM TDS-D-KD-WS DS STEEL DOUBLE DOOR - IMPACT INSTALLATION DETAILS	
ENGINEER	DATE	SIZE B	DWG NO 08-01018
APPROVED	DATE	RELEASE STATE	
	TJH 06/03/10	FINAL	
	R.J.A. 10/17/23	SCALE	SHEET
		NTS	5 OF 8
THIRD ANGLE PROJECTION			

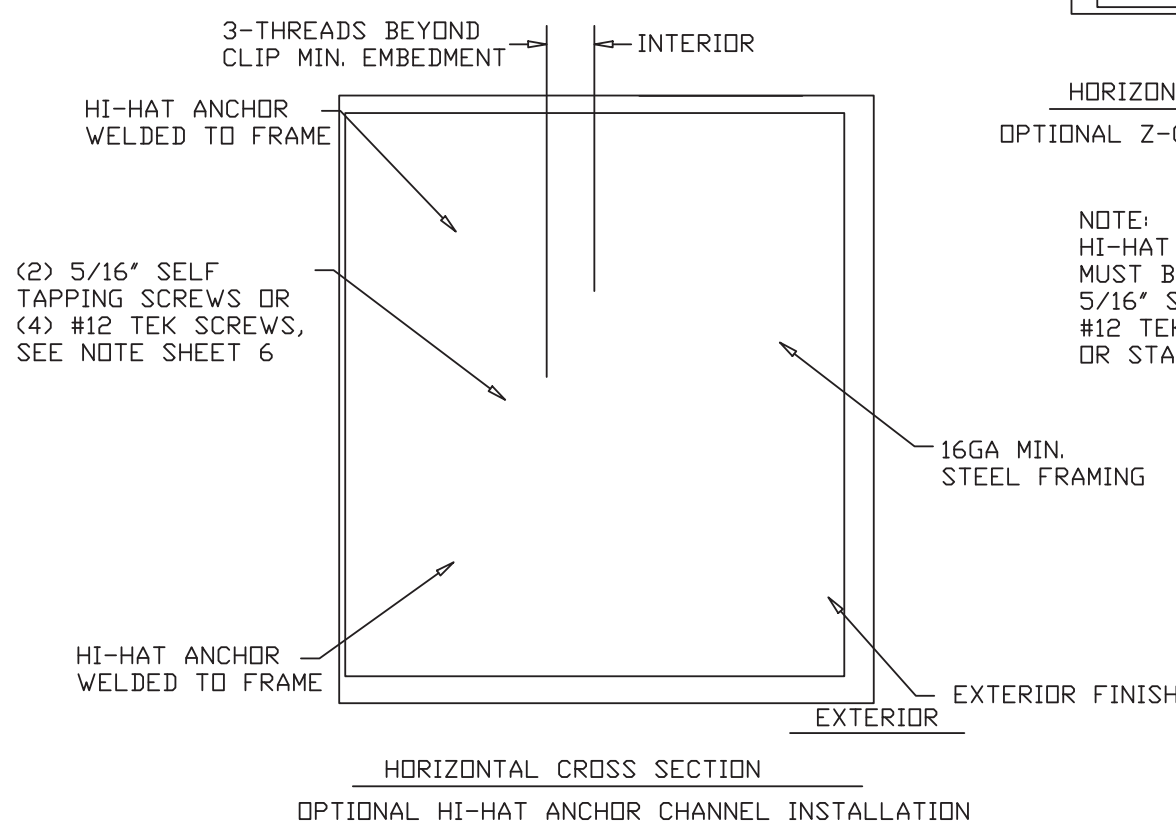
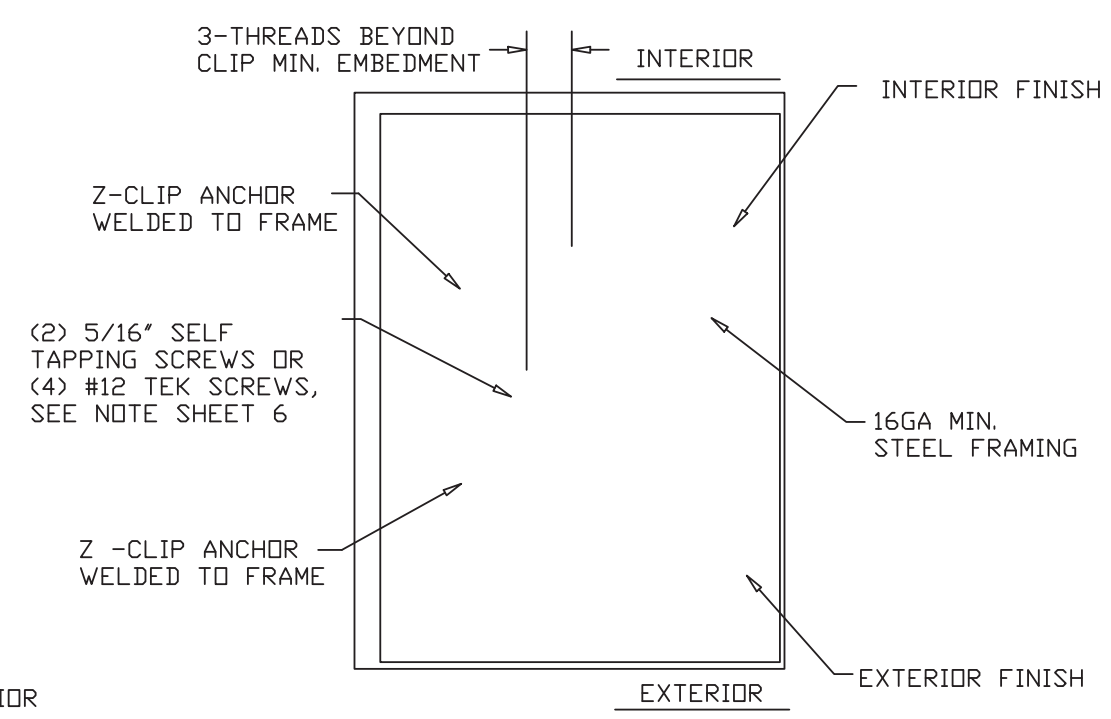
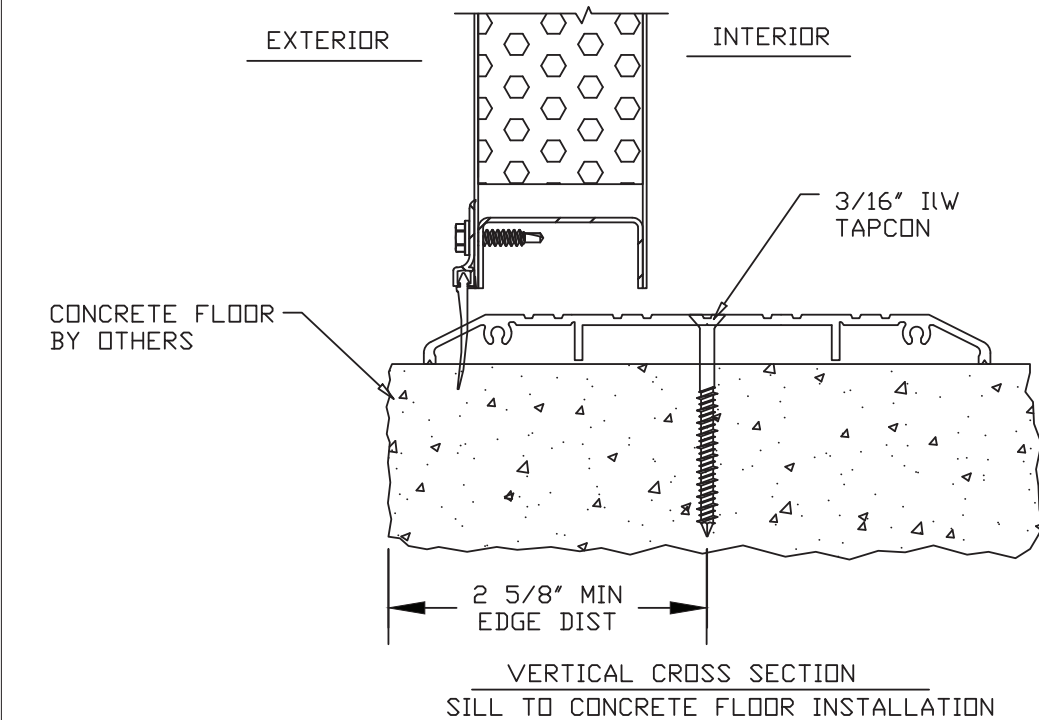
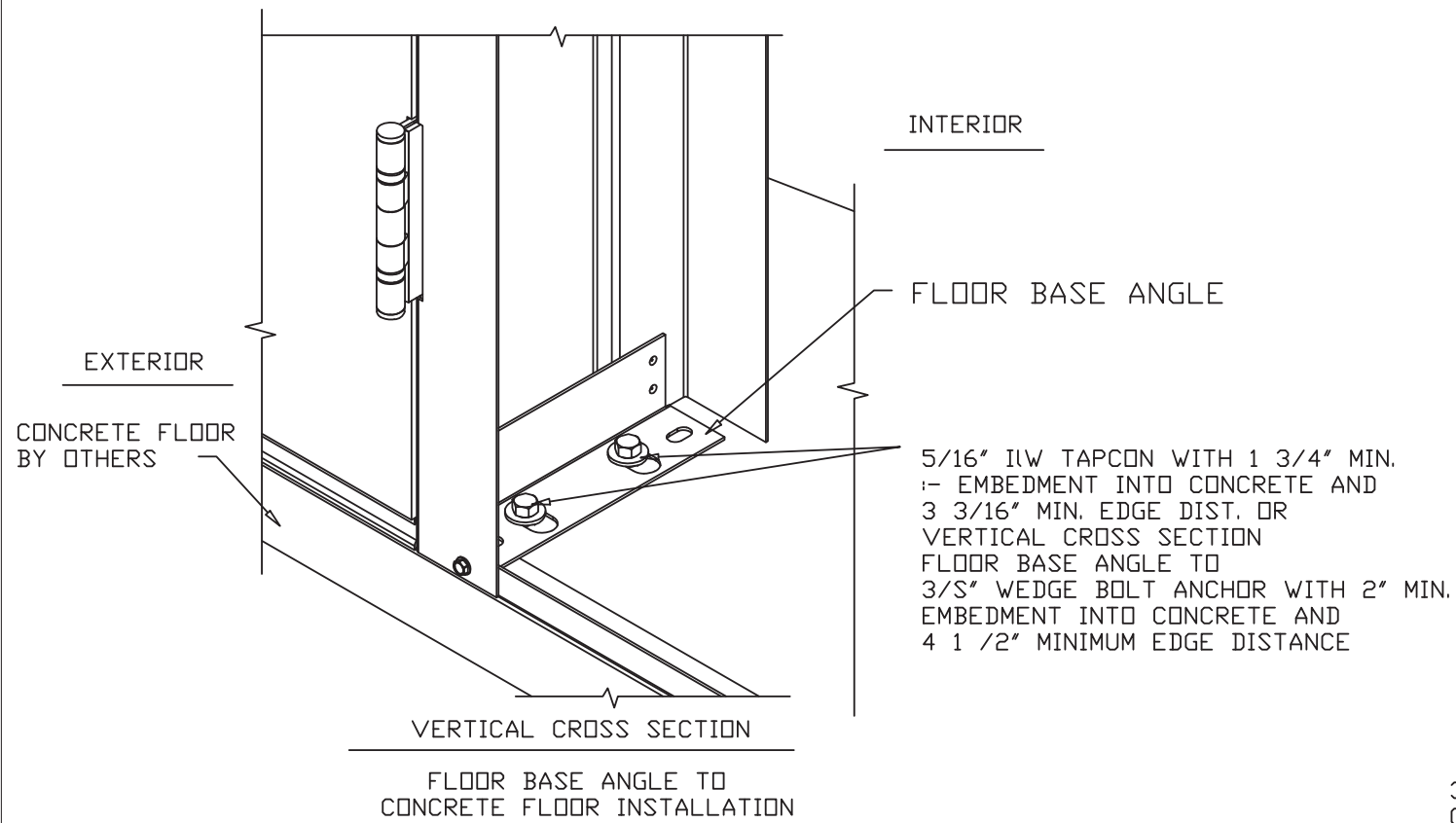

NOTE:  
HI-HAT AND Z-CLIP ANCHOR CHANNELS  
MUST BE INSTALLED USING EITHER (2)  
5/16" SELF TAPPING SCREWS OR (4)  
#12 TEK SCREWS EITHER SIDE BY SIDE  
OR STACKED

Robert J. Amoruso, P.E.  
Florida P.E. No. 49752

PTC PRODUCT DESIGN GROUP, LLC  
PO BOX 520775 | LONGWOOD, FLORIDA 32752  
FBPE C.A. NO. 25935  
Phone: 321.690.1788 | Email: info@ptc-corp.com

TELL MANUFACTURING, INC.  
18 RICHARD DRIVE, LITITZ, PA 17543

TELL MFG  
**Spectrum Brands** | Hardware & Home Improvement

THIS DOCUMENT IS THE PROPERTY OF SPECTRUM BRANDS, INC. AND/OR ITS AFFILIATES. THE CONTENTS OF THIS DOCUMENT ARE CONFIDENTIAL AND CONSTITUTE TRADE SECRETS PROPRIETARY TO SPECTRUM BRANDS. NEITHER THIS DOCUMENT NOR ITS CONTENTS SHALL BE DISCLOSED TO ANY UNAUTHORIZED PERSON, COPIED, OR PUBLISHED WITHOUT SPECTRUM BRANDS' PRIOR WRITTEN CONSENT.

DRAFTER	DATE	TELL DOORS & WINDOWS, LLC. 6535 GUHN RD, STE 100, HOUSTON, TX 77040	
CHECKED	DATE	TITLE TIOGA DOORWAY SYSTEM TDS-D-KD-WS DS STEEL DOUBLE DOOR - IMPACT INSTALLATION DETAILS	
ENGINEER	DATE TJH 06/03/10	SIZE B	DWG NO 08-01018
APPROVED	DATE R.J.A. 10/17/23	RELEASE STATE	REV B
THIRD ANGLE PROJECTION 	SCALE NTS	FINAL	SHEET 6 OF 8

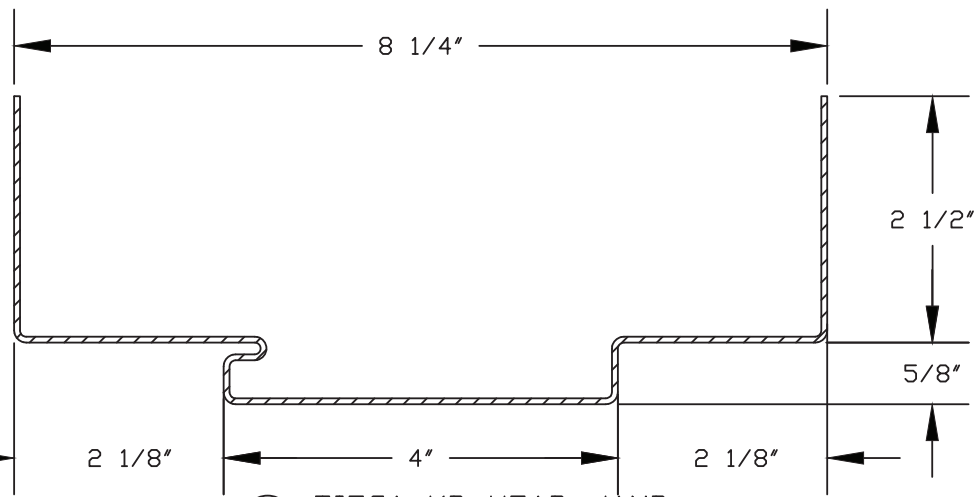

① TIOGA KD HEAD JAMB  
 ② TIOGA KD HINGE JAMB  
 16GA. GALVANNEALED  
 STEEL .053" MIN. THICK

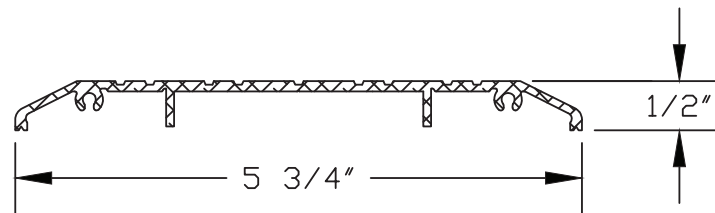

③ THRESHOLD 1/2" HIGH  
 ALUMINUM 6063-T5 .105" THICK

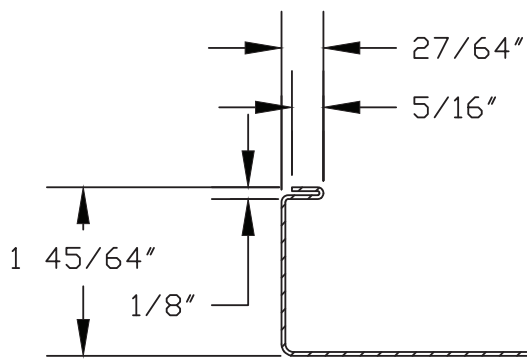

⑤ TIOGA BOTTOM DOOR SKIN  
 18GA GALVANNEALED STEEL .044" MIN. THICK  
 LEFT END SHOWN, RIGHT END IS SIMILAR

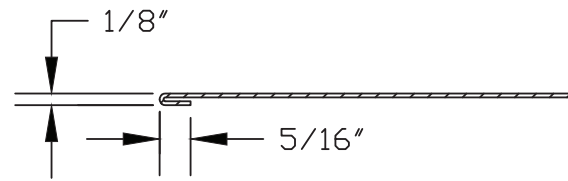

⑥ TIOGA TOP DOOR SKIN  
 18GA STEEL .044" MIN. THICK  
 LEFT END SHOWN, RIGHT END IS SIMILAR

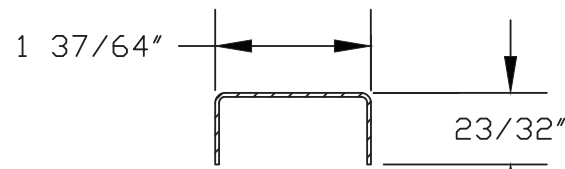

⑦ TOP CAP DOOR  
 CHANNEL  
 20GA GALVANNEALED  
 STEEL .036" MIN. THICK

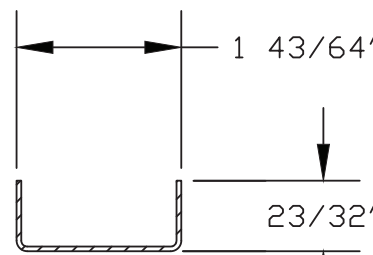

⑧ TOP DOOR CHANNEL  
 16GA GALVANNEALED  
 STEEL .053" MIN. THICK

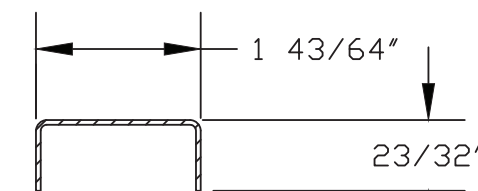

⑨ BOTTOM DOOR CHANNEL  
 16GA GALVANNEALED  
 STEEL .053" MIN. THICK

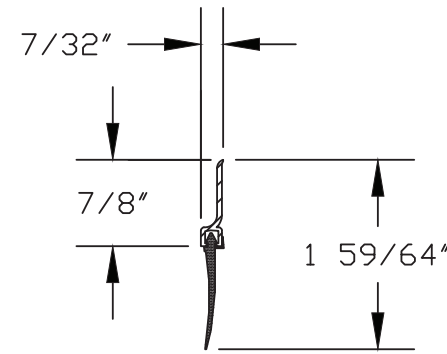

⑳ DOOR SWEEP  
 ALUMINUM 6063-T5.042" MIN. THICK  
 EPDM

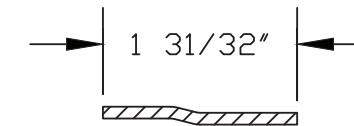

⑭ OVERLAP STRIP  
 ASTRAGAL  
 11GA GALVANNEALED  
 STEEL .123" MIN. THICK

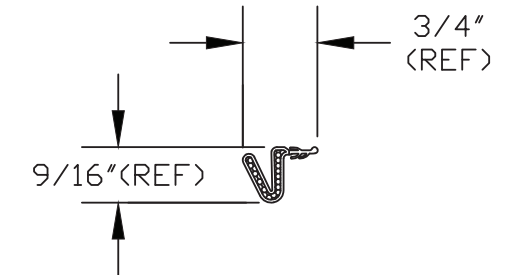

⑰ FRAME WEATHERSTRIPPING  
 FOAM

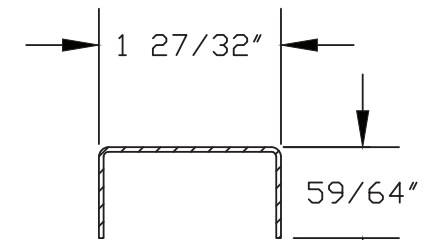

⑮ INACTIVE DOOR  
 EDGE CHANNEL  
 16GA GALVANNEALED  
 STEEL .053" MIN. THICK

Robert J. Amoruso, P.E.  
 Florida P.E. No. 49752



PTC PRODUCT DESIGN GROUP, LLC  
 PO BOX 520775 | LONGWOOD, FLORIDA 32752  
 FBPE C.A. NO. 25935  
 Phone: 321.690.1788 | Email: info@ptc-corp.com

DRAFTER	DATE	TELL DOORS & WINDOWS, LLC. 6535 GUHN RD, STE 100, HOUSTON, TX 77040	
CHECKED	DATE	TITLE TIOGA DOORWAY SYSTEM TDS-D-KD-WS OS STEEL DOUBLE DOOR - IMPACT COMPONENTS	
ENGINEER T.J.H.	DATE 06/03/10	SIZE B	DWG NO 08-01018
APPROVED R.J.A.	DATE 10/17/23	RELEASE STATE FINAL	REV B
THIRD ANGLE PROJECTION		SCALE NTS	SHEET 7 OF 8



THIS DOCUMENT IS THE PROPERTY OF SPECTRUM BRANDS, INC. AND/OR ITS AFFILIATES. THE CONTENTS OF THIS DOCUMENT ARE CONFIDENTIAL AND CONSTITUTE TRADE SECRETS PROPRIETARY TO SPECTRUM BRANDS. NEITHER THIS DOCUMENT NOR ITS CONTENTS SHALL BE DISCLOSED TO ANY UNAUTHORIZED PERSON, COPIED, OR PUBLISHED WITHOUT SPECTRUM BRANDS' PRIOR WRITTEN CONSENT.

TELL MANUFACTURING, INC.  
 18 RICHARD DRIVE, LITITZ, PA 17543

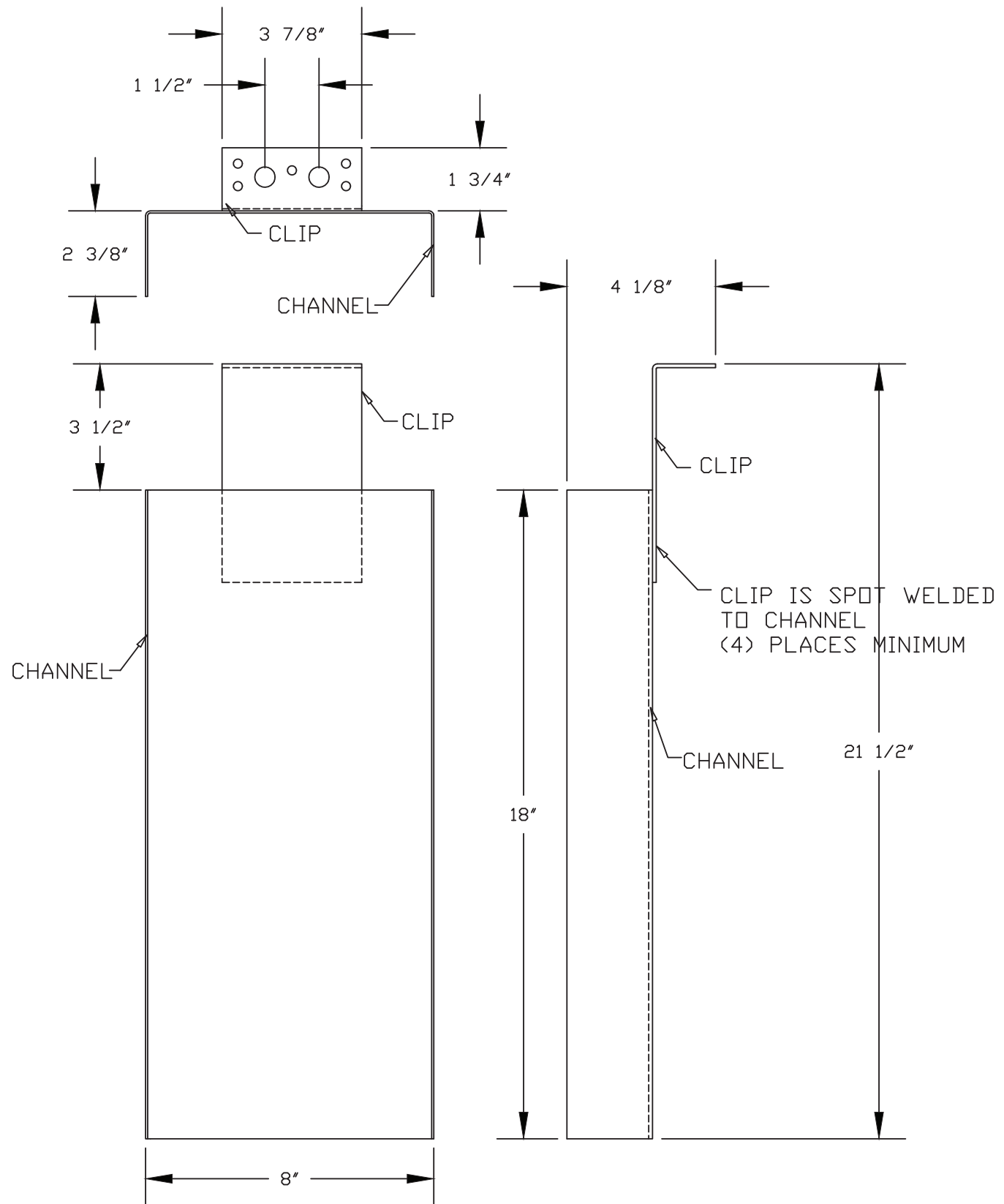

**22** JAMB EXTENSION ASSEMBLY  
 16GA GALVANNEALED STEEL .053" MIN. THICK (CHANNEL)  
 12GA GALVANNEALED STEEL .108" MIN. THICK (CLIP)

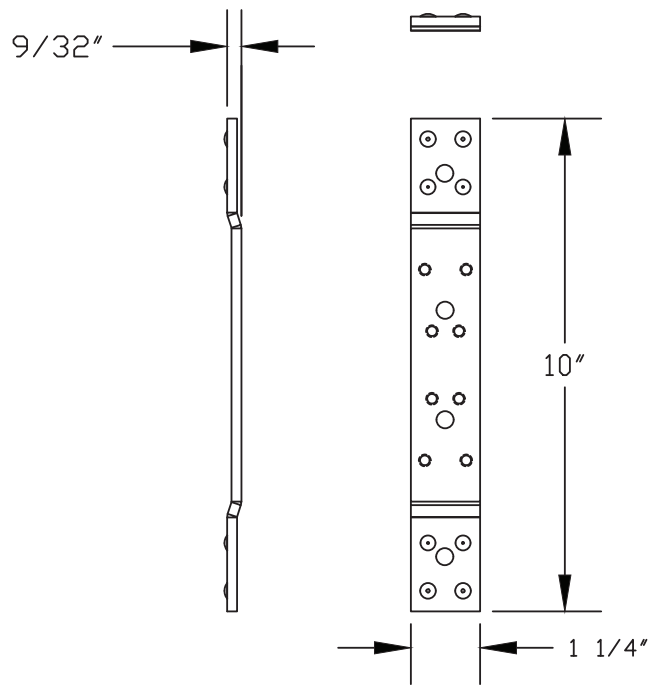

**10** DOOR HINGE REINFORCEMENT  
 10GA. GALVANNEALED STEEL .138" MIN. THICK

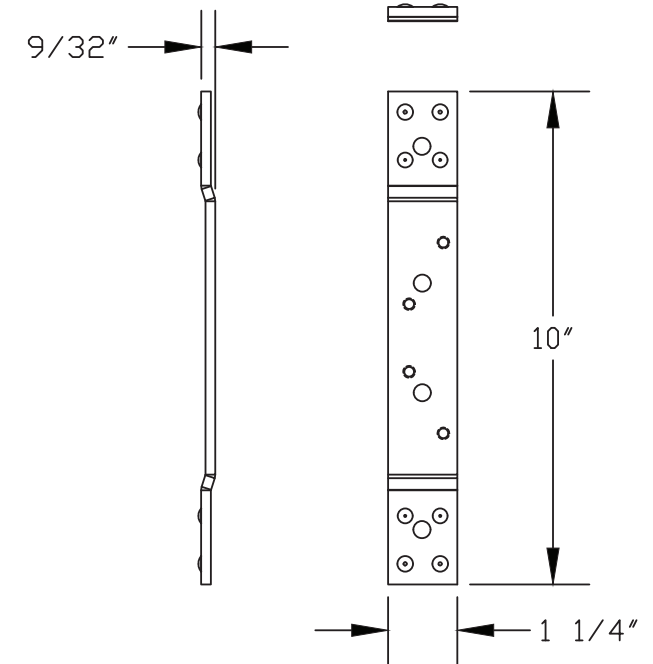

**4** FRAME HINGE REINFORCEMENT  
 10GA. GALVANNEALED STEEL .138" MIN. THICK

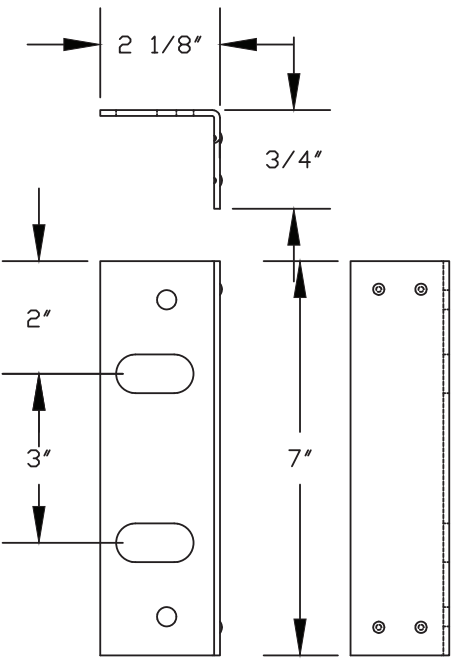

**16** HINGE JAMB CLIP  
**23** FLOOR BASE CLIP  
 12GA. GALVANNEALED STEEL .108 MIN. THICK

Robert J. Amoruso, P.E.  
 Florida P.E. No. 49752

PTC PRODUCT DESIGN GROUP, LLC  
 PO BOX 520775 | LONGWOOD, FLORIDA 32752  
 FBPE C.A. NO. 25935  
 Phone: 321.690.1788 | Email: info@ptc-corp.com

DRAFTER	DATE	TELL DOORS & WINDOWS, LLC. 6535 GUHN RD, STE 100, HOUSTON, TX 77040	
CHECKED	DATE	TITLE 10GA DOORWAY SYSTEM TDS-D-KD-WS STEEL DOUBLE DOOR DS - IMPACT COMPONENTS	
ENGINEER	DATE TJH 06/03/10	SIZE B	DWG NO 08-01018
APPROVED	DATE R.J.A. 10/17/23	RELEASE STATE FINAL	REV B
THIRD ANGLE PROJECTION 		SCALE NTS	SHEET 8 OF 8

TELL MANUFACTURING, INC.  
 18 RICHARD DRIVE, LITITZ, PA 17543

TELL MFG  
**Spectrum Brands** | Hardware & Home Improvement

THIS DOCUMENT IS THE PROPERTY OF SPECTRUM BRANDS, INC. AND/OR ITS AFFILIATES. THE CONTENTS OF THIS DOCUMENT ARE CONFIDENTIAL AND CONSTITUTE TRADE SECRETS PROPRIETARY TO SPECTRUM BRANDS. NEITHER THIS DOCUMENT NOR ITS CONTENTS SHALL BE DISCLOSED TO ANY UNAUTHORIZED PERSON, COPIED, OR PUBLISHED WITHOUT SPECTRUM BRANDS' PRIOR WRITTEN CONSENT.