

- NOTES:**
- 1) THE PRODUCT SHOWN HEREIN IS DESIGNED AND MANUFACTURED TO COMPLY WITH REQUIREMENTS OF THE FLORIDA BUILDING CODE INCLUDING THE HVHZ.
 - 2) STEEL FRAMING AND CONCRETE OPENING TO BE DESIGNED AND ANCHORED TO PROPERLY TRANSFER ALL LOADS TO STRUCTURE. FRAMING AND CONCRETE OPENING IS THE RESPONSIBILITY OF THE ARCHITECT OR ENGINEER OF RECORD.
 - 3) BUILDING GIRT AND OPTIONAL INTERMEDIATE BUILDING GIRT TO BE DESIGNED AND ANCHORED TO PROPERLY TRANSFER ALL LOADS TO STRUCTURE. BUILDING GIRT AND OPTIONAL INTERMEDIATE GIRT ARE THE RESPONSIBILITY OF THE ARCHITECT OR ENGINEER OF RECORD.
 - 4) ALLOWABLE STRESS INCREASE OF 1/3 WAS NOT USED IN THE DESIGN OF THE PRODUCT SHOWN HEREIN. WIND LOAD DURATION FACTOR Cd=1.6 WAS USED FOR WOOD ANCHOR CALCULATIONS.
 - 5) FRAME MATERIAL: FORMED 16GA. (.053" MIN.) GALVANNEALED STEEL.
 - 6) DOOR PANEL MATERIAL: FORMED 18GA. (.044" MIN.) GALVANNEALED STEEL.
 - 7) APPROVED IMPACT PROTECTIVE SYSTEM IS NOT REQUIRED FOR THIS PRODUCT IN WIND BORNE DEBRIS REGIONS.
 - 8) EACH PANEL IS FITTED WITH THREE HINGES LOCATED AT 6" MINIMUM UPTO 10" MAXIMUM FROM EACH END WITH ONE AT PANEL MIDSPAN.

HARDWARE SCHEDULE	
A.	ML 1300 MORTISE LOCK BY TELL MANUFACTURING, INC.
B.	STEEL SURFACE BOLTS 988Y BY YALE SECURITY, INC.
C.	STEEL ASTRAGAL .140" THICK BY TELL DOORS & WINDOWS, LLC
D.	STEEL HINGES H4545 BY TELL MANUFACTURING, INC.
E.	ALUMINUM THRESHOLD 1/2" HIGH BY HOUSTON NON-FERROUS

TABLE OF CONTENTS	
SHEET NO.	DESCRIPTION
1	ELEVATION, ANCHORING LAYOUT AND NOTES
2	DETAILS AND NOTES
3	BILL OF MATERIALS AND CROSS SECTION
4	CROSS SECTION
5 - 6	INSTALLATION DETAILS
7 - 8	COMPONENTS

TIOGA DOORWAY SYSTEM TDS-D-PA-WS
EXTERIOR VIEW

DESIGN PRESSURE RATING	IMPACT RATING
±50PSF	LARGE AND SMALL MISSILE IMPACT
THIS SYSTEM WAS NOT TESTED FOR WATER INFILTRATION AND IS TO BE INSTALLED ONLY WHERE THE WATER REQUIREMENT IS NOT NEEDED	

Robert J. Amoruso, P.E.
Florida P.E. No. 49752

PTC PRODUCT DESIGN GROUP, LLC
PO BOX 520775 | LONGWOOD, FLORIDA 32752
FBPE C.A. NO. 25935
Phone: 321.690.1788 | Email: info@ptc-corp.com

DRAFTER	TJH	DATE	06/29/10	TELL DOORS & WINDOWS, LLC. 6535 GUHN RD, STE 100, HOUSTON, TX 77040	
CHECKED		DATE		TITLE TIOGA DOORWAY SYSTEM TDS-D-PA-WS DS STEEL DOUBLE DOOR - IMPACT ELEVATION, ANCHORING LAYOUT AND NOTES	
ENGINEER		DATE		SIZE	B
APPROVED	RJA	DATE	10/17/23	DWG NO	08-01019
THIRD ANGLE PROJECTION			RELEASE STATE	FINAL	REV B
			SCALE	NTS	SHEET 1 OF 8

TELL MFG
Spectrum Brands | Hardware & Home Improvement

TELL MANUFACTURING, INC.
18 RICHARD DRIVE, LITITZ, PA 17543

THIS DOCUMENT IS THE PROPERTY OF SPECTRUM BRANDS, INC. AND/OR ITS AFFILIATES. THE CONTENTS OF THIS DOCUMENT ARE CONFIDENTIAL AND CONSTITUTE TRADE SECRETS PROPRIETARY TO SPECTRUM BRANDS. NEITHER THIS DOCUMENT NOR ITS CONTENTS SHALL BE DISCLOSED TO ANY UNAUTHORIZED PERSON, COPIED, OR PUBLISHED WITHOUT SPECTRUM BRANDS' PRIOR WRITTEN CONSENT.

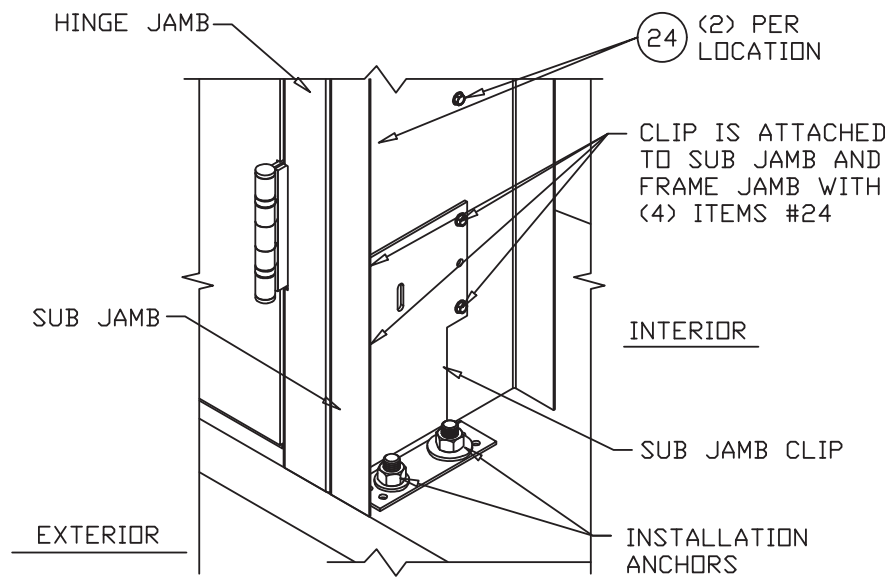

SUB JAMB CLIP TO FLOOR DETAIL

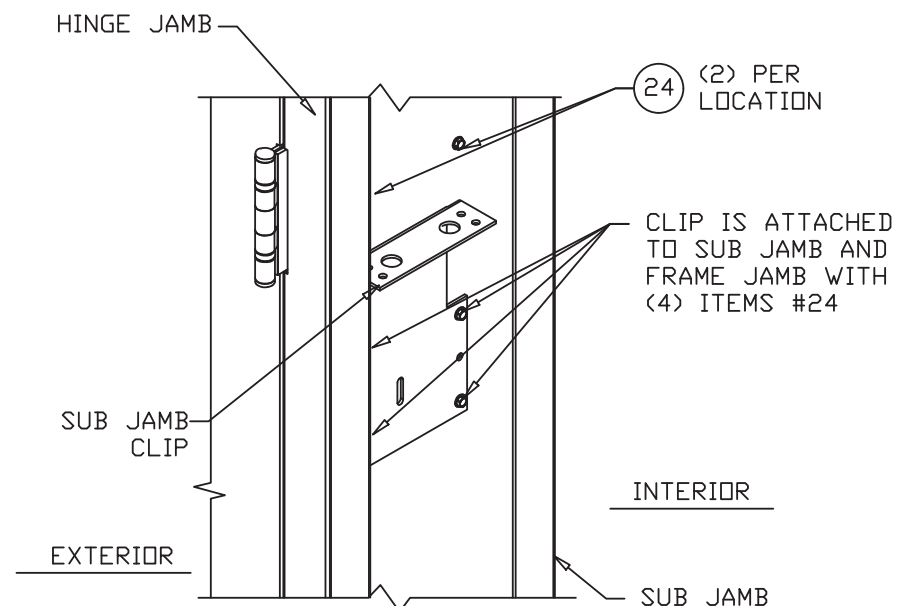

SUB JAMB CLIP TO SUB JAMB ASSEMBLY DETAIL

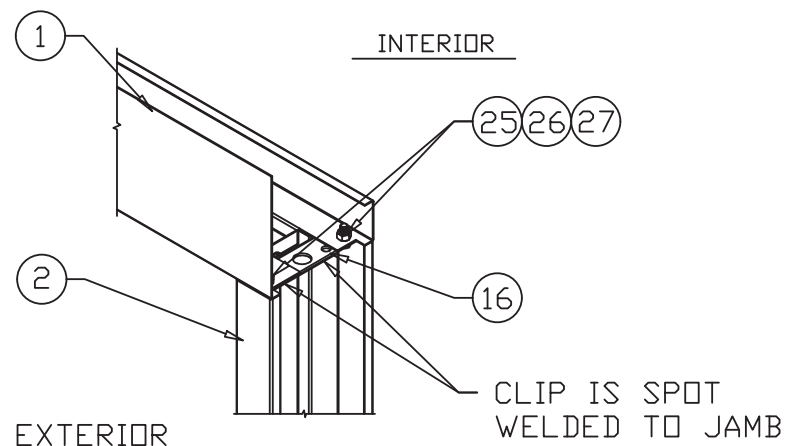

CORNER CONSTRUCTION DETAIL

NOTES:

- FOR ANCHORING SUB JAMB CLIP TO 16GA. (.060" MIN.) STEEL FRAMING USE 5/16"-18 BOLT WITH 5/16"-18 NUT AND 5/16" WASHER. BOLT TO BE OF SUFFICIENT LENGTH TO ACHIEVE 3-THREADS MINIMUM BEYOND NUT. LOCATE ANCHORS AS SHOWN IN ELEVATION AND INSTALLATION DETAILS.
- FOR ANCHORING SUB JAMB CLIP INTO CONCRETE AT FLOOR USE:
 - 5/16" MINIMUM 90° L-BOLT SET IN CONCRETE WITH 5/16" NUT AND WASHER. BOLT TO BE OF SUFFICIENT LENGTH TO ACHIEVE 6" MINIMUM EMBEDMENT INTO CONCRETE AND 3-THREADS MINIMUM BEYOND NUT AND WASHER WITH 2 3/4" MINIMUM EDGE DISTANCE.
 - 90° L-BOLT TO BE MINIMUM A36 STEEL.
 - 3/8" HILTI KWIK BOLT 3 OF SUFFICIENT LENGTH TO ACHIEVE 2 1/2" MINIMUM EMBEDMENT INTO CONCRETE WITH 4 1/2" MINIMUM EDGE DISTANCE
 - 3/8" WEDGE BOLT OF SUFFICIENT LENGTH TO ACHIEVE 2" MINIMUM EMBEDMENT INTO CONCRETE WITH 4 1/2" MINIMUM EDGE DISTANCE.
 - 5/16" ITW TAPCON OF SUFFICIENT LENGTH TO ACHIEVE 1 3/4" MINIMUM EMBEDMENT INTO CONCRETE WITH 3 3/16" MINIMUM EDGE DISTANCE.
 LOCATE ALL ANCHORS AS SHOWN IN ELEVATIONS AND INSTALLATION DETAILS.
- FOR ANCHORING THRESHOLD INTO CONCRETE USE 3/16" ITW TAPCONS WITH SUFFICIENT LENGTH TO ACHIEVE A 1 3/4" MINIMUM EMBEDMENT INTO SUBSTRATE WITH 2 1/4" MINIMUM EDGE DISTANCE. LOCATE ANCHORS AS SHOWN IN ELEVATIONS AND INSTALLATION DETAILS.
- FOR ANCHORING SUB JAMB CLIP TO WOOD USE 5/16" LAG SCREW WITH MINIMUM EMBEDMENT OF 1-3/4", MINIMUM EDGE DISTANCE OF 1-1/4" AND MINIMUM SPACING OF 1-1/4". LOCATE ANCHORS AS SHOWN IN ELEVATIONS AND INSTALLATION DETAILS.
- WASHERS SHALL BE USED WHEN ANCHORS ARE INSTALLED IN OVERSIZE HOLES (CLIP HOLE DIAMETER 1/16" GREATER DIAMETER THAN ANCHOR DIAMETER).
- MINIMUM 2 ANCHORS PER SUB JAMB CLIP FOR ATTACHMENT TO SUPPORTING SUBSTRATE.
- ALL FASTENERS TO BE CORROSION RESISTANT.
- INSTALLATION ANCHORS SHALL BE INSTALLED IN ACCORDANCE WITH ANCHOR MANUFACTURER'S INSTALLATION INSTRUCTIONS, AND ANCHORS SHALL NOT BE USED IN SUBSTRATES WITH STRENGTHS LESS THAN THE MINIMUM STRENGTH SPECIFIED BELOW:
 - A. WOOD - MINIMUM SPECIFIC GRAVITY OF G=0.42 (NON-HVHZ) AND G=0.55 (HVHZ)
 - B. CONCRETE - MINIMUM COMPRESSIVE STRENGTH OF 3,192 PSI.
 - C. STEEL FRAMING: 16GA. (.060" MIN.)

Robert J. Amoruso, P.E.
Florida P.E. No. 49752



PTC PRODUCT DESIGN GROUP, LLC
PO BOX 520775 | LONGWOOD, FLORIDA 32752
FBPE C.A. NO. 25935
Phone: 321.690.1788 | Email: info@ptc-corp.com

DRAFTER	TJH	DATE	06/29/10	TELL DOORS & WINDOWS, LLC. 6535 GUHN RD, STE 100, HOUSTON, TX 77040	
CHECKED		DATE		TITLE TIIGA DOORWAY SYSTEM TDS-D-PA-WS OS STEEL DOUBLE DOOR - IMPACT DETAILS AND NOTES	
ENGINEER		DATE		SIZE	B
APPROVED	RJA	DATE	10/17/23	DWG NO	08-01019
THIRD ANGLE PROJECTION			RELEASE STATE	FINAL	REV B
			SCALE	NTS	SHEET 2 OF 8

TELL MANUFACTURING, INC.
18 RICHARD DRIVE, LITITZ, PA 17543



THIS DOCUMENT IS THE PROPERTY OF SPECTRUM BRANDS, INC AND/OR ITS AFFILIATES. THE CONTENTS OF THIS DOCUMENT ARE CONFIDENTIAL AND CONSTITUTE TRADE SECRETS PROPRIETARY TO SPECTRUM BRANDS. NEITHER THIS DOCUMENT NOR ITS CONTENTS SHALL BE DISCLOSED TO ANY UNAUTHORIZED PERSON, COPIED, OR PUBLISHED WITHOUT SPECTRUM BRANDS' PRIOR WRITTEN CONSENT.

PARTS LIST

NO.	PART NUMBER	DESCRIPTION	MANUFACTURER	MATERIAL
1	T-10.3.1	TIOGA PA HEAD JAMB 16GA.	TELL MANUFACT.	GALVANNEALED STEEL
2	T-10.2.1	TIOGA PA HINGE JAMB 16GA.	TELL MANUFACT.	GALVANNEALED STEEL
3	T-1.7	THESHOLD, 1/2" HIGH	HOUSTON NON-FER.	ALUMINUM 6063-T5
4	T-1.2.2	FRAME HINGE REINFORCEMENT 10GA.	DAYTON INDUSTRIES	GALVANNEALED STEEL
5	T-1.1.1	TIOGA BOM DOOR SKIN 18GA.	TELL MANUFACT.	GALVANNEALED STEEL
6	T-1.1.2	TIOGA TOP DOOR SKIN 18GA.	TELL MANUFACT.	GALVANNEALED STEEL
7	T-1.1.3	TOP CAP DOOR CHANNEL 20GA.	TELL MANUFACT.	GALVANNEALED STEEL
8	T-1.1.4	TOP DOOR CHANNEL 16GA.	TELL MANUFACT.	GALVANNEALED STEEL
9	T-1.1.5	BOTTOM DOOR CHANNEL 16GA.	TELL MANUFACT.	GALVANNEALED STEEL
10	T-1.1.6	DOOR HINGE REINFORCEMENT 10GA.	DAYTON INDUSTRIES	GALVANNEALED STEEL
11	T-1.1.7	DOOR FOAM CORE 1 LB/FT DENSITY		POLYSIYRENE
12	T-1.1.8	DOOR CLOSER REINFORCEMENT 12GA.	TELL MANUFACT.	GALVANNEALED STEEL
13	T-1.1.10	MORTISE LOCK REINFORCEMENT 14GA.	TELL MANUFACT.	GALVANNEALED STEEL
14	T-1.1.11	OVERLAP STRIP ASTRAGAL 11 GA.	TELL MANUFACT.	GALVANNEALED STEEL
15	T-1.1.12	INACTIVE DOOR EDGE CHANNEL 16GA.	TELL MANUFACT.	GALVANNEALED STEEL
16	T-10.2.3	PA HINGE JAMB CLIP 12GA.	TELL MANUFACT.	GALVANNEALED STEEL
17	T-1.2.4	FRAME WEATHERSTRIPPING		FOAM
18	T-1.5	HINGES - H4545 SERIES	TELL MANUFACT.	STEEL
19	T-1.6.8	MORTISE LOCK ML 1300	TELL MANUFACT.	STEEL
20	988Y	SURFACE BOLT	YALE SECURITY	STEEL
21	T-1.8	DOOR SWEEP, DT100101	TELL MANUFACT.	ALUMINUM 6063-T5
22	T-10.9	TIOGA PA SUB JAMB 16GA.	TELL MANUFACT.	GALVANNEALED STEEL
23	T-10.10	TIOGA PA SUB JAMB CLIP 12GA.		GALVANNEALED STEEL
24	S1	#12-24 X 1 1/4" HEX HEAD TEK		STEEL
25	B1	5/16"-18 X 3/4" HEX CAP SCREW		STEEL
26	N1	HEX NUT 5/16"		STEEL
27	W1	FLAT WASHER 5/16"		STEEL
28	S2	#8-32 X 1/2" PPH SMS		STEEL
29	S2	#14 X 1/2" PFH SMS		STEEL
30	S3	#10-24 X 1/2" UC PFH SMS		STEEL

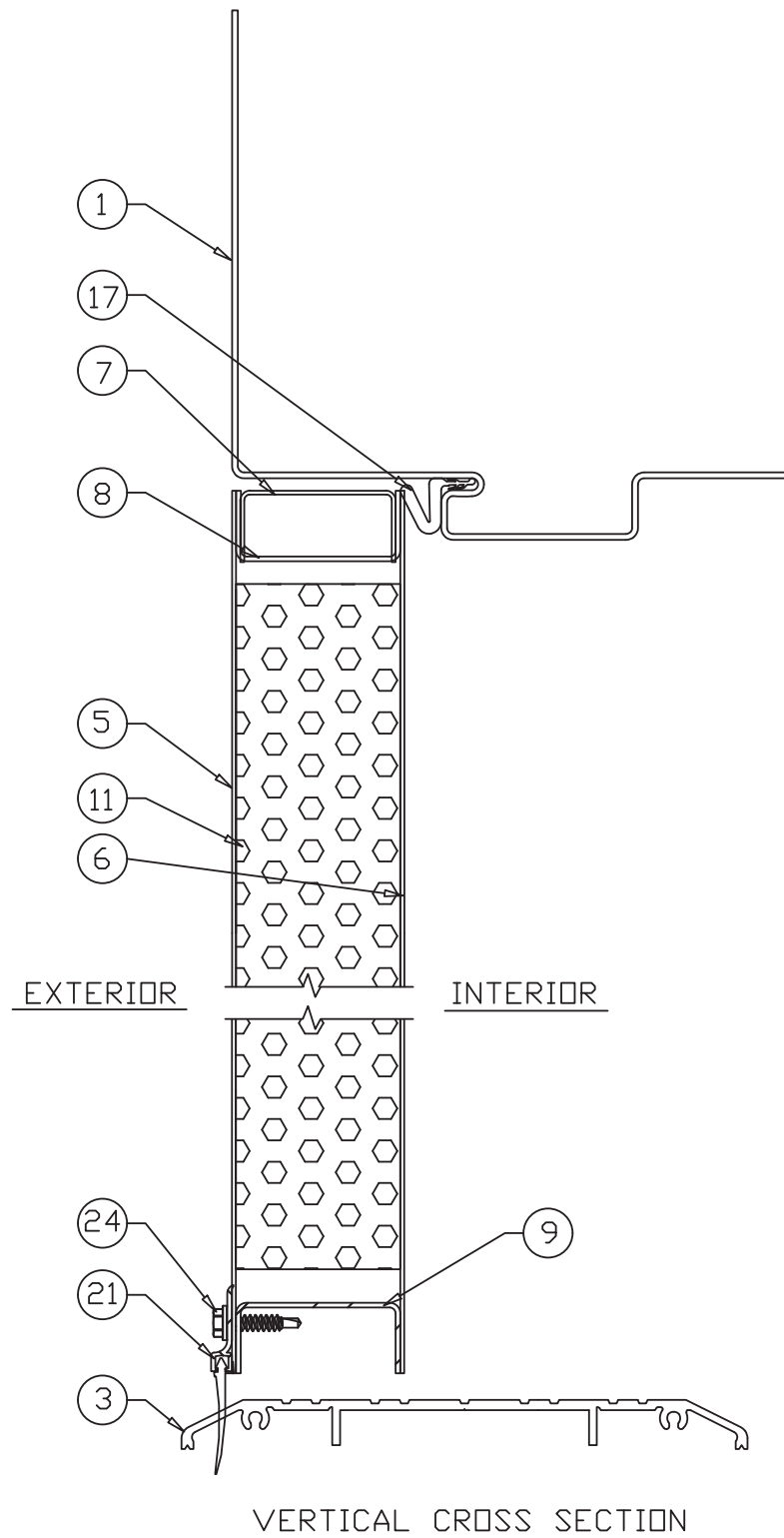

Robert J. Amoruso, P.E.
Florida P.E. No. 49752

PTC PRODUCT DESIGN GROUP, LLC
PO BOX 520775 | LONGWOOD, FLORIDA 32752
FBPE C.A. NO. 25935
Phone: 321.690.1788 | Email: info@ptc-corp.com

DRAFTER TJH	DATE 06/29/10	TELL DOORS & WINDOWS, LLC. 6535 GUHN RD, STE 100, HOUSTON, TX 77040	
CHECKED	DATE	TITLE TIOGA DOORWAY SYSTEM TDS-D-PA-WS DS STEEL DOUBLE DOOR - IMPACT BILL OF MATERIALS AND CROSS SECTION	
ENGINEER	DATE	SIZE B	DWG NO 08-01019
APPROVED RJA	DATE 10/17/23	RELEASE STATE FINAL	REV B
THIRD ANGLE PROJECTION 		SCALE NTS	SHEET 3 OF 8

TELL MANUFACTURING, INC.
18 RICHARD DRIVE, LITITZ, PA 17543

TELL MFG
Spectrum Brands | Hardware & Home Improvement

THIS DOCUMENT IS THE PROPERTY OF SPECTRUM BRANDS, INC. AND/OR ITS AFFILIATES. THE CONTENTS OF THIS DOCUMENT ARE CONFIDENTIAL AND CONSTITUTE TRADE SECRETS PROPRIETARY TO SPECTRUM BRANDS. NEITHER THIS DOCUMENT NOR ITS CONTENTS SHALL BE DISCLOSED TO ANY UNAUTHORIZED PERSON, COPIED, OR PUBLISHED WITHOUT SPECTRUM BRANDS' PRIOR WRITTEN CONSENT.

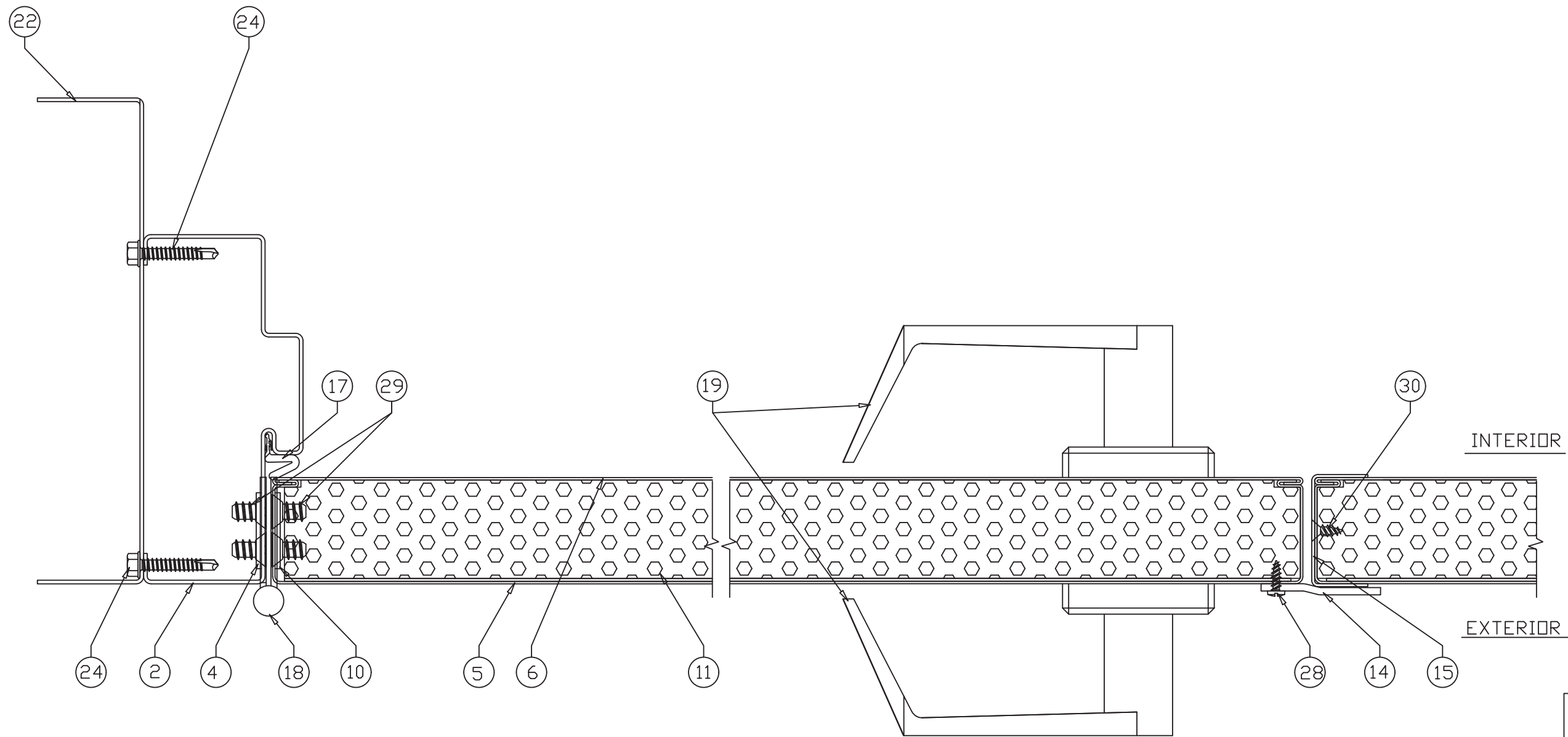

HORIZONTAL CROSS SECTION

Robert J. Amoruso, P.E.
Florida P.E. No. 49752

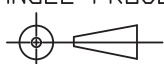

PTC PRODUCT DESIGN GROUP, LLC
PO BOX 520775 | LONGWOOD, FLORIDA 32752
FBPE C.A. NO. 25935
Phone: 321.690.1788 | Email: info@ptc-corp.com

DRAFTER	DATE	TELL DOORS & WINDOWS, LLC. 6535 GUHN RD, STE 100, HOUSTON, TX 77040	
TJH	06/29/10	TITLE	
CHECKED	DATE	TIOGA DOORWAY SYSTEM TDS-D-PA-WS OS STEEL DOUBLE DOOR - IMPACT CROSS SECTION	
ENGINEER	DATE	SIZE	DWG NO
		B	08-01019
APPROVED	DATE	RELEASE STATE	REV ITER
RJA	10/17/23	FINAL	B
THIRD ANGLE PROJECTION		SCALE	SHEET
		NTS	4 OF 8

TELL MANUFACTURING, INC.
18 RICHARD DRIVE, LITITZ, PA 17543

TELL MFG
Spectrum Brands | Hardware & Home Improvement

THIS DOCUMENT IS THE PROPERTY OF SPECTRUM BRANDS, INC AND/OR ITS AFFILIATES. THE CONTENTS OF THIS DOCUMENT ARE CONFIDENTIAL AND CONSTITUTE TRADE SECRETS PROPRIETARY TO SPECTRUM BRANDS. NEITHER THIS DOCUMENT NOR ITS CONTENTS SHALL BE DISCLOSED TO ANY UNAUTHORIZED PERSON, COPIED, OR PUBLISHED WITHOUT SPECTRUM BRANDS' PRIOR WRITTEN CONSENT.

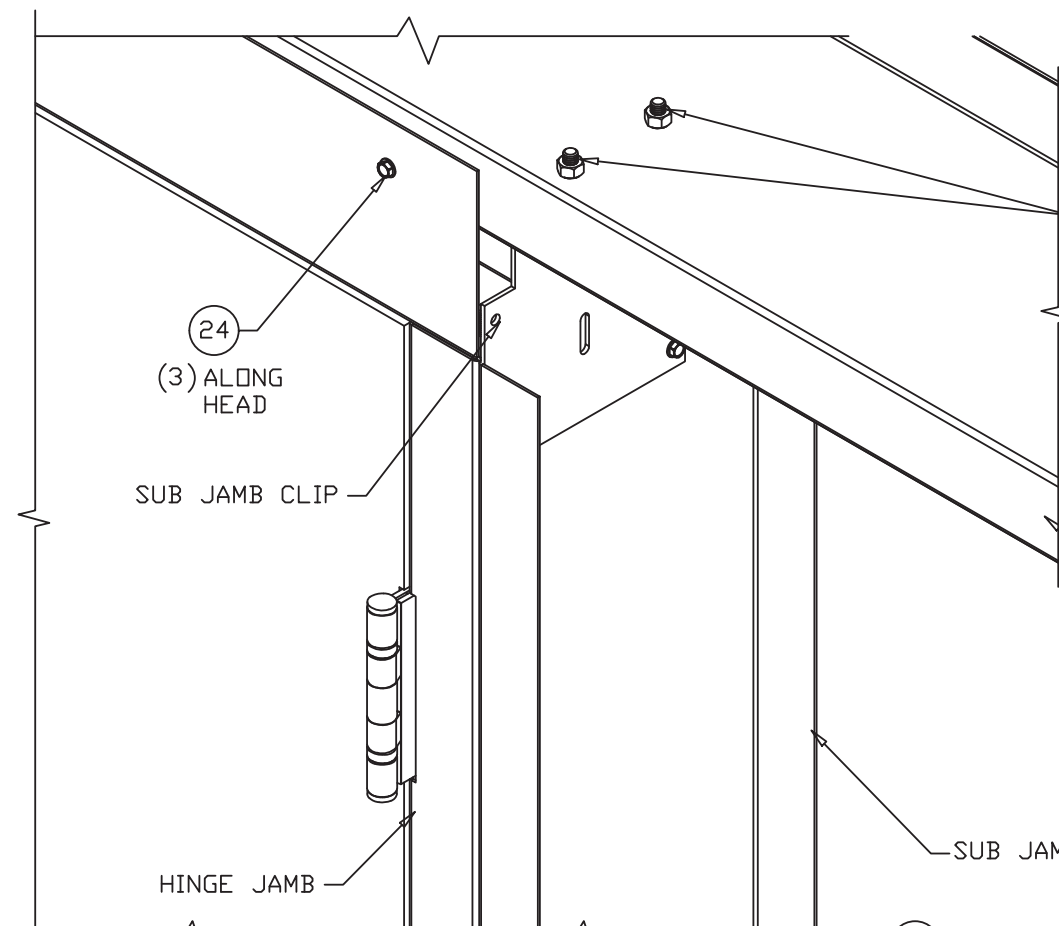

5/16" BOLT WITH 5/16" NUT AND WASHER. BOLT MUST BE 3-THREADS BEYOND NUT MIN. ENGAGEMENT

BUILDING GIRT BY OTHERS

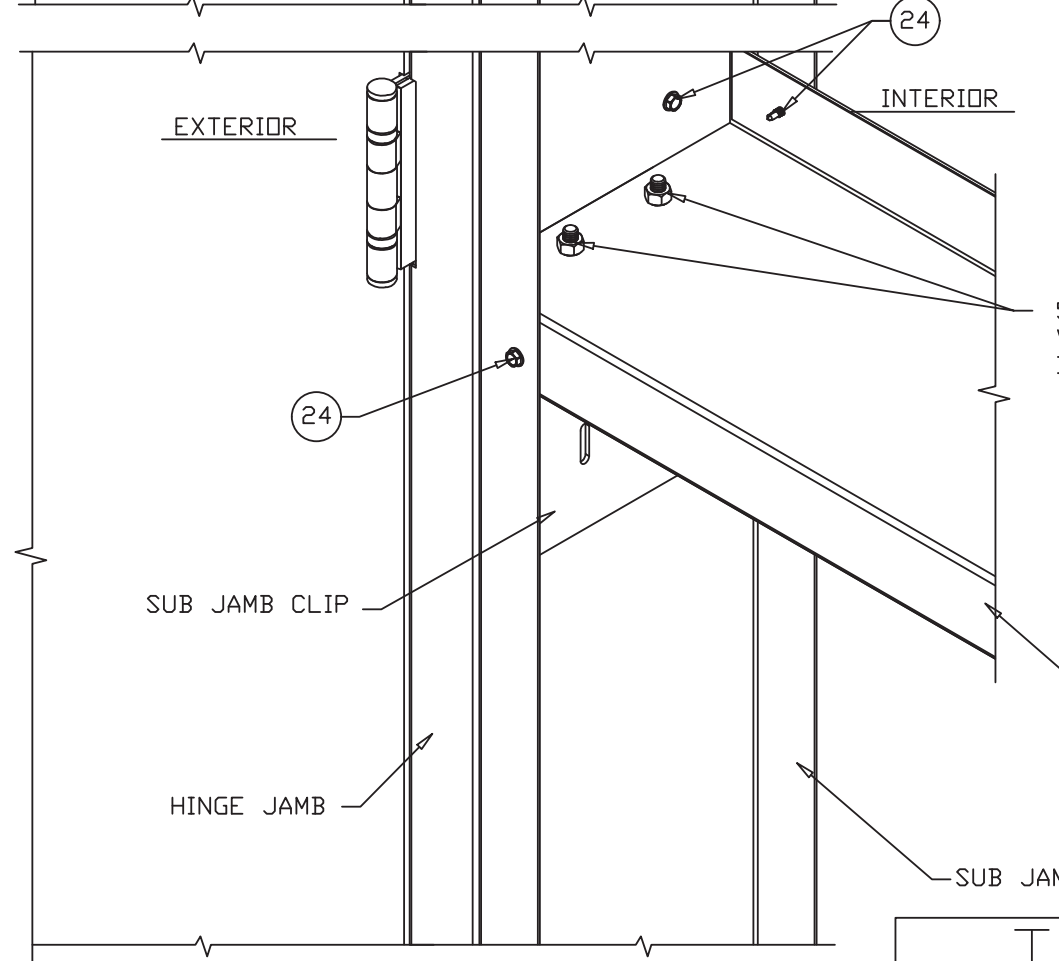

5/16" BOLT WITH 5/16" NUT AND WASHER. BOLT MUST BE 3-THREADS BEYOND NUT MIN. ENGAGEMENT

BUILDING GIRT BY OTHERS

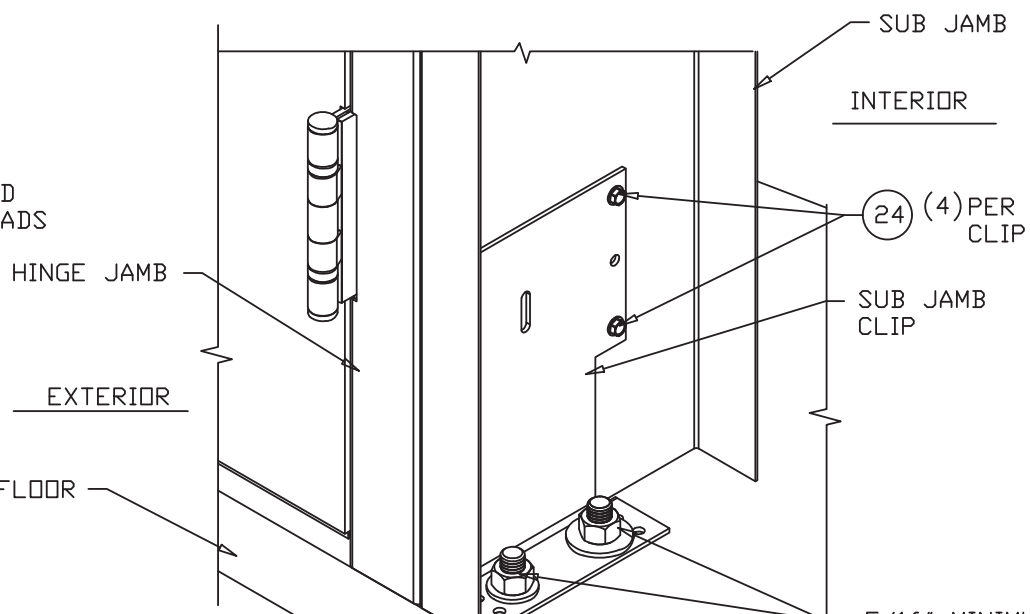

5/16" MINIMUM 90° L-BOLT SET IN CONCRETE WITH 5/16" NUT AND WASHER. BOLT TO BE SET 6" IN CONCRETE MIN. AND HAVE 3-THREADS MIN. BEYOND NUT MIN. ENGAGEMENT AND 2 3/4" MIN. EDGE DISTANCE OR 3/8" HILTI KWIK BOLT 3 WITH 2 1/2" MIN. EMBEDMENT INTO CONCRETE AND 4 1/2" MIN. EDGE DIST.

VERTICAL CROSS SECTION
SUB JAMB CLIP TO CONCRETE FLOOR INSTALLATION

VERTICAL CROSS SECTION
SUB JAMB TO GIRT

TELL MANUFACTURING, INC.
18 RICHARD DRIVE, LITITZ, PA 17543



THIS DOCUMENT IS THE PROPERTY OF SPECTRUM BRANDS, INC AND/OR ITS AFFILIATES. THE CONTENTS OF THIS DOCUMENT ARE CONFIDENTIAL AND CONSTITUTE TRADE SECRETS PROPRIETARY TO SPECTRUM BRANDS. NEITHER THIS DOCUMENT NOR ITS CONTENTS SHALL BE DISCLOSED TO ANY UNAUTHORIZED PERSON, COPIED, OR PUBLISHED WITHOUT SPECTRUM BRANDS' PRIOR WRITTEN CONSENT.

DRAFTER	DATE
TJH	06/29/10
CHECKED	DATE
ENGINEER	DATE
APPROVED	DATE
RJA	10/17/23

TELL DOORS & WINDOWS, LLC. 6535 GUHN RD, STE 100, HOUSTON, TX 77040	
TITLE TIOGA DOORWAY SYSTEM TDS-D-PA-WS OS STEEL DOUBLE DOOR - IMPACT INSTALLATION DETAILS	
SIZE B	DWG NO 08-01019
RELEASE STATE	REV ITER FINAL B
SCALE NTS	SHEET 5 OF 8

Robert J. Amoruso, P.E.
Florida P.E. No. 49752

PTC PRODUCT DESIGN GROUP, LLC
PO BOX 520775 | LONGWOOD, FLORIDA 32752
FBPE C.A. NO. 25935
Phone: 321.690.1788 | Email: info@ptc-corp.com

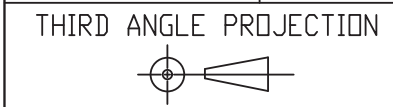

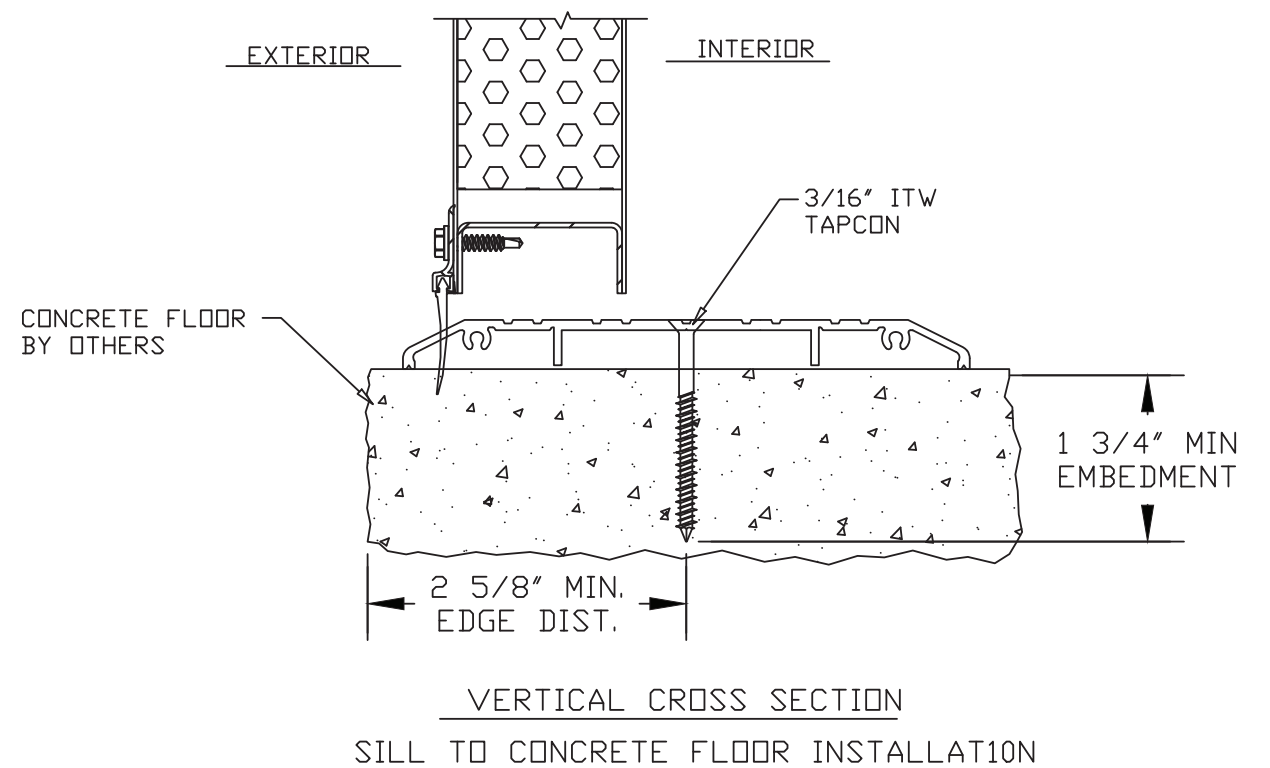
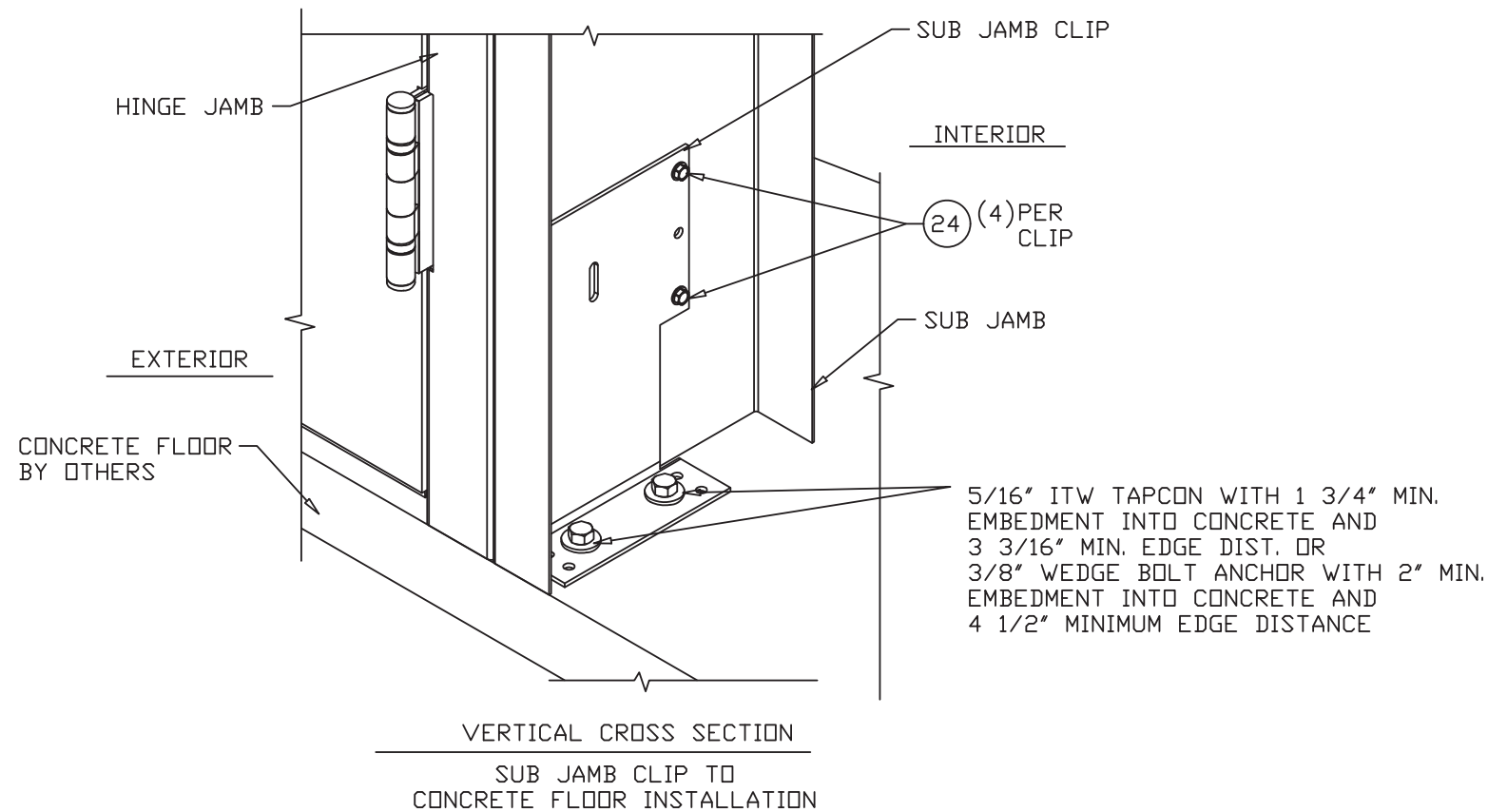

Robert J. Amoruso, P.E.
Florida P.E. No. 49752

PTC PRODUCT DESIGN GROUP, LLC
PO BOX 520775 | LONGWOOD, FLORIDA 32752
FBPE C.A. NO. 25935
Phone: 321.690.1788 | Email: info@ptc-corp.com

TELL MANUFACTURING, INC.
18 RICHARD DRIVE, LITITZ, PA 17543

TELL MFG
Spectrum Brands | **Hardware & Home Improvement**

THIS DOCUMENT IS THE PROPERTY OF SPECTRUM BRANDS, INC AND/OR ITS AFFILIATES. THE CONTENTS OF THIS DOCUMENT ARE CONFIDENTIAL AND CONSTITUTE TRADE SECRETS PROPRIETARY TO SPECTRUM BRANDS. NEITHER THIS DOCUMENT NOR ITS CONTENTS SHALL BE DISCLOSED TO ANY UNAUTHORIZED PERSON, COPIED, OR PUBLISHED WITHOUT SPECTRUM BRANDS' PRIOR WRITTEN CONSENT.

DRAFTER	DATE	TELL DOORS & WINDOWS, LLC. 6535 GUHN RD, STE 100, HOUSTON, TX 77040	
TJH	06/29/10	TITLE	
CHECKED	DATE	TIOGA DOORWAY SYSTEM TDS-D-PA-WS OS STEEL DOUBLE DOOR - IMPACT INSTALLATION DETAILS	
ENGINEER	DATE	SIZE	DWG NO
		B	08-01019
APPROVED	DATE	RELEASE STATE	REV
RJA	10/17/23	FINAL	B
THIRD ANGLE PROJECTION		SCALE	SHEET
		NTS &bhc_pn_note	6 OF 8

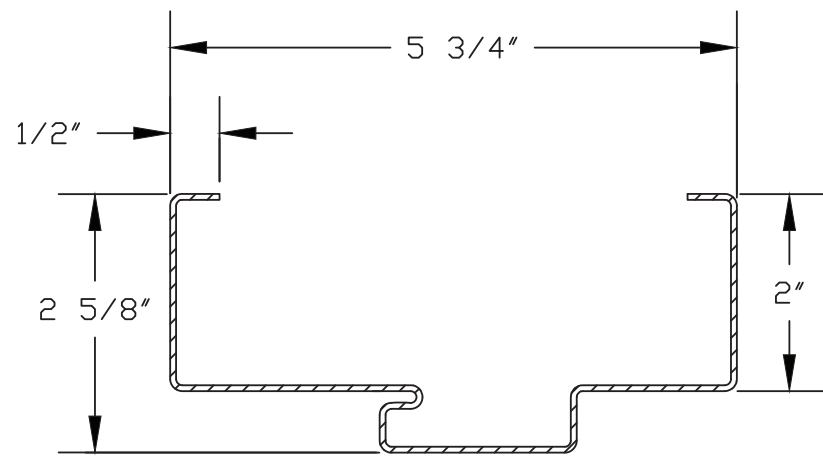

② TIQGA PA HINGE JAMB
16GA. GALVANNEALED
STEEL .053" MIN. THICK

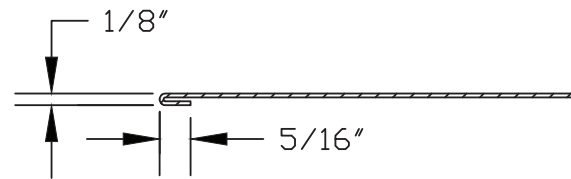

⑥ TIQGA TOP DOOR SKIN
18GA STEEL .044" MIN. THICK
LEFT END SHOWN, RIGHT END IS SIMILAR

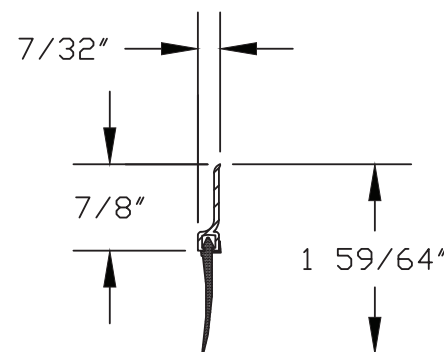

⑳ DOORSWEEP
ALUMINUM 6063-T5 .042" MIN. THICK
EPDM

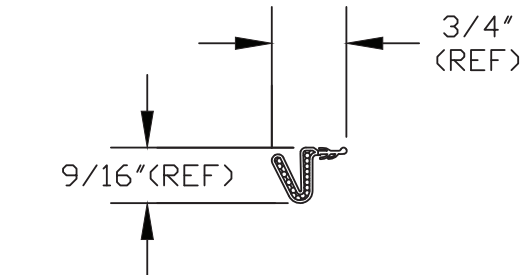

⑰ FRAME WEATHERSTRIPPING
FOAM

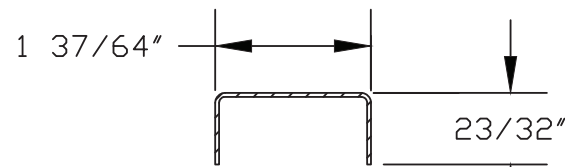

⑦ TOP CAP DOOR
CHANNEL
20GA GALVANNEALED
STEEL .036" MIN. THICK

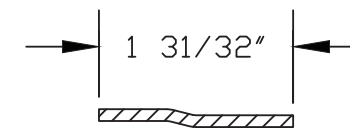

⑭ OVERLAP STRIP
ASTRAGAL
11GA GALVANNEALED
STEEL .123" MIN. THICK

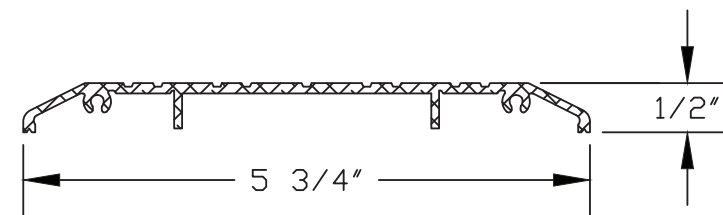

③ THRESHOLD 1/2" HIGH
ALUMINUM 6063-T5 .105" THICK

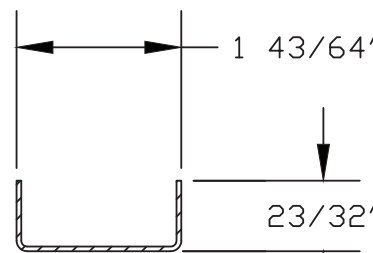

⑧ TOP DOOR CHANNEL
16GA GALVANNEALED
STEEL .053" MIN. THICK

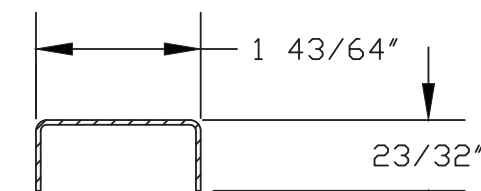

⑨ BOTTOM DOOR CHANNEL
16GA GALVANNEALED
STEEL .053" MIN. THICK

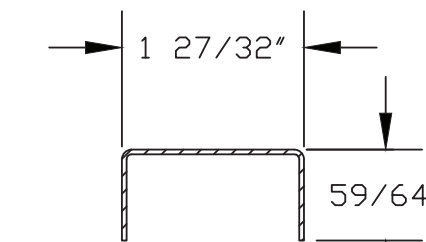

⑮ INACTIVE DOOR
EDGE CHANNEL
16GA GALVANNEALED
STEEL .053" MIN. THICK

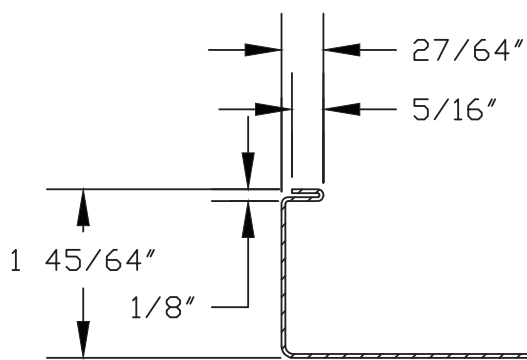

⑤ TIQGA BOTTOM DOOR SKIN
18GA GALVANNEALED STEEL .044" MIN. THICK
LEFT END SHOWN, RIGHT END IS SIMILAR

Robert J. Amoruso, P.E.
Florida P.E. No. 49752



PTC PRODUCT DESIGN GROUP, LLC
PO BOX 520775 | LONGWOOD, FLORIDA 32752
FBPE C.A. NO. 25935
Phone: 321.690.1788 | Email: info@ptc-corp.com

DRAFTER	DATE	TELL DOORS & WINDOWS, LLC. 6535 GUHN RD, STE 100, HOUSTON, TX 77040	
TJH	06/29/10	TITLE	
CHECKED	DATE	TIQGA DOORWAY SYSTEM TDS-D-PA-WS OS STEEL DOUBLE DOOR - IMPACT COMPONENTS	
ENGINEER	DATE	SIZE	DWG NO
APPROVED	DATE	B	08-01019
RJA	10/17/23	RELEASE STATE	REV ITER
THIRD ANGLE PROJECTION		FINAL	B
		SCALE NTS	SHEET 7 OF 8

TELL MFG
Spectrum Brands | Hardware & Home Improvement

THIS DOCUMENT IS THE PROPERTY OF SPECTRUM BRANDS, INC AND/OR ITS AFFILIATES. THE CONTENTS OF THIS DOCUMENT ARE CONFIDENTIAL AND CONSTITUTE TRADE SECRETS PROPRIETARY TO SPECTRUM BRANDS. NEITHER THIS DOCUMENT NOR ITS CONTENTS SHALL BE DISCLOSED TO ANY UNAUTHORIZED PERSON, COPIED, OR PUBLISHED WITHOUT SPECTRUM BRANDS' PRIOR WRITTEN CONSENT.

TELL MANUFACTURING, INC.
18 RICHARD DRIVE, LITITZ, PA 17543

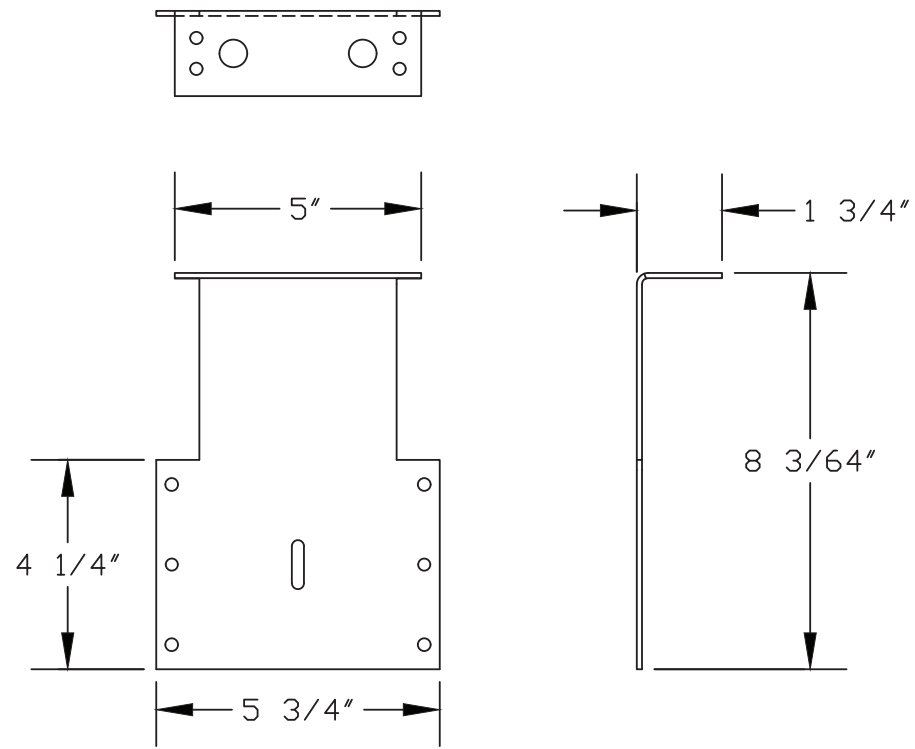

②③ TIOGA PA SUB JAMB CLIP
12GA. GALVANNEALED STEEL .108" MIN. THICK

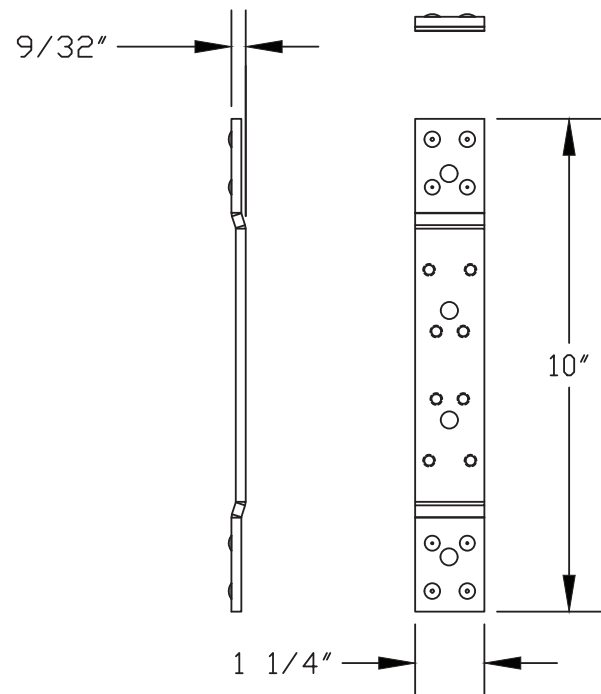

⑩ DOOR HINGE REINFORCEMENT
10GA. GALVANNEALED STEEL .138" MIN. THICK

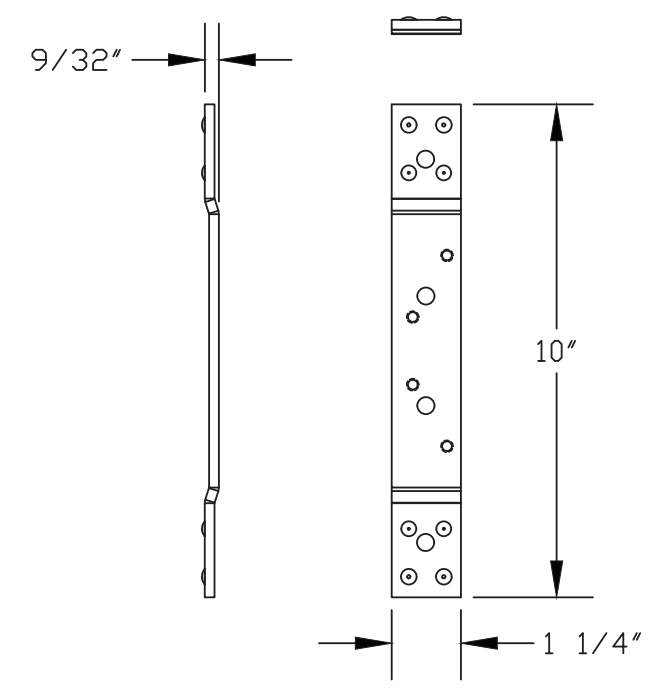

④ FRAME HINGE REINFORCEMENT
10GA. GALVANNEALED STEEL .138" MIN. THICK

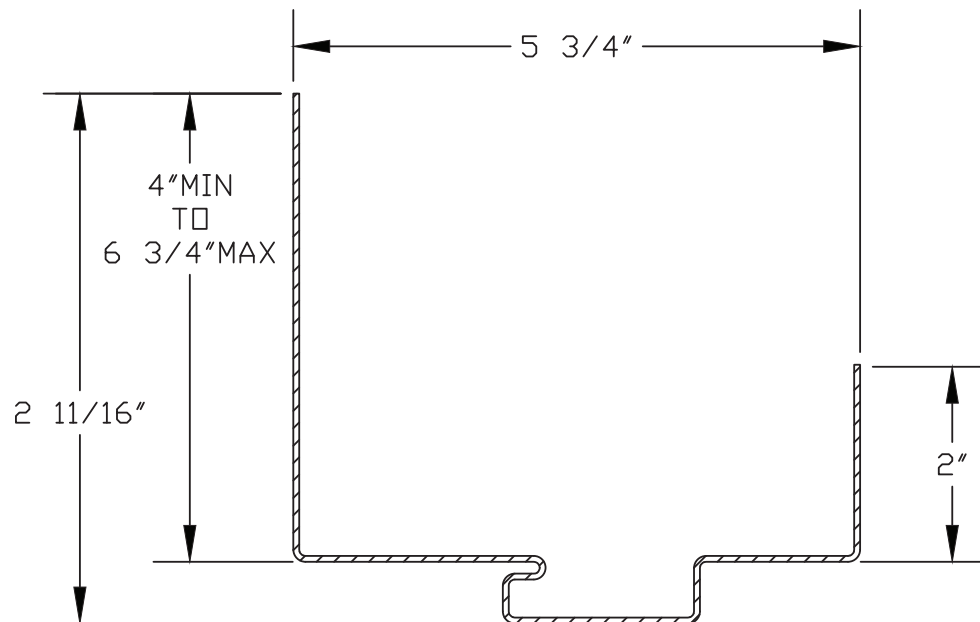

① TIOGA PA HEAD JAMB
16GA. GALVANNEALED STEEL .053" MIN. THICK

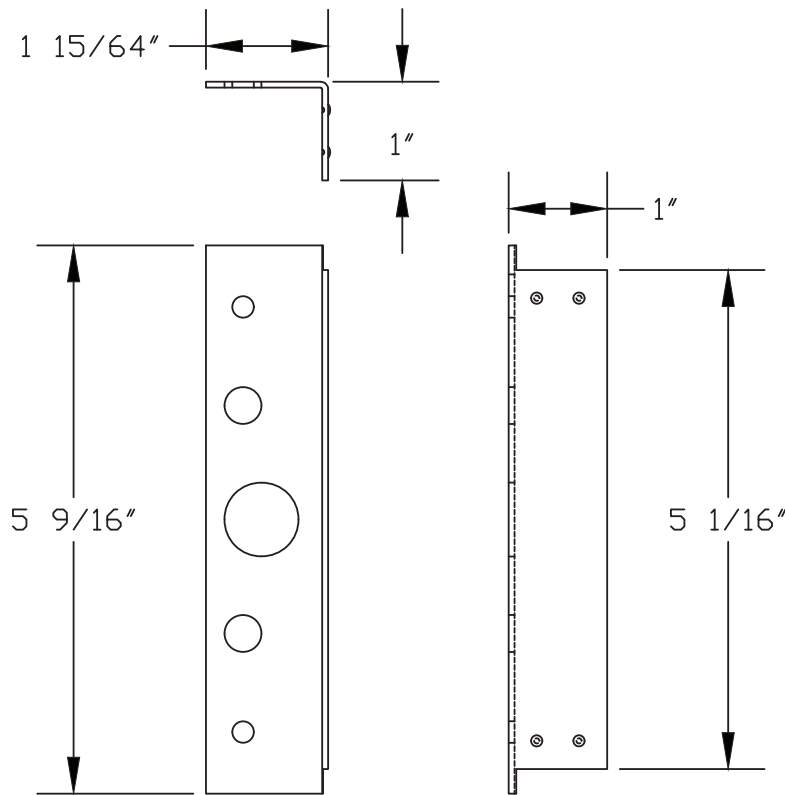

⑩⑥ PA HINGE JAMB CLIP
12GA. GALVANNEALED STEEL .108" MIN. THICK

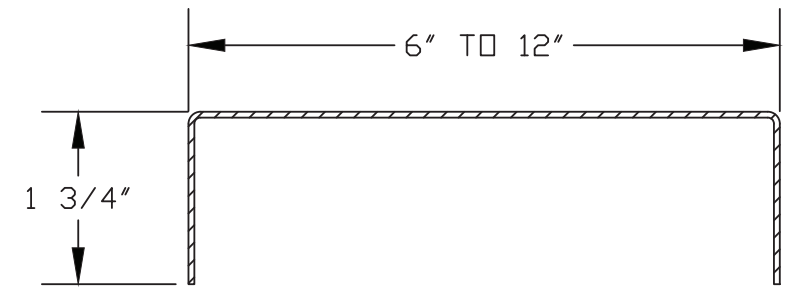

⑩⑥ TIOGA PA SUB JAMB
16GA. GALVANNEALED STEEL .053" MIN. THICK

Robert J. Amoruso, P.E.
Florida P.E. No. 49752

PTC PRODUCT DESIGN GROUP, LLC
PO BOX 520775 | LONGWOOD, FLORIDA 32752
FBPE C.A. NO. 25935
Phone: 321.690.1788 | Email: info@ptc-corp.com

TELL MANUFACTURING, INC.
18 RICHARD DRIVE, LITITZ, PA 17543

TELL MFG
Spectrum Brands | Hardware & Home Improvement

THIS DOCUMENT IS THE PROPERTY OF SPECTRUM BRANDS, INC. AND/OR ITS AFFILIATES. THE CONTENTS OF THIS DOCUMENT ARE CONFIDENTIAL AND CONSTITUTE TRADE SECRETS PROPRIETARY TO SPECTRUM BRANDS. NEITHER THIS DOCUMENT NOR ITS CONTENTS SHALL BE DISCLOSED TO ANY UNAUTHORIZED PERSON, COPIED, OR PUBLISHED WITHOUT SPECTRUM BRANDS' PRIOR WRITTEN CONSENT.

DRAFTER	DATE	TELL DOORS & WINDOWS, LLC. 6535 GUHN RD, STE 100, HOUSTON, TX 77040
TJH	06/29/10	
CHECKED	DATE	
ENGINEER	DATE	
APPROVED	DATE	TITLE
RJA	10/17/23	TIOGA DOORWAY SYSTEM TDS-D-PA-WS STEEL DOUBLE DOOR DS - IMPACT COMPONENTS
THIRD ANGLE PROJECTION	SIZE	DWG NO
	B	08-01019
	RELEASE STATE	REV
	FINAL	B
	SCALE	SHEET
	NTS	8 OF 8

SCALE	NTS	&bhc_pn_note
RELEASE STATE	FINAL	
SHEET	8 OF 8	