

TIIGA DOORWAY SYSTEM TDS-S-PA-WS  
EXTERIOR VIEW

DESIGN PRESSURE RATING	IMPACT RATING
±50PSF	LARGE AND SMALL MISSILE IMPACT
THIS SYSTEM WAS NOT TESTED FOR WATER INFILTRATION AND IS TO BE INSTALLED ONLY WHERE THE WATER REQUIREMENT IS NOT NEEDED	

NOTES:

- 1) THE PRODUCT SHOWN HEREIN IS DESIGNED AND MANUFACTURED TO COMPLY WITH REQUIREMENTS OF THE FLORIDA BUILDING CODE INCLUDING THE HVHZ.
- 2) STEEL FRAMING AND CONCRETE OPENING TO BE DESIGNED AND ANCHORED TO PROPERLY TRANSFER ALL LOADS TO STRUCTURE. FRAMING AND CONCRETE OPENING IS THE RESPONSIBILITY OF THE ARCHITECT OR ENGINEER OF RECORD.
- 3) BUILDING GIRT AND OPTIONAL INTERMEDIATE BUILDING GIRT TO BE DESIGNED AND ANCHORED TO PROPERLY TRANSFER ALL LOADS TO STRUCTURE. BUILDING GIRT AND OPTIONAL INTERMEDIATE GIRT ARE THE RESPONSIBILITY OF THE ARCHITECT OR ENGINEER OF RECORD.
- 4) ALLOWABLE STRESS INCREASE OF 1/3 WAS NOT USED IN THE DESIGN OF THE PRODUCT SHOWN HEREIN. WIND LOAD DURATION FACTOR Cd=1.6 WAS USED FOR WOOD ANCHOR CALCULATIONS.
- 5) FRAME MATERIAL: FORMED 16GA. (.053" MIN.) GALVANNEALED STEEL.
- 6) DOOR PANEL MATERIAL: FORMED 20GA. (.036" MIN.) GALVANNEALED STEEL.
- 7) APPROVED IMPACT PROTECTIVE SYSTEM IS NOT REQUIRED FOR THIS PRODUCT IN WIND BORNE DEBRIS REGIONS.
- 8) EACH PANEL IS FITTED WITH THREE HINGES LOCATED AT 6" MINIMUM UPTO 10" MAXIMUM FROM EACH END WITH ONE AT PANEL MIDSPAN.

HARDWARE SCHEDULE	
A.	ML 1300 MORTISE LOCK BY TELL MANUFACTURING, INC.
B.	RIM PANIC DEVICE 9500 SERIES BY TELL MANUFACTURING, INC.
C.	CYLINDRICAL LOCK LC1200 SERIES BY TELL MANUFACTURING, INC.
D.	STEEL HINGES H4545 BY TELL MANUFACTURING, INC.
E.	ALUMINUM THRESHOLD 1/2" HIGH BY HOUSTON NON-FERROUS

ITEMS A, B AND C ARE INTERCHANGEABLE

TABLE OF CONTENTS	
SHEET NO.	DESCRIPTION
1	ELEVATION, ANCHORING LAYOUT AND NOTES
2	DETAILS AND NOTES
3	BILL OF MATERIALS AND CROSS SECTION
4	CROSS SECTION
5 - 6	INSTALLATION DETAILS
7 - 8	COMPONENTS

Robert J. Amoruso, P.E.  
Florida P.E. No. 49752

PTC PRODUCT DESIGN GROUP, LLC  
PO BOX 520775 | LONGWOOD, FLORIDA 32752  
FBPE C.A. NO. 25935  
Phone: 321.690.1788 | Email: info@ptc-corp.com

DRAFTER	DATE	TELL DOORS & WINDOWS, LLC. 6535 GUHN RD, STE 100, HOUSTON, TX 77040	
CHECKED	DATE	TITLE TIIGA DOORWAY SYSTEM TDS-S-PA-WS OS STEEL SINGLE DOOR - IMPACT ELEVATION, ANCHORING LAYOUT AND NOTES	
ENGINEER TJH	DATE 07/06/10	SIZE B	DWG NO 08-01021
APPROVED RJA	DATE 10/17/23	RELEASE STATE FINAL	
THIRD ANGLE PROJECTION 		SCALE NTS	SHEET 1 OF 8

TELL MFG  
**Spectrum Brands** | Hardware & Home Improvement

THIS DOCUMENT IS THE PROPERTY OF SPECTRUM BRANDS, INC. AND/OR ITS AFFILIATES. THE CONTENTS OF THIS DOCUMENT ARE CONFIDENTIAL AND CONSTITUTE TRADE SECRETS PROPRIETARY TO SPECTRUM BRANDS. NEITHER THIS DOCUMENT NOR ITS CONTENTS SHALL BE DISCLOSED TO ANY UNAUTHORIZED PERSON, COPIED, OR PUBLISHED WITHOUT SPECTRUM BRANDS' PRIOR WRITTEN CONSENT.

NOTES:

- 1) FOR ANCHORING SUB JAMB CLIP TO 16GA. (.060" MIN.) STEEL FRAMING USE 5/16"-18 BOLT WITH 5/16"-18 NUT AND 5/16" WASHER. BOLT TO BE OF SUFFICIENT LENGTH TO ACHIEVE 3-THREADS MINIMUM BEYOND NUT. LOCATE ANCHORS AS SHOWN IN ELEVATION AND INSTALLATION DETAILS.
- 2) FOR ANCHORING SUB JAMB CLIP INTO CONCRETE AT FLOOR USE:
  - 5/16" MINIMUM 90° L-BOLT SET IN CONCRETE WITH 5/16" NUT AND WASHER. BOLT TO BE OF SUFFICIENT LENGTH TO ACHIEVE 6" MINIMUM EMBEDMENT INTO CONCRETE AND 3-THREADS MINIMUM BEYOND NUT AND WASHER WITH 2 3/4" MINIMUM EDGE DISTANCE.
  - 90° L-BOLT TO BE MINIMUM A36 STEEL.
  - 3/8" HILTI KWIK BOLT 3 OF SUFFICIENT LENGTH TO ACHIEVE 2 1/2" MINIMUM EMBEDMENT INTO CONCRETE WITH 4 1/2" MINIMUM EDGE DISTANCE
  - 3/8" WEDGE BOLT OF SUFFICIENT LENGTH TO ACHIEVE 2" MINIMUM EMBEDMENT INTO CONCRETE WITH 4 1/2" MINIMUM EDGE DISTANCE.
  - 5/16" ITW TAPCON OF SUFFICIENT LENGTH TO ACHIEVE 1 3/4" MINIMUM EMBEDMENT INTO CONCRETE WITH 3 3/16" MINIMUM EDGE DISTANCE.
 LOCATE ALL ANCHORS AS SHOWN IN ELEVATIONS AND INSTALLATION DETAILS.
- 3) FOR ANCHORING THRESHOLD INTO CONCRETE USE 3/16" ITW TAPCONS WITH SUFFICIENT LENGTH TO ACHIEVE A 1 3/4" MINIMUM EMBEDMENT INTO SUBSTRATE WITH 2 1/4" MINIMUM EDGE DISTANCE. LOCATE ANCHORS AS SHOWN IN ELEVATIONS AND INSTALLATION DETAILS.
- 4) FOR ANCHORING SUB JAMB CLIP TO WOOD USE 5/16" LAG SCREW WITH MINIMUM EMBEDMENT OF 1-3/4", MINIMUM EDGE DISTANCE OF 1-1/4" AND MINIMUM SPACING OF 1-1/4". LOCATE ANCHORS AS SHOWN IN ELEVATIONS AND INSTALLATION DETAILS.
- 5) WASHERS SHALL BE USED WHEN ANCHORS ARE INSTALLED IN OVERSIZE HOLES (CLIP HOLE DIAMETER 1/16" GREATER DIAMETER THAN ANCHOR DIAMETER).
- 6) MINIMUM 2 ANCHORS PER SUB JAMB CLIP FOR ATTACHMENT TO SUPPORTING SUBSTRATE.
- 7) ALL FASTENERS TO BE CORROSION RESISTANT.
- 8) INSTALLATION ANCHORS SHALL BE INSTALLED IN ACCORDANCE WITH ANCHOR MANUFACTURER'S INSTALLATION INSTRUCTIONS, AND ANCHORS SHALL NOT BE USED IN SUBSTRATES WITH STRENGTHS LESS THAN THE MINIMUM STRENGTH SPECIFIED BELOW:
  - A. WOOD - MINIMUM SPECIFIC GRAVITY OF G=0.42 (NON-HVHZ) AND G=0.55 (HVHZ)
  - B. CONCRETE - MINIMUM COMPRESSIVE STRENGTH OF 3,192 PSI.
  - C. STEEL FRAMING: 16GA. (.060" MIN.)

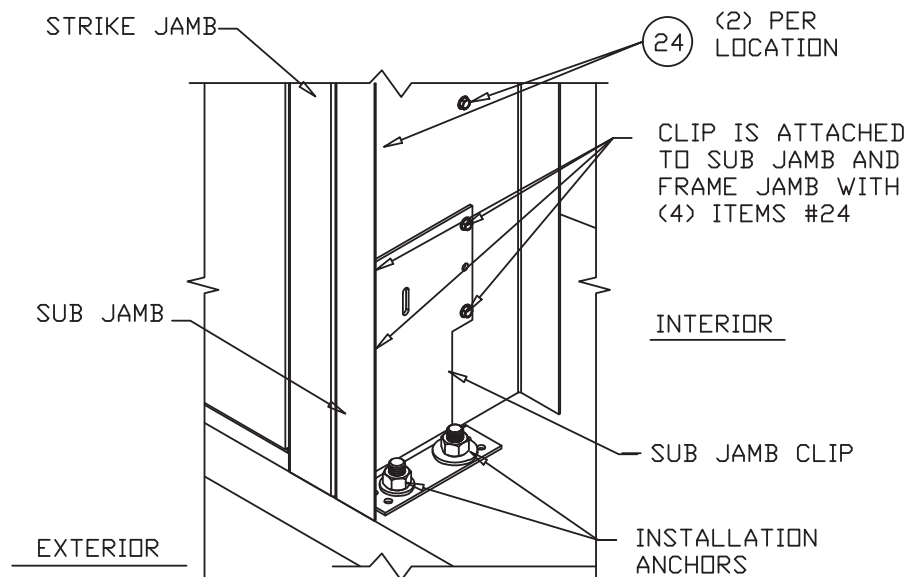

SUB JAMB CLIP TO FLOOR DETAIL

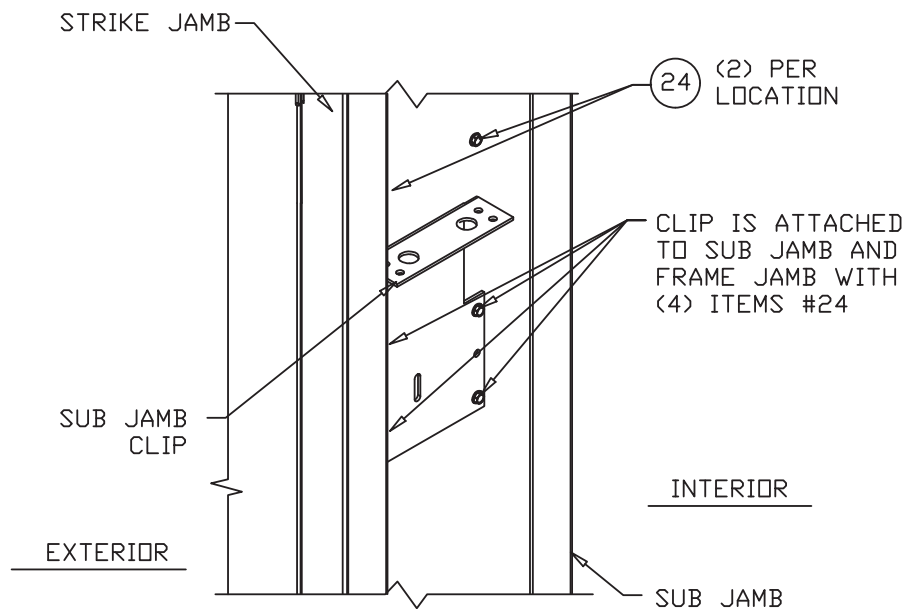

SUB JAMB CLIP TO SUB JAMB ASSEMBLY DETAIL

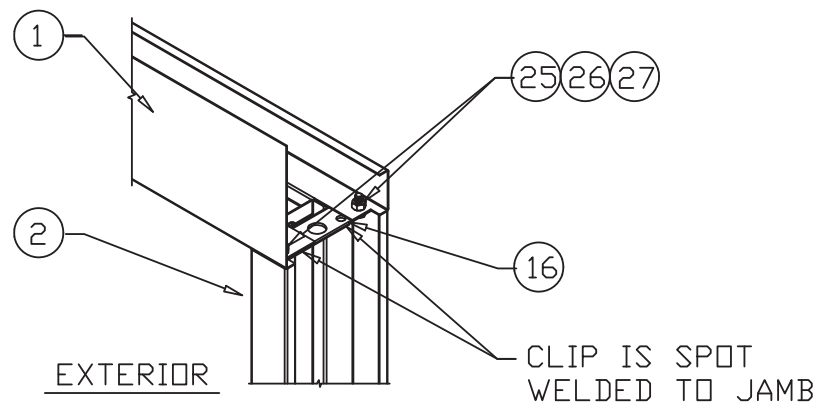

CORNER CONSTRUCTION DETAIL

TELL MANUFACTURING, INC.  
18 RICHARD DRIVE, LITITZ, PA 17543



THIS DOCUMENT IS THE PROPERTY OF SPECTRUM BRANDS, INC AND/OR ITS AFFILIATES. THE CONTENTS OF THIS DOCUMENT ARE CONFIDENTIAL AND CONSTITUTE TRADE SECRETS PROPRIETARY TO SPECTRUM BRANDS. NEITHER THIS DOCUMENT NOR ITS CONTENTS SHALL BE DISCLOSED TO ANY UNAUTHORIZED PERSON, COPIED, OR PUBLISHED WITHOUT SPECTRUM BRANDS' PRIOR WRITTEN CONSENT.

DRAFTER	DATE	TELL DOORS & WINDOWS, LLC. 6535 GUHN RD, STE 100, HOUSTON, TX 77040	
CHECKED	DATE	TITLE TIOGA DOORWAY SYSTEM TDS-S-PA-WS OS STEEL SINGLE DOOR - IMPACT DETAILS AND NOTES	
ENGINEER	DATE TJH 07/06/10	SIZE B	DWG NO 08-01021
APPROVED	DATE RJA 10/17/23	RELEASE STATE	REV B
THIRD ANGLE PROJECTION		SCALE NTS	SHEET 2 OF 8
		FINAL	

Robert J. Amoruso, P.E.  
Florida P.E. No. 49752

PTC PRODUCT DESIGN GROUP, LLC  
PO BOX 520775 | LONGWOOD, FLORIDA 32752  
FBPE C.A. NO. 25935  
Phone: 321.690.1788 | Email: info@ptc-corp.com

PARTS LIST

NO.	PART NUMBER	DESCRIPTION	MANUFACTURER	MATERIAL
1	T-10.3.1	TIOGA PA HEAD JAMB 16GA.	TELL MANUFACT.	GALVANNEALED STEEL
2	T-10.2.1	TIOGA PA HINGE JAMB 16GA.	TELL MANUFACT.	GALVANNEALED STEEL
3	T-1.7	THESHOLD, 1/2" HIGH	HOUSTON NON-FER.	ALUMINUM 6063-T5
4	T-1.2.2	FRAME HINGE REINFORCEMENT 10GA.	DAYTON INDUSTRIES	GALVANNEALED STEEL
5	T-1.1.1	TIOGA BOTTOM DOOR SKIN 20GA.	TELL MANUFACT.	GALVANNEALED STEEL
6	T-1.1.2	TIOGA TOP DOOR SKIN 20GA.	TELL MANUFACT.	GALVANNEALED STEEL
7	T-1.1.3	TOP CAP DOOR CHANNEL 20GA.	TELL MANUFACT.	GALVANNEALED STEEL
8	T-1.1.4		TELL MANUFACT.	GALVANNEALED STEEL
9	T-1.1.5	BOTTOM DOOR CHANNEL 16GA.	TELL MANUFACT.	GALVANNEALED STEEL
10	T-1.1.6	DOOR HINGE REINFORCEMENT 10GA.	DAYTON INDUSTRIES	GALVANNEALED STEEL
11	T-1.1.7	DOOR FOAM CORE 1 LB/FT DENSITY		POLYSIYRENE
12	T-1.1.8	DOOR CLOSER REINFORCEMENT 12GA.	TELL MANUFACT.	GALVANNEALED STEEL
13	T-1.1.10	MORTISE LOCK REINFORCEMENT 14GA.	TELL MANUFACT.	GALVANNEALED STEEL
14	T-10.4.1	TIOGA PA STRIKE JAMB 16GA.	TELL MANUFACT.	GALVANNEALED STEEL
15	T-10.4.3	PA STRIKE JAMB CLIP 12GA.	TELL MANUFACT.	GALVANNEALED STEEL
16	T-10.2.3	PA HINGE JAMB CLIP 12GA.	TELL MANUFACT.	GALVANNEALED STEEL
17	T-1.2.4	FRAME WEATHERSTRIPPING		FOAM
18	T-1.5	HINGES - H4545 SERIES	TELL MANUFACT.	STEEL
19	T-1.6.8	MORTISE LOCK ML 1300	TELL MANUFACT.	STEEL
20	T-I.6A	CYLINDRICAL LOCK LC1200 SERIES	YALE SECURILY	
21	T-1.8	DOOR SWEEP, DT100101	TELL MANUFACT.	ALUMINUM 6063-T5
22	T-10.9	TIOGA PA SUB JAMB 16GA.	TELL MANUFACT.	GALVANNEALED STEEL
23	T-10.10	TIOGA PA SUB JAMB CLIP 12GA.		GALVANNEALED STEEL
24	S1	#12-24 X 1 1/4" HEX HEAD TEK		STEEL
25	B1	5/16"-18 X 3/4" HEX CAP SCREW		STEEL
26	N1	HEX NUT 5/16"		STEEL
27	W1	FLAT WASHER 5/16"		STEEL
28	S2	#8-32 X 1/2" PPH SMS		STEEL
29	S2	#14 X 1/2" PFH SMS		STEEL
30	S3	#10-24 X 1/2" UC PFH SMS		STEEL
31	T.1.6C	RI~ PANIC DEVICE 9500 SERIES	TELL MANUFACT.	
32	T-1.1.9	CYLINDRICAL LOCK REINFORCE. 16GA	TELL MANUFACT.	GALVANNEALED STEEL

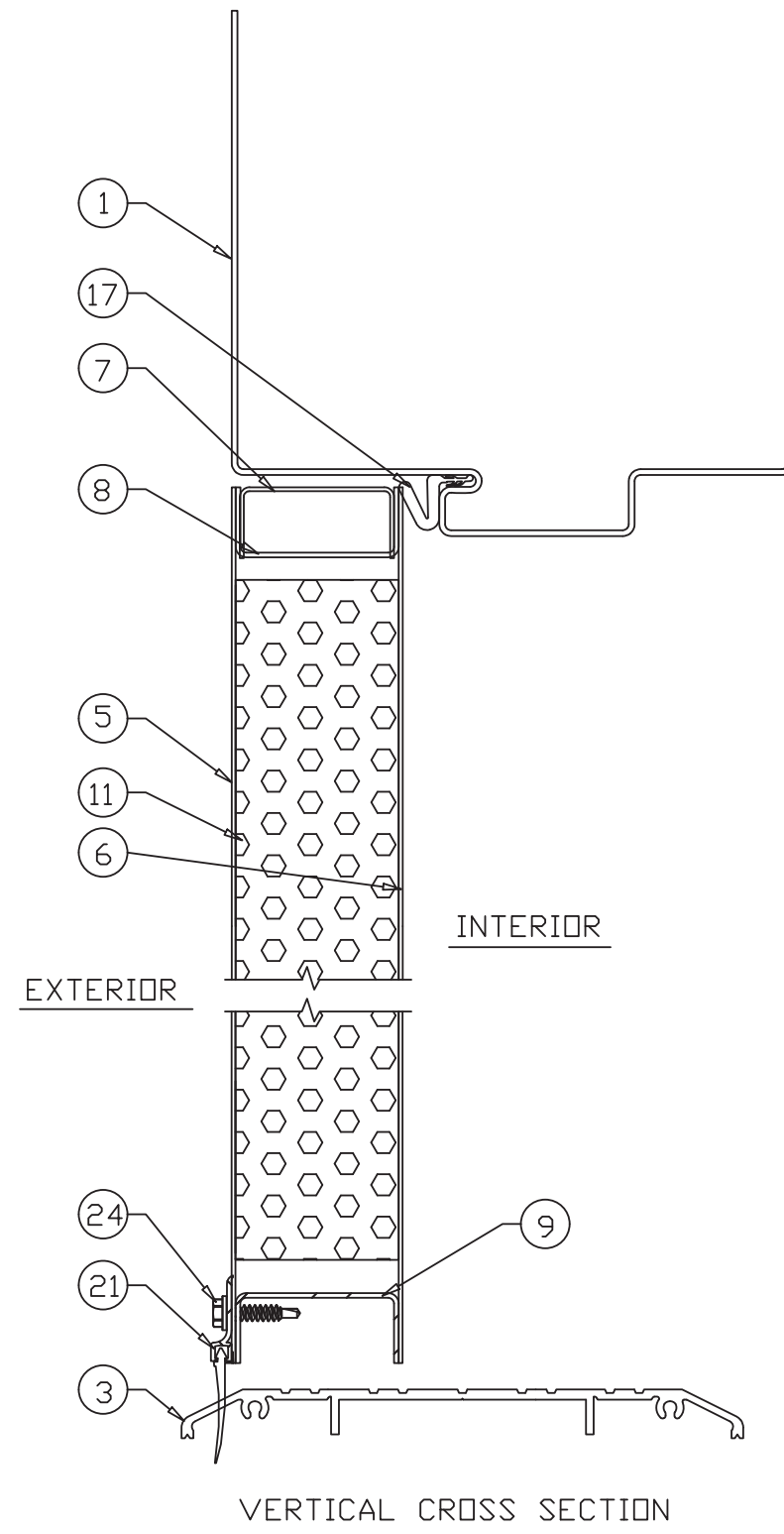

Robert J. Amoruso, P.E.  
 Florida P.E. No. 49752

PTC PRODUCT DESIGN GROUP, LLC  
 PO BOX 520775 | LONGWOOD, FLORIDA 32752  
 FBPE C.A. NO. 25935  
 Phone: 321.690.1788 | Email: info@ptc-corp.com

TELL MANUFACTURING, INC.  
 18 RICHARD DRIVE, LITITZ, PA 17543



THIS DOCUMENT IS THE PROPERTY OF SPECTRUM BRANDS, INC. AND/OR ITS AFFILIATES. THE CONTENTS OF THIS DOCUMENT ARE CONFIDENTIAL AND CONSTITUTE TRADE SECRETS PROPRIETARY TO SPECTRUM BRANDS. NEITHER THIS DOCUMENT NOR ITS CONTENTS SHALL BE DISCLOSED TO ANY UNAUTHORIZED PERSON, COPIED, OR PUBLISHED WITHOUT SPECTRUM BRANDS' PRIOR WRITTEN CONSENT.

DRAFTER	DATE	TELL DOORS & WINDOWS, LLC. 6535 GUHN RD, STE 100, HOUSTON, TX 77040	
CHECKED	DATE	TITLE TIOGA DOORWAY SYSTEM TDS-S-PA-WS DS STEEL SINGLE DOOR - IMPACT BILL OF MATERIALS AND CROSS SECTION	
ENGINEER TJH	DATE 07/06/10	SIZE B	DWG NO 08-01021
APPROVED RJA	DATE 10/17/23	RELEASE STATE FINAL	
THIRD ANGLE PROJECTION 		SCALE NTS	SHEET 3 OF 8

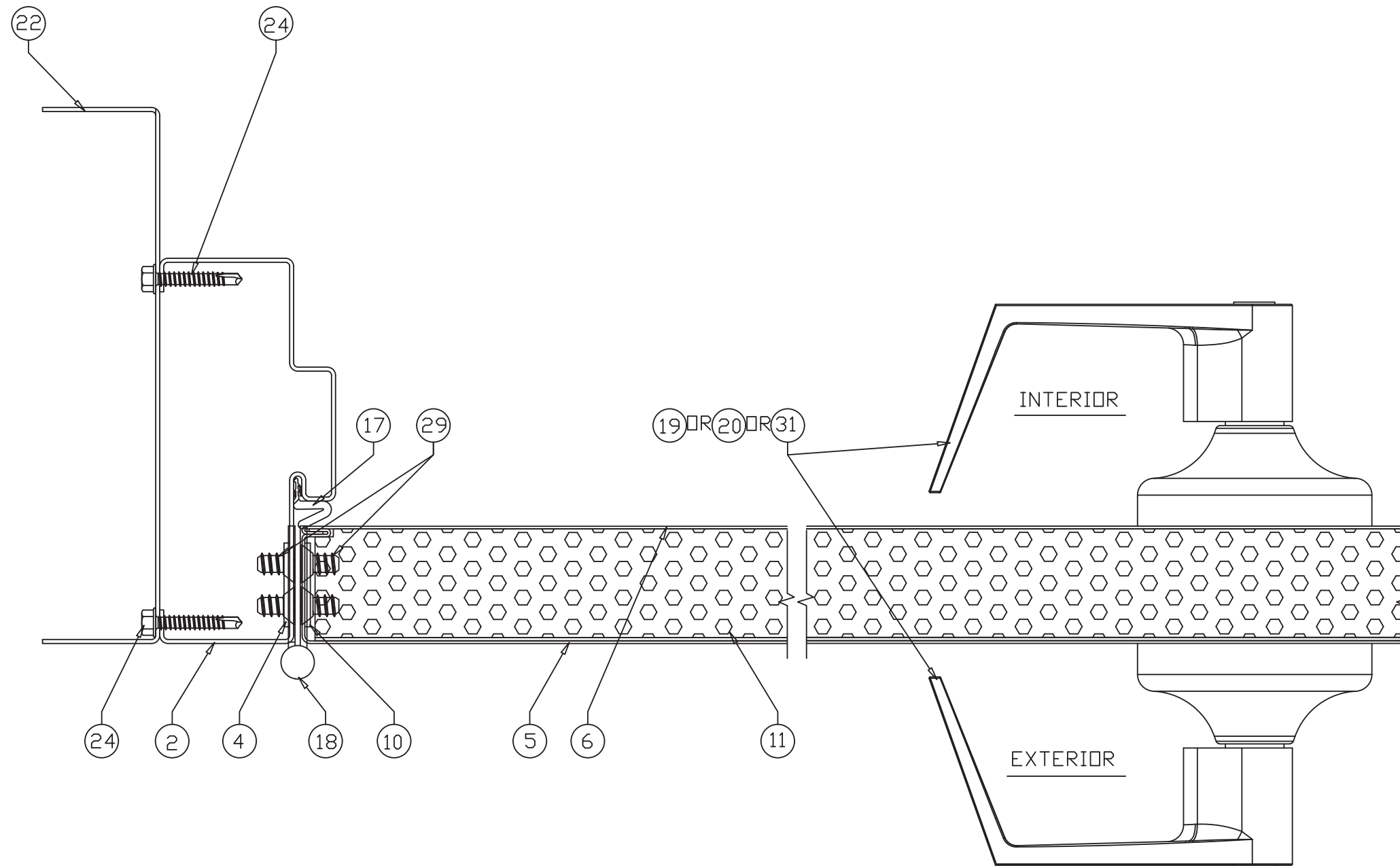

HORIZONTAL CROSS SECTION

Robert J. Amoruso, P.E.  
 Florida P.E. No. 49752

PTC PRODUCT DESIGN GROUP, LLC  
 PO BOX 520775 | LONGWOOD, FLORIDA 32752  
 FBPE C.A. NO. 25935  
 Phone: 321.690.1788 | Email: info@ptc-corp.com

TELL MANUFACTURING, INC.  
 18 RICHARD DRIVE, LITITZ, PA 17543

TELL MFG  
**Spectrum Brands** | Hardware & Home Improvement

THIS DOCUMENT IS THE PROPERTY OF SPECTRUM BRANDS, INC AND/OR ITS AFFILIATES. THE CONTENTS OF THIS DOCUMENT ARE CONFIDENTIAL AND CONSTITUTE TRADE SECRETS PROPRIETARY TO SPECTRUM BRANDS. NEITHER THIS DOCUMENT NOR ITS CONTENTS SHALL BE DISCLOSED TO ANY UNAUTHORIZED PERSON, COPIED, OR PUBLISHED WITHOUT SPECTRUM BRANDS' PRIOR WRITTEN CONSENT.

DRAFTER	DATE	TELL DOORS & WINDOWS, LLC. 6535 GUHN RD, STE 100, HOUSTON, TX 77040			
CHECKED	DATE	TITLE TIOGA DOORWAY SYSTEM TDS-S-PA-WS OS STEEL SINGLE DOOR - IMPACT CROSS SECTION			
ENGINEER T J H	DATE 07/06/10	SIZE B	DWG NO	08-01021	
APPROVED RJA	DATE 10/17/23	RELEASE STATE		FINAL	REV B
THIRD ANGLE PROJECTION 		SCALE	NTS		SHEET 4 OF 8



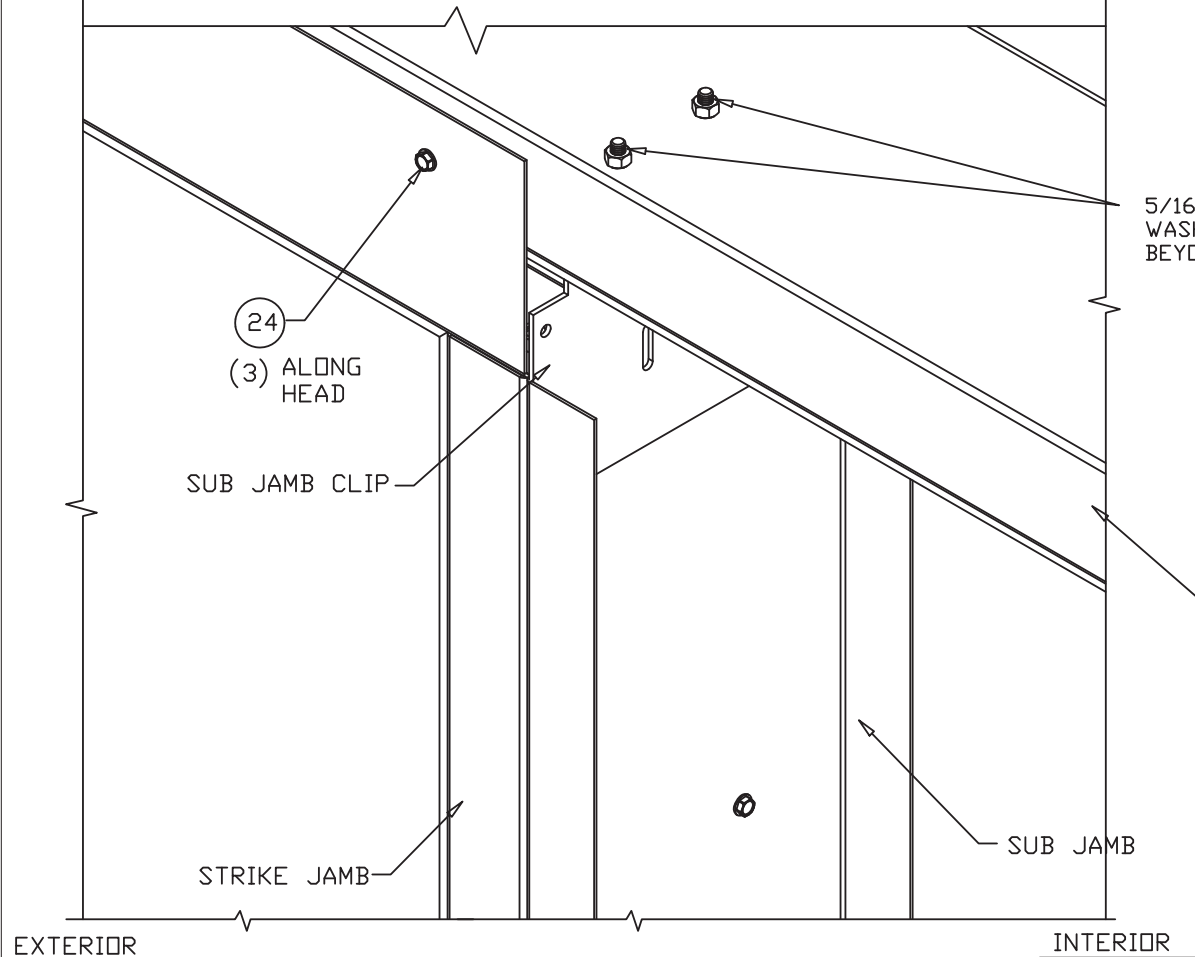

5/16" BOLT WITH 5/16" NUT AND WASHER. BOLT MUST BE 3-THREADS BEYOND NUT MIN. ENGAGEMENT

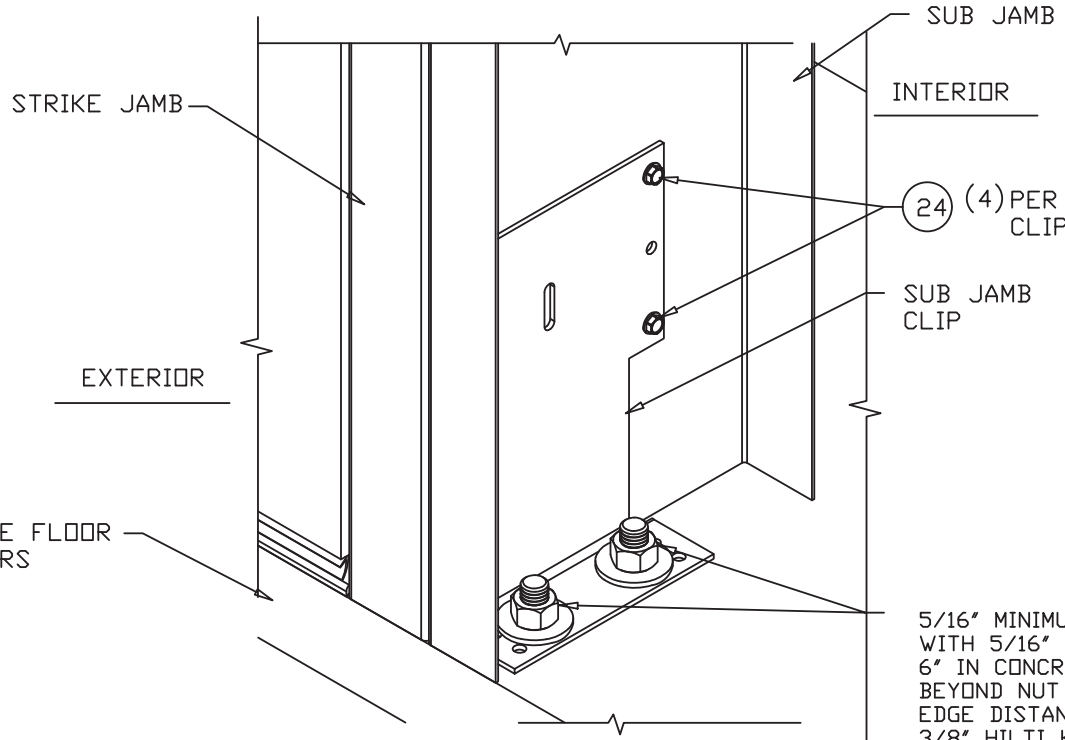

5/16" MINIMUM 90° L-BOLT SET IN CONCRETE WITH 5/16" NUT AND WASHER. BOLT TO BE SET 6" IN CONCRETE MIN. AND HAVE 3-THREADS MIN. BEYOND NUT MIN. ENGAGEMENT AND 2 3/4" MIN. EDGE DISTANCE OR 3/8" HILTI KWIK BOLT 3 WITH 2 1/2" MIN. EMBEDMENT INTO CONCRETE AND 4 1/2" MIN. EDGE DIST.

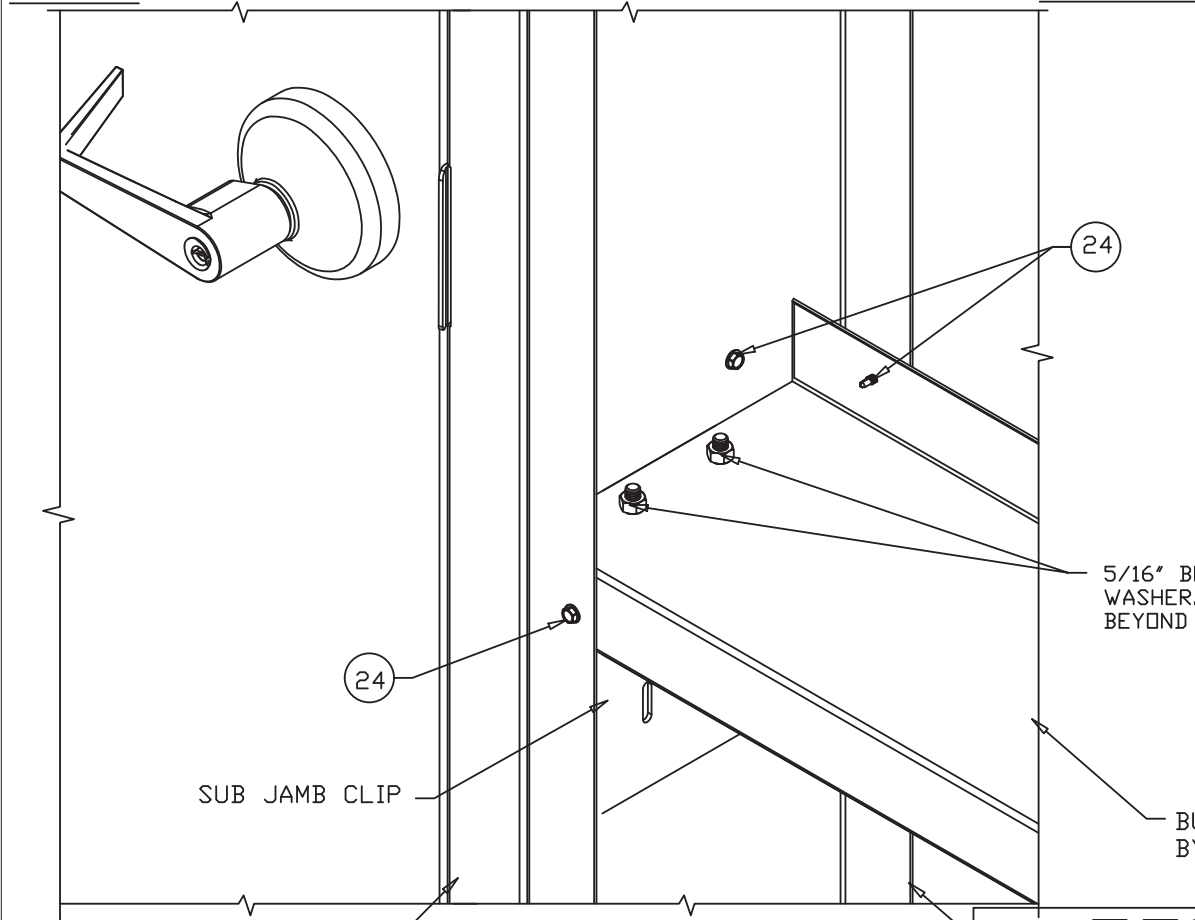

5/16" BOLT WITH 5/16" NUT AND WASHER. BOLT MUST BE 3-THREADS BEYOND NUT MIN. ENGAGEMENT

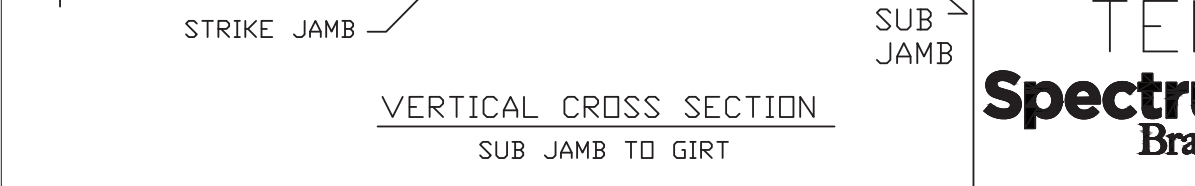

VERTICAL CROSS SECTION  
SUB JAMB TO GIRT

TELL MANUFACTURING, INC.  
18 RICHARD DRIVE, LITITZ, PA 17543



THIS DOCUMENT IS THE PROPERTY OF SPECTRUM BRANDS, INC AND/OR ITS AFFILIATES. THE CONTENTS OF THIS DOCUMENT ARE CONFIDENTIAL AND CONSTITUTE TRADE SECRETS PROPRIETARY TO SPECTRUM BRANDS. NEITHER THIS DOCUMENT NOR ITS CONTENTS SHALL BE DISCLOSED TO ANY UNAUTHORIZED PERSON, COPIED, OR PUBLISHED WITHOUT SPECTRUM BRANDS' PRIOR WRITTEN CONSENT.

Robert J. Amoruso, P.E.  
Florida P.E. No. 49752

PTC PRODUCT DESIGN GROUP, LLC  
PO BOX 520775 | LONGWOOD, FLORIDA 32752  
FBPE C.A. NO. 25935  
Phone: 321.690.1788 | Email: info@ptc-corp.com

DRAFTER	DATE	TELL DOORS & WINDOWS, LLC. 6535 GUHN RD, STE 100, HOUSTON, TX 77040	
CHECKED	DATE	TITLE TIOGA DOORWAY SYSTEM TDS-S-PA-WS OS STEEL SINGLE DOOR - IMPACT INSTALLATION DETAILS	
ENGINEER TJH	DATE 07/06/10	SIZE B	DWG NO 08-01021
APPROVED RJA	DATE 10/17/23	RELEASE STATE	REV ITER FINAL B
THIRD ANGLE PROJECTION 		SCALE NTS	SHEET 5 OF 8

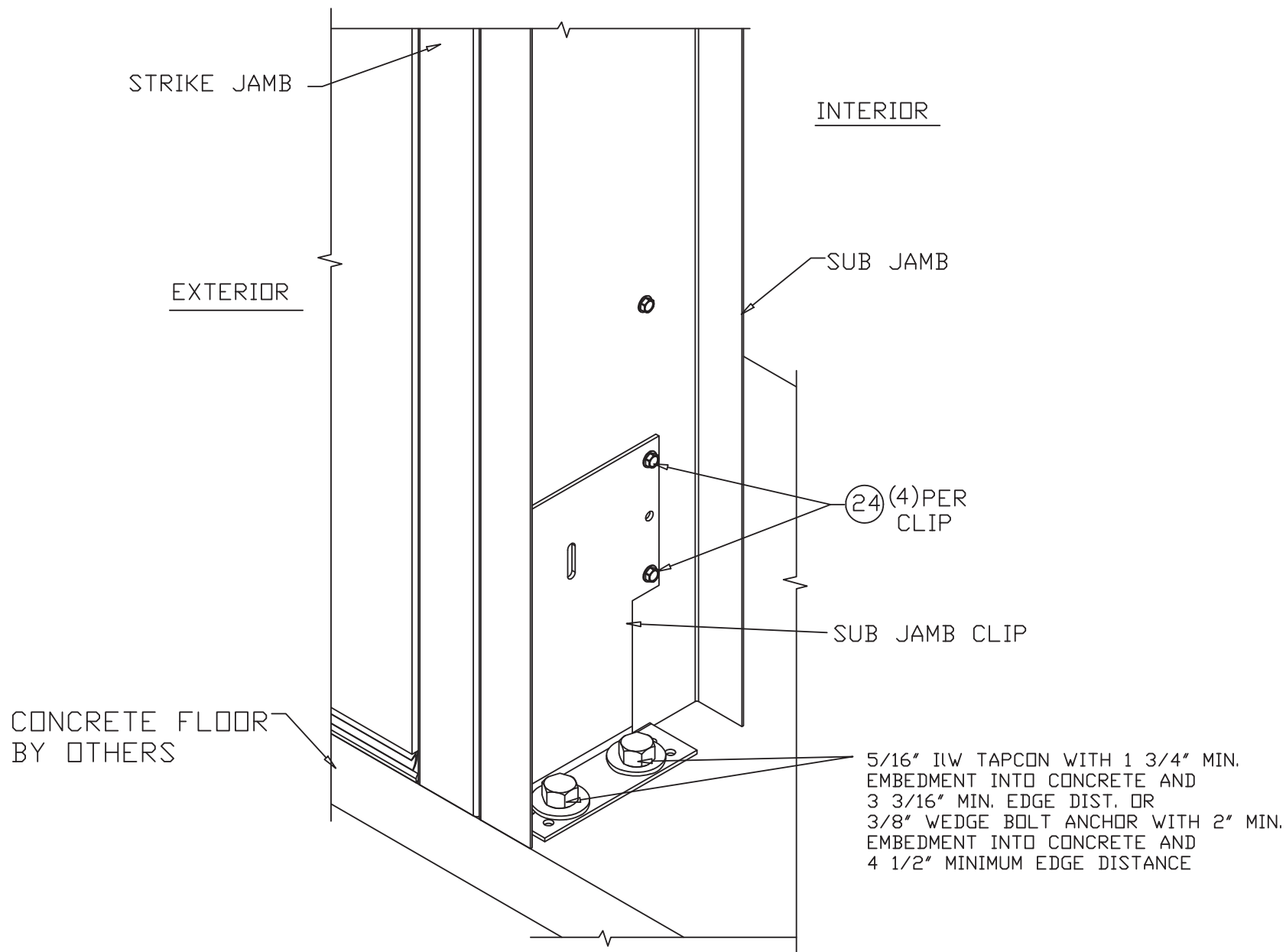

VERTICAL CROSS SECTION

SUB JAMB CLIP TO  
CONCRETE FLOOR INSTALLTION

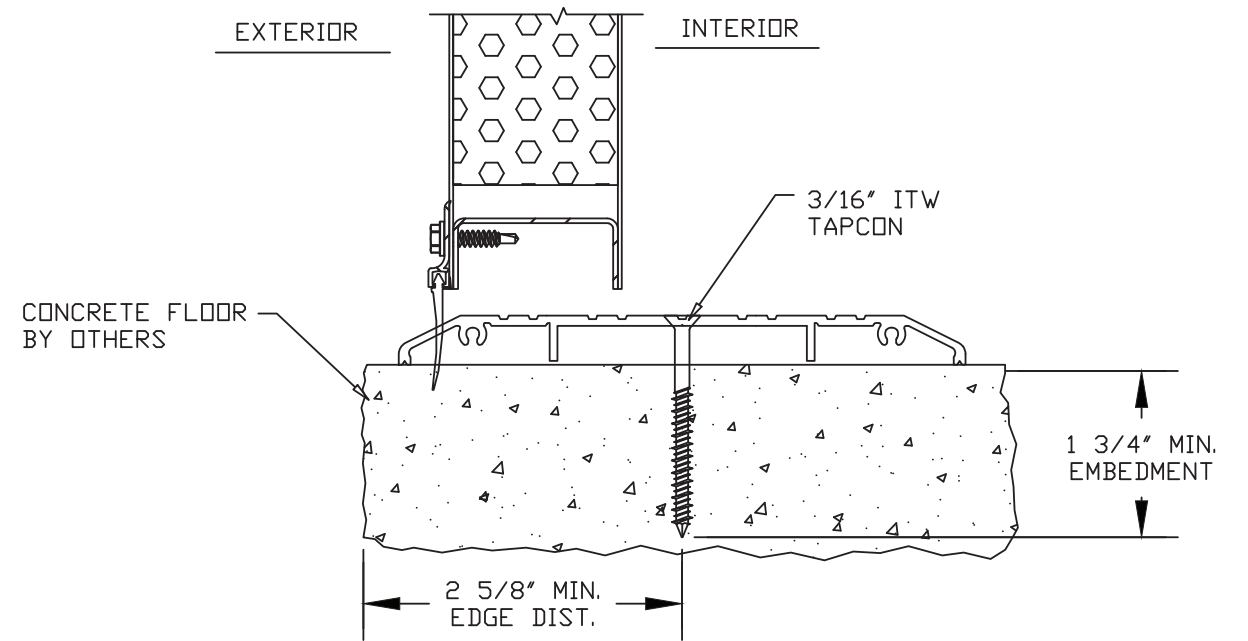

VERTICAL CROSS SECTION  
SILL TO CONCRETE FLOOR INSTALLATION

Robert J. Amoruso, P.E.  
Florida P.E. No. 49752

PTC PRODUCT DESIGN GROUP, LLC  
PO BOX 520775 | LONGWOOD, FLORIDA 32752  
FBPE C.A. NO. 25935  
Phone: 321.690.1788 | Email: info@ptc-corp.com

TELL MANUFACTURING, INC.  
18 RICHARD DRIVE, LITITZ, PA 17543

TELL MFG  
**Spectrum Brands** | Hardware & Home Improvement

THIS DOCUMENT IS THE PROPERTY OF SPECTRUM BRANDS, INC AND/OR ITS AFFILIATES. THE CONTENTS OF THIS DOCUMENT ARE CONFIDENTIAL AND CONSTITUTE TRADE SECRETS PROPRIETARY TO SPECTRUM BRANDS. NEITHER THIS DOCUMENT NOR ITS CONTENTS SHALL BE DISCLOSED TO ANY UNAUTHORIZED PERSON, COPIED, OR PUBLISHED WITHOUT SPECTRUM BRANDS' PRIOR WRITTEN CONSENT.

DRAFTER	DATE	TELL DOORS & WINDOWS, LLC. 6535 GUHN RD, STE 100, HOUSTON, TX 77040			
CHECKED	DATE	TITLE TIOGA DOORWAY SYSTEM TDS-S-PA-WS OS STEEL SINGLE DOOR - IMPACT INSTALLATION DETAILS			
ENGINEER	DATE	SIZE	DWG NO	REV	
TJH	07/06/10	B	08-01021	B	ITER
APPROVED	DATE	RELEASE STATE		SHEET	
RJA	10/17/23	FINAL		6 OF 8	
THIRD ANGLE PROJECTION		SCALE			
		NTS			

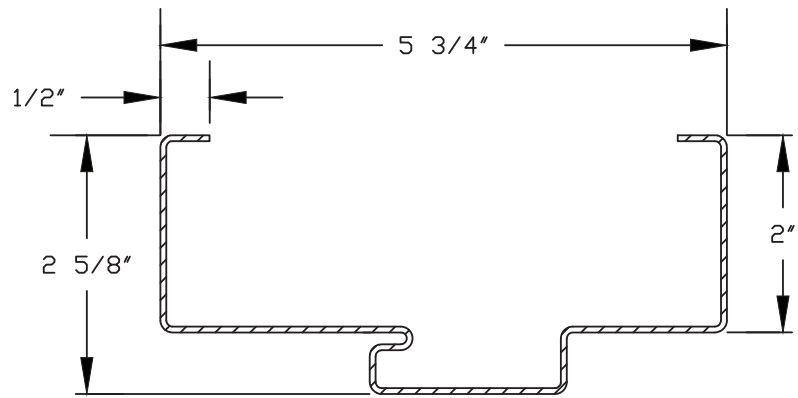

① TIOGA PA HINGE JAMB  
 ⑭ TIOGA PA STRIKE JAMB  
 16GA. GALVANNEALED  
 STEEL .053" MIN. THICK

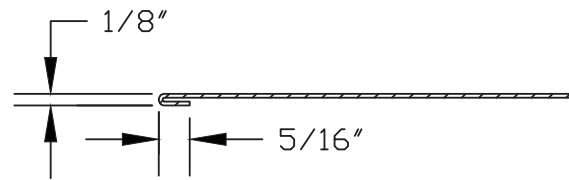

⑥ TIOGA TOP DOOR SKIN  
 20GA STEEL .036" MIN. THICK  
 LEFT END SHOWN, RIGHT END IS SIMILAR

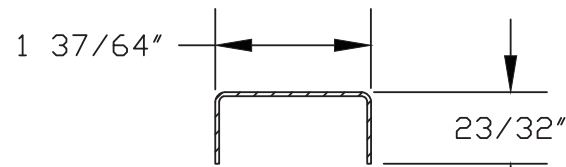

⑦ TOP CAP DOOR  
 CHANNEL  
 20GA GALVANNEALED  
 STEEL .036" MIN. THICK

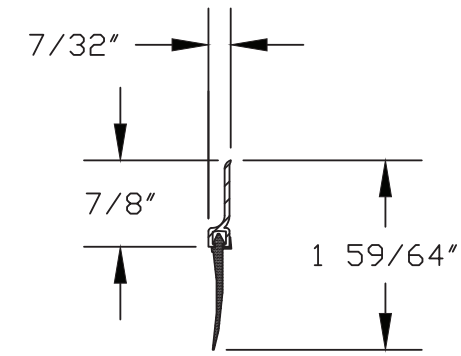

⑳ DOOR SWEEP  
 ALUMINUM 6063-T5.042" MIN. THICK  
 EPDM

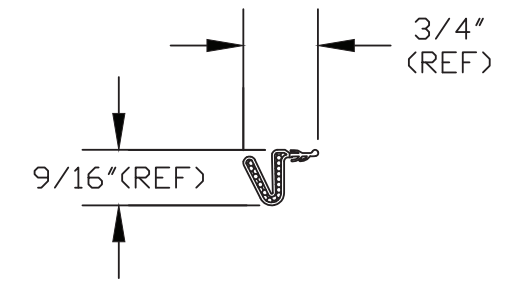

⑰ FRAME WEATHERSTRIPPING  
 FOAM

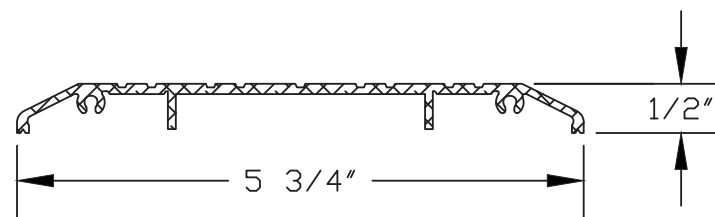

③ THRESHOLD 1/2" HIGH  
 ALUMINUM 6063-T5 .105" THICK

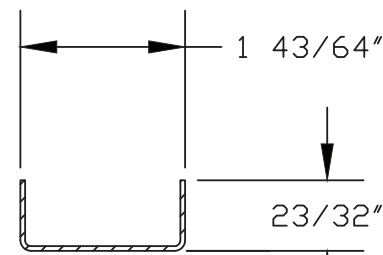

⑧ TOP DOOR CHANNEL  
 16GA GALVANNEALED  
 STEEL .053" MIN. THICK

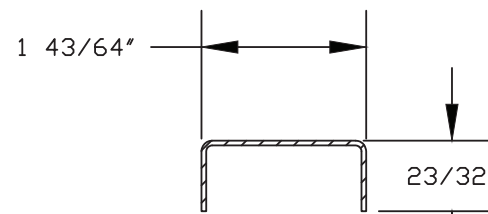

⑨ BOTTOM DOOR CHANNEL  
 16GA GALVANNEALED  
 STEEL .053" MIN. THICK

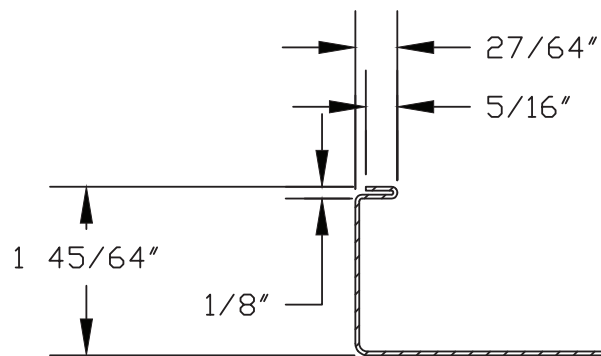

⑤ TIOGA BOTTOM DOOR SKIN  
 20GA GALVANNEALED STEEL .036" MIN. THICK  
 LEFT END SHOWN, RIGHT END IS SIMILAR

Robert J. Amoruso, P.E.  
 Florida P.E. No. 49752

PTC PRODUCT DESIGN GROUP, LLC  
 PO BOX 520775 | LONGWOOD, FLORIDA 32752  
 FBPE C.A. NO. 25935  
 Phone: 321.690.1788 | Email: info@ptc-corp.com

DRAFTER	DATE	TELL DOORS & WINDOWS, LLC. 6535 GUHN RD, STE 100, HOUSTON, TX 77040	
CHECKED	DATE	TITLE TIOGA DOORWAY SYSTEM TDS-S-PA-WS OS STEEL SINGLE DOOR - IMPACT COMPONENTS	
ENGINEER	DATE	SIZE B	DWG NO 08-01021
APPROVED	DATE	RELEASE STATE	REV ITER
TJH	07/06/10	FINAL	B
RJA	10/17/23	SCALE NTS	SHEET 7 OF 8
THIRD ANGLE PROJECTION			

TELL MFG

**Spectrum Brands** | Hardware & Home Improvement

TELL MANUFACTURING, INC.  
 18 RICHARD DRIVE, LITITZ, PA 17543

THIS DOCUMENT IS THE PROPERTY OF SPECTRUM BRANDS, INC AND/OR ITS AFFILIATES. THE CONTENTS OF THIS DOCUMENT ARE CONFIDENTIAL AND CONSTITUTE TRADE SECRETS PROPRIETARY TO SPECTRUM BRANDS. NEITHER THIS DOCUMENT NOR ITS CONTENTS SHALL BE DISCLOSED TO ANY UNAUTHORIZED PERSON, COPIED, OR PUBLISHED WITHOUT SPECTRUM BRANDS' PRIOR WRITTEN CONSENT.

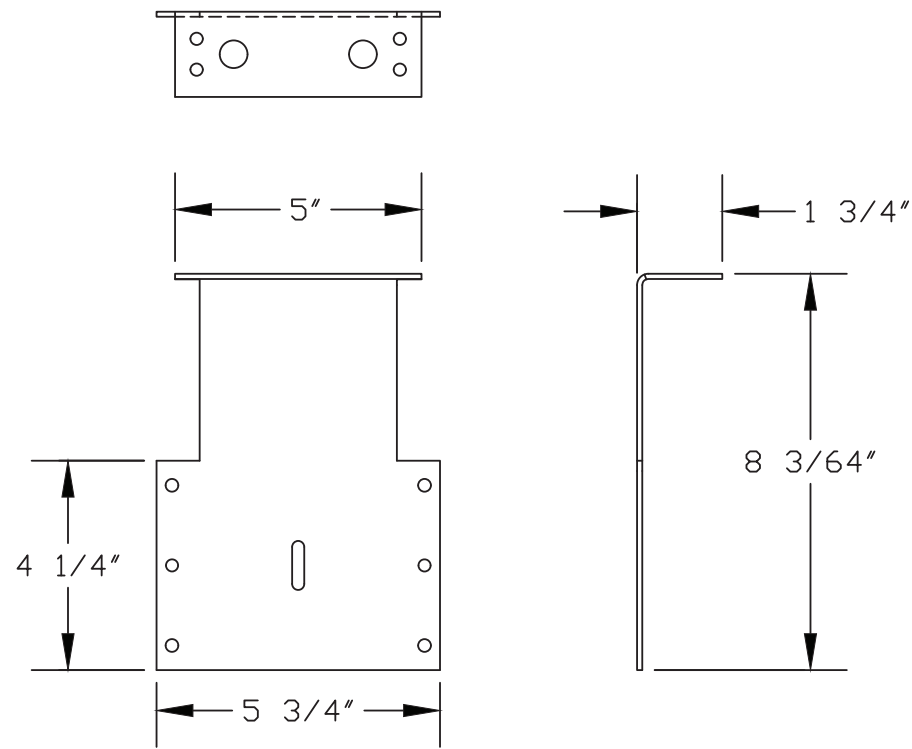

②③ TIOGA PA SUB JAMB CLIP  
12GA. GALVANNEALED STEEL .108" MIN. THICK

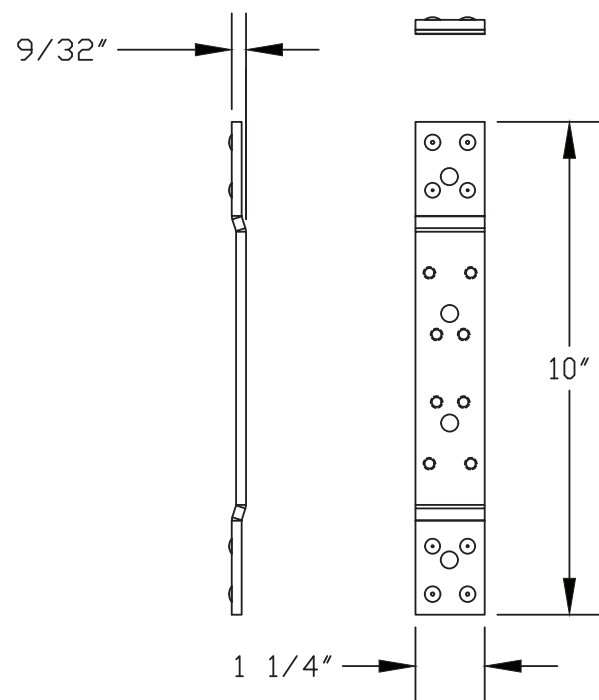

⑩ DOOR HINGE REINFORCEMENT  
10GA. GALVANNEALED STEEL .138" MIN. THICK

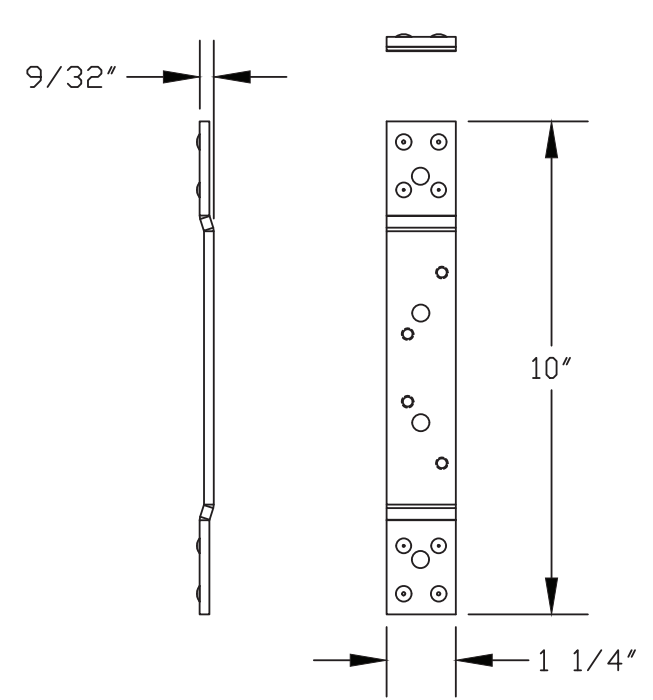

④ FRAME HINGE REINFORCEMENT  
10GA. GALVANNEALED STEEL .138" MIN. THICK

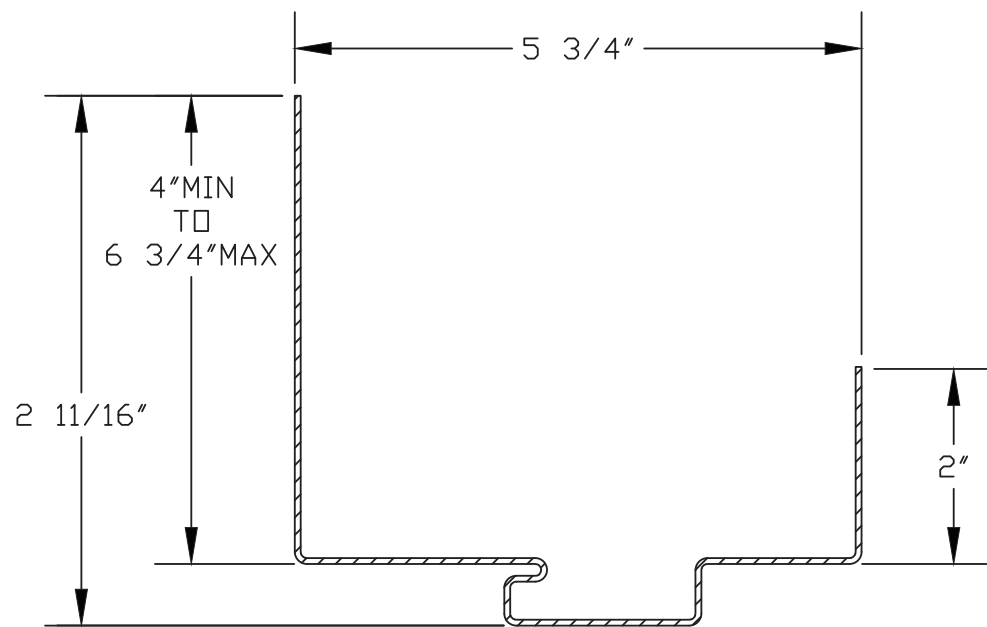

① TIOGA PA HEAD JAMB  
16GA. GALVANNEALED STEEL .053" MIN. THICK

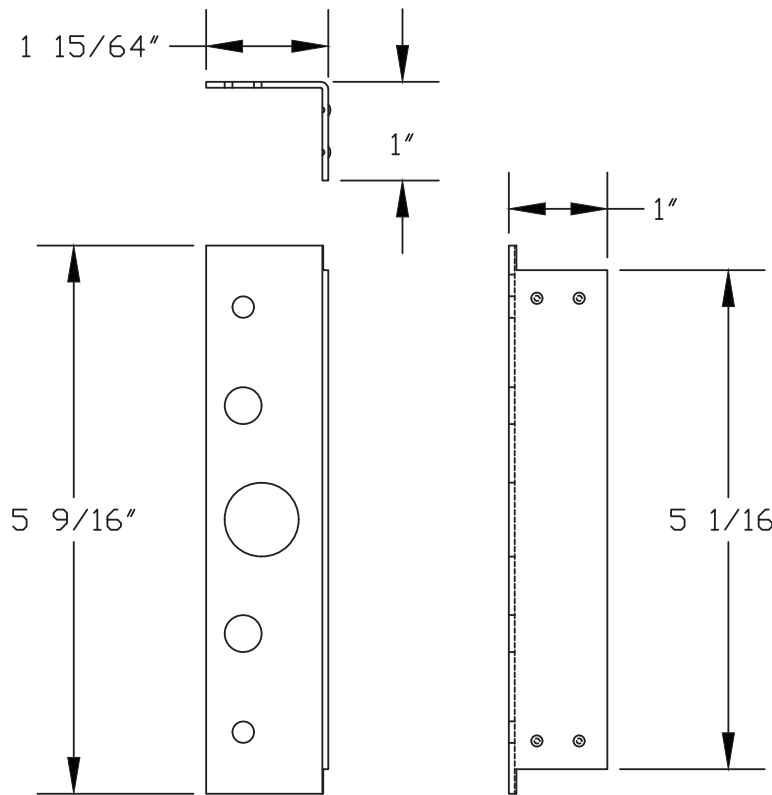

⑮ PA STRIKE JAMB CLIP  
⑯ PA HINGE JAMB CLIP  
12GA. GALVANNEALED STEEL .108" MIN. THICK

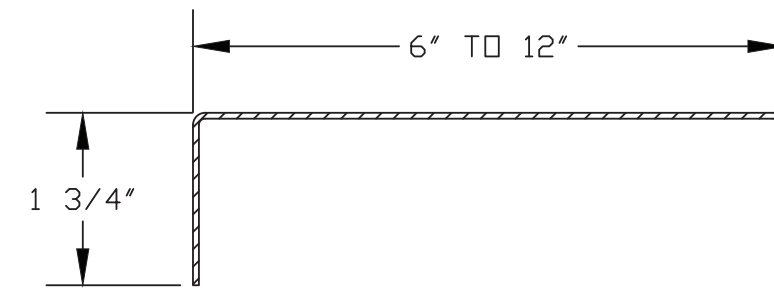

②② TIOGA PA SUB JAMB  
16GA. GALVANNEALED STEEL .053" MIN. THICK

Robert J. Amoruso, P.E.  
Florida P.E. No. 49752

PTC PRODUCT DESIGN GROUP, LLC  
PO BOX 520775 | LONGWOOD, FLORIDA 32752  
FBPE C.A. NO. 25935  
Phone: 321.690.1788 | Email: info@ptc-corp.com

DRAFTER	DATE	TELL DOORS & WINDOWS, LLC. 6535 GUHN RD, STE 100, HOUSTON, TX 77040	
CHECKED	DATE	TITLE TIOGA DOORWAY SYSTEM TDS-S-PA-WS STEEL SINGLE DOOR DS - IMPACT COMPONENTS	
ENGINEER	DATE	SIZE B	DWG NO 08-01021
APPROVED	DATE	RELEASE STATE	REV LITER
TJH	07/06/10	FINAL	B
RJA	10/17/23	SCALE NTS	SHEET 8 OF 8
THIRD ANGLE PROJECTION			

TELL MANUFACTURING, INC.  
18 RICHARD DRIVE, LITITZ, PA 17543

TELL MFG  
**Spectrum Brands** | Hardware & Home Improvement

THIS DOCUMENT IS THE PROPERTY OF SPECTRUM BRANDS, INC. AND/OR ITS AFFILIATES. THE CONTENTS OF THIS DOCUMENT ARE CONFIDENTIAL AND CONSTITUTE TRADE SECRETS PROPRIETARY TO SPECTRUM BRANDS. NEITHER THIS DOCUMENT NOR ITS CONTENTS SHALL BE DISCLOSED TO ANY UNAUTHORIZED PERSON, COPIED, OR PUBLISHED WITHOUT SPECTRUM BRANDS' PRIOR WRITTEN CONSENT.