

TIOGA DOORWAY SYSTEM TDS-S-KD-WS 16GA STEEL EXTERIOR VIEW

DESIGN PRESSURE RATING	IMPACT RATING
± 70.0PSF	LARGE AND SMALL MISSILE IMPACT
THIS SYSTEM WAS NOT TESTED FOR WATER INFILTRATION AND IS TO BE INSTALLED ONLY WHERE THE WATER REQUIREMENT IS NOT NEEDED	

NOTES:

- 1) THE PRODUCT SHOWN HEREIN IS DESIGNED AND MANUFACTURED TO COMPLY WITH REQUIREMENTS OF THE FLORIDA BUILDING CODE INCLUDING THE HVHZ.
- 2) STEEL FRAMING AND CONCRETE OPENING TO BE DESIGNED AND ANCHORED TO PROPERLY TRANSFER ALL LOADS TO STRUCTURE. FRAMING AND CONCRETE OPENING IS THE RESPONSIBILITY OF THE ARCHITECT OR ENGINEER OF RECORD.
- 3) BUILDING GIRT AND OPTIONAL INTERMEDIATE BUILDING GIRT TO BE DESIGNED AND ANCHORED TO PROPERLY TRANSFER ALL LOADS TO STRUCTURE. BUILDING GIRT AND OPTIONAL INTERMEDIATE GIRT ARE THE RESPONSIBILITY OF THE ARCHITECT OR ENGINEER OF RECORD.
- 4) ALLOWABLE STRESS INCREASE OF 1/3 WAS NOT USED IN THE DESIGN OF THE PRODUCT SHOWN HEREIN. WIND LOAD DURATION FACTOR Cd=1.6 WAS USED FOR WOOD ANCHOR CALCULATIONS.
- 5) FRAME AND DOOR PANEL MATERIAL: FORMED 16GA. (.053" MIN.) GALVANNEALED STEEL.
- 6) APPROVED IMPACT PROTECTIVE SYSTEM IS NOT REQUIRED FOR THIS PRODUCT IN WIND BORNE DEBRIS REGIONS.
- 7) EACH PANEL IS FITTED WITH THREE HINGES LOCATED AT 6" MINIMUM UP TO 10" MAXIMUM FROM EACH END WITH ONE AT PANEL MIDSPAN.

HARDWARE SCHEDULE

A. ML 1300 MORTISE LOCK BY TELL MANUFACTURING, INC.
B. (3) STEEL HINGES H4545BBNRP BY TELL MANUFACTURING, INC.
C. ALUMINUM THRESHOLD 1/2" HIGH.

TABLE OF CONTENTS

SHEET NO	DESCRIPTION
1	ELEVATION, ANCHORING LAYOUT AND NOTES
2	DETAILS AND NOTES
3	BILL OF MATERIALS AND CROSS SECTION
4	CROSS SECTION
5 - 6	INSTALLATION DETAILS
7 - 8	COMPONENTS

Robert J. Amoruso, P.E.
Florida P.E. No. 49752



PTC PRODUCT DESIGN GROUP, LLC
PO BOX 520775 | LONGWOOD, FLORIDA 32752
FBPE C.A. NO. 25935
Phone: 321.690.1788 | Email: info@ptc-corp.com

DRAFTER	V.L.	DATE	6/22/16	TELL DOORS & WINDOWS, LLC. 6535 GUHN RD, STE 100, HOUSTON, TX 77040	
CHECKED		DATE		TITLE	
ENGINEER		DATE		TIOGA DOORWAY SYSTEM TDS-S-KD-WS DS 16GA STEEL SINGLE DOOR - IMPACT ELEVATION, ANCHORING LAYOUT AND NOTES	
APPROVED	RJA	DATE	10/17/23	SIZE	B
THIRD ANGLE PROJECTION			DWG NO	08-01999	
				RELEASE STATE	-
				SCALE	NTS
				SHEET	1 OF 8



TELL MANUFACTURING, INC.
18 RICHARD DRIVE, LITITZ, PA 17543

THIS DOCUMENT IS THE PROPERTY OF SPECTRUM BRANDS, INC. AND/OR ITS AFFILIATES. THE CONTENTS OF THIS DOCUMENT ARE CONFIDENTIAL AND CONSTITUTE TRADE SECRETS PROPRIETARY TO SPECTRUM BRANDS. NEITHER THIS DOCUMENT NOR ITS CONTENTS SHALL BE DISCLOSED TO ANY UNAUTHORIZED PERSON, COPIED, OR PUBLISHED WITHOUT SPECTRUM BRANDS' PRIOR WRITTEN CONSENT.

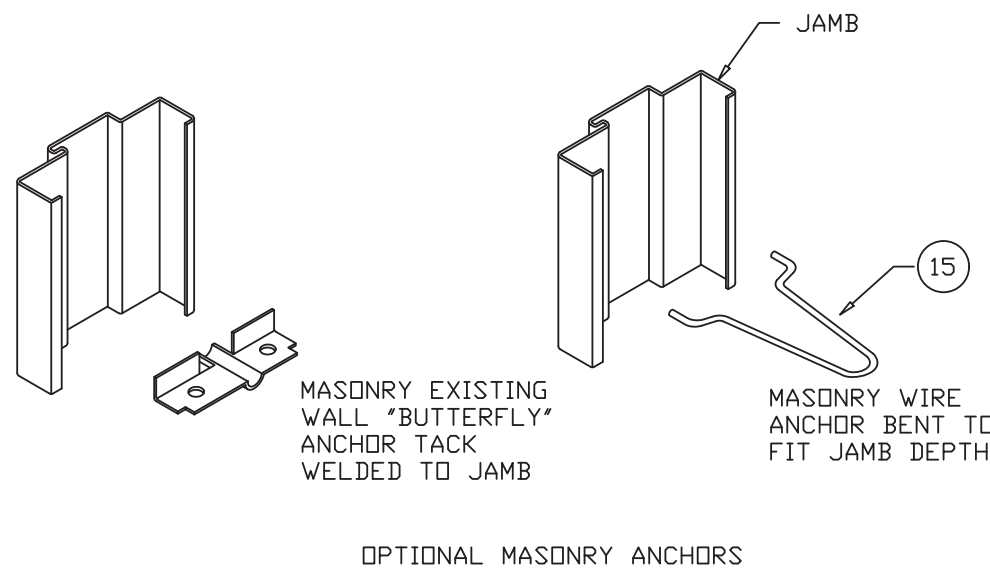
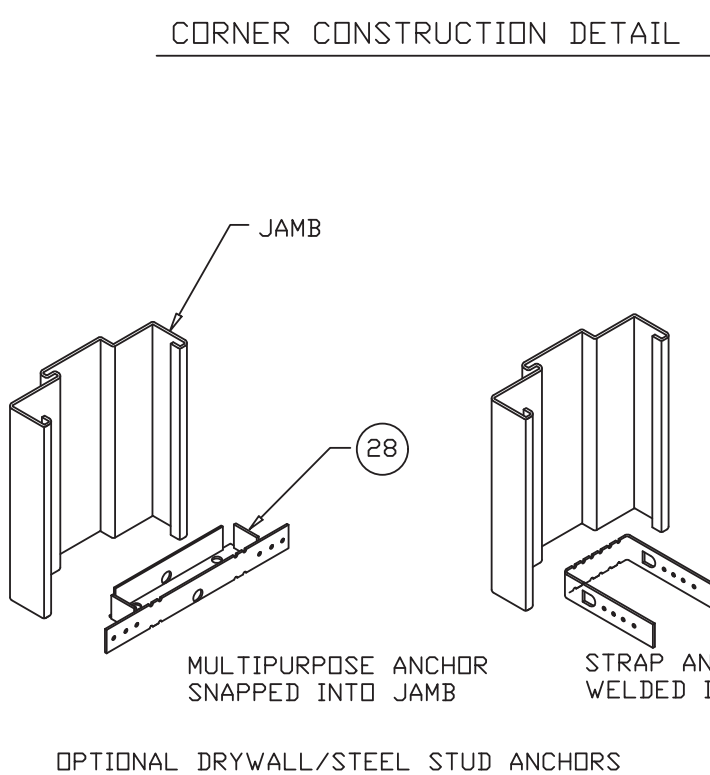
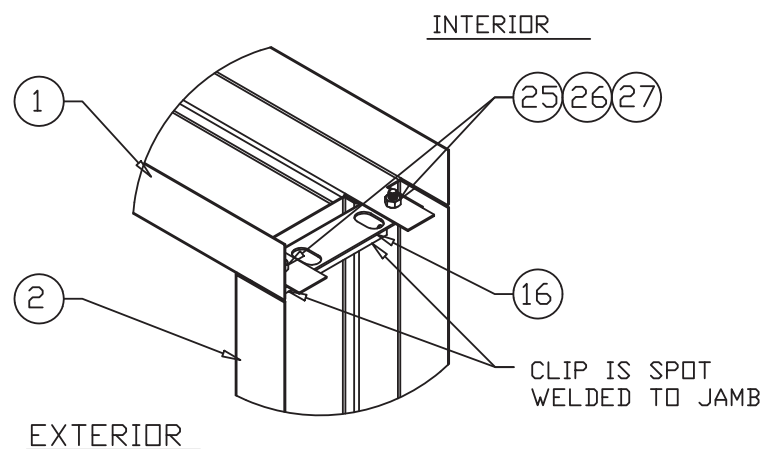
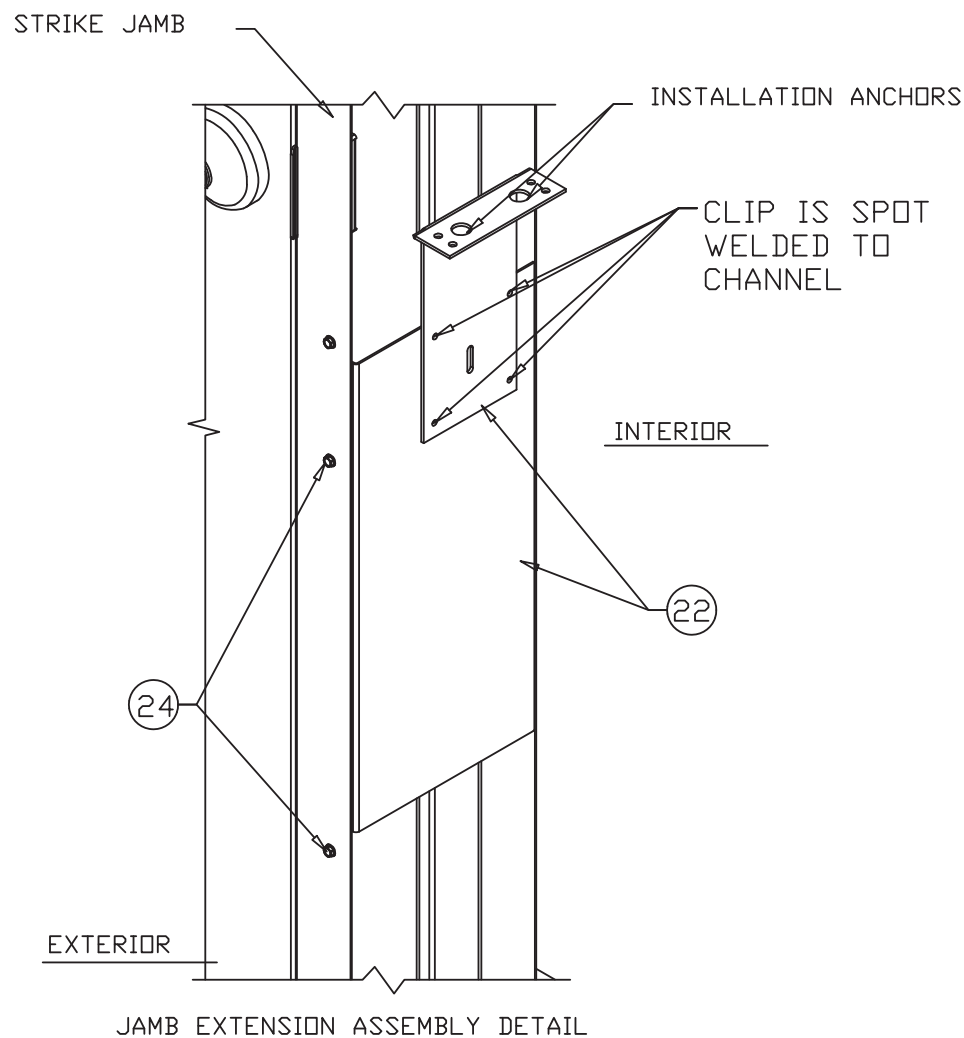
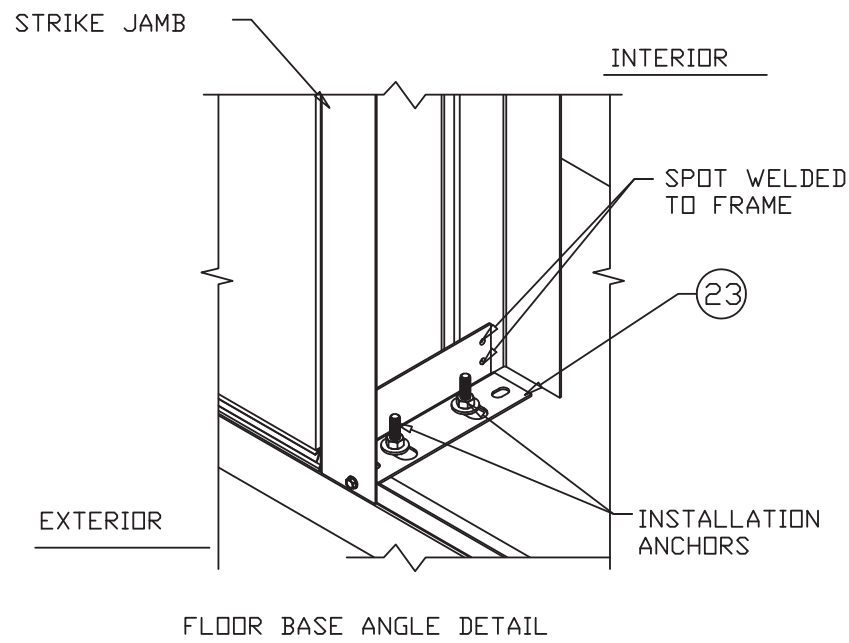

- NOTES:
- FOR ANCHORING JAMB EXTENSION ASSEMBLY TO 16GA. (.060" MIN.) STEEL FRAMING USE 5/16"-18 BOLT WITH 5/16"-18 NUT. BOLT TO BE OF SUFFICIENT LENGTH TO ACHIEVE 3-THREADS MINIMUM BEYOND NUT. LOCATE ANCHORS AS SHOWN IN ELEVATIONS AND INSTALLATION DETAILS.
 - FOR ANCHORING OPTIONAL INSTALLATION ANCHORS TO 16GA. (.060" MIN.) STEEL FRAMING USE EQUIVALENT OR BETTER OF:
 - 5/16" SELF TAPPING SCREWS, OR
 - #12 SELF DRILLING SCREWS.
 - BOTH OF SUFFICIENT LENGTH TO ACHIEVE 3-THREADS MINIMUM BEYOND ANCHOR CHANNELS.
 - LOCATE ANCHORS AS SHOWN IN ELEVATIONS AND INSTALLATION DETAILS. SEE NOTE SHEET 6.
 - FOR ANCHORING FLOOR BASE ANGLE INTO CONCRETE USE EQUIVALENT OR BETTER OF:
 - 3/8" EXPANSION BOLT OF SUFFICIENT LENGTH TO ACHIEVE 2 1/2" MINIMUM EMBEDMENT INTO CONCRETE WITH 4 1/2" MINIMUM EDGE DISTANCE, OR
 - 5/16" ITW TAPCON OF SUFFICIENT LENGTH TO ACHIEVE 1 3/4" MINIMUM EMBEDMENT INTO CONCRETE WITH 3 3/16" MINIMUM EDGE DISTANCE.
 - LOCATE ALL ANCHORS AS SHOWN IN ELEVATIONS AND INSTALLATION DETAILS.
 - FOR ANCHORING THRESHOLD INTO CONCRETE USE 3/16" ITW TAPCONS WITH SUFFICIENT LENGTH TO ACHIEVE A 1 3/4" MINIMUM EMBEDMENT INTO SUBSTRATE WITH 2 1/4" MINIMUM EDGE DISTANCE. LOCATE ANCHORS AS SHOWN IN ELEVATIONS AND INSTALLATION DETAILS.
 - FOR ANCHORING JAMB EXTENSION ASSEMBLY, FLOOR BASE ANGLE, OPTIONAL Z-CLIP ANCHOR CHANNEL OR OPTIONAL HI-HAT ANCHOR CHANNEL TO WOOD SUBSTRATE USE 5/16" LAG SCREW WITH MINIMUM EMBEDMENT OF 1-3/4", MINIMUM EDGE DISTANCE OF 1-1/4" AND MINIMUM SPACING OF 1-1/4". LOCATE ANCHORS AS SHOWN IN ELEVATIONS AND INSTALLATION DETAILS.
 - WASHERS SHALL BE USED WHEN ANCHORS ARE INSTALLED IN OVERSIZE HOLES (CLIP HOLE DIAMETER 1/16" GREATER DIAMETER THAN ANCHOR DIAMETER).
 - MINIMUM 2 ANCHORS PER JAMB EXTENSION ASSEMBLY, FLOOR BASE ANGLE, OPTIONAL Z-CLIP ANCHOR CHANNEL OR OPTIONAL HI-HAT ANCHOR CHANNEL FOR ATTACHMENT TO SUPPORTING SUBSTRATE.
 - ALL FASTENERS TO BE CORROSION RESISTANT.
 - INSTALLATION ANCHORS SHALL BE INSTALLED IN ACCORDANCE WITH ANCHOR MANUFACTURER'S INSTALLATION INSTRUCTIONS, AND ANCHORS SHALL NOT BE USED IN SUBSTRATES WITH STRENGTHS LESS THAN THE MINIMUM STRENGTH SPECIFIED BELOW, A. WOOD - MINIMUM SPECIFIC GRAVITY OF G=0.42 (NON-HVHZ) AND G=0.55 (HVHZ). B. CONCRETE - MINIMUM COMPRESSIVE STRENGTH 3,192 PSI. C. STEEL FRAMING, 16GA. (.060" MIN.)

Robert J. Amoruso, P.E.
Florida P.E. No. 49752

PTC PRODUCT DESIGN GROUP, LLC
PO BOX 520775 | LONGWOOD, FLORIDA 32752
FBPE C.A. NO. 25935
Phone: 321.690.1788 | Email: info@ptc-corp.com

TELL MANUFACTURING, INC.
18 RICHARD DRIVE, LITITZ, PA 17543

DRAFTER	DATE	TELL DOORS & WINDOWS, LLC. 6535 GUHN RD, STE 100, HOUSTON, TX 77040			
CHECKED	DATE	TITLE TIOGA DOORWAY SYSTEM TDS-S-KD-WS DS 16GA STEEL SINGLE DOOR - IMPACT DETAILS AND NOTES			
ENGINEER	DATE	SIZE	DWG NO		
V.L.	04/30/13	B	08-01999		
APPROVED	DATE	RELEASE STATE	FINAL		
RJA	10/17/23	SCALE	NTS		
THIRD ANGLE PROJECTION		SHEET		2 OF 8	

TELL MFG

Spectrum Brands | Hardware & Home Improvement

THIS DOCUMENT IS THE PROPERTY OF SPECTRUM BRANDS, INC. AND/OR ITS AFFILIATES. THE CONTENTS OF THIS DOCUMENT ARE CONFIDENTIAL AND CONSTITUTE TRADE SECRETS PROPRIETARY TO SPECTRUM BRANDS. NEITHER THIS DOCUMENT NOR ITS CONTENTS SHALL BE DISCLOSED TO ANY UNAUTHORIZED PERSON, COPIED, OR PUBLISHED WITHOUT SPECTRUM BRANDS' PRIOR WRITTEN CONSENT.

PARTS LIST

NO.	PART NO.	DESCRIPTION	QTY	MATERIAL
1		TIOGA KD HEAD JAMB 16GA.	1	GALVANNEALED STEEL
2		TIOGA KD HINGE JAMB 16GA.	1	GALVANNEALED STEEL
3		THESHOLD, 1/2" HIGH	1	ALUMINUM 6063-T5
4		FRAME HINGE REINFORCEMENT 7GA.	1	GALVANNEALED STEEL
5		TIOGA BOTTOM DOOR SKIN 16GA.	1	GALVANNEALED STEEL
6		TIOGA TOP DOOR SKIN 16GA.	1	GALVANNEALED STEEL
7		TOP CAP DOOR CHANNEL 18GA.	1	GALVANNEALED STEEL
8		TOP DOOR CHANNEL 18GA.	1	GALVANNEALED STEEL
9		BOTTOM DOOR CHANNEL 18GA.	1	GALVANNEALED STEEL
10		DOOR HINGE REINFORCEMENT 10GA.	1	GALVANNEALED STEEL
11		DOOR FOAM CORE 1 LB ³ /FT DENSITY	1	POLYSIYRENE
12		DOOR CLOSER REINFORCEMENT 12GA.	1	GALVANNEALED STEEL
13		MORTISE LOCK REINFORCEMENT 14GA.	1	GALVANNEALED STEEL
14		TIOGA KD STRIKE JAMB 16GA.	1	GALVANNEALED STEEL
15		HI HAT ANCHOR CHANNEL 16GA.	1	GALVANNEALED STEEL
16		HINGE JAMB CLIP 12GA	1	GALVANNEALED STEEL
17		FRAME WEATHERSTRIPPING	1	FOAM
18		HINGES - H4545BBNRP SERIES	1	STEEL
19		MORTISE LOCK ML 1300	1	STEEL
20		STRIKE JAMB CUP 12GA.	1	GALVANNEALED STEEL
21		DOOR SWEEP, DT100101	1	ALUMINUM 6063-T5
22		JAMB EXTENSION ASSEMBLY 16 / 12GA	1	GALVANNEALED STEEL
23		FLOOR BASE ANGLE	1	GALVANNEALED STEEL
24		#12-24 X 1 1/4" HEX HEAD TEK	1	STEEL
25		5/16"-18 X 3/4" HEX CAP SCREW	1	STEEL
26		HEX NUT 5/16"	1	STEEL
27		FLAT WASHER 5/16"	1	STEEL
28		Z-CLIP ANCHOR CHANNEL 16GA.	1	STEEL
29		#14 X 1/2" PFH SMS	1	STEEL

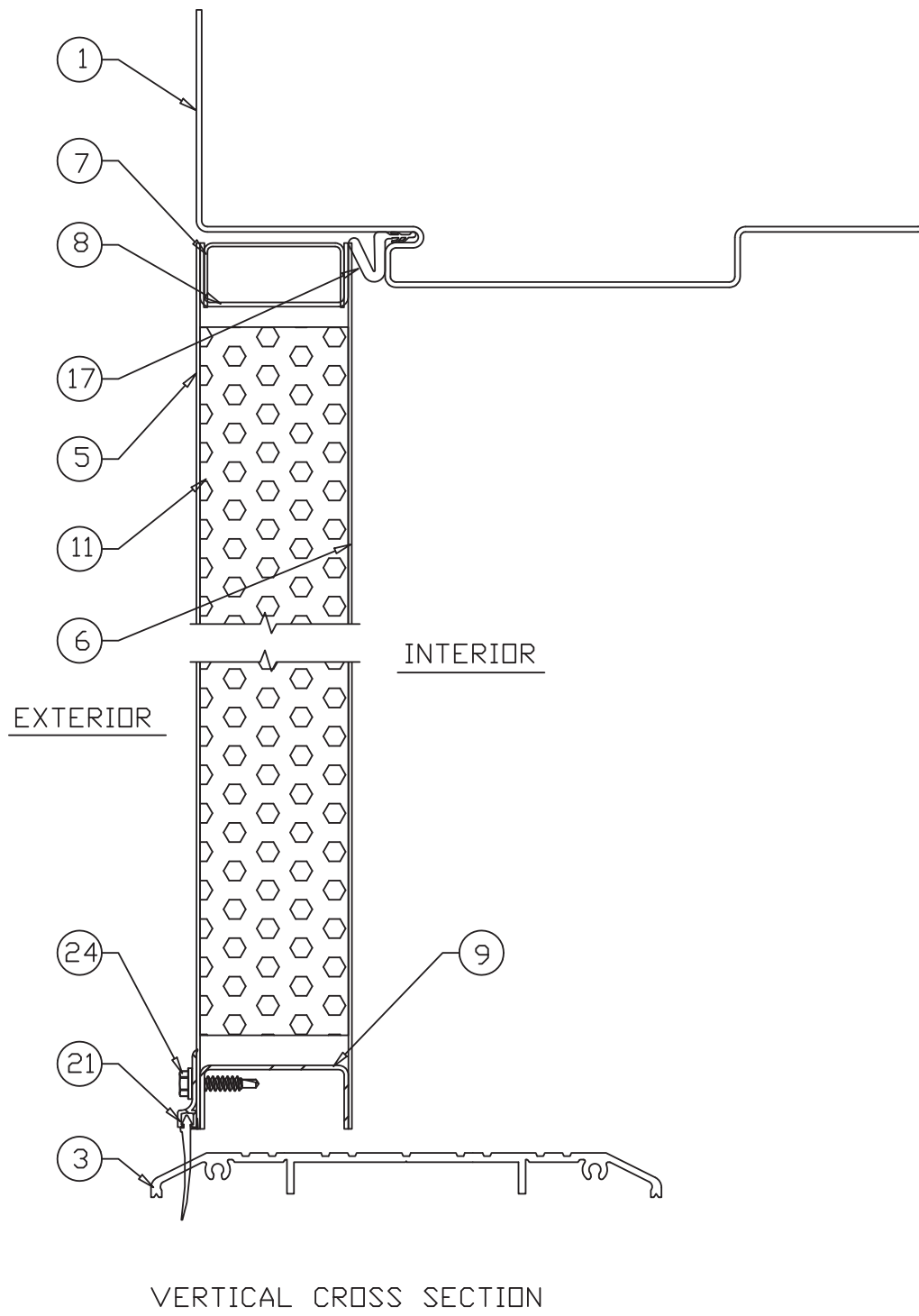

Robert J. Amoruso, P.E.
 Florida P.E. No. 49752

PTC PRODUCT DESIGN GROUP, LLC
 PO BOX 520775 | LONGWOOD, FLORIDA 32752
 FBPE C.A. NO. 25935
 Phone: 321.690.1788 | Email: info@ptc-corp.com

TELL MANUFACTURING, INC.
 18 RICHARD DRIVE, LITITZ, PA 17543

TELL MFG
Spectrum Brands | Hardware & Home Improvement

THIS DOCUMENT IS THE PROPERTY OF SPECTRUM BRANDS, INC AND/OR ITS AFFILIATES. THE CONTENTS OF THIS DOCUMENT ARE CONFIDENTIAL AND CONSTITUTE TRADE SECRETS PROPRIETARY TO SPECTRUM BRANDS. NEITHER THIS DOCUMENT NOR ITS CONTENTS SHALL BE DISCLOSED TO ANY UNAUTHORIZED PERSON, COPIED, OR PUBLISHED WITHOUT SPECTRUM BRANDS' PRIOR WRITTEN CONSENT.

DRAFTER	DATE	TELL DOORS & WINDOWS, LLC. 6535 GUHN RD, STE 100, HOUSTON, TX 77040	
CHECKED	DATE	TITLE TIOGA DOORWAY SYSTEM TDS-S-KD-WS DS 16GA STEEL SINGLE DOOR - IMPACT BILL OF MATERIALS AND CROSS SECTION	
ENGINEER	DATE	SIZE	DWG NO
V.L.	04/30/13	B	08-01999
APPROVED	DATE	RELEASE STATE	REV
RJA	10/17/23	FINAL	B
THIRD ANGLE PROJECTION		SCALE	SHEET
		NTS	3 OF 8

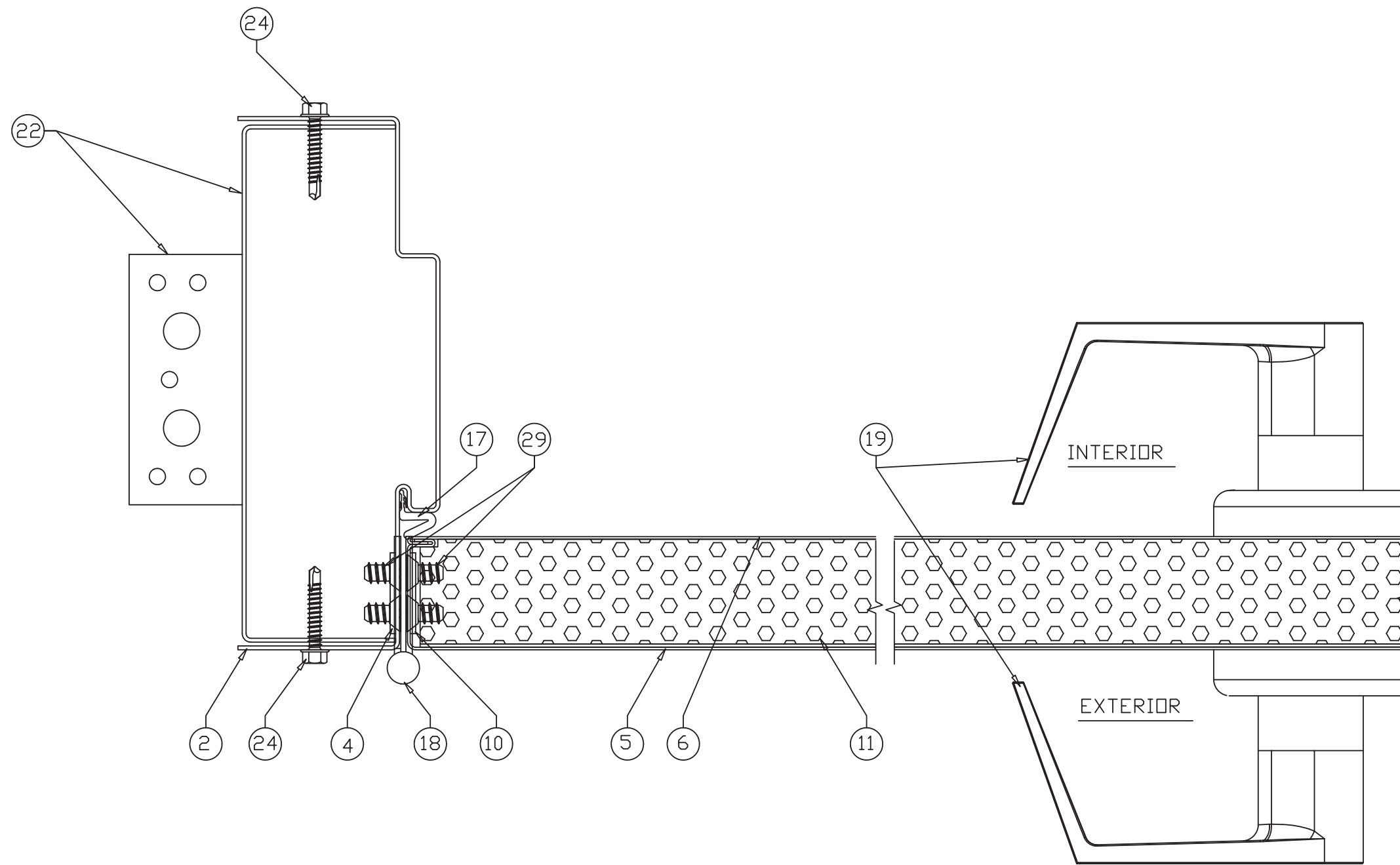

HORIZONTAL CROSS SECTION

Robert J. Amoruso, P.E.
 Florida P.E. No. 49752

PTC PRODUCT DESIGN GROUP, LLC
 PO BOX 520775 | LONGWOOD, FLORIDA 32752
 FBPE C.A. NO. 25935
 Phone: 321.690.1788 | Email: info@ptc-corp.com

TELL MANUFACTURING, INC.
 18 RICHARD DRIVE, LITITZ, PA 17543

TELL MFG
Spectrum Brands | Hardware & Home Improvement

THIS DOCUMENT IS THE PROPERTY OF SPECTRUM BRANDS, INC AND/OR ITS AFFILIATES. THE CONTENTS OF THIS DOCUMENT ARE CONFIDENTIAL AND CONSTITUTE TRADE SECRETS PROPRIETARY TO SPECTRUM BRANDS. NEITHER THIS DOCUMENT NOR ITS CONTENTS SHALL BE DISCLOSED TO ANY UNAUTHORIZED PERSON, COPIED, OR PUBLISHED WITHOUT SPECTRUM BRANDS' PRIOR WRITTEN CONSENT.

DRAFTER	DATE	TELL DOORS & WINDOWS, LLC. 6535 GUHN RD, STE 100, HOUSTON, TX 77040	
CHECKED	DATE	TITLE TIIGA DOORWAY SYSTEM TDS-S-KD-WS QS 16GA STEEL SINGLE DOOR - IMPACT CROSS SECTION	
ENGINEER V.L.	DATE 6/22/16	SIZE B	DWG NO 08-01999
APPROVED RJA	DATE 10/17/23	RELEASE STATE FINAL	
THIRD ANGLE PROJECTION 		SCALE NTS	REV B
		SHEET 4 OF 8	

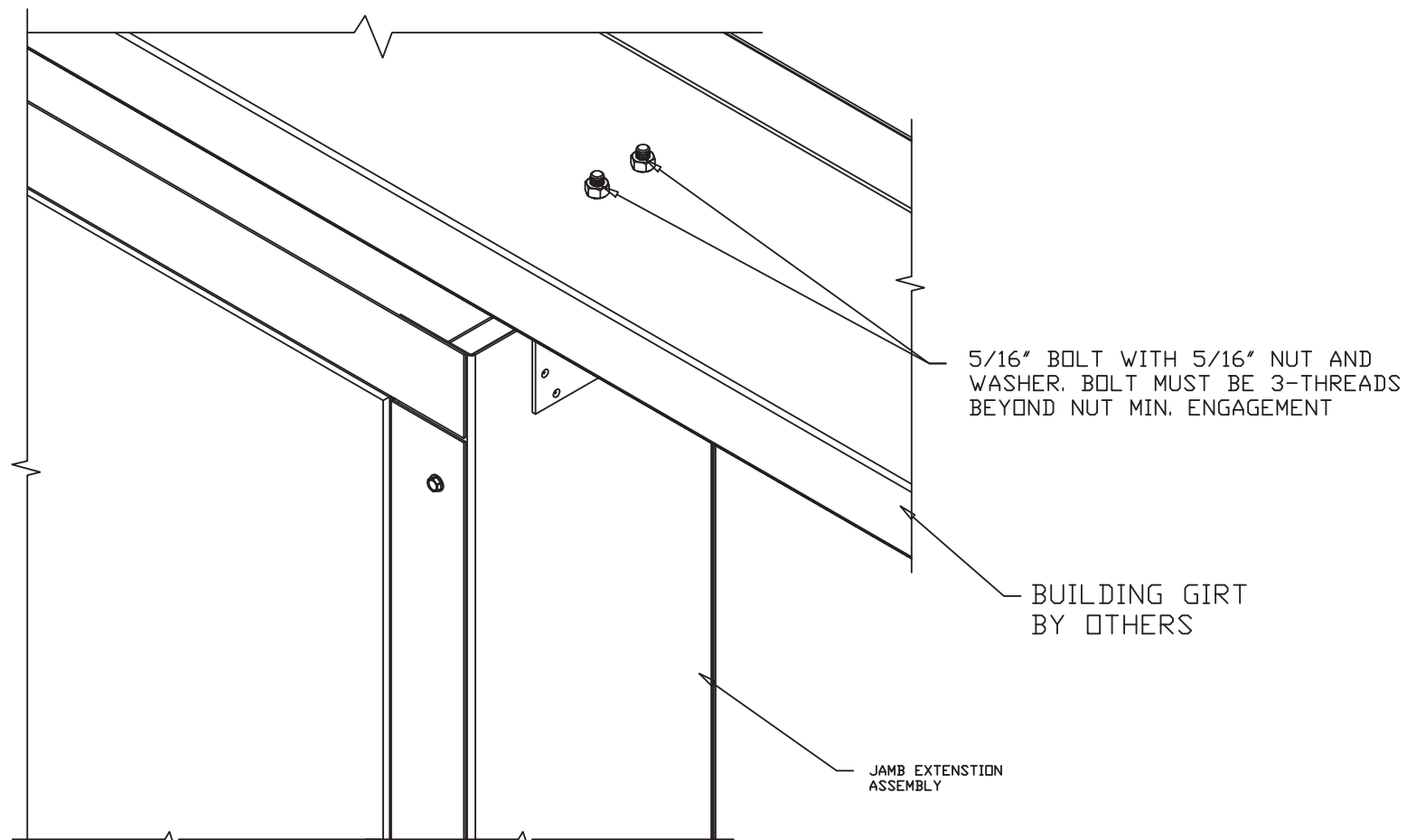

5/16" BOLT WITH 5/16" NUT AND WASHER. BOLT MUST BE 3-THREADS BEYOND NUT MIN. ENGAGEMENT

BUILDING GIRT BY OTHERS

JAMB EXTENSION ASSEMBLY

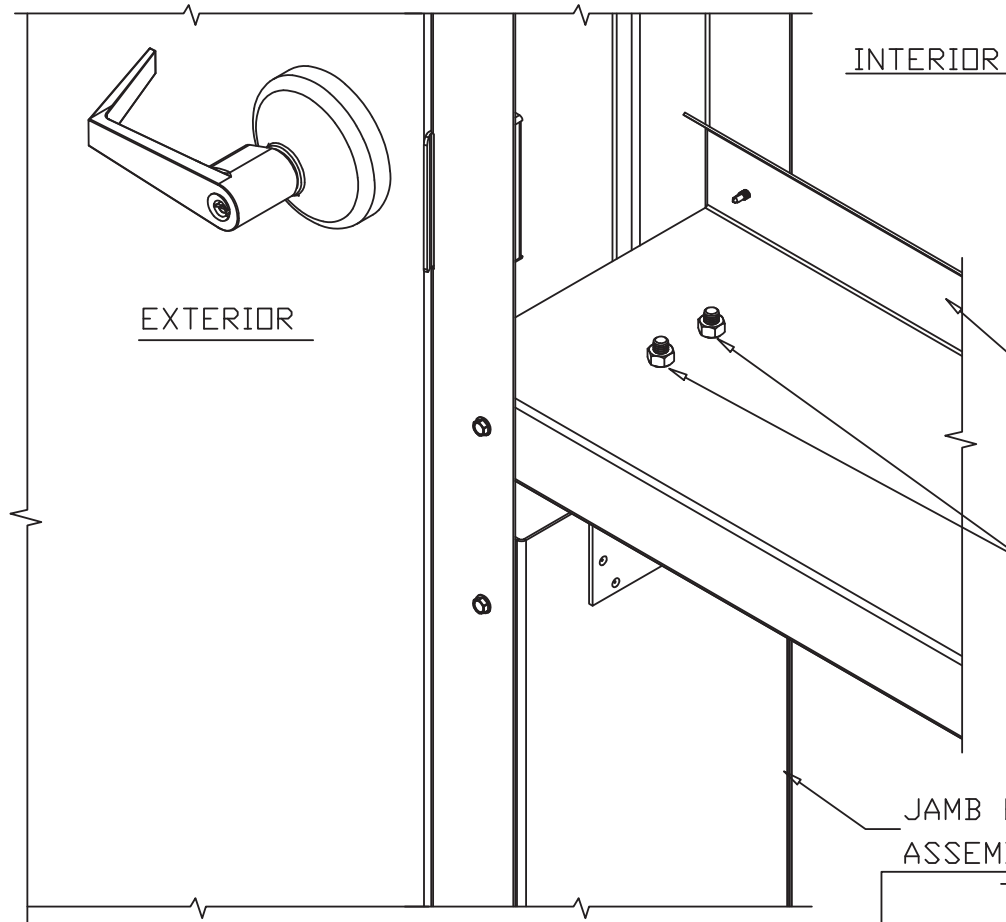

INTERIOR

OPTIONAL BUILDING INTERMEDIATE GIRT BY OTHERS

5/16" BOLT WITH 5/16" NUT AND WASHER. BOLT MUST BE 3-THREADS BEYOND NUT MIN. ENGAGEMENT

JAMB EXTENSION ASSEMBLY

TELL MANUFACTURING, INC.
18 RICHARD DRIVE, LITITZ, PA 17543

VERTICAL CROSS SECTION
JAMB EXTENSION ASSEMBLY TO METAL BUILDING INSTALLATION



THIS DOCUMENT IS THE PROPERTY OF SPECTRUM BRANDS, INC AND/OR ITS AFFILIATES. THE CONTENTS OF THIS DOCUMENT ARE CONFIDENTIAL AND CONSTITUTE TRADE SECRETS PROPRIETARY TO SPECTRUM BRANDS. NEITHER THIS DOCUMENT NOR ITS CONTENTS SHALL BE DISCLOSED TO ANY UNAUTHORIZED PERSON, COPIED, OR PUBLISHED WITHOUT SPECTRUM BRANDS' PRIOR WRITTEN CONSENT.

Robert J. Amoruso, P.E.
Florida P.E. No. 49752

PTC PRODUCT DESIGN GROUP, LLC
PO BOX 520775 | LONGWOOD, FLORIDA 32752
FBPE C.A. NO. 25935
Phone: 321.690.1788 | Email: info@ptc-corp.com

DRAFTER	DATE	TELL DOORS & WINDOWS, LLC. 6535 GUHN RD, STE 100, HOUSTON, TX 77040	
CHECKED	DATE	TITLE TIOGA DOORWAY SYSTEM TDS-S-KD-WS OS 16GA STEEL SINGLE DOOR - IMPACT INSTALLATION DETAILS	
ENGINEER	DATE	SIZE B	DWG NO 08-01999
APPROVED	DATE	RELEASE STATE	REV ITER
V.L.	6/22/16	FINAL	B
RJA	10/17/23	SCALE NTS	SHEET 5 OF 8
THIRD ANGLE PROJECTION 			

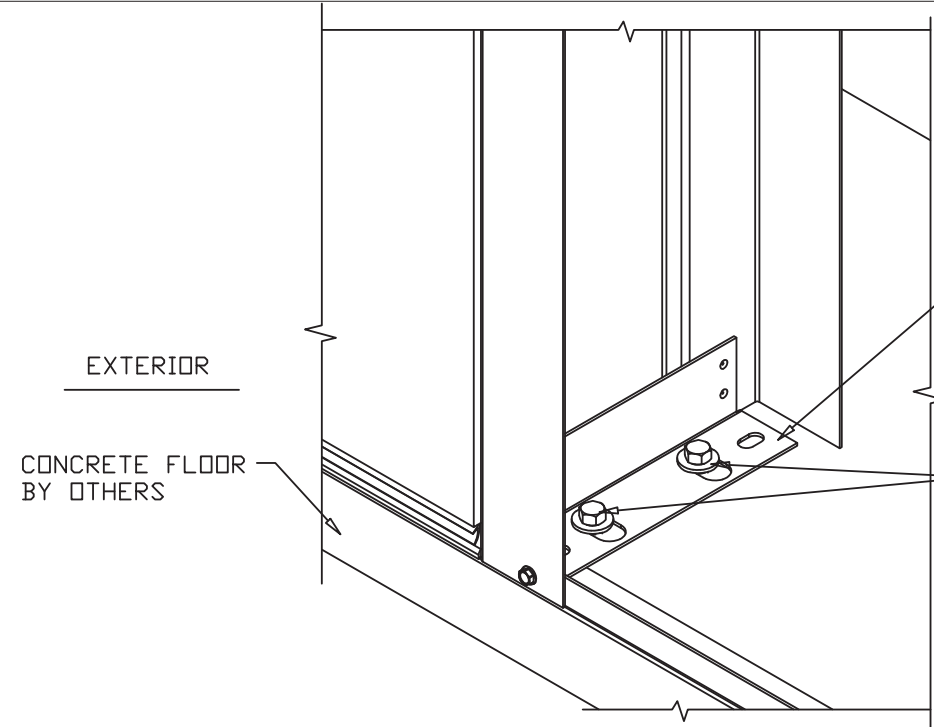

INTERIOR

FLOOR BASE ANGLE

5/16" ILW TAPCON WITH 1 3/4" MIN. EMBEDMENT INTO CONCRETE AND 3 3/16" MIN. EDGE DIST. OR VERTICAL CROSS SECTION FLOOR BASE ANGLE TO 3/8" WEDGE BOLT ANCHOR WITH 2" MIN. EMBEDMENT INTO CONCRETE AND 4 1/2" MINIMUM EDGE DISTANCE

VERTICAL CROSS SECTION

FLOOR BASE ANGLE TO CONCRETE FLOOR INSTALLATION

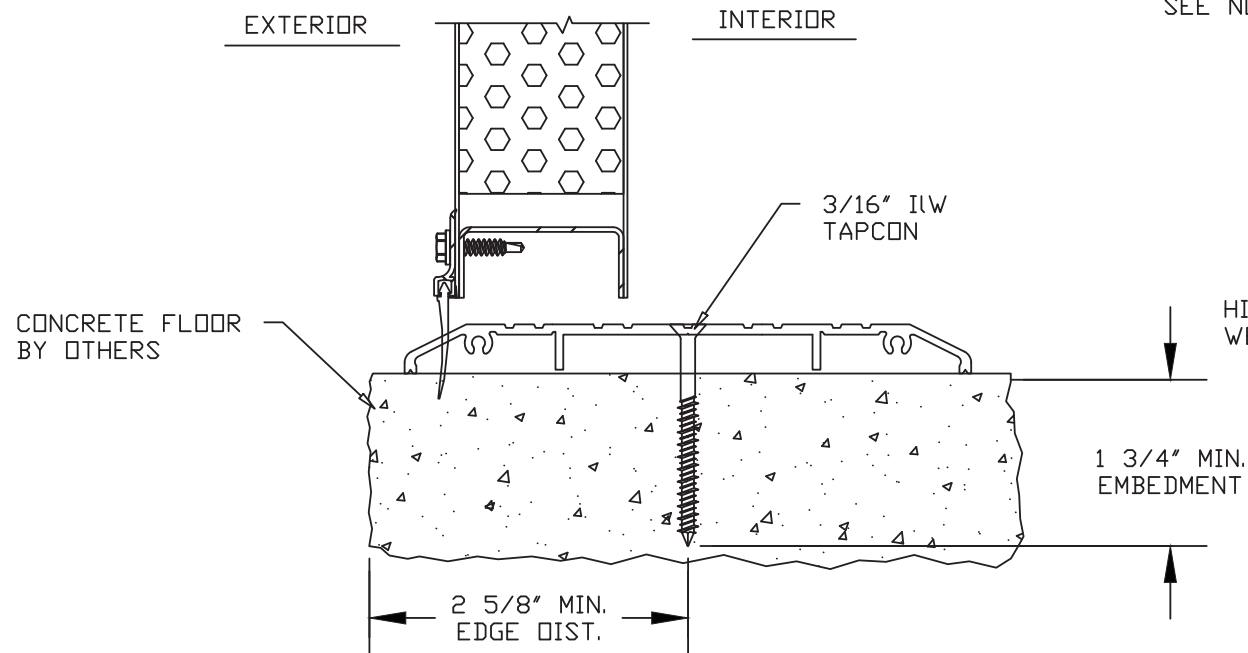

VERTICAL CROSS SECTION

SILL TO CONCRETE FLOOR INSTALLATION

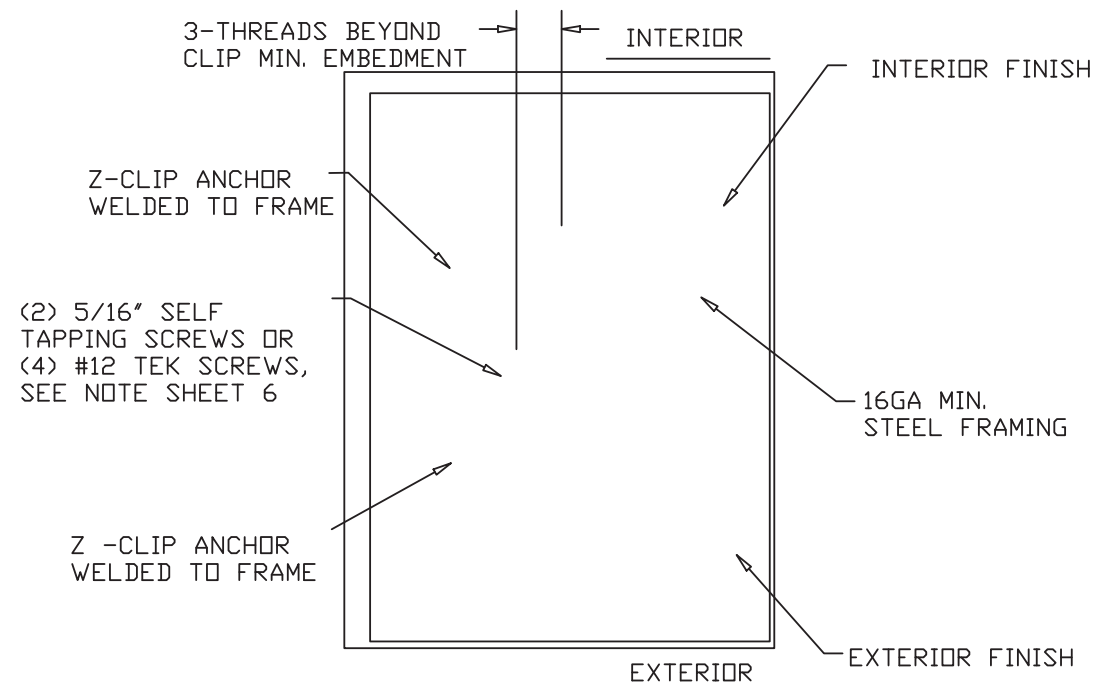

HORIZONTAL CROSS SECTION

OPTIONAL Z-CLIP ANCHOR CHANNEL INSTALLATION

NOTE, HI-HAT AND Z-CLIP ANCHOR CHANNELS MUST BE INSTALLED USING EITHER (2) 5/16" SELF TAPPING SCREWS OR (4) #12 TEK SCREWS EITHER SIDE BY SIDE OR STACKED.

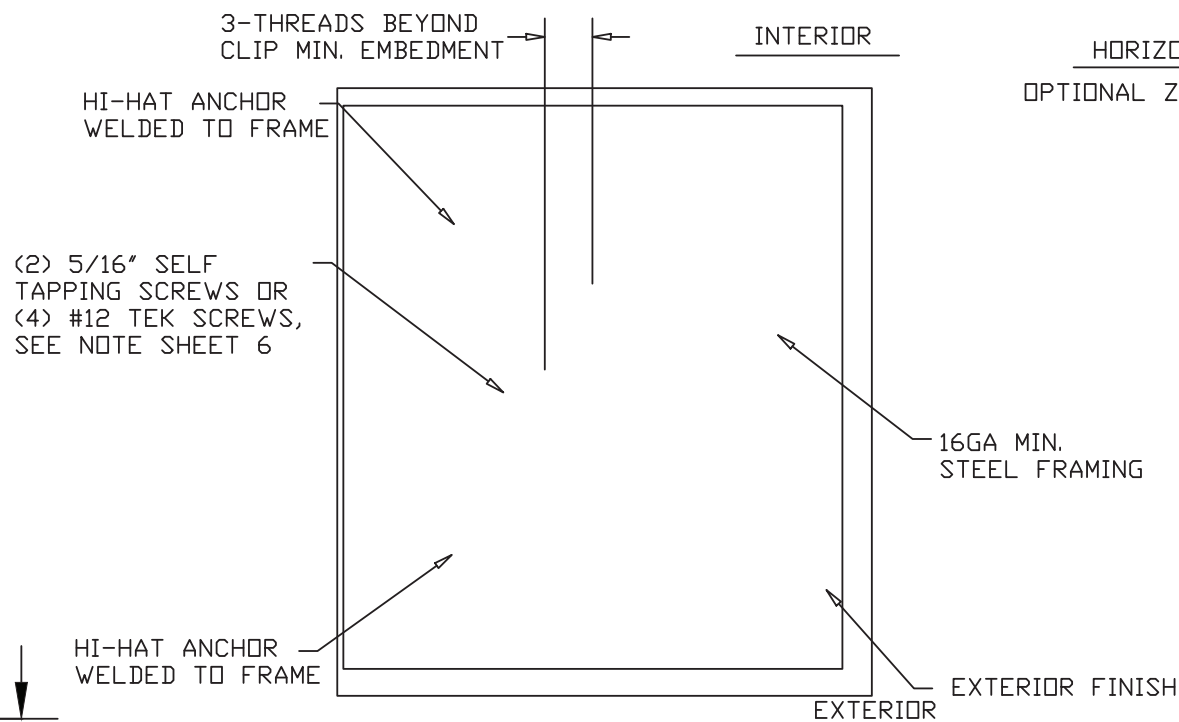

HORIZONTAL CROSS SECTION

OPTIONAL HI-HAT ANCHOR CHANNEL INSTALLATION

(2) 5/16" SELF TAPPING SCREWS OR (4) #12 TEK SCREWS, SEE NOTE SHEET 6

HI-HAT ANCHOR WELDED TO FRAME

HI-HAT ANCHOR WELDED TO FRAME

TELL MANUFACTURING, INC.
18 RICHARD DRIVE, LITITZ, PA 17543

Robert J. Amoruso, P.E.
Florida P.E. No. 49752



PTC PRODUCT DESIGN GROUP, LLC
PO BOX 520775 | LONGWOOD, FLORIDA 32752
FBPE C.A. NO. 25935
Phone: 321.690.1788 | Email: info@ptc-corp.com

DRAFTER	DATE	TELL DOORS & WINDOWS, LLC. 6535 GUHN RD, STE 100, HOUSTON, TX 77040	
CHECKED	DATE	TITLE TIIGA DOORWAY SYSTEM TDS-S-KD-WS OS 16GA STEEL SINGLE DOOR - IMPACT INSTALLATION DETAILS	
ENGINEER V.L.	DATE 6/22/16	SIZE B	DWG NO 08-01999
APPROVED RJA	DATE 10/17/23	RELEASE STATE FINAL	REV B
THIRD ANGLE PROJECTION 		SCALE NTS	SHEET 6 OF 8

TELL MFG
Spectrum Brands | Hardware & Home Improvement

THIS DOCUMENT IS THE PROPERTY OF SPECTRUM BRANDS, INC AND/OR ITS AFFILIATES. THE CONTENTS OF THIS DOCUMENT ARE CONFIDENTIAL AND CONSTITUTE TRADE SECRETS PROPRIETARY TO SPECTRUM BRANDS. NEITHER THIS DOCUMENT NOR ITS CONTENTS SHALL BE DISCLOSED TO ANY UNAUTHORIZED PERSON, COPIED, OR PUBLISHED WITHOUT SPECTRUM BRANDS' PRIOR WRITTEN CONSENT.

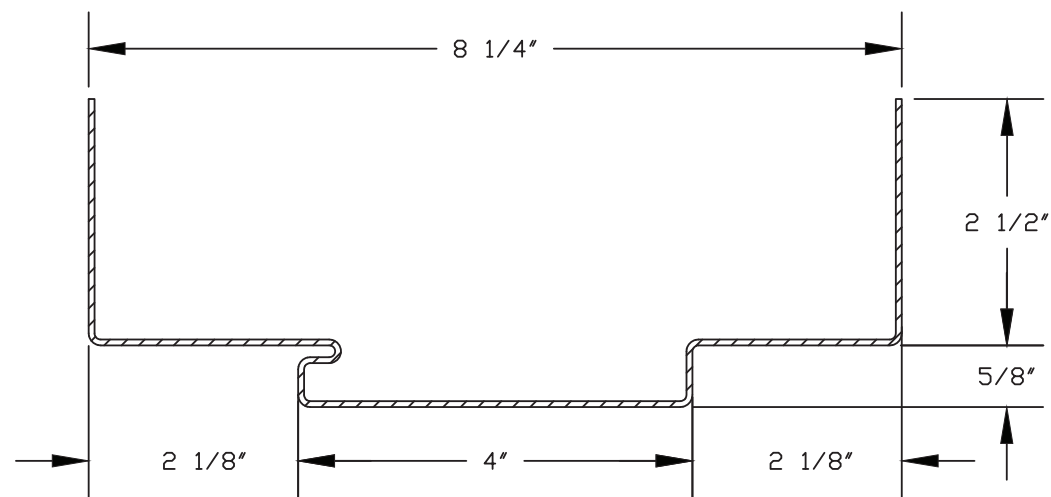

- ① TIOGA KD HEAD JAMB
 - ② TIOGA KD HINGE JAMB
 - ⑭ TIOGA KD STRIKE JAMB
- 16GA. GALVANNEALED STEEL .053" MIN. THICK

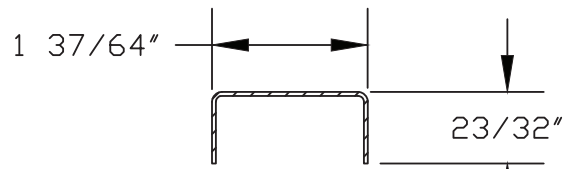

⑦ TOP CAP DOOR CHANNEL
18GA GALVANNEALED STEEL .047" MIN. THICK

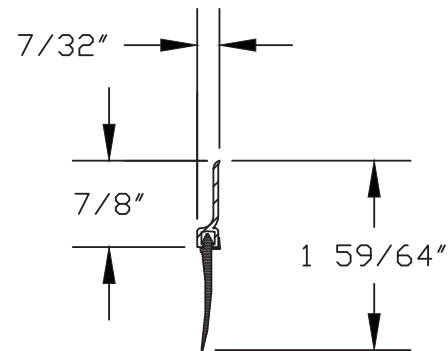

⑳ DOOR SWEEP
ALUMINUM 6063-T5 .042" MIN. THICK EPDM

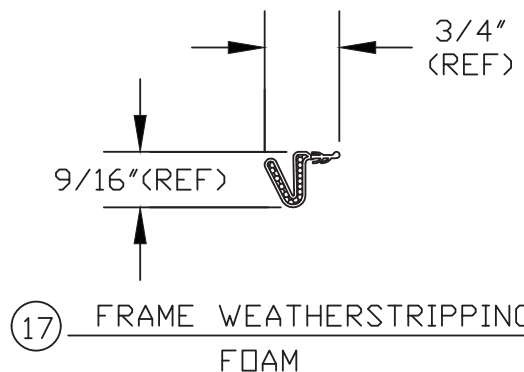

⑰ FRAME WEATHERSTRIPPING FOAM

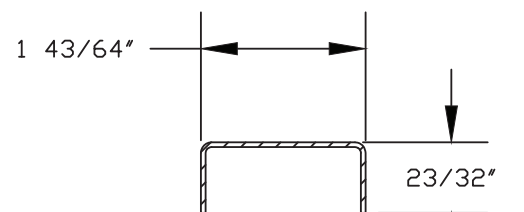

⑨ BOTTOM DOOR CHANNEL
18GA GALVANNEALED STEEL .047-MIN. THICK

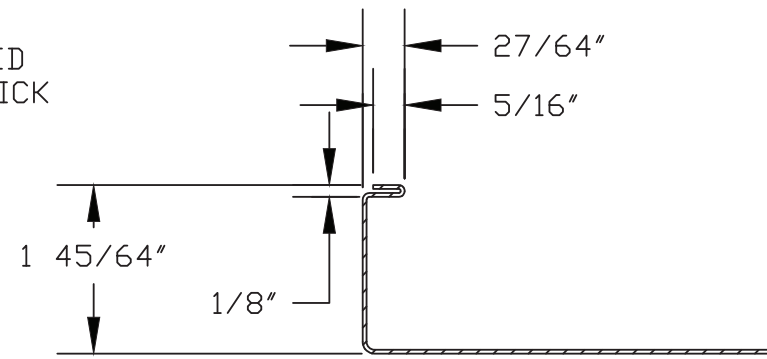

⑤ TIOGA BOTTOM DOOR SKIN
16GA GALVANNEALED STEEL .059" MIN. THICK
LEFT END SHOWN, RIGHT END IS SIMILAR

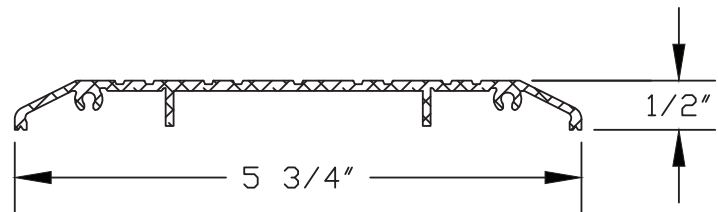

③ THRESHOLD 1/2" HIGH
ALUMINUM 6063-T5 .105" THICK

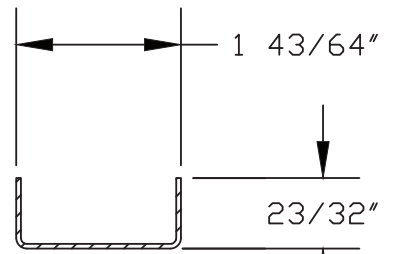

⑧ TOP DOOR CHANNEL
18GA GALVANNEALED STEEL .047" MIN. THICK

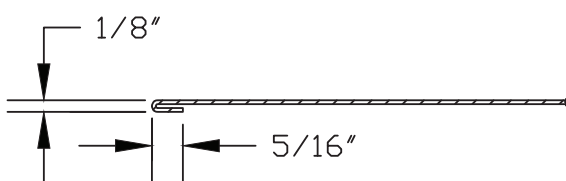

⑥ TIOGA TOP DOOR SKIN
16GA GALVANNEALED STEEL .059" MIN. THICK
LEFT END SHOWN, RIGHT END IS SIMILAR

Robert J. Amoruso, P.E.
Florida P.E. No. 49752

PTC PRODUCT DESIGN GROUP, LLC
PO BOX 520775 | LONGWOOD, FLORIDA 32752
FBPE C.A. NO. 25935
Phone: 321.690.1788 | Email: info@ptc-corp.com

TELL MANUFACTURING, INC.
18 RICHARD DRIVE, LITITZ, PA 17543

TELL MFG
Spectrum Brands | Hardware & Home Improvement

THIS DOCUMENT IS THE PROPERTY OF SPECTRUM BRANDS, INC AND/OR ITS AFFILIATES. THE CONTENTS OF THIS DOCUMENT ARE CONFIDENTIAL AND CONSTITUTE TRADE SECRETS PROPRIETARY TO SPECTRUM BRANDS. NEITHER THIS DOCUMENT NOR ITS CONTENTS SHALL BE DISCLOSED TO ANY UNAUTHORIZED PERSON, COPIED, OR PUBLISHED WITHOUT SPECTRUM BRANDS' PRIOR WRITTEN CONSENT.

DRAFTER	DATE	TELL DOORS & WINDOWS, LLC. 6535 GUHN RD, STE 100, HOUSTON, TX 77040	
CHECKED	DATE	TITLE TIOGA DOORWAY SYSTEM TDS-S-KD-WS OS 16GA STEEL SINGLE DOOR - IMPACT COMPONENTS	
ENGINEER V.L.	DATE 6/22/16	SIZE B	DWG NO 08-01999
APPROVED RJA	DATE 10/17/23	RELEASE STATE	REV B
THIRD ANGLE PROJECTION 		SCALE NTS	ITER 8
		SHEET 7 OF 8	

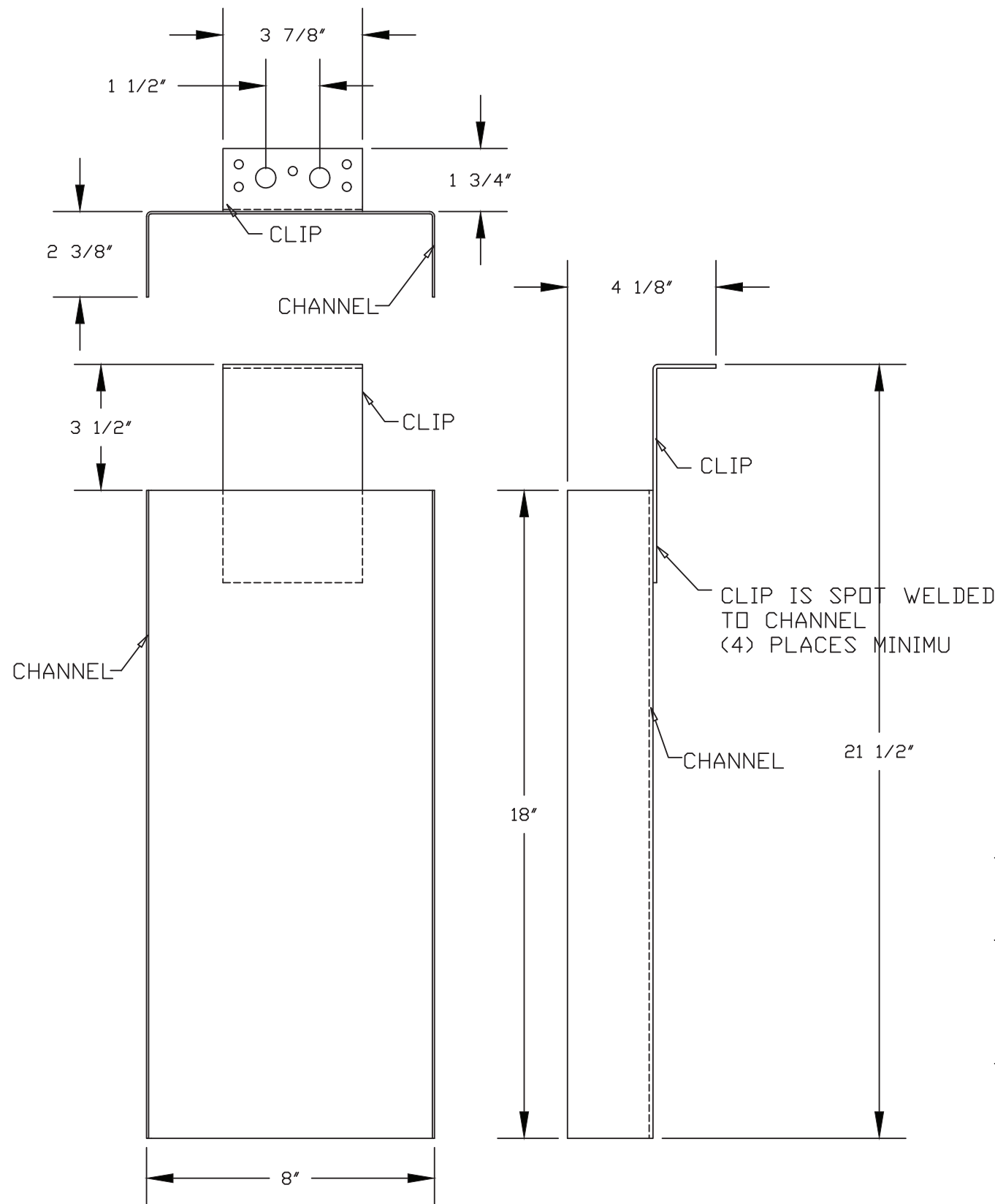

(22) JAMB EXTENSION ASSEMBLY
 16GA GALVANNEALED STEEL .059" MIN. THICK (CHANNEL)
 12GA GALVANNEALED STEEL .108" MIN. THICK (CLIP)

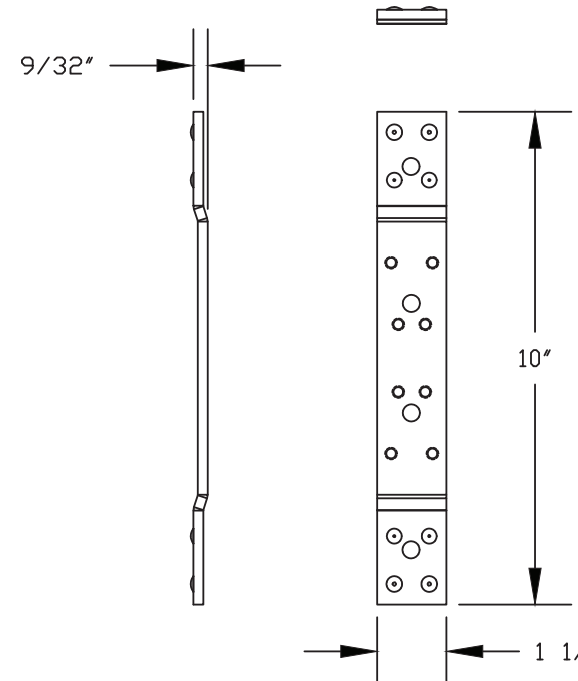

(10) DOOR HINGE REINFORCEMENT
 10GA. GALVANNEALED STEEL .138" MIN. THICK

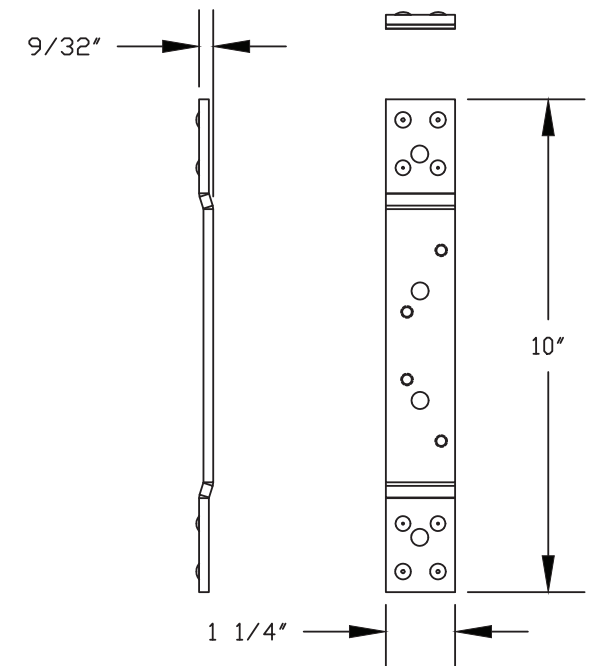

(4) FRAME HINGE REINFORCEMENT
 10GA. GALVANNEALED STEEL .138" MIN. THICK

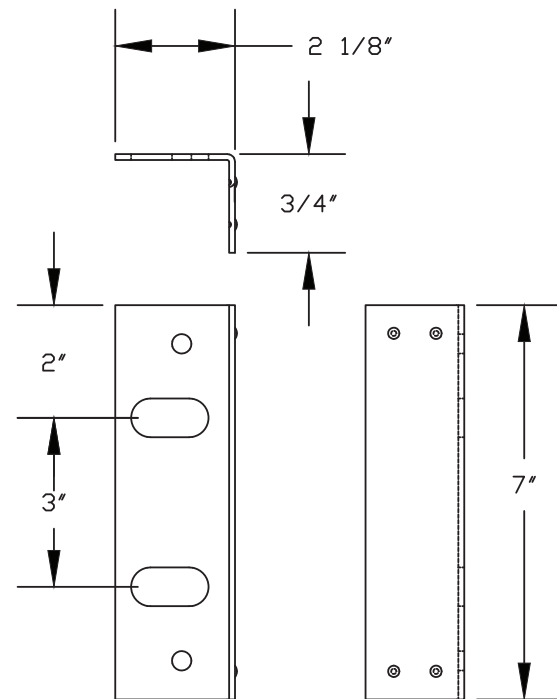

(16) HINGE JAMB CLIP
(23) FLOOR BASE CLIP
(20) STRIKE JAMB CLIP
 12GA. GALVANNEALED STEEL .108" MIN. THICK

Robert J. Amoruso, P.E.
 Florida P.E. No. 49752

PTC PRODUCT DESIGN GROUP, LLC
 PO BOX 520775 | LONGWOOD, FLORIDA 32752
 FBPE C.A. NO. 25935
 Phone: 321.690.1788 | Email: info@ptc-corp.com

DRAFTER	DATE	TELL DOORS & WINDOWS, LLC. 6535 GUHN RD, STE 100, HOUSTON, TX 77040	
CHECKED	DATE	TITLE TIOGA DOORWAY SYSTEM TDS-S-KD-WS DS 16GA STEEL SINGLE DOOR -IMPACT COMPONENTS	
ENGINEER	DATE V.L 6/22/16	SIZE B	DWG NO 08-01999
APPROVED	DATE RJA 10/17/23	RELEASE STATE	REV B
THIRD ANGLE PROJECTION 		SCALE NTS	SHEET 8 OF 8

TELL MFG

Spectrum Brands | Hardware & Home Improvement

TELL MANUFACTURING, INC.
 18 RICHARD DRIVE, LITITZ, PA 17543

THIS DOCUMENT IS THE PROPERTY OF SPECTRUM BRANDS, INC AND/OR ITS AFFILIATES. THE CONTENTS OF THIS DOCUMENT ARE CONFIDENTIAL AND CONSTITUTE TRADE SECRETS PROPRIETARY TO SPECTRUM BRANDS. NEITHER THIS DOCUMENT NOR ITS CONTENTS SHALL BE DISCLOSED TO ANY UNAUTHORIZED PERSON, COPIED, OR PUBLISHED WITHOUT SPECTRUM BRANDS' PRIOR WRITTEN CONSENT.