

JAMB SCREW INSTALLATION

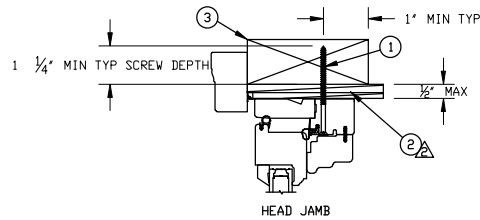

HEAD JAMB

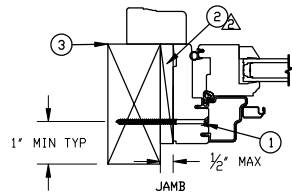

JAMB

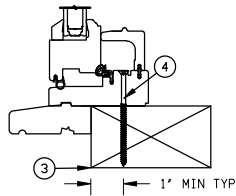

SILL

NARROW FRAME PRODUCT DETAILS

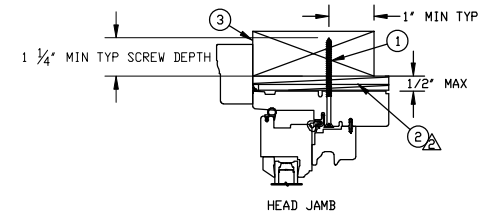
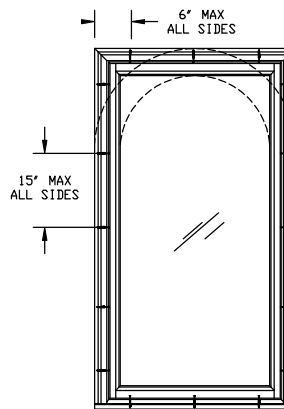

HEAD JAMB

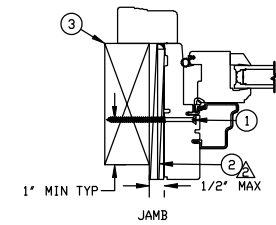

JAMB

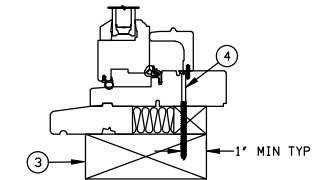

SILL

FULL FRAME PRODUCT DETAILS

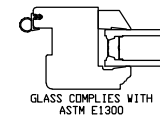

GLASS COMPLIES WITH ASTM E1300

GLASS DETAIL

JAMB SCREW INSTALLATION METHOD:

- UNIT MUST NOT BE IN DIRECT CONTACT WITH EITHER CONCRETE OR TREATED BUCK MATERIAL. IF SHIM SPACE IS LESS THAN 1/8" WRAPPING THE UNIT ON ALL 4 SIDES WITH WINDOW FLASHING TAPE IS REQUIRED AS A BARRIER BETWEEN THE UNIT AND CONCRETE OR TREATED LUMBER.
- SECURE JAMBS AND HEAD JAMBS WITH #8 X 3" SCREWS.
- SECURE THE SILL WITH #8 X 3 1/2" WOOD SCREWS.
- SHIM AT EACH SCREW LOCATION.

UNIT	MAX FRAME SIZE	DP RATING
UL WD CSMNT STAT POLY	64 X 97 1/8 DR 97 1/8 X 64	+50/-50
UL WD CSMNT NF STAT POLY	64 X 97 1/8 DR 97 1/8 X 64	+50/-50
UL WD CSMNT STAT POLY	72 X 72 1/16 DR 72 1/16 X 72	+50/-50
UL WD CSMNT STAT POLY	88 X 97 1/16 DR 97 1/16 X 88	+50/-50
UL WD CSMNT STAT RT	64 X 97 1/8	+50/-50
UL WD CSMNT NF STAT RT	64 X 97 1/8	+50/-50
UL WD CSMNT STAT RT	88 X 97 1/16	+50/-50

NOTES:

1. THIS PRINT IS FOR STRUCTURAL PERFORMANCE ONLY. FOR FLASHING & SEALING INSTRUCTIONS, REFER TO THE INSTALLATION INSTRUCTIONS.

△ SHIMS

-PLACE A SHIM WITHIN 4-6 INCHES OF EACH CORNER AND SPACE ALL OTHERS EVENLY A MAXIMUM OF 15" APART.

3. IF CHEMICALLY TREATED LUMBER IS USED FOR BUCK MATERIAL, FASTENERS INTO THE BUCK MUST BE A MINIMUM OF 0.90 OZ/FT² ZINC HOT DIPPED GALVANIZED OR STAINLESS STEEL TYPE 304 OR 316.

4. RECTANGULAR UNITS SHOWN, SHAPED UNITS ALSO APPLY.

4	-----	#8 X 3.000 WOOD SCREW
3	-----	WOOD BUCK BY OTHERS
2	-----	SHIM
1	-----	#8 X 3.000 WOOD SCREW
ITEM NO	REF NO	DESCRIPTION

UNSPECIFIED TOLERANCES

DECIMALS:	ANGLE DEG:
XX ± .03	± .5
XXX ± .0125	FAB LINEAL:
- .000	± N/A

MATERIAL:

N/A

MARVIN		RESEARCH & DEVELOPMENT	
PRODUCT CATEGORY:	ULTIMATE CASEMENT		
UNIT TYPE:	UWCART, UWCANFRT, UWCAPOLY, UWCANFPOLY		
DWG TYPE:	INSTALLATION		
DESCRIPTION:	INSTALLATION		
CHK:	SIZE:	CLASS:	DWG NO:
	B	MISC	00065783
APP:	SCALE:	DATE:	DWG BY:
	N/A	12/14/12	BORNEMAN, SKIP
			SHEET:
			1 OF 1

NOTICE - CONFIDENTIAL INFORMATION

The information in this document is privileged and strictly confidential. The information contained herein shall be used only by Marvin Windows and Doors employees and by those agents or suppliers granted official written permission. If the reader of this document is not the intended recipient, or the employee or agent of the intended recipient, please delete this document from all data storage devices, and destroy all hard copies. Any unauthorized dissemination, distribution, copying or other use of the information contained in this document is strictly prohibited.

Template Version 11.0