

SINGLE HUNG - NON-IMPACT

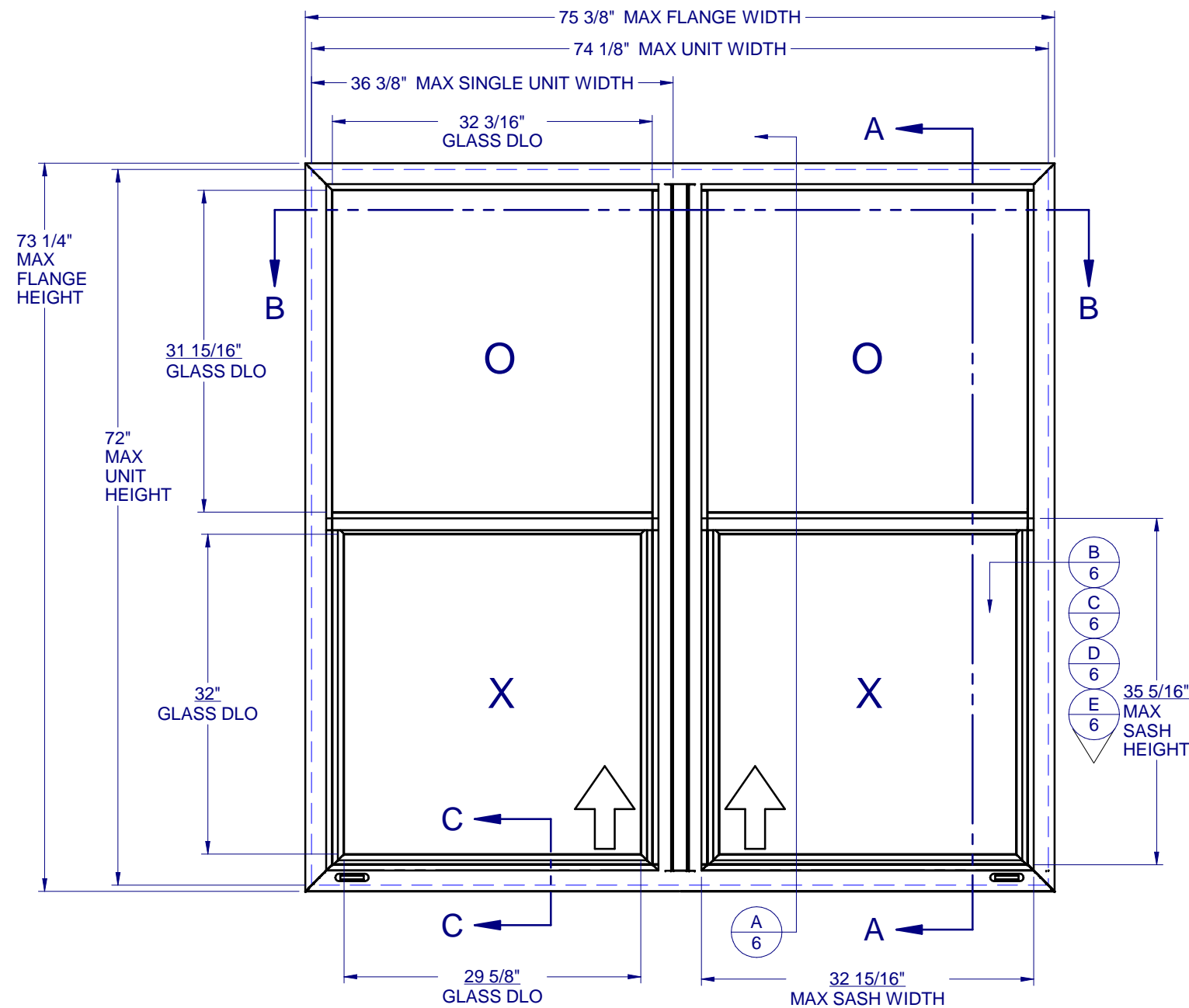

GENERAL NOTES:

1. THE PRODUCT SHOWN HEREIN IS DESIGNED AND MANUFACTURED TO COMPLY WITH THE FLORIDA BUILDING CODE (FBC), CURRENT EDITION.
2. GLAZING OPTIONS: (SEE SHEET 2)
3. CONFIGURATIONS: "O/X" - "O/X".
4. DESIGN PRESSURE RATING (SEE SHEET 2):
 -NEGATIVE DESIGN LOADS BASED ON, TESTED PRESSURE AND GLASS TABLES ASTM E-1300-04e01/09.
 -POSITIVE DESIGN LOADS BASED ON, TESTED PRESSURE, WATER INFILTRATION TEST PRESSURE AND GLASS TABLES ASTM E-1300-04e01/09.
5. ANCHORAGE: THE 33 1/3% STRESS INCREASE HAS NOT BEEN USED IN THE DESIGN OF THIS PRODUCT. SEE SHEET 6 FOR ANCHOR DETAILS. WINDLOAD DURATION FACTOR Cd=1.6 WAS USED FOR WOOD ANCHOR CALCULATIONS.
6. NOT APPROVED FOR IMPACT RESISTANCE. IMPACT PROTECTIVE SYSTEM IS REQUIRED IN WIND BORNE DEBRIS REGION.
7. ALL FRAMES AND VENTS FULLY WELDED. SMALL JOINT SEAM SEALANT USED AT FIXED MEETING RAIL, INTERNAL MULL ENDS AND JAMBS.
8. SERIES / MODEL DESIGNATION SH-8100 CONTINUOUS FRAME.
9. THE DESIGNATION X AND O STAND FOR THE FOLLOWING:
 X = OPERABLE SASH, O = FIXED SASH
10. SECTION CALLOUTS APPLY TO ALL ELEVATIONS IN A SIMILAR LOCATION.
11. EXTERNAL WEEP SLOT = 1/4" x 1" LOCATED 4" FROM BOTH ENDS.



510 PVC SINGLE HUNG NON-IMPACT

PROPRIETARY AND CONFIDENTIAL
 THE INFORMATION CONTAINED IN THIS DRAWING IS THE SOLE PROPERTY OF CUSTOM WINDOW SYSTEMS, INC. ANY REPRODUCTION IN PART OR AS A WHOLE WITHOUT THE WRITTEN PERMISSION OF CUSTOM WINDOW SYSTEMS, INC IS PROHIBITED.

FLORIDA APPROVAL NO.:
 33447



9/26/2023

LUCAS A. TURNER, P.E.
 FL PE # 58201
 Turner Engineering & Consulting, Inc.
 2428 Old Natchez Trc Trl
 Camden, TN 38320
 PH. 941-380-1574

SHEET DESCRIPTION:
 GENERAL NOTES AND ELEVATIONS

DRAWN BY: MCS	DATE: 9/19/2023
DWG #: PEL-492	REV.: B
SCALE: 1:15	SHEET 1 OF 6

TABLE OF CONTENTS

GENERAL NOTES & ELEVATIONS.....	1
COMP. ANALYSIS & GLAZING DETAIL....	2
SECTION VIEWS.....	3
BOM & EXTRUSIONS.....	4
ANCHOR SCHEDULE & NOTES.....	5
INSTALLATION DETAILS.....	6

MAX. UNIT SIZE	DESIGN PRESSURE RATING	IMPACT RATING
74-1/8" x 72"	SEE COMPARATIVE ANALYSIS CHART, SHEET 2	NONE

DESIGN PRESSURES (PSF) WITH GLASS TYPES A, B, C, AND D

Unit Width	Unit Height								
	29.500	31.500	37.500	43.500	49.500	55.500	59.500	65.500	72.000
35.000	+67.5 / -101.3	+67.5 / -101.3	+67.5 / -101.3	+67.5 / -101.3	+67.5 / -101.3	+67.5 / -101.3	+67.5 / -101.3	+67.5 / -101.3	+67.5 / -94.3
40.000	+67.5 / -101.3	+67.5 / -101.3	+67.5 / -101.3	+67.5 / -101.3	+67.5 / -101.3	+67.5 / -101.3	+67.5 / -101.3	+67.5 / -98.1	+67.5 / -86
45.000	+67.5 / -101.3	+67.5 / -101.3	+67.5 / -101.3	+67.5 / -101.3	+67.5 / -101.3	+67.5 / -101.3	+67.5 / -101.3	+67.5 / -91.8	+67.5 / -79.9
50.000	+67.5 / -101.3	+67.5 / -101.3	+67.5 / -101.3	+67.5 / -101.3	+67.5 / -101.3	+67.5 / -101.3	+67.5 / -101.3	+67.5 / -87.4	+67.5 / -75.5
55.000	+67.5 / -101.3	+67.5 / -101.3	+67.5 / -101.3	+67.5 / -101.3	+67.5 / -101.3	+67.5 / -101.3	+67.5 / -99.8	+67.5 / -84.3	+67.5 / -72.2
60.000	+67.5 / -101.3	+67.5 / -101.3	+67.5 / -101.3	+67.5 / -101.3	+67.5 / -101.3	+67.5 / -101.3	+67.5 / -98.9	+67.5 / -82.5	+67.5 / -69.9
65.000	+67.5 / -101.3	+67.5 / -101.3	+67.5 / -101.3	+67.5 / -98.1	+67.5 / -92.8	+67.5 / -89.7	+67.5 / -88.6	+67.5 / -81.6	+67.5 / -68.4
70.000	+67.5 / -101.3	+67.5 / -101.3	+67.5 / -95.5	+67.5 / -87.6	+67.5 / -82.2	+67.5 / -78.7	+67.5 / -77.2	+67.5 / -76	+67.5 / -67.6
74.125	+67.5 / -101.3	+67.5 / -99.5	+67.5 / -88.2	+67.5 / -80.5	+67.5 / -75.2	+67.5 / -71.5	+67.5 / -69.8	+67.5 / -68.2	+67.5 / -67.5



**510 PVC
SINGLE HUNG
NON-IMPACT**

PROPRIETARY AND CONFIDENTIAL
 THE INFORMATION CONTAINED IN THIS DRAWING IS THE SOLE PROPERTY OF CUSTOM WINDOW SYSTEMS, INC. ANY REPRODUCTION IN PART OR AS A WHOLE WITHOUT THE WRITTEN PERMISSION OF CUSTOM WINDOW SYSTEMS, INC IS PROHIBITED.

FLORIDA APPROVAL NO.:
 33447



9/26/2023
 LUCAS A. TURNER, P.E.
 FL PE # 58201
 Turner Engineering & Consulting, Inc.
 2428 Old Natchez Trc Trl
 Camden, TN 38320
 PH. 941-380-1574

SHEET DESCRIPTION:
**COMPARATIVE ANALYSIS
 AND GLAZING DETAIL**

DRAWN BY: MCS	DATE: 9/19/2023
DWG #: PEL-492	REV.: B
SCALE: 1:1	SHEET 2 OF 6

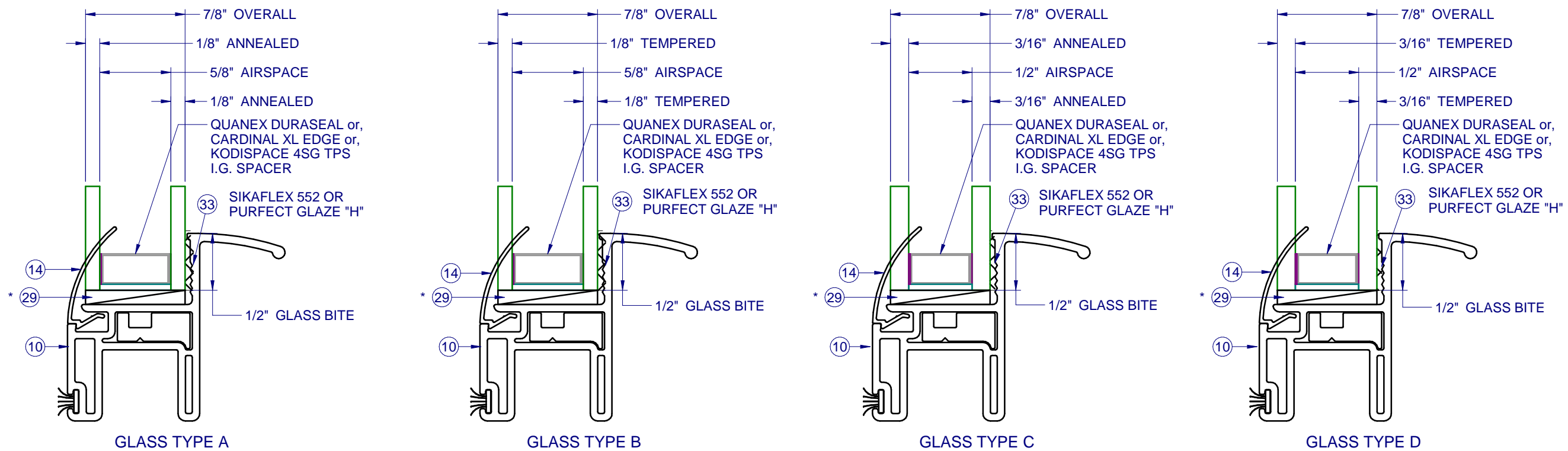

NOTE: IF SIZE INTENDED IS NOT SHOWN, USE NEXT LARGER SIZE.

**510 PVC
 SINGLE HUNG
 NON-IMPACT**

PROPRIETARY AND CONFIDENTIAL
 THE INFORMATION CONTAINED IN
 THIS DRAWING IS THE SOLE
 PROPERTY OF CUSTOM WINDOW
 SYSTEMS, INC. ANY
 REPRODUCTION IN PART OR AS A
 WHOLE WITHOUT THE WRITTEN
 PERMISSION OF CUSTOM WINDOW
 SYSTEMS, INC IS PROHIBITED.

FLORIDA APPROVAL NO.:
 33447

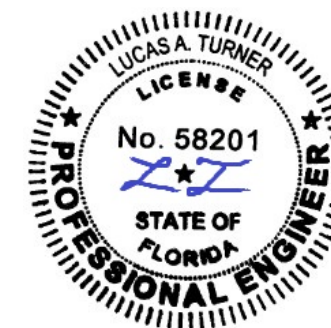

9/26/2023

LUCAS A. TURNER, P.E.
 FL PE # 58201
 Turner Engineering &
 Consulting, Inc.
 2428 Old Natchez Trc Trl
 Camden, TN 38320
 PH. 941-380-1574

SHEET DESCRIPTION:

SECTION VIEWS

DRAWN BY:	DATE:
MCS	9/19/2023
DWG #:	REV.:
PEL-492	B
SCALE:	SHEET
1:2	3 OF 6

INTERIOR

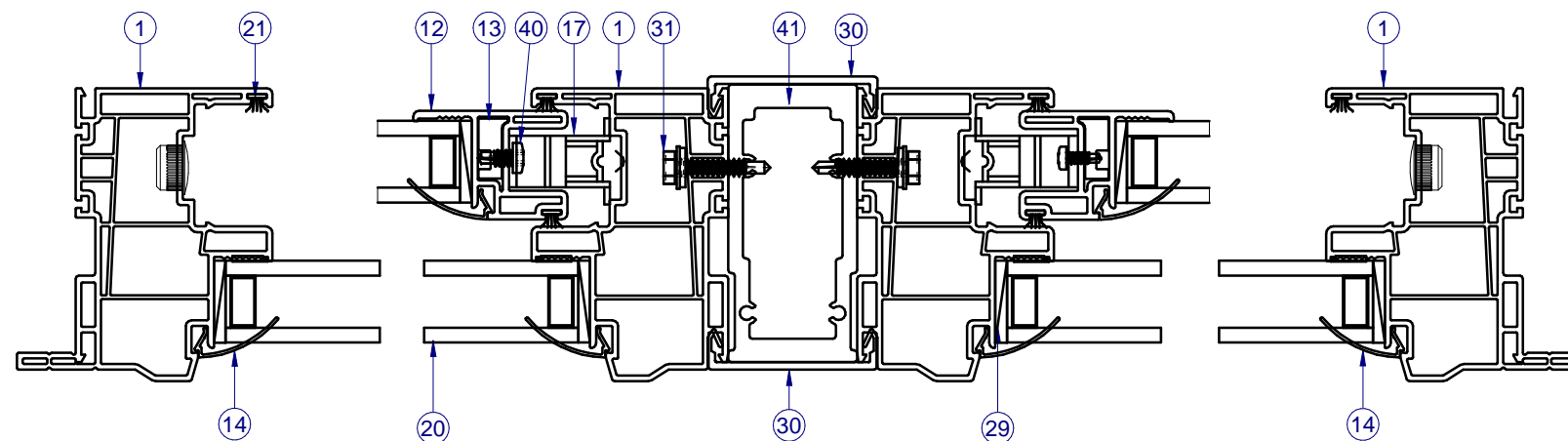

SECTION B-B

INTERIOR

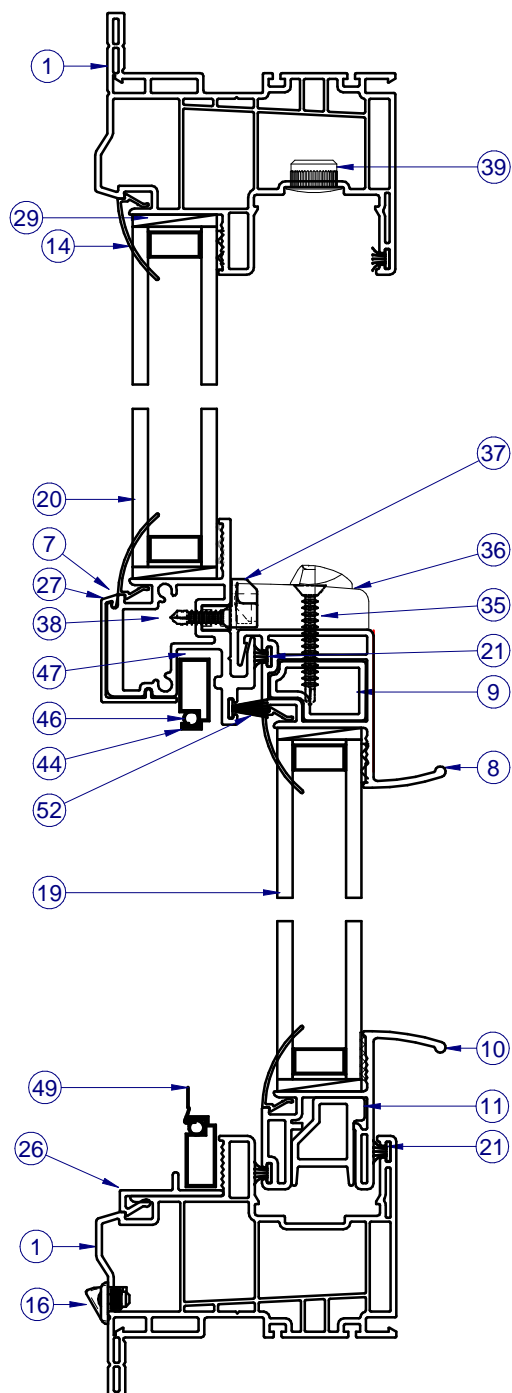

SECTION A-A

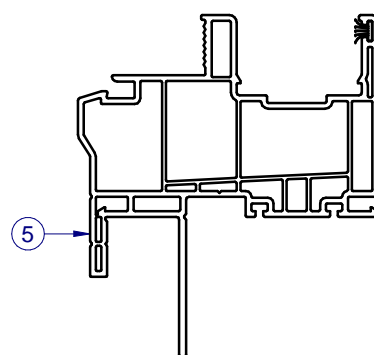

SECTION C-C
 ALTERNATE FIN FRAME

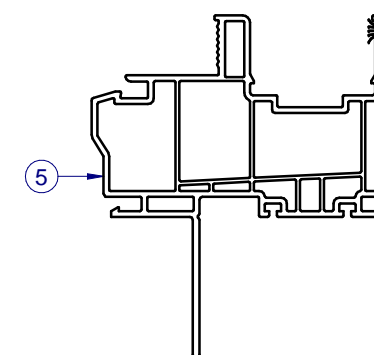

SECTION C-C
 ALTERNATE FIN ONLY FRAME

NOTE: ITEMS NOT SHOWN FOR CLARITY:
 6, 15, 18, 32, 34, 42, 45, 48

PARTS LIST			
ITEM	PART #	DESCRIPTION	MATERIAL
1	H-6222	Main Frame, Flg,	Vinyl
5	H-6231	Frame, Fin	Vinyl
6	S-5087	SASH STOP, PVC	Vinyl
7	H-2121	Alum. Fixed Meet. Rail	Alum
8	H-6224	Sash Top Rail	Vinyl
9	H-2124	Reinforcement for STR	Alum
10	H-6223	Sash Bottom Rail	Vinyl
11	H-2123	Reinforcement for SBR	Alum
12	H-6225	Sash Side Rail	Vinyl
13	S-2129	Reinforcement for SSR	Alum
14	S-6237	Glazing Bead	Vinyl
15	P-4056	Sash Cam	Plastic
16	P-4479	WEEP HOLE COVER	Plastic
17		SASH BALANCE	
18	P-3295	Take Out Clip	SS
19		Glass, Sash (See Sheet 2)	
20		Glass, Fixed (See Sheet 2)	
21	P-3305	Wstp., 0.270 x 0.187 High Density	
22	P-4638	#8 x 2-1/2 Ph Mod. Truss, Type A, Tek 2	Steel
23		#10 x 1 1/2" Panhead SMS	Steel
25	S-6227	Screen Adaptor, Jamb	Vinyl
26	S-6226	Screen Adaptor, Sill	Vinyl
27	S-6228	Fixed Rail Cover	Vinyl
29	P-5612	Setting Block, .12 x 1 x 2	Rubber
30	S-6018	Mullbar Cover	Vinyl
31		#10 x 1 Hex Head Tek	Steel
32	P-3342	Seam Sealer, SM-5504	
33		SikaFlex 552 or Purfect Glaze "H"	
35	P-4051	#8 x 1 1/4" PH Flat Tek	Steel
36	P-3783	IMPACT LOCK	
37	P-4069	Keeper	Zamac
38	P-3539	#8 x 3/4" Phillips Square SMS	Steel
39	P-5588	Hole Plug	Nylon
40	P-3541	#8 x 1/2" Quadrex PH Tek	Steel
41	H-2127	Internal Mullbar	Alum
44	P-3218	Screen frame	Alum
45	P-4754	Screen Corner Key	Plastic
46	P-5576	Screen Spline, .125	Vinyl
47	P-3195	SPRING, NO HOLE TENSION	SS
48	P-4755	Screen Corner Key W/ Safety Pull Tab	Alum
49	P-4771	36" BetterVue Insect Screen, 18x16	Fiberglass
52	P-4959	Wstp., 0.420 x 0.187 back	

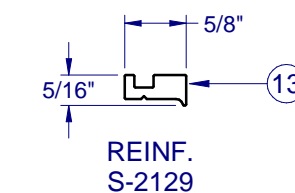
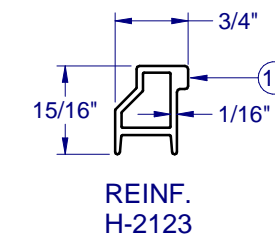
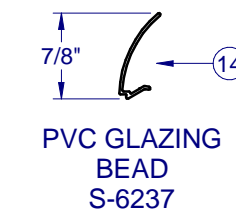
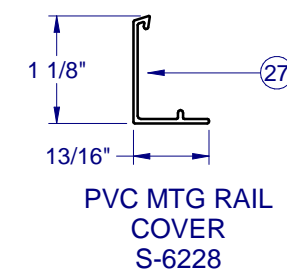
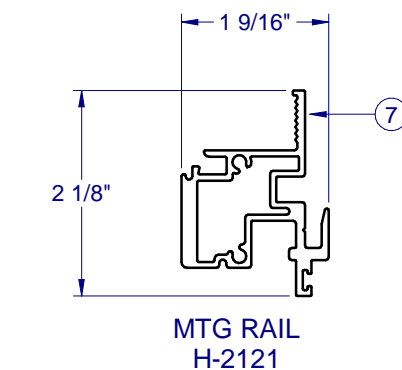
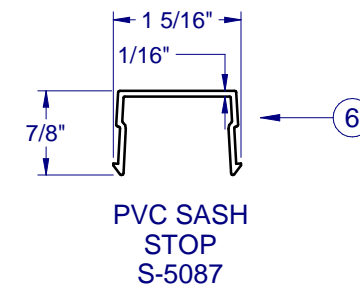
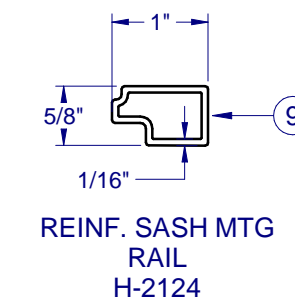
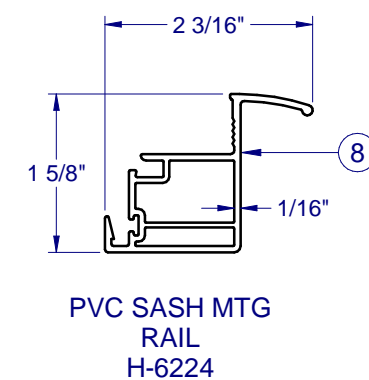
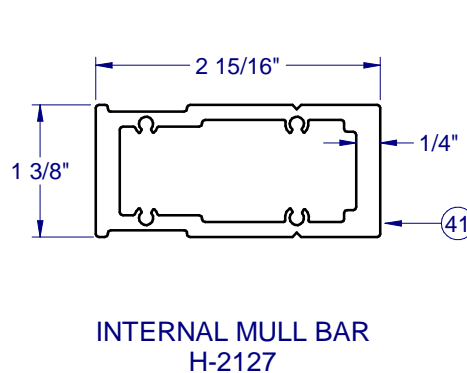
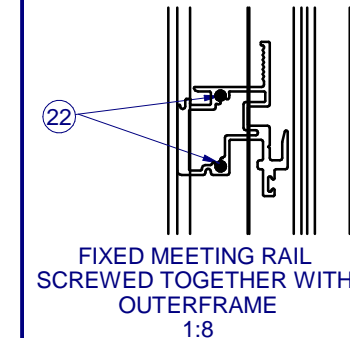
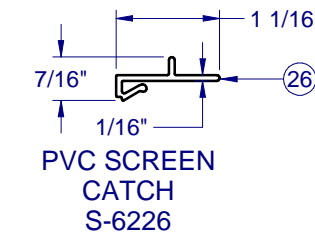
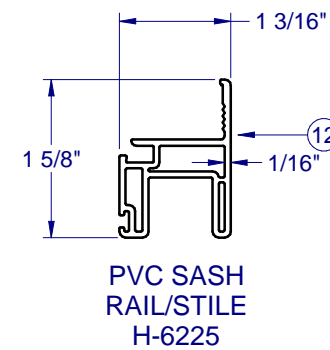
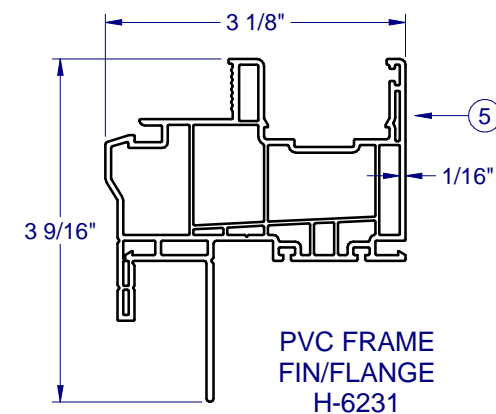
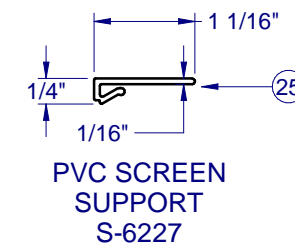
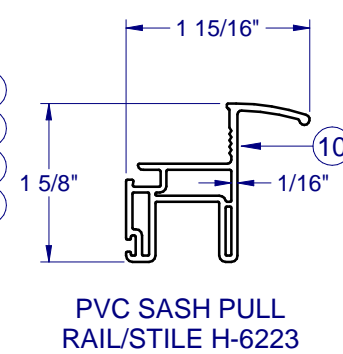
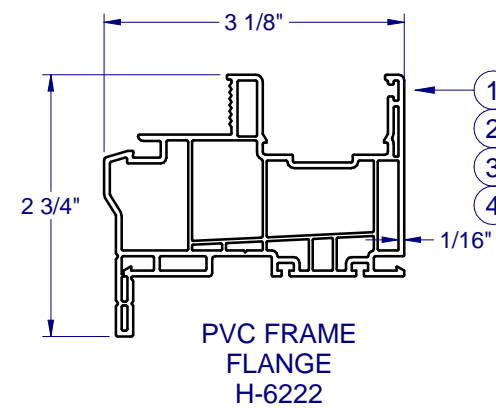

FRAME CORNER CONSTRUCTION

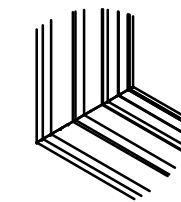

CORNER WELD (ALL SIDES) 1:8



510 PVC SINGLE HUNG NON-IMPACT

PROPRIETARY AND CONFIDENTIAL
 THE INFORMATION CONTAINED IN THIS DRAWING IS THE SOLE PROPERTY OF CUSTOM WINDOW SYSTEMS, INC. ANY REPRODUCTION IN PART OR AS A WHOLE WITHOUT THE WRITTEN PERMISSION OF CUSTOM WINDOW SYSTEMS, INC IS PROHIBITED.

FLORIDA APPROVAL NO.: 33447

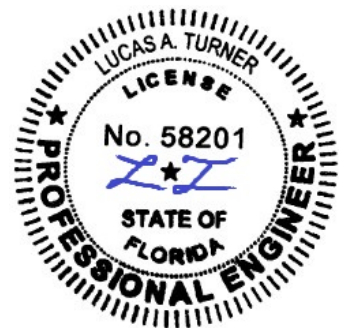

9/26/2023
 LUCAS A. TURNER, P.E.
 FL PE # 58201
 Turner Engineering & Consulting, Inc.
 2428 Old Natchez Trc Trl
 Camden, TN 38320
 PH. 941-380-1574

SHEET DESCRIPTION:
BOM AND EXTRUSIONS

DRAWN BY: MCS	DATE: 9/19/2023
DWG #: PEL-492	REV.: B
SCALE: 1:2	SHEET 4 OF 6

LINE ITEMS NOT USED:
34, 42, 50-51

NOTE: ALL EXTRUSIONS ARE ALUMINUM 6063-T6 UNLESS OTHERWISE NOTED.

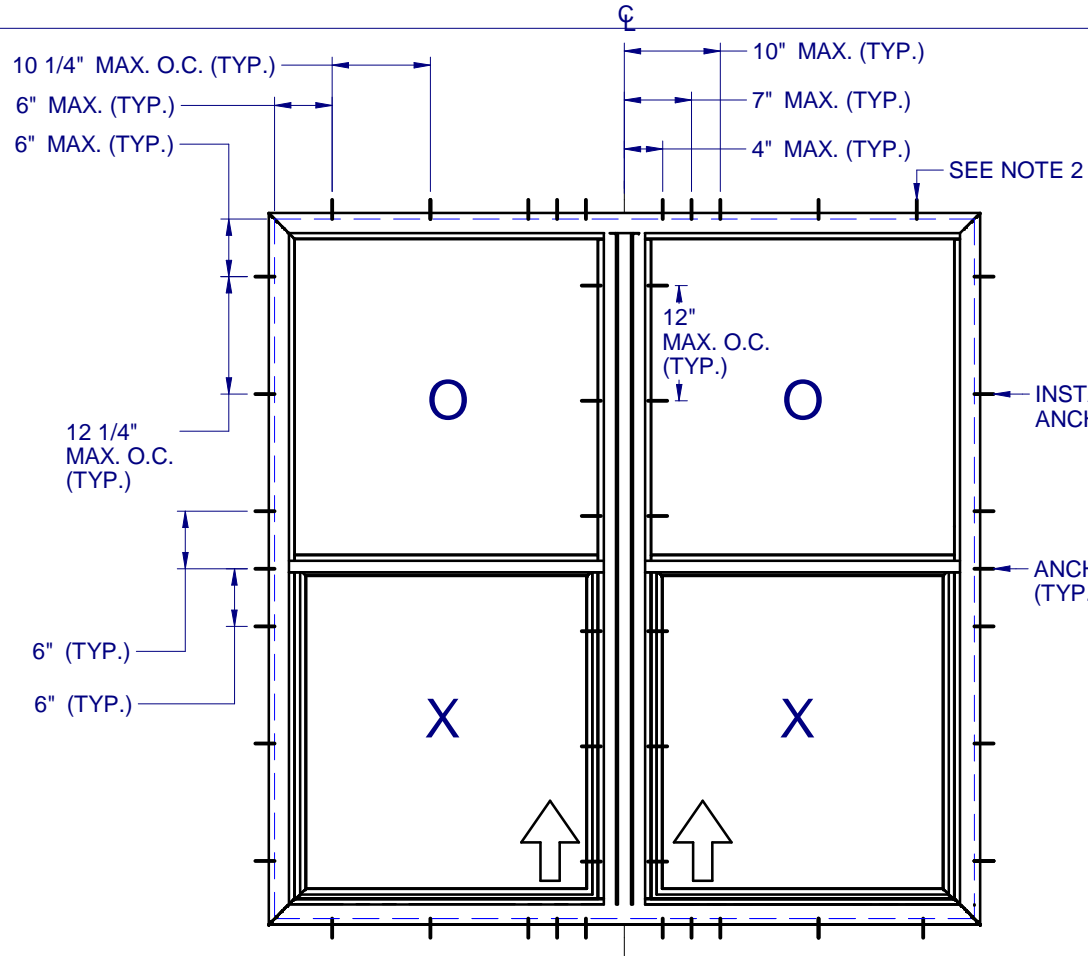

ANCHOR LAYOUT - (FLANGE)

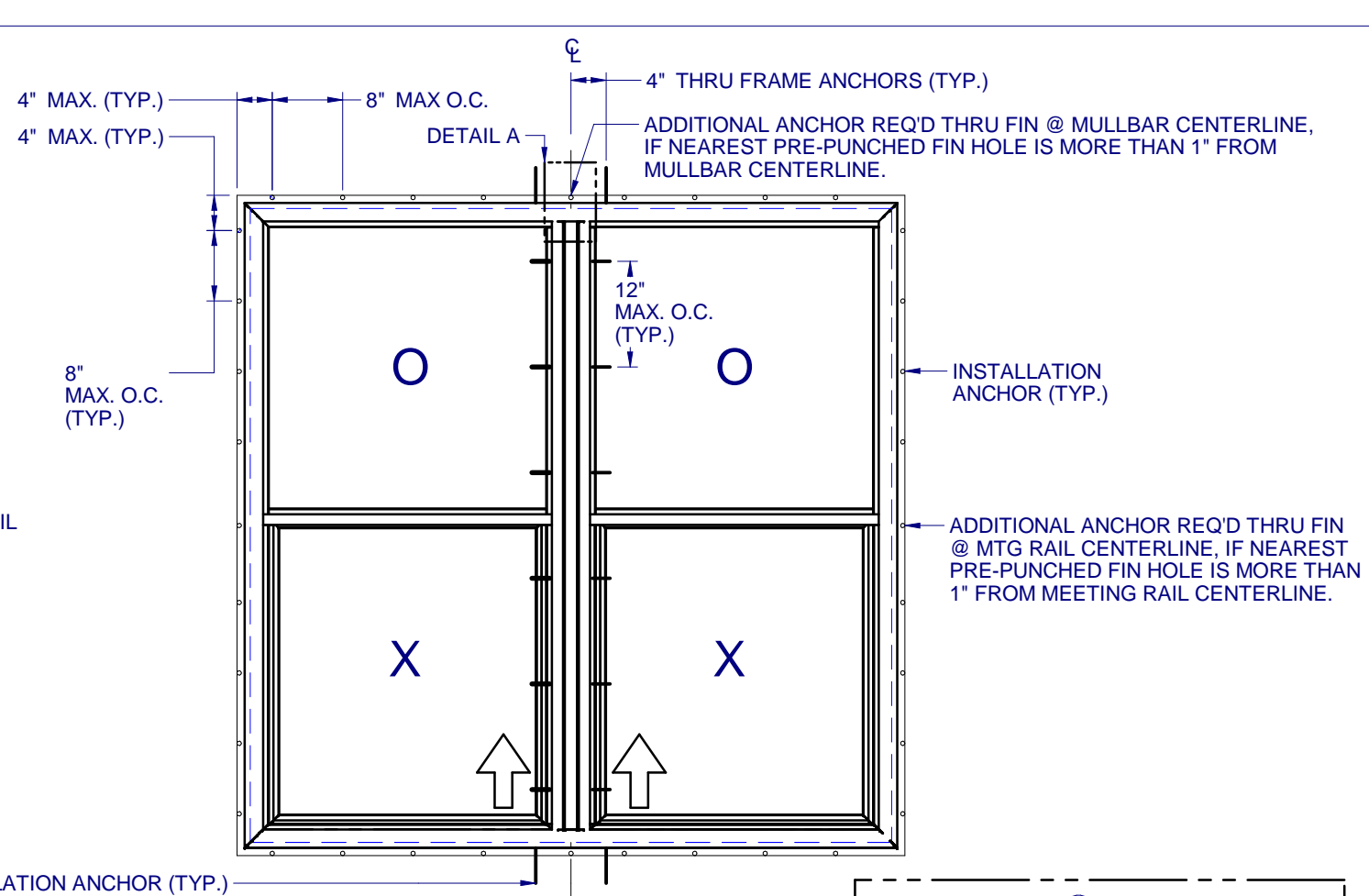

ANCHOR LAYOUT - (FIN)

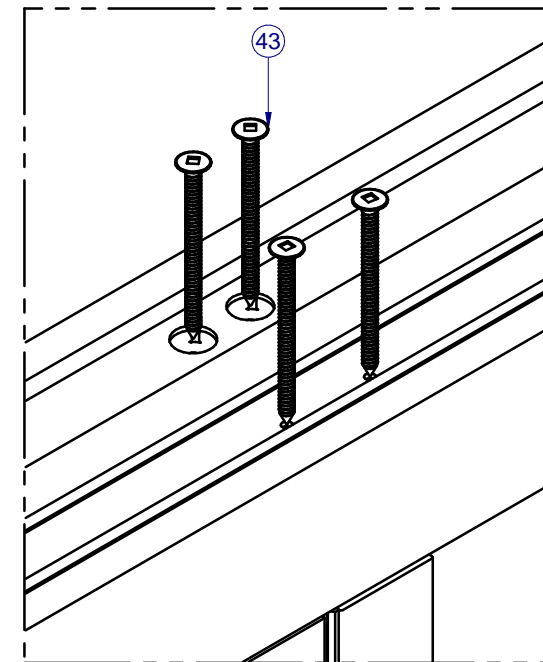

DETAIL A
INTERNAL MULL ATTACHMENT

NOTES:

- INSTALL ONE ANCHOR AT EACH INSTALLATION LOCATION. SILL ANCHOR SPACING SAME AS HEAD. SEAL CORNERS AND INTERNAL MULL WITH SMALL JOINT SEAM SEALANT.
- SHIM AS REQ AT EACH INSTALLATION ANCHOR USING LOAD BEARING SHIMS. MAX. ALLOWABLE SHIM STACK TO BE 1/4". USE SHIMS WHERE SPACE GREATER THAN 1/16" IS PRESENT. LOAD BEARING SHIMS SHALL BE CONSTRUCTED OF HIGH DENSITY PLASTIC OR BETTER. WOOD SHIMS ARE NOT ALLOWED.
- ANCHOR TYPE, SIZE, SPACING AND EMBEDMENT SHALL BE AS SPECIFIED IN THESE DRAWINGS, SEE TABLE 1, SHEET 6.
- ALL INSTALLATION ANCHORS MUST BE MADE OF OR PROTECTED WITH A CORROSION RESISTANT MATERIAL OR COATING. DISSIMILAR METALS OR MATERIALS IN CONTACT WITH PRESSURE TREATED WOOD MUST BE PROTECTED TO PREVENT REACTION.
- INSTALLATION ANCHORS SHALL BE IN ACCORDANCE WITH ANCHOR MANUFACTURER'S INSTALLATION INSTRUCTIONS, AND ANCHORS SHALL NOT BE USED IN SUBSTRATES WITH STRENGTHS LESS THAN THE MINIMUM SPECIFIED IN TABLE 1, SHEET 6.
- ANCHOR EMBEDMENT TO SUBSTRATE SHALL BE BEYOND WALL DRESSING OR STUCCO. FOR CONCRETE/CMU OPENINGS, EMBEDMENT SHALL BE BEYOND WOOD BUCKS, IF USED, INTO SUBSTRATE - 1X BUCKS ARE OPTIONAL.
- A MINIMUM CENTER-TO-CENTER SPACING SHALL BE MAINTAINED BETWEEN ALL FASTENERS: 3" FOR MASONRY, 1" FOR WOOD AND METAL.
- WOOD OR MASONRY OPENINGS, BUCKS AND BUCK FASTENERS SHALL BE PROPERLY DESIGNED BY THE ARCHITECT OR ENGINEER OF RECORD AND INSTALLED TO TRANSFER WIND LOADS TO THE STRUCTURE. SUBSTRATES SHALL MEET THE MINIMUM STRENGTH REQUIREMENTS AS SHOWN IN TABLE 1, SHEET 6. CONCRETE AND MASONRY SUBSTRATES MAY NOT BE CRACKED.
- SEALING AND FLASHING STRATEGIES FOR OVERALL WATER RESISTANCE OF INSTALLATION SHALL BE DONE BY OTHERS FOLLOWING THE CURRENT VERSION OF THE REFERENCE DOCUMENTS: FMA/AAMA 100(FIN WINDOWS), FMA/AAMA 200(FLANGE WINDOWS), FMA/WDMA 250(BOX WINDOWS), FMA/AAMA/WDMA 300(EXTERIOR DOORS)



**510 PVC
SINGLE HUNG
NON-IMPACT**

PROPRIETARY AND CONFIDENTIAL
 THE INFORMATION CONTAINED IN THIS DRAWING IS THE SOLE PROPERTY OF CUSTOM WINDOW SYSTEMS, INC. ANY REPRODUCTION IN PART OR AS A WHOLE WITHOUT THE WRITTEN PERMISSION OF CUSTOM WINDOW SYSTEMS, INC IS PROHIBITED.

FLORIDA APPROVAL NO.:
33447



9/26/2023

LUCAS A. TURNER, P.E.
 FL PE # 58201
 Turner Engineering & Consulting, Inc.
 2428 Old Natchez Trc Trl
 Camden, TN 38320
 PH. 941-380-1574

SHEET DESCRIPTION:
ANCHOR SCHEDULE AND NOTES

DRAWN BY:	DATE:
MCS	9/19/2023
DWG #:	REV.:
PEL-492	B
SCALE:	SHEET
1:20	5 OF 6

**510 PVC
 SINGLE HUNG
 NON-IMPACT**

PROPRIETARY AND CONFIDENTIAL
 THE INFORMATION CONTAINED IN THIS DRAWING IS THE SOLE PROPERTY OF CUSTOM WINDOW SYSTEMS, INC. ANY REPRODUCTION IN PART OR AS A WHOLE WITHOUT THE WRITTEN PERMISSION OF CUSTOM WINDOW SYSTEMS, INC IS PROHIBITED.

FLORIDA APPROVAL NO.:
 33447



9/26/2023
 LUCAS A. TURNER, P.E.
 FL PE # 58201
 Turner Engineering & Consulting, Inc.
 2428 Old Natchez Trc Trl
 Camden, TN 38320
 PH. 941-380-1574

SHEET DESCRIPTION:
INSTALLATION DETAILS

DRAWN BY:	DATE:
MCS	9/19/2023
DWG #:	REV.:
PEL-492	B
SCALE:	SHEET
1:2	6 OF 6

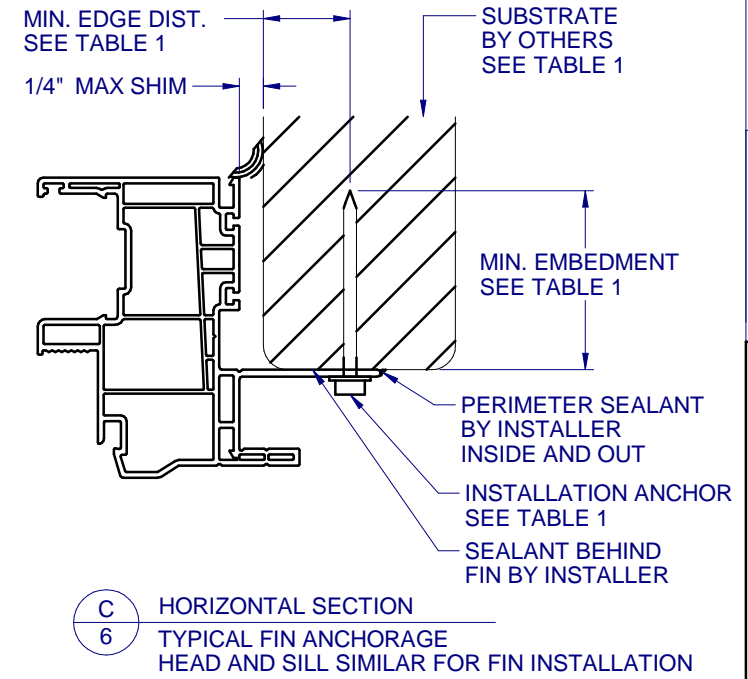
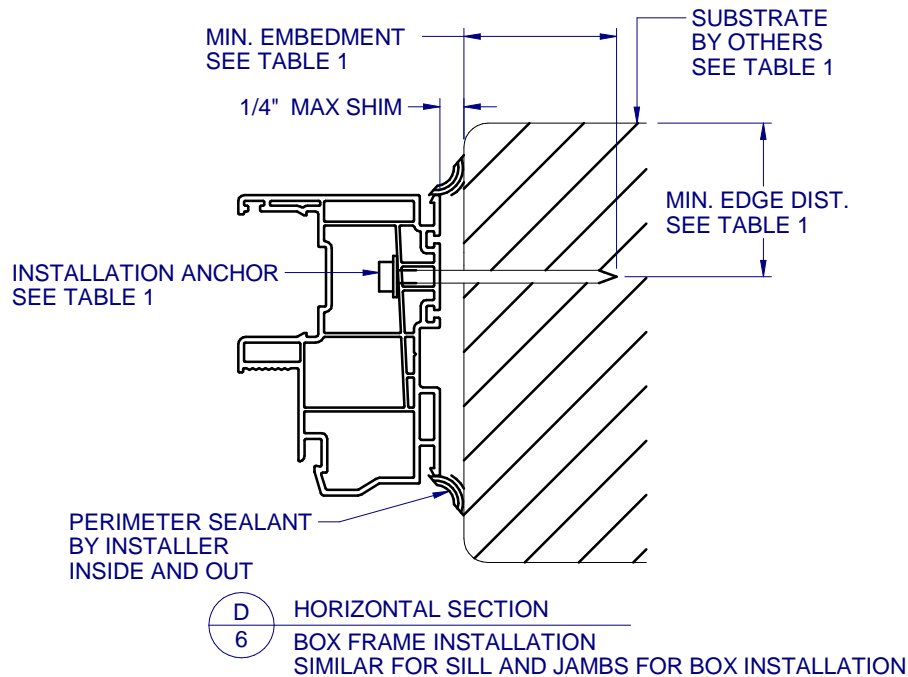
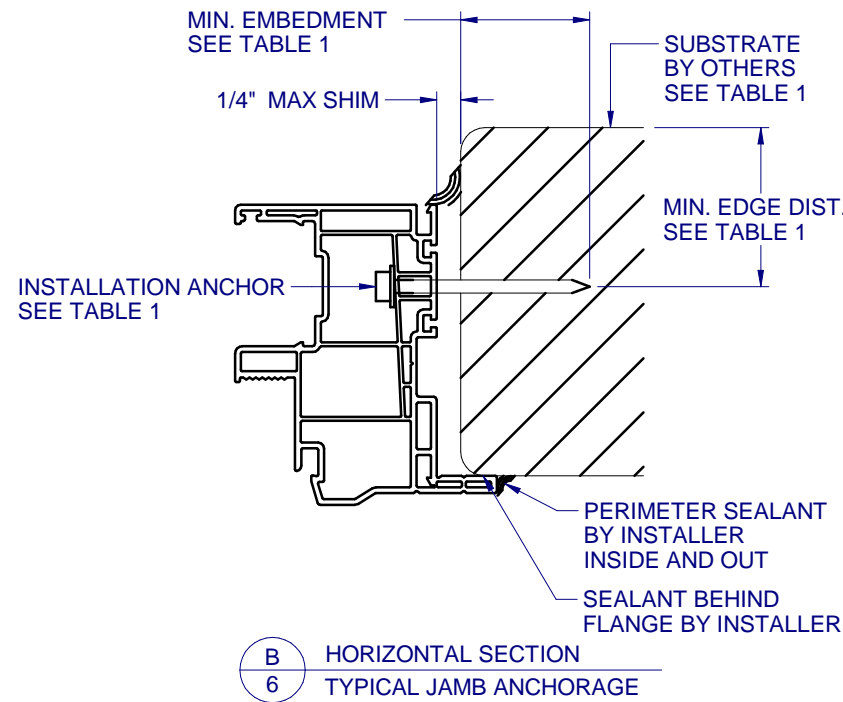
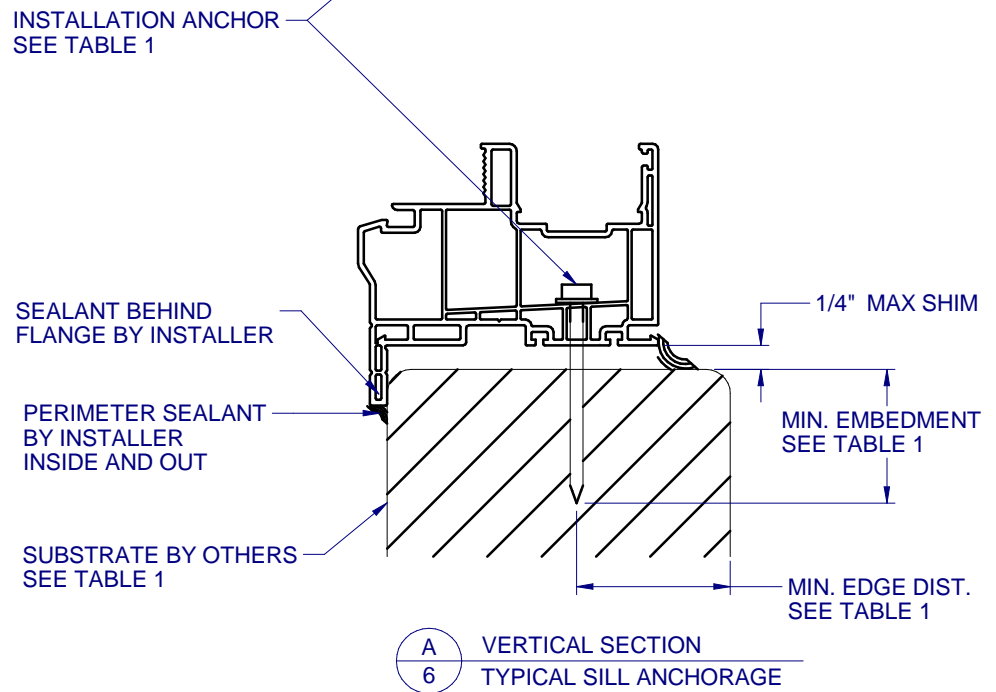
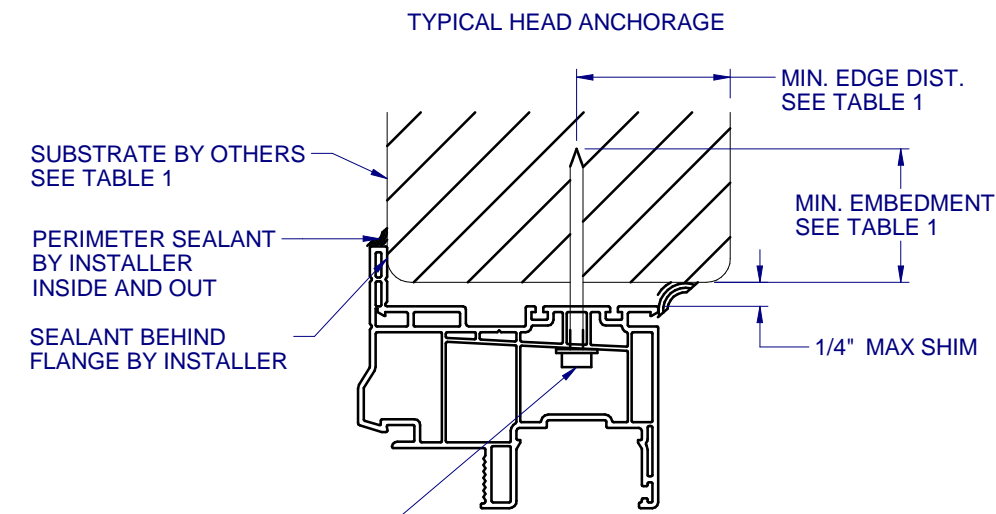

NOTE: ADDITIONAL THRU-FRAME ANCHORS (AS SHOWN IN DET. A/6) REQ'D AT THE HEAD AND SILL AT MULLION, SEE SHEET 5 ANCHOR LAYOUT.

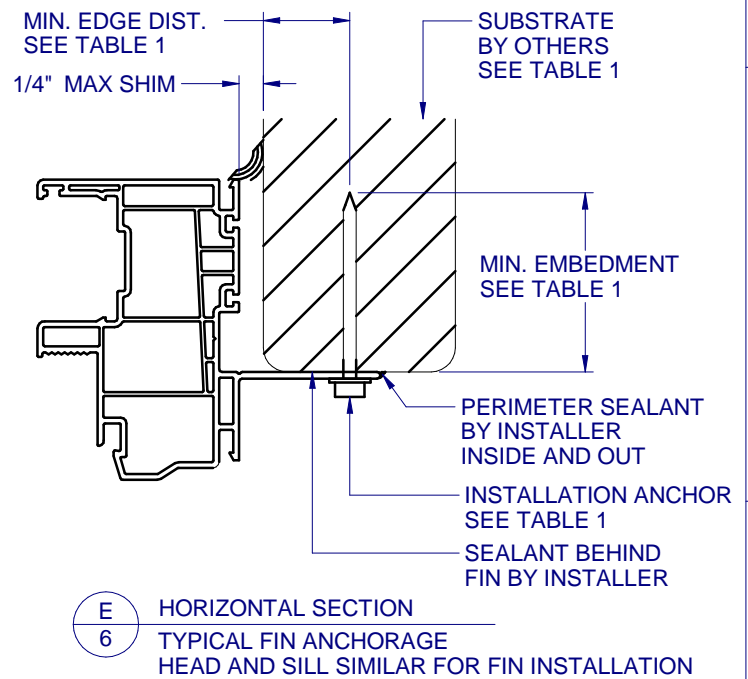

FLANGE REMOVAL NOTE: PARTIALLY OR FULLY REMOVING THE FLANGE, UP TO AND INCLUDING A BOX-FRAME APPLICATION IS ACCEPTABLE PROVIDED:

- MIN. 1/4" FILLET OF CONSTRUCTION-GRADE ADHESIVE CAULK IS APPLIED INSIDE AND OUT, FULL PERIMETER, BY INSTALLER.
- PRODUCT ANCHORAGE IS IN ACCORDANCE WITH REQUIREMENTS AS SHOWN FOR FLANGE WINDOWS.

FRAME TYPE	SUBSTRATE TYPE	ANCHOR TYPE	MIN. EMBEDMENT	MIN. EDGE DIST.
FLANGE	CONCRETE (2.0 KSI MIN.)	3/16" ITW TAPCON	1"	1-1/8"
FLANGE	HOLLOW OR GROUT-FILLED CMU (117 PCF MIN.)	3/16" ITW TAPCON	1"	2"
FLANGE	CONCRETE (3.05 KSI MIN.)	3/16" DEWALT ULTRACON+	1-3/4"	1"
FLANGE	HOLLOW OR GROUT-FILLED CMU (ASTM C-90)	3/16" DEWALT ULTRACON+	1-1/4"	2-1/2"
FLANGE	2X MIN. SOUTHERN PINE (G=0.55)	3/16" ITW TAPCON OR DEWALT ULTRACON+	1-3/8"	7/8"
FLANGE	2X MIN. SOUTHERN PINE (G=0.55)	#10 WOOD SCREW	1-3/8"	7/8"
FLANGE	16 GAUGE (0.060") MIN. STEEL STUD (33 KSI YIELD MIN)	#10-16 HILTI KWIK-FLEX OR ITW TEKS SELF-DRILLING SCREW	FULL THREAD THRU 0.060"	7/16"
FLANGE	1/8" ALUM. (6063-T5 MIN.) OR 1/8" STEEL (33 KSI MIN.)	#10 GRADE 5 SELF-TAPPING / DRILLING SCREW	FULL THREAD THRU 0.125"	7/16"
FIN	2X MIN. SOUTHERN PINE (G=0.55)	#8 WOOD SCREW	1-1/2"	7/16"