

HORIZONTAL SLIDER - NON-IMPACT

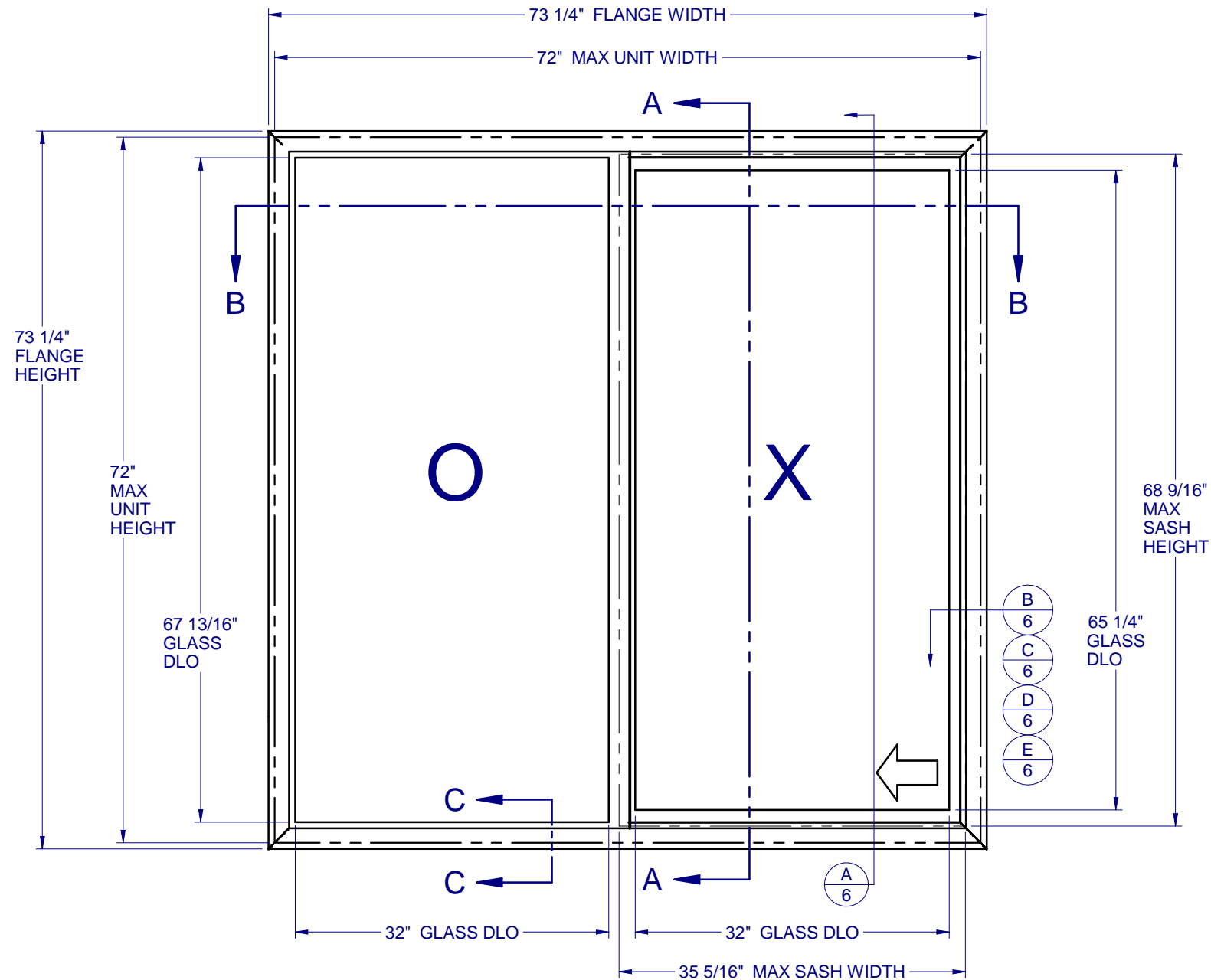

TABLE OF CONTENTS

GENERAL NOTES & ELEVATIONS.....	1
COMPARATIVE ANALYSIS & GLAZING DETAILS.....	2
SECTION VIEW & ALTERNATE FRAMES.....	3
BOM & EXTRUSIONS.....	4
ANCHOR SCHEDULE & NOTES.....	5
INSTALLATION DETAILS.....	6

MAX. UNIT SIZE	DESIGN PRESSURE RATING	IMPACT RATING
72" x 72"	SEE COMPARATIVE ANALYSIS CHART, SHEET 2	NONE

GENERAL NOTES:

1. THE PRODUCT SHOWN HEREIN IS DESIGNED AND MANUFACTURED TO COMPLY WITH THE FLORIDA BUILDING CODE (FBC), CURRENT EDITION.
2. GLAZING OPTIONS: (SEE SHEET 2)
3. CONFIGURATIONS: "OX", "XO".
4. DESIGN PRESSURE RATING (SEE SHEET 2):
 -NEGATIVE DESIGN LOADS BASED ON, TESTED PRESSURE AND GLASS TABLES ASTM E-1300-04e01/09.
 -POSITIVE DESIGN LOADS BASED ON, TESTED PRESSURE, WATER INFILTRATION TEST PRESSURE AND GLASS TABLES ASTM E-1300-04e01/09.
5. ANCHORAGE: THE 33 1/3% STRESS INCREASE HAS NOT BEEN USED IN THE DESIGN OF THIS PRODUCT. SEE SHEET 6 FOR ANCHOR DETAILS. WINDLOAD DURATION FACTOR Cd=1.6 WAS USED FOR WOOD ANCHOR CALCULATIONS.
6. NOT APPROVED FOR IMPACT RESISTANCE. IMPACT PROTECTIVE SYSTEM IS REQUIRED IN WIND BORNE DEBRIS REGION.
7. ALL FRAMES AND VENTS FULLY WELDED. SMALL JOINT SEAM SEALANT USED AT FIXED MEETING RAIL AND HEAD/SILL.
8. SERIES / MODEL DESIGNATION HS-8200.
9. THE DESIGNATION X AND O STAND FOR THE FOLLOWING:
 X = OPERABLE SASH, O = FIXED SASH
10. SECTION CALLOUTS APPLY TO ALL ELEVATIONS IN A SIMILAR LOCATION.
11. EXTERNAL WEEP SLOT = 1/4" x 1" LOCATED 4" FROM BOTH ENDS.



520 PVC SLIDING WINDOW NON-IMPACT

PROPRIETARY AND CONFIDENTIAL
 THE INFORMATION CONTAINED IN THIS DRAWING IS THE SOLE PROPERTY OF CUSTOM WINDOW SYSTEMS, INC. ANY REPRODUCTION IN PART OR AS A WHOLE WITHOUT THE WRITTEN PERMISSION OF CUSTOM WINDOW SYSTEMS, INC IS PROHIBITED.

FLORIDA APPROVAL NO.:
33448



8/15/2023

LUCAS A. TURNER, P.E.
 FL PE # 58201
 Turner Engineering & Consulting, Inc.
 2428 Old Natchez Trc Trl
 Camden, TN 38320
 PH. 941-380-1574

SHEET DESCRIPTION:

GENERAL NOTES AND ELEVATIONS

DRAWN BY: MCS	DATE: 7/28/2023
DWG #: PEL-223	REV.: A
SCALE: 1:15	SHEET 1 OF 6

Equal Split OX or XO Design Pressures (PSF)

Unit Height (in.)	Glass Type	Unit Width (in.)										
		35 1/2	39 1/2	43 1/2	47 1/2	51 1/2	55 1/2	59 1/2	63 1/2	67 1/2	72	
35 1/2	A	+60.0 / -60.0	+60.0 / -60.0	+60.0 / -60.0	+60.0 / -60.0	+60.0 / -60.0	+60.0 / -60.0	+60.0 / -60.0	+58.6 / -58.6	+51.4 / -51.4	+45.5 / -45.5	+40.0 / -40.0
	B, C, D	+60.0 / -60.0	+60.0 / -60.0	+60.0 / -60.0	+60.0 / -60.0	+60.0 / -60.0	+60.0 / -60.0	+60.0 / -60.0	+58.6 / -58.6	+51.4 / -51.4	+45.5 / -45.5	+40.0 / -40.0
39 1/2	A	+60.0 / -60.0	+60.0 / -60.0	+60.0 / -60.0	+60.0 / -60.0	+60.0 / -60.0	+60.0 / -60.0	+60.0 / -60.0	+58.6 / -58.6	+51.4 / -51.4	+45.5 / -45.5	+40.0 / -40.0
	B, C, D	+60.0 / -60.0	+60.0 / -60.0	+60.0 / -60.0	+60.0 / -60.0	+60.0 / -60.0	+60.0 / -60.0	+60.0 / -60.0	+58.6 / -58.6	+51.4 / -51.4	+45.5 / -45.5	+40.0 / -40.0
43 1/2	A	+60.0 / -60.0	+60.0 / -60.0	+60.0 / -60.0	+60.0 / -60.0	+60.0 / -60.0	+60.0 / -60.0	+60.0 / -60.0	+58.6 / -58.6	+51.4 / -51.4	+45.5 / -45.5	+40.0 / -40.0
	B, C, D	+60.0 / -60.0	+60.0 / -60.0	+60.0 / -60.0	+60.0 / -60.0	+60.0 / -60.0	+60.0 / -60.0	+60.0 / -60.0	+58.6 / -58.6	+51.4 / -51.4	+45.5 / -45.5	+40.0 / -40.0
47 1/2	A	+60.0 / -60.0	+60.0 / -60.0	+60.0 / -60.0	+60.0 / -60.0	+60.0 / -60.0	+60.0 / -60.0	+60.0 / -60.0	+58.6 / -58.6	+51.4 / -51.4	+45.5 / -45.5	+40.0 / -40.0
	B, C, D	+60.0 / -60.0	+60.0 / -60.0	+60.0 / -60.0	+60.0 / -60.0	+60.0 / -60.0	+60.0 / -60.0	+60.0 / -60.0	+58.6 / -58.6	+51.4 / -51.4	+45.5 / -45.5	+40.0 / -40.0
51 1/2	A	+60.0 / -60.0	+60.0 / -60.0	+60.0 / -60.0	+60.0 / -60.0	+60.0 / -60.0	+60.0 / -60.0	+60.0 / -60.0	+58.6 / -58.6	+51.4 / -51.4	+45.5 / -45.5	+40.0 / -40.0
	B, C, D	+60.0 / -60.0	+60.0 / -60.0	+60.0 / -60.0	+60.0 / -60.0	+60.0 / -60.0	+60.0 / -60.0	+60.0 / -60.0	+58.6 / -58.6	+51.4 / -51.4	+45.5 / -45.5	+40.0 / -40.0
55 1/2	A	+60.0 / -60.0	+60.0 / -60.0	+60.0 / -60.0	+60.0 / -60.0	+60.0 / -60.0	+60.0 / -60.0	+60.0 / -60.0	+58.6 / -58.6	+51.4 / -51.4	+45.5 / -45.5	+40.0 / -40.0
	B, C, D	+60.0 / -60.0	+60.0 / -60.0	+60.0 / -60.0	+60.0 / -60.0	+60.0 / -60.0	+60.0 / -60.0	+60.0 / -60.0	+58.6 / -58.6	+51.4 / -51.4	+45.5 / -45.5	+40.0 / -40.0
59 1/2	A	+60.0 / -60.0	+60.0 / -60.0	+60.0 / -60.0	+60.0 / -60.0	+60.0 / -60.0	+60.0 / -60.0	+60.0 / -60.0	+58.6 / -58.6	+51.4 / -51.4	+45.5 / -45.5	+40.0 / -40.0
	B, C, D	+60.0 / -60.0	+60.0 / -60.0	+60.0 / -60.0	+60.0 / -60.0	+60.0 / -60.0	+60.0 / -60.0	+60.0 / -60.0	+58.6 / -58.6	+51.4 / -51.4	+45.5 / -45.5	+40.0 / -40.0
63 1/2	A	+60.0 / -60.0	+60.0 / -60.0	+60.0 / -60.0	+60.0 / -60.0	+55.8 / -55.8	+54.8 / -54.8	+53.8 / -53.8	+51.4 / -51.4	+45.5 / -45.5	+40.0 / -40.0	+40.0 / -40.0
	B, C, D	+60.0 / -60.0	+60.0 / -60.0	+60.0 / -60.0	+60.0 / -60.0	+59.7 / -59.7	+56.5 / -56.5	+53.8 / -53.8	+51.4 / -51.4	+45.5 / -45.5	+40.0 / -40.0	+40.0 / -40.0
67 1/2	A	+60.0 / -60.0	+60.0 / -60.0	+60.0 / -60.0	+56.6 / -56.6	+51.8 / -51.8	+50.2 / -50.2	+49.7 / -49.7	+47.4 / -47.4	+45.5 / -45.5	+40.0 / -40.0	+40.0 / -40.0
	B, C, D	+60.0 / -60.0	+60.0 / -60.0	+60.0 / -60.0	+58.9 / -58.9	+55.3 / -55.3	+52.3 / -52.3	+49.7 / -49.7	+47.4 / -47.4	+45.5 / -45.5	+40.0 / -40.0	+40.0 / -40.0
72	A	+60.0 / -60.0	+60.0 / -60.0	+58.5 / -58.5	+54.2 / -54.2	+48.4 / -48.4	+45.9 / -45.9	+45.6 / -45.6	+43.6 / -43.6	+41.8 / -41.8	+40.0 / -40.0	+40.0 / -40.0
	B, C, D	+60.0 / -60.0	+60.0 / -60.0	+58.5 / -58.5	+54.5 / -54.5	+51.1 / -51.1	+48.2 / -48.2	+45.8 / -45.8	+43.6 / -43.6	+41.8 / -41.8	+40.0 / -40.0	+40.0 / -40.0



520 PVC SLIDING WINDOW NON-IMPACT

PROPRIETARY AND CONFIDENTIAL
 THE INFORMATION CONTAINED IN THIS DRAWING IS THE SOLE PROPERTY OF CUSTOM WINDOW SYSTEMS, INC. ANY REPRODUCTION IN PART OR AS A WHOLE WITHOUT THE WRITTEN PERMISSION OF CUSTOM WINDOW SYSTEMS, INC IS PROHIBITED.

FLORIDA APPROVAL NO.:
 33448



8/15/2023
 LUCAS A. TURNER, P.E.
 FL PE # 58201
 Turner Engineering & Consulting, Inc.
 2428 Old Natchez Trc Trl
 Camden, TN 38320
 PH. 941-380-1574

SHEET DESCRIPTION:
COMPARATIVE ANALYSIS AND GLAZING DETAILS

DRAWN BY: MCS	DATE: 7/28/2023
DWG #: PEL-223	REV.: A
SCALE: 1:1	SHEET 2 OF 6

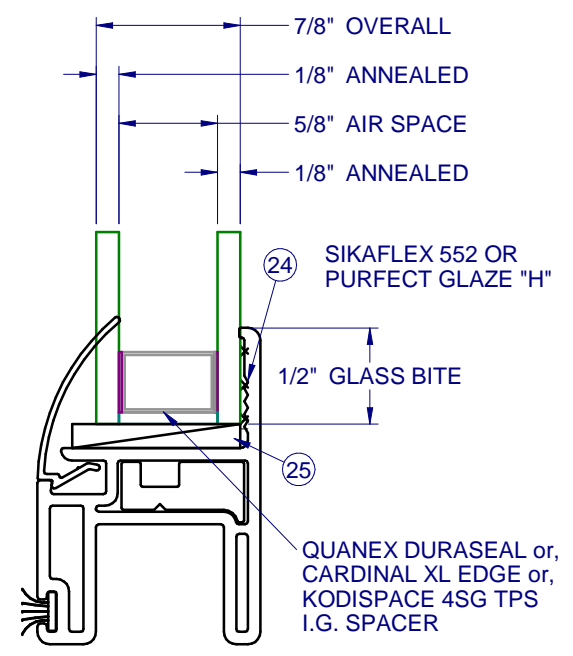

GLASS TYPE A

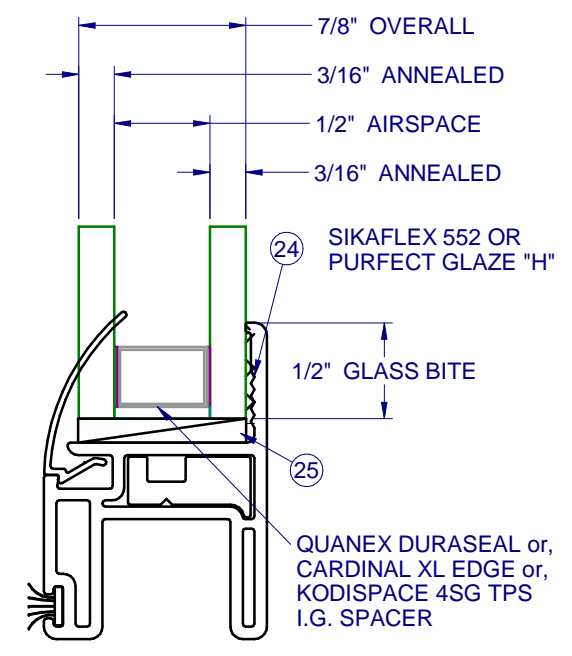

GLASS TYPE B

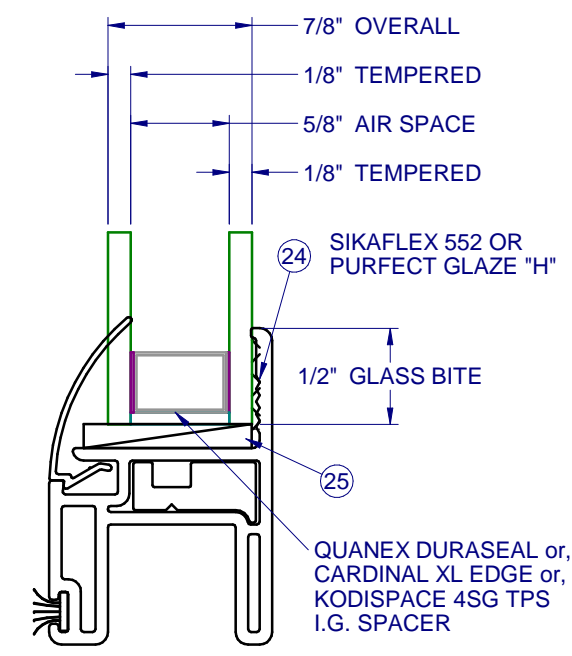

GLASS TYPE C

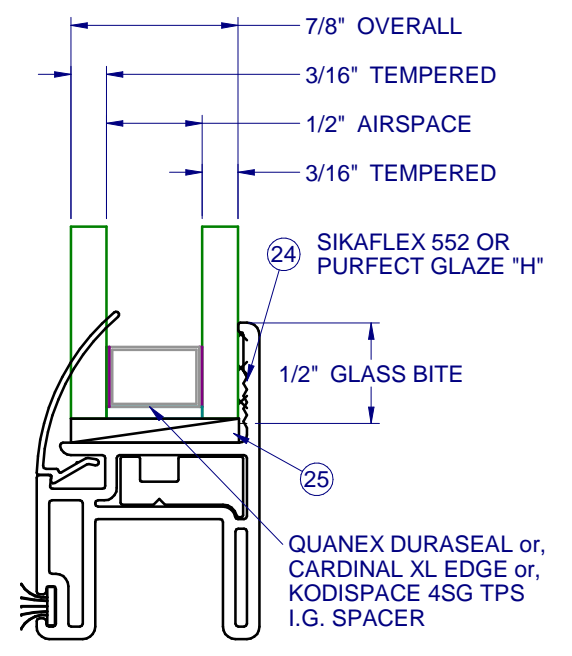

GLASS TYPE D

NOTE: IF SIZE INTENDED IS NOT SHOWN, USE NEXT LARGER SIZE

**520 PVC
 SLIDING WINDOW
 NON-IMPACT**

PROPRIETARY AND CONFIDENTIAL
 THE INFORMATION CONTAINED IN
 THIS DRAWING IS THE SOLE
 PROPERTY OF CUSTOM WINDOW
 SYSTEMS, INC. ANY
 REPRODUCTION IN PART OR AS A
 WHOLE WITHOUT THE WRITTEN
 PERMISSION OF CUSTOM WINDOW
 SYSTEMS, INC IS PROHIBITED.

FLORIDA APPROVAL NO.:
 33448

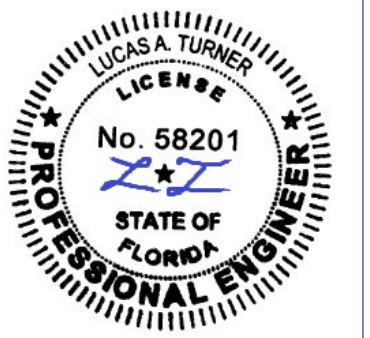

8/15/2023
 LUCAS A. TURNER, P.E.
 FL PE # 58201
 Turner Engineering &
 Consulting, Inc.
 2428 Old Natchez Trc Trl
 Camden, TN 38320
 PH. 941-380-1574

SHEET DESCRIPTION:
**SECTION VIEW &
 ALTERNATE FRAMES**

DRAWN BY: MCS	DATE: 7/28/2023
DWG #: PEL-223	REV.: A
SCALE: 1:2	SHEET 3 OF 6

INTERIOR

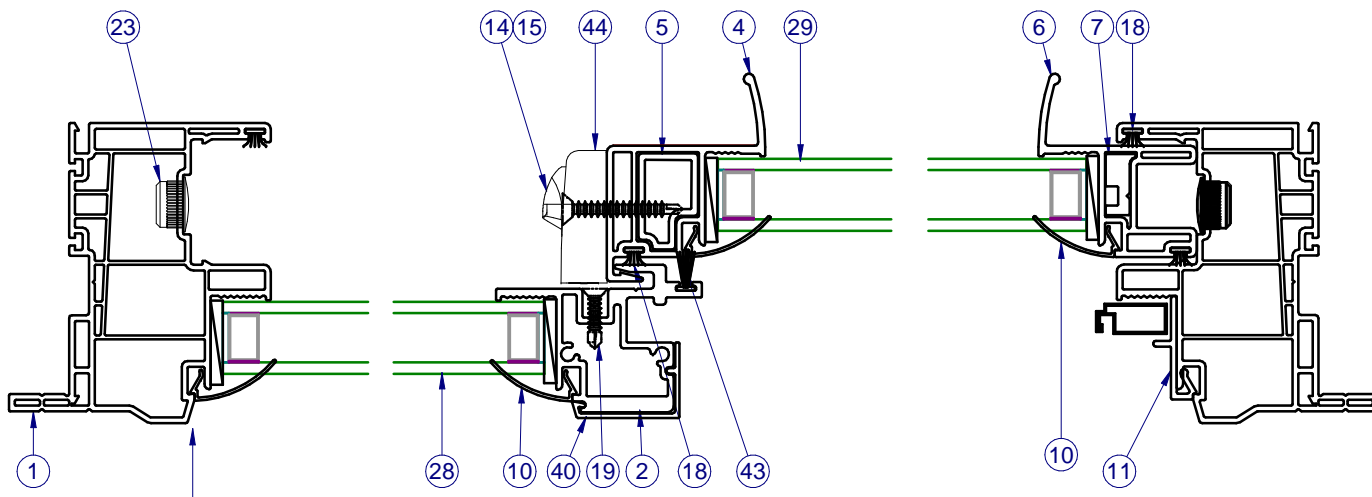

SECTION VIEW B-B
 NOTE: FIXED LITE AT HEAD
 AND SILL IS SIMILAR.

INTERIOR

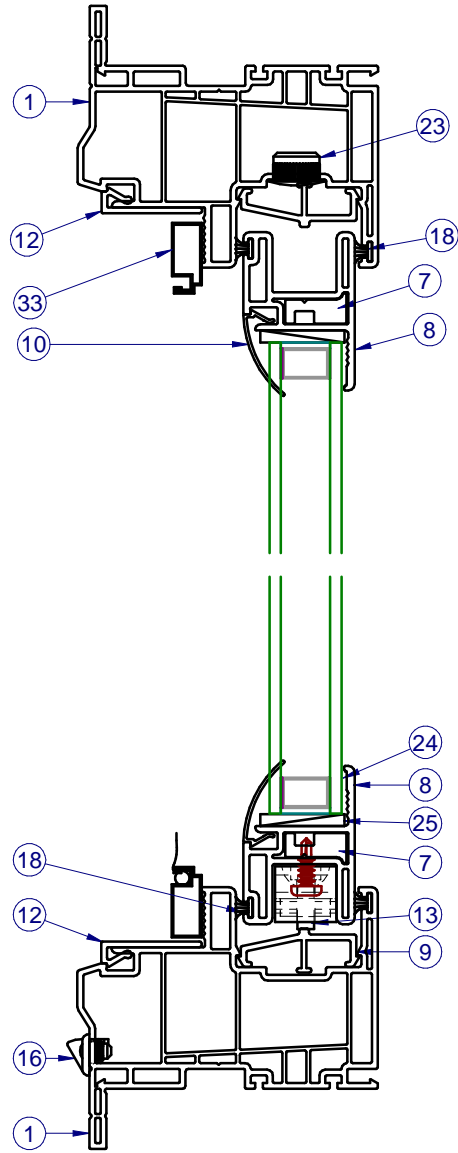

SECTION VIEW A-A

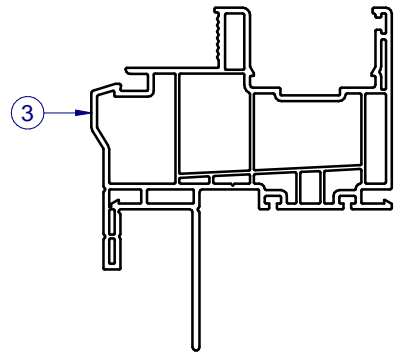

SECTION C-C
 ALT. FIN/FLANGE FRAME

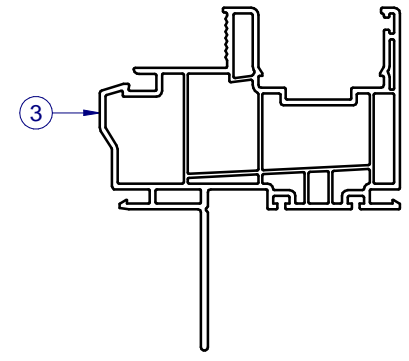

SECTION C-C
 ALT. FIN FRAME

NOTE: ITEMS NOT SHOWN FOR CLARITY:
 22, 30-31

PARTS LIST			
ITEM	PART #	DESCRIPTION	MATERIAL
1	H-6222	Main Fr., SH, w/Flg., PVC	PVC
2	H-2121	Meet. Rail, Fxd.	Alum
3	H-6231	Main Fr., SH, w/Fin., PVC	PVC
4	H-6224	Sash Meet. Rail, PVC	PVC
5	H-2124	Reinf. Sash Meet. Rail	Alum
6	H-6223	Sash Bottom Rail, PVC (S.S.R. for HS)	PVC
7	S-2129	Reinf. S.B.R./S.S.R/S.T.R.	Alum
8	H-6225	Sash Top/Bot. Rail	PVC
9	S-1776	Roller track	Alum
10	S-6237	Glz. Bd., 7/8",Fxd., Horiz.	PVC
11	S-6226	Scrm. Adapt., w/ Nib, PVC	PVC
12	S-6227	Scrm. Adapt., PVC	PVC
13	P-5241	Roller, Tandem	Nylon
14	P-3783	Lock, Impact, PVC	Zinc
15	P-4069	Keeper, Impact, PVC	Zinc
16	P-4479	Weep Cover w/ Flap	Nylon
18	P-3429	Wstp., 0.270 x .187 back FinSeal, Gray	
19	P-3539	#8 x 0.75" Ph PH Tek@keeper	Steel
20	P-3541	#8 x 0.5 Ph PH Tek@roller	Steel
21	P-4051W	#8 x 1.250 Ph FH TEK, Wht.@lock	Steel
22	P-3342	Seam Sealer, SM-5504	Silicone
23	P-5588	Cap Plug, 1/2" Hole	Nylon
24	P-4648	Purfect Glaze "H", Sika Flex 552	Silicone
25	P-5612	Set. Blk., 85 Dur., 1/8" x 1" x 2" Lg.	Rubber
26	P-3683	HS-8200 Gold Cert. Label	
27	P-3881	Temporary Lbl. (NFRC/DP)	
28	Fixed	SEE SHEET 2	
29	Sash	SEE SHEET 2	
30		Spacer, See SHT 2	
33	P-3218	Screen Frame, Horz.	RollForm
34	P-4754	Screen Frame Corner Key	Nylon
35	P-3581	Screen Cloth, 18 x 16 Fiberglass	
36	P-5576	Screen Spline, .155 Dia., Blk.	
37	P-3029	Screen Pull Tab	
38	P-3195	Screen Spring, SS	
40	S-6228	Fixed rail Cover	PVC
42	P-4638	#8 x 2 1/2", PH, Modified Truss, TEK2	Steel
43	P-4959	Wstp., 0.420 x .187 back FinSeal, Gray	

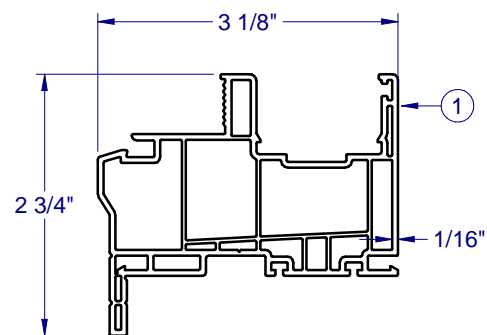

PVC FRAME FLANGE
H-6222

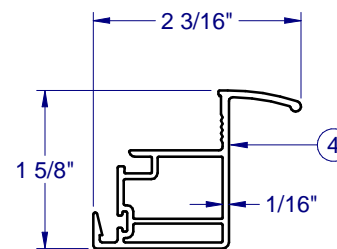

PVC SASH MTG RAIL
H-6224

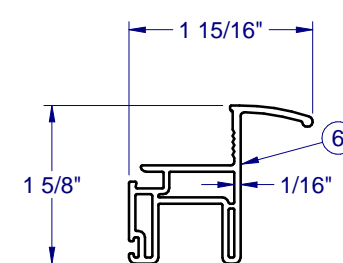

PVC SASH PULL
RAIL/STILE
H-6223

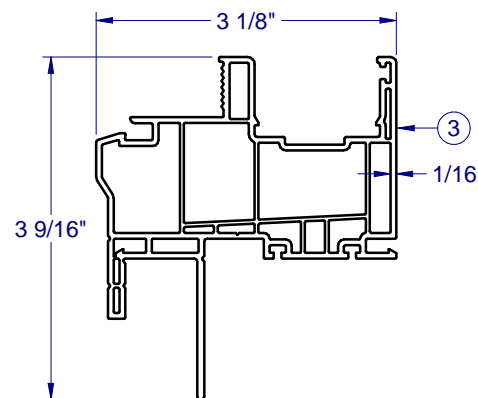

PVC FRAME FIN/FLANGE
H-6231

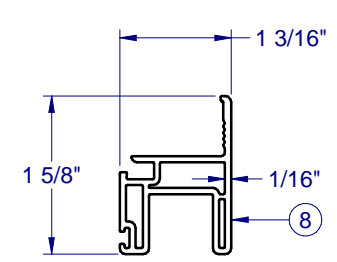

PVC SASH RAIL/STILE
H-6225

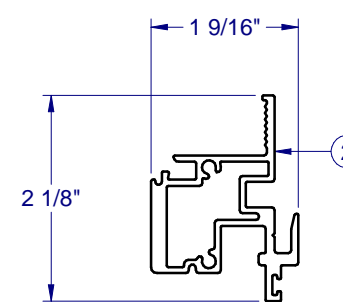

MTG RAIL
H-2121

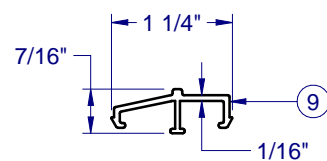

ROLLER TRACK
S-1776

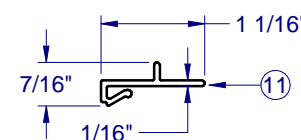

PVC SCREEN CATCH
S-6226

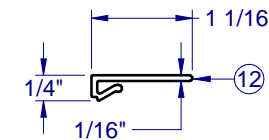

PVC SCREEN SUPPORT
S-6227

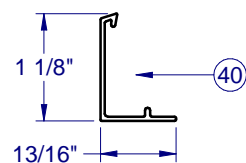

PVC MTG RAIL COVER
S-6228

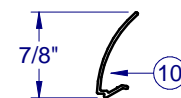

PVC GLAZING BEAD
S-6237

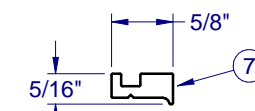

REINF. SBR/SSR
S-2129

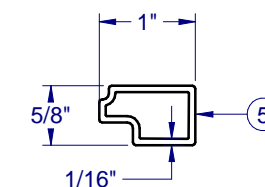

REINF. SASH MTG RAIL
H-2124

CORNER CONSTRUCTION

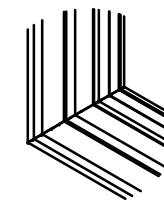

CORNER WELD
(ALL SIDES)
1:8

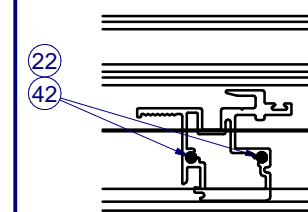

FIXED MEETING RAIL
SCREWED TOGETHER WITH
OUTERFRAME
1:8



Pella Corporation
102 Main Street
Pella, IA 50219
www.pella.com

**520 PVC
SLIDING WINDOW
NON-IMPACT**

PROPRIETARY AND CONFIDENTIAL
THE INFORMATION CONTAINED IN
THIS DRAWING IS THE SOLE
PROPERTY OF CUSTOM WINDOW
SYSTEMS, INC. ANY
REPRODUCTION IN PART OR AS A
WHOLE WITHOUT THE WRITTEN
PERMISSION OF CUSTOM WINDOW
SYSTEMS, INC IS PROHIBITED.

FLORIDA APPROVAL NO.:
33448

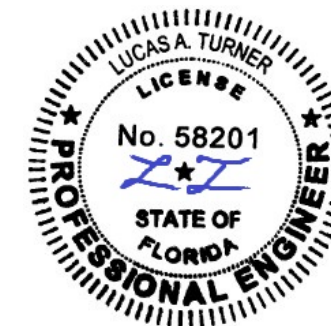

8/15/2023

LUCAS A. TURNER, P.E.
FL PE # 58201
Turner Engineering &
Consulting, Inc.
2428 Old Natchez Trc Trl
Camden, TN 38320
PH. 941-380-1574

SHEET DESCRIPTION:

BOM AND EXTRUSIONS

DRAWN BY:	DATE:
MCS	7/28/2023
DWG #:	REV.:
PEL-223	A
SCALE:	SHEET
1:2	4 OF 6

LINE ITEMS NOT USED:
17, 31-32

NOTE: ALL ALUMINUM EXTRUSIONS ARE 6063-T6 UNLESS OTHERWISE NOTED.

**520 PVC
 SLIDING WINDOW
 NON-IMPACT**

PROPRIETARY AND CONFIDENTIAL
 THE INFORMATION CONTAINED IN
 THIS DRAWING IS THE SOLE
 PROPERTY OF CUSTOM WINDOW
 SYSTEMS, INC. ANY
 REPRODUCTION IN PART OR AS A
 WHOLE WITHOUT THE WRITTEN
 PERMISSION OF CUSTOM WINDOW
 SYSTEMS, INC IS PROHIBITED.

FLORIDA APPROVAL NO.:
 33448



8/15/2023

LUCAS A. TURNER, P.E.
 FL PE # 58201
 Turner Engineering &
 Consulting, Inc.
 2428 Old Natchez Trc Trl
 Camden, TN 38320
 PH. 941-380-1574

SHEET DESCRIPTION:
**ANCHOR SCHEDULE AND
 NOTES**

DRAWN BY:	DATE:
MCS	7/28/2023
DWG #:	REV.:
PEL-223	A
SCALE:	SHEET
1:20	5 OF 6

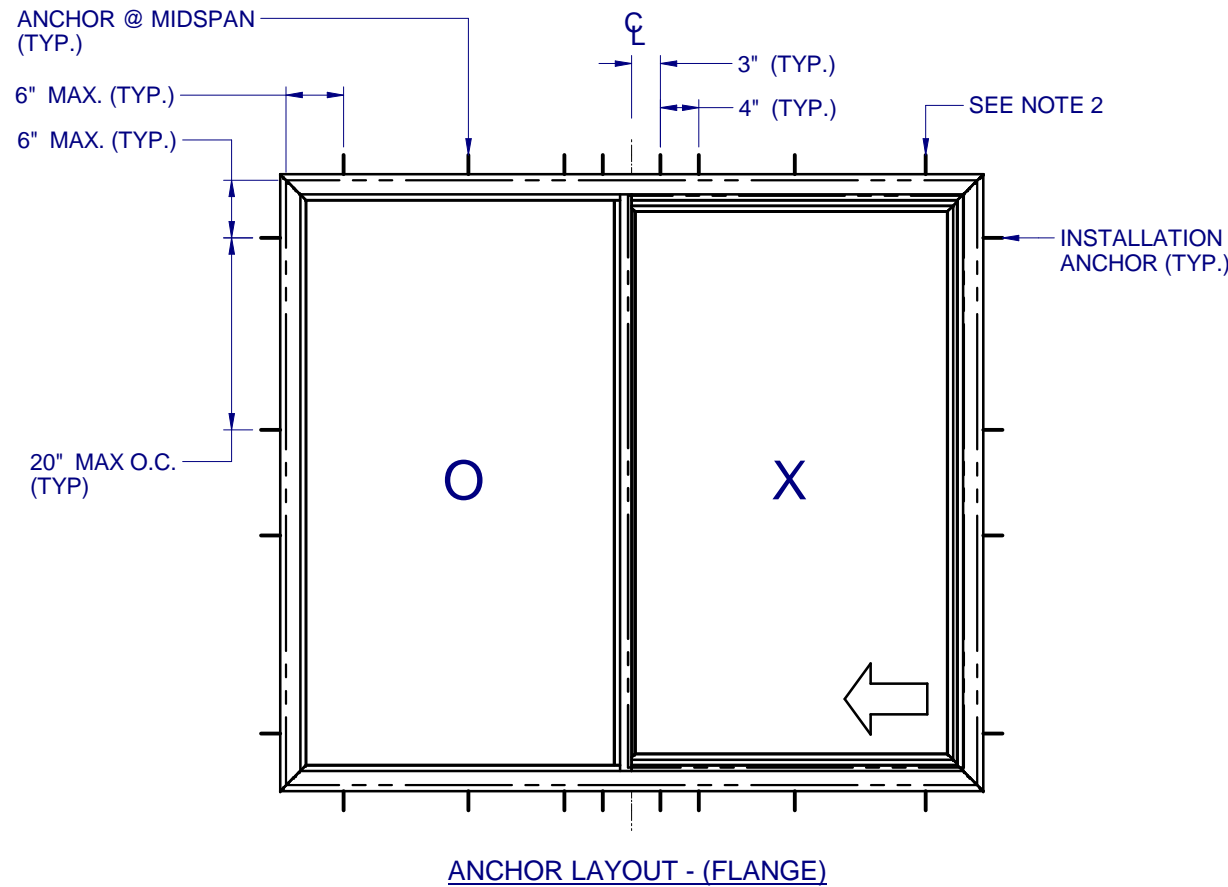

ANCHOR LAYOUT - (FLANGE)

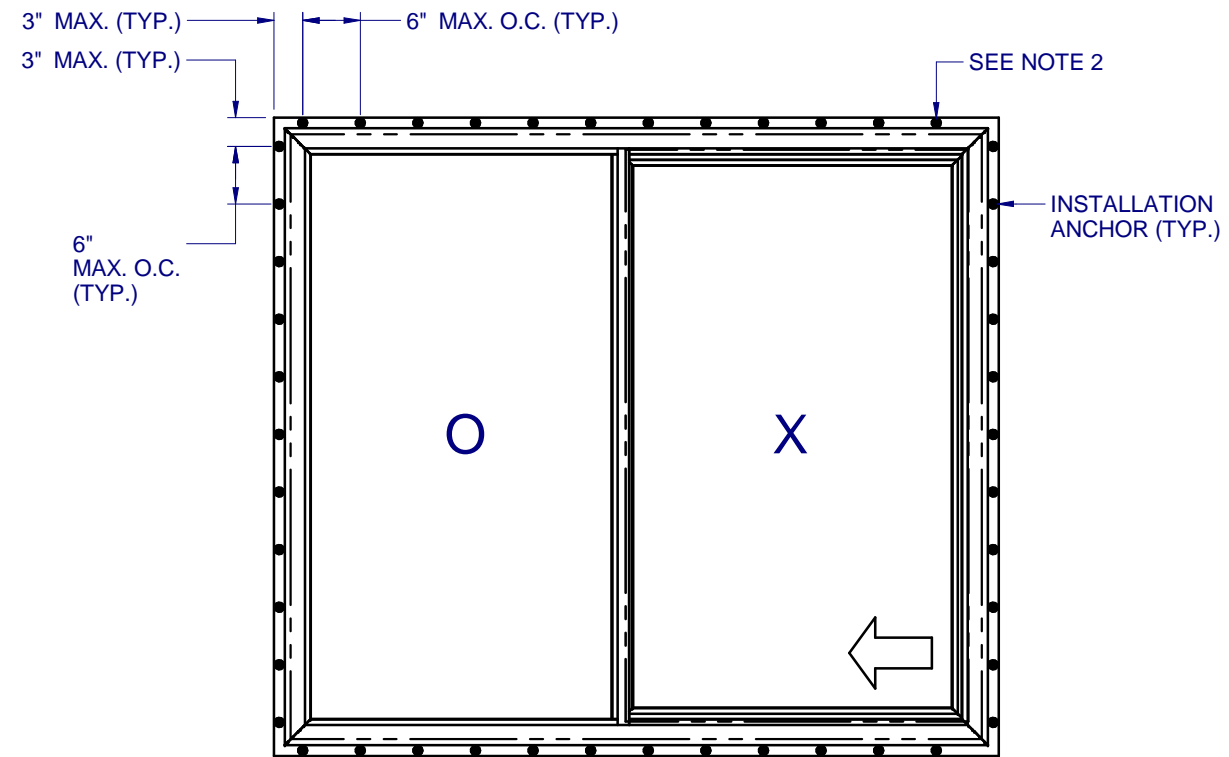

ANCHOR LAYOUT - (FIN)

NOTES:

1. INSTALL ONE ANCHOR AT EACH INSTALLATION LOCATION. SILL ANCHOR SPACING SAME AS HEAD.
2. SHIM AS REQ AT EACH INSTALLATION ANCHOR USING LOAD BEARING SHIMS. MAX. ALLOWABLE SHIM STACK TO BE 1/4". USE SHIMS WHERE SPACE GREATER THAN 1/16" IS PRESENT. LOAD BEARING SHIMS SHALL BE CONSTRUCTED OF HIGH DENSITY PLASTIC OR BETTER. WOOD SHIMS ARE NOT ALLOWED.
3. ANCHOR TYPE, SIZE, SPACING AND EMBEDMENT SHALL BE AS SPECIFIED IN THESE DRAWINGS, SEE TABLE 1, SHEET 6.
4. ALL INSTALLATION ANCHORS MUST BE MADE OF OR PROTECTED WITH A CORROSION RESISTANT MATERIAL OR COATING. DISSIMILAR METALS OR MATERIALS IN CONTACT WITH PRESSURE TREATED WOOD MUST BE PROTECTED TO PREVENT REACTION.
5. INSTALLATION ANCHORS SHALL BE IN ACCORDANCE WITH ANCHOR MANUFACTURER'S INSTALLATION INSTRUCTIONS, AND ANCHORS SHALL NOT BE USED IN SUBSTRATES WITH STRENGTHS LESS THAN THE MINIMUM SPECIFIED IN TABLE 1, SHEET 6.
6. ANCHOR EMBEDMENT TO SUBSTRATE SHALL BE BEYOND WALL DRESSING OR STUCCO. FOR CONCRETE/CMU OPENINGS, EMBEDMENT SHALL BE BEYOND WOOD BUCKS, IF USED, INTO SUBSTRATE - 1X BUCKS ARE OPTIONAL.
7. A MINIMUM CENTER-TO-CENTER SPACING SHALL BE MAINTAINED BETWEEN ALL FASTENERS: 3" FOR MASONRY, 1" FOR WOOD AND METAL.
8. WOOD OR MASONRY OPENINGS, BUCKS AND BUCK FASTENERS SHALL BE PROPERLY DESIGNED BY THE ARCHITECT OR ENGINEER OF RECORD AND INSTALLED TO TRANSFER WIND LOADS TO THE STRUCTURE. SUBSTRATES SHALL MEET THE MINIMUM STRENGTH REQUIREMENTS AS SHOWN IN TABLE 1, SHEET 6. CONCRETE AND MASONRY SUBSTRATES MAY NOT BE CRACKED.
9. SEALING AND FLASHING STRATEGIES FOR OVERALL WATER RESISTANCE OF INSTALLATION SHALL BE DONE BY OTHERS FOLLOWING THE CURRENT VERSION OF THE REFERENCE DOCUMENTS: FMA/AAMA 100(FIN WINDOWS), FMA/AAMA 200(FLANGE WINDOWS), FMA/WDMA 250(BOX WINDOWS), FMA/AAMA/WDMA 300(EXTERIOR DOORS)

**520 PVC
 SLIDING WINDOW
 NON-IMPACT**

PROPRIETARY AND CONFIDENTIAL
 THE INFORMATION CONTAINED IN THIS DRAWING IS THE SOLE PROPERTY OF CUSTOM WINDOW SYSTEMS, INC. ANY REPRODUCTION IN PART OR AS A WHOLE WITHOUT THE WRITTEN PERMISSION OF CUSTOM WINDOW SYSTEMS, INC IS PROHIBITED.

FLORIDA APPROVAL NO.:
 33448



8/15/2023

LUCAS A. TURNER, P.E.
 FL PE # 58201
 Turner Engineering & Consulting, Inc.
 2428 Old Natchez Trc Trl
 Camden, TN 38320
 PH. 941-380-1574

SHEET DESCRIPTION:

INSTALLATION DETAILS

DRAWN BY:	DATE:
MCS	7/28/2023
DWG #:	REV.:
PEL-223	A
SCALE:	SHEET
1:2	6 OF 6

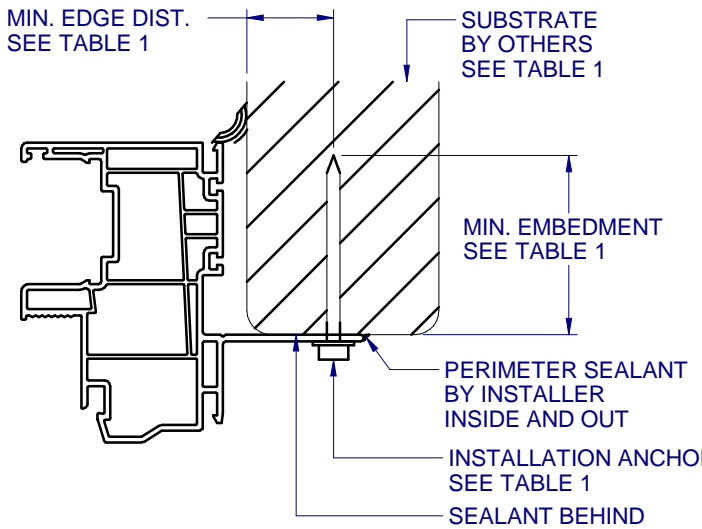
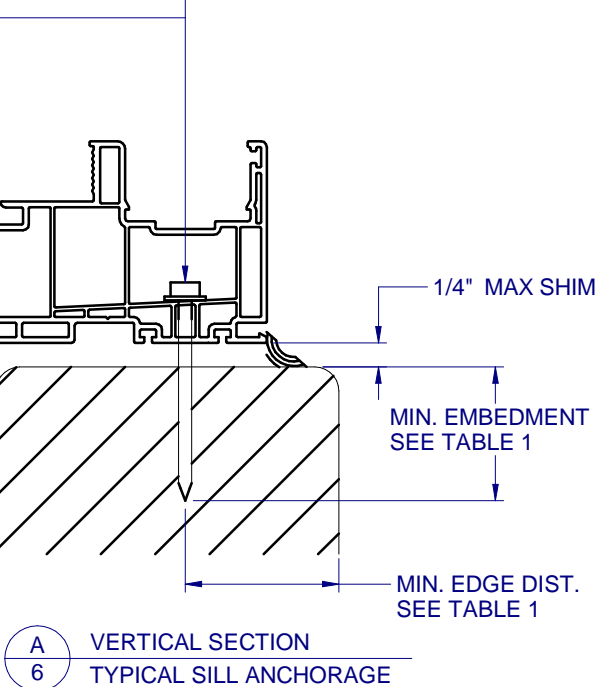
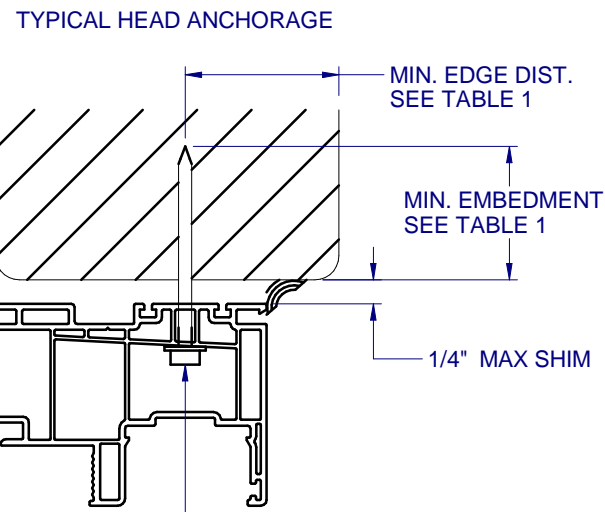

E HORIZONTAL SECTION
 6 TYPICAL FIN ANCHORAGE
 HEAD AND SILL SIMILAR FOR FIN INSTALLATION

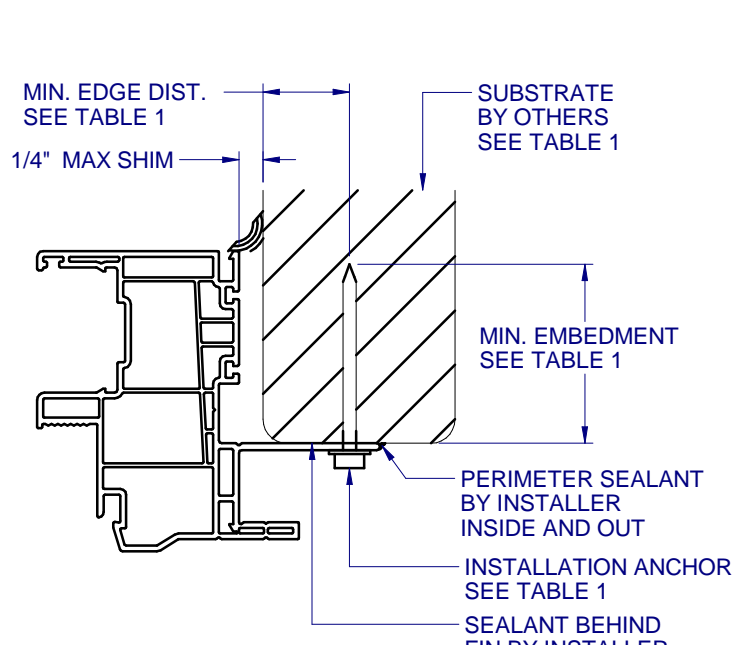
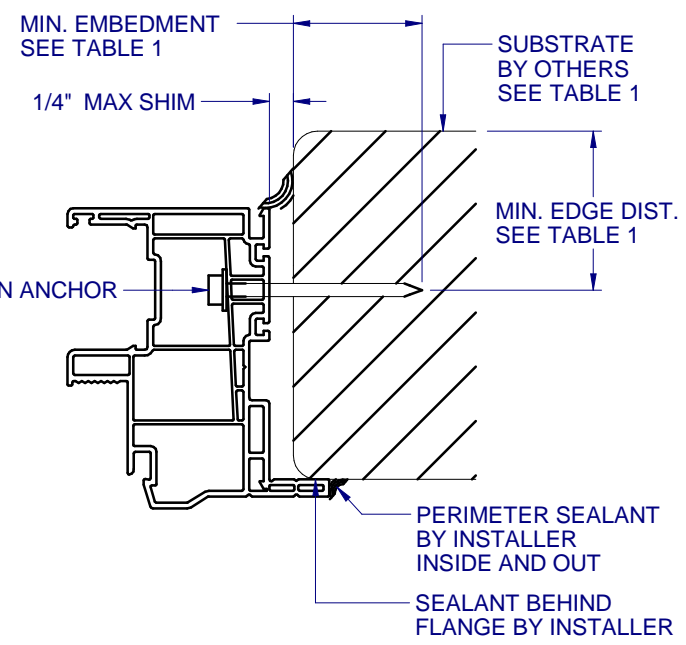

C HORIZONTAL SECTION
 6 TYPICAL FIN/FLANGE ANCHORAGE
 HEAD AND SILL SIMILAR FOR FIN INSTALLATION

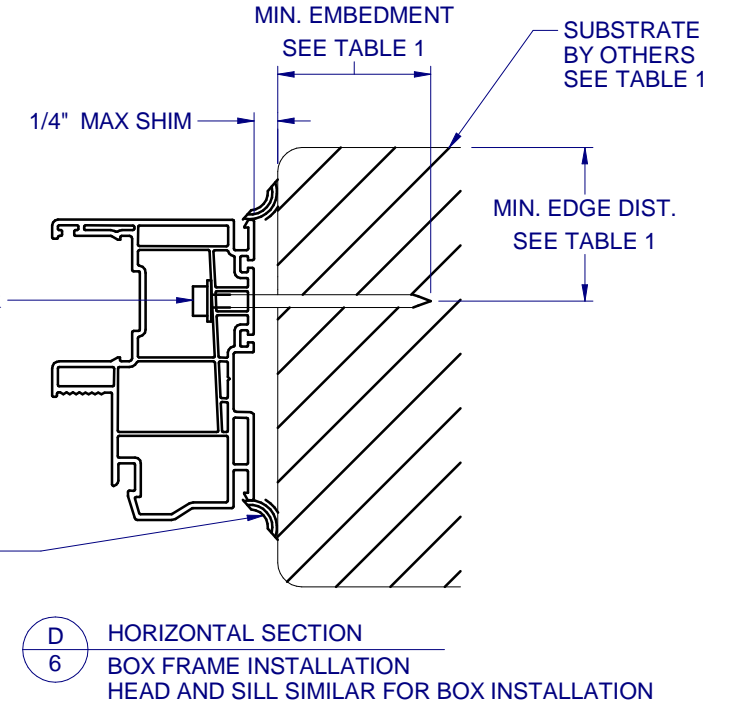

D HORIZONTAL SECTION
 6 BOX FRAME INSTALLATION
 HEAD AND SILL SIMILAR FOR BOX INSTALLATION

FRAME TYPE	SUBSTRATE TYPE	ANCHOR TYPE	MIN. EMBEDMENT	MIN. EDGE DIST.
FLANGE	CONCRETE (2.0 KSI MIN.)	3/16" ITW TAPCON	1-1/2"	1-1/8"
FLANGE	HOLLOW OR GROUT-FILLED CMU (117 PCF MIN.)	3/16" ITW TAPCON	1"	2"
FLANGE	CONCRETE (3.05 KSI MIN.)	3/16" DEWALT ULTRACON+	1-3/4"	1"
FLANGE	HOLLOW OR GROUT-FILLED CMU (ASTM C-90)	3/16" DEWALT ULTRACON+	1-1/4"	2-1/2"
FLANGE	2X MIN. SOUTHERN PINE (G=0.55)	3/16" ITW TAPCON OR DEWALT ULTRACON+	1-3/8"	7/8"
FLANGE	2X MIN. SOUTHERN PINE (G=0.55)	#10 WOOD SCREW	1-3/8"	7/8"
FLANGE	16 GAUGE (0.060") MIN. STEEL STUD (33 KSI YIELD MIN)	#10-16 HILTI KWIK-FLEX OR ITW TEKS SELF-DRILLING SCREW	FULL THREAD THRU 0.060"	7/16"
FLANGE	1/8" ALUM. (6063-T5 MIN.) OR 1/8" STEEL (33 KSI MIN.)	#10 GRADE 5 SELF-TAPPING / DRILLING SCREW	FULL THREAD THRU 0.125"	7/16"
FIN	2X MIN. SOUTHERN PINE (G=0.55)	#8 WOOD SCREW	1-1/2"	1/2"

FLANGE REMOVAL NOTE: PARTIALLY OR FULLY REMOVING THE FLANGE, UP TO AND INCLUDING A BOX-FRAME APPLICATION IS ACCEPTABLE PROVIDED:

- MIN. 1/4" FILLET OF CONSTRUCTION-GRADE ADHESIVE CAULK IS APPLIED INSIDE AND OUT, FULL PERIMETER, BY INSTALLER.
- PRODUCT ANCHORAGE IS IN ACCORDANCE WITH REQUIREMENTS AS SHOWN FOR FLANGE WINDOWS.