

SLIDING GLASS DOOR - NON-IMPACT



590 PVC SLIDING PATIO DOOR NON-IMPACT

PROPRIETARY AND CONFIDENTIAL
 THE INFORMATION CONTAINED IN THIS DRAWING IS THE SOLE PROPERTY OF CUSTOM WINDOW SYSTEMS, INC. ANY REPRODUCTION IN PART OR AS A WHOLE WITHOUT THE WRITTEN PERMISSION OF CUSTOM WINDOW SYSTEMS, INC IS PROHIBITED.

FLORIDA APPROVAL NO.:
33464

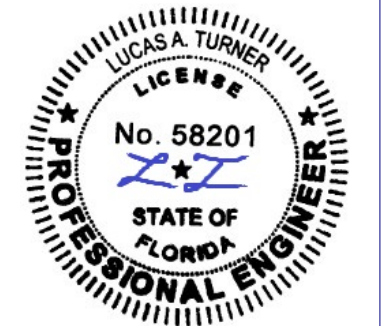

10/3/2023

LUCAS A. TURNER, P.E.
 FL PE # 58201
 Turner Engineering & Consulting, Inc.
 2428 Old Natchez Trc Trl
 Camden, TN 38320
 PH. 941-380-1574

SHEET DESCRIPTION:
 GENERAL NOTES AND ELEVATIONS

DRAWN BY: MCS	DATE: 9/18/2023
DWG #: PEL-496	REV.: A
SCALE: 1:40	SHEET 1 OF 7

GENERAL NOTES:

1. THE PRODUCT SHOWN HEREIN IS DESIGNED AND MANUFACTURED TO COMPLY WITH THE FLORIDA BUILDING CODE (FBC), CURRENT EDITION AND IS RATED FOR USE IN THE HIGH VELOCITY HURRICANE ZONE (HVHZ).
2. GLAZING OPTIONS: (SEE SHEET 2)
3. APPROVED CONFIGURATIONS INCLUDE BUT ARE NOT LIMITED TO: "XO", "OX", "OXO", "OXXO".
4. DESIGN PRESSURE RATING (SEE SHEET 2):
 -NEGATIVE DESIGN LOADS BASED ON, TESTED PRESSURE AND GLASS TABLES ASTM E-1300-04e01/09.
 -POSITIVE DESIGN LOADS BASED ON, TESTED PRESSURE, WATER INFILTRATION TEST PRESSURE AND GLASS TABLES ASTM E-1300-04e01/09.
5. ANCHORAGE: THE 33 1/3% STRESS INCREASE HAS NOT BEEN USED IN THE DESIGN OF THIS PRODUCT. SEE SHEET 7 FOR ANCHOR DETAILS. WINDLOAD DURATION FACTOR Cd=1.6 WAS USED FOR WOOD ANCHOR CALCULATIONS.
6. NOT APPROVED FOR IMPACT RESISTANCE. IMPACT PROTECTIVE SYSTEM IS REQUIRED IN WIND BORNE DEBRIS REGION.
7. FRAMES ARE PROCESSED AND SCREWED TOGETHER. VENTS ARE FULLY WELDED.
8. SERIES / MODEL DESIGNATION SGD-8900.
9. THE DESIGNATION X AND O STAND FOR THE FOLLOWING:
 X = OPERABLE SASH, O = FIXED SASH
10. SECTION CALLOUTS APPLY TO ALL CONFIGURATIONS IN A SIMILAR LOCATION.
11. WEEP SLOTS = 1/4" x 1-1/4" LOCATED 3" FROM BOTH ENDS.

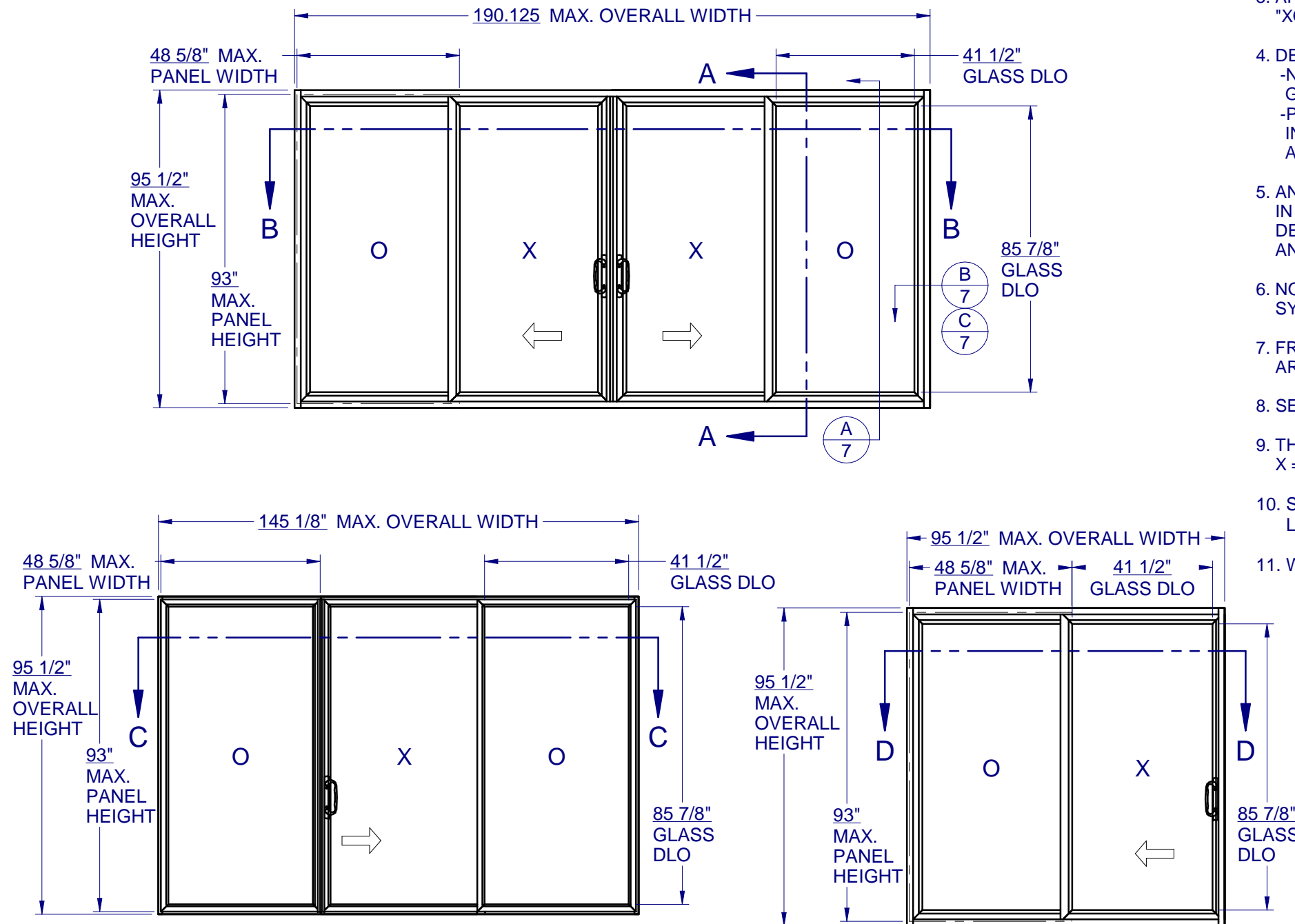

TABLE OF CONTENTS

GENERAL NOTES & ELEVATIONS.....	1
COMP. ANALYSIS AND GLAZING DETAIL....	2
SECTION VIEWS.....	3-4
BOM & EXTRUSIONS.....	5
ANCHOR SCHEDULE & NOTES.....	6
INSTALLATION DETAILS.....	7

MAX. PANEL SIZE	DESIGN PRESSURE RATING	IMPACT RATING
48-5/8" x 93"	SEE COMPARATIVE ANALYSIS CHART, SHEET 2	NONE

MAX. OF FOUR (4) PANELS IS ALLOWED AS LONG AS INDIVIDUAL PANELS DO NOT EXCEED PANEL SIZE AS SHOWN.

		Width											
		59.5	71.5	84	95.5	91	109	126	145	118	142	168	190
Panel Size	Configuration	30.625	36.625	42.875	48.625	30.625	36.625	42.25	48.625	30.625	36.625	42.625	48.625
Unit Height	Glass Type	OX,XO	OX,XO	OX,XO	OX,XO	OXO	OXO	OXO	OXO	OXXO	OXXO	OXXO	OXXO
80	A	-90/+60	-90/+60	-82.2/+60	-72/+60	-90/+60	-90/+60	-82.2/+60	-72/+60	-90/+60	-90/+60	-82.2/+60	-72/+60
84	A	-90/+60	-87.3/+60	-78.4/+60	-68.5/+60	-90/+60	-87.3/+60	-78.4/+60	-68.5/+60	-90/+60	-87.3/+60	-78.4/+60	-68.5/+60
90	A	-90/+60	-80/+60	-71.6/+60	-64/+60	-90/+60	-80/+60	-71.6/+60	-64/+60	-90/+60	-80/+60	-71.6/+60	-64/+60
96	A	-85.3/+60	-73.8/+60	-65.8/+60	+60/-60	-85.3/+60	-73.8/+60	-65.8/+60	+60/-60	-85.3/+60	-73.8/+60	-65.8/+60	+60/-60



590 PVC SLIDING PATIO DOOR NON-IMPACT

PROPRIETARY AND CONFIDENTIAL
 THE INFORMATION CONTAINED IN THIS DRAWING IS THE SOLE PROPERTY OF CUSTOM WINDOW SYSTEMS, INC. ANY REPRODUCTION IN PART OR AS A WHOLE WITHOUT THE WRITTEN PERMISSION OF CUSTOM WINDOW SYSTEMS, INC IS PROHIBITED.

FLORIDA APPROVAL NO.:
33464



10/3/2023
 LUCAS A. TURNER, P.E.
 FL PE # 58201
 Turner Engineering & Consulting, Inc.
 2428 Old Natchez Trc Trl
 Camden, TN 38320
 PH. 941-380-1574

SHEET DESCRIPTION:
 COMPARATIVE ANALYSIS AND GLAZING DETAIL

DRAWN BY:	DATE:
MCS	9/18/2023
DWG #:	REV.:
PEL-496	A
SCALE:	SHEET
1:1	2 OF 7

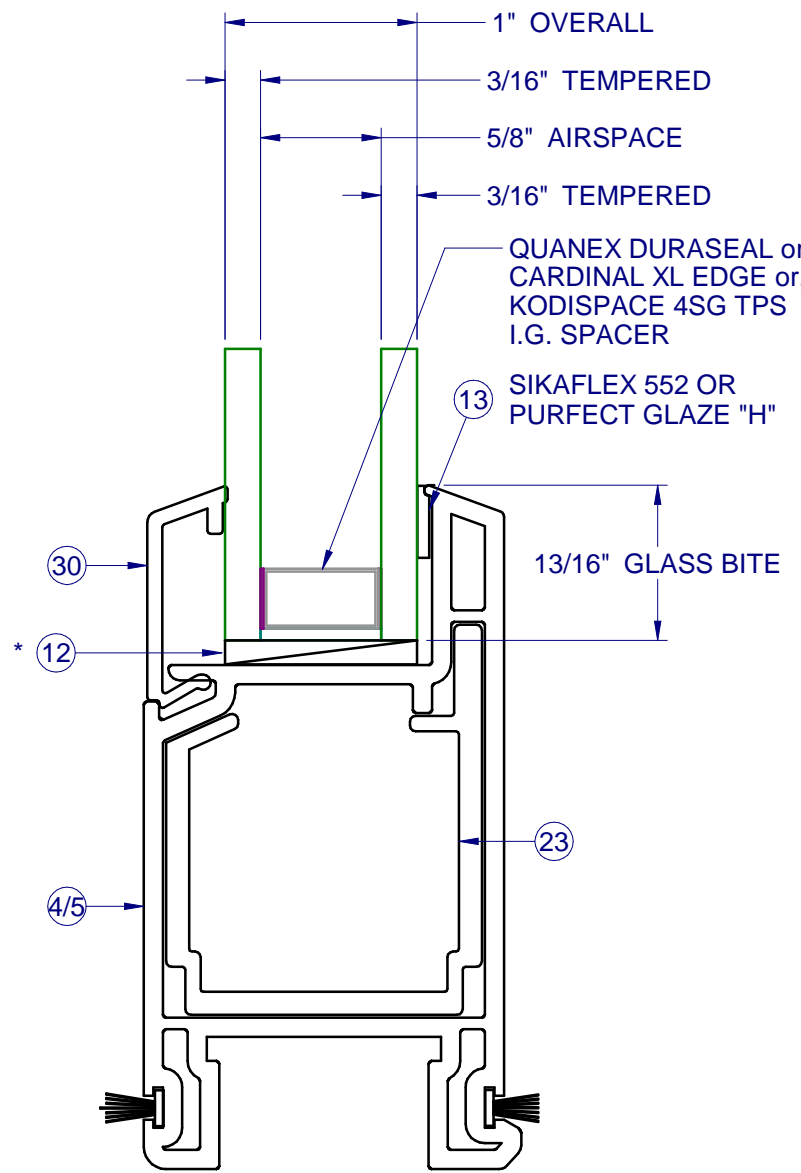

GLASS TYPE A

* SETTING BLOCKS PER FBC 2411.3.3.1

SILL RISER	MAX. POSITIVE DP
* NONE	60
1737	60

* INSTALLATION WITH NO SILL RISER ALLOWED ONLY WHERE WATER INFILTRATION RESISTANCE IS NOT REQUIRED.

NOTE: IF SIZE INTENDED IS NOT SHOWN, USE NEXT LARGER SIZE.

590 PVC SLIDING PATIO DOOR NON-IMPACT

PROPRIETARY AND CONFIDENTIAL
THE INFORMATION CONTAINED IN THIS DRAWING IS THE SOLE PROPERTY OF CUSTOM WINDOW SYSTEMS, INC. ANY REPRODUCTION IN PART OR AS A WHOLE WITHOUT THE WRITTEN PERMISSION OF CUSTOM WINDOW SYSTEMS, INC IS PROHIBITED.

FLORIDA APPROVAL NO.:
33464

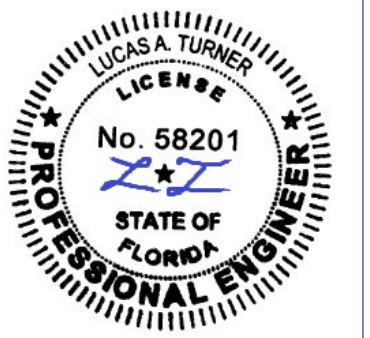

10/3/2023

LUCAS A. TURNER, P.E.
FL PE # 58201
Turner Engineering & Consulting, Inc.
2428 Old Natchez Trc Trl
Camden, TN 38320
PH. 941-380-1574

SHEET DESCRIPTION:
SECTION VIEWS
OXXO

DRAWN BY: MCS	DATE: 9/18/2023
DWG #: PEL-496	REV.: A
SCALE: 1:2	SHEET 3 OF 7

SILL RISER	MAX. POSITIVE DP
* NONE	60
1737	60

* INSTALLATION WITH NO SILL RISER ALLOWED ONLY WHERE WATER INFILTRATION RESISTANCE IS NOT REQUIRED.

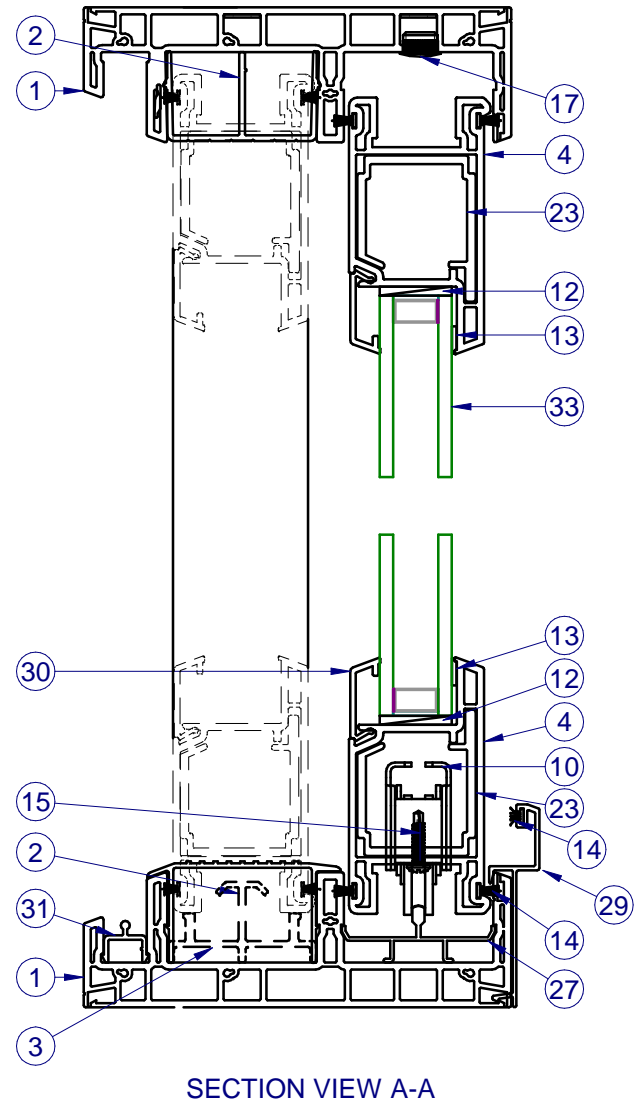
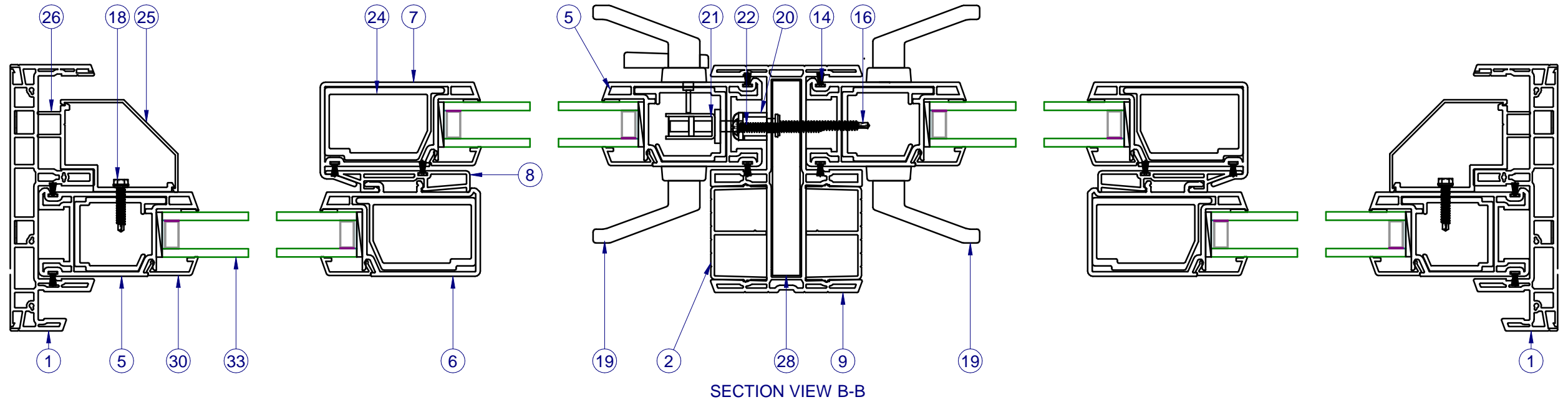

**590 PVC SLIDING
 PATIO DOOR
 NON-IMPACT**

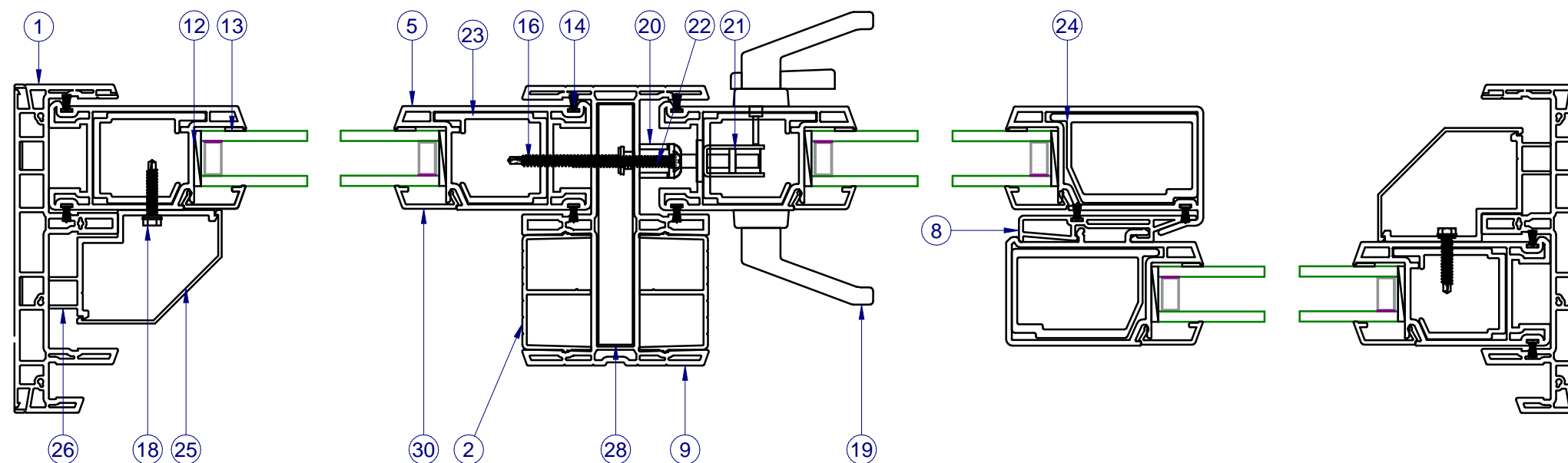

SECTION VIEW C-C

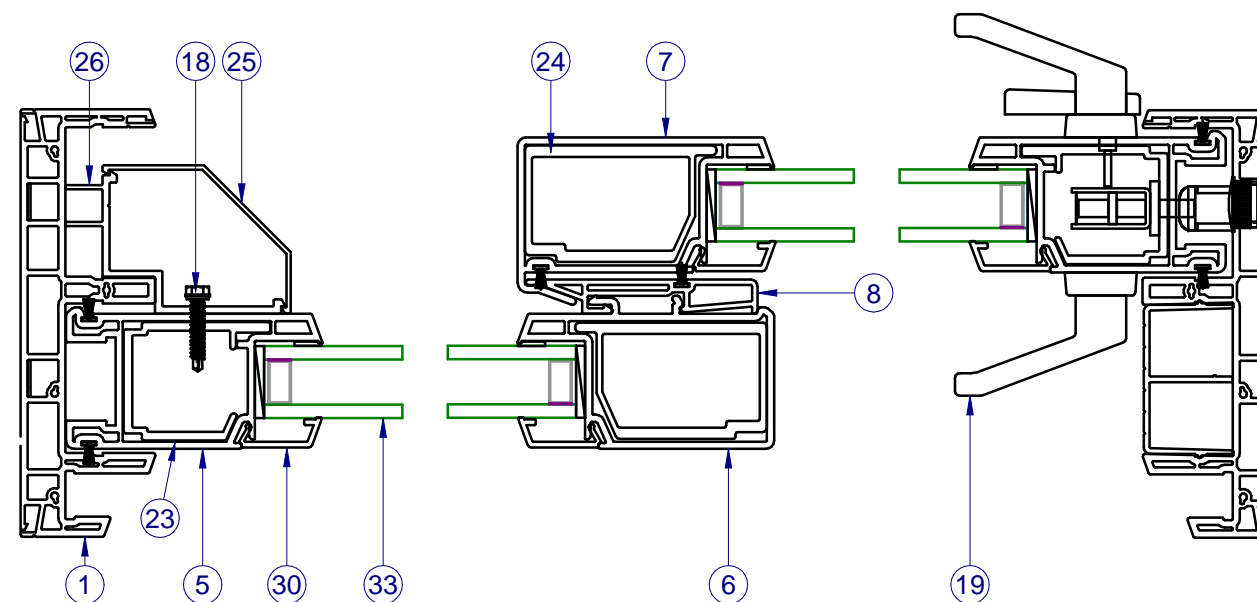

SECTION VIEW D-D

NOTE: VERTICAL SECTION SIMILAR FOR ALL CONFIGURATIONS, SEE SHEET 3

PROPRIETARY AND CONFIDENTIAL
 THE INFORMATION CONTAINED IN
 THIS DRAWING IS THE SOLE
 PROPERTY OF CUSTOM WINDOW
 SYSTEMS, INC. ANY
 REPRODUCTION IN PART OR AS A
 WHOLE WITHOUT THE WRITTEN
 PERMISSION OF CUSTOM WINDOW
 SYSTEMS, INC IS PROHIBITED.

FLORIDA APPROVAL NO.:
 33464

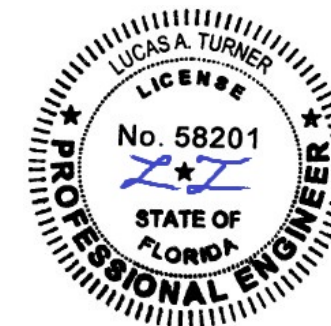

10/3/2023
 LUCAS A. TURNER, P.E.
 FL PE # 58201
 Turner Engineering &
 Consulting, Inc.
 2428 Old Natchez Trc Trl
 Camden, TN 38320
 PH. 941-380-1574

SHEET DESCRIPTION:

SECTION VIEWS
 OXO & OX

DRAWN BY: MCS	DATE: 9/18/2023
DWG #: PEL-496	REV.: A
SCALE: 1:2	SHEET 4 OF 7

PARTS LIST			
ITEM	PART NO.	DESCRIPTION	MATERIAL
1	H-6042	FRAME, MAIN, SGD	PVC
2	S-6040	THRESHOLD/FILLER, SGD	PVC
3	S-1722	Fixed Panel Support	ALUM
4	H-6059	PANEL RAIL PVC SGD W/INTEGRAL WSTP	PVC
5	H-6059	PANEL RAIL PVC SGD W/INTEGRAL WSTP	PVC
6	H-6033	PANEL, INTERLOCK, FIXED	PVC
7	H-6060	PANEL INTLK, OPER, PVC SGD	PVC
8	H-6061	CATCH PNL INTLK, PVC SGD W/ INTEGRAL	PVC
9	H-6043	ASTRAGAL, SGD,	PVC
10	P-3142	ROLLER,SGD,ADJUSTABLE,STAINLESS W/	STEEL
11	P-3342	SEAM SEALER, SM-5504	
12	P-5531	Setting Block, .09 x 1 x 2	RUBBER
13	P-3438	SIKAFLEX 552 OR PURFECT GLAZE "H"	
14	P-3429	WSTP., 0.270 X .187, BACK FINSEAL, GRAY	
15	P-3539	#8 X 3/4" QUAD PHILIPS, TEK	ZINC
16	P-3557	#10 x 2, HEXHEAD, TEK	ZINC
17	P-5588	CAP PLUG, 1/2" HOLE	NYLON
18	P-3767	#10 X 1" HEX WASHER HEAD, TEK	ZINC
19	P-5535	LOCK & HANDLE KIT, PVC, SGD	STEEL
20	P-3792	3/4" KEEPER	STEEL
21	P-3793	MORTISE LOCK	STEEL
22	P-4250	#10 x 2 1/2", PH PAN, SMS	
23	S-1775	REINFORCEMENT, PVC SGD, PANEL	ALUM
24	H-1993	REINFORCEMENT, ALUMINUM, SGD, PANE	ALUM
25	S-1618	CLIP, FIXED PANEL	ALUM
26	S-1597	Fixed Panel Snap Cover, PVC SGD	ALUM
27	S-1930	Sill Roller Track, Aluminum	ALUM
28	S-1726	REINFORCEMENT, ASTRAGAL, SGD	ALUM
29	S-1737	HIGHRISE SILL, ALUMINUM	ALUM
30	S-6037	GLAZING BEAD 1.00", SGD	PVC
31	S-6041	TRACK, SCREEN, SGD	PVC
32	S-1764	SILL THRESHOLD COVER	ALUM
33	GLASS	SEE SHEET 2	

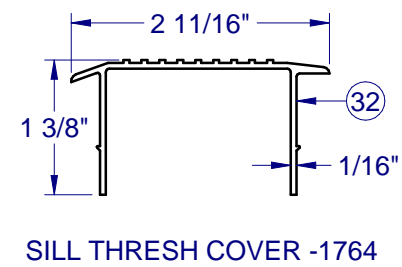
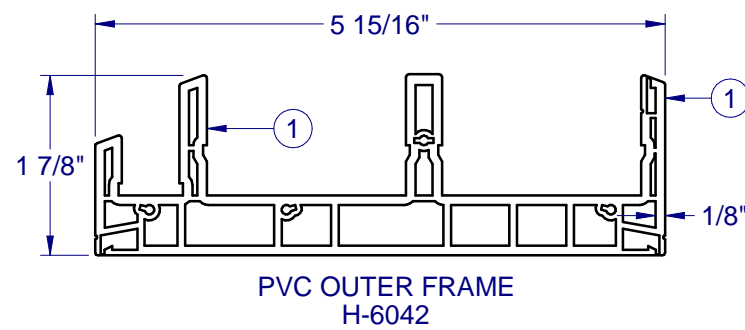

FRAME CONSTRUCTION

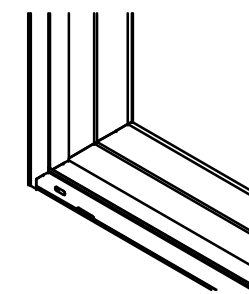

FRAME CORNERS
SCREWED TOGETHER
1:10

VENT CONSTRUCTION

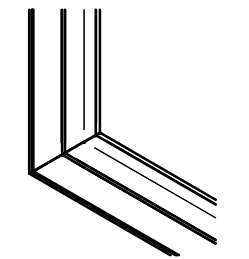

VENTS FULLY WELDED
1:10

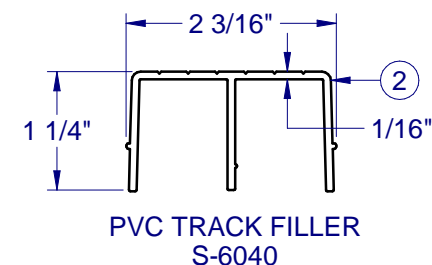
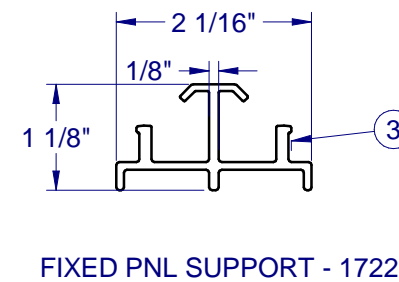
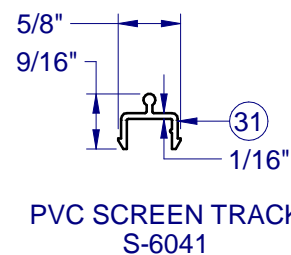
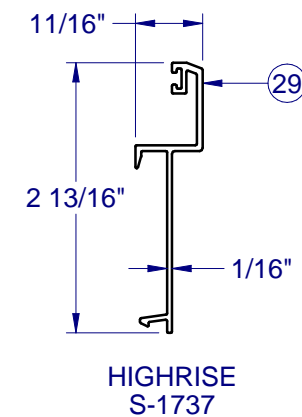
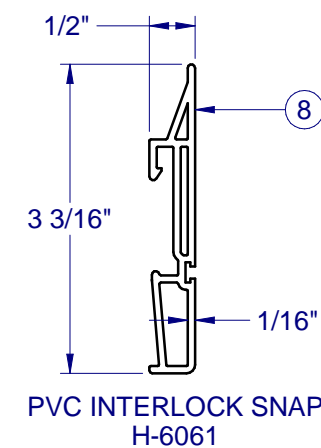
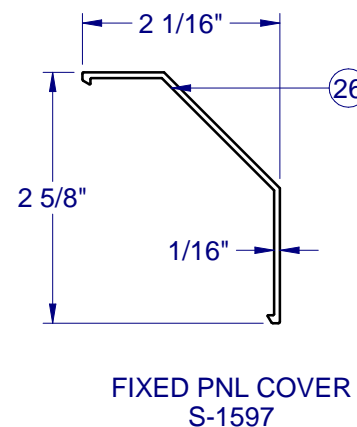
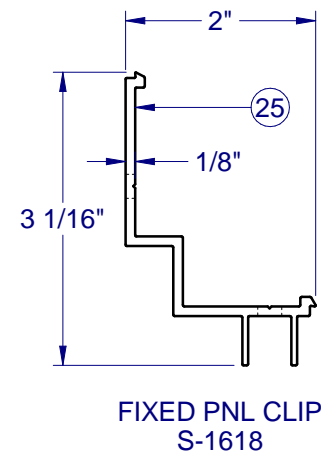
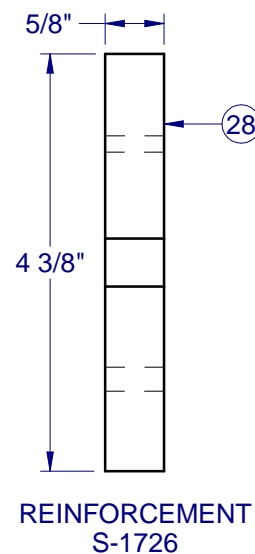
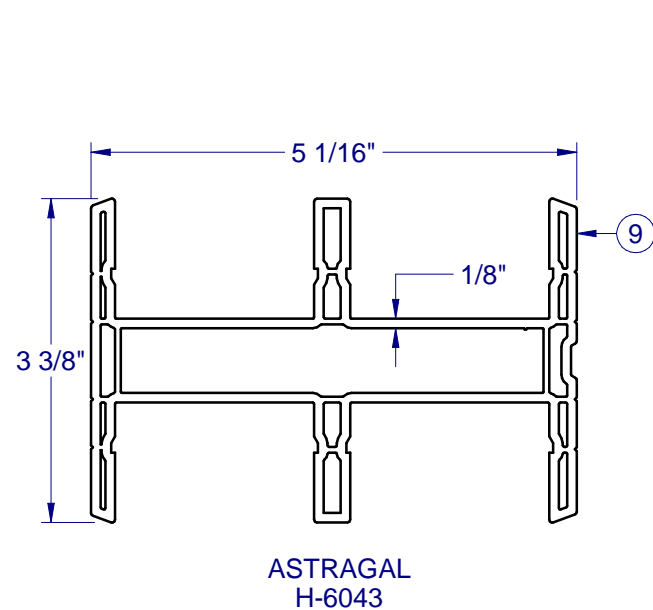
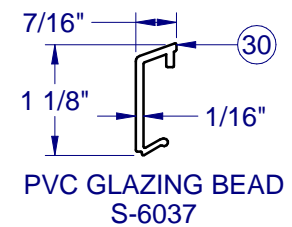
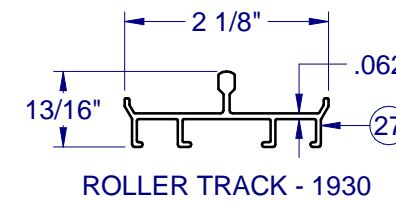
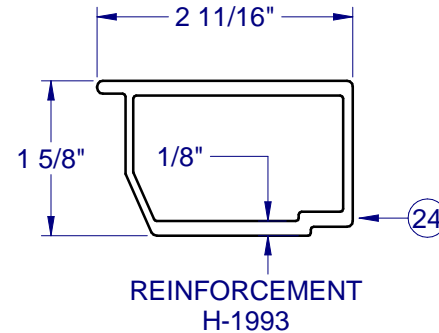
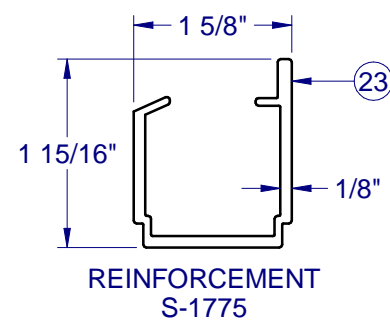
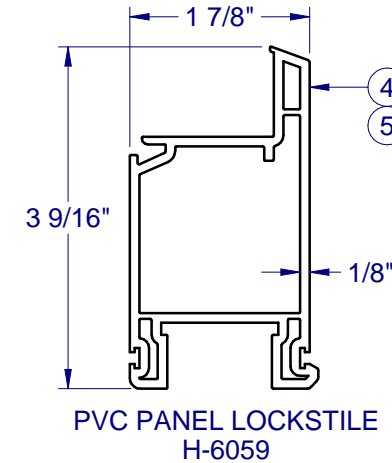
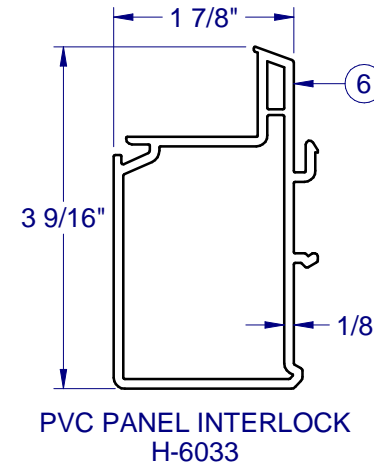
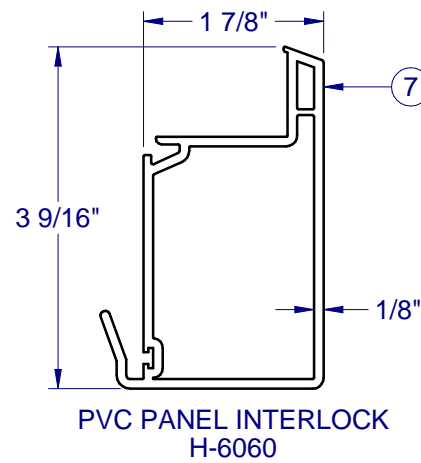

NOTE: ALL ALUMINUM EXTRUSIONS ARE 6063-T6 UNLESS OTHERWISE NOTED.



590 PVC SLIDING
PATIO DOOR
NON-IMPACT

PROPRIETARY AND CONFIDENTIAL
THE INFORMATION CONTAINED IN
THIS DRAWING IS THE SOLE
PROPERTY OF CUSTOM WINDOW
SYSTEMS, INC. ANY
REPRODUCTION IN PART OR AS A
WHOLE WITHOUT THE WRITTEN
PERMISSION OF CUSTOM WINDOW
SYSTEMS, INC IS PROHIBITED.

FLORIDA APPROVAL NO.:
33464



10/3/2023
LUCAS A. TURNER, P.E.
FL PE # 58201
Turner Engineering &
Consulting, Inc.
2428 Old Natchez Trc Trl
Camden, TN 38320
PH. 941-380-1574

SHEET DESCRIPTION:

BOM AND EXTRUSIONS

DRAWN BY:	DATE:
MCS	9/18/2023
DWG #:	REV.:
PEL-496	A
SCALE:	SHEET
1:2	5 OF 7

**590 PVC SLIDING
 PATIO DOOR
 NON-IMPACT**

PROPRIETARY AND CONFIDENTIAL
 THE INFORMATION CONTAINED IN
 THIS DRAWING IS THE SOLE
 PROPERTY OF CUSTOM WINDOW
 SYSTEMS, INC. ANY
 REPRODUCTION IN PART OR AS A
 WHOLE WITHOUT THE WRITTEN
 PERMISSION OF CUSTOM WINDOW
 SYSTEMS, INC IS PROHIBITED.

FLORIDA APPROVAL NO.:
 33464

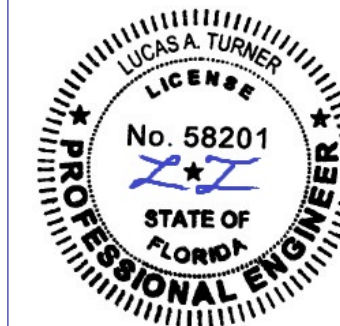

10/3/2023

LUCAS A. TURNER, P.E.
 FL PE # 58201
 Turner Engineering &
 Consulting, Inc.
 2428 Old Natchez Trc Trl
 Camden, TN 38320
 PH. 941-380-1574

SHEET DESCRIPTION:
**ANCHOR SCHEDULE AND
 NOTES**

DRAWN BY: MCS	DATE: 9/18/2023
DWG #: PEL-496	REV.: A
SCALE: 1:25	SHEET 6 OF 7

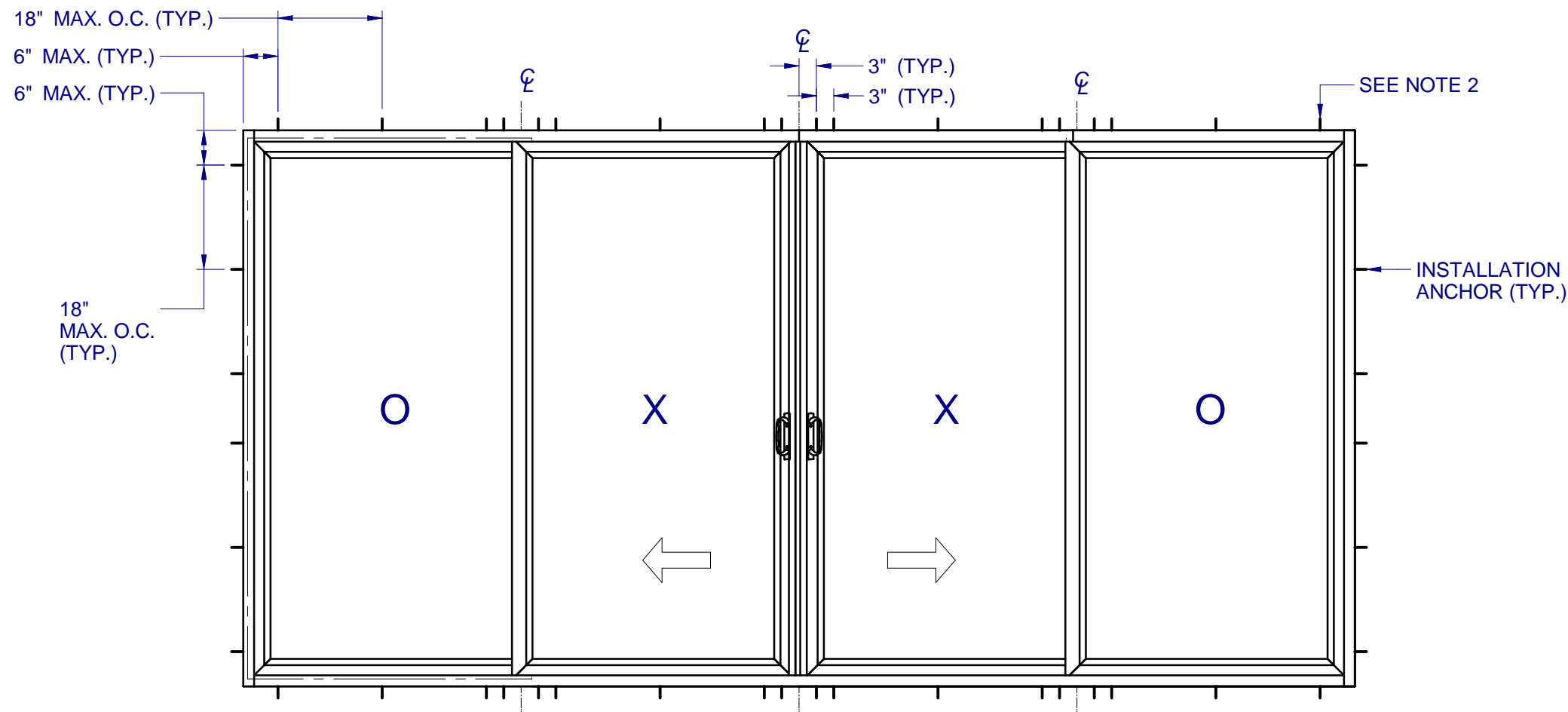

ANCHOR LAYOUT - (FLANGE)

NOTES:

- INSTALL TWO ANCHORS AT EACH INSTALLATION LOCATION. SILL ANCHOR SPACING SAME AS HEAD.
- SHIM AS REQ AT EACH INSTALLATION ANCHOR USING LOAD BEARING SHIMS. MAX. ALLOWABLE SHIM STACK TO BE 1/4". USE SHIMS WHERE SPACE GREATER THAN 1/16" IS PRESENT. LOAD BEARING SHIMS SHALL BE CONSTRUCTED OF HIGH DENSITY PLASTIC OR BETTER. WOOD SHIMS ARE NOT ALLOWED.
- ANCHOR TYPE, SIZE, SPACING AND EMBEDMENT SHALL BE AS SPECIFIED IN THESE DRAWINGS, SEE TABLE 1, SHEET 7.
- ALL INSTALLATION ANCHORS MUST BE MADE OF OR PROTECTED WITH A CORROSION RESISTANT MATERIAL OR COATING. DISSIMILAR METALS OR MATERIALS IN CONTACT WITH PRESSURE TREATED WOOD MUST BE PROTECTED TO PREVENT REACTION.
- INSTALLATION ANCHORS SHALL BE IN ACCORDANCE WITH ANCHOR MANUFACTURER'S INSTALLATION INSTRUCTIONS, AND ANCHORS SHALL NOT BE USED IN SUBSTRATES WITH STRENGTHS LESS THAN THE MINIMUM SPECIFIED IN TABLE 1, SHEET 7.
- ANCHOR EMBEDMENT TO SUBSTRATE SHALL BE BEYOND WALL DRESSING OR STUCCO. FOR CONCRETE/CMU OPENINGS, EMBEDMENT SHALL BE BEYOND WOOD BUCKS, IF USED, INTO SUBSTRATE - 1X BUCKS ARE OPTIONAL.
- A MINIMUM CENTER-TO-CENTER SPACING SHALL BE MAINTAINED BETWEEN ALL FASTENERS: 2-7/16" FOR MASONRY, 2" FOR FIXED PANEL CLIPS (ALL SUBSTRATES), 1" FOR WOOD AND METAL.
- WOOD OR MASONRY OPENINGS, BUCKS AND BUCK FASTENERS SHALL BE PROPERLY DESIGNED BY THE ARCHITECT OR ENGINEER OF RECORD AND INSTALLED TO TRANSFER WIND LOADS TO THE STRUCTURE. SUBSTRATES SHALL MEET THE MINIMUM STRENGTH REQUIREMENTS AS SHOWN IN TABLE 1, SHEET 7. CONCRETE AND MASONRY SUBSTRATES MAY NOT BE CRACKED.
- SEALING AND FLASHING STRATEGIES FOR OVERALL WATER RESISTANCE OF INSTALLATION SHALL BE DONE BY OTHERS FOLLOWING THE CURRENT VERSION OF THE REFERENCE DOCUMENTS: FMA/AAMA 100(FIN WINDOWS), FMA/AAMA 200(FLANGE WINDOWS), FMA/WDMA 250(BOX WINDOWS), FMA/AAMA/WDMA 300(EXTERIOR DOORS)

590 PVC SLIDING PATIO DOOR NON-IMPACT

PROPRIETARY AND CONFIDENTIAL
 THE INFORMATION CONTAINED IN THIS DRAWING IS THE SOLE PROPERTY OF CUSTOM WINDOW SYSTEMS, INC. ANY REPRODUCTION IN PART OR AS A WHOLE WITHOUT THE WRITTEN PERMISSION OF CUSTOM WINDOW SYSTEMS, INC IS PROHIBITED.

FLORIDA APPROVAL NO.:
 33464

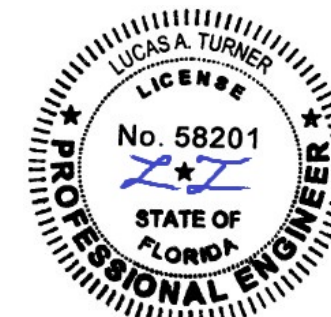

10/3/2023
 LUCAS A. TURNER, P.E.
 FL PE # 58201
 Turner Engineering & Consulting, Inc.
 2428 Old Natchez Trc Trl
 Camden, TN 38320
 PH. 941-380-1574

SHEET DESCRIPTION:
INSTALLATION DETAILS

DRAWN BY: MCS	DATE: 9/18/2023
DWG #: PEL-496	REV.: A
SCALE: 1:2	SHEET 7 OF 7

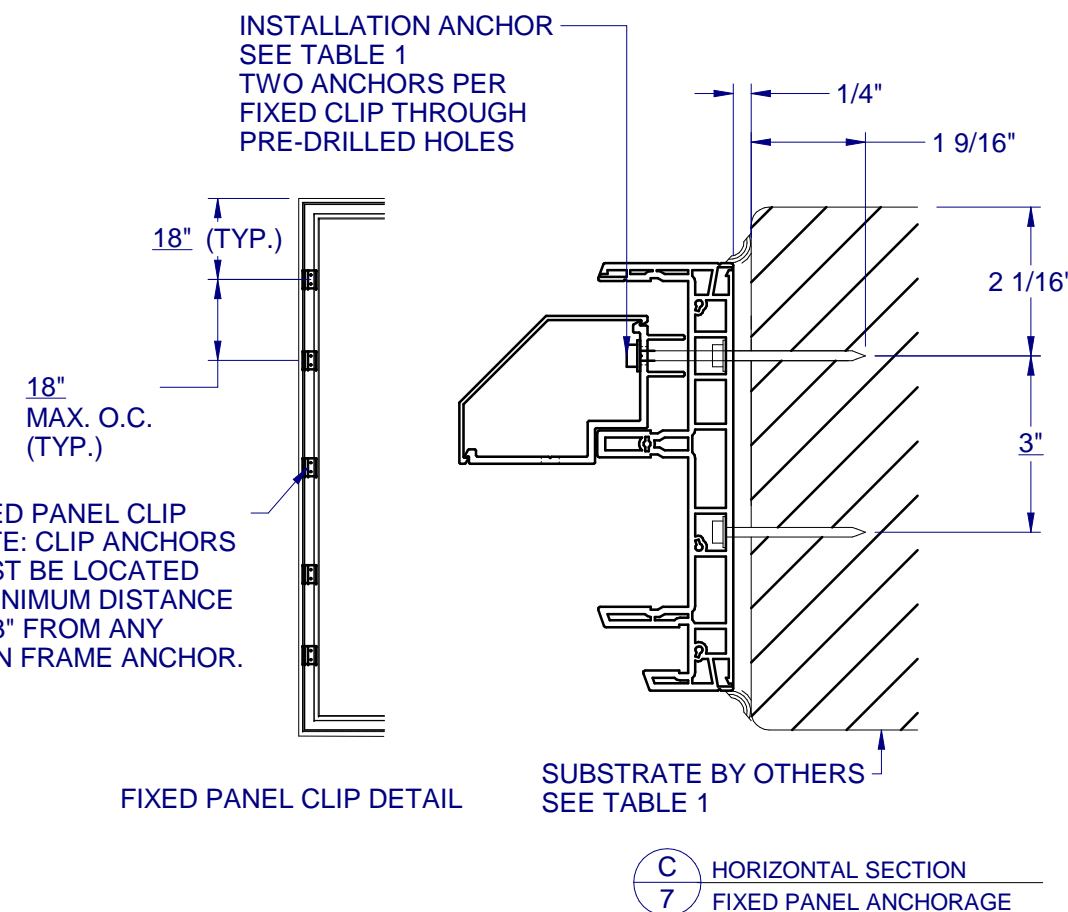
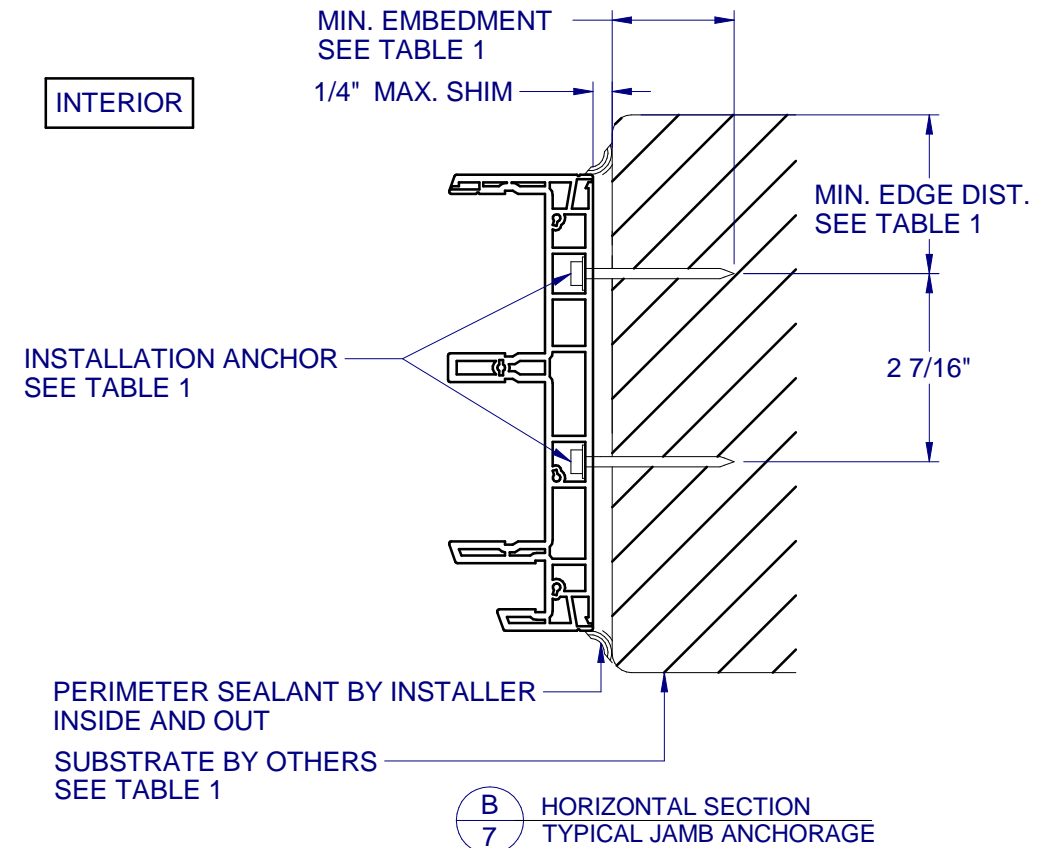
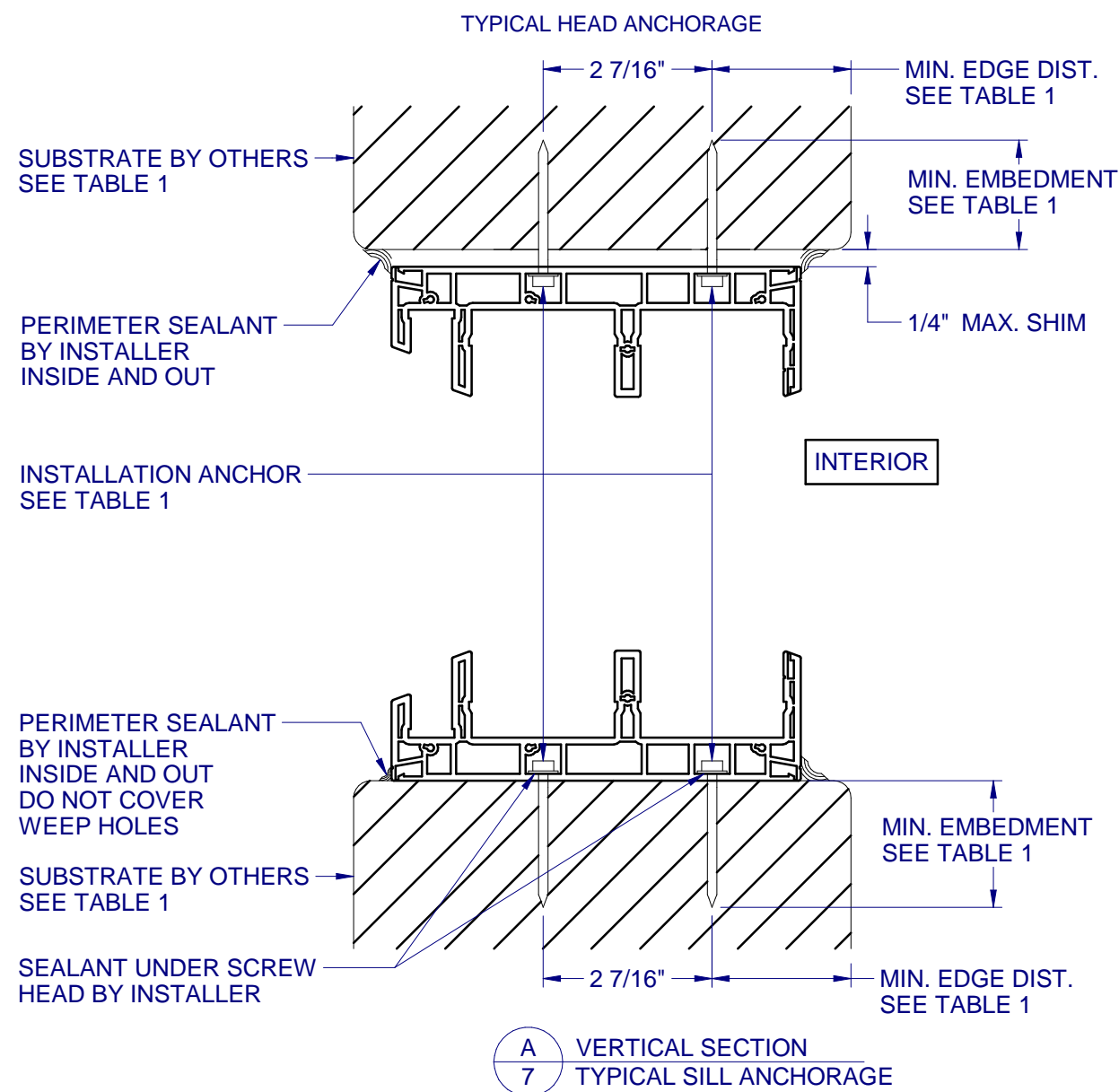

TABLE 1: APPROVED INSTALLATION FASTENERS			
SUBSTRATE TYPE	ANCHOR TYPE	MIN. EMBEDMENT	MIN. EDGE DIST.
CONCRETE (2.0 KSI MIN.)	3/16" ITW TAPCON	1"	3"
CONCRETE (3.05 KSI MIN.)	3/16" DEWALT ULTRACON+	1-3/4"	1"
HOLLOW OR GROUT-FILLED CMU (ASTM C-90)	3/16" DEWALT ULTRACON+	1-1/4"	1"
2X MIN. SPRUCE-PINE-FIR (G=0.42)	3/16" ITW TAPCON OR DEWALT ULTRACON+	1-3/8"	7/8"
2X MIN. SPRUCE-PINE-FIR (G=0.42)	#10 WOOD SCREW	1-3/8"	7/8"
16 GAUGE (0.060") MIN. STEEL STUD (33 KSI YIELD MIN)	#10-16 HILTI KWIK-FLEX OR ITW TEKS SELF-DRILLING SCREW	FULL THREAD THRU 0.060"	1/2"
1/8" ALUM. (6063-T5 MIN.) OR 1/8" STEEL (33 KSI MIN.)	#10 GRADE 5 SELF-TAPPING / DRILLING SCREW	FULL THREAD THRU 0.125"	1/2"
FIXED PANEL CLIP ANCHORS INTO CONCRETE (2.0 KSI MIN.) OR HOLLOW OR GROUT-FILLED CMU (117 PCF MIN.)	3/16" ITW TAPCON	1"	3"
FIXED PANEL CLIP ANCHORS INTO CONCRETE (3.05 KSI MIN.) OR HOLLOW OR GROUT-FILLED CMU (ASTM C-90)	3/16" DEWALT ULTRACON+	1-1/4"	2-1/2"

NOTE: FIXED PANEL CLIP ANCHORS INTO WOOD OR METAL SHALL FOLLOW THE ANCHOR TYPE, MIN. EMBEDMENT AND MIN. EDGE DISTANCE LISTED IN TABLE 1.