



INSTALLATION

1 General

- 1.1 Piazza Stone® shall be installed with the Piazza Stone® Installation System in accordance with the engineered design, manufacturer's product data, and approved shop drawings. In the event of a conflict between the manufacturer's installation instructions and this TER, the more restrictive shall govern.
- 1.2 All other installation and flashing details germane to the project shall be in accordance with the applicable building code and manufacturer's installation instructions.
- 1.3 Piazza Stone® shall be installed over substrates of concrete, masonry, or cold formed steel studs.
- 1.4 Substrates shall be flat within ¼" in 4'-0" and deviations shall be corrected before beginning installation.
- 1.5 Installation shall be performed by an applicator certified by the manufacturer.
- 1.6 Installation is subject to conditions of use set forth in Section 9 of this TER.

2 NFPA 285-Compliant Installation Method

- 2.1 The wall assembly shall comply with the vertical and lateral fire propagation requirements of Section 5.10.
- 2.2 The exposed EPS on the backside of the units shall be completely covered and sealed using Piazza Adhesive, as shown in Figure 2. The Piazza Adhesive shall be a continuous ¼" thick coat and shall be applied using a trowel.
- 2.3 The adhesive should be allowed to set for six to eight hours after applying to the Piazza Stone® units.
- 2.4 Piazza Track System is attached to the substrate, then Piazza Stone® units shall be positioned and mechanically attached to the clips according to the approved shop drawings.

2.5 Fasteners:

- 2.5.1 Fasteners for attaching the Piazza Stone clips to the Piazza Stone® units shall be cadmium coated Hilti Kwik Con II 3/16" or ¼" diameter x 1¼" length anchors, or equal. Longer fasteners are allowed.
 - 2.5.2 All fasteners must meet ASTM B117 – 1000 Hour Salt Spray
 - 2.5.3 All fasteners must be in accordance with manufacturer's product data and approved shop drawings.
- 2.6 Maintain a 3/8" to 1" joint spacing between units.
 - 2.7 Caulk joints using Pecora 890FTS-TXTR or equivalent.

3 Adhesion Installation Method

- 3.1 Substrate surfaces shall be clean, dry, structurally sound, and free of paint, efflorescence, grease, oil, form release agents, and curing compounds.
- 3.2 Piazza Adhesive shall be mixed according to manufacturer's instructions.
- 3.3 Piazza Adhesive shall be applied directly to the Piazza Stone® units, not the substrate.
- 3.4 Use ribbon and dab method. Apply mixed Piazza Adhesive in a ribbon of approximately 2" wide by 3/8" thick to entire perimeter of Piazza Stone® unit using a trowel. Apply dabs of 3/8" to 5/8" thickness by 4" in diameter approximately 8" o.c., both vertically and horizontally, over entire Piazza Stone® unit.
- 3.5 Units shall be immediately placed on the substrate.
- 3.6 The Piazza Stone® units shall be allowed to set for six to eight hours after applying adhesive.
- 3.7 Maintain a 3/8" to 1" joint spacing between units.
- 3.8 Caulk joints using Pecora 890FTS-TXTR or equivalent.

4 Mechanical Installation Method where NFPA 285 compliance is not required

- 4.1 The exposed EPS on the backside of the units does not need to be covered and sealed using Piazza Adhesive, as shown in Figure 1.
- 4.2 Method 1: Piazza Track System is attached to the substrate, then Piazza Stone® units shall be positioned and mechanically attached to the clips according to the approved shop drawings.
- 4.3 Method 2: PZ Connectors are attached to the substrate, then Piazza Stone® units shall be positioned and mechanically attached according to the approved shop drawings.
- 4.4 **Fasteners:**
 - 4.4.1 Fasteners for attaching the Piazza Stone clips to the Piazza Stone® units shall be cadmium coated Hilti Kwik Con II 3/16" or 1/4" diameter x 1/4" length anchors, or equal. Longer fasteners are allowed.
 - 4.4.2 All fasteners must meet ASTM B117 – 1000 Hour Salt Spray
 - 4.4.3 All fasteners must be in accordance with manufacturer's product data and approved shop drawings.
- 4.5 Maintain a 3/8" to 1" joint spacing between units.
- 4.6 Caulk joints using Pecora 890FTS-TXTR or equivalent.
- 4.7 A standard mechanical installation example without rigid insulation is shown in Figure 4.
- 4.8 To meet energy code requirements, Piazza-Z can be used vertically with rigid insulation.

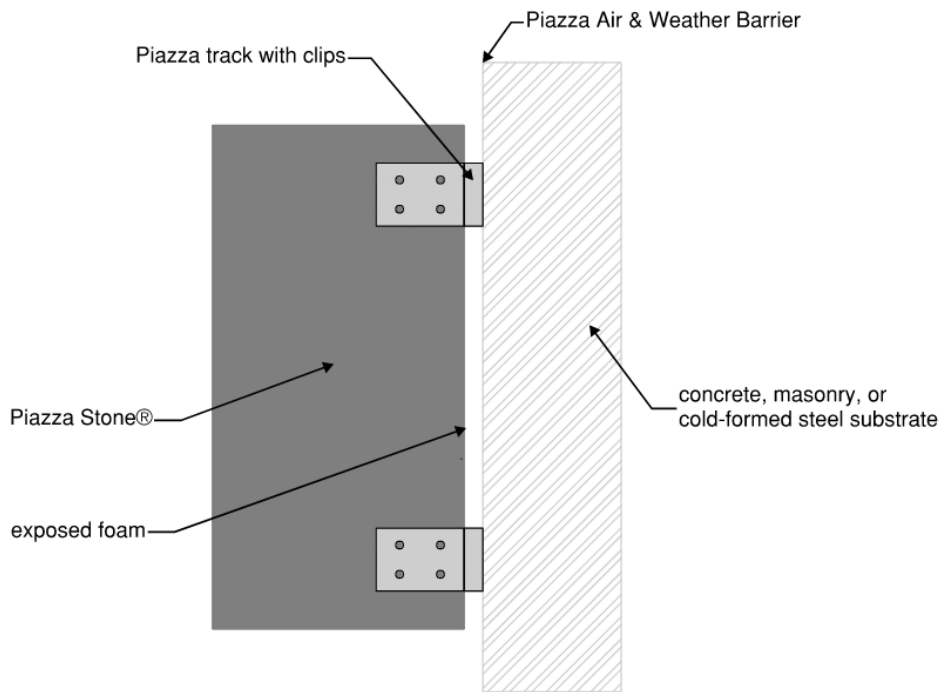

FIGURE 4. EXAMPLE OF MECHANICAL ATTACHMENT OF PIAZZA STONE® TO SUBSTRATE