

Piazza Stone Installation Instructions

1 Installation

- 1.1 Installation shall comply with the approved construction documents, the manufacturer installation instructions, this TER, and the applicable building code.
- 1.2 In the event of a conflict between the manufacturer installation instructions and this TER, the more restrictive shall govern.
- 1.3 *General*
 - 1.3.1 Piazza Stone® shall be installed with the Piazza Stone® Installation System in accordance with the engineered design, manufacturer product data, and approved shop drawings. In the event of a conflict between the manufacturer installation instructions and this TER, the more restrictive shall govern.
 - 1.3.2 All other installation and flashing details germane to the project shall be in accordance with the applicable building code and manufacturer installation instructions.
 - 1.3.3 Piazza Stone® shall be installed over substrates of concrete, masonry, or cold-formed steel studs.
 - 1.3.4 Substrates shall be flat within 1/4" in 4'-0" and deviations shall be corrected before beginning installation.
 - 1.3.5 Installation shall be performed by an applicator certified by the manufacturer.
 - 1.3.6 Installation is subject to conditions of use set forth in Section 9 of TER 1909-03.
- 1.4 *NFPA 285-Compliant Installation Method*
 - 1.4.1 The wall assembly shall comply with the vertical and lateral fire propagation of TER 1909-03.
 - 1.4.2 The exposed EPS on the backside of the units shall be completely covered and sealed using Piazza Adhesive. The Piazza Adhesive shall be a continuous 1/4" thick coat and shall be applied using a trowel.
 - 1.4.3 The adhesive should be allowed to set for six to eight hours after applying to the Piazza Stone® units.
 - 1.4.4 Piazza Track System is attached to the substrate, and then Piazza Stone® units shall be positioned and mechanically attached to the clips according to the approved shop drawings.
 - 1.4.5 *Fasteners*
 - 1.4.5.1 Fasteners for attaching the Piazza Stone® clips to the Piazza Stone® units shall be cadmium coated Hilti Kwik Con II 3/16" or 1/4" diameter x 1 1/4" length anchors, or equal. Longer fasteners are allowed.
 - 1.4.5.2 All fasteners must meet ASTM B117 – 1000 Hour Salt Spray.
 - 1.4.5.3 All fasteners must be in accordance with manufacturer product data and approved shop drawings.
 - 1.4.6 Maintain a 3/8" to 1" joint spacing between units.
 - 1.4.7 Caulk joints using Pecora 890FTS-TXTR or equivalent.
- 1.5 *Adhesion Installation Method*
 - 1.5.1 Substrate surfaces shall be clean, dry, structurally sound, and free of paint, efflorescence, grease, oil, form release agents, and curing compounds.
 - 1.5.2 Piazza Adhesive shall be mixed according to manufacturer instructions.
 - 1.5.3 Piazza Adhesive shall be applied directly to the Piazza Stone® units, not the substrate.
 - 1.5.4 Use ribbon and dab method. Apply mixed Piazza Adhesive in a ribbon of approximately 2" wide by 3/8" thick to entire perimeter of Piazza Stone® unit using a trowel. Apply dabs of 3/8" to 5/8" thickness by 4" in diameter approximately 8" o.c., both vertically and horizontally, over entire Piazza Stone® unit.
 - 1.5.5 Units shall be immediately placed on the substrate.
 - 1.5.6 The Piazza Stone® units shall be allowed to set for six to eight hours after applying adhesive.
 - 1.5.7 Maintain a 3/8" to 1" joint spacing between units.
 - 1.5.8 Caulk joints using Pecora 890FTS-TXTR or equivalent.

1.6 *Mechanical Installation Method Where NFPA 285 Compliance is not Required*

- 1.6.1 The exposed EPS on the backside of the units does not need to be covered and sealed using Piazza Adhesive.
- 1.6.2 Method 1: Piazza Track System is attached to the substrate, and then Piazza Stone® units shall be positioned and mechanically attached to the clips according to the approved shop drawings.
- 1.6.3 Method 2: PZ Connectors are attached to the substrate, and then Piazza Stone® units shall be positioned and mechanically attached according to the approved shop drawings.
- 1.6.4 *Fasteners*
 - 1.6.4.1 Fasteners for attaching the Piazza Stone® clips to the Piazza Stone® units shall be cadmium coated Hilti Kwik Con II $\frac{3}{16}$ " or $\frac{1}{4}$ " diameter x $1\frac{1}{4}$ " length anchors, or equal. Longer fasteners are allowed.
 - 1.6.4.2 All fasteners must meet ASTM B117 – 1000 Hour Salt Spray.
 - 1.6.4.3 All fasteners must be in accordance with manufacturer product data and approved shop drawings.
- 1.6.5 Maintain a $\frac{3}{8}$ " to 1" joint spacing between units.
- 1.6.6 Caulk joints using Pecora 890FTS-TXTR or equivalent.
- 1.6.7 A standard mechanical installation example without rigid insulation is shown in Figure 1.
- 1.6.8 To meet energy code requirements, Piazza-Z can be used vertically with rigid insulation.

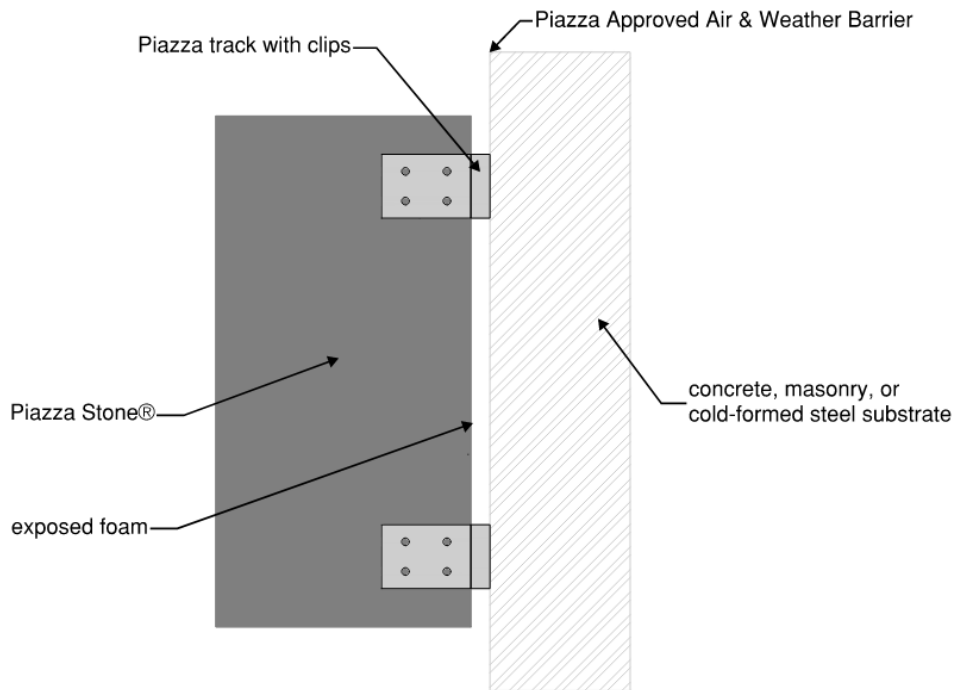

Figure 1. Example of Mechanical Attachment of Piazza Stone® to Substrate