

SIMPSON DOOR COMPANY

SERIES “MULLED WOODEN TRIPLE TRANSOM” GLAZED FIXED UNIT W/SIDE-MOUNTED WOODEN THRESHOLD

INSTALLATION ANCHORAGE DETAILS

PROJECT NO. 421-0102				
				DATE
				BY

SIMPSON DOOR COMPANY 400 SIMPSON AVE. MCCLEARY, WA 98557	DRAWN BY: RJA SCALE: N.T.S. REV: ---	DATE: 6/8/21 DRAWING NO: SIMP0025 SHEET: 1 OF 4	PTC PTC Product Design Group, LLC PO Box 520775 Lenoir, NC 27529-0775 Phone: 321.690.1788 Fax: 321.690.1789 Email: info@ptc-corp.com FEFE GA. NO. 24585
TITLE: MULLED TRIPLE TRANSOM / FIXED WINDOW GENERAL AND INSTALLATION NOTES			

Robert J. Amoruso, P.E.
Florida P.E. No. 49752

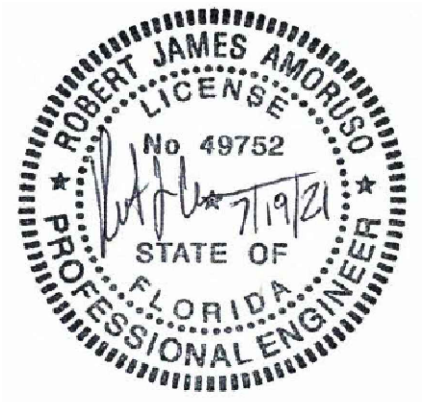

GENERAL NOTES:

1. THIS PRODUCT IS DESIGNED TO COMPLY WITH THE CURRENT EDITION OF THE FLORIDA BUILDING CODE - BUILDING (FBC) AND RESIDENTIAL (FRC) REQUIREMENTS EXCLUDING THE HIGH VELOCITY HURRICANE ZONE (HVHZ) AT THE DESIGN PRESSURE(S) STATED HEREIN. THE PRODUCT DETAILS CONTAINED HEREIN ARE BASED UPON SIGNED AND SEALED TEST REPORT #NCTL-210-4190-7 AND ASSOCIATED LABORATORY STAMPED DRAWINGS.
2. ADEQUACY OF THE EXISTING STRUCTURAL CONCRETE / MASONRY AND 2X FRAMING AS A MAIN WIND FORCE RESISTING SYSTEM CAPABLE OF WITHSTANDING AND TRANSFERRING APPLIED PRODUCT LOADS TO THE STRUCTURE IS THE RESPONSIBILITY OF THE ENGINEER OR ARCHITECT OF RECORD.
3. 1X AND 2X BUCKS (WHEN USED) SHALL BE DESIGNED AND ANCHORED TO PROPERLY TRANSFER ALL LOADS TO THE STRUCTURE. BUCK DESIGN AND INSTALLATION IS THE RESPONSIBILITY OF THE ENGINEER OR ARCHITECT OF RECORD.
4. IN AREAS WHERE WIND-BORNE DEBRIS PROTECTION REQUIREMENTS EXIST, USE OF AN APPROVED IMPACT PROTECTIVE SYSTEM IS REQUIRED.
5. TRANSOM FRAME OR COMPONENTS STRUCTURAL CORE MATERIAL: LAMINATED VENEER LUMBER (LVL) AND/OR FIR OR PINE FINGERJOINTED AND EDGE GLUED CORE MATERIAL. USE OF ALTERNATE WOOD VENEERS ON THE SAME STRUCTURAL CORE MATERIAL IS ACCEPTABLE FOR THIS PRODUCT. LVL MAY BE EITHER VERTICAL OR HORIZONTAL ORIENTATION.
6. GLASS MEETS THE REQUIREMENTS OF ASTM E1300-12AE1. SEE SHEET 4 FOR GLAZING DETAILS.

7. DESIGNATION "O" STANDS FOR THE FOLLOWING:
O: FIXED PANEL

INSTALLATION NOTES:

1. ONE (1) INSTALLATION ANCHOR IS REQUIRED AT EACH ANCHOR LOCATION SHOWN.
2. THE NUMBER OF INSTALLATION ANCHORS DEPICTED ARE THE MINIMUM NUMBER OF ANCHORS TO BE USED FOR PRODUCT INSTALLATION.
3. SHIM AS REQUIRED AT EACH INSTALLATION ANCHOR WITH LOAD BEARING SHIM(S). MAXIMUM ALLOWABLE SHIM SIZE IS 1/4 INCH. SHIM WHERE SPACE OF 1/16 INCH OR GREATER OCCURS. SHIM(S) SHALL BE CONSTRUCTED OF HIGH DENSITY PLASTIC OR BETTER.
4. FOR INSTALLATION INTO WOOD FRAMING, USE #10 WOOD SCREWS OF SUFFICIENT LENGTH TO ACHIEVE 1 1/2 INCH MINIMUM EMBEDMENT. MINIMUM EDGE DISTANCE IS 3/4 INCHES.
5. FOR INSTALLATION THROUGH 1X BUCK TO CONCRETE / MASONRY, OR DIRECTLY INTO CONCRETE / MASONRY, USE 1/4 INCH ITW TAPCONS (ADVANCED THREADFORM) OF SUFFICIENT LENGTH TO ACHIEVE 1 3/4 INCH MINIMUM EMBEDMENT INTO CONCRETE AND 1 INCH MINIMUM EMBEDMENT INTO MASONRY. MINIMUM EDGE DISTANCE IS 2-1/2 INCHES FOR CONCRETE AND MASONRY.
6. MINIMUM EMBEDMENT AND EDGE DISTANCE EXCLUDE WALL FINISHES, INCLUDING BUT NOT LIMITED TO STUCCO, FOAM, BRICK VENEER AND SIDING.

7. FOR CONCRETE BLOCK APPLICATIONS DO NOT INSTALL INSTALLATION ANCHORS INTO MORTAR JOINTS.
8. INSTALLATION ANCHORS SHALL BE INSTALLED IN ACCORDANCE WITH ANCHOR MANUFACTURER'S INSTALLATION INSTRUCTIONS AND ANCHORS SHALL NOT BE USED IN SUBSTRATES WITH STRENGTHS LESS THAN THE MINIMUM STRENGTH SPECIFIED BY THE ANCHOR MANUFACTURER.
9. INSTALLATION ANCHOR CAPACITIES FOR PRODUCTS HEREIN ARE BASED ON SUBSTRATE MATERIALS WITH THE FOLLOWING PROPERTIES:
 - 9.1 WOOD - MINIMUM SPECIFIC GRAVITY OF 0.42 (NON-HVHZ).
 - 9.2 CONCRETE - MINIMUM COMPRESSIVE STRENGTH OF 2500 PSI.
 - 9.3 MASONRY - STRENGTH CONFORMANCE TO ASTM C-90 MEDIUM WEIGHT WITH COMPRESSIVE STRENGTH OF 1900 psi (DENSITY > 117 PCF).

TABLE OF CONTENTS		
SHEET	REV.	SHEET DESCRIPTION
1	---	GENERAL AND INSTALLATION NOTES
2	---	ELEVATION AND ANCHOR LAYOUT
3	---	VERTICAL SECTIONS
4	---	HORIZONTAL SECTIONS & GLAZING DETAIL

DESIGN PRESSURE RATING (PSF)	IMPACT RATING
±50.0	NONE

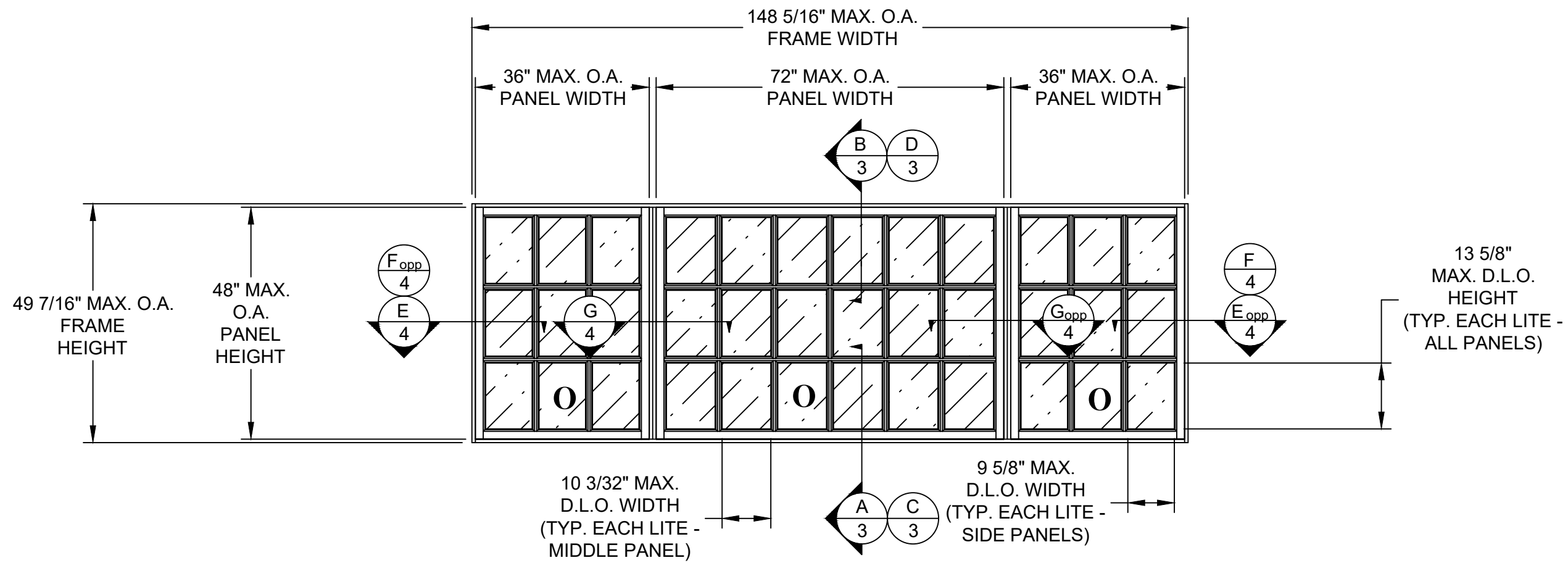

ELEVATION

FRAME, PANEL AND D.L.O. ABOVE BASED ON ACTUAL TEST
SPECIMEN SIZE
EXTERIOR VIEW

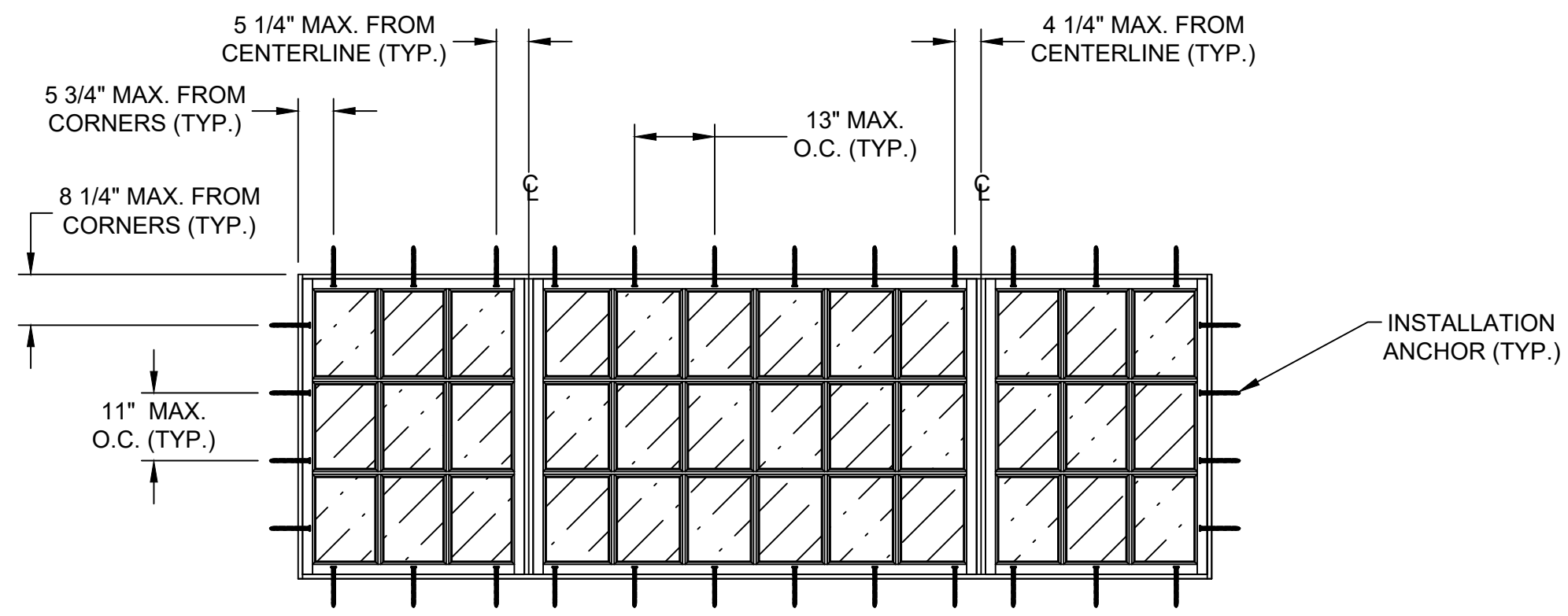

ANCHOR LAYOUT

EXTERIOR VIEW

PROJECT NO. 421-0102					

SIMPSON DOOR COMPANY 400 SIMPSON AVE. MCCLEARY, WA 98557	TITLE: MULLED TRIPLE TRANSOM / FIXED WINDOW ELEVATION & ANCHOR LAYOUT	DATE:	6/8/21
		DRAWN BY:	RJA
		SCALE:	N.T.S.
		REV:	---
DRAWING NO.:	SIMP0025	SHEET:	2 OF 4

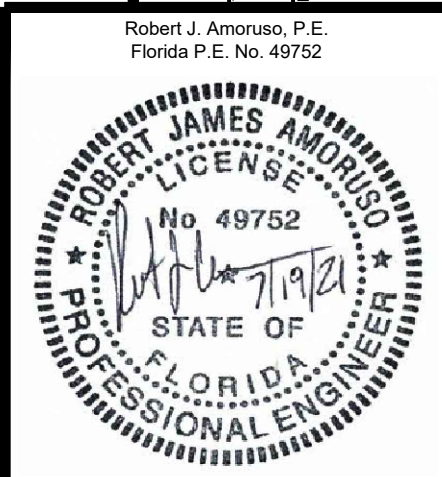

Robert J. Amoruso, P.E.
Florida P.E. No. 49752

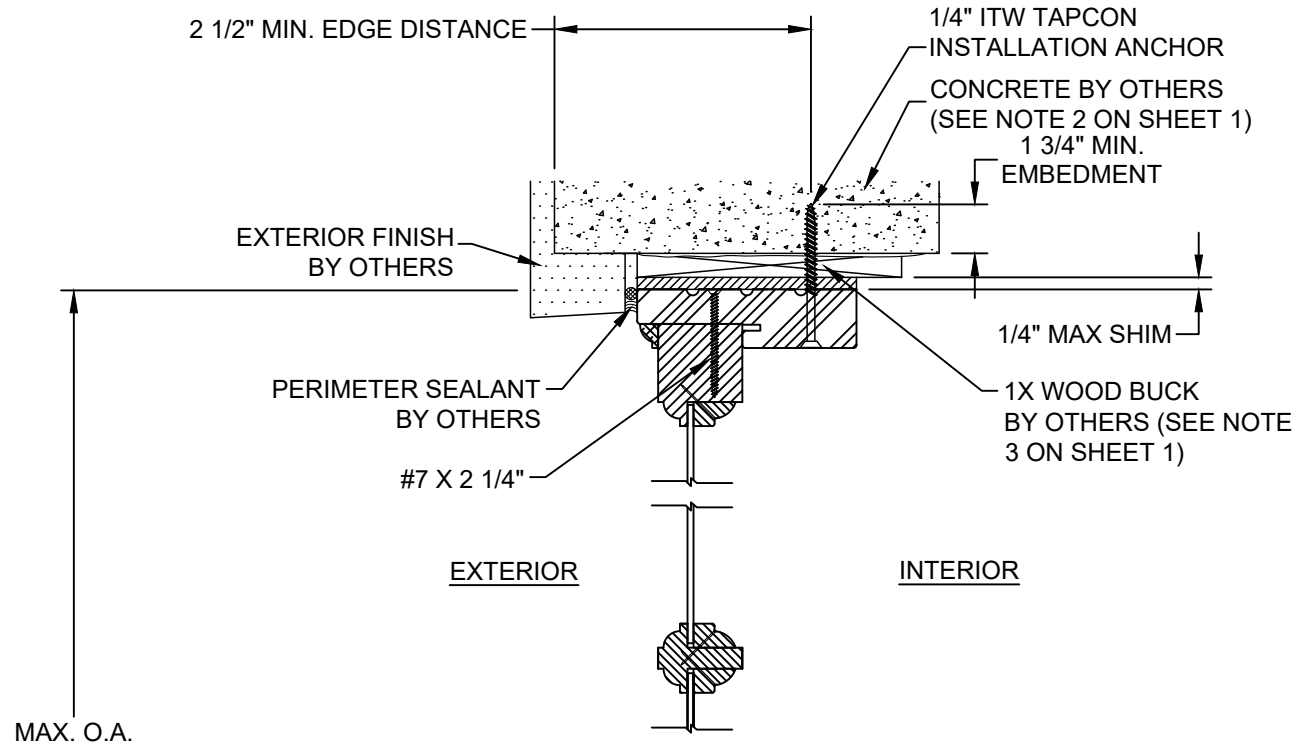

B VERTICAL SECTION
CONCRETE SUBSTRATE

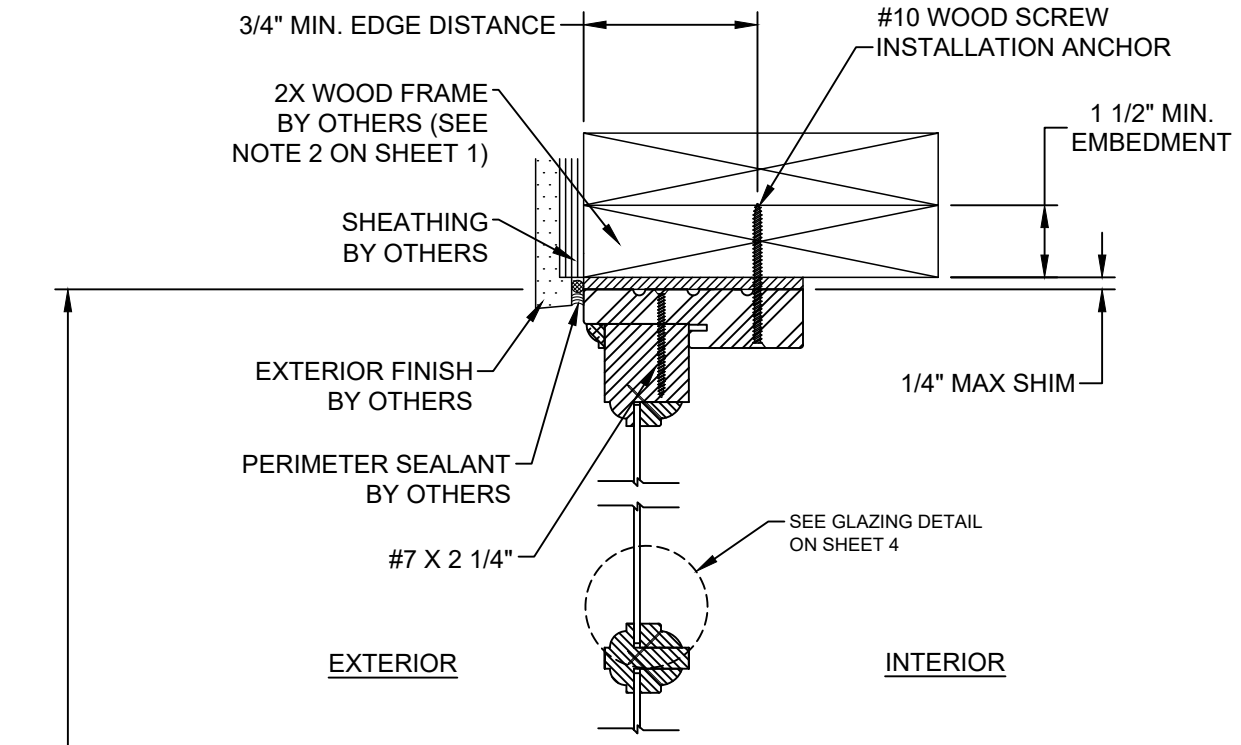

D VERTICAL SECTION
WOOD FRAME SUBSTRATE

MAX. O.A.
FRAME
HEIGHT

MAX. O.A.
FRAME
HEIGHT

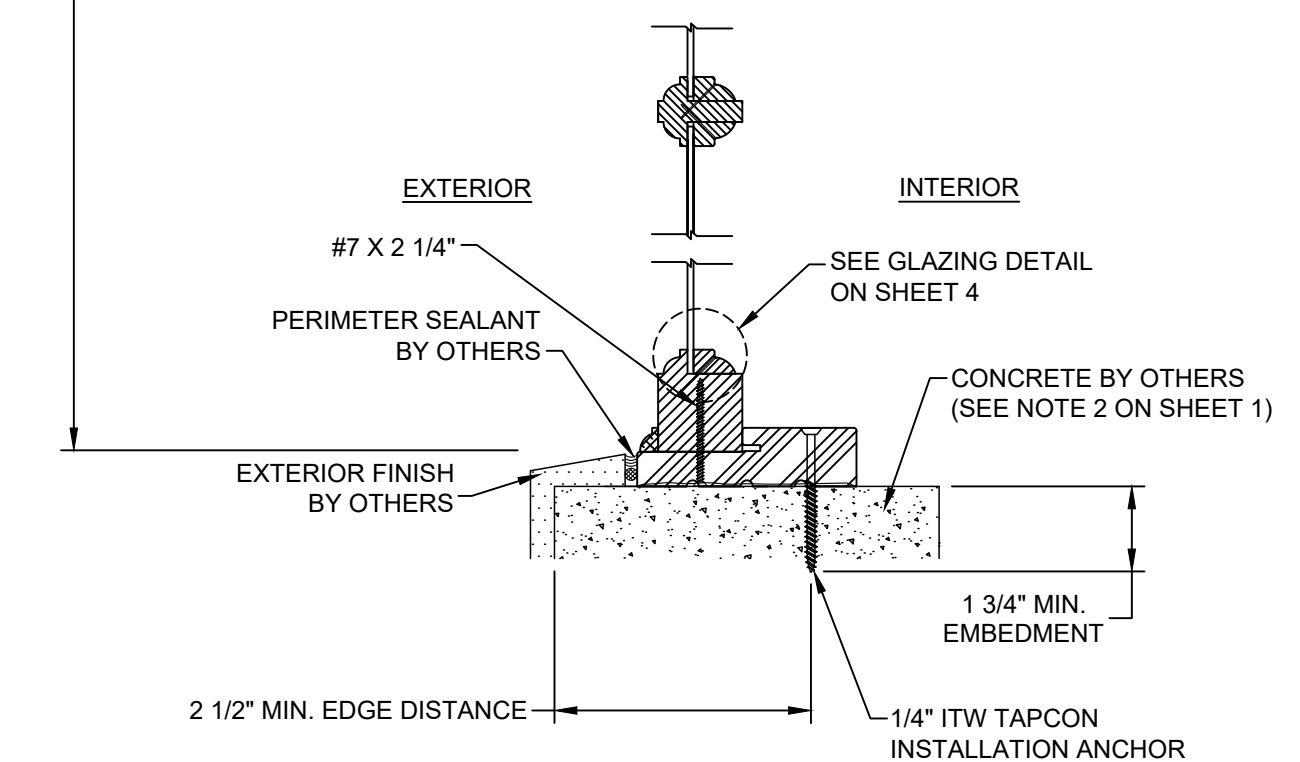

A VERTICAL SECTION
CONCRETE SUBSTRATE

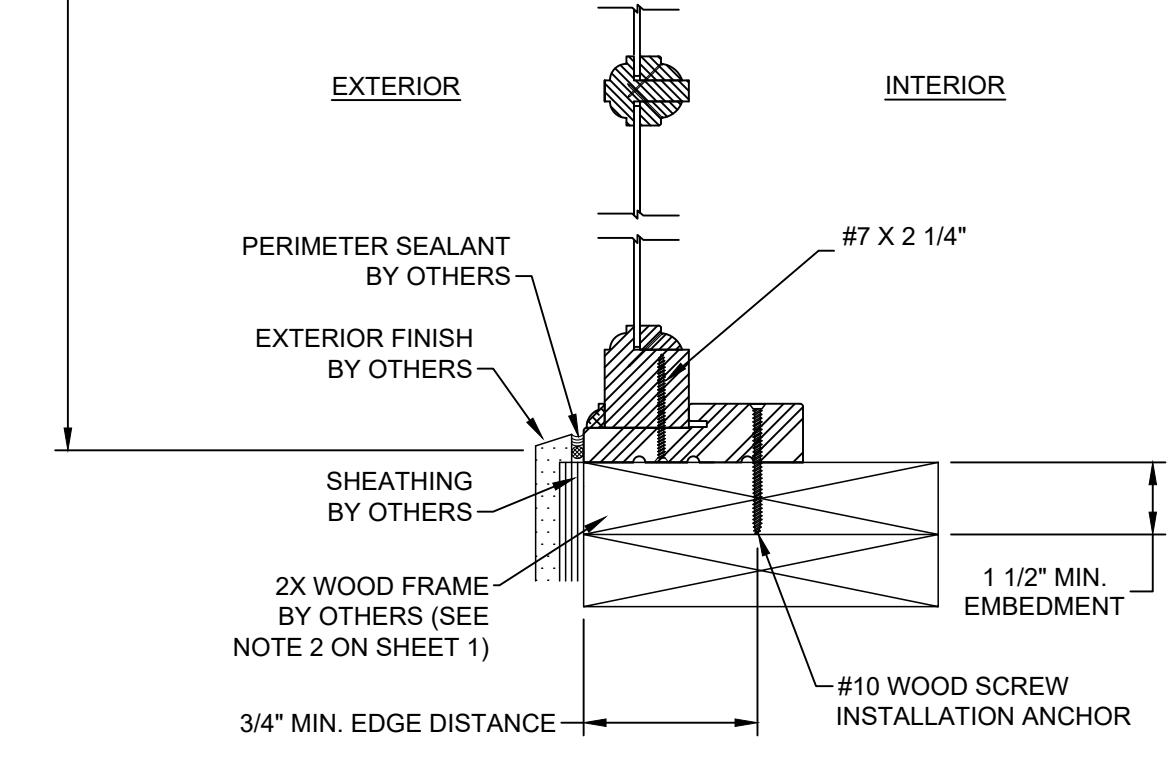

C VERTICAL SECTION
WOOD FRAME SUBSTRATE

PROJECT NO. 421-0102

SIMPSON DOOR COMPANY
400 SIMPSON AVE.
MCCLEARY, WA 98557

TITLE: MULLED TRIPLE TRANSOM / FIXED WINDOW
VERTICAL SECTIONS

DRAWN BY: RJA	DATE: 6/8/21
SCALE: N.T.S.	DRAWING NO: SIMP0025
REV: ---	SHEET: 3 OF 4

PREPARED BY: **FE**
PTC Product Design Group, LLC
PO Box 520775
Lanswood, FL 32752-0775
Phone: 321.690.1788
Fax: 321.690.1789
Email: info@ptc-corp.com
FEPE GA. NO. 45855

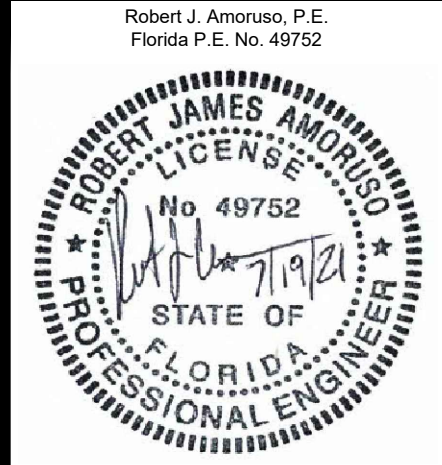

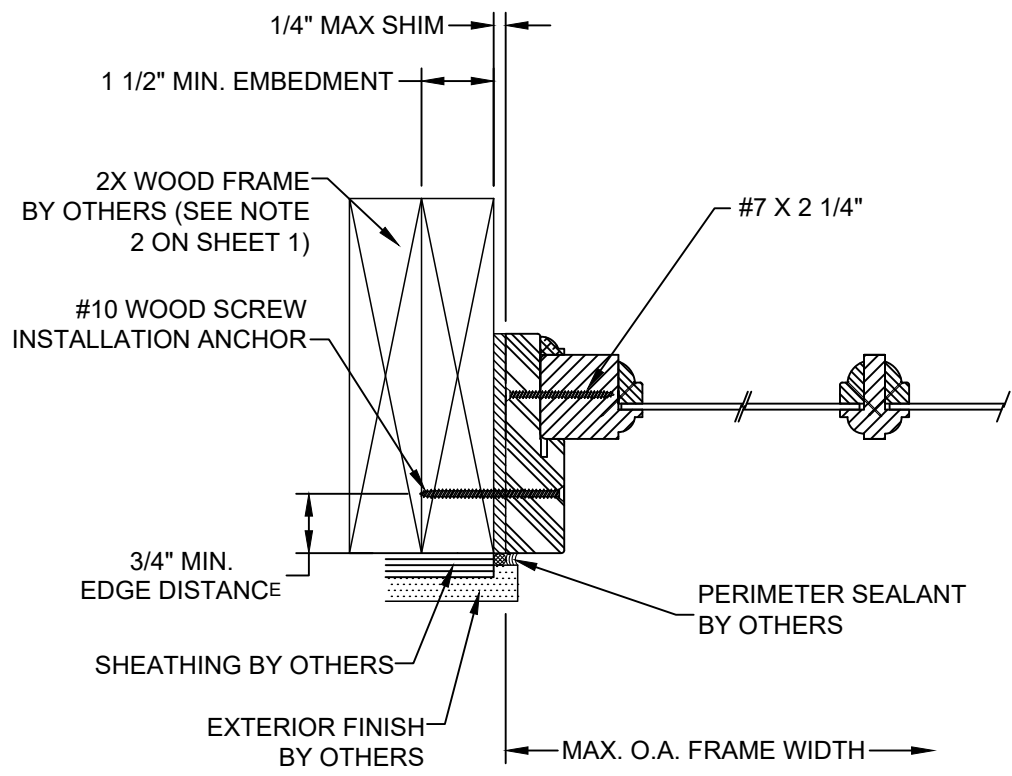

E HORIZONTAL SECTION
WOOD FRAME SUBSTRATE

INTERIOR

EXTERIOR

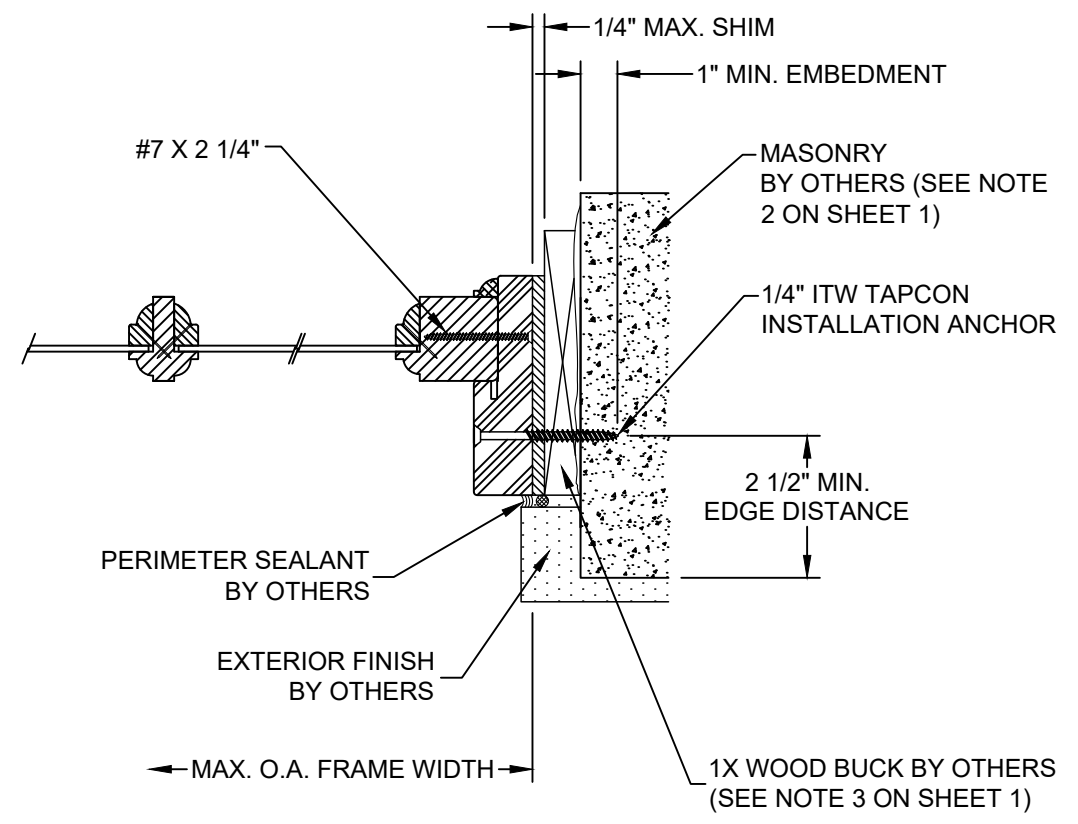

F HORIZONTAL SECTION
MASONRY SUBSTRATE

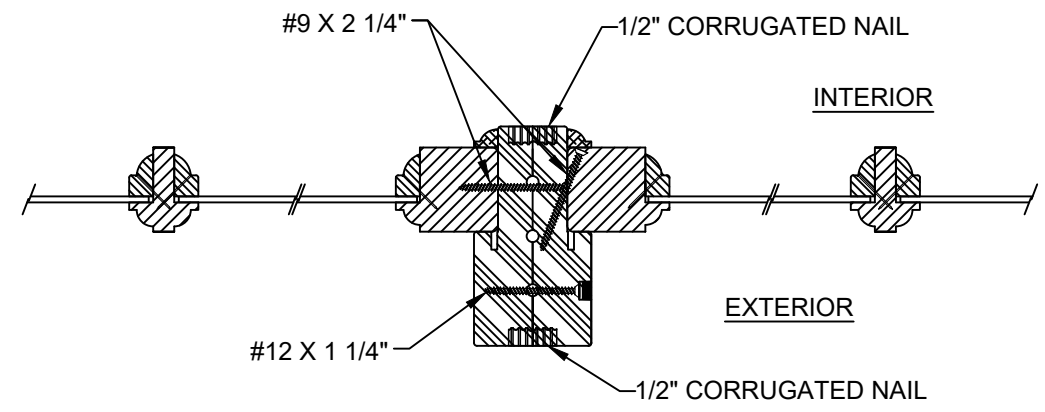

G HORIZONTAL SECTION
MULLION

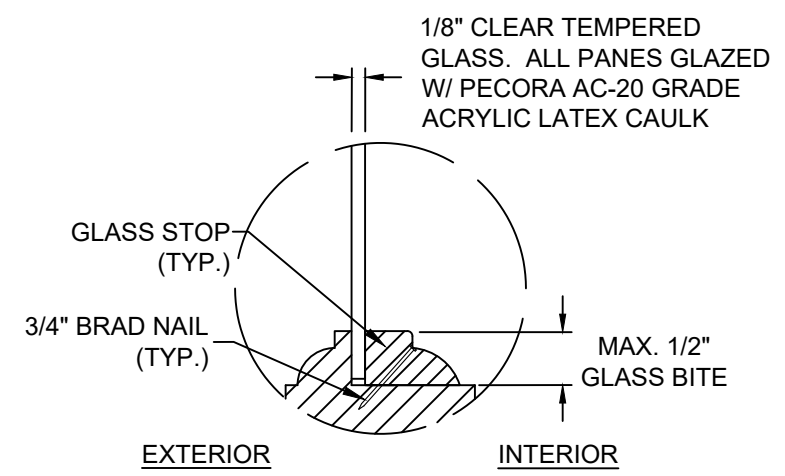

GLAZING DETAIL

PROJECT NO. 421-0102

REV	DESCRIPTION	DATE	BY

SIMPSON DOOR COMPANY
400 SIMPSON AVE.
MCCLEARY, WA 98557

TITLE: MULLED TRIPLE TRANSOM / FIXED WINDOW HORIZONTAL SECTIONS

PREPARED BY: RJA
SCALE: N.T.S.
REV: ---

DATE: 6/8/21
DRAWING NO: SIMP0025
SHEET: 4 OF 4

PTC Product Design Group, LLC
PO Box 520775
Lanswood, FL 32752-0775
Phone: 321.690.1788
Fax: 321.690.1789
Email: info@ptc-corp.com
FEPE GA. NO. 43555

Robert J. Amoruso, P.E.
Florida P.E. No. 49752

