

Doors tested per ANSI/DASMA 108 for static air pressure and ANSI/DASMA 115 for large missile impact and cyclic wind pressure

Max. Door Width	Colonial		Ranch		Carriage House	
	Ctr. Hngs. per Sect.	Design Loads	Ctr. Hngs. per Sect.	Design Loads	Ctr. Hngs. per Sect.	Design Loads
8'-2"	1	48.9 -55.3	1	48.9 -55.3	1	48.9 -55.3
9'-2"	1	41.4 -46.4	1	41.4 -46.4	2	27.4 -31.0
10'-2"	2	27.4 -31.0	2	27.4 -31.0	2	23.3 -26.0
12'-2"	2	16.8 -18.7	3	16.8 -18.7	3	12.3 -13.8
14'-2"	3	12.3 -13.8	4	12.3 -13.8	4	12.3 -13.8
16'-2"	3	12.3 -13.8	4	12.3 -13.8	4	12.3 -13.8
18'-2"	4	12.3 -13.8	4	12.3 -13.8	4	12.3 -13.8
20'-2"	4	12.3 -13.8	4	12.3 -13.8	4	12.3 -13.8



Scott A. Brown, P.E. Lic. No. 65940  
 Wender Engineering Services, Inc.  
 698 Timber Creek Road, Dixon, IL 61021  
 FBPE CA Lic. No. 31544  
 Structural Adequacy for Wind Load

Printed copies of this document are not considered signed and sealed and the SHA authentication code must be verified on any electronic copies.

Scale: None		Title: Spec, Wind Load Commercial Encore	
Drawn by: R. Frey		RAYNOR	
Checked by: G. Wedekind		1101 East River Road Dixon, IL. 61021	
Date: 07/26/22		No. P-3403	
ECO: 8593.02		Sheet 1 of 4	
Rev. A		Rev. A	

**Jamb Attachment Notes:**

1. Maximum Positive Load per Jamb = (12'-0" x 41.4 PSF) / 2 = 249 lbs. per foot.
2. Maximum Negative Load per Jamb = (12'-0" x -46.4 PSF) / 2 = 279 lbs. per foot.
3. Design of the supporting structure shall be the sole responsibility of the building designer and shall be designed for the jamb loads listed in notes 1 and 2.
4. Alternate jamb attachments may be used if approved by a registered Professional Engineer.
5. DASMA Technical Data Sheet TDS-161 may be used for alternate jamb attachments.
6. 3/8" diameter lag screws required 1/4" pilot hole and 1-1/2" minimum required distance.
7. Masonry fasteners by others.

2x6 Attachment to Structure						
Structure Type	Fastener Type	Minimum Embedment	Minimum Edge Distance	Minimum on Center Spacing	Maximum on Center Spacing	Allowable Tension Load
2500 PSI Min. Concrete	1/4" Tapcon+ (Plus) with 1-1/8" OD Washer	2"	2.5	6"	24"	526
Southern Pine	3/8" x 3" Lag with 1-1/8" OD Washer	1.50"	1.50"	1.50"	24"	655
Spruce Pine Fir	3/8" x 3" LAG with 1-1/8" OD Washer	1.50"	1.50"	1.50"	23"	482

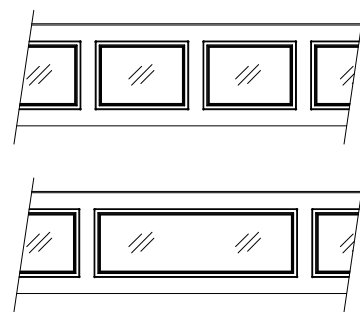

Window Styles

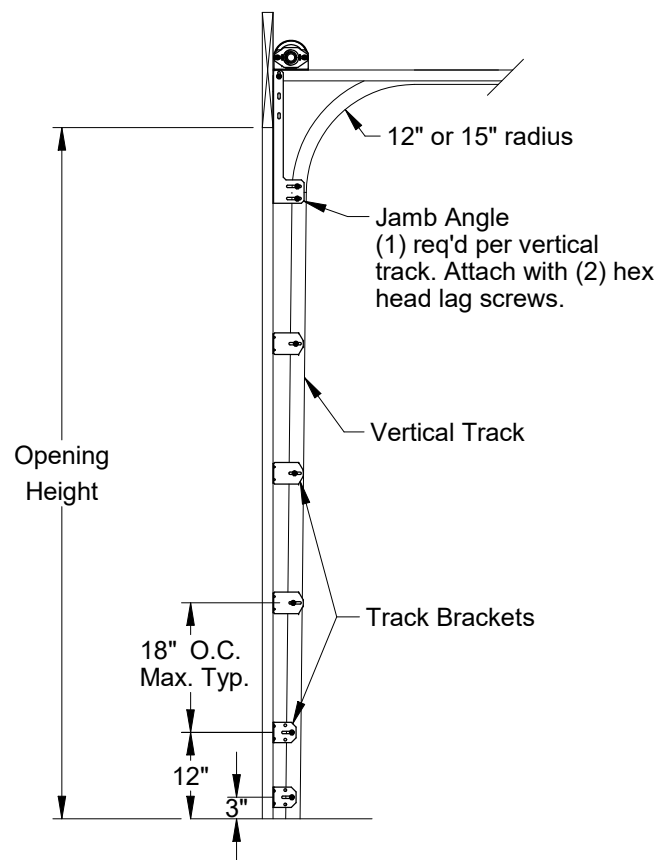
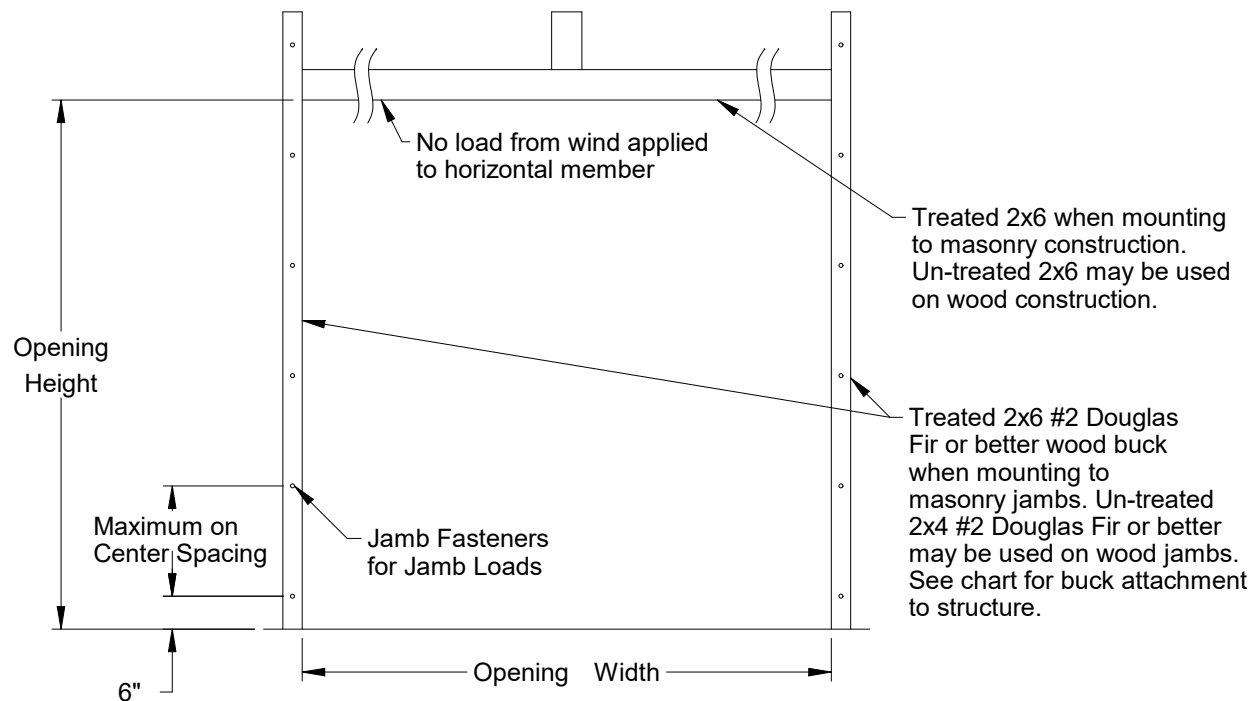

Typical Track Installation  
Bracket Mount  
Wood Jambs

Normal headroom track shown, low headroom, lift clearance and vertical lift track available.

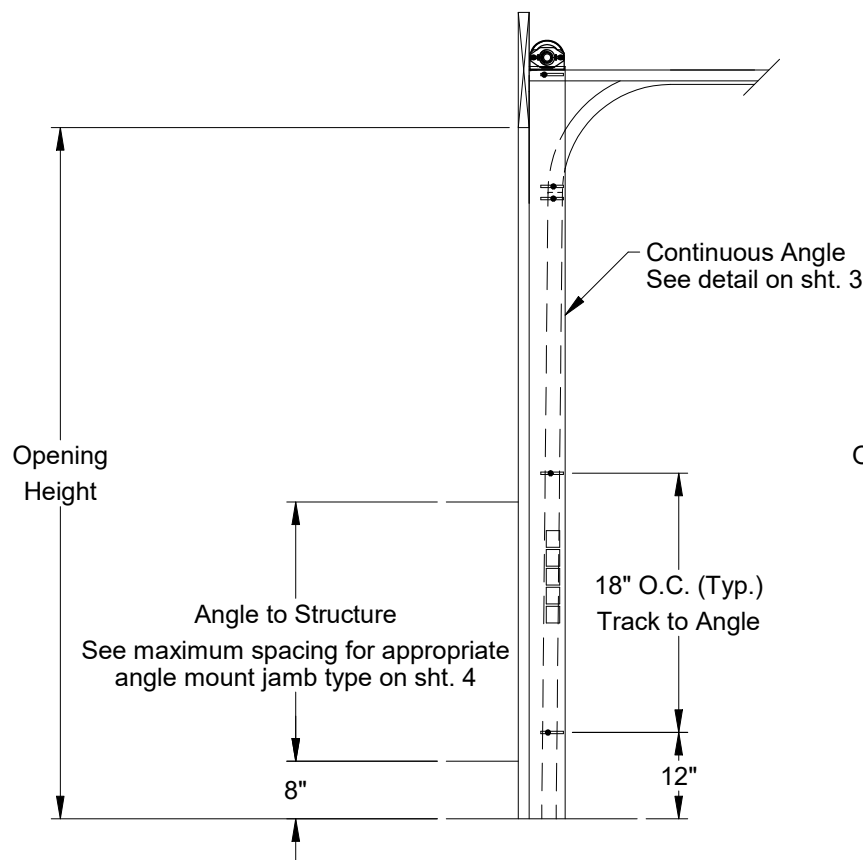

Typical Track Installation  
Angle Mount  
Wood, Steel or Concrete Jambs

Normal headroom track shown, low headroom, lift clearance and vertical lift track available.

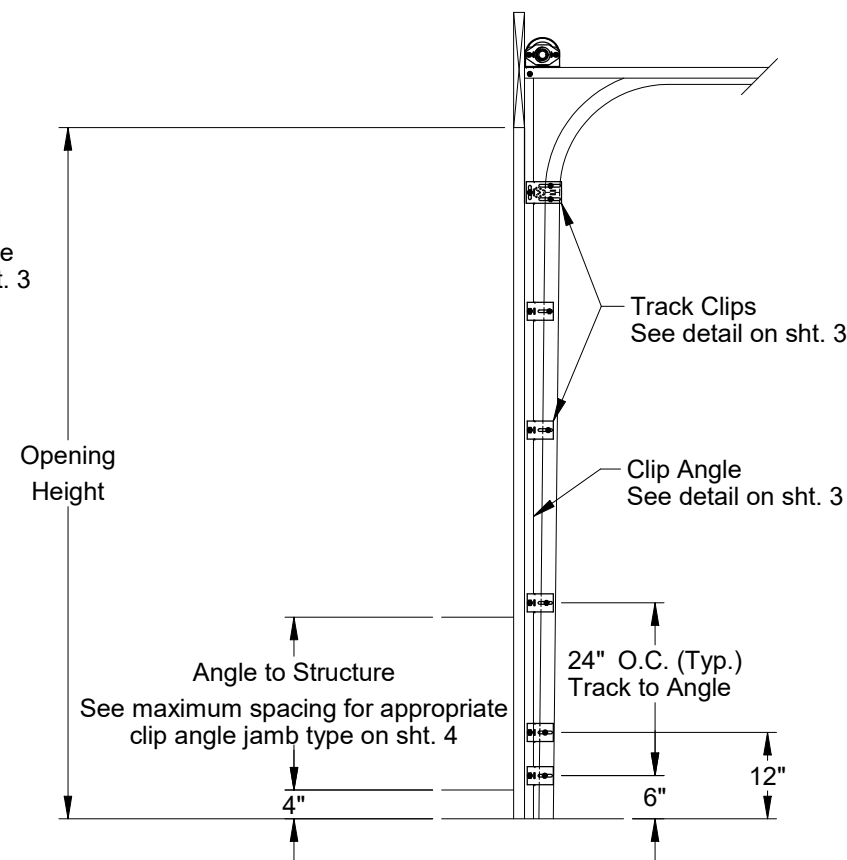

Typical Track Installation  
Pre-Assembled Clip Angle  
Wood, Steel or Concrete Jambs

Normal headroom track shown, lift clearance and vertical lift track available.



Scott A. Brown, P.E. Lic. No. 65940  
Wendler Engineering Services, Inc.  
698 Timber Creek Road, Dixon, IL 61021  
FBPE CA Lic. No. 31544  
Structural Adequacy for Wind Load

Scale: None	<p>1101 East River Road Dixon, IL. 61021</p>	Title: Spec, Wind Load Commercial Encore	
Drawn by: R. Frey		No. P-3403	Sheet 2
Checked by: G. Wedekind			Rev A
Date: 07/26/22		ECO: 8593.02	

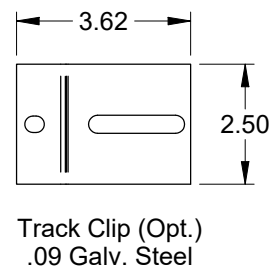
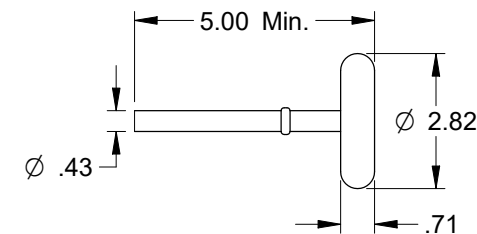
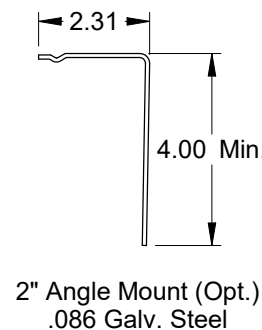
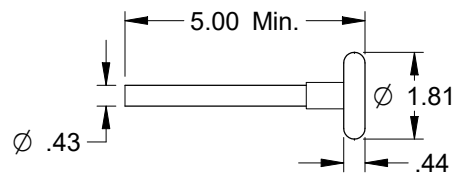
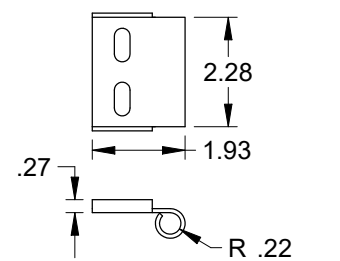
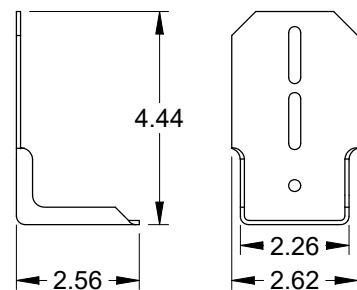
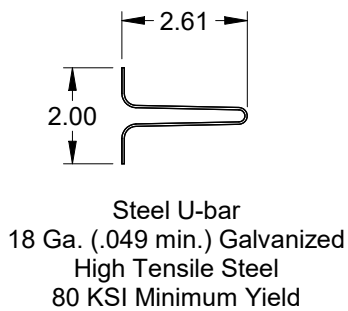
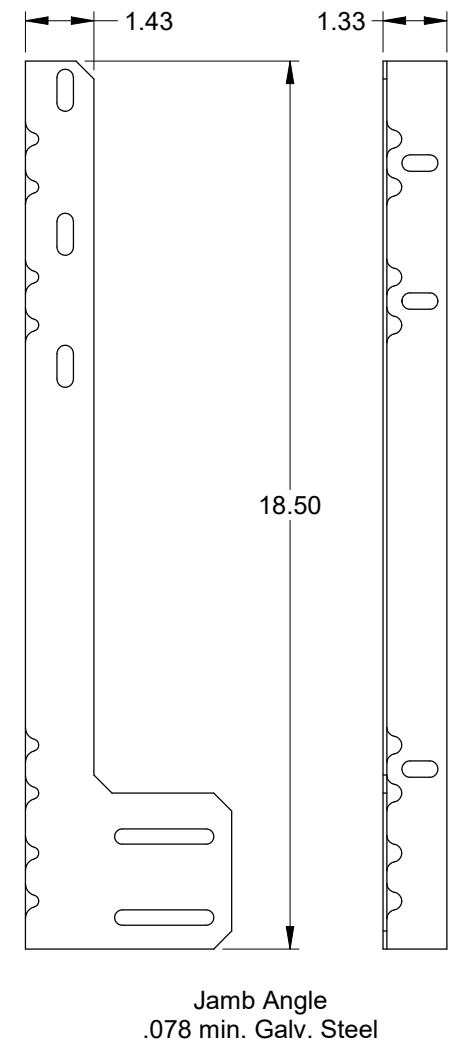
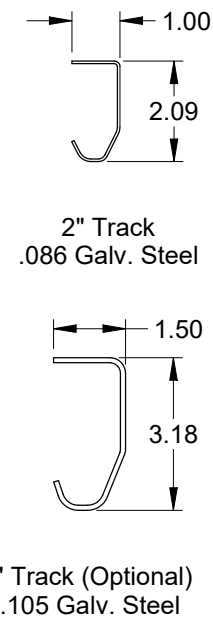
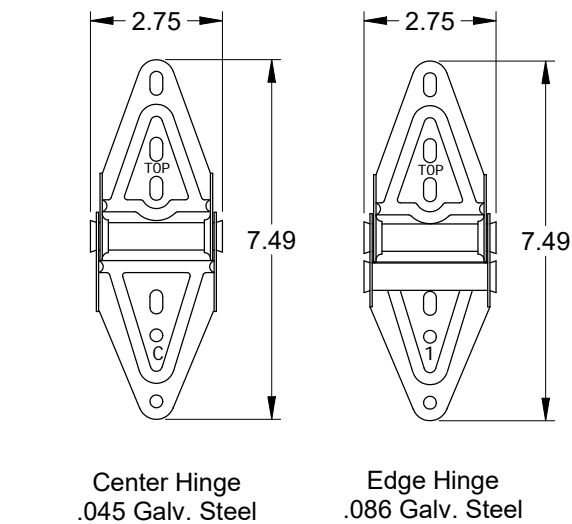
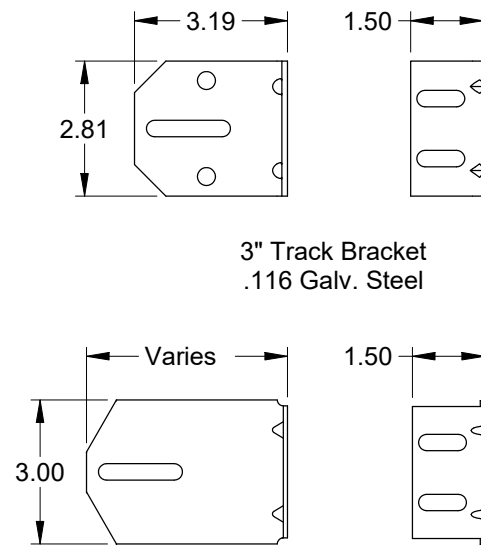
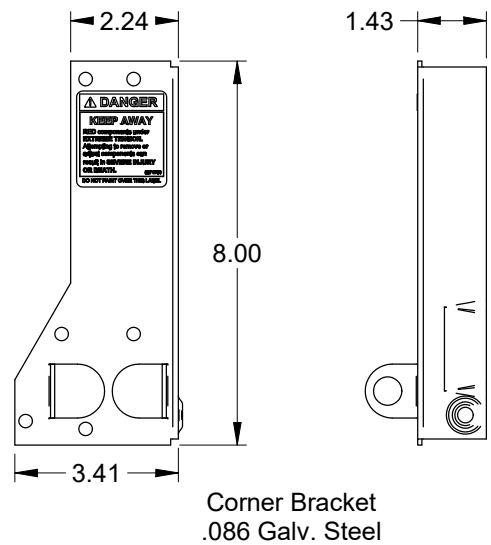

**Top Fixture**  
.085 Galv. Steel

**Roller Carrier**  
.114 Galv. Steel  
Attached to Top Fixture  
w/(2) Track Bolts and Whiz Nuts

**2" Angle Mount (Opt.)**  
.086 Galv. Steel

**3" Roller**  
Steel 10-ball (Opt.)

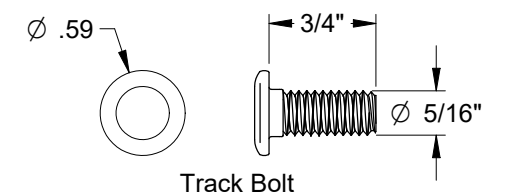
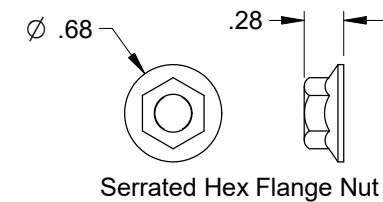
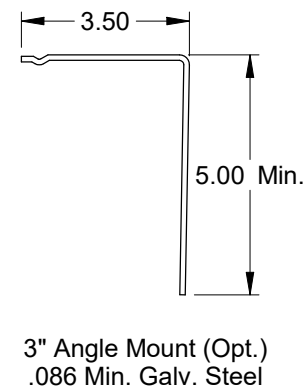
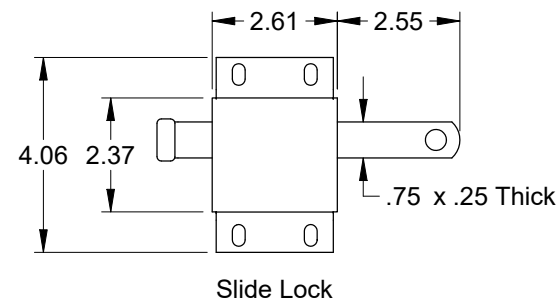
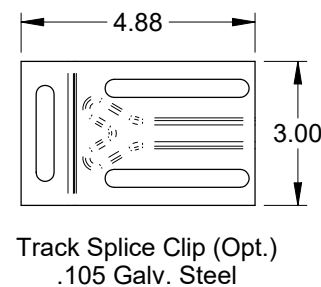
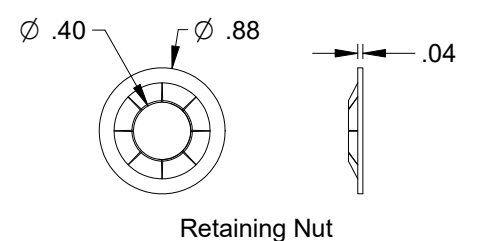

Scott A. Brown, P.E. Lic. No. 65940  
Wendler Engineering Services, Inc.  
698 Timber Creek Road, Dixon, IL 61021  
FBPE CA Lic. No. 31544  
Structural Adequacy for Wind Load

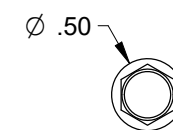
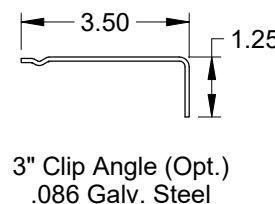
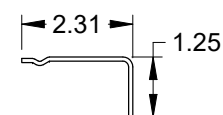

**Self-Drilling Screw**

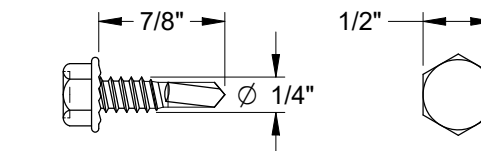

**Hex Head Lag Screw**

Scale: None	<p>1101 East River Road Dixon, IL 61021</p>	Title: Spec, Wind Load Commercial Encore	
Drawn by: R. Frey		No. P-3403	Sheet 3
Checked by: G. Wedekind			Rev A
Date: 07/26/22		ECO: 8593.02	

Angle Mount					
Jamb Type	Fastener Type	Minimum Embedment (in.)	Minimum Edge Distance (in.)	Maximum on Center Spacing (in.)	Allowable Tension Load (lbs.)
2500 PSI Min. Concrete	3/8" ITW Trubolt	2-1/2"	2-1/2"	36"	893
	1/4" Tapcon+ (Plus) with 1-1/8" OD Washer	2"	1-5/8"	18"	687
	1/4" x 2-5/8" Screw-Bolt+ with 9/16" OD Washer	2-1/2"	1-1/2"	18"	651
Steel	5/16" x 1" SAE J78, Min. AISI 1022 with 5/16" Washer	3/16"	1-1/2"	36"	971
Wood	5/16" x 1-3/4" Lag with 5/16" Washer	1-1/2"	1-1/2"	12"	352
Grout Filled CMU Block	3/8" Simpson Titen HD	2-3/4"	4"	18"	480

Alternate fasteners may be used if approved by a registered Professional Engineer.

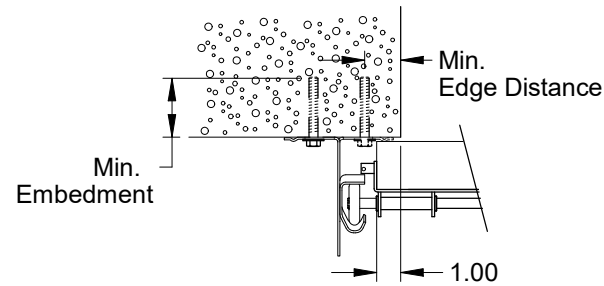

**Track Assembly Attachment to 2500 PSI Min. Concrete**

2" Angle mount turned-out standard (solid)  
2" Angle mount turned-in optional (dashed)  
3" Angle mount available

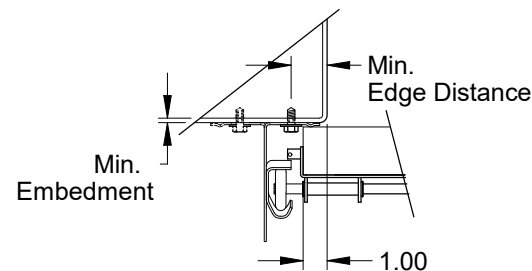

**Track Assembly Attachment to 3/16" Min. Steel Jamb**

2" Angle mount turned-out standard (solid)  
2" Angle mount turned-in optional (dashed)  
3" Angle mount available

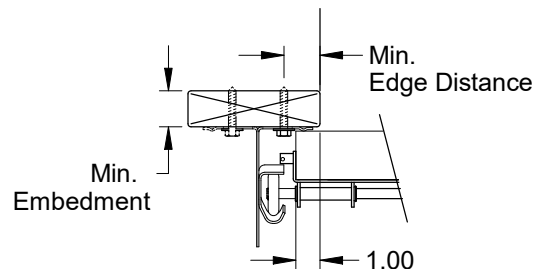

**Track Assembly Attachment to Wood Jamb**

2" Angle mount turned-out standard (solid)  
2" Angle mount turned-in optional (dashed)  
3" Angle mount available

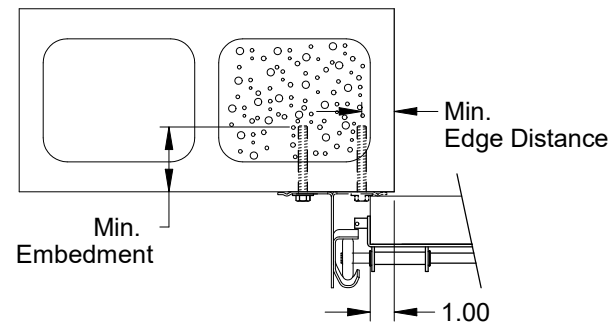

**Track Assembly Attachment to Grout Filled CMU Block**

2" Angle mount turned-out standard (solid)  
2" Angle mount turned-in optional (dashed)  
3" Angle mount available



Scott A. Brown, P.E. Lic. No. 65940  
Wendler Engineering Services, Inc.  
698 Timber Creek Road, Dixon, IL 61021  
FBPE CA Lic. No. 31544  
Structural Adequacy for Wind Load

Pre-Assembled Clip Angle					
Jamb Type	Fastener Type	Minimum Embedment (in.)	Minimum Edge Distance (in.)	Maximum on Center Spacing (in.)	Allowable Tension Load (Lbs.)
2500 PSI Min. Concrete	3/8" ITW Trubolt	2-1/2"	2-1/2"	24"	893
	1/4" Tapcon+ (Plus) with 1-1/8" OD Washer	2"	1-5/8"	24"	687
	1/4" x 2-5/8" Screw-Bolt+ with 9/16" OD Washer	2-1/2"	1-1/2"	24"	651
Steel	5/16" x 1" SAE J78, Min. AISI 1022 with 5/16" Washer	3/16"	1-1/2"	24"	971
Wood	5/16" x 1-3/4" Lag with 5/16" Washer	1-1/2"	1-1/2"	*12"	352
Grout Filled CMU Block	3/8" Simpson Titen HD	2-3/4"	4"	*12"	480

\* Field drilling req'd.

Alternate fasteners may be used if approved by a registered Professional Engineer.

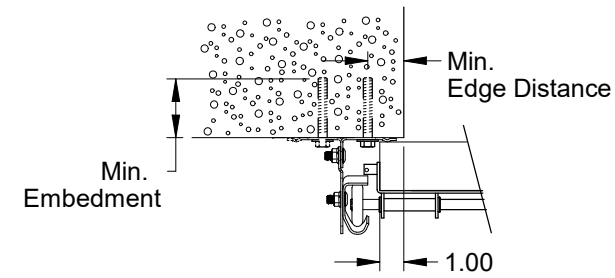

**Pre-Assembled Track Assembly Attachment to 2500 PSI Min. Concrete**

2" Clip angle turned-in standard (solid)  
2" Clip angle turned-out optional (dashed)  
3" Clip angle available

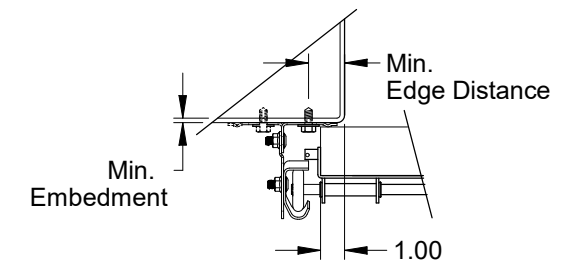

**Pre-Assembled Track Assembly Attachment to 3/16" Min. Steel Jamb**

2" Clip angle turned-in standard (solid)  
2" Clip angle turned-out optional (dashed)  
3" Clip angle available

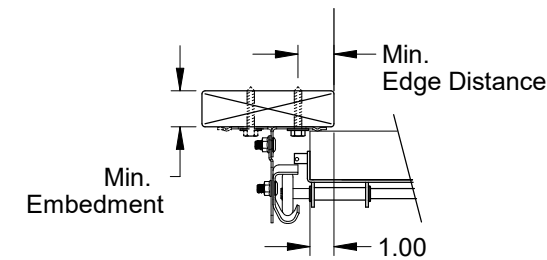

**Pre-Assembled Track Assembly Attachment to Wood Jamb**

2" Clip angle turned-in standard (solid)  
2" Clip angle turned-out optional (dashed)  
3" Clip angle available

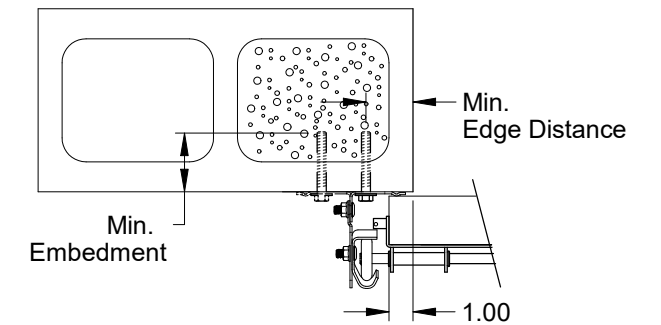

**Pre-Assembled Track Assembly Attachment to Grout Filled CMU Block**

2" Clip angle turned-in standard (solid)  
2" Clip angle turned-out optional (dashed)  
3" Clip angle available

Scale: None
Drawn by: R. Frey
Checked by: G. Wedekind
Date: 07/26/22
ECO: 8593.02



Title: Spec, Wind Load Commercial Encore	
No. P-3403	Sheet 4
Rev A	