

3" ALUM. MULL BAR - NON-IMPACT

SHOWN w/DIFFERENT OPTIONS

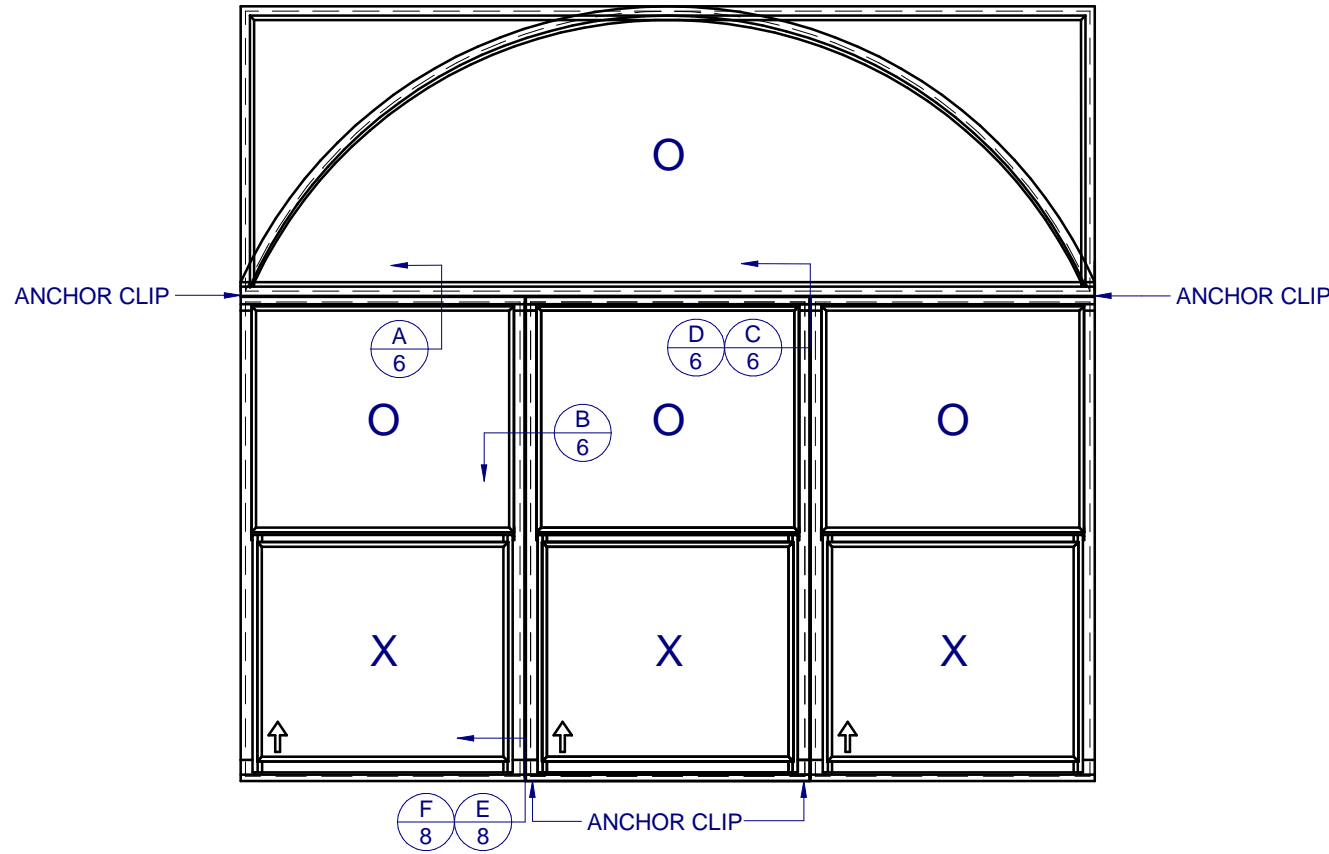

EXAMPLE HORIZ./VERT. MULLION FOR SECTION VIEW ONLY

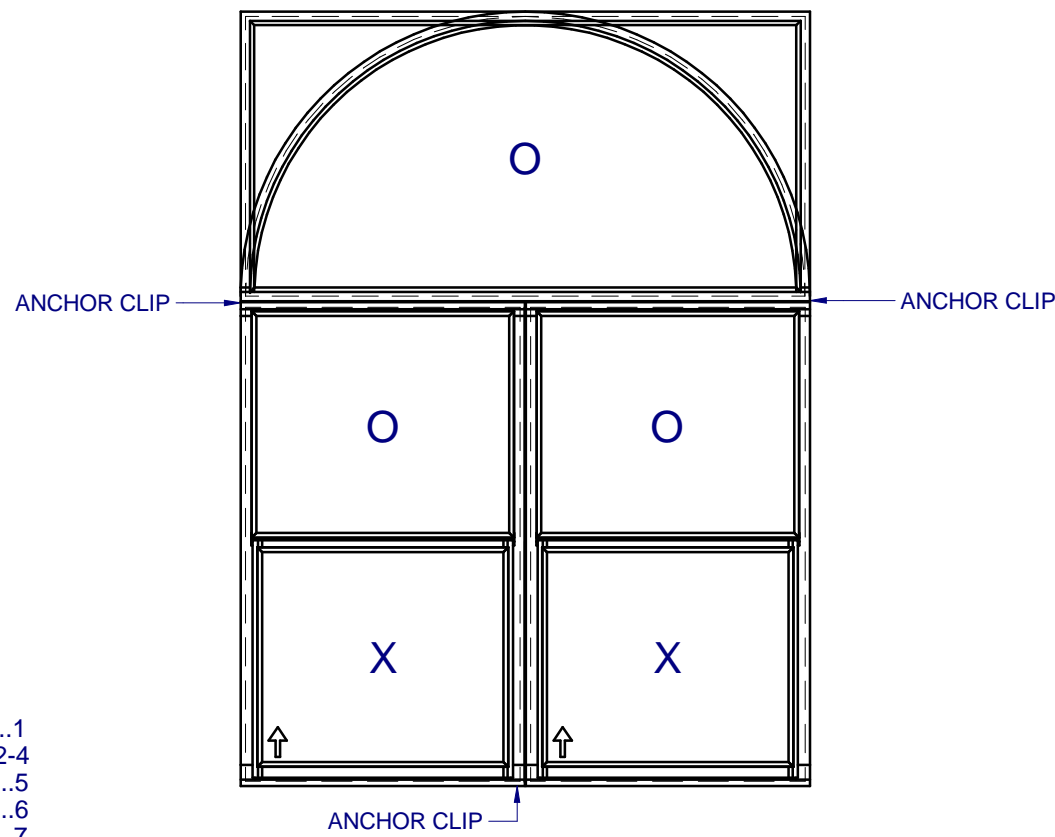

EXAMPLE HORIZ./VERT. MULLION FOR SECTION VIEW ONLY

GENERAL NOTES:

1. THE PRODUCT SHOWN HEREIN IS DESIGNED AND MANUFACTURED TO COMPLY WITH THE FLORIDA BUILDING CODE (FBC), CURRENT EDITION.
2. CONFIGURATIONS (SEE SHEET 2): VERTICAL OR HORIZONTAL.
3. SEE MULLION CHARTS FOR MAX. DESIGN PRESSURES AND LENGTH. (REFER TO SHEETS 2-4)
4. ANCHORAGE: THE 33 1/3% STRESS INCREASE HAS NOT BEEN USED IN THE DESIGN OF THIS PRODUCT. SEE SHEET 8 FOR ANCHOR DETAIL. WINDLOAD DURATION FACTOR Cd=1.6 WAS USED FOR WOOD ANCHOR CALCULATIONS.
5. NOT APPROVED FOR IMPACT RESISTANCE. IMPACT PROTECTIVE SYSTEM IS REQUIRED IN WIND BORNE DEBRIS REGION.
6. DESIGN PRESSURE OF MULLED UNITS SHALL BE CONTROLLED BY THE LESSER DESIGN PRESSURE OF THE MULLION OR THE INDIVIDUAL WINDOW UNITS.
7. DESIGN PRESSURES AND INSTALLATION DETAILS SHOWN IN THIS DOCUMENT APPLY ONLY TO THE MULLION. WINDOWS MUST BE APPROVED UNDER SEPARATE APPROVAL.
8. RESPONSIBILITY OF SELECTING FENESTRATION PRODUCTS TO MEET ANY APPLICABLE LOCAL LAWS, BUILDING CODES, ORDINANCES OR OTHER SAFTEY REQUIREMENTS RESTS SOLEY WITH THE ARCHITECT, ENGINEER OF RECORD, BUILDING OWNER OR CONTRACTOR.
9. SINGLE UNITS TO BE MULLED ARE NOT LIMITED TO THOSE SHOWN IN THIS DRAWING. SINGLE UNITS TO BE MULLED TOGETHER MUST BE MANUFACTURED BY CUSTOM WINDOW SYSTEMS, INC. AND MUST BE MADE OUT OF VINYL PVC OR EXTRUDED ALUMINUM.
10. VERTICAL MULLED UNITS MAY BE MULLED INDEFINITELY AS LONG AS THE SINGLE UNIT WIDTH AND HEIGHT ARE NOT EXCEEDED, AND MULLIONS ARE ANCHORED AS SHOWN HERE IN.
11. HORIZONTAL MULLION SHALL EXTEND THE ENTIRE WIDTH OF THE MULLED UNIT. VERTICAL MULLION IS USED TO MULL SIDE BY SIDE UNITS TOGETHER.

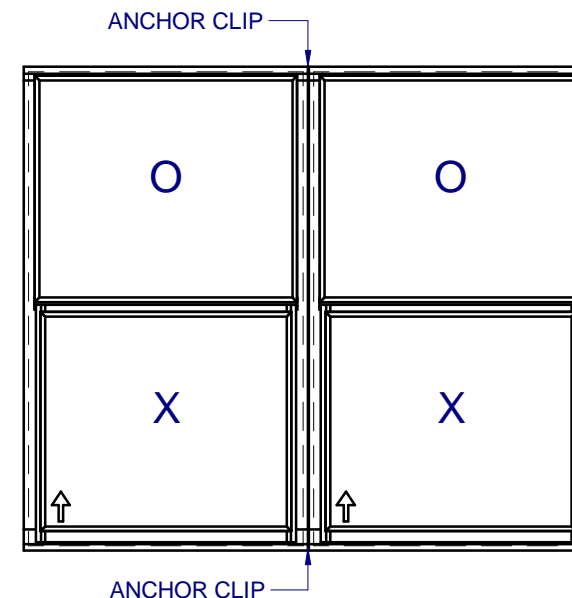

EXAMPLE VERT. MULLION FOR SECTION VIEWS ONLY

TABLE OF CONTENTS

GENERAL NOTES & ELEVATIONS.....	1
DP CHARTS.....	2-4
BOM & EXTRUSIONS.....	5
SECTION VIEWS.....	6
CONFIGURATIONS & ANCHOR NOTES.....	7
INSTALLATION DETAILS.....	8



1900 SW 44TH AVE.
OCALA, FLORIDA 34474
WWW.CWS.CC

3" ALUM. MULL BAR NON-IMPACT

PROPRIETARY AND CONFIDENTIAL
THE INFORMATION CONTAINED IN THIS DRAWING IS THE SOLE PROPERTY OF CUSTOM WINDOW SYSTEMS, INC. ANY REPRODUCTION IN PART OR AS A WHOLE WITHOUT THE WRITTEN PERMISSION OF CUSTOM WINDOW SYSTEMS, INC IS PROHIBITED.

FLORIDA APPROVAL NO.:

5777



9/14/2023

LUCAS A. TURNER, P.E.
FL PE # 58201
Turner Engineering & Consulting, Inc.
2428 Old Natchez Trc Trl
Camden, TN 38320
PH. 941-380-1574

SHEET DESCRIPTION:

GENERAL NOTES AND ELEVATIONS

DRAWN BY:	DATE:
MCS	9/7/2023
DWG #:	REV.:
CWS-234	E
SCALE:	SHEET
1:25	1 OF 8

DESIGN PRESSURE CHART (PSF) FOR NON-IMPACT ALUMINUM 3" MULLION H-1952, HORIZONTAL OR VERTICAL, WITH 1522 CLIPS USING FOUR (4) #10 SCREWS INTO WOOD or METAL, FOUR (4) 3/16" ITW TAPCONS or DEWALT ULTRACON+ INTO SOLID CONCRETE or TWO (2) 1/4" ITW TAPCONS or DEWALT ULTRACON+ INTO HOLLOW or GROUT-FILLED BLOCK WITH WASHERS PER CLIP

MULL LENGTH (in.)	OPENING WIDTH (in.)																
	39	45	51	57	63	69	75	81	87	93	99	106.375	114	120	132	144	
37	120.0	120.0	120.0	120.0	120.0	120.0	120.0	120.0	120.0	120.0	113.3	107.2	99.8	93.4	89.0	81.3	74.8
42.75	120.0	120.0	120.0	120.0	120.0	120.0	120.0	118.3	110.3	103.3	97.1	91.8	85.7	80.3	76.5	69.9	64.3
48.75	120.0	120.0	120.0	120.0	119.8	110.5	102.5	95.6	89.6	84.3	79.8	74.4	69.8	66.5	60.9	56.0	
53.125	120.0	120.0	120.0	118.7	108.9	100.4	93.3	87.1	81.6	76.8	72.8	67.9	63.7	60.7	55.5	51.2	
57	120.0	120.0	120.0	109.6	100.5	92.9	86.2	80.5	75.5	71.1	67.4	62.9	59.0	56.3	51.5	47.5	
63	120.0	118.8	107.2	97.7	89.7	82.9	77.1	72.1	67.6	63.7	60.4	56.4	53.0	50.6	46.3	42.7	
66.75	120.0	110.9	100.2	91.4	84.0	77.7	72.3	67.6	63.4	59.8	56.7	53.0	49.7	47.5	43.5	40.1	
72	114.1	101.3	91.6	83.6	76.9	71.2	66.3	62.0	58.3	55.0	52.1	48.8	45.8	43.7	40.1	37.0	
76	107.2	95.0	85.9	78.5	72.2	66.9	62.4	58.4	54.8	51.7	49.1	45.9	43.2	41.2	37.8	34.9	
80	101.1	89.5	80.7	73.8	68.0	63.1	58.8	55.1	51.8	48.8	46.4	43.4	40.7	38.7	35.2	32.3	
84	95.6	84.5	75.2	67.9	62.1	57.4	52.9	49.1	45.8	42.9	40.5	37.6	35.1	33.4	30.4	27.9	
90	78.4	68.4	60.8	54.9	50.1	46.2	43.0	39.9	37.2	34.8	32.9	30.5	28.5	27.1	24.7	22.7	
96	64.5	56.2	49.9	45.0	41.0	37.8	35.1	32.8	30.6	28.7	27.0	25.1	23.5	22.3	20.3	18.6	
102	53.6	46.7	41.5	37.4	34.0	31.3	29.1	27.2	25.5	23.9	22.5	20.9	19.5	18.6	16.9	15.5	
106.38	47.2	41.1	36.5	32.8	29.9	27.5	25.5	23.8	22.4	21.0	19.8	18.4	17.2	16.4	-	-	
114	38.3	33.3	29.6	26.6	24.2	22.2	20.6	19.2	18.0	17.0	16.1	-	-	-	-	-	
120	32.8	28.5	25.3	22.7	20.7	19.0	17.6	16.4	15.4	-	-	-	-	-	-	-	
126	28.3	24.6	21.8	19.6	17.8	16.3	15.1	-	-	-	-	-	-	-	-	-	
132	24.6	21.4	18.9	17.0	15.5	-	-	-	-	-	-	-	-	-	-	-	
138	21.5	18.7	16.5	-	-	-	-	-	-	-	-	-	-	-	-	-	

DP CHART IS FOR:
NON-IMPACT 3" MULLION 1952, HORIZONTAL OR VERTICAL, USING EITHER (PER END):

- 1522 CLIPS
- (4) #10 SCREWS INTO WOOD or METAL
- (4) 3/16" ITW TAPCONS or DEWALT ULTRACON+ INTO SOLID CONCRETE or WOOD
- (2) 1/4" DEWALT ULTRACON+ INTO HOLLOW or GROUT-FILLED BLOCK

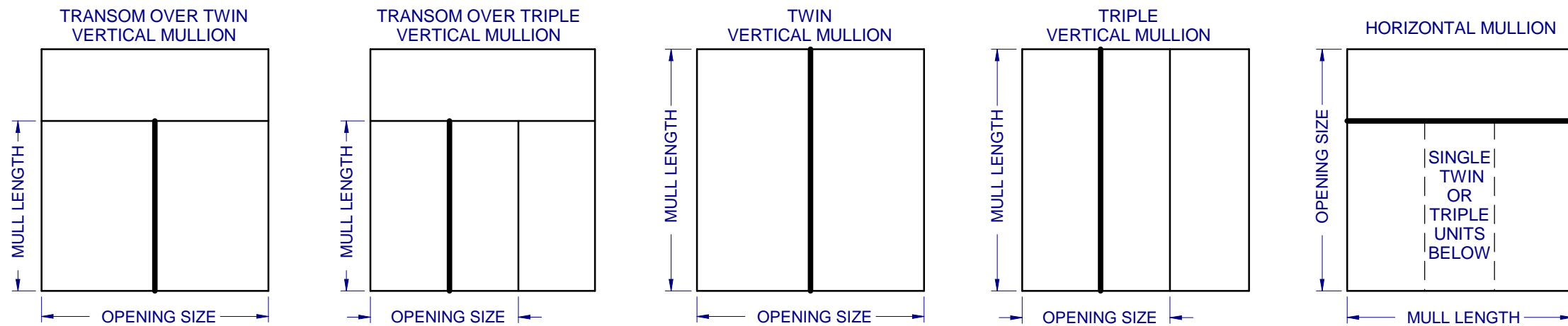

**3" ALUM.
MULL BAR
NON-IMPACT**

PROPRIETARY AND CONFIDENTIAL
THE INFORMATION CONTAINED IN THIS DRAWING IS THE SOLE PROPERTY OF CUSTOM WINDOW SYSTEMS, INC. ANY REPRODUCTION IN PART OR AS A WHOLE WITHOUT THE WRITTEN PERMISSION OF CUSTOM WINDOW SYSTEMS, INC IS PROHIBITED.

FLORIDA APPROVAL NO.:
5777



9/14/2023

LUCAS A. TURNER, P.E.
FL PE # 58201
Turner Engineering & Consulting, Inc.
2428 Old Natchez Trc Trl
Camden, TN 38320
PH. 941-380-1574

SHEET DESCRIPTION:
DP CHART
1522 CLIP
4 ANCHORS

DRAWN BY: MCS	DATE: 9/7/2023
DWG #: CWS-234	REV.: E
SCALE: 1:1	SHEET 2 OF 8

DESIGN PRESSURE CHART (PSF) FOR NON-IMPACT ALUMINUM 3" MULLION H-1952, HORIZONTAL OR VERTICAL, WITH 1522 CLIPS USING TWO (2) #10 SCREWS OR 3/16" ITW TAPCONS or DEWALT ULTRACON+ INTO SOLID CONCRETE WITH WASHERS PER CLIP. HOLLOW or GROUT-FILLED BLOCK REQUIRE TWO (2) 1/4" DEWALT ULTRACON+.

		OPENING WIDTH (in.)															
		39	45	51	57	63	69	75	81	87	93	99	106.375	114	120	132	144
MULL LENGTH (in.)	37	109.4	96.6	86.4	78.2	71.4	65.8	60.9	56.7	53.0	49.9	47.0	43.9	41.1	39.2	35.8	32.9
	42.75	92.7	82.1	73.6	66.7	61.0	56.2	52.1	48.6	45.4	42.7	40.3	37.7	35.3	33.7	30.7	28.3
	48.75	79.6	70.6	63.4	57.6	52.7	48.6	45.1	42.1	39.4	37.1	35.0	32.8	30.7	29.3	26.8	24.7
	53.125	71.9	63.9	57.5	52.3	47.9	44.2	41.0	38.3	35.9	33.8	31.9	29.9	28.0	26.7	24.4	22.5
	57	66.1	58.9	53.0	48.2	44.2	40.9	38.0	35.4	33.2	31.3	29.6	27.7	26.0	24.8	22.7	20.9
	63	58.7	52.3	47.2	43.0	39.5	36.5	34.0	31.7	29.8	28.1	26.5	24.8	23.3	22.3	20.4	18.8
	66.75	54.8	48.8	44.1	40.2	37.0	34.2	31.8	29.7	27.9	26.3	24.9	23.3	21.9	20.9	19.1	17.7
	72	50.2	44.6	40.3	36.8	33.9	31.3	29.2	27.3	25.7	24.2	22.9	21.5	20.2	19.2	17.6	16.3
	76	47.2	41.8	37.8	34.5	31.8	29.5	27.4	25.7	24.1	22.8	21.5	20.2	19.0	18.1	16.6	15.4
	80	44.5	39.4	35.5	32.5	29.9	27.8	25.9	24.2	22.8	21.5	20.3	19.1	18.0	17.1	15.7	-
	84	42.1	37.2	33.5	30.7	28.3	26.2	24.5	22.9	21.6	20.3	19.3	18.1	17.0	16.2	-	-
	90	38.9	34.4	30.9	28.2	26.0	24.2	22.6	21.2	19.9	18.8	17.8	16.7	15.7	15.0	-	-
	96	36.2	32.0	28.7	26.2	24.1	22.4	20.9	19.6	18.5	17.5	16.6	15.6	-	-	-	-
	102	33.9	29.8	26.8	24.4	22.4	20.8	19.5	18.3	17.2	16.3	15.5	-	-	-	-	-
	106.38	32.3	28.5	25.5	23.2	21.3	19.8	18.5	17.4	16.4	15.5	-	-	-	-	-	-
	114	30.0	26.4	23.6	21.4	19.7	18.3	17.1	16.0	15.1	-	-	-	-	-	-	-
	120	28.3	24.9	22.3	20.2	18.6	17.2	16.1	15.1	-	-	-	-	-	-	-	-
126	26.9	23.6	21.1	19.1	17.5	16.2	15.1	-	-	-	-	-	-	-	-	-	
132	24.6	21.4	18.9	17.0	15.5	-	-	-	-	-	-	-	-	-	-	-	
138	21.5	18.7	16.5	-	-	-	-	-	-	-	-	-	-	-	-	-	

DP CHART IS FOR:
NON-IMPACT 3" MULLION 1952, HORIZONTAL OR VERTICAL, USING EITHER (PER END):

- 1522 CLIPS
- (2) #10 SCREWS INTO WOOD or METAL
- (2) 3/16" ITW TAPCONS or DEWALT ULTRACON+ INTO SOLID CONCRETE or WOOD
- (2) 1/4" DEWALT ULTRACON+ INTO HOLLOW or GROUT-FILLED BLOCK

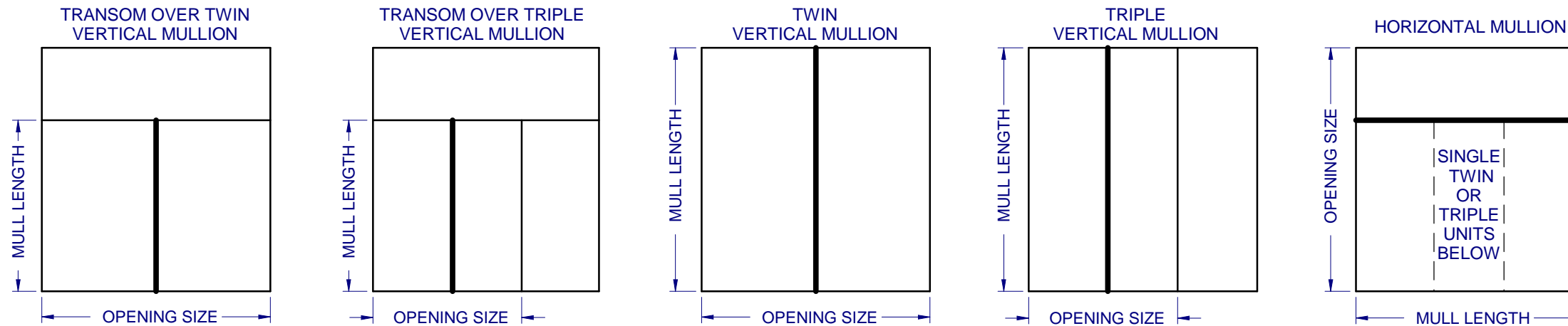

**3" ALUM.
MULL BAR
NON-IMPACT**

PROPRIETARY AND CONFIDENTIAL
THE INFORMATION CONTAINED IN THIS DRAWING IS THE SOLE PROPERTY OF CUSTOM WINDOW SYSTEMS, INC. ANY REPRODUCTION IN PART OR AS A WHOLE WITHOUT THE WRITTEN PERMISSION OF CUSTOM WINDOW SYSTEMS, INC IS PROHIBITED.

FLORIDA APPROVAL NO.:
5777

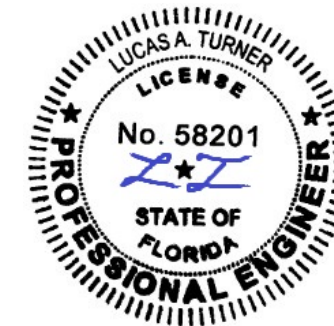

9/14/2023

LUCAS A. TURNER, P.E.
FL PE # 58201
Turner Engineering & Consulting, Inc.
2428 Old Natchez Trc Trl
Camden, TN 38320
PH. 941-380-1574

SHEET DESCRIPTION:
DP CHART
1522 CLIP
2 ANCHORS

DRAWN BY: MCS	DATE: 9/7/2023
DWG #: CWS-234	REV.: E
SCALE: 1:1	SHEET 3 OF 8

DESIGN PRESSURE CHART (PSF) FOR NON-IMPACT ALUMINUM 3" MULLION H-1952, HORIZONTAL OR VERTICAL, WITH 1523 STRAP CLIPS USING ONE (1) #10 SCREW, 3/16" ITW TAPCON or DEWALT ULTRACON+ or 1/4" DEWALT ULTRACON+ WITH WASHER PER CLIP

		OPENING WIDTH (in.)															
		39	45	51	57	63	69	75	81	87	93	99	106 3/8	114	120	132	144
37	Masonry 1	58	51	46	41	38	35	32	30	28	26	25	23	22	21	19	17
	Wood/Metal	75	66	59	54	49	45	42	39	36	34	32	30	28	27	25	23
42 3/4	Masonry 1	102	90	80	73	67	61	57	53	49	46	44	41	38	36	33	31
	Wood/Metal	64	56	50	46	42	38	36	33	31	29	28	26	24	23	21	19
48 3/4	Masonry 1	86	76	69	62	57	52	48	45	42	40	38	35	33	31	29	26
	Wood/Metal	42	37	34	30	28	26	24	22	21	20	19	17	16	15	-	-
53 1/8	Masonry 1	55	48	43	39	36	33	31	29	27	25	24	22	21	20	18	17
	Wood/Metal	74	66	59	54	49	45	42	39	37	35	33	30	29	27	25	23
57	Masonry 1	38	34	30	28	25	23	22	20	19	18	17	16	-	-	-	-
	Wood/Metal	49	44	39	36	33	30	28	26	25	23	22	20	19	18	17	15
63	Masonry 1	67	59	54	49	45	41	38	36	33	31	30	28	26	25	23	21
	Wood/Metal	35	31	28	26	23	22	20	19	18	17	16	-	-	-	-	-
66 3/4	Masonry 1	45	40	36	33	30	28	26	24	23	21	20	19	18	17	16	-
	Wood/Metal	62	55	49	45	41	38	35	33	31	29	28	26	24	23	21	19
72	Masonry 1	31	28	25	23	21	19	18	17	16	-	-	-	-	-	-	-
	Wood/Metal	40	36	32	29	27	25	23	22	20	19	18	17	16	15	-	-
76	Masonry 1	55	49	44	40	37	34	32	30	28	26	25	23	22	21	19	17
	Wood/Metal	29	26	23	21	20	18	17	16	-	-	-	-	-	-	-	-
80	Masonry 1	38	33	30	28	25	23	22	20	19	18	17	16	15	-	-	-
	Wood/Metal	51	45	41	37	34	32	30	28	26	24	23	22	20	19	18	16
84	Masonry 1	27	24	21	19	18	17	15	-	-	-	-	-	-	-	-	-
	Wood/Metal	34	31	28	25	23	21	20	19	18	17	16	-	-	-	-	-
90	Masonry 1	47	42	38	34	32	29	27	25	24	23	21	20	19	18	16	15
	Wood/Metal	25	22	20	18	17	16	-	-	-	-	-	-	-	-	-	-
96	Masonry 1	32	29	26	24	22	20	19	18	17	16	-	-	-	-	-	-
	Wood/Metal	44	39	35	32	30	27	26	24	22	21	20	19	18	17	15	-
102	Masonry 1	24	21	19	17	16	-	-	-	-	-	-	-	-	-	-	-
	Wood/Metal	30	27	24	22	21	19	18	17	16	-	-	-	-	-	-	-
106.38	Masonry 1	41	37	33	30	28	26	24	23	21	20	19	18	17	16	-	-
	Wood/Metal	22	20	18	16	-	-	-	-	-	-	-	-	-	-	-	-
114	Masonry 1	29	26	23	21	19	18	17	16	-	-	-	-	-	-	-	-
	Wood/Metal	39	35	31	29	26	24	23	21	20	19	18	17	16	15	-	-
120	Masonry 1	21	18	16	-	-	-	-	-	-	-	-	-	-	-	-	-
	Wood/Metal	27	24	21	19	18	17	15	-	-	-	-	-	-	-	-	-
126	Masonry 1	36	32	29	26	24	23	21	20	19	18	17	16	-	-	-	-
	Wood/Metal	19	17	15	-	-	-	-	-	-	-	-	-	-	-	-	-
132	Masonry 1	34	30	27	24	22	21	19	18	17	16	15	-	-	-	-	-
	Wood/Metal	18	16	-	-	-	-	-	-	-	-	-	-	-	-	-	-
138	Masonry 1	23	20	18	17	15	-	-	-	-	-	-	-	-	-	-	-
	Wood/Metal	32	28	25	23	21	19	18	17	16	15	-	-	-	-	-	-

DP CHART IS FOR:
NON-IMPACT 3" MULLION 1952, HORIZONTAL OR VERTICAL, USING EITHER (PER END):

- 1523 CLIPS
- (1) #10 SCREWS INTO WOOD or METAL
- (1) 3/16" ITW TAPCONS or DEWALT ULTRACON+ INTO SOLID CONCRETE or WOOD
- (1) 1/4" DEWALT ULTRACON+ INTO HOLLOW or GROUT-FILLED BLOCK or SOLID CONCRETE

NOTES:

MASONRY 1 INDICATES:
3/16" ITW TAPCON or DEWALT ULTRACON+

MASONRY 2 INDICATES:
1/4" DEWALT ULTRACON+

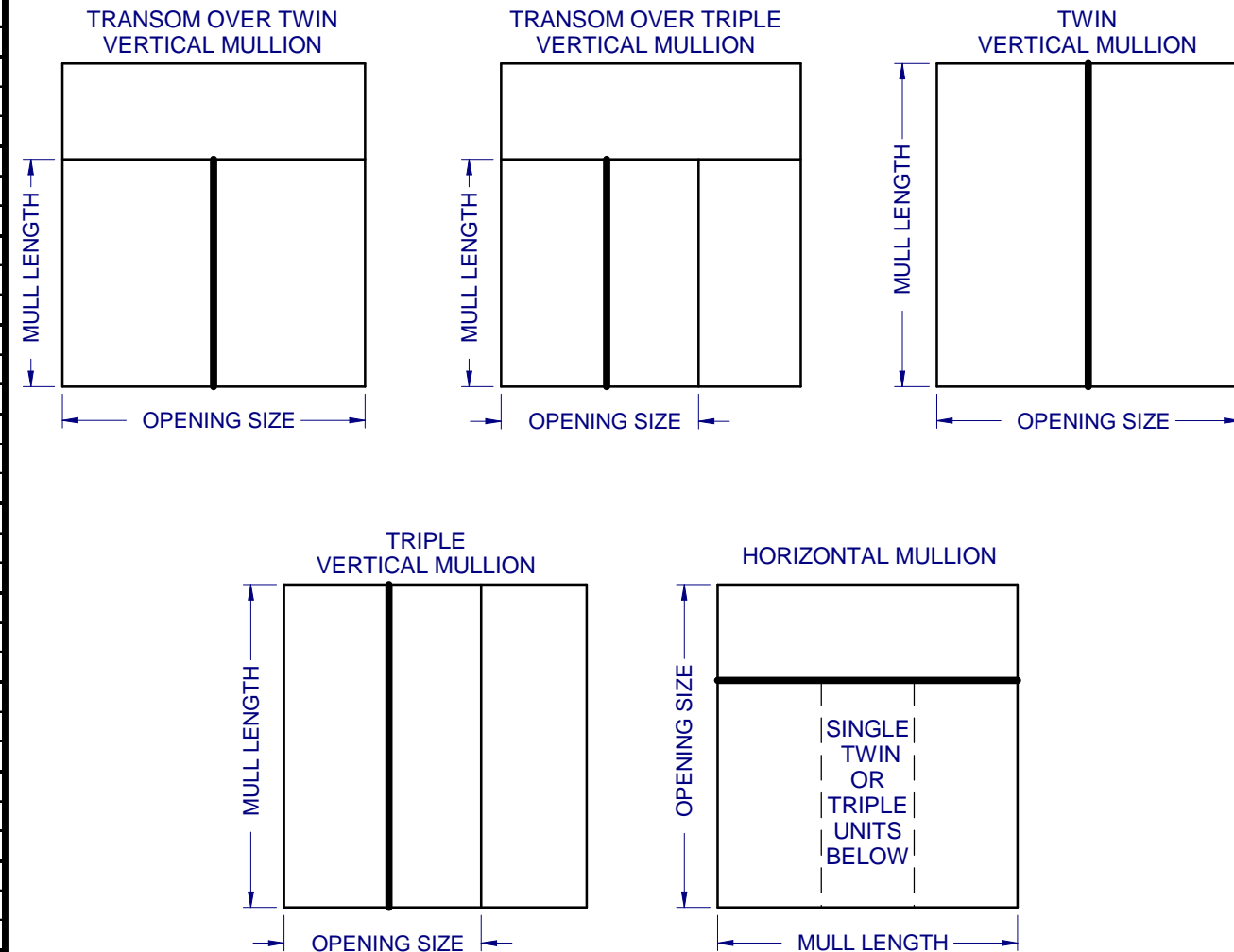

1900 SW 44TH AVE.
OCALA, FLORIDA 34474
WWW.CWS.CC

**3" ALUM.
MULL BAR
NON-IMPACT**

PROPRIETARY AND CONFIDENTIAL
THE INFORMATION CONTAINED IN THIS DRAWING IS THE SOLE PROPERTY OF CUSTOM WINDOW SYSTEMS, INC. ANY REPRODUCTION IN PART OR AS A WHOLE WITHOUT THE WRITTEN PERMISSION OF CUSTOM WINDOW SYSTEMS, INC IS PROHIBITED.

FLORIDA APPROVAL NO.:
5777



9/14/2023
LUCAS A. TURNER, P.E.
FL PE # 58201
Turner Engineering & Consulting, Inc.
2428 Old Natchez Trc Trl
Camden, TN 38320
PH. 941-380-1574

SHEET DESCRIPTION:
DP CHART
1523 CLIP
1 ANCHOR

DRAWN BY: MCS	DATE: 9/7/2023
DWG #: CWS-234	REV.: E
SCALE: 1:1	SHEET 4 OF 8

ITEM #.	PART #.	DESCRIPTION	MATERIAL
1	H-1952	3" MULL BAR, ALUM. FRAME	ALUM
2	S-1953	3" HORIZ/VERT CLIP	ALUM
3	F-1522-015	3" RETRO CLIP	ALUM
4	F-1522-018	3" FIN CLIP	ALUM
5	S-1895	DRIP CAP ADAPTER	ALUM
6	S-1896	FLANGE ADAPTER	ALUM
7		#10 OR #12 PAN HEAD TEK *(see note below)	STEEL
8	S-1523	3" STRAP CLIP	ALUM
9		#10 WASHER HEAD TEK	STEEL

* USE WOOD SCREW SIZE (#10 OR #12), SPECIFIED IN WINDOW UNIT APPROVAL DOCUMENT

NOTE: WHEN USING RETRO CLIP F-1522-015 IN HOLLOW or GROUT-FILLED BLOCK, USE THE TWO OUTERMOST HOLES (CIRCLED) WITH TWO (2) 1/4" DEWALT ULTRACON+.

**3" ALUM.
MULL BAR
NON-IMPACT**

PROPRIETARY AND CONFIDENTIAL
THE INFORMATION CONTAINED IN THIS DRAWING IS THE SOLE PROPERTY OF CUSTOM WINDOW SYSTEMS, INC. ANY REPRODUCTION IN PART OR AS A WHOLE WITHOUT THE WRITTEN PERMISSION OF CUSTOM WINDOW SYSTEMS, INC IS PROHIBITED.

FLORIDA APPROVAL NO.:
5777



9/14/2023

LUCAS A. TURNER, P.E.
FL PE # 58201
Turner Engineering & Consulting, Inc.
2428 Old Natchez Trc Trl
Camden, TN 38320
PH. 941-380-1574

SHEET DESCRIPTION:

BOM AND EXTRUSIONS

DRAWN BY: MCS	DATE: 9/7/2023
DWG #: CWS-234	REV.: E
SCALE: 1:2	SHEET 5 OF 8

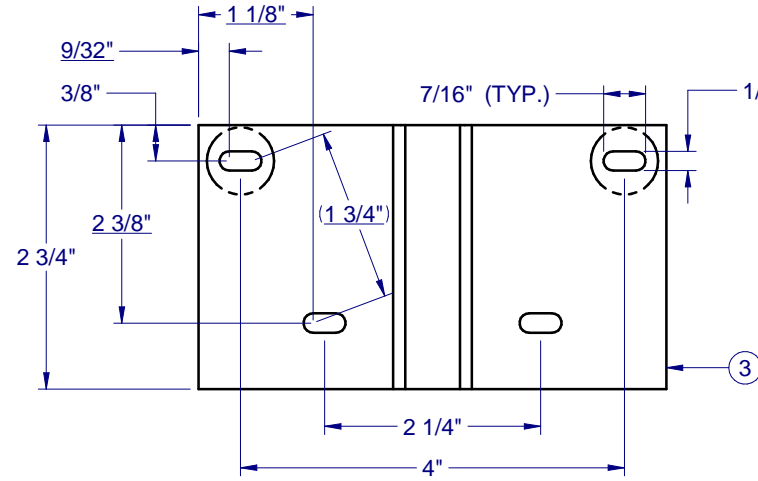

RETRO CLIP - F-1522-015

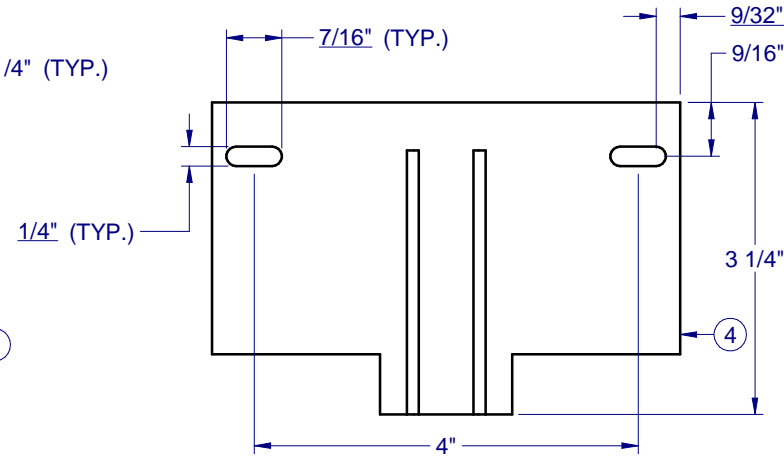

FIN CLIP - F-1522-018

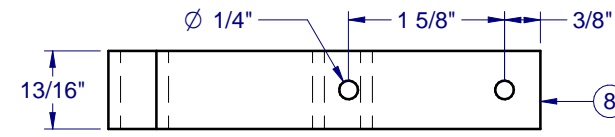

3" STRAP CLIP - 1523

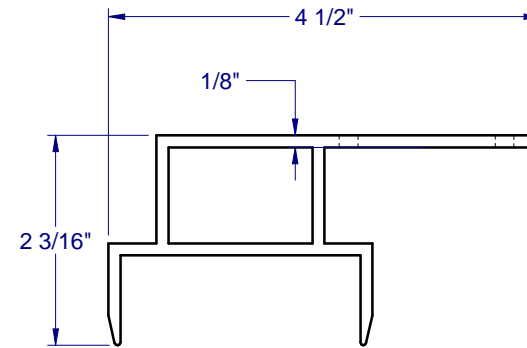

DRIP CAP ADAPTOR - 1895

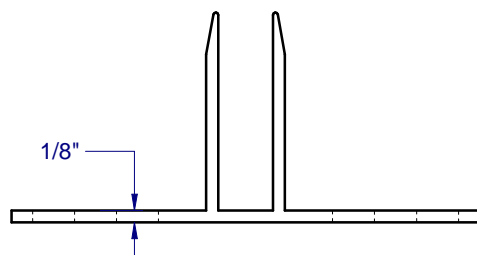

3" HORIZ/VERT CLIP - 1953

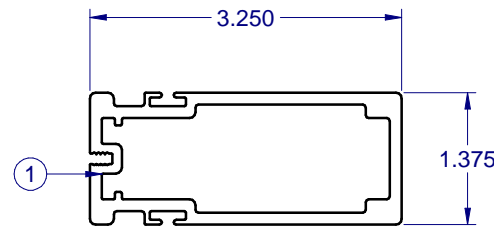

3" ALUM MULL BAR - 1952

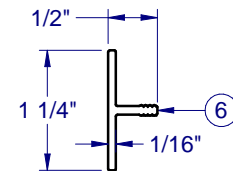

FLANGE ADAPTOR - 1896

NOTE: ALL ALUMINUM EXTRUSIONS ARE 6063-T6 UNLESS OTHERWISE NOTED.



1900 SW 44TH AVE.
OCALA, FLORIDA 34474
WWW.CWS.CC

**3" ALUM.
MULL BAR
NON-IMPACT**

PROPRIETARY AND CONFIDENTIAL
THE INFORMATION CONTAINED IN
THIS DRAWING IS THE SOLE
PROPERTY OF CUSTOM WINDOW
SYSTEMS, INC. ANY
REPRODUCTION IN PART OR AS A
WHOLE WITHOUT THE WRITTEN
PERMISSION OF CUSTOM WINDOW
SYSTEMS, INC IS PROHIBITED.

FLORIDA APPROVAL NO.:

5777



9/14/2023

LUCAS A. TURNER, P.E.
FL PE # 58201
Turner Engineering &
Consulting, Inc.
2428 Old Natchez Trc Trl
Camden, TN 38320
PH. 941-380-1574

SHEET DESCRIPTION:

SECTION VIEWS

DRAWN BY:

MCS

DATE:

9/7/2023

DWG #:

CWS-234

REV.:

E

SCALE:

1:2

SHEET

6 OF 8

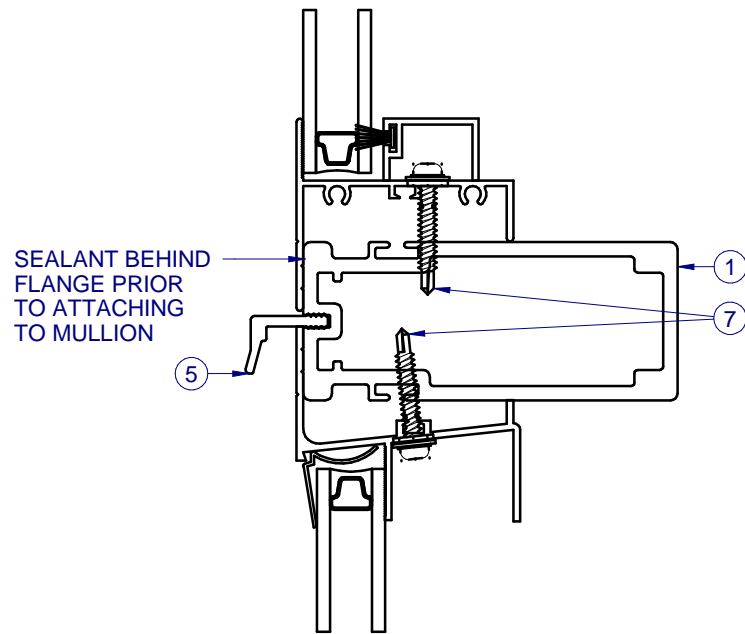

A HORIZONTAL MULL BAR SECTION
6 SINGLE WINDOW W/TRANSOM

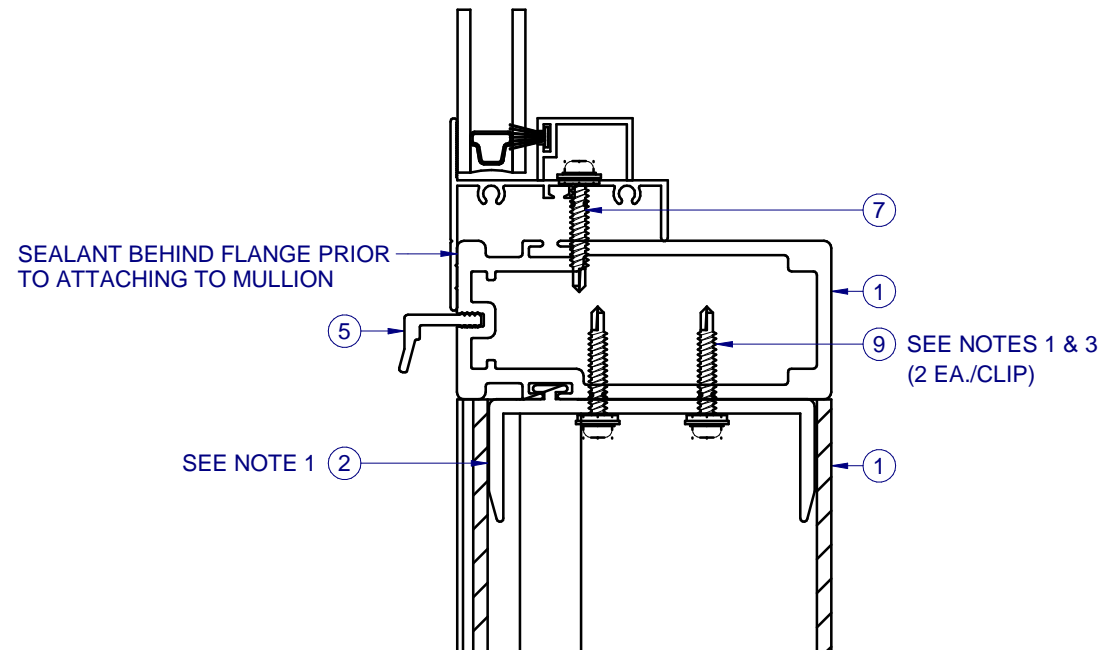

D HORIZONTAL MULL BAR SECTION
6 3" HORIZ. / 3" VERT. INTERSECTION

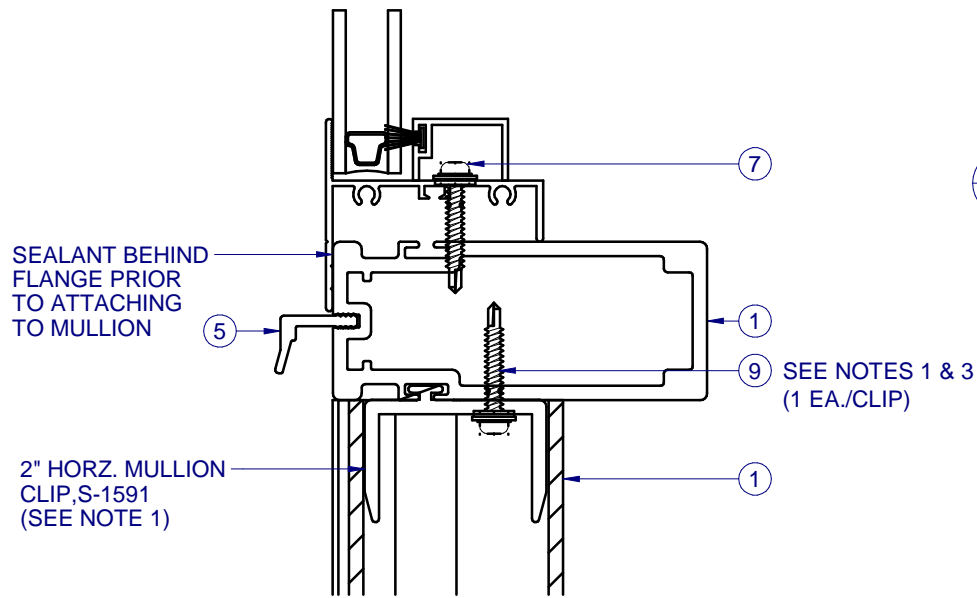

C HORIZONTAL MULL BAR SECTION
6 3" HORIZ. / 2" VERT. INTERSECTION

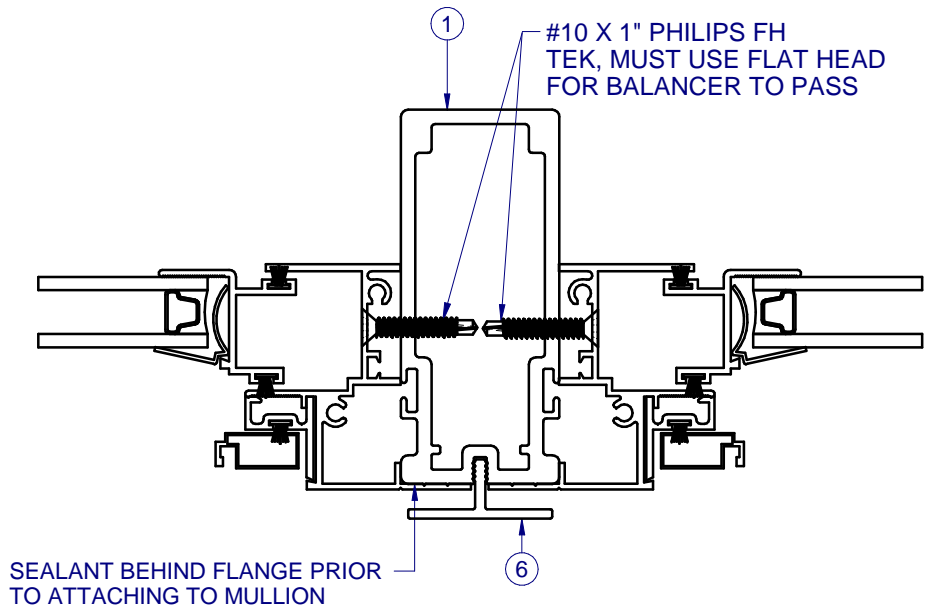

B VERTICAL MULL BAR SECTION
6 TWIN WINDOWS

NOTES:

1. 2" **VERTICAL MULL**: SLIDE CLIP INTO LOCATION AND SECURE WITH ITEM 9 (QTY 1), AS SHOWN ON THIS SHEET.
2. 3" **VERTICAL MULL**: SLIDE CLIP INTO LOCATION AND SECURE WITH ITEM 9 (QTY 2), AS SHOWN ON THIS SHEET.
3. PRE-DRILLED HOLES (THRU H/V CLIPS 1951 & 1953), BY THE INSTALLER, MAY BE LOCATED AS NEEDED WHILE MAINTAINING MIN. CLIP EDGE DISTANCE OF 9/32" AND MIN. CENTER TO CENTER SPACING OF 1/2".
4. THE ABOVE SECTIONS APPLY TO ALL MULLBAR-TO-MULLBAR CONNECTIONS, REGARDLESS OF ORIENTATION (i.e., HORIZONTAL OR VERTICAL). THE FULL LENGTH MULL MUST BE THE SAME DEPTH, OR GREATER, THAN THE INTERSECTING MULL.



1900 SW 44TH AVE.
OCALA, FLORIDA 34474
WWW.CWS.CC

**3" ALUM.
MULL BAR
NON-IMPACT**

PROPRIETARY AND CONFIDENTIAL
THE INFORMATION CONTAINED IN
THIS DRAWING IS THE SOLE
PROPERTY OF CUSTOM WINDOW
SYSTEMS, INC. ANY
REPRODUCTION IN PART OR AS A
WHOLE WITHOUT THE WRITTEN
PERMISSION OF CUSTOM WINDOW
SYSTEMS, INC IS PROHIBITED.

FLORIDA APPROVAL NO.:

5777

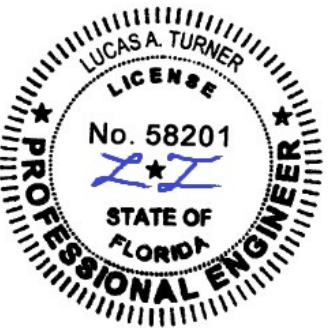

9/14/2023

LUCAS A. TURNER, P.E.
FL PE # 58201
Turner Engineering &
Consulting, Inc.
2428 Old Natchez Trc Trl
Camden, TN 38320
PH. 941-380-1574

SHEET DESCRIPTION:

**CONFIGURATIONS AND
ANCHORAGE NOTES**

DRAWN BY:

MCS

DATE:

9/7/2023

DWG #:

CWS-234

REV.:

E

SCALE:

1:1

SHEET

7 OF 8

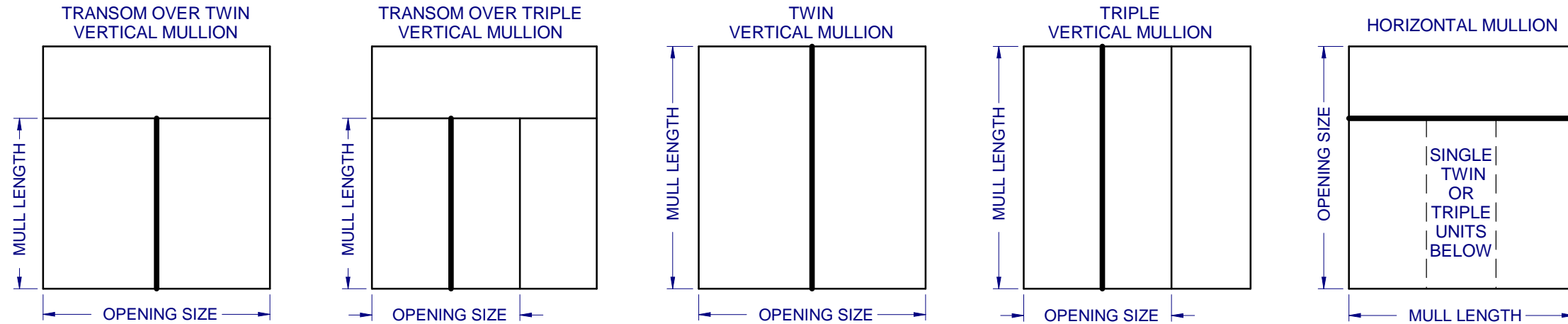

NOTES:

1. AT MULLION LOCATION, ATTACH WINDOW UNIT(S) TO MULLBAR THRU FRAME AS SPECIFIED IN WINDOW UNIT APPROVAL DOCUMENTS. IF ALUMINUM ATTACHMENT IS NOT SPECIFIED IN THE WINDOW UNIT APPROVAL DOCUMENTS, FOLLOW THE ANCHOR SPACING AS INDICATED IN THE WINDOW APPROVAL FOR ATTACHMENT TO WOOD SUBSTRATE, USING A HEX WASHER HEAD TEK SCREW OF THE SAME SIZE (#10 OR #12) AS THE WOOD SCREW INDICATED IN THE WINDOW APPROVAL. TEK SCREWS SHALL BE LONG ENOUGH TO ENSURE THREE (3) THREADS OF PENETRATION BEYOND THE INSIDE WALL OF MULLBAR.
2. MULL CLIP INSTALLATION ANCHOR TYPE, SIZE, SPACING AND EMBEDMENT SHALL BE AS SPECIFIED IN THESE DRAWINGS, SEE TABLE 1, SHEET 8.
3. ALL MULL CLIP INSTALLATION ANCHORS MUST BE MADE OF OR PROTECTED WITH A CORROSION RESISTANT MATERIAL OR COATING. DISSIMILAR METALS OR MATERIALS IN CONTACT WITH PRESSURE TREATED WOOD MUST BE PROTECTED TO PREVENT REACTION.
4. INSTALLATION ANCHORS SHALL BE IN ACCORDANCE WITH ANCHOR MANUFACTURER'S INSTALLATION INSTRUCTIONS, AND ANCHORS SHALL NOT BE USED IN SUBSTRATES WITH STRENGTHS LESS THAN THE MINIMUM SPECIFIED IN TABLE 1, SHEET 8.
5. ANCHOR EMBEDMENT TO SUBSTRATE SHALL BE BEYOND WALL DRESSING OR STUCCO. FOR CONCRETE/CMU OPENINGS, EMBEDMENT SHALL BE BEYOND WOOD BUCKS, IF USED, INTO SUBSTRATE - 1X BUCKS ARE OPTIONAL.
6. A MINIMUM CENTER-TO-CENTER SPACING SHALL BE MAINTAINED AS INDICATED BY THE PRE-DRILLED HOLES AS SHOWN IN THE CLIP LAYOUTS ON SHEET 5.
7. WOOD OR MASONRY OPENINGS, BUCKS AND BUCK FASTENERS SHALL BE PROPERLY DESIGNED BY THE ARCHITECT OR ENGINEER OF RECORD AND INSTALLED TO TRANSFER WIND LOADS TO THE STRUCTURE. SUBSTRATES SHALL MEET THE MINIMUM STRENGTH REQUIREMENTS AS SHOWN IN TABLE 1, SHEET 8. CONCRETE AND MASONRY SUBSTRATES MAY NOT BE CRACKED.
8. SEALING AND FLASHING STRATEGIES FOR OVERALL WATER RESISTANCE OF INSTALLATION SHALL BE DONE BY OTHERS FOLLOWING THE CURRENT VERSION OF THE REFERENCE DOCUMENTS:
FMA/AAMA 100(FIN WINDOWS), FMA/AAMA 200(FLANGE WINDOWS), FMA/WDMA 250(BOX WINDOWS), FMA/AAMA/WDMA 300(EXTERIOR DOORS)

**3" ALUM.
MULL BAR
NON-IMPACT**

PROPRIETARY AND CONFIDENTIAL
THE INFORMATION CONTAINED IN
THIS DRAWING IS THE SOLE
PROPERTY OF CUSTOM WINDOW
SYSTEMS, INC. ANY
REPRODUCTION IN PART OR AS A
WHOLE WITHOUT THE WRITTEN
PERMISSION OF CUSTOM WINDOW
SYSTEMS, INC IS PROHIBITED.

FLORIDA APPROVAL NO.:

5777

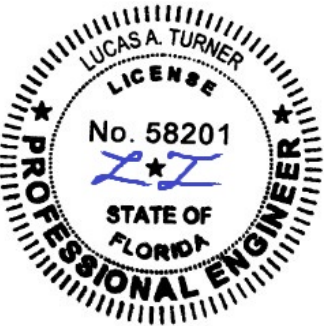

9/14/2023

LUCAS A. TURNER, P.E.
FL PE # 58201
Turner Engineering &
Consulting, Inc.
2428 Old Natchez Trc Trl
Camden, TN 38320
PH. 941-380-1574

SHEET DESCRIPTION:

INSTALLATION DETAILS

DRAWN BY:	DATE:
MCS	9/7/2023
DWG #:	REV.:
CWS-234	E
SCALE:	SHEET
1:2	8 OF 8

INTERIOR

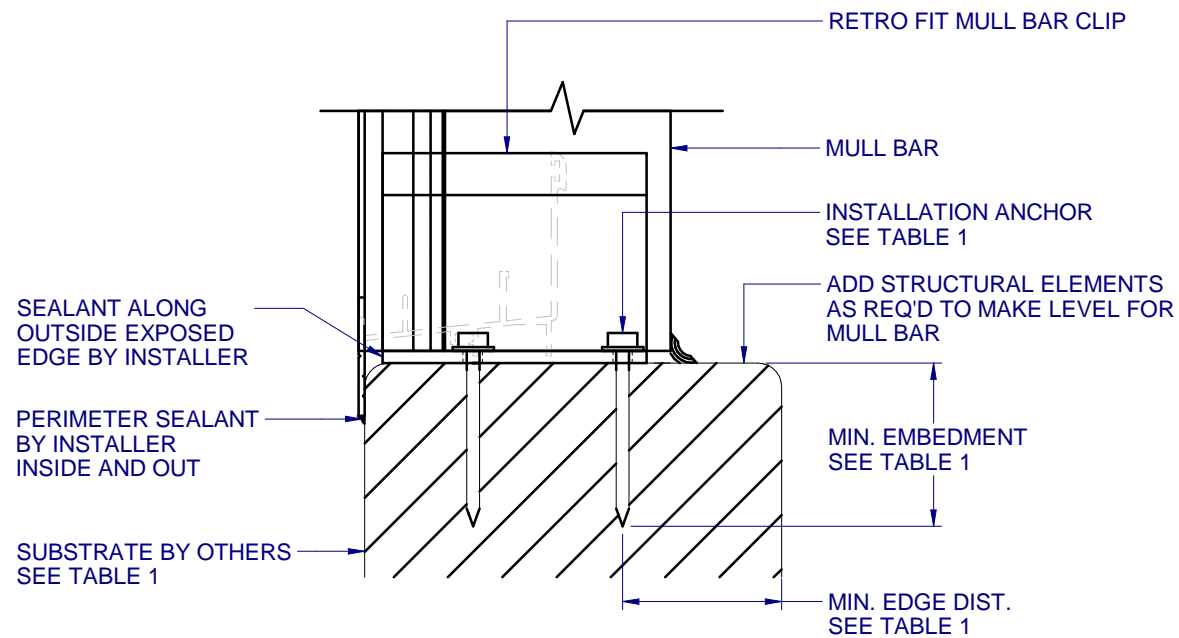

E VERTICAL SECTION
8 TYPICAL FLANGE (RETRO FIT) ANCHORAGE
HEAD AND JAMBS SIMILAR FOR FLANGE INSTALLATION

INTERIOR

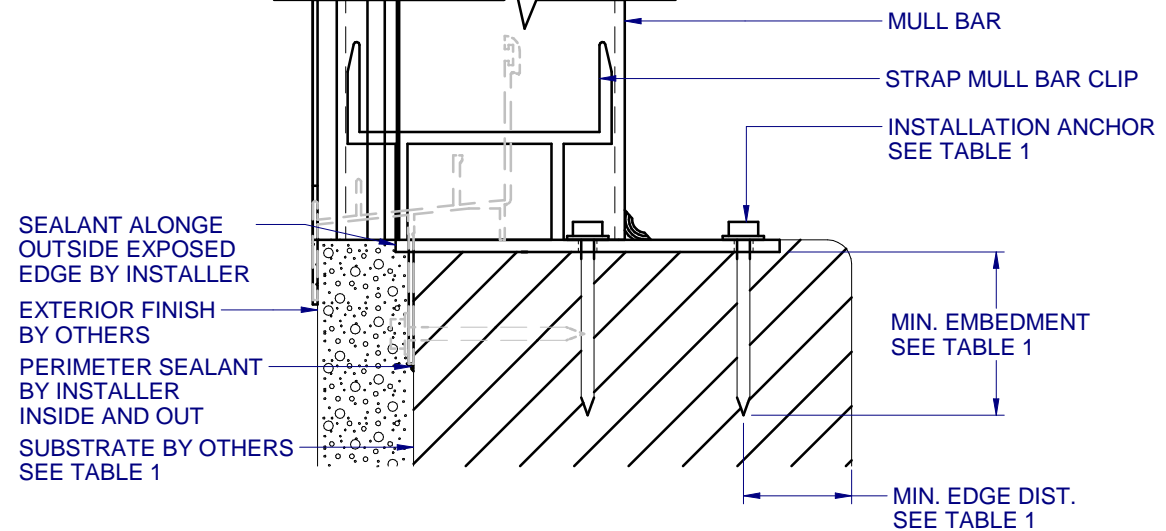

F VERTICAL SECTION
8 TYPICAL FIN ANCHORAGE
HEAD AND JAMBS SIMILAR FOR FIN INSTALLATION

TABLE 1: APPROVED MULL CLIP INSTALLATION FASTENERS

SUBSTRATE TYPE	ANCHOR TYPE	MIN. EMBEDMENT	MIN. EDGE DIST.
CONCRETE (2.0 KSI MIN.)	3/16" ITW TAPCON	1"	3"
CONCRETE (3.05 KSI MIN.)	3/16" DEWALT ULTRACON+	1-3/4"	1"
HOLLOW or GROUT-FILLED CMU (ASTM C-90) or SINGLE ANCHOR IN CLIP 1523 IN CONCRETE (3.05 KSI MIN.)	1/4" DEWALT ULTRACON+	1-3/4"	2-1/2"
2X MIN. SOUTHERN PINE (G=0.55)	3/16" ITW TAPCON OR DEWALT ULTRACON+	1-3/8"	7/8"
2X MIN. SOUTHERN PINE (G=0.55)	#10 WOOD SCREW	1-3/8"	7/8"
16 GAUGE (0.060") MIN. STEEL STUD (33 KSI YIELD MIN)	#10-16 HILTI KWIK-FLEX OR ITW TEKS SELF-DRILLING SCREW	FULL THREAD THRU 0.060"	7/16"
1/8" ALUM. (6063-T5 MIN.) OR 1/8" STEEL (33 KSI MIN.)	#10 GRADE 5 SELF-TAPPING / DRILLING SCREW	FULL THREAD THRU 0.125"	7/16"

NOTES:

1. BOX FRAME MULL INSTALLATION SIMILAR TO FLANGE FRAME.
2. SILL STOOL MUST BE FLUSH AGAINST INSIDE OF MULLED WINDOWS AFTER INSTALLATION.
3. RECESS RETRO MULLION CLIP 3/8" MAX. FOR CLEARANCE OF WINDOW UNIT AS NEEDED.
4. TWO (2) or FOUR (4) ANCHORS REQUIRED PER "T" MULL CLIP, SEE SHEETS 2-3. ONE (1) ANCHOR REQUIRED PER STRAP MULL BAR CLIP, SEE SHEET 4.
5. SEAT MULLION TIGHT TO MULL CLIP.
6. FOR ANCHORAGE DETAILS FOR THE WINDOW, REFER TO THE WINDOW SPECIFIC INSTALLATION DETAILS.