

# TRANSPARENT PROTECTION SYSTEMS, INC.

SAFEGUARD POLYCARBONATE STORM PANELS  
LARGE MISSILE IMPACT RESISTANT (MISSILE LEVEL D)

**VALID FOR USE OUTSIDE THE HVHZ ONLY (SEE LIMITATIONS HEREIN)**

NON-SITE-SPECIFIC STRUCTURAL PERFORMANCE EVALUATION. A DESIGN PROFESSIONAL SHALL BE RESPONSIBLE FOR CERTIFYING THE APPLICATION OF THIS INFORMATION TO ANY SITE-SPECIFIC LOCATION.

FRANK BENNARDO, P.E.  
PE# 0046549 CA# 9885

SEPTEMBER 27, 2023

## GENERAL NOTES:

- THIS SYSTEM HAS BEEN TESTED AND EVALUATED AS A LARGE MISSILE IMPACT PROTECTIVE SYSTEM IN ACCORDANCE WITH THE REQUIREMENTS OF THE FLORIDA BUILDING CODE EIGHTH EDITION (2023) AND THE INTERNATIONAL BUILDING/RESIDENTIAL CODE PER ASTM STANDARDS E330, E1886, & E1996. **PANELS ARE APPROVED FOR USE OUTSIDE THE HIGH VELOCITY HURRICANE ZONE (HVHZ), OR THROUGHOUT OTHER AREAS GOVERNED BY THE IBC/IRC.**
- POSITIVE AND NEGATIVE DESIGN PRESSURES CALCULATED FOR USE WITH THIS SYSTEM SHALL BE DETERMINED BY OTHERS ON A JOB-SPECIFIC BASIS IN ACCORDANCE WITH THE GOVERNING CODE. SITE-SPECIFIC PRESSURE REQUIREMENTS AS DETERMINED IN ACCORDANCE WITH ASCE 7 AND CHAPTER 1609 OF THE FLORIDA BUILDING CODE SHALL BE LESS THAN OR EQUAL TO THE POSITIVE OR NEGATIVE DESIGN PRESSURE CAPACITY VALUES LISTED HEREIN FOR ANY ASSEMBLY AS SHOWN.
- DESIGN PRESSURES NOTED HEREIN ARE BASED ON MAXIMUM TESTED PRESSURES DIVIDED BY A 1.5 SAFETY FACTOR.
- THE SYSTEM DETAILED HEREIN IS GENERIC AND DOES NOT PROVIDE INFORMATION FOR A SPECIFIC SITE. IF SITE CONDITIONS DEVIATE FROM THE CONDITIONS DETAILED HEREIN, A LICENSED ENGINEER OR REGISTERED ARCHITECT SHALL PREPARE SITE SPECIFIC DOCUMENTS TO BE USED IN CONJUNCTION WITH THIS DOCUMENT.
- THE ADEQUACY OF THE EXISTING STRUCTURE TO WITHSTAND SUPERIMPOSED LOADS IS OUTSIDE THE SCOPE OF THIS CERTIFICATION AND SHALL BE VERIFIED BY OTHERS. THE ARCHITECT/ENGINEER OF RECORD FOR THE PROJECT SUPERSTRUCTURE WITH WHICH THIS DESIGN IS USED SHALL BE RESPONSIBLE FOR THE INTEGRITY OF ALL SUPPORTING SURFACES TO THIS DESIGN WHICH SHALL BE COORDINATED BY THE PERMITTING CONTRACTOR.
- CLEAR POLYCARBONATE STORM PANELS (FULL, HALF, & DOUBLE-WIDE) MAY VARY IN "COVERAGE" WIDTH UP TO THE RESPECTIVE MAXIMA SHOWN HEREIN, PROVIDED THAT THE PANEL PROFILE HEIGHT BE MAINTAINED. PANELS SHALL BE MOUNTED WITH FASTENERS OR STUDS AT MAXIMUM SPACING SHOWN FOR EACH PROFILE.
- ALL POLYCARBONATE PANELS SHALL BE MANUFACTURED BY TRANSPARENT PROTECTION SYSTEMS, Inc.
- THIS PRODUCT APPROVAL IS FOR THE USE OF CLEAR POLYCARBONATE PANELS ONLY. ALL POLYCARBONATE PANELS SHALL BE EXTRUDED WITH THICKNESS  $t=0.100"$  ( $\pm 0.010"$ ) AND SHALL BE MANUFACTURED FROM 100% SYNTHETIC THERMOPLASTIC POLYMER RESIN (UV STABILIZED). TYPICAL SYNTHETIC THERMOPLASTIC POLYMER TENSILE STRENGTH  $F_y=8,908$  KSI, FLEXURAL STRENGTH  $F_{by}=12.90$  KSI, & FLEXURAL MODULUS IS 328.7 KSI.
- ALL EXTRUSIONS SHALL BE 6063-T6 ALUMINUM ALLOY, U.N.O.

**\*NOTE:** FOR ALTERNATE ARCH TOP INSTALLATIONS, THE TOP TRACK OR U-HEADER SHALL BE CUT INTO 6" MINIMUM ADJACENT SEGMENTS. EACH SEGMENT SHALL HAVE ANCHORS SPACED PER THE ANCHOR SCHEDULE, WITH A MINIMUM OF (2) ANCHORS PER SEGMENT. ANCHORS SHALL BE 1-1/2" MIN FROM ENDS OF EACH SEGMENT AND SPACED 3" MINIMUM FROM ADJACENT ANCHORS. FOR STUDDER TRACKS ONLY, THERE SHALL BE A MINIMUM OF (1) STUD PER SEGMENT FASTENED TO THE STORM PANEL. STUDS SHALL BE LOCATED 2" MINIMUM FROM ENDS OF EACH SEGMENT.

## GENERAL NOTES (CONTINUED):

- PANELS SHALL BE PERMANENTLY LABELED WITH A MINIMUM OF ONE LABEL PER PANEL CONTAINING THE FOLLOWING:  
  
TRANSPARENT PROTECTION SYSTEMS, INC.  
BENSALEM, PENNSYLVANIA  
ASTM E330, E1886 & E1996  
PRODUCT APPROVAL NUMBER
- TOP & BOTTOM MOUNTING SECTIONS MAY BE INTERCHANGED AS FIELD CONDITIONS DICTATE. PANELS MAY BE MOUNTED VERTICALLY OR HORIZONTALLY AS APPLICABLE.
- USE OF KEYHOLE WASHERS IS OPTIONAL IN CONJUNCTION WITH ANY MOUNTING CONDITION. HOLES MAY BE FIELD DRILLED AT  $\varnothing 3/8"$  (OR  $\varnothing 5/8"$  WITH KEYHOLE WASHER) WITH ANY FASTENER TYPE. WASHERED WINGNUTS SHALL HAVE 0.865" MINIMUM WASHER DIAMETER.
- ALL BOLTS & WASHERS SHALL BE ZINC COATED STEEL, GALVANIZED STEEL, OR STAINLESS STEEL WITH A MINIMUM TENSILE YIELD STRENGTH OF 60 KSI. FASTENERS SHALL BE CADMIUM-PLATED OR OTHERWISE CORROSION-RESISTANT MATERIAL AND SHALL COMPLY WITH "SPECIFICATIONS FOR ALUMINUM STRUCTURES" SECTION J.3.7.2 BY THE ALUMINUM ASSOCIATION INC., AND ANY APPLICABLE FEDERAL, STATE AND OR LOCAL CODES.
- THE HURRI-OUT EGRESS STORM PANEL DETAILS ARE INTENDED TO ALLOW THE POSSIBILITY OF REMOVING PANELS FROM INSIDE OF DWELLING. RESULTS MAY VARY ACCORDING TO INSTALLATION, END-USER, AND TRAINING, ETC. ENGINEERING EXPRESS AND TRANSPARENT PROTECTION SYSTEMS DO NOT ASSUME ANY RESPONSIBILITY OR LIABILITY ASSOCIATED WITH USE OF THIS INSTALLATION AND OR ITS APPLICATIONS.
- THE CONTRACTOR IS RESPONSIBLE TO INSULATE ALL MEMBERS FROM DISSIMILAR MATERIALS TO PREVENT ELECTROLYSIS.
- REFER TO FASTENER MANUFACTURER'S PUBLISHED DATA SHEETS AND RECOMMENDATIONS FOR FASTENER INSTALLATION INSTRUCTIONS.
- ENGINEER SEAL AFFIXED HERETO VALIDATE STRUCTURAL DESIGN AS SHOWN ONLY. USE OF THIS SPECIFICATION BY CONTRACTOR, et. al. INDEMNIFIES & SAVES HARMLESS THIS ENGINEER FOR ALL COST & DAMAGES INCLUDING LEGAL FEES & APPELLATE FEES RESULTING FROM MATERIAL FABRICATION, SYSTEM ERECTION, & CONSTRUCTION PRACTICES BEYOND THAT WHICH IS CALLED FOR BY LOCAL, STATE & FEDERAL CODES & FROM DEVIATIONS OF THIS PLAN.
- EXCEPT AS EXPRESSLY PROVIDED HEREIN, NO ADDITIONAL CERTIFICATIONS OR AFFIRMATIONS ARE INTENDED.
- PRESSURE VALUES ON THIS APPROVAL ARE (ASD) ALLOWABLE DESIGN PRESSURES.
- ALTERATIONS ADDITIONS OR OTHER MARKINGS TO THIS DOCUMENT ARE NOT PERMITTED AND INVALIDATE THIS CERTIFICATION.

## SYSTEM PERFORMANCE DERIVATIONS

STORM PANELS HAVE BEEN DESIGNED AND TESTED TO THE MAXIMUM SPANS AND CORRESPONDING LOADS SHOWN HEREIN. REFERENCE CONSTRUCTION TESTING CORPORATION (CTC OF MIAMI, FL) TEST REPORTS #04-009-FE-ASTM & #04-009-LE-ASTM, AS WELL AS HURRICANE TEST LAB (HTL OF RIVIERA BEACH, FL) TEST REPORTS #0239-0107-05, #0239-1013-07, #0239-0312-06, #0239-0110-07 & #0239-0813-06.

### NOTE REGARDING USE OF THIS DOCUMENT & USE OUTSIDE FLORIDA:

NON-SITE-SPECIFIC STRUCTURAL PERFORMANCE EVALUATION. THIS PRODUCT EVALUATION IS VALID FOR USE IN **FLORIDA ONLY**. USE OF THIS EVALUATION REQUIRES A REVIEW & CERTIFICATION BY A LOCAL DESIGN PROFESSIONAL WHO SHALL BE RESPONSIBLE FOR THE PROPER ADAPTATION OF THIS GENERAL PERFORMANCE EVALUATION TO ANY SITE-SPECIFIC PROJECT. CONTACT THIS OFFICE AT [ENGINEERINGEXPRESS.COM/QUOTE](http://ENGINEERINGEXPRESS.COM/QUOTE) FOR ASSISTANCE WITH YOUR PROJECT-SPECIFIC NEEDS & FOR ADAPTATION & CERTIFICATION OF THIS DOCUMENT OUTSIDE OF FLORIDA.

### PAGE INDEX:

SHEET INDEX	
# SHEET	DESCRIPTION
1	COVER SHEET
2	PARTS & TYPICAL ELEVATION
3	PARTS
4-6	SECTIONS
7	ANCHOR SCHEDULE
8	GLASS SEPARATION SPECIFICATIONS

### TERMINOLOGY:

THE FOLLOWING ABBREVIATIONS APPEAR IN THIS APPROVAL: "CORP." FOR "CORPORATION", "ALUM" FOR "ALUMINUM", "ASD" FOR "ALLOWABLE STRESS DESIGN", "ASTM" FOR "AMERICAN SOCIETY FOR TESTING AND MATERIALS", "CS" FOR "CARBON STEEL", "CONN" FOR "CONNECTION", "EMBED" FOR "EMBEDMENT", "DIST." FOR "DISTANCE", "GA" FOR "GAUGE", "HVHZ" FOR "HIGH-VELOCITY HURRICANE ZONE", "LB" FOR "POUND", "MAX" FOR "MAXIMUM", "N.T.S." FOR "NOT TO SCALE", "PSF" FOR "POUNDS PER SQUARE FOOT (lb/ft<sup>2</sup>)", "SPECS" FOR "SPECIFICATIONS", "&" FOR "AND", "MAX" FOR "MAXIMUM", "W/" FOR "WITH", "EXIST" FOR "EXISTING", "STRUCT" FOR "STRUCTURE", "CONC." FOR "CONCRETE". CONTACT ENGINEERING EXPRESS FOR ADDITIONAL ABBREVIATION/TERMINOLOGY CLARIFICATIONS.

FL 6417.1

**ENGINEERING EXPRESS**

POSTAL ADDRESS:  
2234 NORTH FEDERAL HWY #7664  
BOCA RATON, FL 33431  
ENGINEERINGEXPRESS.COM

TRANSPARENT PROTECTION SYSTEMS, INC.  
633 DUNKSFERRY ROAD  
BENSALEM, PA 19020

CLEARGUARD POLYCARBONATE STORM PANELS  
FLORIDA BUILDING CODE EIGHTH EDITION (2023)  
FLORIDA STATEWIDE APPROVAL (FSA FL#6417.1)

REMARKS	DRWN	CHKD	DATE
PREV. SUBMITTAL (20-30218)	CCB	RWV	09/04/20
2023 FBC UPDATE	MRT	RWV	09/27/23

COPYRIGHT ENGINEERING EXPRESS®

23-65075

SCALE: NTS UNLESS NOTED

1 OF 8

VISIT [ECALC.IO/65075](http://ECALC.IO/65075)

FOR SITE-SPECIFIC DEVIATIONS & MORE INFORMATION ABOUT THIS DOCUMENT OR SCAN THIS QR CODE

VISIT [ENGINEERINGEXPRESS.COM/STORE](http://ENGINEERINGEXPRESS.COM/STORE) FOR ADDITIONAL PLANS, REPORTS & RESOURCES



c:\users\milton\engineering\express\production - documents\projects\23-65075 2023 product fbc update fl6417\work\2023 fbc\drawings & cad\23-65075a - fl6417.1 - cad.dwg  
9/27/2023 4:28 PM MILTON

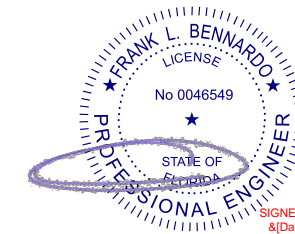

FL

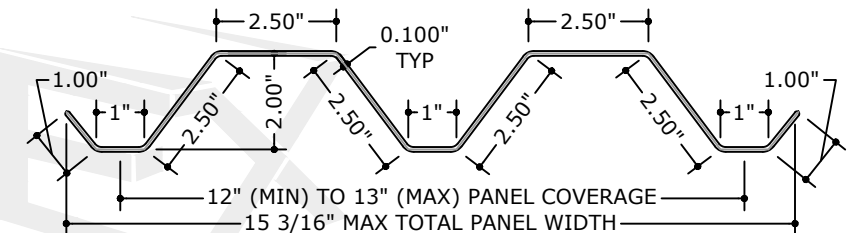

**1 FULL PANEL PROFILE**  
3" = 1'-0" (SEE GEN NOTE 7)  
MOUNT WITH FASTENERS OR STUDS AT 13" O.C. MAX

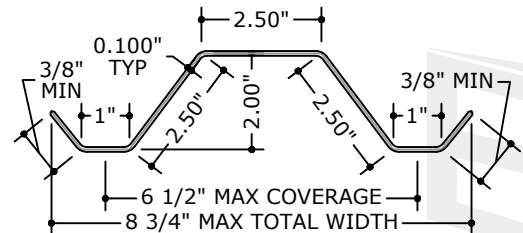

**2 HALF PANEL PROFILE**  
3" = 1'-0" (SEE GEN NOTE 7)  
MOUNT WITH FASTENERS OR STUDS AT 6-1/2" O.C. MAX

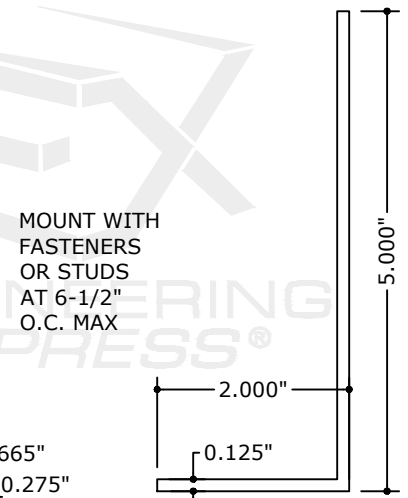

**7 CLOSURE ANGLE**  
6" = 1'-0"

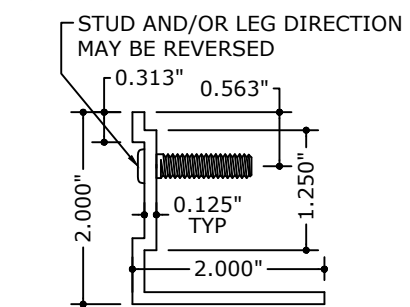

**3 STUD ANGLE**  
6" = 1'-0"

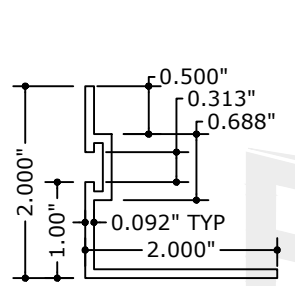

**4 REVERSE 'F' ANGLE**  
6" = 1'-0"

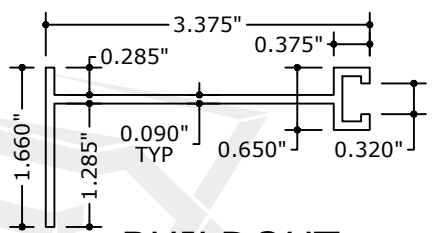

**5 BUILDOUT 'F' TRACK**  
6" = 1'-0"

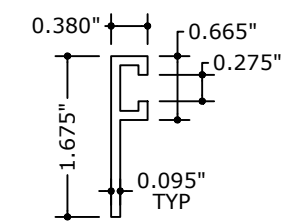

**6 'F' TRACK**  
6" = 1'-0"

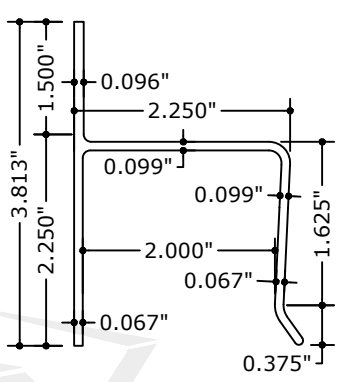

**10.1 'H' HEADER**  
6" = 1'-0"

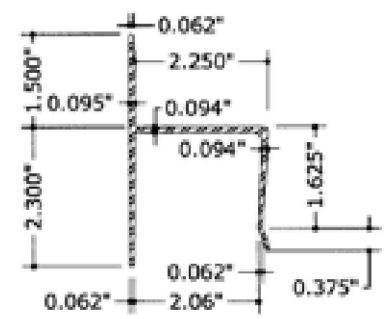

**10.2 ALTERNATE 'H' HEADER**  
NOT TO SCALE

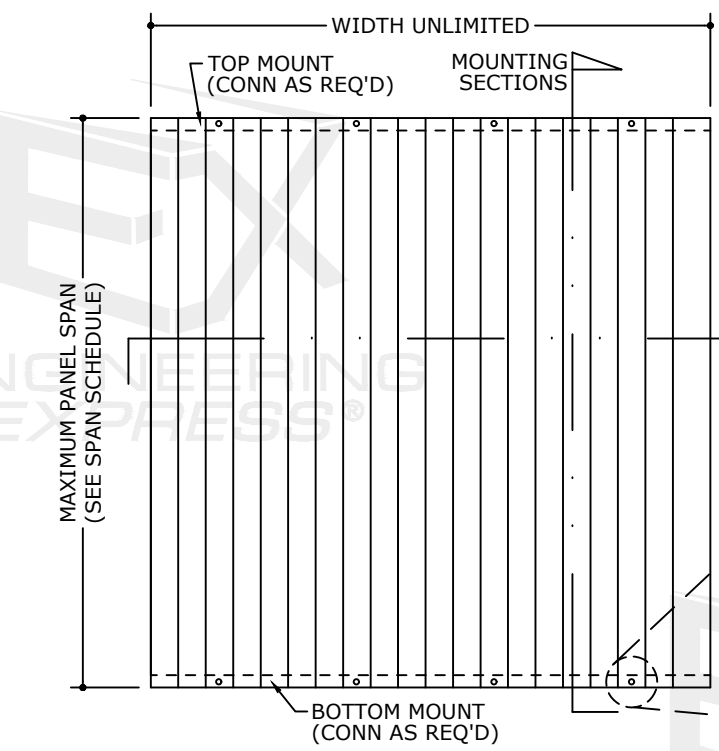

**1 TYPICAL ELEVATION**  
2 N.T.S.

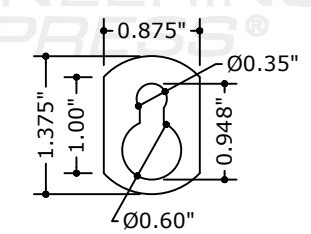

**8 KEYHOLE WASHER**  
6" = 1'-0"



**9 WASHERED WINGNUT**  
6" = 1'-0"

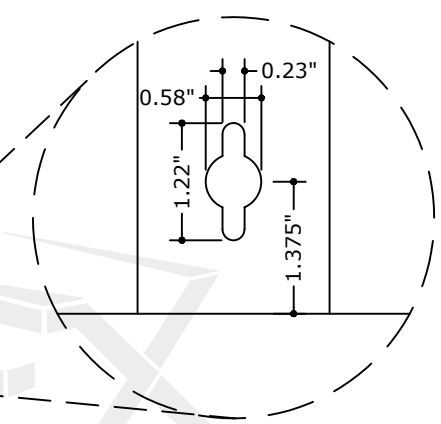

**2 KEYHOLE DETAIL**  
2 N.T.S. ALT: FIELD DRILL Ø3/8" HOLE (OR Ø5/8" HOLE W/ KEYHOLE WASHER)

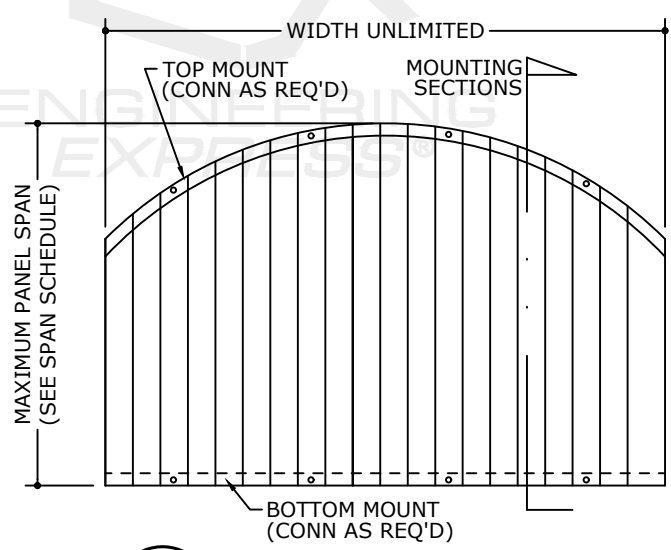

**3 ALT. ARCH TOP\***  
2 N.T.S.

FL 6417.1

**ENGINEERING EXPRESS**  
POSTAL ADDRESS:  
2234 NORTH FEDERAL HWY #7664  
BOCA RATON, FL 33431  
ENGINEERINGEXPRESS.COM

**TRANSPARENT PROTECTION SYSTEMS, INC.**  
633 DUNKSFERRY ROAD  
BENSALEM, PA 19020  
CLEARGUARD POLYCARBONATE STORM PANELS  
FLORIDA BUILDING CODE EIGHTH EDITION (2023)  
FLORIDA STATEWIDE APPROVAL (FSA FL#6417.1)

REMARKS	DRWN	CHKD	DATE
PREV. SUBMITTAL (20-30218)	CCB	RWV	09/04/20
2023 FBC UPDATE	MRT	RWV	09/27/23

23-65075

SCALE: NTS UNLESS NOTED

c:\users\milton\engineering\express\production - documents\projects\23-65075 2023 product fbc update fl6417\work\2023 fbc\drawings & cad\23-65075a - fl6417.1 - cad.dwg 9/27/2023 4:28 PM MILTON

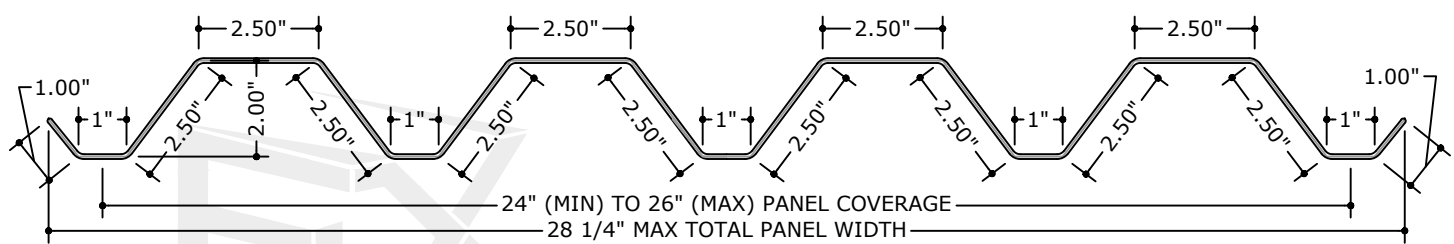

**11** "CLEARMAX™" DOUBLE-WIDE PANEL PROFILE  
3" = 1'-0" (SEE GEN NOTE 6)  
MOUNT WITH FASTENERS OR STUDS AT 13" O.C. MAX

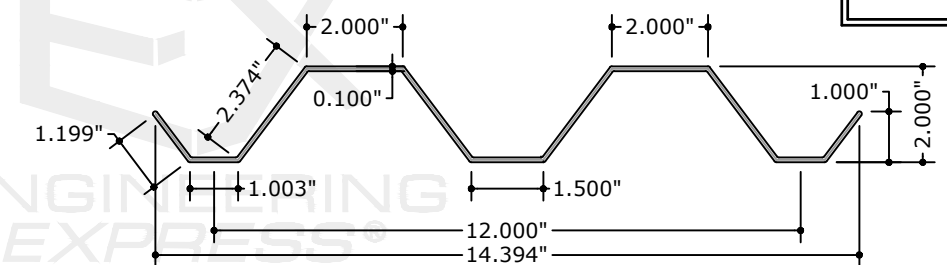

**12** ALT. FULL PANEL PROFILE  
N.T.S. (SEE GEN NOTE 6)  
MOUNT WITH FASTENERS OR STUDS AT 13" O.C. MAX

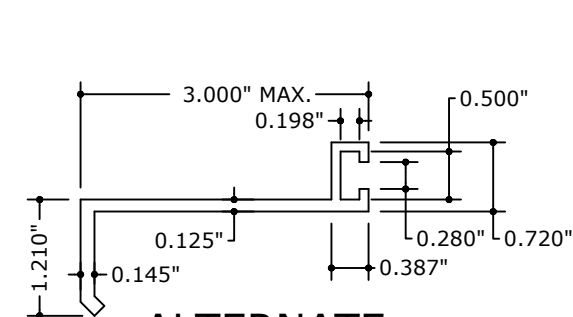

**13** ALTERNATE B.O. 'F' TRACK  
6" = 1'-0"

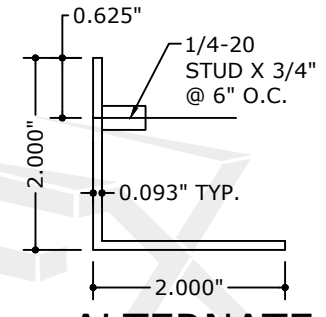

**14** ALTERNATE STUD ANGLE  
6" = 1'-0"

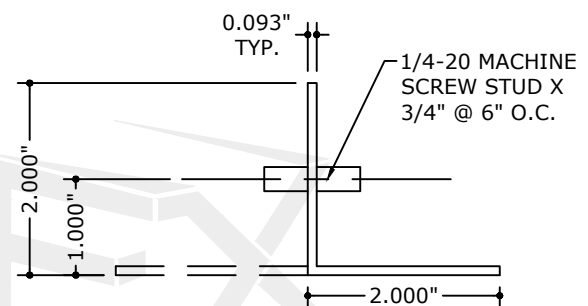

**15** STUDDED ANGLE  
6" = 1'-0"

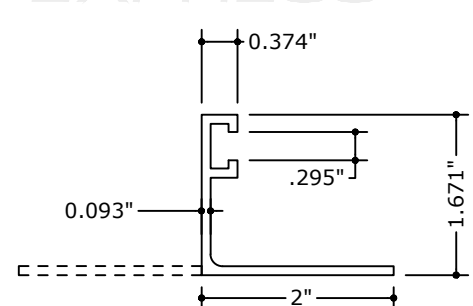

**20** 'F' TRACK ANGLE  
6" = 1'-0"

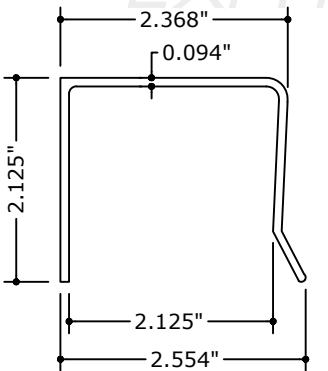

**16** U-HEADER  
N.T.S. 6063-T6

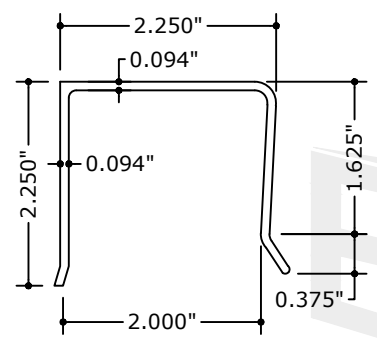

**17** ALTERNATE U-HEADER  
N.T.S. 6063-T6

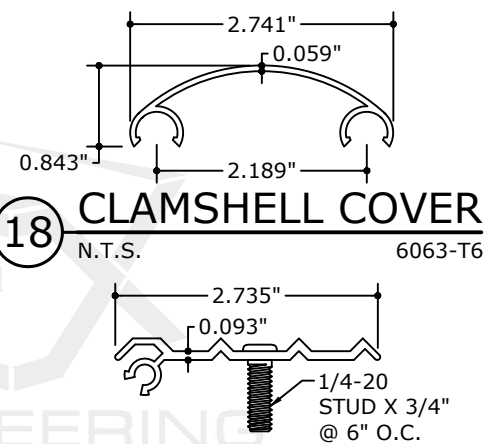

**18** CLAMSHELL COVER  
N.T.S. 6063-T6

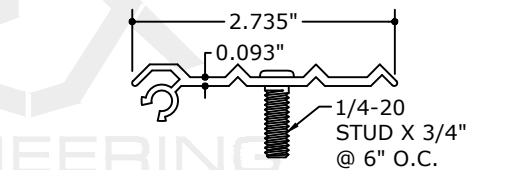

**19** CLAMSHELL TRACK  
N.T.S. 6063-T6

**MAXIMUM PANEL SPAN SCHEDULE (POSITIVE CONN.)**

LOAD (psf)	MAX SPAN (ft)
38	12'-0"
40	11'-5"
45	10'-1"
50	9'-1"
55	8'-3"
60	7'-7"
65	7'-0"
70	6'-7"
75	6'-1"
80	5'-9"
90	5'-1"
100	4'-7"
110	4'-2"
120	3'-10"

**MAXIMUM PANEL SPAN SCHEDULE (W/ "H" HEADER)**

LOAD (psf)	MAX SPAN (ft)
17.3	8'-7"
24.2	7'-9"
34.6	7'-0"
41.6	6'-0"
55.4	5'-0"
104	4'-0"

**MAXIMUM PANEL SPAN SCHEDULE (W/ "U" HEADER)**

MAX SPAN (ft)	MAX DESIGN PRESSURES	
	POSITIVE (psf)	NEGATIVE (psf)
6'-3"	35	38
5'-3"	48	48
4'-4"	78	80

**MAXIMUM SPAN SCHEDULE NOTES:**

1. SPANS SHOWN IN "MAX PANEL SPAN SCHEDULES" ARE MAXIMUM ALLOWABLE SPANS AT EACH RESPECTIVE DESIGN PRESSURE.
2. THE <POSITIVE CONNECTION> SPAN SCHEDULE MAY BE USED TO DETERMINE MAXIMUM ALLOWABLE SPANS FOR PANELS INSTALLED USING ANY COMBINATION OF MOUNTING EXTRUSIONS INVOLVING A POSITIVE CONNECTION - i.e. ALL INSTALLATIONS WHICH DO NOT INCLUDE AN "H" OR "U" HEADER.
3. THE <WITH "H" HEADER> SPAN SCHEDULE SHALL BE USED FOR ALL INSTALLATIONS WHICH INCLUDE AN "H" HEADER.
4. THE <WITH "U" HEADER> SPAN SCHEDULE SHALL BE USED FOR ALL INSTALLATIONS WHICH INCLUDE A "U" HEADER.
5. TABLES ARE VALID FOR PANELS MOUNTED HORIZONTALLY OR VERTICALLY. SPAN DIRECTION IS ALWAYS PERPENDICULAR TO LINE OF ANCHORAGE.

FL 6417.1

**ENGINEERING EXPRESS**

POSTAL ADDRESS:  
2234 NORTH FEDERAL HWY #7664  
BOCA RATON, FL 33431  
ENGINEERINGEXPRESS.COM

**TRANSPARENT PROTECTION SYSTEMS, INC.**  
633 DUNKSFERRY ROAD  
BENSALEM, PA 19020

CLEARGUARD POLYCARBONATE STORM PANELS  
FLORIDA BUILDING CODE EIGHTH EDITION (2023)  
FLORIDA STATEWIDE APPROVAL (FSA FL#6417.1)

REMARKS	DRWN	CHKD	DATE
PREV. SUBMITTAL (20-30218)	CCB	RWN	09/04/20
2023 FBC UPDATE	MRT	RWN	09/27/23

COPYRIGHT ENGINEERING EXPRESS®

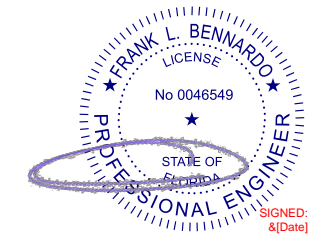

FL

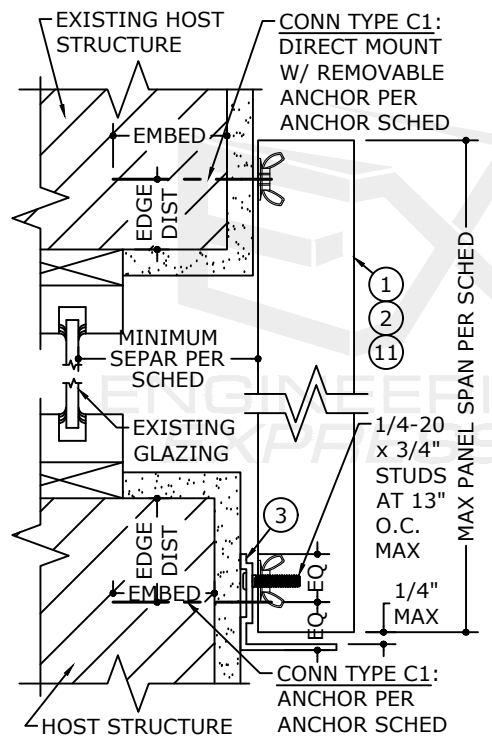

**1**  
**4** MOUNTING SECTION  
3" = 1'-0" VERT SECTION

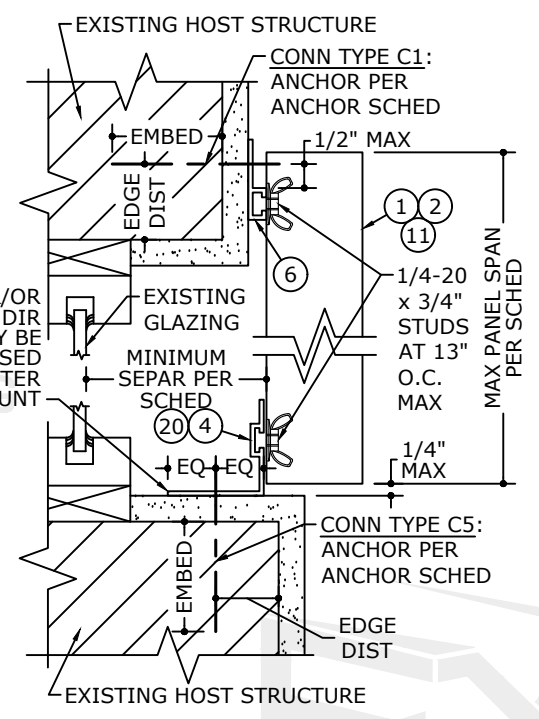

**2**  
**4** MOUNTING SECTION  
3" = 1'-0" VERT SECTION

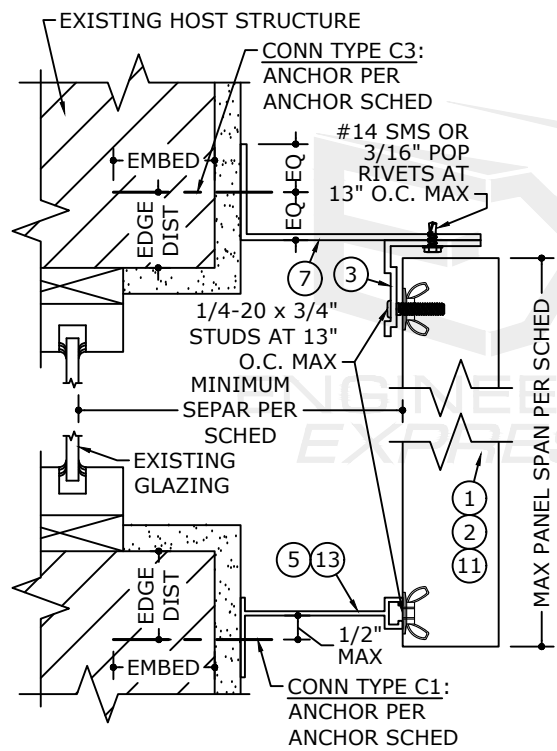

**3**  
**4** MOUNTING SECTION  
3" = 1'-0" VERT SECTION

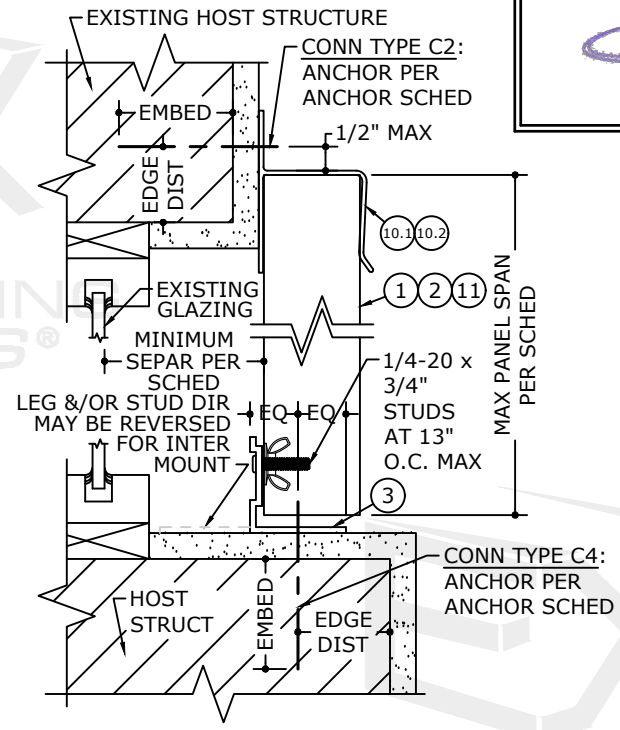

**4**  
**4** MOUNTING SECTION  
3" = 1'-0" VERT SECTION

**HURRI-OUT™ EGRESS STORM PANEL DETAILS\***

(\*NOTE: SEE GENERAL NOTE #15)

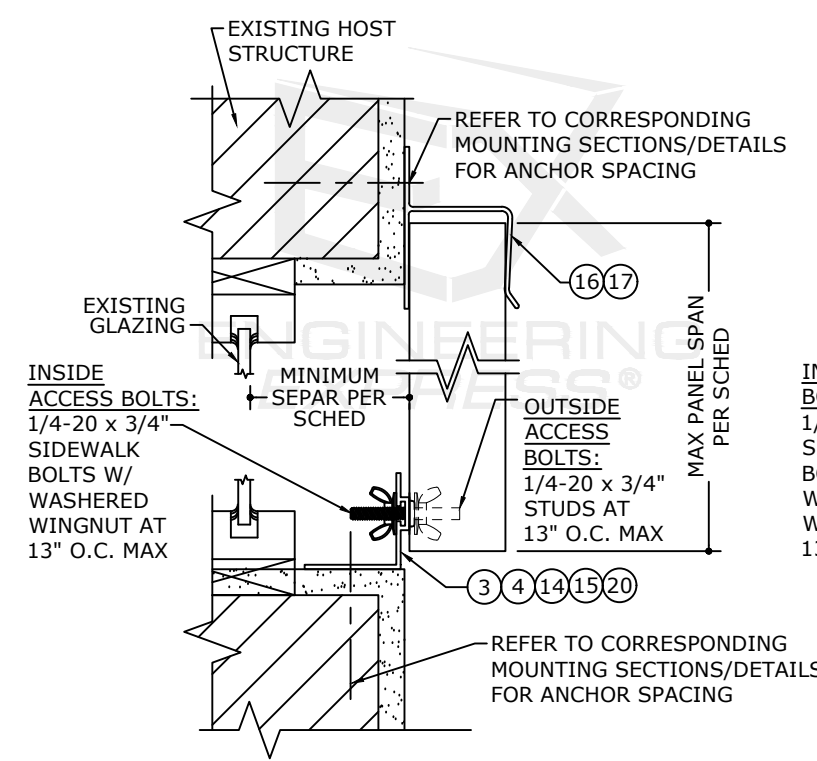

**5**  
**4** MOUNTING SECTION  
N.T.S. VERT SECTION

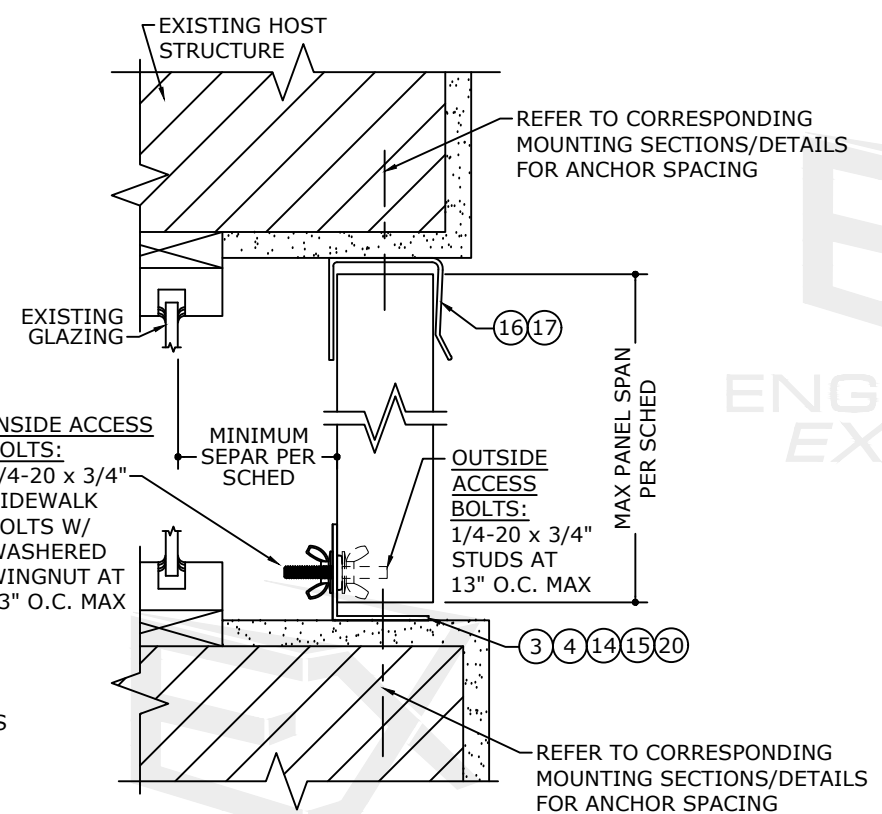

**6**  
**4** MOUNTING SECTION  
N.T.S. VERT SECTION

- ALUMINUM OR GALVANIZED STEEL SPACER:
- REQUIRED ONLY FOR EIFS, ICF, OR OTHER MALLEABLE FINISHES.
  - OPTIONAL FOR STUCCO, BRICK, OR OTHER RIGID FINISHES.

NOTE: SHUTTER SYSTEM MAY BE ANCHORED THROUGH EXTERIOR WALL FINISH TO HOST STRUCTURE WITH ANY MOUNTING CONDITION SHOWN HEREIN.

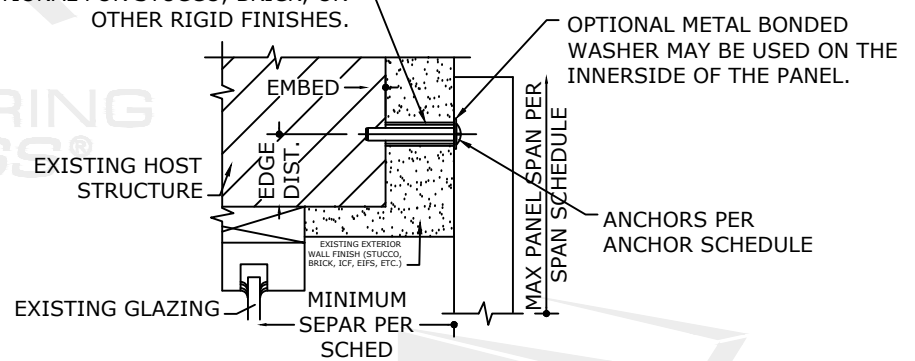

**7**  
**4** MOUNTING SECTION THRU EXTERIOR WALL FINISH (BRICK, ICF, EIFS, ETC.)  
N.T.S. VERT SECTION

FL 6417.1

**ENGINEERING EXPRESS**  
POSTAL ADDRESS:  
2234 NORTH FEDERAL HWY #7664  
BOCA RATON, FL 33431  
ENGINEERINGEXPRESS.COM

**TRANSPARENT PROTECTION SYSTEMS, INC.**  
633 DUNKSFERRY ROAD  
BENSALEM, PA 19020  
CLEARGUARD POLYCARBONATE STORM PANELS  
FLORIDA BUILDING CODE EIGHTH EDITION (2023)  
FLORIDA STATEWIDE APPROVAL (FSA FL#6417.1)

REMARKS	DRWN	CHKD	DATE
PREV. SUBMITTAL (20-30218)	CCB	RWN	09/04/20
2023 FBC UPDATE	MRT	RWN	09/27/23

23-65075  
SCALE: NTS UNLESS NOTED

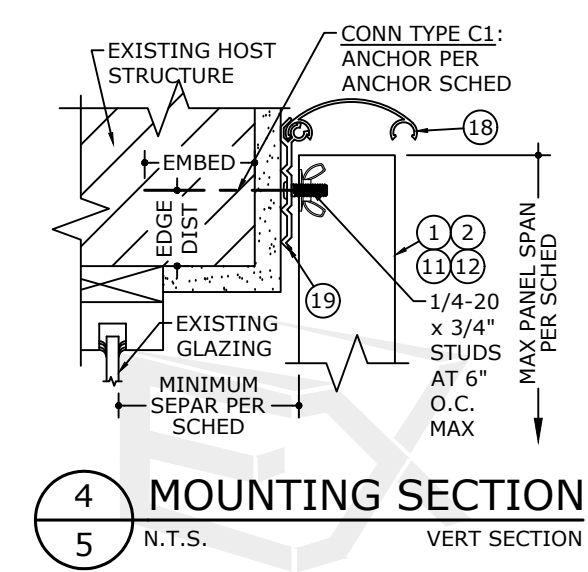
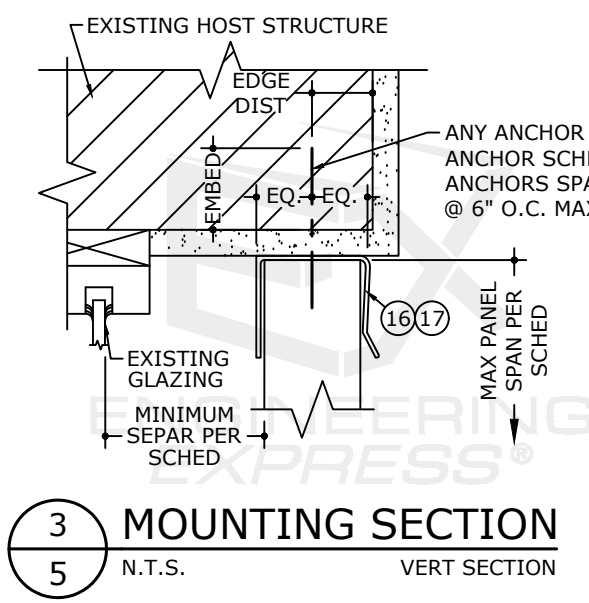
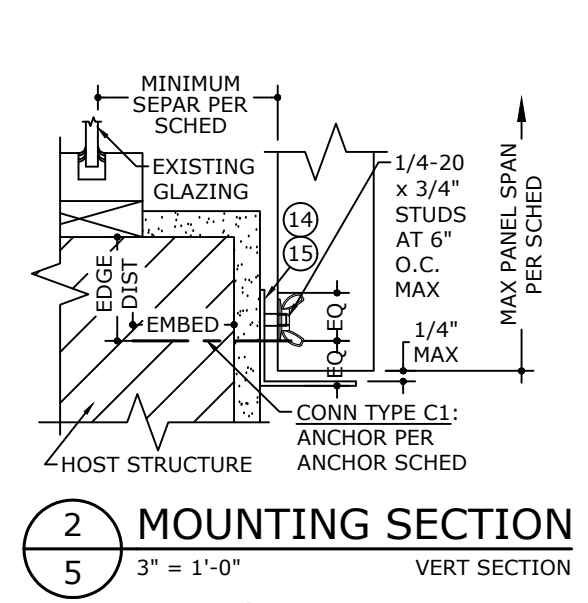
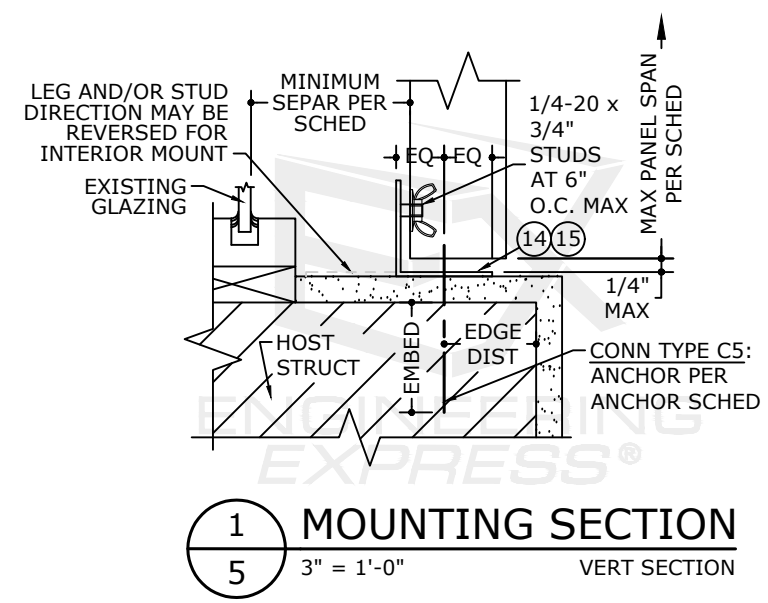

**BUILDOUT MOUNTING DETAILS**

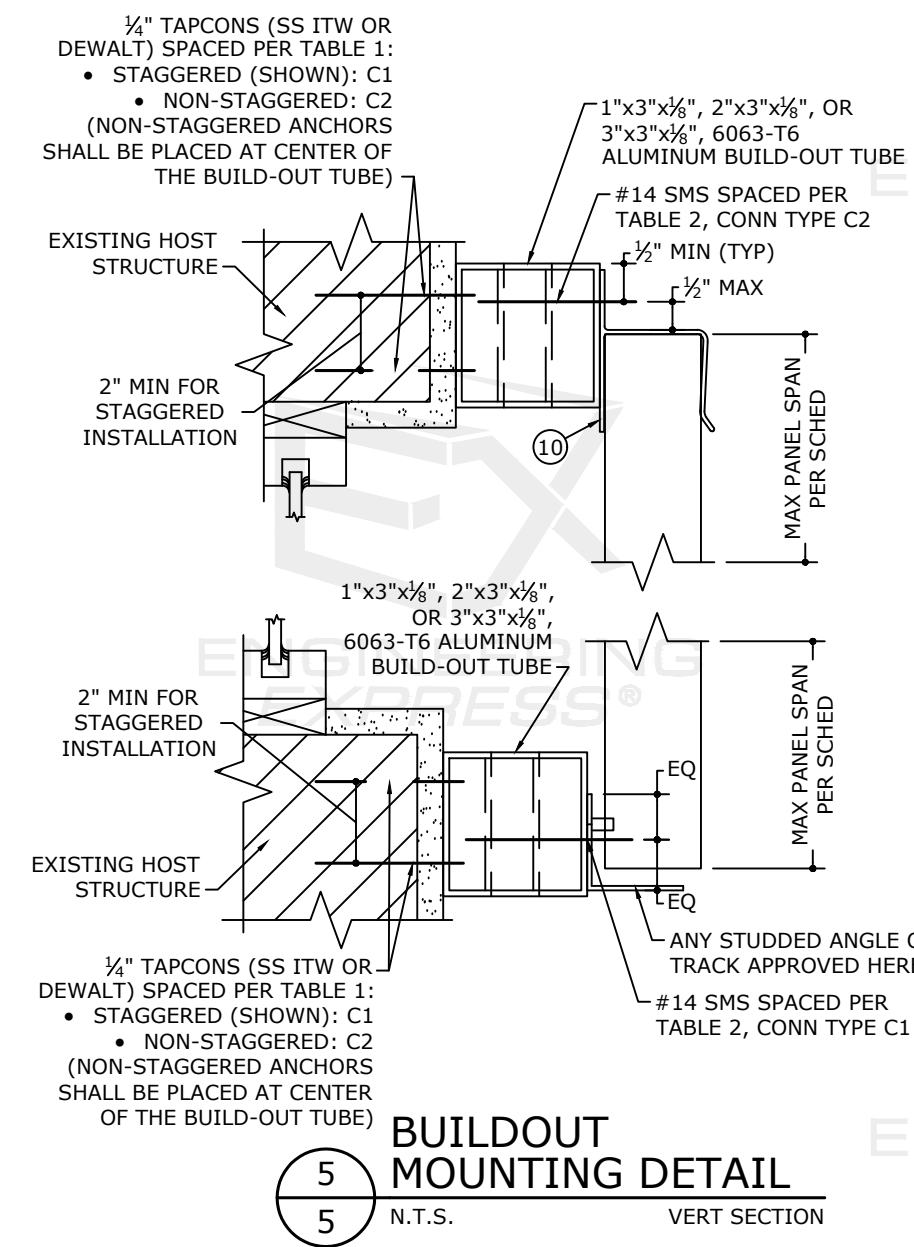

**TABLE 1\*: BUILDOUT ONLY**

HOST STRUCT.	LOAD (psf)	Spans Up To 6'-0"		Spans Up To 8'-6"		Spans Up To 11'-4"	
		CONN TYPE C1	CONN TYPE C2	CONN TYPE C1	CONN TYPE C2	CONN TYPE C1	CONN TYPE C2
CONCRETE	30	13.0"	13.0"	13.0"	13.0"	13.0"	11.8"
	38	13.0"	13.0"	13.0"	12.4"	13.0"	9.3"
	47	13.0"	13.0"	13.0"	10.1"	13.0"	8.5"
	54	13.0"	12.4"	13.0"	8.8"	13.0"	8.5"
	120	13.0"	8.5"	13.0"	8.5"	13.0"	8.5"
HOLLOW BLOCK	30	10.9"	6.6"	7.7"	4.6"	5.8"	3.5"
	38	8.6"	5.2"	6.1"	3.7"	4.6"	
	47	7.0"	4.2"	4.9"	3.0"	4.2"	
	54	6.1"	3.6"	4.3"		4.2"	
	120	4.2"		4.2"		4.2"	
WOOD	30	13.0"	8.5"	10.0"	6.0"	7.5"	4.5"
	38	11.2"	6.7"	7.9"	4.7"	5.9"	3.6"
	47	9.1"	5.4"	6.4"	3.8"	5.4"	3.3"
	54	7.9"	4.7"	5.6"	3.3"	5.4"	3.3"
	120	5.4"	3.3"	5.4"	3.3"	5.4"	3.3"

**TABLE 2\*: BUILDOUT ONLY**

LOAD (psf)	Spans Up To 6'-0"		Spans Up To 8'-6"		Spans Up To 11'-4"	
	CONN TYPE C1	CONN TYPE C2	CONN TYPE C1	CONN TYPE C2	CONN TYPE C1	CONN TYPE C2
30	13.0"	13.0"	13.0"	13.0"	13.0"	13.0"
38	13.0"	13.0"	13.0"	13.0"	11.3"	8.1"
47	13.0"	13.0"	12.2"	9.4"	10.3"	6.8"
54	13.0"	13.0"	10.6"	7.2"	10.3"	6.8"
120	10.3"	6.8"	10.3"	6.8"	10.3"	6.8"

**NOTES:**

- TABLE 1 AND 2 APPLY ONLY TO BUILDOUT MOUNTING DETAIL (7/3).
- TAPCONS SHALL BE INSTALLED WITH THE FOLLOWING MINIMUM EMBEDMENT:
  - TO CONCRETE: 1 1/4" MIN
  - TO HOLLOW BLOCK: 1 1/4" MIN
  - TO WOOD: 1 1/2" MIN
- REFER TO SHT 6 FOR ADDITIONAL ANCHOR NOTES.
- THESE MOUNTING CONDITIONS MAY BE USED INDEPENDENTLY OF ONE ANOTHER AND IN CONJUNCTION WITH OTHER MOUNTING CONDITIONS/DETAILS DEPICTED HEREIN.

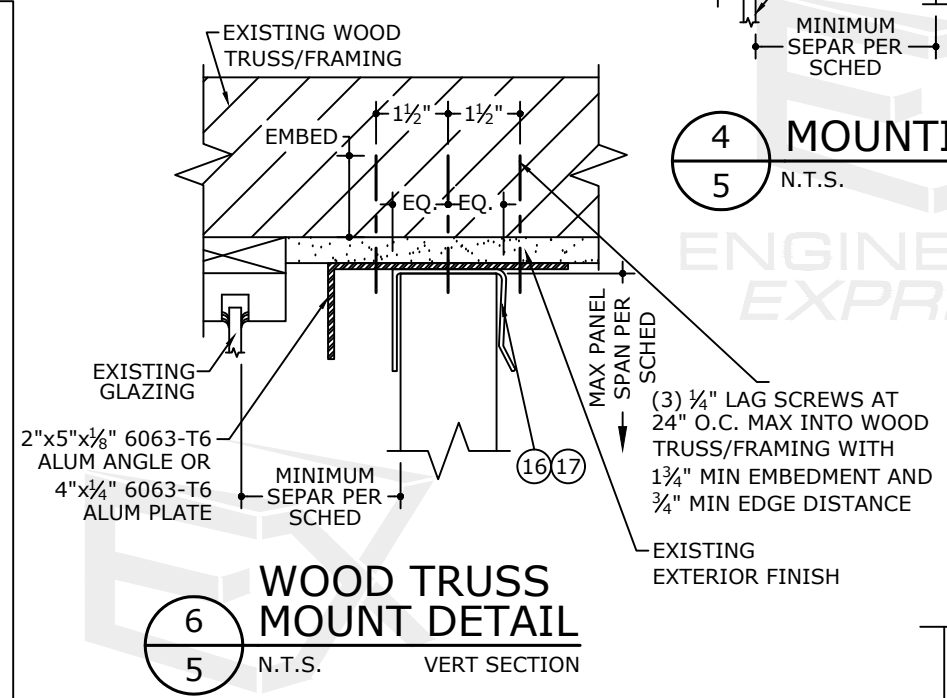

**TABLE 3:**

1/4" ITW SS TAPCONS WITH 1 1/4" MIN EMBED		1/4" ALL POINTS SOLID-SET WITH 7/8" MIN EMBED		#14 WOOD SCREWS WITH 1 1/2" MIN PENETRATION	
CONC	CMU	CONC	CMU	WOOD	
12" O.C.	8" O.C.	12" O.C.	11" O.C.	12" O.C.	

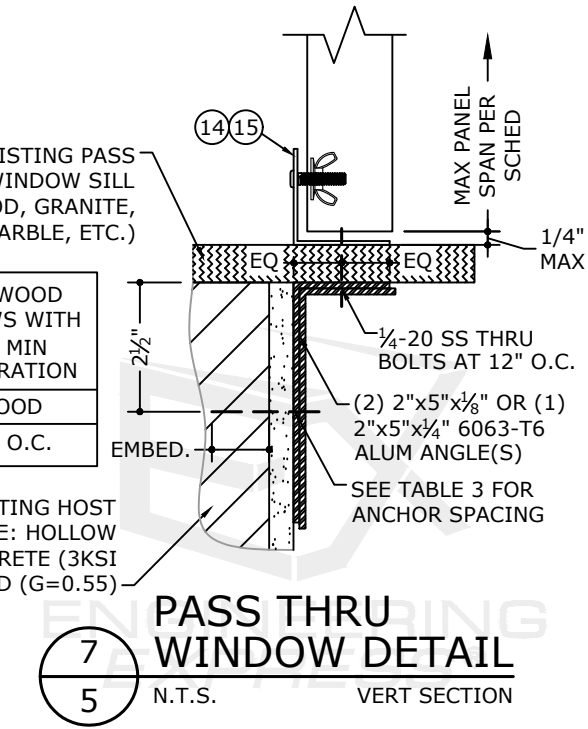

FL 6417.1

**ENGINEERING EXPRESS**

POSTAL ADDRESS:  
2234 NORTH FEDERAL HWY #7664  
BOCA RATON, FL 33431  
ENGINEERINGEXPRESS.COM

**TRANSPARENT PROTECTION SYSTEMS, INC.**  
633 DUNKSFERRY ROAD  
BENSALEM, PA 19020

CLEARGUARD POLYCARBONATE STORM PANELS  
FLORIDA BUILDING CODE EIGHTH EDITION (2023)  
FLORIDA STATEWIDE APPROVAL (FSA FL#6417.1)

REMARKS	DRWN	CHKD	DATE
PREV. SUBMITTAL (20-30218)	CCB	RWN	09/04/20
2023 FBC UPDATE	MRT	RWN	09/27/23

COPYRIGHT ENGINEERING EXPRESS®

23-65075

SCALE: NTS UNLESS NOTED

5

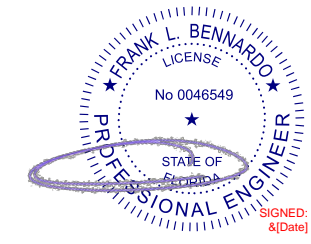

FL

# CLOSURE DETAILS

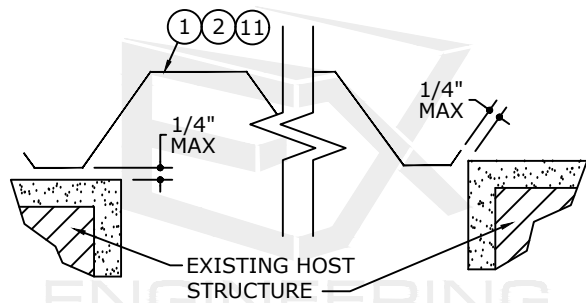

**1 WALL MOUNT CLOSURE**  
3" = 1'-0" PLAN VIEW

## MINIMUM SPAN SCHEDULE

ONE (1) CLOSURE AT TOP OR BOTTOM

TOP OR BOTTOM WITH CLOSURE	TOP OR BOTTOM MOUNT WITHOUT CLOSURE							
	DIRECT MOUNT	STUD ANGLE (WALL MOUNT)	"F" TRACK	REVERSE "F" ANGLE	B.O. 2x5 + STUD ANGLE	B.O. "F" TRACK	"H" HEADER	STUD ANGLE (TRAP MOUNT)
DIRECT MOUNT	32"	30"	33"	30"	30"	32"	30"	30"
STUD ANGLE (WALL MOUNT)	32"	30"	33"	30"	30"	32"	30"	30"
"F" TRACK	33"	30"	35"	30"	30"	33"	30"	30"
REVERSE "F" ANGLE	32"	30"	33"	30"	30"	32"	30"	30"
B.O. 2x5 + STUD ANGLE	32"	30"	33"	30"	30"	32"	30"	30"
B.O. "F" TRACK	32"	30"	33"	30"	30"	32"	30"	30"
"H" HEADER	30"	30"	30"	30"	30"	30"	30"	30"
STUD ANGLE (TRAP MOUNT)	32"	30"	33"	30"	30"	32"	30"	30"

## MINIMUM SPAN SCHEDULE NOTES:

- SPANS SHOWN ABOVE ARE MINIMUM ALLOWABLE SPANS BASED ON ANY COMBINATION OF MOUNTING CONDITIONS AT TOP OR BOTTOM. PANEL LENGTHS LESS THAN THOSE NOTED IN TABLES ABOVE ARE NOT ACCEPTABLE.
- NO SEPARATION FROM GLASS IS REQUIRED WHEN PANEL LENGTH IS GREATER THAN THAT NOTED FOR RESPECTIVE MOUNTING COMBINATIONS ABOVE.
- SIDE CLOSURES REQUIRED IF GAP BETWEEN PANEL AND STRUCTURE EXCEEDS DISTANCE SHOWN IN HORIZONTAL SECTION DETAILS (REF. DETAILS 6/3, 7/3 AND 9/3).
- TABLES ABOVE ARE VALID FOR PANELS MOUNTED HORIZONTALLY OR VERTICALLY.
- TOP/BOTTOM CLOSURES MAY CONSIST OF NON-STRUCTURAL 28ga (0.018" MIN) GALV STEEL OR 0.022" MIN SHEET ALUMINUM OF ALLOY 5052-H32 OR 3004-H34. REFERENCE DETAILS HEREIN FOR DEPICTION OF TOP/BOTTOM CLOSURE MOUNTING REQUIREMENTS.
- STORM PANELS MAY BE INSTALLED WITH A 12" MINIMUM SPAN WHEN INSTALLED WITH A CLOSURE ANGLE AT BOTH TOP AND BOTTOM.

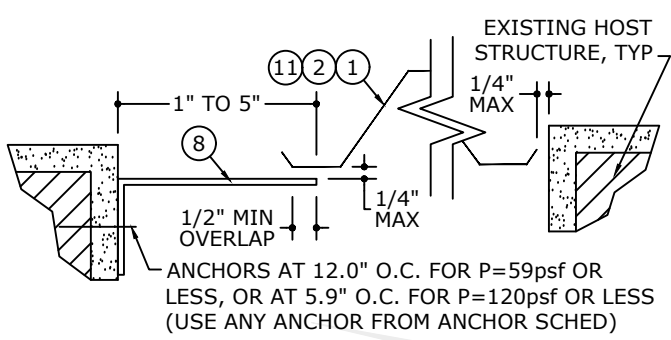

**2 TRAP MOUNT CLOSURE**  
3" = 1'-0" PLAN VIEW

## MINIMUM SPAN SCHEDULE

NO TOP/BOTTOM CLOSURES

TOP MOUNT	BOTTOM MOUNT							
	DIRECT MOUNT	STUD ANGLE (WALL MOUNT)	"F" TRACK	REVERSE "F" ANGLE	B.O. 2x5 + STUD ANGLE	B.O. "F" TRACK	"H" HEADER	STUD ANGLE (TRAP MOUNT)
DIRECT MOUNT	53"	32"	55"	32"	32"	53"	30"	32"
STUD ANGLE (WALL MOUNT)	32"	30"	33"	30"	30"	32"	30"	30"
"F" TRACK	55"	33"	57"	33"	33"	55"	30"	33"
REVERSE "F" ANGLE	32"	30"	33"	30"	30"	32"	30"	30"
B.O. 2x5 + STUD ANGLE	32"	30"	33"	30"	30"	32"	30"	30"
B.O. "F" TRACK	53"	32"	55"	32"	32"	53"	30"	32"
"H" HEADER	30"	30"	30"	30"	30"	30"	30"	30"
STUD ANGLE (TRAP MOUNT)	32"	30"	33"	30"	30"	32"	30"	30"

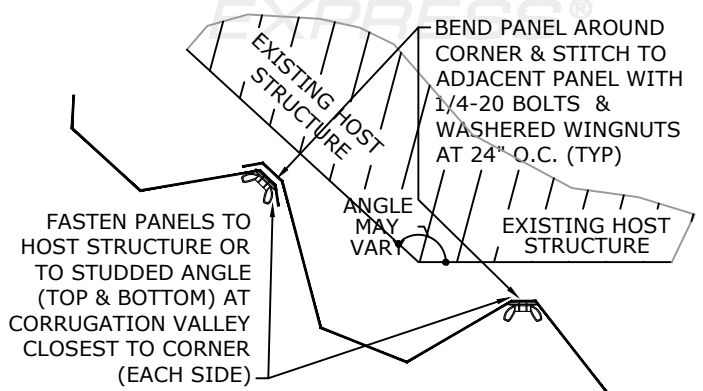

**3 CORNER CLOSURE**  
N.T.S. PLAN VIEW

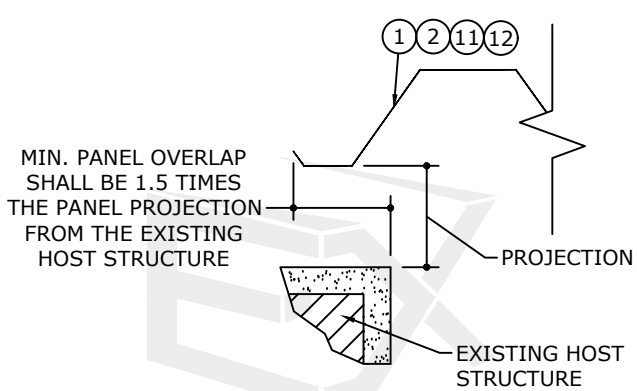

**4 PANEL OVERLAP**  
N.T.S. PLAN VIEW

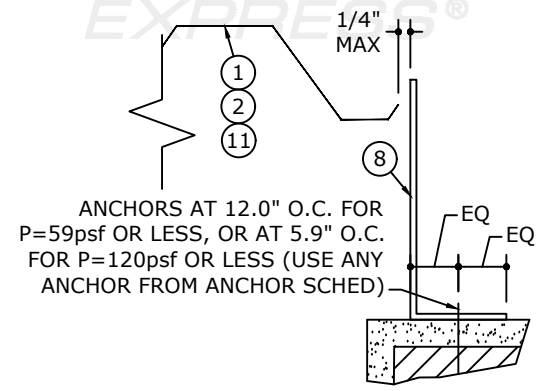

**5 BUILD-OUT CLOSURE**  
3" = 1'-0" PLAN VIEW

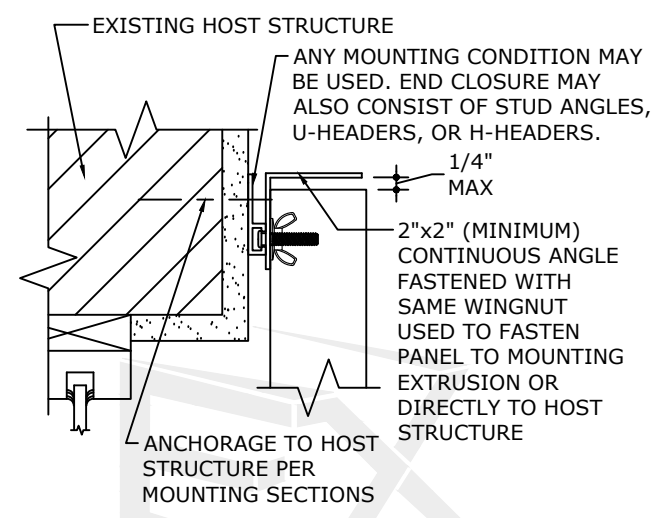

**6 TOP/BOTTOM CLOSURE**  
N.T.S. VERT SECTION

FL 6417.1

**ENGINEERING EXPRESS**  
POSTAL ADDRESS:  
2234 NORTH FEDERAL HWY #7664  
BOCA RATON, FL 33431  
ENGINEERINGEXPRESS.COM

**TRANSPARENT PROTECTION SYSTEMS, INC.**  
633 DUNKSFERRY ROAD  
BENSALEM, PA 19020  
CLEARGUARD POLYCARBONATE STORM PANELS  
FLORIDA BUILDING CODE EIGHTH EDITION (2023)  
FLORIDA STATEWIDE APPROVAL (FSA FL#6417.1)

REMARKS	DATE	DRWN	CHKD
PREV. SUBMITTAL (20-30218)	09/04/20	CCB	RWN
2023 FBC UPDATE	09/27/23	MRT	RWN

23-65075

SCALE: NTS UNLESS NOTED



c:\users\milton\engineering\express\production - documents\projects\23-65075 2023 product fbc update fl6417\work\2023 fbc\drawings & cad\23-65075a - fl6417.1 - cad.dwg

# ANCHOR SCHEDULE NOTES:

- 1/4" TAPCONS MAY BE BY ITW (STAINLESS STEEL) OR BY DEWALT. "DEWALT PANELMATE" ANCHORS MAY BE MALE, FEMALE, OR PANELMATE PLUS, AS ILLUSTRATED. HEAD STYLE MAY BE STD 13/32" OR WASHERED 5/8" HEX HEAD.
- ENSURE MINIMUM 2" EDGE DISTANCE FOR ALL ANCHORS TO CONCRETE & TO HOLLOW BLOCK. EDGE DISTANCE OF 3/4" IS ACCEPTABLE FOR ANCHORS TO WOOD.
- MINIMUM EMBEDMENT SHALL BE AS NOTED IN ANCHOR SCHEDULE. MINIMUM EMBEDMENT AND EDGE DISTANCE EXCLUDES STUCCO, FOAM, BRICK, AND OTHER WALL FINISHES.
- ANCHORS SHALL BE INSTALLED IN ACCORDANCE WITH MANUFACTURERS' RECOMMENDATIONS.
- WHERE EXISTING STRUCTURE IS WOOD FRAMING, EXISTING CONDITIONS MAY VARY. FIELD VERIFY THAT FASTENERS ARE INTO ADEQUATE WOOD FRAMING MEMBERS, NOT INTO PLYWOOD.
- WHERE ANCHORS FASTEN TO NARROW FACE OF STUD FRAMING, ANCHOR SHALL BE LOCATED IN CENTER OF NOMINAL 2x4 (MIN) WOOD STUD (i.e. 3/4" EDGE DISTANCE IS ACCEPTABLE FOR ANCHORS TO WOOD FRAMING). WOOD STUD SHALL BE "SOUTHERN PINE" (FOR G=0.55 OR GREATER DENSITY) OR "SPRUCE-PINE-FIR" (FOR G=0.42 OR GREATER DENSITY).
- ANCHOR SCHEDULE APPLIES FOR ALL PRODUCTS CERTIFIED HEREIN, BUT ONLY PROVIDES MAXIMUM ALLOWABLE ANCHOR SPACING. MAXIMUM ALLOWABLE SPANS AND PRESSURES INDICATED IN SPAN SCHEDULE SHALL APPLY.
- MACHINE SCREWS SHALL HAVE MINIMUM OF 1/2" ENGAGEMENT OF THREADS IN BASE ANCHOR AND MAY HAVE EITHER A PAN HEAD, TRUSS HEAD, OR WAFER HEAD ("SIDEWALK BOLT") U.N.O.
- \* DESIGNATES REMOVABLE ANCHORS. PANELS SHALL BE MOUNTED DIRECTLY TO THE HOST STRUCTURE ONLY WITH THESE ANCHORS, LOCATED AT KEYHOLES AND LESS THAN OR EQUAL TO ALLOWABLE SPACING SHOWN IN ANCHOR SCHEDULE.
- DESIGNATES ANCHOR CONDITIONS WHICH ARE NOT ACCEPTABLE FOR USE.

FRANK BENNARDO, P.E.  
PE# 0046549 CA# 9885

SEPTEMBER 27, 2023

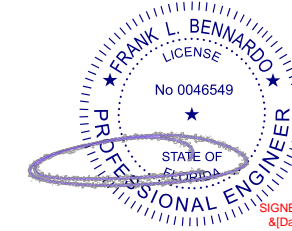

FL



## ANCHOR SCHEDULES

HOST STRUCT.	ANCHOR	LOAD (psf)	2" MIN EDGE DISTANCE															
			Spans Up To 6'-0"					Spans Up To 8'-6"					Spans Up To 12'-0"					
			CONN TYPE					CONN TYPE					CONN TYPE					
			C1	C2	C3	C4	C5	C1	C2	C3	C4	C5	C1	C2	C3	C4	C5	
CONCRETE	1/4" DEWALT ULTRACON OR ITW SS TAPCON WITH 1-3/4" EMBED (3192 PSI MIN CONC)	30	13.0"	13.0"	13.0"	13.0"	13.0"	13.0"	13.0"	13.0"	13.0"	13.0"	13.0"	10.6"	13.0"	13.0"	13.0"	13.0"
		38	13.0"	13.0"	13.0"	13.0"	13.0"	13.0"	13.0"	13.0"	13.0"	13.0"	13.0"	8.3"	6.5"	13.0"	13.0"	9.0"
		47	13.0"	13.0"	13.0"	13.0"	13.0"	13.0"	13.0"	9.5"	7.4"	13.0"	13.0"	13.0"	6.7"	5.3"	13.0"	7.2"
		54	13.0"	13.0"	13.0"	13.0"	13.0"	13.0"	8.3"	6.5"	13.0"	8.9"	13.0"	5.9"	4.6"	11.7"	6.3"	
		120	5.4"	5.3"	4.1"	5.1"	5.7"	3.8"	3.7"		3.6"	4.0"						
	1/4" DEWALT PANELMATE WITH 1-3/4" MIN EMBED (3350 PSI MIN CONC)	30	13.0"	13.0"	13.0"	13.0"	13.0"	13.0"	13.0"	13.0"	13.0"	13.0"	13.0"	13.0"	13.0"	13.0"	13.0"	13.0"
		38	13.0"	13.0"	13.0"	13.0"	13.0"	13.0"	13.0"	13.0"	13.0"	13.0"	13.0"	10.7"	8.3"	13.0"	11.5"	
		47	13.0"	13.0"	13.0"	13.0"	13.0"	13.0"	12.2"	9.5"	13.0"	13.0"	13.0"	8.6"	6.7"	13.0"	9.3"	
		54	13.0"	13.0"	13.0"	13.0"	13.0"	13.0"	10.6"	8.3"	13.0"	11.4"	13.0"	7.5"	5.9"	13.0"	8.1"	
		120	6.9"	6.8"	5.3"	6.5"	7.3"	4.9"	4.8"	3.7"	4.6"	5.1"	3.4"	3.4"		3.3"	3.6"	
	1/4-20 ALL POINTS SOLID- SET WITH 7/8" MIN EMBED (3000 PSI MIN CONC)	30	13.0"	13.0"	13.0"	13.0"	13.0"	13.0"	13.0"	13.0"	13.0"	13.0"	13.0"	10.6"	13.0"	13.0"	13.0"	13.0"
		38	13.0"	13.0"	13.0"	13.0"	13.0"	13.0"	13.0"	13.0"	13.0"	13.0"	8.4"	6.6"	13.0"	10.5"		
		47	13.0"	13.0"	13.0"	13.0"	13.0"	13.0"	9.6"	7.5"	13.0"	13.0"	13.0"	6.8"	5.3"	13.0"	8.5"	
		54	13.0"	13.0"	13.0"	13.0"	13.0"	13.0"	8.3"	6.5"	13.0"	10.4"	13.0"	5.9"	4.6"	13.0"	7.4"	
		120	5.4"	5.3"	4.1"	5.9"	6.6"	3.8"	3.8"		4.1"	4.7"						
	1/4-20 DEWALT CALK-IN WITH 7/8" MIN EMBED (3000 PSI MIN CONC)	30	13.0"	13.0"	13.0"	13.0"	13.0"	13.0"	13.0"	13.0"	13.0"	13.0"	6.7"	13.0"	11.5"	11.5"		
		38	13.0"	13.0"	13.0"	13.0"	13.0"	13.0"	13.0"	13.0"	12.8"	12.8"	13.0"	5.3"	4.1"	9.1"	5.2"	
		47	13.0"	13.0"	13.0"	13.0"	13.0"	13.0"	6.0"	4.7"	10.4"	10.4"	11.5"	4.3"	3.3"	7.4"	4.2"	
		54	13.0"	13.0"	13.0"	13.0"	13.0"	13.0"	5.3"	4.1"	9.0"	5.2"	10.0"	3.7"		6.4"	3.7"	
		120	3.4"	3.4"		3.0"	3.3"											

HOST STRUCT.	ANCHOR	LOAD (psf)	3/4" MIN EDGE DISTANCE																		
			Spans Up To 6'-0"					Spans Up To 8'-6"					Spans Up To 12'-0"								
			CONN TYPE					CONN TYPE					CONN TYPE								
			C1	C2	C3	C4	C5	C1	C2	C3	C4	C5	C1	C2	C3	C4	C5				
WOOD (G=0.55 MIN)	1/4" TAPCON (DEWALT OR ITW) OR #14 WOOD SCREW W/ 1-1/2" EMBED	30	13.0"	13.0"	13.0"	13.0"	13.0"	13.0"	13.0"	13.0"	13.0"	13.0"	13.0"	13.0"	13.0"	13.0"	13.0"	9.7"	13.0"	13.0"	13.0"
		38	13.0"	13.0"	13.0"	13.0"	13.0"	13.0"	13.0"	13.0"	13.0"	13.0"	13.0"	8.3"	6.5"	13.0"	13.0"	7.6"	6.0"	13.0"	5.2"
		47	13.0"	13.0"	13.0"	13.0"	13.0"	13.0"	13.0"	9.5"	7.4"	13.0"	13.0"	13.0"	6.7"	5.3"	13.0"	6.2"	4.8"	10.5"	4.2"
		54	13.0"	13.0"	13.0"	13.0"	13.0"	13.0"	8.3"	6.5"	13.0"	8.9"	13.0"	5.9"	4.6"	11.7"	6.3"				
		120	4.9"	4.8"	3.8"	4.3"	3.3"	3.5"	3.4"	2.7"	3.0"	2.3"	2.5"	2.4"		2.2"					
	1/4" DEWALT PANELMATE (FEMALE, MALE, OR PLUS) W/ 1-7/8" MIN EMBED	30	13.0"	13.0"	13.0"	13.0"	13.0"	13.0"	13.0"	13.0"	13.0"	13.0"	13.0"	13.0"	13.0"	13.0"	13.0"	13.0"	13.0"	13.0"	13.0"
		38	13.0"	13.0"	13.0"	13.0"	13.0"	13.0"	13.0"	13.0"	13.0"	13.0"	13.0"	10.7"	8.3"	13.0"	11.5"				
		47	13.0"	13.0"	13.0"	13.0"	13.0"	13.0"	12.2"	9.5"	13.0"	13.0"	13.0"	8.6"	6.7"	13.0"	9.3"				
		54	13.0"	13.0"	13.0"	13.0"	13.0"	13.0"	10.6"	8.3"	13.0"	11.4"	13.0"	7.5"	5.9"	13.0"	8.1"				
		120	6.7"	6.5"	5.1"	4.7"	3.8"	4.7"	4.6"	3.6"	3.3"	2.7"	3.3"	3.3"	2.6"	2.4"					
	7/16" WOOD BUSHING W/ 7/8" MIN EMBED & 1/4-20 S.S. MACHINE SCREW	30	13.0"	13.0"	13.0"	13.0"	13.0"	13.0"	13.0"	13.0"	13.0"	13.0"	13.0"	10.6"	13.0"	13.0"	13.0"	13.0"	13.0"	13.0"	13.0"
		38	13.0"	13.0"	13.0"	13.0"	13.0"	13.0"	13.0"	13.0"	13.0"	13.0"	8.4"	6.6"	13.0"	10.5"					
		47	13.0"	13.0"	13.0"	13.0"	13.0"	13.0"	9.6"	7.5"	13.0"	13.0"	13.0"	6.8"	5.3"	13.0"	8.5"				
		54	13.0"	13.0"	13.0"	13.0"	13.0"	13.0"	8.3"	6.5"	13.0"	10.4"	13.0"	5.9"	4.6"	13.0"	7.4"				
		120	2.9"	2.9"	2.2"	3.2"	2.3"	2.1"	2.0"												
	1/4" LAG SCREW OR HANGAR BOLT WITH 2-3/32" MIN THREAD PENETR	30	13.0"	13.0"	13.0"	13.0"	13.0"	13.0"	13.0"	13.0"	13.0"	13.0"	6.7"	13.0"	11.5"	11.5"					
		38	13.0"	13.0"	13.0"	13.0"	13.0"	13.0"	13.0"	13.0"	12.8"	12.8"	13.0"	5.3"	4.1"	9.1"	5.2"				
		47	13.0"	13.0"	13.0"	13.0"	13.0"	13.0"	6.0"	4.7"	10.4"	10.4"	11.5"	4.3"	3.3"	7.4"	4.2"				
		54	13.0"	13.0"	13.0"	13.0"	13.0"	13.0"	5.3"	4.1"	9.0"	5.2"	10.0"	3.7"		6.4"	3.7"				
		120	6.5"	6.4"	5.0"	4.5"	3.6"	4.6"	4.5"	3.5"	3.1"	2.5"	3.2"	3.2"	2.5"	2.2"					

HOST STRUCT.	ANCHOR	LOAD (psf)	2" MIN EDGE DISTANCE																		
			Spans Up To 6'-0"					Spans Up To 8'-6"					Spans Up To 12'-0"								
			CONN TYPE					CONN TYPE					CONN TYPE								
			C1	C2	C3	C4	C5	C1	C2	C3	C4	C5	C1	C2	C3	C4	C5				
HOLLOW BLOCK (ASTM C-90 MIN)	1/4" DEWALT ULTRACON OR ITW SS TAPCON WITH 1-1/4" EMBED	30	13.0"	13.0"	13.0"	13.0"	13.0"	11.7"	11.7"	11.7"	9.4"	9.4"	8.3"	3.1"	8.3"	6.7"	6.7"				
		38	13.0"	13.0"	13.0"	10.5"	10.5"	9.3"	9.3"	9.3"	7.4"	7.4"	6.6"			5.3"					
		47	10.6"	10.6"	10.6"	8.5"	8.5"	7.5"			6.0"	6.0"	5.3"			4.3"					
		54	9.2"	9.2"	9.2"	7.4"	7.4"	6.5"			5.2"		4.6"			3.7"					
		120																			
	1/4" DEWALT PANELMATE WITH 1-1/4" MIN EMBED	30	13.0"	13.0"	13.0"	13.0"	13.0"	13.0"	13.0"	13.0"	13.0"	13.0"	13.0"	5.4"	13.0"	13.0"	13.0"				
		38	13.0"	13.0"	13.0"	13.0"	13.0"	13.0"	13.0"	13.0"	13.0"	13.0"	11.5"	4.3"	3.3"	10.5"	5.1"				
		47	13.0"	13.0"	13.0"	13.0"	13.0"	13.0"	4.9"	3.8"	11.9"	11.9"	9.3"	3.5"		8.5"	4.1"				
		54	13.0"	13.0"	13.0"	13.0"	13.0"	11.4"	4.3"	3.3"	10.4"	5.1"	8.1"	3.0"		7.4"	3.6"				
		120						3.2"													
	1/4-20 ALL POINTS SOLID- SET WITH 7/8" MIN EMBED	30	13.0"	13.0"	13.0"	13.0"	13.0"	13.0"	13.0"	13.0"	13.0"	13.0"	13.0"	8.9"	13.0"	13.0"	13.0"				
		38	13.0"	13.0"	13.0"	13.0"	13.0"	13.0"	13.0"	13.0"	13.0"	13.0"	13.0"	7.0"	5.5"	13.0"	7.3"				
		47	13.0"	13.0"	13.0"	13.0"	13.0"	13.0"	8.0"	6.3"	13.0"	13.0"	13.0"	5.7"	4.4"	10.6"	5.9"				
		54	13.0"	13.0"	13.0"	13.0"	13.0"	13.0"	7.0"	5.4"	13.0"	7.2"	13.0"	4.9"	3.9"	9.2"	5.1"				
		120	4.5"	4.4"	3.5"	4.2"	4.6"	3.2"	3.1"				3.2"								

HOST STRUCT.	ANCHOR	LOAD (psf)	3/4" MIN EDGE DISTANCE																			
			Spans Up To 6'-0"					Spans Up To 8'-6"					Spans Up To 12'-0"									
			CONN TYPE					CONN TYPE					CONN TYPE									
			C1	C2	C3	C4	C5	C1	C2	C3	C4	C5	C1	C2	C3	C4	C5					
WOOD (G=0.42 MIN)	1/4" TAPCON (DEWALT OR ITW) OR #14 WOOD SCREW W/ 1-1/2" EMBED	30	13.0"	13.0"	13.0"	13.0"	13.0"	13.0"	13.0"	13.0"	13.0"	13.0"	13.0"	13.0"	13.0"	13.0"	13.0"	6.2"	13.0"	13.0"	13.0"	
		38	13.0"	13.0"	13.0"	13.0"	13.0"	13.0"	13.0"	13.0"	13.0"	13.0"	13.0"	5.6"	4.4"	12.3"	4.2"	10.7"	4.0"	3.1"	8.7"	3.0"
		47	13.0"	13.0"	13.0"	13.0"	13.0"	13.0"	13.0"	5.6"	4.4"	12.3"	4.2"	10.7"	4.0"	3.1"	8.7"	3.0"				
		54	13.0"	13.0"	13.0"	13.0"	13.0"	13.0"	4.9"	3.8"	10.7"	3.6"	9.3"	3.5"	2.7"	7.6"	2.6"					
		120	3.2"	3.1"	2.4"	3.1"	2.3"	2.2"	2.2"													
	1/4" DEWALT PANELMATE (FEMALE, MALE, OR PLUS) W/ 1-7/8" MIN EMBED	30	13.0"	13.0"	13.0"	13.0"	13.0"	13.0"	13.0"	13.0"	13.0"	13.0"	13.0"	5.4"	13.0"	13.0"	13.0"					
		38	13.0"	13.0"	13.0"	13.0"	13.0"	13.0"	13.0"	13.0"	13.0"	13.0"	11.5"	4.3"	3.3"	10.5"	5.1"					
		47	13.0"	13.0"	13.0"	13.0"	13.0"	13.0"	4.9"	3.8"												

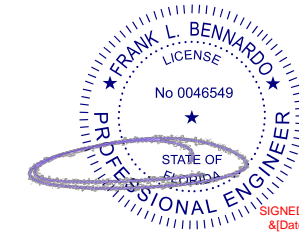

FL

### POSITIVE CONNECTION MINIMUM GLASS SEPARATION SCHEDULE

LOAD (PSF)	SPAN LESS THAN	MINIMUM SEPARATION AT OR BELOW 30' ABOVE GRADE	MINIMUM SEPARATION AT ELEVATION > 30' ABOVE GRADE
38	4'-0"	7.73"	1.65"
	7'-0"	7.73"	4.38"
	12'-0"	8.78"	8.78"
40	4'-0"	7.73"	1.69"
	7'-0"	7.73"	4.56"
	11'-5"	8.33"	8.33"
45	4'-0"	7.73"	1.77"
	7'-0"	7.73"	5.01"
	10'-1"	7.73"	7.39"
50	4'-0"	7.73"	1.86"
	7'-0"	7.73"	5.45"
	9'-1"	7.73"	6.87"
60	4'-0"	7.73"	2.03"
	7'-0"	7.73"	6.34"
	7'-7"	7.73"	6.57"
70	4'-0"	7.73"	2.20"
	6'-7"	7.73"	6.38"
120	3'-10"	7.73"	2.74"

### H-HEADER MINIMUM GLASS SEPARATION SCHEDULE

SPAN LESS THAN	MINIMUM SEPARATION AT OR BELOW 30' ABOVE GRADE	MINIMUM SEPARATION AT ELEVATION > 30' ABOVE GRADE
8'-7"	8.60"	7.17"
7'-9"	8.60"	6.69"
7'-0"	8.60"	5.97"
6'-0"	8.60"	4.94"
5'-0"	8.60"	4.10"
4'-0"	8.60"	3.58"

### U-HEADER MINIMUM GLASS SEPARATION SCHEDULE

SPAN LESS THAN	MINIMUM SEPARATION AT OR BELOW 30' ABOVE GRADE	MINIMUM SEPARATION AT ELEVATION > 30' ABOVE GRADE
6'-3"	3.98"	3.21"
5'-3"	3.98"	2.58"
4'-4"	3.98"	2.24"

### GLASS SEPARATION SCHEDULE NOTES:

1. GLASS SEPARATION SCHEDULE PROVIDES MINIMUM SEPARATION DISTANCE REQUIRED BETWEEN EXTERIOR FACE OF GLAZING (OR OTHER PRODUCT BEING PROTECTED) AND INTERIOR FACE OF INSTALLED STORM PANEL.
2. SEPARATION DISTANCE PER THIS SCHEDULE IS REQUIRED FOR USE WITH POSITIVE LOADS ONLY.
3. SEPARATION FROM GLASS IS REQUIRED ONLY WHEN INSTALLED WITHIN ASTM WIND ZONE 4 AND ESSENTIAL FACILITIES.

FL 6417.1

**ENGINEERING EXPRESS®**  
 POSTAL ADDRESS:  
 2234 NORTH FEDERAL HWY #7664  
 BOCA RATON, FL 33431  
 ENGINEERINGEXPRESS.COM

**TRANSPARENT PROTECTION SYSTEMS, INC.**  
 633 DUNKSFERRY ROAD  
 BENSLEM, PA 19020  
 CLEARGUARD POLYCARBONATE STORM PANELS  
 FLORIDA BUILDING CODE EIGHTH EDITION (2023)  
 FLORIDA STATEWIDE APPROVAL (FSA FL#6417.1)

REMARKS	DRWN	CHKD	DATE
PREV. SUBMITTAL (20-30218)	CCB	RWV	09/04/20
2023 FBC UPDATE	MRT	RWV	09/27/23

COPYRIGHT ENGINEERING EXPRESS®

23-65075

SCALE: NTS UNLESS NOTED



c:\users\milton\engineering express\production - documents\projects\23-65075 2023 product fbc update fl6417\work\2023 fbc\drawings & cad\23-65075a - fl6417.1 - cad.dwg

ENGINEERING EXPRESS®

ENGINEERING EXPRESS®

ENGINEERING EXPRESS®

ENGINEERING EXPRESS®

ENGINEERING EXPRESS®

ENGINEERING EXPRESS®

ENGINEERING EXPRESS®