

TEST REPORT

Report No.: B0805.03-801-44

Rendered to:

GLASSCRAFT DOOR COMPANY
Houston, Texas

PRODUCT TYPE: Fiberglass In-Swing Solid Double Doors
SERIES/MODEL: Fiberglass Door

Title	Summary of Results
Design Pressure	+1513 Pa (+31.6 psf)
Negative Design Pressure	-1657 Pa (-34.6 psf)

This report contains in its entirety:

Cover Page: 1 page
Report Body: 5 pages
Drawings: 11 pages

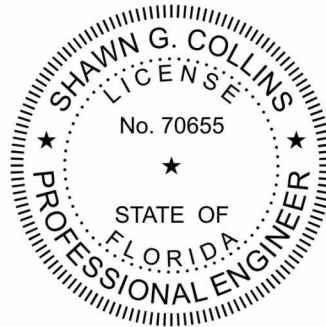

Digitally Signed by: Shawn G. Collins

2011.08.29 13:50:22
-04'00'

Reference must be made to Report No. B0805.03-801-44, dated 06/23/11 for complete test specimen description and detailed test results.

1.0 Report Issued To: GlassCraft Door Company
2002 Brittmoore Street
Houston, Texas 77043

2.0 Test Laboratory: Architectural Testing, Inc.
2865 Market Loop
Southlake, Texas 76092
(817) 410-7202

3.0 Project Summary:

3.1 Product Type: Fiberglass In-Swing Solid Double Doors

3.2 Series/Model: Fiberglass Door

3.3 Compliance Statement: Results obtained are tested values and were secured by using the designated test method(s). The samples tested met the performance requirements set forth in the referenced test procedures for a +1513/-1657 Pa (+31.6/-34.6 psf) Design Pressure.

3.4 Test Dates: 06/15/2011

3.5 Test Location: Architectural Testing, Inc. test facility in Southlake, Texas.

3.6 Test Sample Source: The test specimens were provided by the client. Representative samples of the test specimens will be retained by Architectural Testing for a minimum of four years from the test completion date.

3.7 Drawing Reference: The test specimen drawings have been reviewed by Architectural Testing and are representative of the test specimen(s) reported herein. Test specimen construction was verified by Architectural Testing per the drawings located in Appendix B. Any deviations are documented herein or on the drawings.

3.8 List of Official Observers:

<u>Name</u>	<u>Company</u>
Chris Longoria	Architectural Testing, Inc.
Tom Klein	Architectural Testing, Inc.

4.0 Test Method(s):

ASTM E 330-02, *Test Method for Structural Performance of Exterior Windows, Curtain Walls and Doors by Uniform Static Air Pressure Difference.*

5.0 Test Specimen Description:

5.1 Product Sizes:

Test Specimens #1 - #3:

Overall Area: 4.5 m ² (48.3 ft ²)	Width		Height	
	millimeters	inches	millimeters	inches
Overall size	1848	72-3/4	2426	95-1/2
Operable leaf	914	36	2426	95-1/2
Fixed leaf	914	36	2426	95-1/2

5.2 Frame Construction:

Frame Member	Material	Description
Head & jambs	Compressed fiberboard	1-1/4" x 4-5/8" cross section

	Joinery Type	Detail
All corners	Coped & butted	Secured with four #9 x 3" wood screws

5.3 Leaf Construction:

Leaf Member	Material	Other
Rails & stiles	Fiberglass clad foam core	Solid, single pour foam core

5.0 Test Specimen Description: (Continued)

5.4 Weatherstripping:

Description	Quantity	Location
U-shaped foam-filled vinyl bulb gasket with vinyl tongue insert	1 row	Interior face frame jambs
U-shaped foam-filled vinyl bulb gasket with vinyl tongue insert	1 row	Interior face frame head
U-shaped foam-filled vinyl bulb gasket with vinyl tongue insert	1 row	Interior face astragal
Rubber double row bottom door sweep	1 row	Threshold face bottom of each leaf

5.5 Drainage: Sloped threshold was utilized.

5.6 Glazing: None

5.7 Hardware:

Description	Quantity	Location
Door hinge	4 per leaf	12" & 28" up from bottom; 9" & 34-1/2" down from top
Flush bolt	2	Inserted into top and bottom of astragal
3 point lock set	1	Inserted into lock stile of operable leaf
Flush bolt guide	2	One at each end of the fixed panel lock stile

5.8 Reinforcement: No reinforcement was utilized.

5.9 Screen Construction: No screen was utilized.

6.0 Installation:

The specimen was installed into a Spruce-Pine-Fir wood buck. The rough opening allowed for a 1" shim space.

Location	Anchor Description	Anchor Location
Jambs	#9 x 3" wood screws	12" from corners, 24" on center thereafter; through top and bottom mounting holes of hinges
Head & threshold	#9 x 3" wood screws	4" from corners, 12" on center thereafter

7.0 Test Results: The temperature during testing was 28.9°C (84°F). The results are tabulated as follows:

Title of Test	Results	Allowed	Note
Uniform Load Deflection, per ASTM E 330 taken at lock stile +1513 Pa (+31.6 psf) -1657 Pa (-34.6psf)	5.0 mm (0.20") 14.5 mm (0.57")	Report Only	1, 2
Uniform Load Structural, per ASTM E 330 taken at lock stile +2270 Pa (+47.4 psf) -2485Pa (-51.9 psf)	2.0 mm (0.08") 0.8 mm (0.03")	Report Only	1, 2

General Note: All testing was performed in accordance with the referenced standard(s).

Note 1: Loads were held for 10 seconds.

Note 2: Tape and film were used to seal against air leakage during structural testing. In our opinion, the tape and film did not influence the results of the test.

The service life of this report will expire on the stated Test Record Retention End Date, at which time such materials as drawings, data sheets, samples of test specimens, copies of this report, and any other pertinent project documentation, shall be discarded without notice.

If test specimen contains glazing, no conclusions of any kind regarding the adequacy or inadequacy of the glass in any glazed test specimen(s) can be made. This report does not constitute certification of this product nor an opinion or endorsement by this laboratory. It is the exclusive property of the client so named herein and relates only to the specimen(s) tested. This report may not be reproduced, except in full, without the written approval of Architectural Testing, Inc.

For ARCHITECTURAL TESTING, Inc.



Digitally Signed by: Tom Klein

Tom Klein
Technician



Digitally Signed by: Shawn G. Collins

Shawn G. Collins, P.E.
Laboratory Support Engineer

AC:hd

Attachments (pages): This report is complete only when all attachments listed are included.

Appendix-A: Drawings (10)

This report produced from controlled document template ATI 00479, issued 03/01/11.

Revision Log

<u>Rev. #</u>	<u>Date</u>	<u>Page(s)</u>	<u>Revision(s)</u>
1	08/03/11	Cover	Added FL PE Seal.
		4	Replaced Andy Costs signature with Shawn Collins.
2	08/29/11	1	Corrected Compliance Statement

Test Report No.: B0805.01-801-44
Report Date: 06/21/11
Test Record Retention End Date: 06/15/15

Appendix A

Drawings

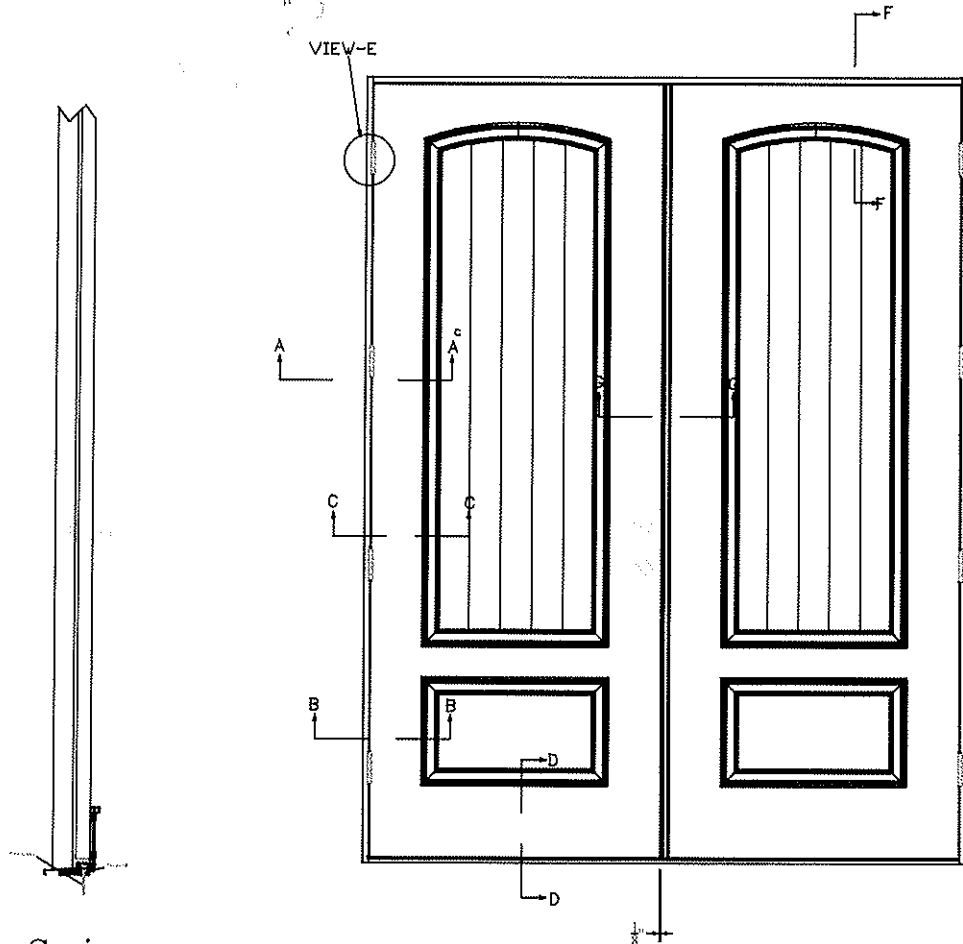

In Swing

ELEVATION

Inside View / In Swing



Architectural Testing

Test sample complies with these details.
Deviations are noted.

Report# B0805.03-801.44
Date 10/23/11 Tech AK

Glass*Craft

Fiberglass Glazed Doors

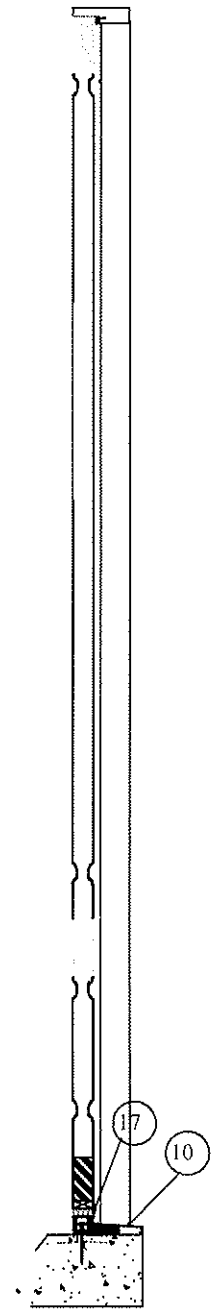
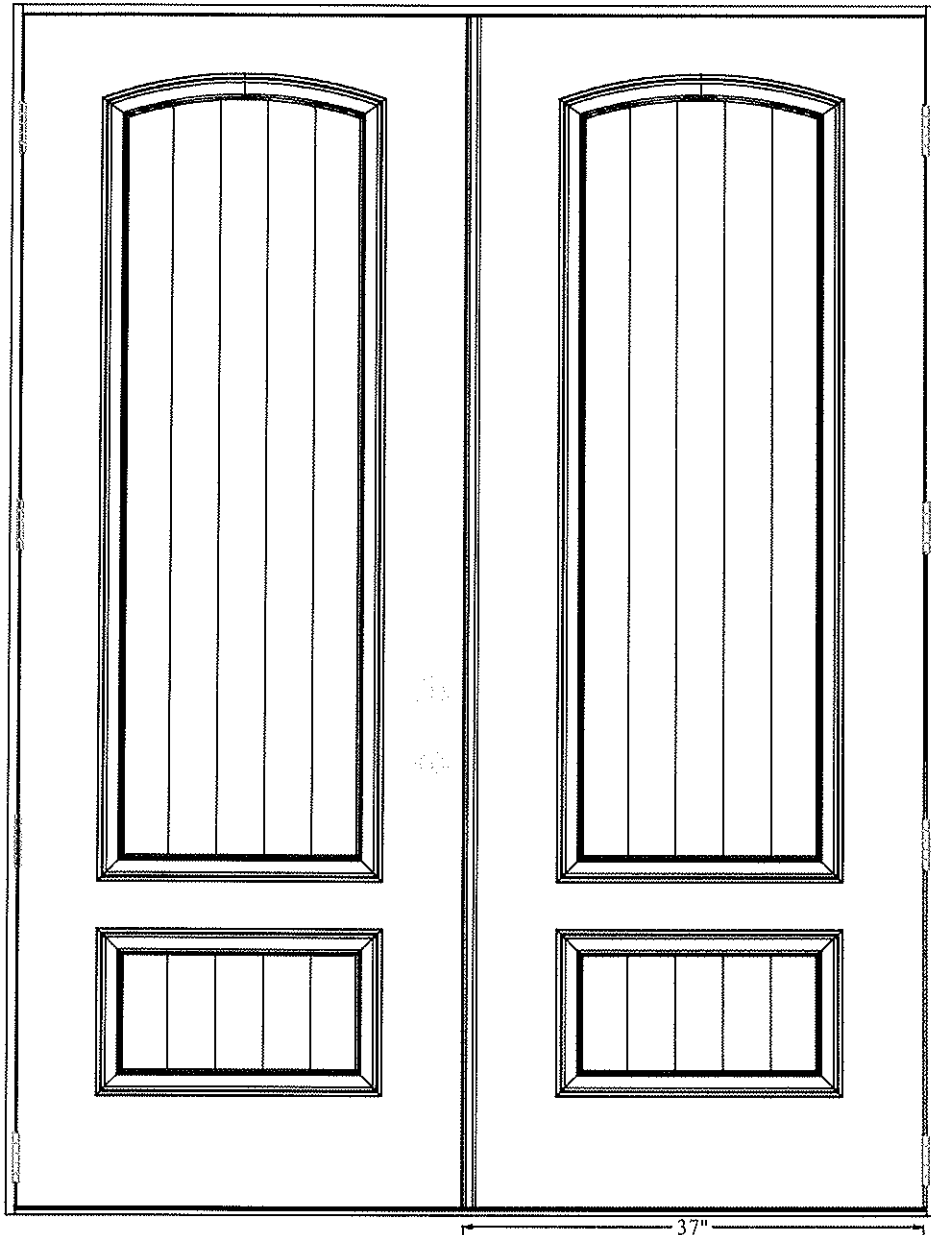

Section
H-H



Architectural Testing

Test sample complies with these details.
Deviations are noted.

Report# BDE05-NB-SD-44
Date 6/23/11 Rev. HQ

Glass*Craft
Fiberglass Glazed Doors

See Hinge Detail

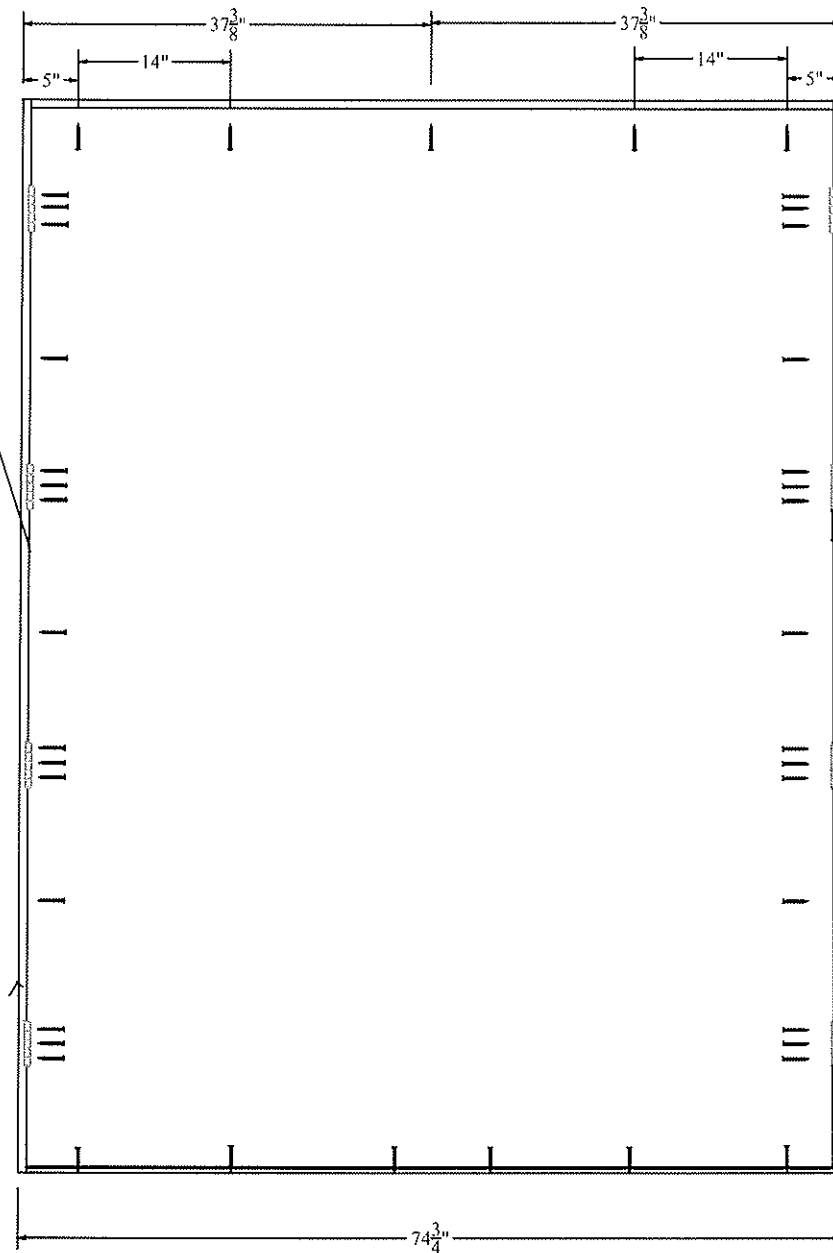

ANCHORING LOCATION



Architectural Testing

Test sample complies with these details.
Deviations are noted.

Report: B0865-03-801-44
6/23/11 HO

Glass*Craft

Fiberglass Glazed Doors

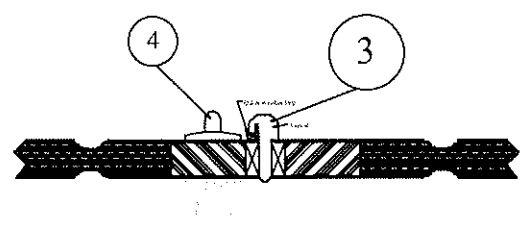
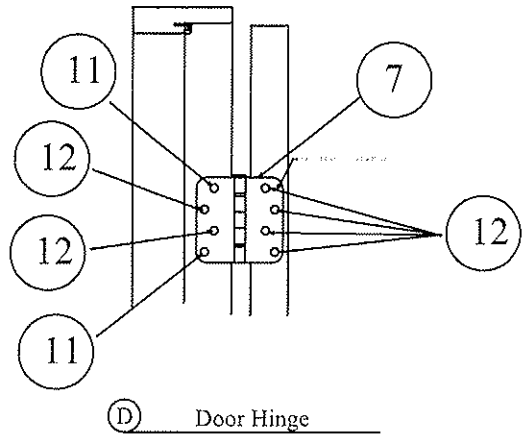
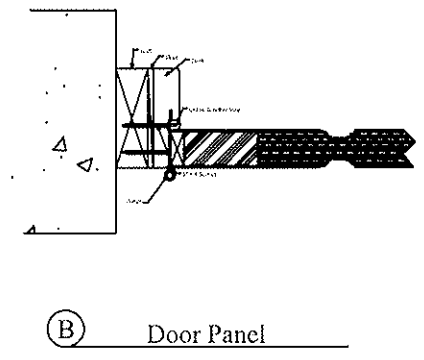
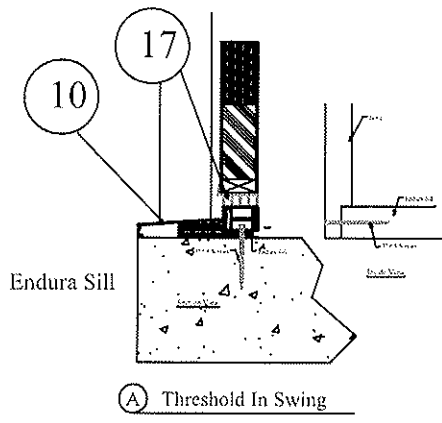

Glass*Craft

Fiberglass Glazed Doors

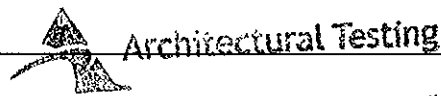

Test sample complies with these details.
 Deviations are noted.
 Report# BD065-03-801-44
 Date 6/23/11 Tech NKQ

Penrond 4"x4" 5/8" Radius Hinge

Install (2) 3" #8 Wood
Screws Per Henge.

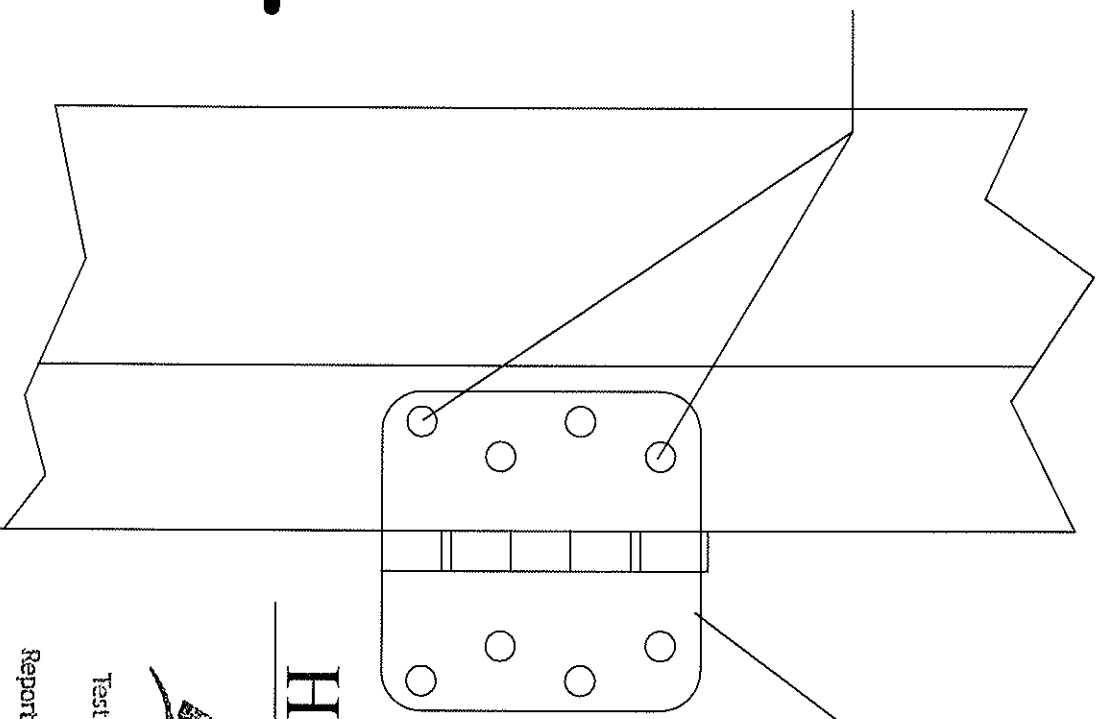

Glass*Craft

Fiberglass Glazed Doors

Hinge Detail



Architectural Testing

Test sample complies with these details.
Deviations are noted.

Report# B0885.03-80144

Date 10/23/11 Tech TD

List of Material

Item #	Description	Material
1	Masonry	CONC.
2	2x Buck	Wood
3	Astrical Imperial T-1-7ST	Alum.
4	Imperial USA Ltd. 168MPL	Metal
5	Glass Frame	Plastic
7	Penrond 4"x4" 5/8" Radius Hinge	Metal
8	Impact Glass	Glass
10	Endura Sill ZAIL 5866 / I/S	Alum.
11	3" #9 Wood screw	Metal
12	#9x1" PFH Wood Screw	Metal
13	Imperial Lock Set IH400 OP6	Metal
16	Door Jam	Composite
17	Bottom Door sweep	Rubber
18	10-32 Sex Bolt	Metal
20	weather strip	Foam
21	Endura Sill ZAIL 5866 / O/S	Alum.



Architectural Testing

Test sample complies with these details.
Deviations are noted.

Report#

BD865.038144

Date

12/31/11

Test #

10



Endura Sill
ZAIL 5866 / I/S

(10)

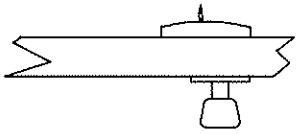

Imperial Lock Set

(13)

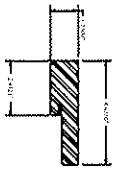

Door Jam

(16)



weather strip

(20)



Astrical

(3)

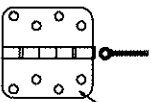

Penrond 4"x4" 5/8" Radius Hinge

(7)



Bottom Door sweep

(17)



Outer Frame

(5)

Inner Frame

Glass*Craft
Fiberglass Glazed Doors

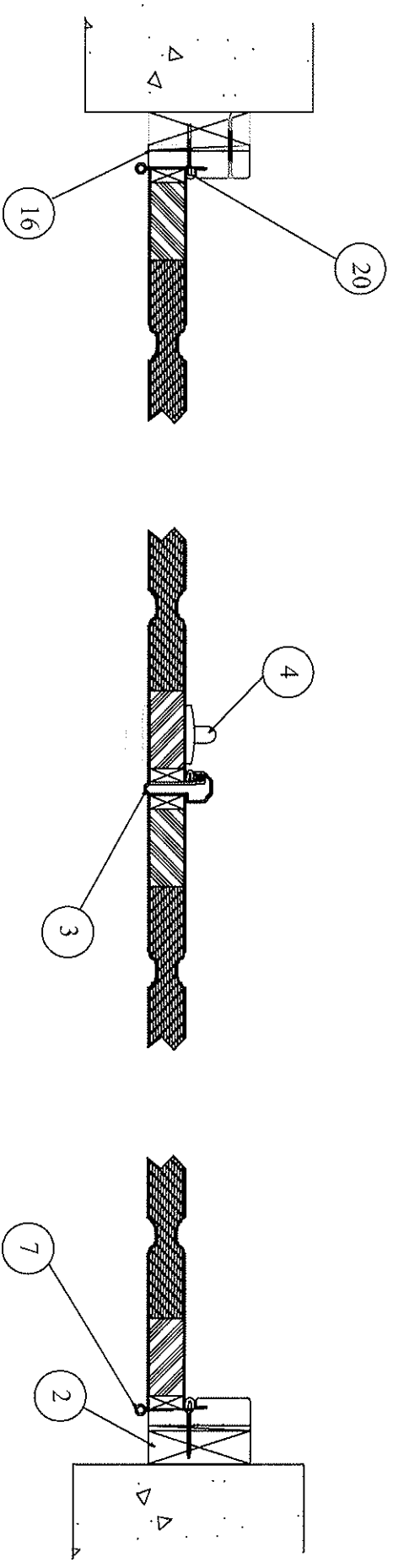

Horizontal Cross Section

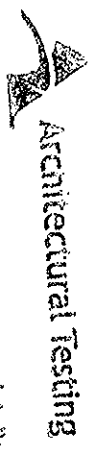

Test sample complies with these details.
 Deviations are noted.

Report# B0805-03-80144
 Date 12/23/11 Tech WJ0

Glass*Craft
 Fiberglass Glazed Doors

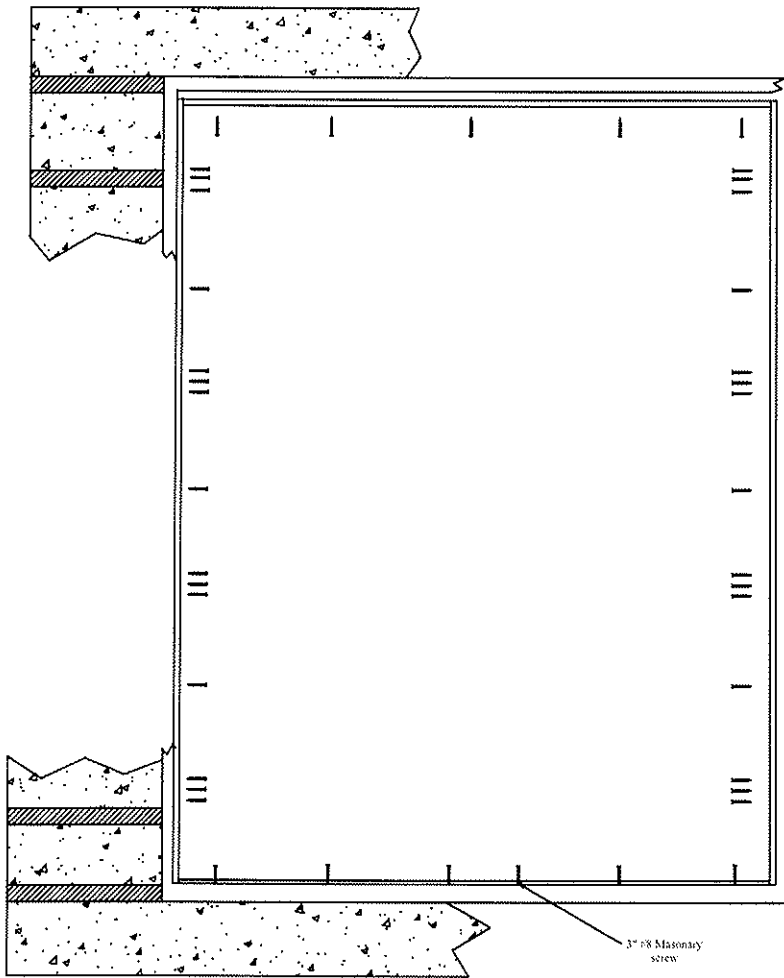

ANCHORING LAYOUT

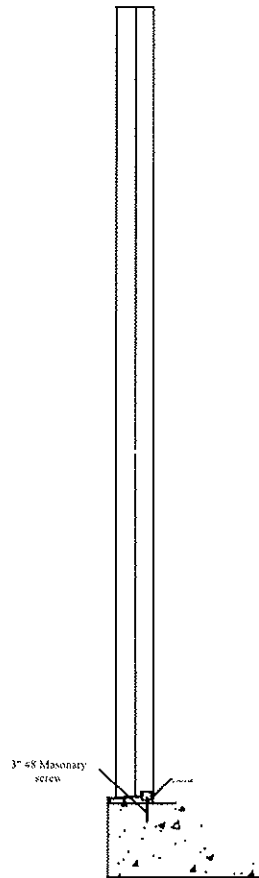

Set frame sill in concrete
or bed of caulk



Architectural Testing

Test sample complies with these details.
Deviations are noted.

Report# B0505.03.801.44
Date 0123/11 Tech HO

Glass*Craft
Fiberglass Glazed Doors

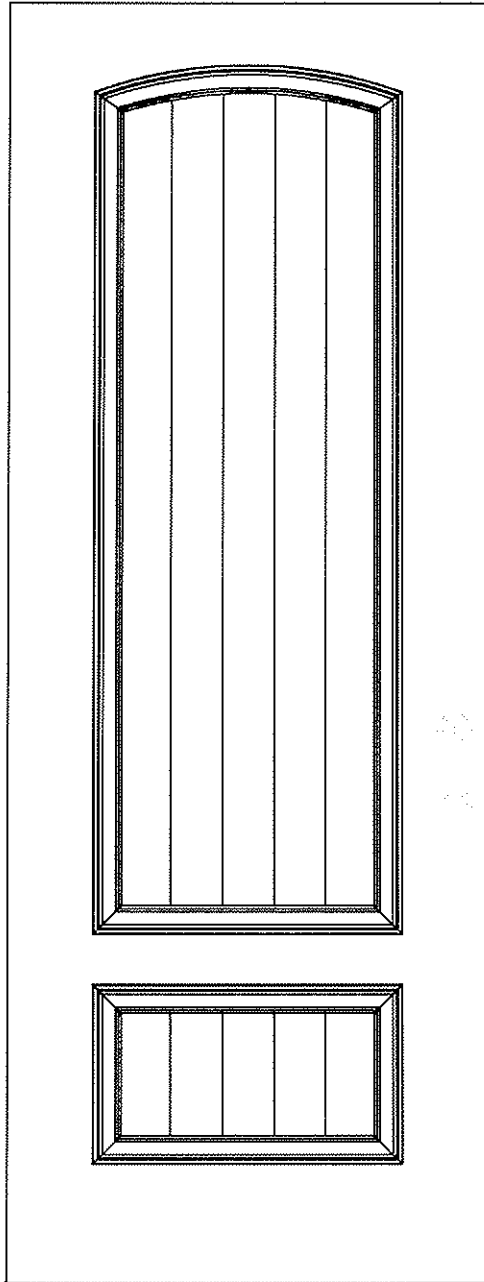

Architectural Testing

Test sample complies with these details.
Deviations are noted.

Report# B0805-03-SD1-44

Date 6/23/11 Tech HTQ

Glass*Craft

Fiberglass Glazed Doors